

AREA OF
**WILD POTATO
 LAKE**
 DISTRICT OF
 RAINY RIVER
 KENORA
 MINING DIVISION
 SCALE: 1-INCH = 40 CHAINS

LEGEND

PATENTED LAND	
CROWN LAND SALE	
LEASES	
LOCATED LAND	
LICENSE OF OCCUPATION	
MINING RIGHTS ONLY	M
SURFACE RIGHTS ONLY	S
ROADS	
IMPROVED ROADS	
KING'S HIGHWAYS	
RAILWAYS	
POWER LINES	
MARSH OR MUSKES	
MINES	

NOTES

FILED: **KENORA**
 FEB. 17 1972
 RECEIPT NO.
 MINING DIVISION

AUG. 20/74

K	K	K	K	K	K	K	K
30220	30221	30222	30223	30224	30225	30226	30227
K	K	K	K	K	K	K	K
30228	30229	30230	30231	30232	30233	30234	30235

Wild Potato

NATIONAL TOPOGRAPHIC SERIES 52C
 PLAN NO. **M-2397**
 ONTARIO
 DEPARTMENT OF MINES
 AND NORTHERN AFFAIRS

BANNET LAKE G-

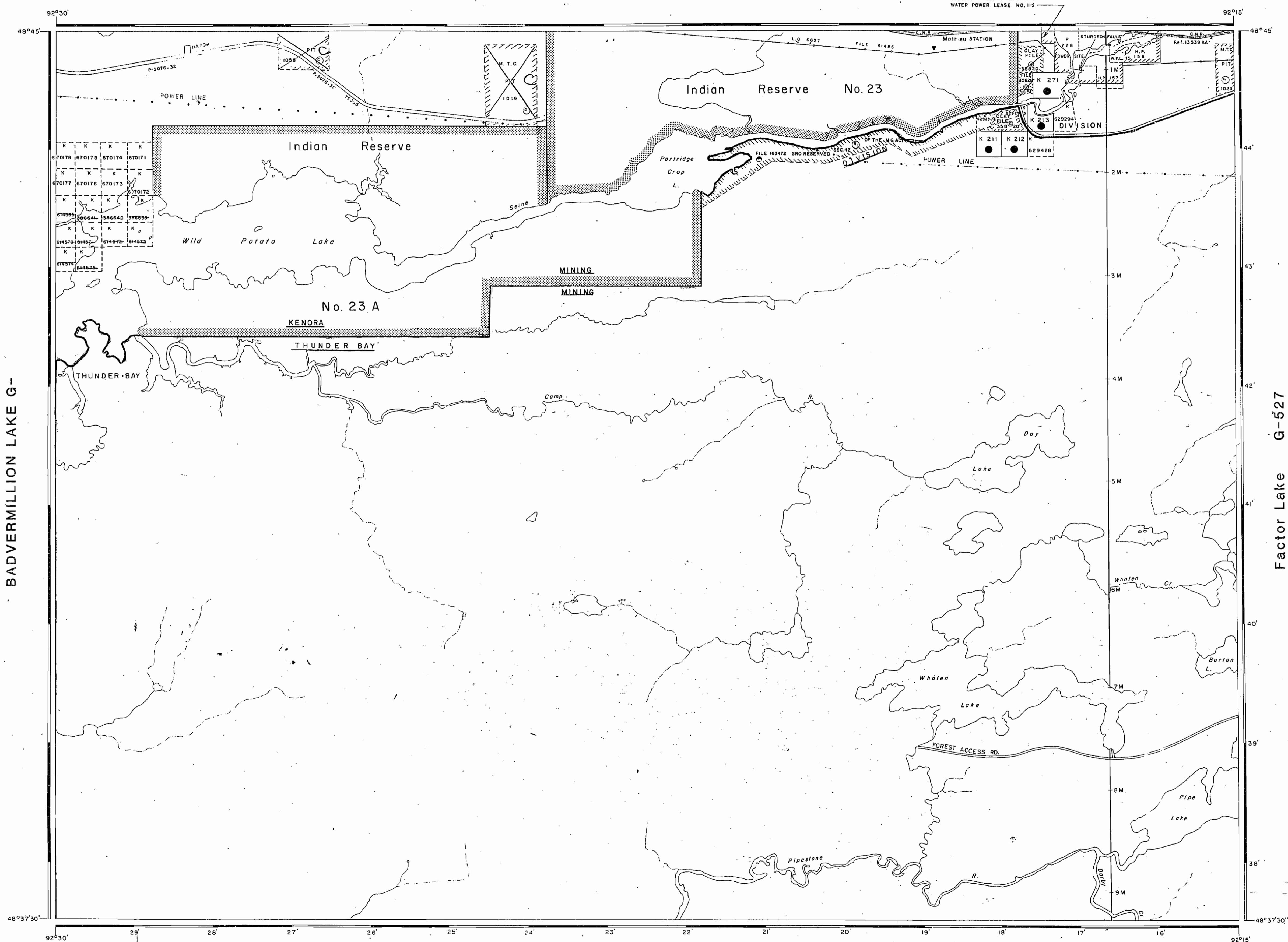

BADVERMILLION LAKE G-

Factor Lake G-527

MAHON LAKE G-538

REFERENCES

DATE OF ISSUE
 JUN 17 1983
 Ministry of Natural Resources
 TORONTO

JUN 24 1983
 Effective as
 48,010,11,12,13,14,15,16,17,18,19,20,21,22,23,24,25,26,27,28,29,30,31,32,33,34,35,36,37,38,39,40,41,42,43,44,45,46,47,48,49,50,51,52,53,54,55,56,57,58,59,60,61,62,63,64,65,66,67,68,69,70,71,72,73,74,75,76,77,78,79,80,81,82,83,84,85,86,87,88,89,90,91,92,93,94,95,96,97,98,99,100

LEGEND

- HIGHWAY AND ROUTE No.
- OTHER ROADS
- TRAILS
- SURVEYED LINES:
 - TOWNSHIPS, BASE LINES, ETC.
 - LOTS, MINING CLAIMS, PARCELS, ETC.
- UNSURVEYED LINES:
 - LOT LINES
 - PARCEL BOUNDARY
 - MINING CLAIMS ETC.
- RAILWAY AND RIGHT OF WAY
- UTILITY LINES
- NON-PERENNIAL STREAM
- FLOODING OR FLOODING RIGHTS
- SUBDIVISION OR COMPOSITE PLAN
- RESERVATIONS
- ORIGINAL SHORELINE
- MARSH OR MUSKEG
- MINES
- TRAVERSE MONUMENT

DISPOSITION OF CROWN LANDS

TYPE OF DOCUMENT	SYMBOL
PATENT, SURFACE & MINING RIGHTS	●
" SURFACE RIGHTS ONLY	○
" MINING RIGHTS ONLY	◐
LEASE, SURFACE & MINING RIGHTS	■
" SURFACE RIGHTS ONLY	□
" MINING RIGHTS ONLY	◻
LICENCE OF OCCUPATION	▼
ORDER-IN-COUNCIL	OC
RESERVATION	⊙
CANCELLED	⊖
SAND & GRAVEL	⊕

NOTE: MINING RIGHTS IN PARCELS PATENTED PRIOR TO MAY 6, 1913, VESTED IN ORIGINAL PATENTEE BY THE PUBLIC LANDS ACT, R.S.O. 1970, CHAP. 380, SEC. 63, SUBSEC. 1.

SCALE: 1 INCH = 40 CHAINS

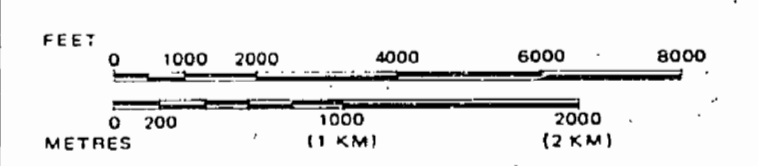

AREA
WILD POTATO LAKE
 M.N.R. ADMINISTRATIVE DISTRICT
ATIKOKAN & FORT FRANCES
 MINING DIVISION
THUNDER BAY & KENORA
 LAND TITLES / REGISTRY DIVISION
RAINY RIVER

Ministry of Land Management
 Natural Resources Branch
 Ontario

Date Dec. 1981 Number
G-565

BANNET LAKE G-527
BENNETT

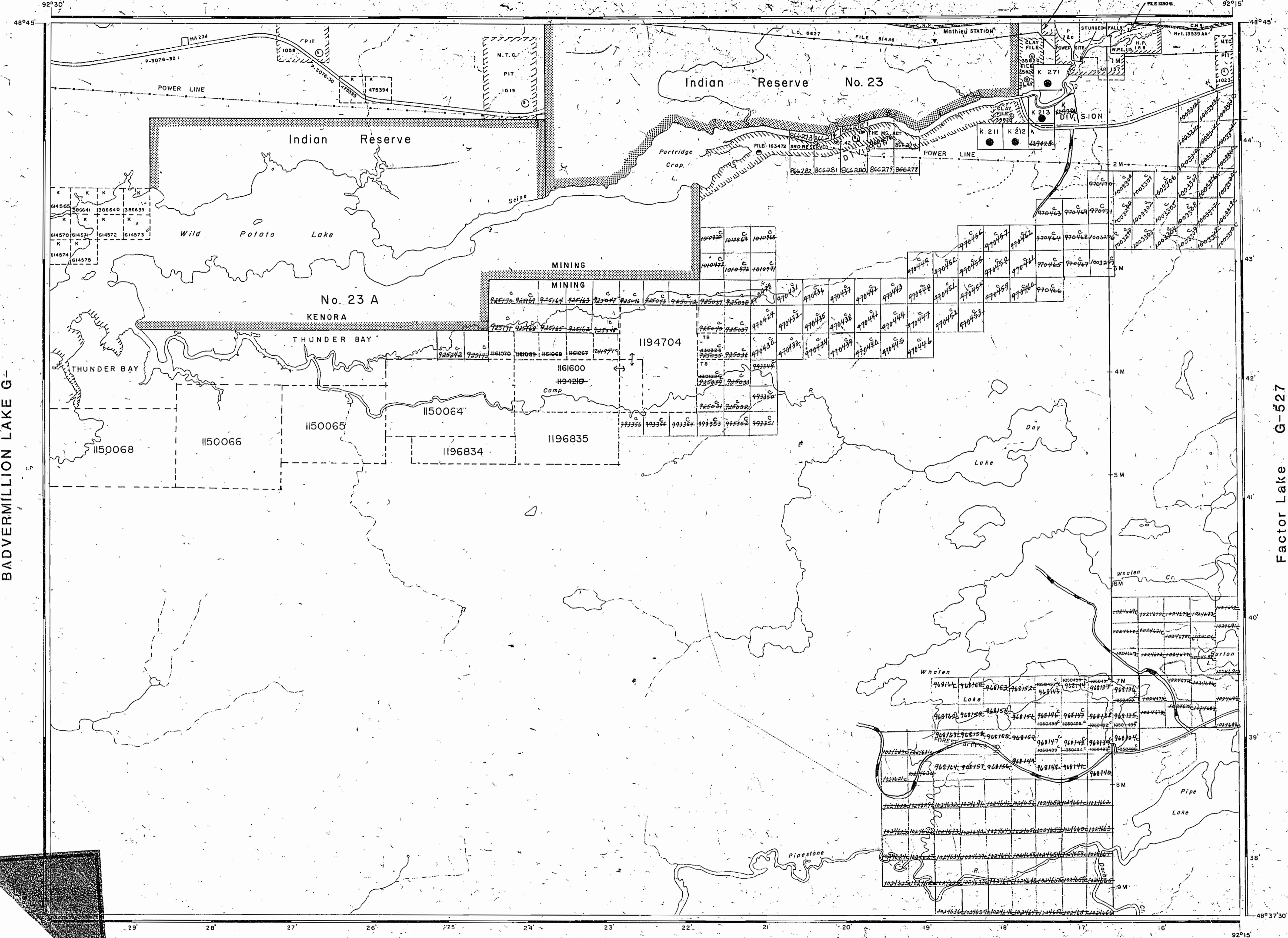

MAHON LAKE G-538

REFERENCES

THE INFORMATION THAT APPEARS ON THIS MAP HAS BEEN COMPILED FROM VARIOUS SOURCES AND ACCURACY IS NOT GUARANTEED. THOSE WISHING TO STAKE MINING CLAIMS SHOULD CONSULT WITH THE MINING RECORDER, MINISTRY OF NORTHERN DEVELOPMENT AND MINES, FOR ADDITIONAL INFORMATION ON THE STATUS OF THE LANDS SHOWN HEREON.

LEGEND

- HIGHWAY AND ROUTE No.
- OTHER ROADS
- TRAILS
- SURVEYED LINES:
 - TOWNSHIPS, BASE LINES, ETC.
 - LOTS, MINING CLAIMS, PARCELS, ETC.
- UNSURVEYED LINES:
 - LOT LINES
 - PARCEL BOUNDARY
 - MINING CLAIMS ETC.
- RAILWAY AND RIGHT OF WAY
- UTILITY LINES
- NON-PERENNIAL STREAM
- FLOODING OR FLOODING RIGHTS
- SUBDIVISION OR COMPOSITE PLAN
- RESERVATIONS
- ORIGINAL SHORELINE
- MARSH OR MUSKEG
- MINES
- TRAVERSE MONUMENT

DISPOSITION OF CROWN LANDS

TYPE OF DOCUMENT	SYMBOL
PATENT, SURFACE & MINING RIGHTS	
SURFACE RIGHTS ONLY	
MINING RIGHTS ONLY	
LEASE, SURFACE & MINING RIGHTS	
SURFACE RIGHTS ONLY	
MINING RIGHTS ONLY	
LICENCE OF OCCUPATION	
ORDER-IN-COUNCIL	
RESERVATION	
CANCELLED	
SAND & GRAVEL	

LAND USE PERMITS FOR COMMERCIAL TOURISM, OUTPOST CAMPS
NOTE: MINING RIGHTS IN PARCELS PATENTED PRIOR TO MAY 8, 1913, VESTED IN ORIGINAL PATENTEE BY THE PUBLIC LANDS ACT, R.S.O. 1970, CHAP. 380, SEC. 63, SUBSEC. 1.

SCALE: 1 INCH = 40 CHAINS

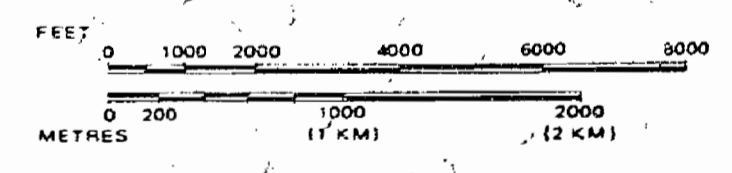

AREA
WILD POTATO LAKE

M.N.R. ADMINISTRATIVE DISTRICT
ATIKOKAN & FORT FRANCES
MINING DIVISION
THUNDER BAY & KENORA
LAND TITLES / REGISTRY DIVISION
RAINY RIVER

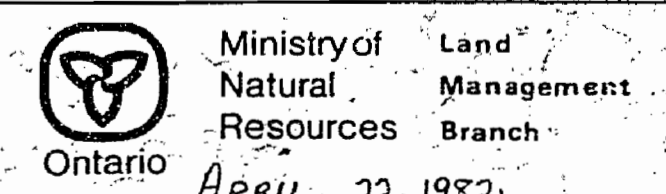

Ontario Ministry of Natural Resources and Land Management
APRIL 22 1982

Date Dec. 1981

Number
G-565

THUNDER BAY
RECEIVED
JUN 6 1995 P.M.
A.A. 71819

JUN 26, 1995
G-565

AREA OF
WILD POTATO LAKE

DISTRICT OF
 RAINY RIVER

KENORA — THUNDER BAY
 MINING DIVISION

SCALE: 1-INCH = 40 CHAINS

LEGEND

- PATENTED LAND Ⓟ
- CROWN LAND SALE C.S.
- LEASES Ⓛ
- LOCATED LAND LOC.
- LICENSE OF OCCUPATION L.O.
- MINING RIGHTS ONLY M.R.O.
- SURFACE RIGHTS ONLY S.R.O.
- ROADS —
- IMPROVED ROADS —
- KING'S HIGHWAYS —
- RAILWAYS —
- POWER LINES —
- MARSH OR MUSKEG —
- MINES —

February 16, 1911

NOTES

ATKOKAN DISTRICT
 NATIONAL TOPOGRAPHIC SERIES 52 C9

PLAN NO. **M-2397**

MINISTRY OF NATURAL RESOURCES
 SOUTHERN BRANCH

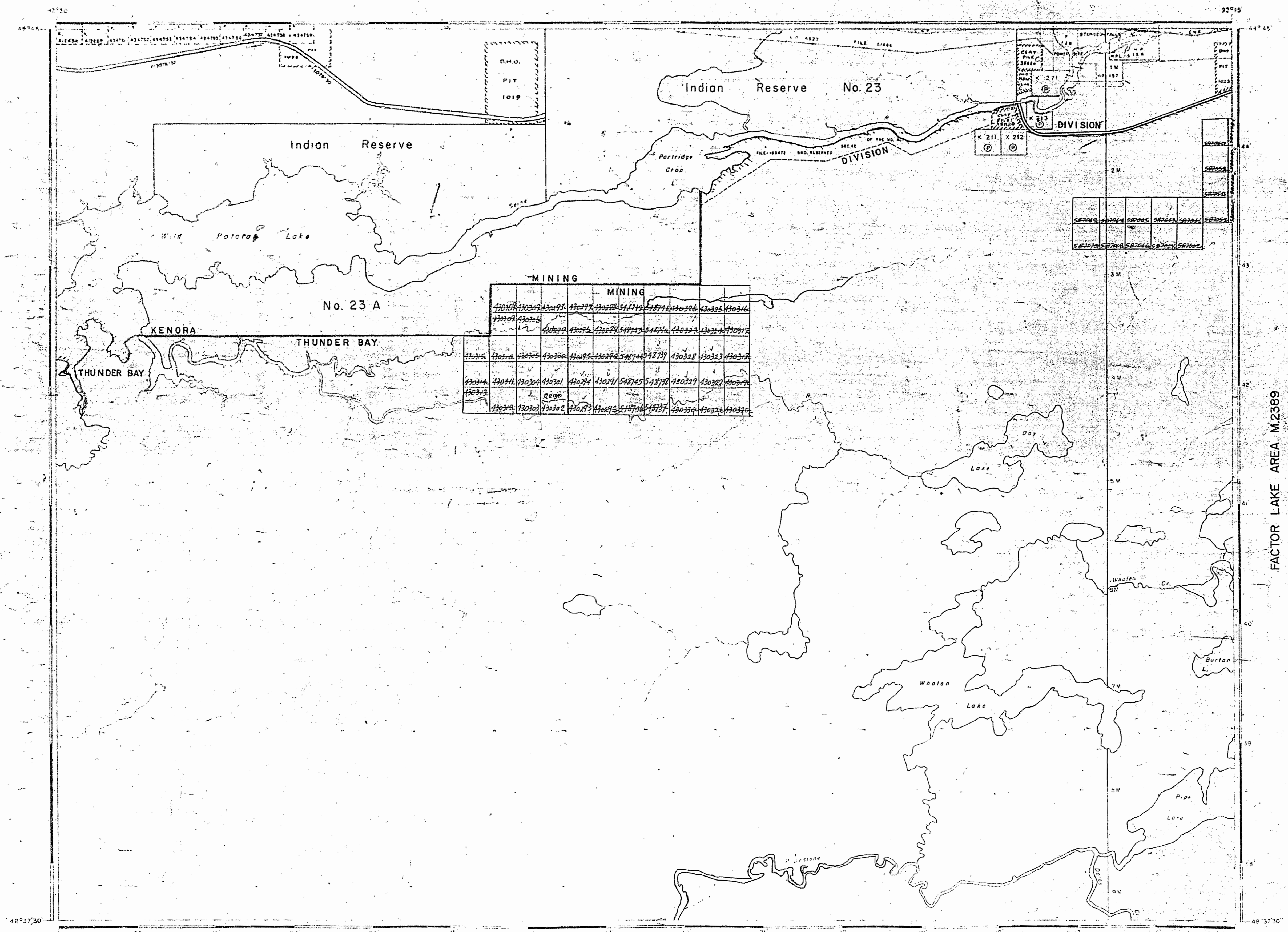

BANNET LAKE G-
BENNETT

REFERENCES

THE INFORMATION THAT APPEARS ON THIS MAP HAS BEEN COMPILED FROM VARIOUS SOURCES, AND ACCURACY IS NOT GUARANTEED. THOSE WISHING TO STAKE MINING CLAIMS SHOULD CONSULT WITH THE MINING RECORDER, MINISTRY OF NORTHERN DEVELOPMENT AND MINES, FOR ADDITIONAL INFORMATION ON THE STATUS OF THE LANDS SHOWN HEREO.

PROPOSED FORESTRY ACTIVITIES FOR 1982/83

LEGEND

- HIGHWAY AND ROUTE No.
- OTHER ROADS
- TRAILS
- SURVEYED LINES:
 - TOWNSHIPS, BASE LINES, ETC.
 - LOTS, MINING CLAIMS, PARCELS, ETC.
- UNSURVEYED LINES:
 - LOT LINES
 - PARCEL BOUNDARY
 - MINING CLAIMS ETC.
- RAILWAY AND RIGHT OF WAY
- UTILITY LINES
- NON-PERENNIAL STREAM
- FLOODING OR FLOODING RIGHTS
- SUBDIVISION OR COMPOSITE PLAN
- RESERVATIONS
- ORIGINAL SHORELINE
- MARSH OR MUSKEG
- MINES
- TRAVERSE MONUMENT

DISPOSITION OF CROWN LANDS

TYPE OF DOCUMENT	SYMBOL
PATENT, SURFACE & MINING RIGHTS	●
SURFACE RIGHTS ONLY	○
MINING RIGHTS ONLY	◐
LEASE, SURFACE & MINING RIGHTS	◑
SURFACE RIGHTS ONLY	◒
MINING RIGHTS ONLY	◓
LICENCE OF OCCUPATION	◔
ORDER-IN-COUNCIL	○
RESERVATION	○
CANCELLED	○
SAND & GRAVEL	○

LAND USE PERMITS FOR COMMERCIAL TOURISM/OUTPOST CAMPS
NOTE: MINING RIGHTS IN PARCELS PATENTED PRIOR TO MAY 6, 1913, VESTED IN ORIGINAL PATENTEE BY THE PUBLIC LANDS ACT, R.S.O. 1970, CHAP. 380, SEC. 63, SUBSEC. 1.

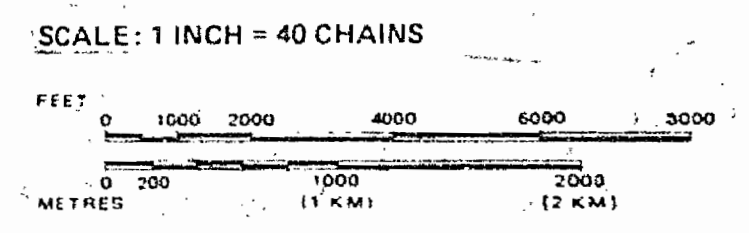

AREA
WILD POTATO LAKE
M.N.R. ADMINISTRATIVE DISTRICT
ATIKOKAN & FORT FRANCES
MINING DIVISION
THUNDER BAY & KENORA
LAND TITLES / REGISTRY DIVISION
RAINY RIVER

Ministry of Natural Resources
Land Management Branch
Ontario
Date: Dec. 1981
Number: APRIL 22, 1982

486922 **G-565**

BADVERMILLION LAKE G-

Factor Lake G-527

MAHON LAKE G-538

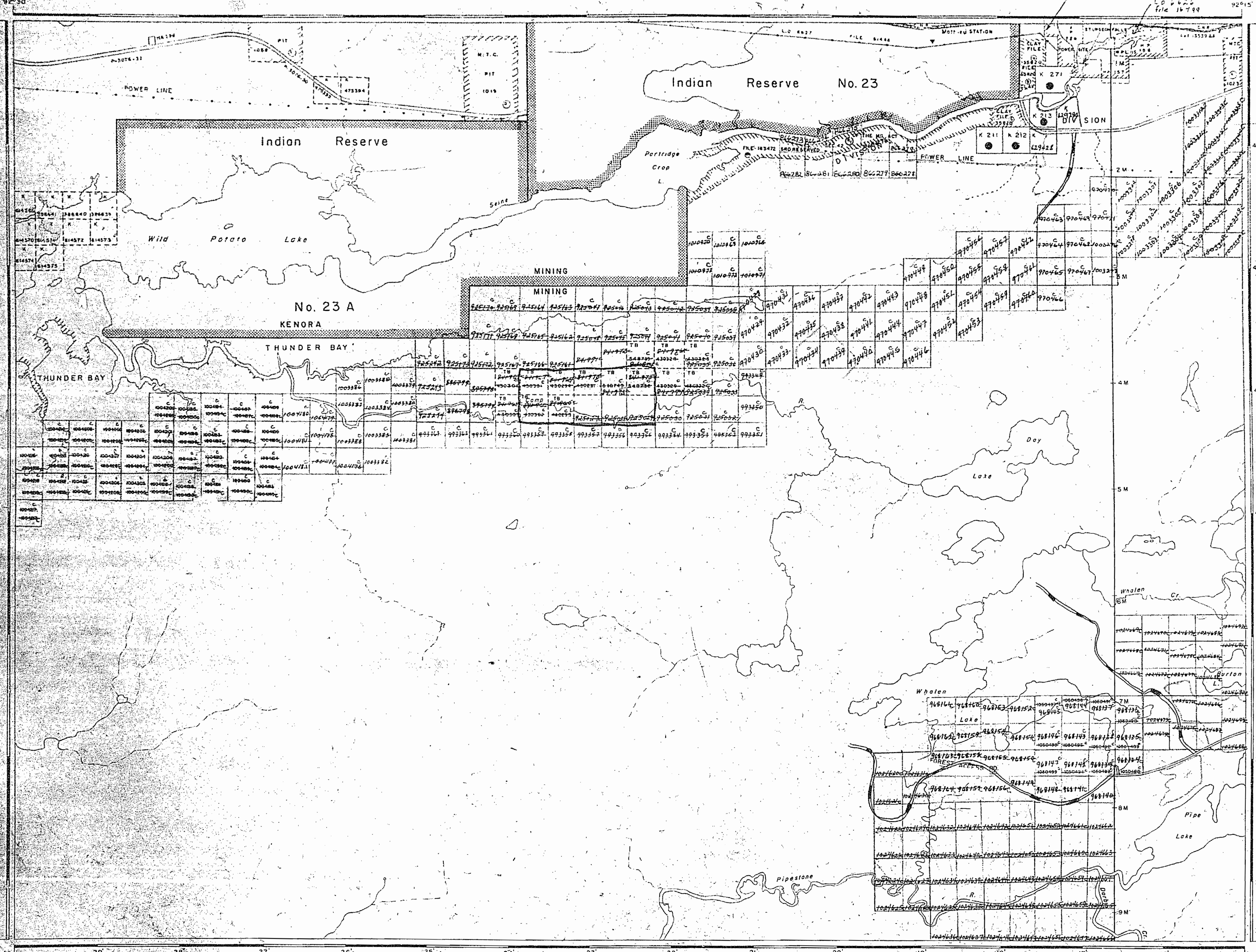

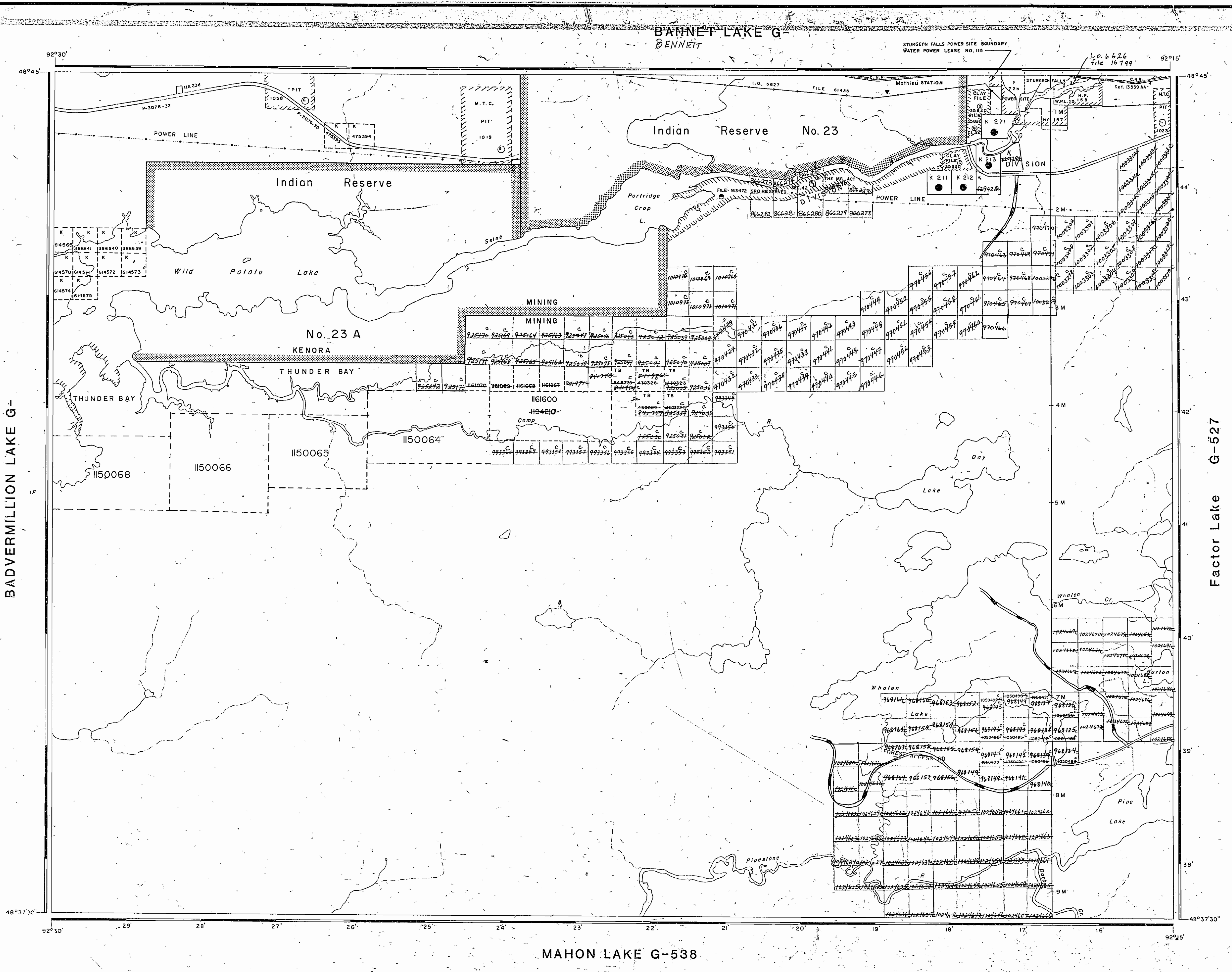

REFERENCES

THE INFORMATION THAT APPEARS ON THIS MAP HAS BEEN COMPILED FROM VARIOUS SOURCES, AND ACCURACY IS NOT GUARANTEED. THOSE WISHING TO STAKE MINING CLAIMS SHOULD CONSULT WITH THE MINING RECORDER, MINISTRY OF NORTHERN DEVELOPMENT AND MINES, FOR ADDITIONAL INFORMATION ON THE STATUS OF THE LANDS SHOWN HEREON.

RECEIVED
THUNDER BAY
MINING DIVISION
9th May 4 PM 2:05

* PROPOSED FORESTRY ACTIVITIES FOR 1989/90.

LEGEND

- HIGHWAY AND ROUTE No.
- OTHER ROADS
- TRAILS
- SURVEYED LINES:
 - TOWNSHIPS, BASE LINES, ETC.
 - LOTS, MINING CLAIMS, PARCELS, ETC.
- UNSURVEYED LINES:
 - LOT LINES
 - PARCEL BOUNDARY
 - MINING CLAIMS ETC.
- RAILWAY AND RIGHT OF WAY
- UTILITY LINES
- NON PERENNIAL STREAM
- FLOODING OR FLOODING RIGHTS
- SUBDIVISION OR COMPOSITE PLAN
- RESERVATIONS
- ORIGINAL SHORELINE
- MARSH OR MUSKEG
- MINES
- TRAVERSE MONUMENT

DISPOSITION OF CROWN LANDS

TYPE OF DOCUMENT	SYMBOL
PATENT, SURFACE & MINING RIGHTS	
" SURFACE RIGHTS ONLY	
" MINING RIGHTS ONLY	
LEASE, SURFACE & MINING RIGHTS	
" SURFACE RIGHTS ONLY	
" MINING RIGHTS ONLY	
LICENCE OF OCCUPATION	
ORDER-IN-COUNCIL	
RESERVATION	
CANCELLED	
SAND & GRAVEL	
LAND USE PERMITS FOR COMMERCIAL TOURISM/OUTPOST CAMPS	

NOTE: MINING RIGHTS IN PARCELS PATENTED PRIOR TO MAY 6, 1913, VESTED IN ORIGINAL PATENTEE BY THE PUBLIC LANDS ACT, R.S.O. 1970, CHAP. 360, SEC. 63, SUBSEC. 1.

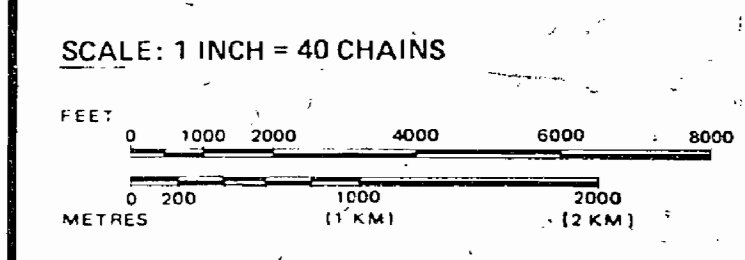

AREA

WILD POTATO LAKE

M.N.R. ADMINISTRATIVE DISTRICT
ATIKOKAN & FORT FRANCES
 MINING DIVISION
THUNDER BAY & KENORA
 LAND TITLES / REGISTRY DIVISION
RAINY RIVER

Ministry of Natural Resources
 Land Management Branch

Date: Dec. 1981
 Number: **G-565**

MAY 4, 1994
 G-565

BANNET LAKE G-538
BENNETT

REFERENCES

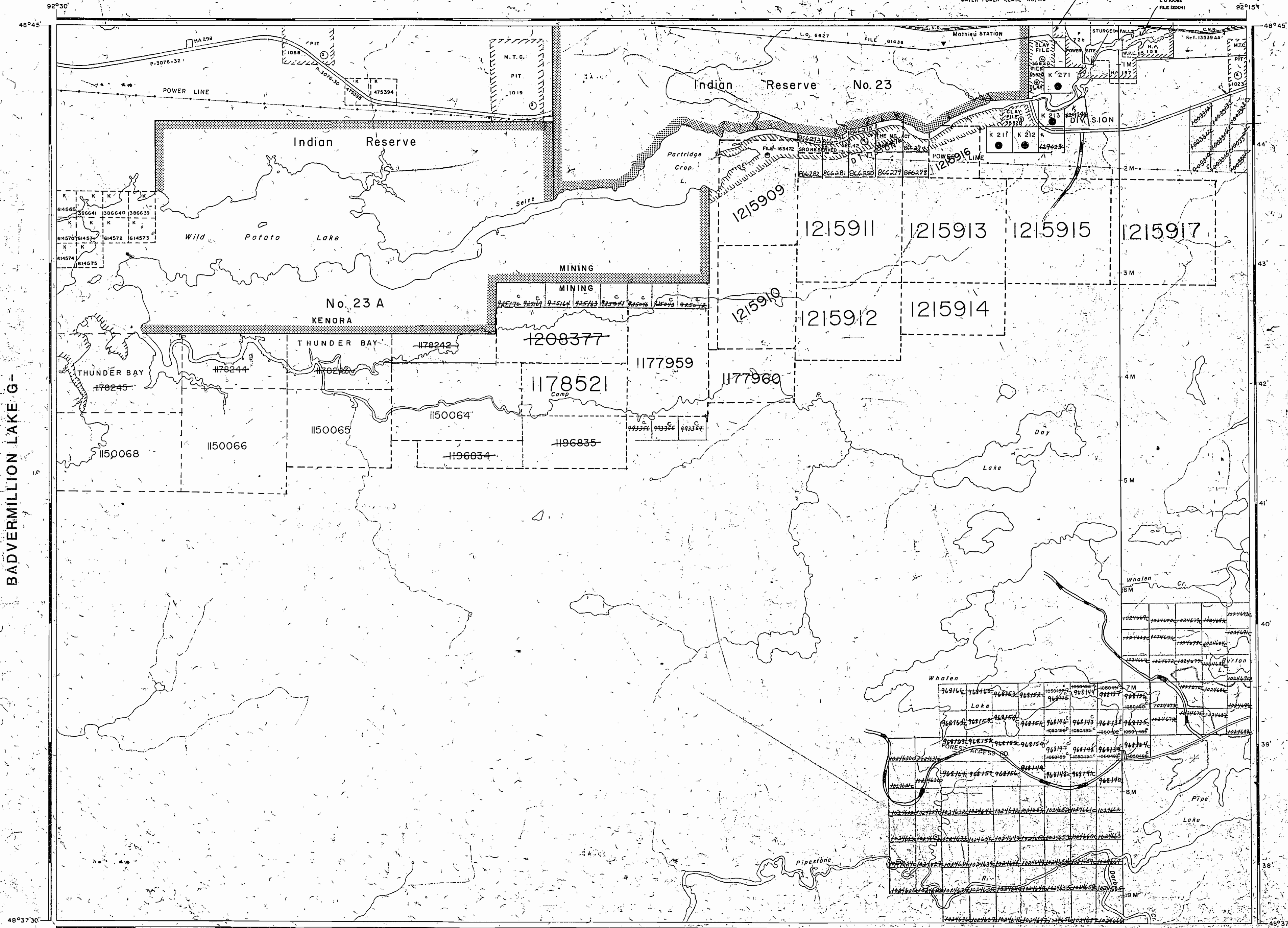

PROPOSED FORESTRY ACTIVITIES FOR 1983/84.
NOTICE: The information that appears on this map has been compiled from various sources and accuracy is not guaranteed. Those wishing to stake MINING CLAIMS should consult with the MINING RECORDER, Ministry of Northern Development and Mines, for additional information on the status of the lands shown hereon.

LEGEND

- HIGHWAY AND ROUTE No.
- OTHER ROADS
- TRAILS
- SURVEYED LINES - TOWNSHIPS, BASE LINES, ETC.
- LOTS, MINING CLAIMS, PARCELS, ETC.
- UNSURVEYED LINES
- LOT LINES
- PARCEL BOUNDARY
- MINING CLAIMS ETC.
- RAILWAY AND RIGHT OF WAY
- UTILITY LINES
- NON-PERENNIAL STREAM
- FLOODING OR FLOODING RIGHTS
- SUBDIVISION OR COMPOSITE PLAN
- RESERVATIONS
- ORIGINAL SHORELINE
- MARSH OR MUSKEG
- MINES
- TRAVERSE MONUMENT

DISPOSITION OF CROWN LANDS

TYPE OF DOCUMENT	SYMBOL
PATENT, SURFACE & MINING RIGHTS	
SURFACE RIGHTS ONLY	
MINING RIGHTS ONLY	
LEASE, SURFACE & MINING RIGHTS	
SURFACE RIGHTS ONLY	
MINING RIGHTS ONLY	
LICENCE OF OCCUPATION	
ORDER-IN-COUNCIL	
RESERVATION	
CANCELLED	
SAND & GRAVEL	
LAND USE PERMITS FOR COMMERCIAL TOURISM/OUTPOST CAMPS	

NOTE: MINING RIGHTS IN PARCELS PATENTED PRIOR TO MAY 8, 1913, VESTED IN ORIGINAL PATENTEE BY THE PUBLIC LANDS ACT, R.S.O. 1970, CHAP. 380, SEC. 63, SUBSEC. 1.

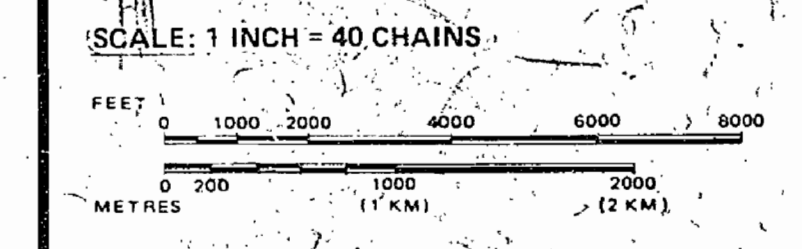

AREA
WILD POTATO LAKE
M.N.R. ADMINISTRATIVE DISTRICT
ATIKOKAN & FORT FRANCES
MINING DIVISION
THUNDER BAY & KENORA
LAND TITLES / REGISTRY DIVISION
RAINY RIVER

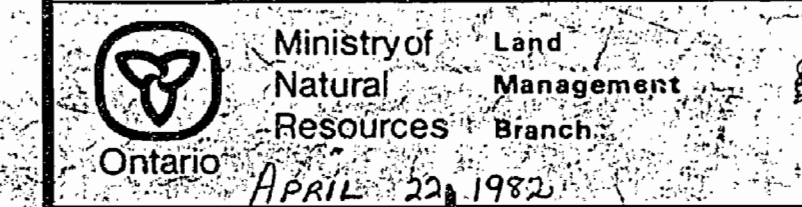

Date: APRIL 22, 1982
Number: D.O.C. 1981
G-565

MAHON LAKE G-538

BADVERMILLION LAKE G-

Factor Lake G-527

BANNET LAKE G-
BENNETT

REFERENCES

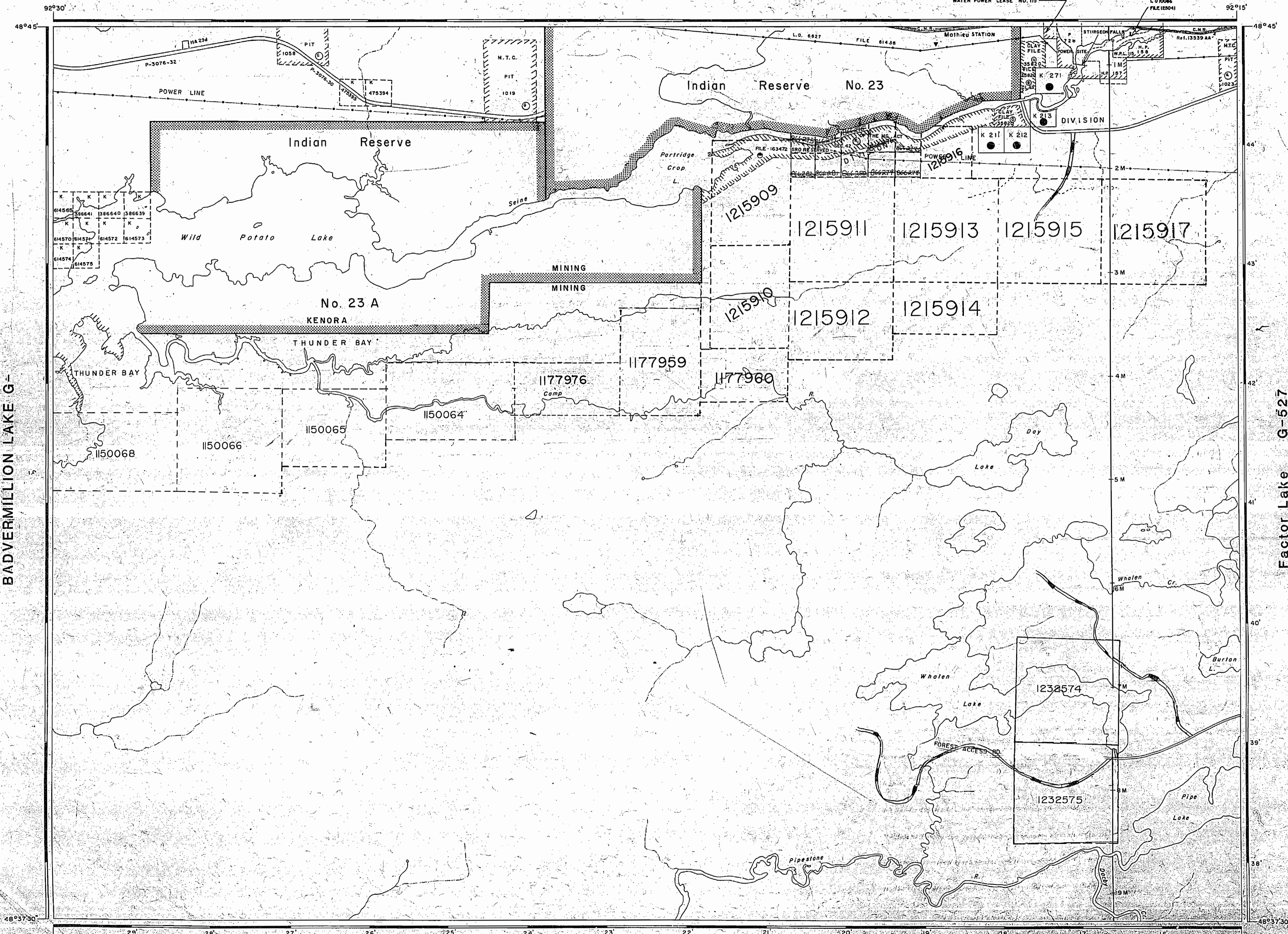

PROPOSED FORESTRY ACTIVITIES FOR 1989/90
 NOTICE:
 The information that appears on this map has been compiled from various sources and accuracy is not guaranteed. Those wishing to stake MINING CLAIMS should consult with the MINING RECORDER, Ministry of Northern Development and Mines, for additional information on the status of the lands shown hereon.

LEGEND

- HIGHWAY AND ROUTE No.
- OTHER ROADS
- TRAILS
- SURVEYED LINES - TOWNSHIPS, BASE LINES, ETC.
- LOTS, MINING CLAIMS, PARCELS, ETC.
- UNSURVEYED LINES
- LOT LINES
- PARCEL BOUNDARY
- MINING CLAIMS ETC.
- RAILWAY AND RIGHT OF WAY
- UTILITY LINES
- NON-PERENNIAL STREAM
- FLOODING OR FLOODING RIGHTS
- SUBDIVISION OR COMPOSITE PLAN
- RESERVATIONS
- ORIGINAL SHORELINE
- MARSH OR MUSKEG
- MINES
- TRAVERSE MONUMENT

DISPOSITION OF CROWN LANDS

TYPE OF DOCUMENT	SYMBOL
PATENT, SURFACE & MINING RIGHTS	●
SURFACE RIGHTS ONLY	○
MINING RIGHTS ONLY	◐
LEASE, SURFACE & MINING RIGHTS	■
SURFACE RIGHTS ONLY	□
MINING RIGHTS ONLY	◑
LICENCE OF OCCUPATION	▼
ORDER-IN-COUNCIL	OC
RESERVATION	○
CANCELLED	○
SAND & GRAVEL	○
LAND USE PERMITS FOR COMMERCIAL TOURISM/OUTPOST CAMPS	▽

NOTE: MINING RIGHTS IN PARCELS PATENTED PRIOR TO MAY 6, 1912, VESTED IN ORIGINAL PATENTEE BY THE PUBLIC LANDS ACT, R.S.O. 1970, CHAP. 380, SEC. 62, SUBSEC. 1.

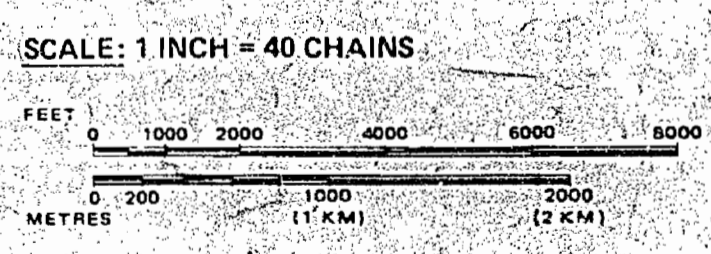

AREA
WILD POTATO LAKE
 M.N.R. ADMINISTRATIVE DISTRICT
ATIKOKAN & FORT FRANCES
 MINING DIVISION
THUNDER BAY & KENORA
 LAND TITLES / REGISTRY DIVISION
RAINY RIVER

Ministry of Natural Resources
 Land Management Branch
 Ontario
 Date: Dec. 1981
 Number: **G-565**

MAHON LAKE G-538

Factor Lake G-527

BADVERMILLION LAKE G-

486922

AREA OF
**WILD POTATO
 LAKE**

DISTRICT OF
 RAINY RIVER

KENORA - THUNDER BAY
 MINING DIVISION

SCALE: 1-INCH = 40 CHAINS

LEGEND

PATENTED LAND	⊙
CROWN LAND SALE	C.S.
LEASES	⊖
LOCATED LAND	⊕
LICENSE OF OCCUPATION	L.O.
MINING RIGHTS ONLY	M.R.O.
SURFACE RIGHTS ONLY	S.R.O.
ROADS	—
IMPROVED ROADS	—
KING'S HIGHWAYS	—
RAILWAYS	—
POWER LINES	—
MARSH OR MUSKEG	—
MINES	—

NOTES

CLAY FILE 35820 (QUARRIES PERMITS)
 EXPIRED IN 1917 - LETTER OF MATTHEWS
 JAN 21/73
 LAND BILL FILE - 5111

FACTOR LAKE AREA M.2389

DATE OF ISSUE
 SEP 29 1977

KENORA
 MINING DIV
RECEIVED
 SEP 30 1977
 AM 7:00 10:11 12:1 2:34 5:00 PM

NATIONAL TOPOGRAPHIC SERIES 52 C 9

PLAN NO. **M-2397**

ONTARIO **G 565**
 MINISTRY OF NATURAL RESOURCES
 SURVEYS AND MAPPING BRANCH

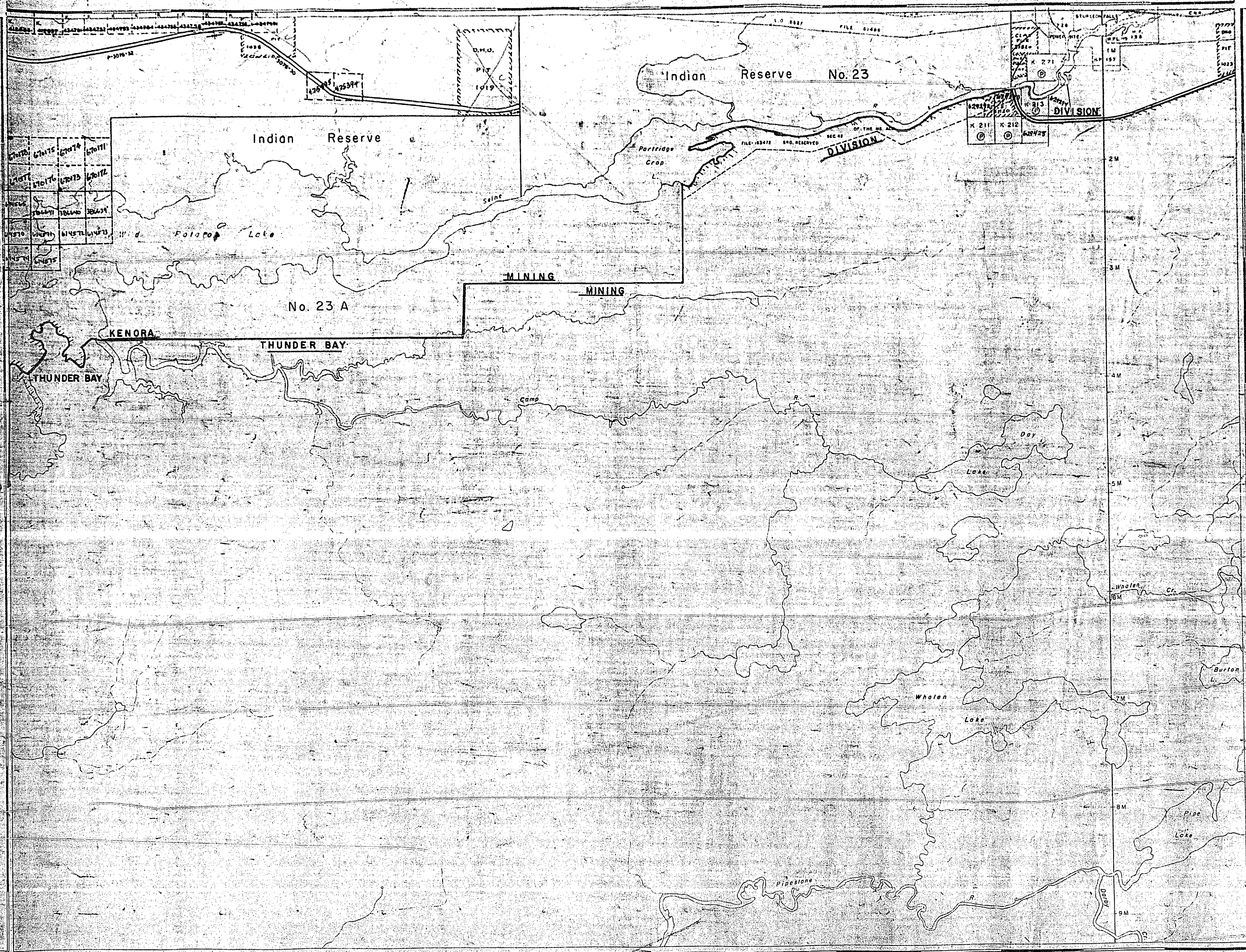

BANNET LAKE G-527

REFERENCES

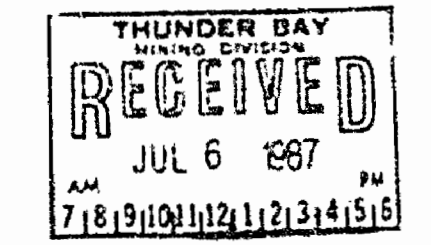

LEGEND

- HIGHWAY AND ROUTE No.
- OTHER ROADS
- TRAILS
- SURVEYED LINES:
 - TOWNSHIPS, BASE LINES, ETC.
 - LOTS, MINING CLAIMS, PARCELS, ETC.
- UNSURVEYED LINES:
 - LOT LINES
 - PARCEL BOUNDARY
 - MINING CLAIMS ETC.
- RAILWAY AND RIGHT OF WAY
- UTILITY LINES
- NON PERENNIAL STREAM
- FLOODING OR FLOODING RIGHTS
- SUBDIVISION OR COMPOSITE PLAN
- RESERVATIONS
- ORIGINAL SHORELINE
- MARSH OR MUSKEG
- MINES
- TRAVERSE MONUMENT

DISPOSITION OF CROWN LANDS

TYPE OF DOCUMENT	SYMBOL
PATENT, SURFACE & MINING RIGHTS	
" SURFACE RIGHTS ONLY	
" MINING RIGHTS ONLY	
LEASE, SURFACE & MINING RIGHTS	
" SURFACE RIGHTS ONLY	
" MINING RIGHTS ONLY	
LICENCE OF OCCUPATION	
ORDER IN COUNCIL	
RESERVATION	
CANCELLED	
SAND & GRAVEL	

NOTE: MINING RIGHTS IN PARCELS PATENTED PRIOR TO MAY 6, 1913, VESTED IN ORIGINAL PATENTEE BY THE PUBLIC LANDS ACT, R.S.O. 1970, CHAP. 380, SEC. 63, SUBSEC. 1.

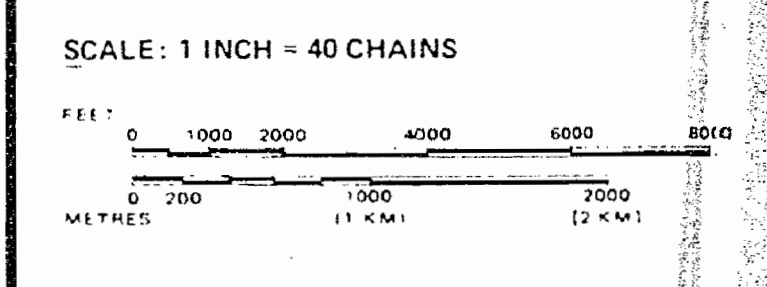

AREA
WILD POTATO LAKE
 M.N.R. ADMINISTRATIVE DISTRICT
ATIKOKAN & FORT FRANCES
 MINING DIVISION
THUNDER BAY & KENORA
 LAND TITLES / REGISTRY DIVISION
RAINY RIVER

Ministry of Natural Resources
 Land Management Branch
 Ontario
 Date: APRIL 22, 1982

Number: **G-565**

BADVERMILLION LAKE G-

Factor Lake G-527

MAHON LAKE G-538

486922

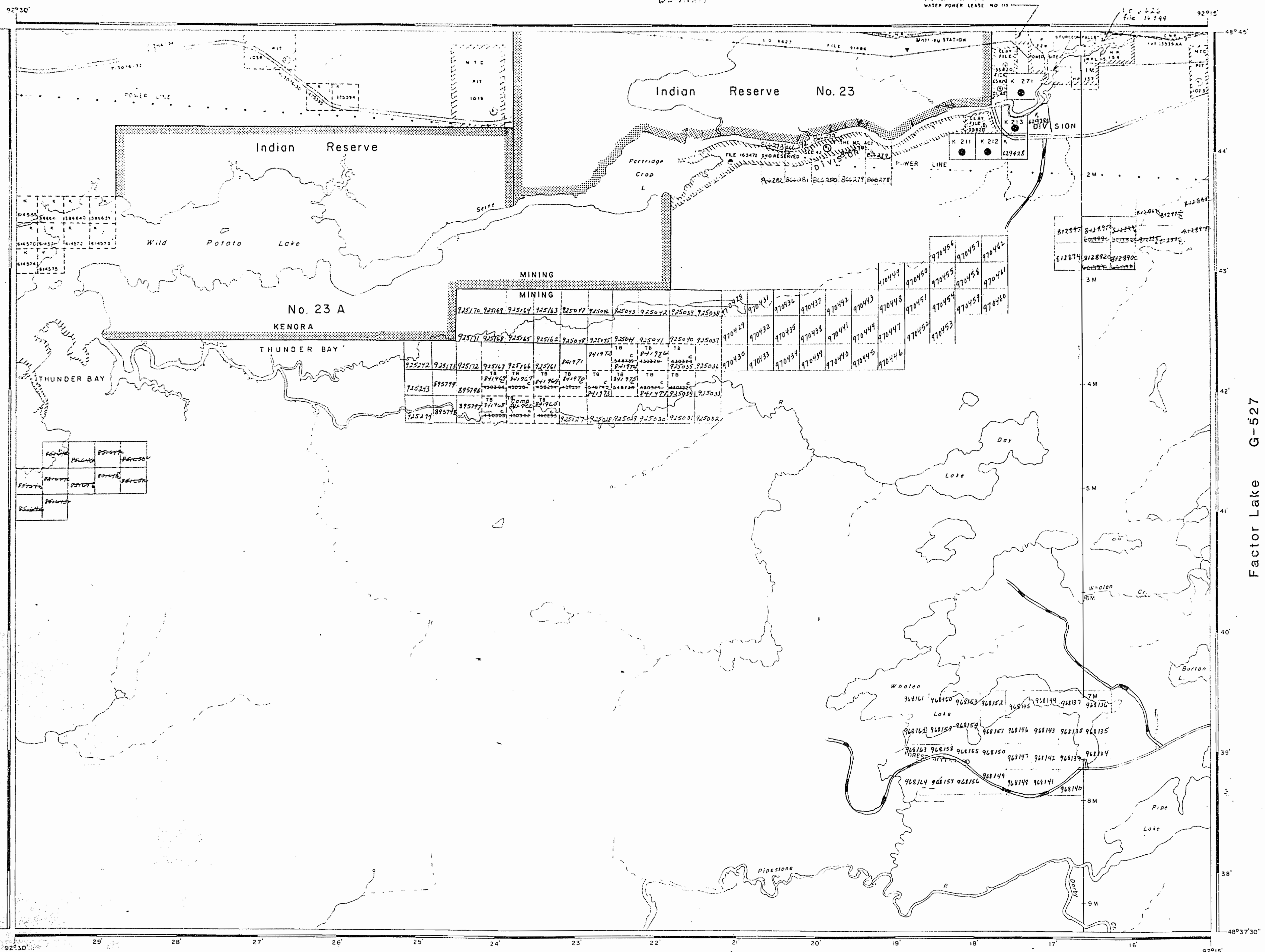

925212	925178	925112	925167	925166	925161	925171	925172	925173	925174	925175	925176	925177	925178	925179	925180	925181	925182	925183	925184	925185	925186	925187	925188	925189	925190	925191	925192	925193	925194	925195	925196	925197	925198	925199	925200	925201	925202	925203	925204	925205	925206	925207	925208	925209	925210	925211	925212
--------	--------	--------	--------	--------	--------	--------	--------	--------	--------	--------	--------	--------	--------	--------	--------	--------	--------	--------	--------	--------	--------	--------	--------	--------	--------	--------	--------	--------	--------	--------	--------	--------	--------	--------	--------	--------	--------	--------	--------	--------	--------	--------	--------	--------	--------	--------	--------

E
BANNET LAKE G-

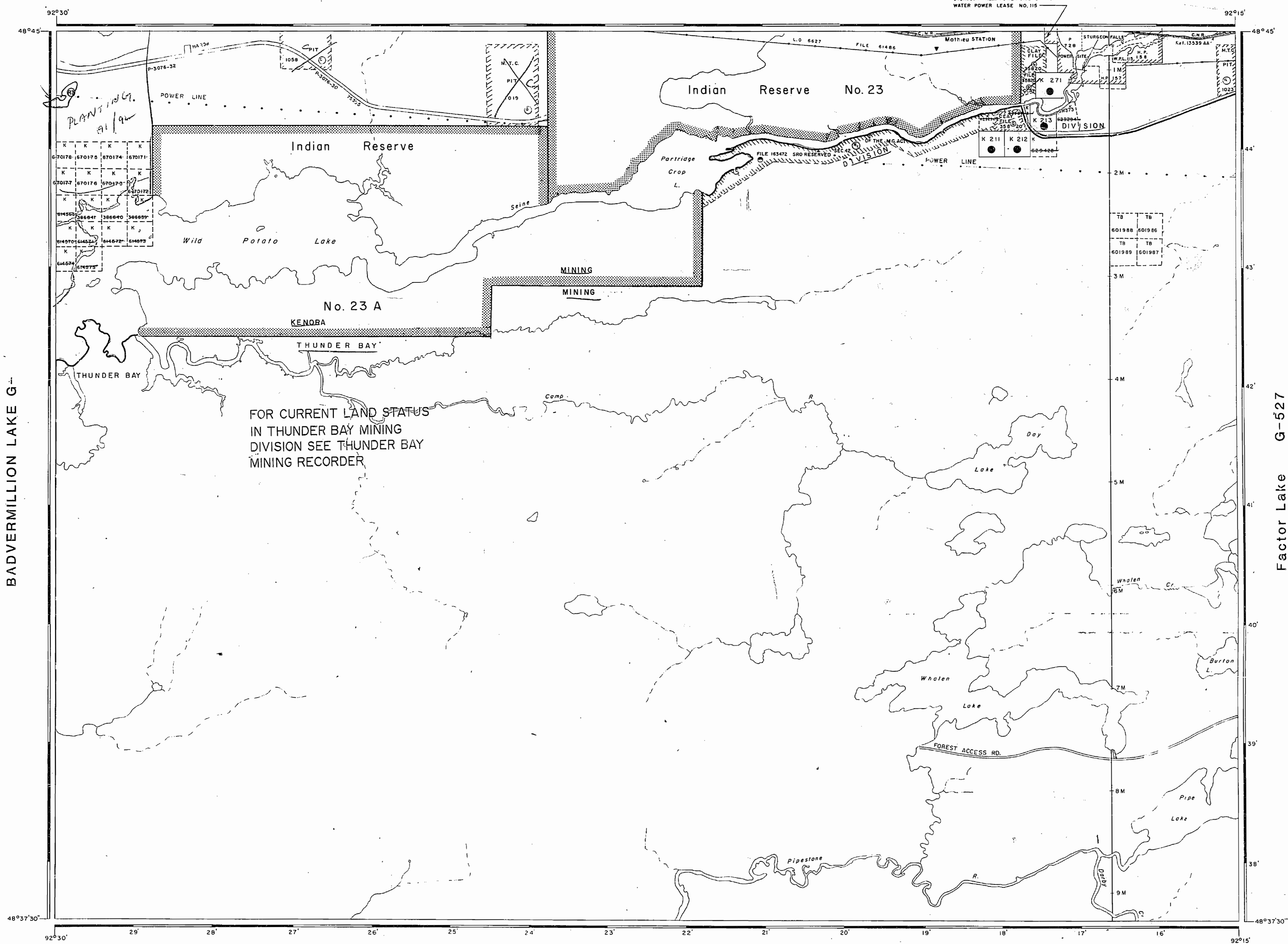

FOR CURRENT LAND STATUS
IN THUNDER BAY MINING
DIVISION SEE THUNDER BAY
MINING RECORDER

REFERENCES

THE INFORMATION THAT APPEARS ON THIS MAP HAS BEEN COMPILED FROM VARIOUS SOURCES, AND ACCURACY IS NOT GUARANTEED. THOSE WISHING TO STAKE MINING CLAIMS SHOULD CONSULT WITH THE MINING RECORDER, MINISTRY OF NORTHERN DEVELOPMENT AND MINES, FOR ADDITIONAL INFORMATION ON THE STATUS OF THE LANDS SHOWN HEREON.

WITHDRAWALS

W-K-24/93 NWR SRO APR 19/93 8:00AM CST

KENORA - MINING DIV. RECEIVED		KENORA MINING DIV. RECEIVED	
OBSOLETE JUL 29 1994		NOV 15 1983	
AM	PM	AM	PM
7 8 9 10 11 12 1 2 3 4 5 6	7 8 9 10 11 12 1 2 3 4 5 6	7 8 9 10 11 12 1 2 3 4 5 6	7 8 9 10 11 12 1 2 3 4 5 6

LEGEND

- HIGHWAY AND ROUTE No.
- OTHER ROADS
- TRAILS
- SURVEYED LINES:
 - TOWNSHIPS, BASE LINES, ETC.
 - LOTS, MINING CLAIMS, PARCELS, ETC.
- UNSURVEYED LINES:
 - LOT LINES
 - PARCEL BOUNDARY
 - MINING CLAIMS ETC.
- RAILWAY AND RIGHT OF WAY
- UTILITY LINES
- NON PERENNIAL STREAM
- FLOODING OR FLOODING RIGHTS
- SUBDIVISION OR COMPOSITE PLAN
- RESERVATIONS
- ORIGINAL SHORELINE
- MARSH OR MUSKEG
- MINES
- TRAVERSE MONUMENT

DISPOSITION OF CROWN LANDS

TYPE OF DOCUMENT	SYMBOL
PATENT, SURFACE & MINING RIGHTS	
" SURFACE RIGHTS ONLY	
" MINING RIGHTS ONLY	
LEASE, SURFACE & MINING RIGHTS	
" SURFACE RIGHTS ONLY	
" MINING RIGHTS ONLY	
LICENCE OF OCCUPATION	
ORDER-IN-COUNCIL	
RESERVATION	
CANCELLED	
SAND & GRAVEL	

NOTE: MINING RIGHTS IN PARCELS PATENTED PRIOR TO MAY 6, 1913, VESTED IN ORIGINAL PATENTEE BY THE PUBLIC LANDS ACT, R.S.O. 1910, CHAP. 380, SEC. 63, SUBSEC. 1.

SCALE: 1 INCH = 40 CHAINS

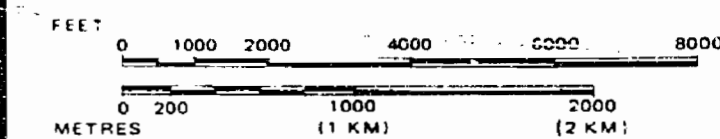

AREA
WILD POTATO LAKE
M.N.R. ADMINISTRATIVE DISTRICT
ATIKOKAN & FORT FRANCES
MINING DIVISION
THUNDER BAY & KENORA
LAND TITLES / REGISTRY DIVISION
RAINY RIVER



Date Doc. 1981 Number
M. 2397 **G-565**

BADVERMILLION LAKE G-

Factor Lake G-527

MAHON LAKE G-538

486922

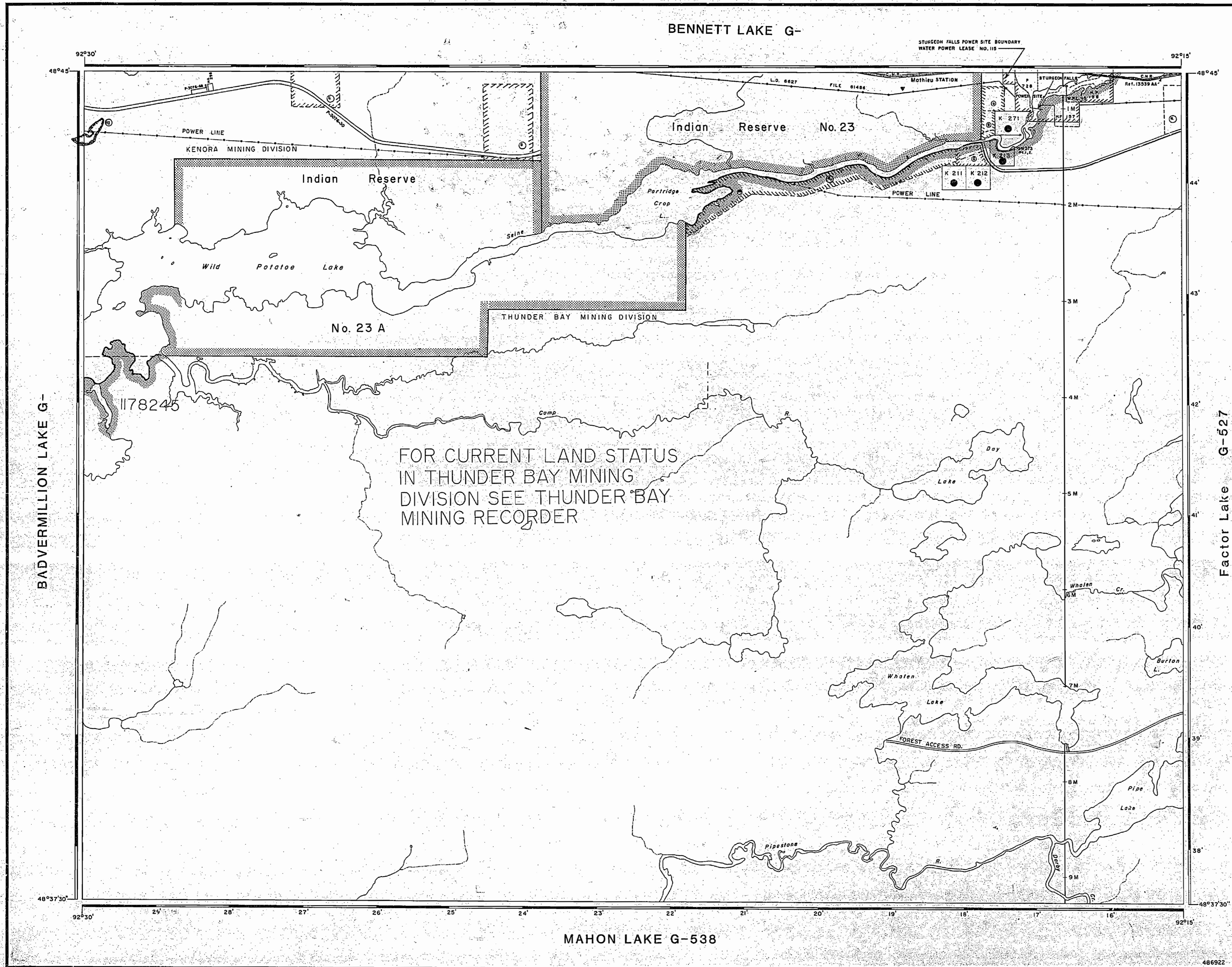

BENNETT LAKE G-

TRIM LINE

STURGEON FALLS POWER SITE BOUNDARY
WATER POWER LEASE NO. 119

92°15'

48°45'

48°

47°

46°

45°

44°

43°

42°

41°

40°

39°

38°

37°

48°37'30"

92°30'

29'

28'

27'

26'

25'

24'

23'

22'

21'

20'

19'

18'

17'

16'

92°15'

MAHON LAKE G-538

Factor Lake G-527

BADVERMILLION LAKE G-

INDIAN RESERVE No. 23

Indian Reserve

Wild Potato Lake

No. 23 A

THUNDER BAY MINING DIVISION

KENORA MINING DIVISION

POWER LINE

POWER LINE

Mothieu STATION

STURGEON FALLS

K 271

K 211

K 212

L.D. 6627

FILE 61486

Ref. 13339 A.A.

1178245

Partridge

Seine

Camp

Whalen

Pipe

Burton

Day

FOREST ACCESS RD.

1178245

FOR CURRENT LAND STATUS
IN THUNDER BAY MINING
DIVISION SEE THUNDER BAY
MINING RECORDER

TRIM LINE

486922

REFERENCES

WITHDRAWALS

W-K-24/93 MWR S.R.O. APR. 19/93 @ 600AM CST

LEGEND

HIGHWAY AND ROUTE No.

OTHER ROADS

TRAILS

SURVEYED LINES:
TOWNSHIPS, BASE LINES, ETC.

LOTS, MINING CLAIMS, PARCELS, ETC.

UNSURVEYED LINES:
LOT LINES

PARCEL BOUNDARY

MINING CLAIMS ETC.

RAILWAY AND RIGHT OF WAY

UTILITY LINES

NON-PERENNIAL STREAM

FLOODING OR FLOODING RIGHTS

SUBDIVISION OR COMPOSITE PLAN

RESERVATIONS

ORIGINAL SHORELINE

MARSH OR MUSKEG

MINES

TRAVERSE MONUMENT

DISPOSITION OF CROWN LANDS

TYPE OF DOCUMENT	SYMBOL
PATENT, SURFACE & MINING RIGHTS	
SURFACE RIGHTS ONLY	
MINING RIGHTS ONLY	
LEASE, SURFACE & MINING RIGHTS	
SURFACE RIGHTS ONLY	
MINING RIGHTS ONLY	
LICENCE OF OCCUPATION	
ORDER-IN-COUNCIL	
RESERVATION	
CANCELLED	
SAND & GRAVEL	

NOTE: MINING RIGHTS IN PARCELS PATENTED PRIOR TO MAY 6, 1912, VESTED IN ORIGINAL PATENTEES BY THE PUBLIC LANDS ACT, R.S.O. 1970, CHAP. 380, SEC. 63, SUBSEC. 1.

SCALE: 1 INCH = 40 CHAINS

FEET 0 1000 2000 4000 6000 8000

METRES 0 200 1000 2000 (1 KM) (2 KM)

AREA

WILD POTATO LAKE

M.N.R. ADMINISTRATIVE DISTRICT

ATIKOKAN & FORT FRANCES

MINING DIVISION

THUNDER BAY & KENORA

LAND TITLES / REGISTRY DIVISION

RAINY RIVER

Ministry of Natural Resources Land Management Branch

Date: Dec. 1981 Number: **G-565**

KENORA - MINING DIV. RECEIVED EFFECTIVE JUL 29 1994 AM 7:35:18 12 1 234 56 THE INFORMATION THAT APPEARS ON THIS MAP HAS BEEN COMPILED FROM VARIOUS SOURCES AND ACCURACY IS NOT GUARANTEED. THOSE WISHING TO STAKE MINING CLAIMS SHOULD CONSULT WITH THE MINING RECORDER, MINISTRY OF NORTHERN DEVELOPMENT AND MINES FOR ADDITIONAL INFORMATION ON THE STATUS OF THE LANDS SHOWN HEREON.

M 2396

M 2395

M 2398

M 2397

S 07801

80° 30' 00"
50° 45' 00"

80° 00' 00"
50° 45' 00"

S 07801

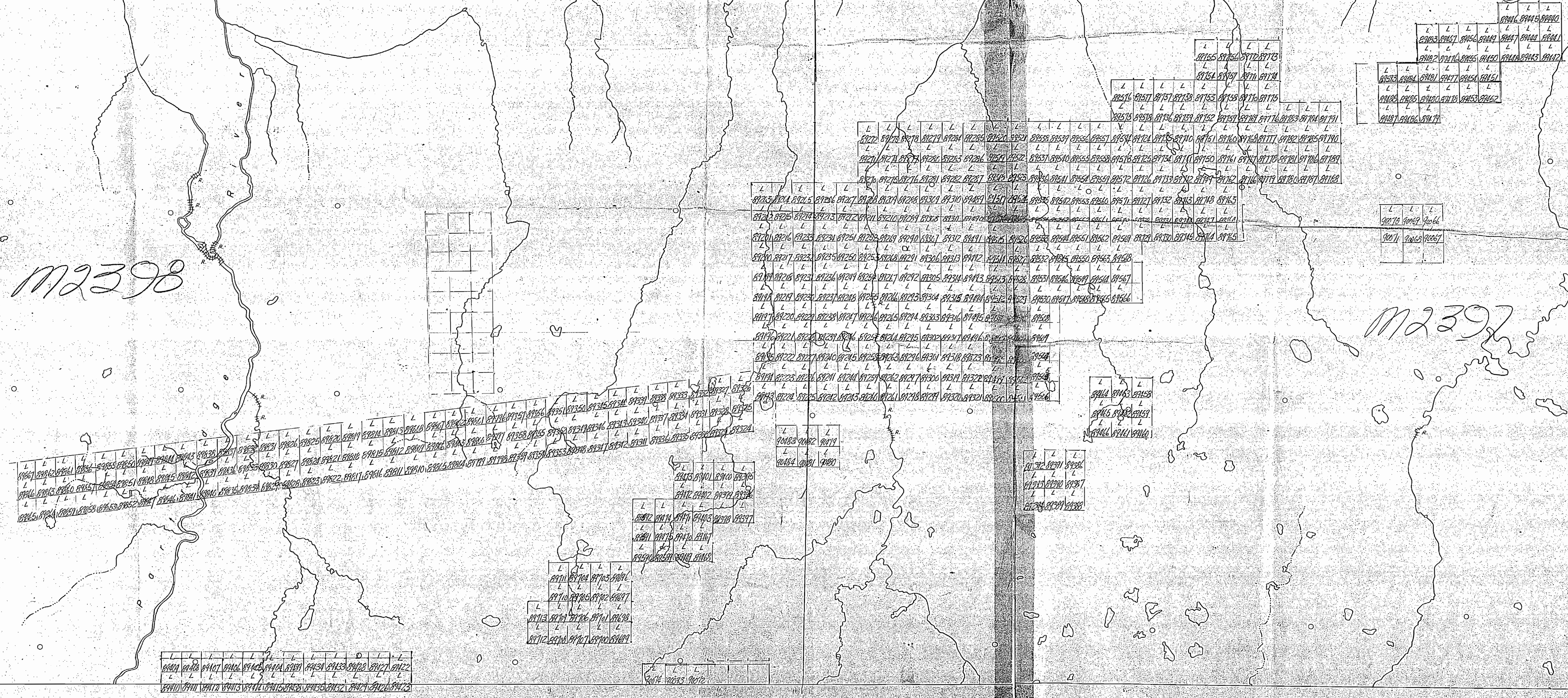

M2396

M2395

M2398

M2397

507801

80° 30' 00"

50° 45' 00"

80° 00' 00"

50° 45' 00"

507801

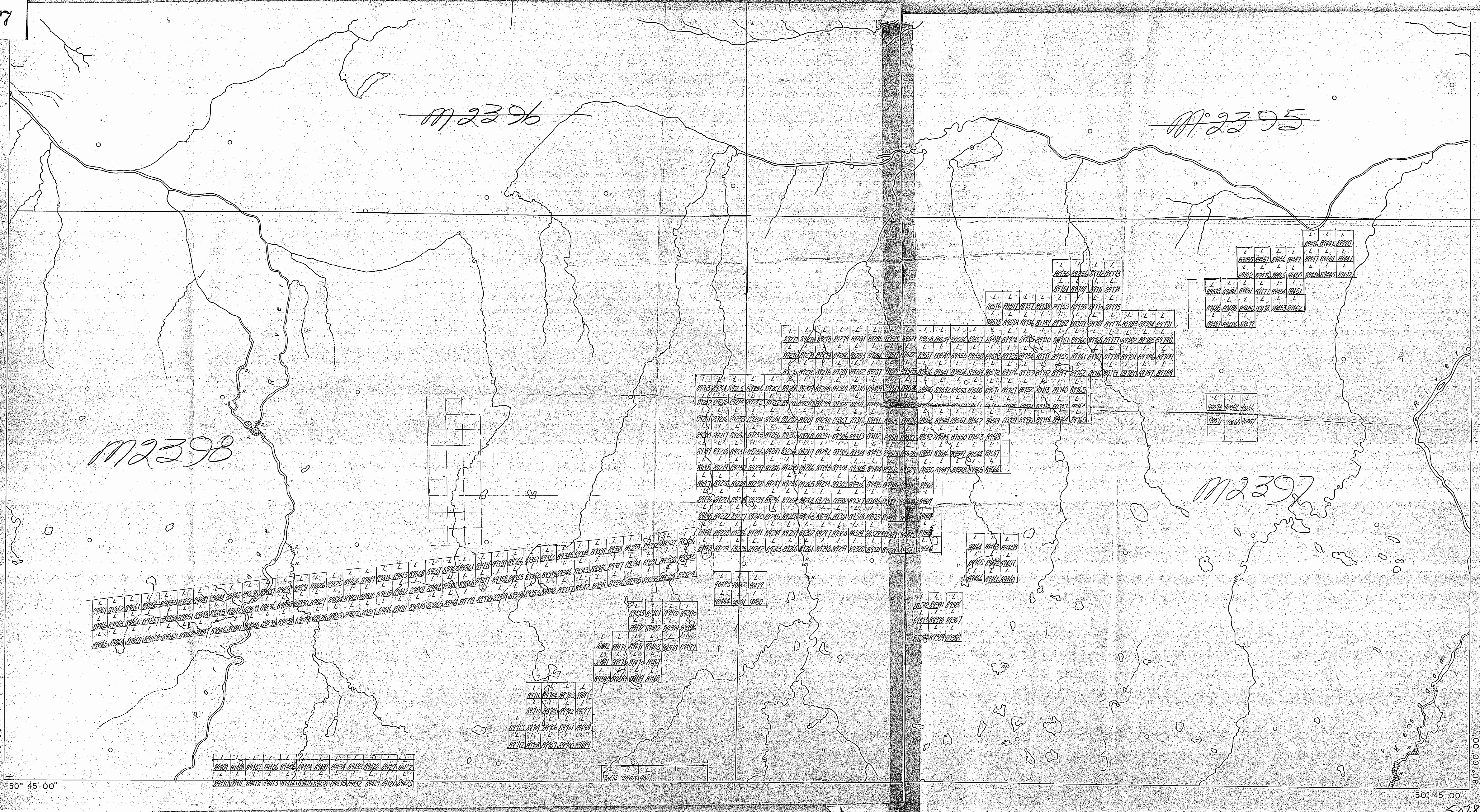

2397

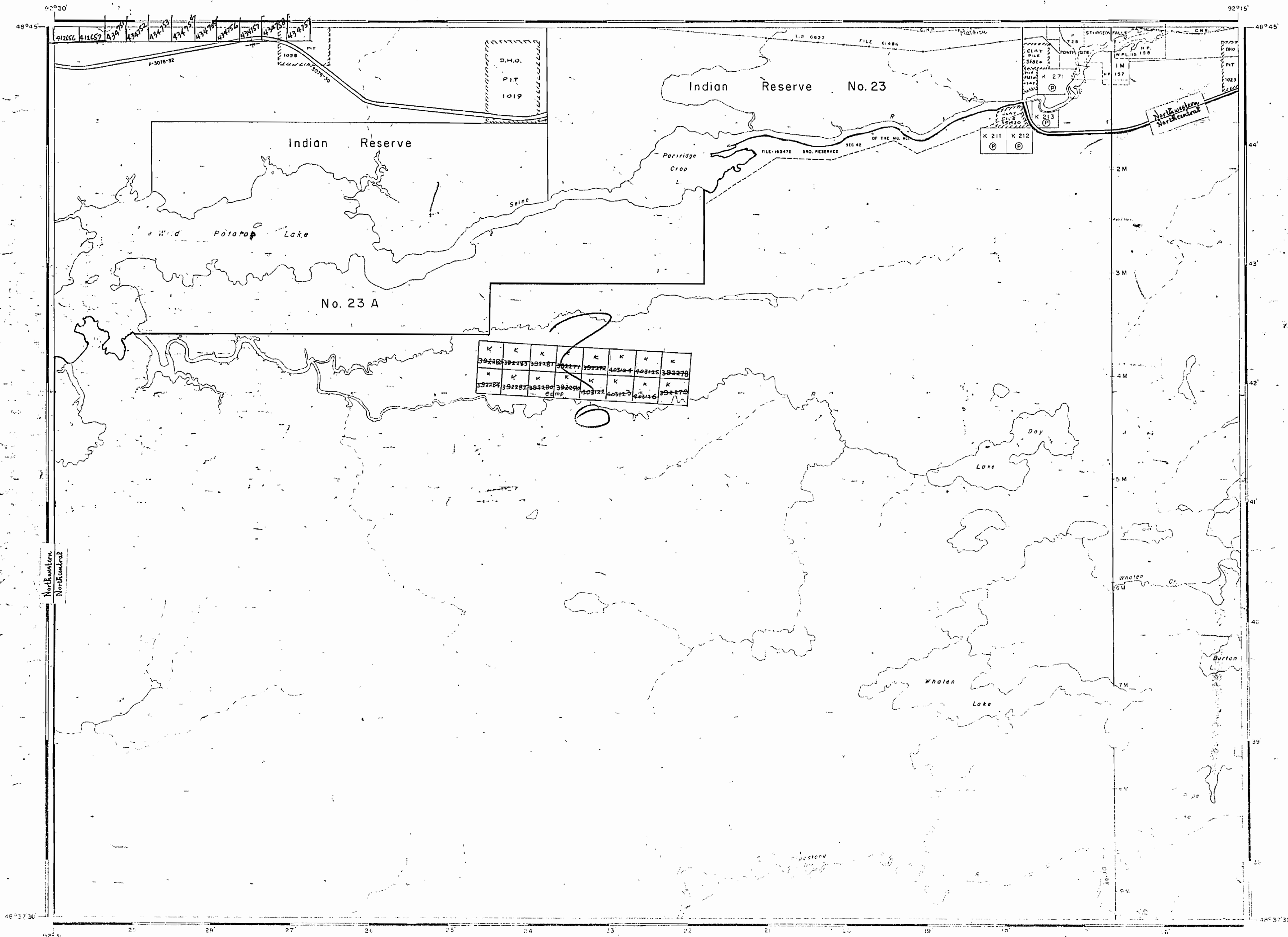

AREA OF
WILD POTATO LAKE
 DISTRICT OF RAINY RIVER
 KENORA MINING DIVISION
 SCALE: 1-INCH = 40 CHAINS

LEGEND

PATENTED LAND	Ⓢ
CROWN LAND SALE	C.S.
LEASES	Ⓛ
LOCATED LAND	Loc.
LICENSE OF OCCUPATION	L.O.
MINING RIGHTS ONLY	M.R.O.
SURFACE RIGHTS ONLY	S.R.O.
ROADS	—
IMPROVED ROADS	—
KING'S HIGHWAYS	—
RAILWAYS	—
POWER LINES	—
MARSH OR MUSKEG	—
MINES	✱

NOTES

— KENORA
 FILED:
 REC'D. FEB 17 1972
 RECEIPT No.
 MINING DIVISION
 AUG. 20/74

NATIONAL TOPOGRAPHIC SERIES 52 C9
 PLAN NO. **M-2397**
 ONTARIO
 DEPARTMENT OF MINES
 AND NORTHERN AFFAIRS

Wild Potato

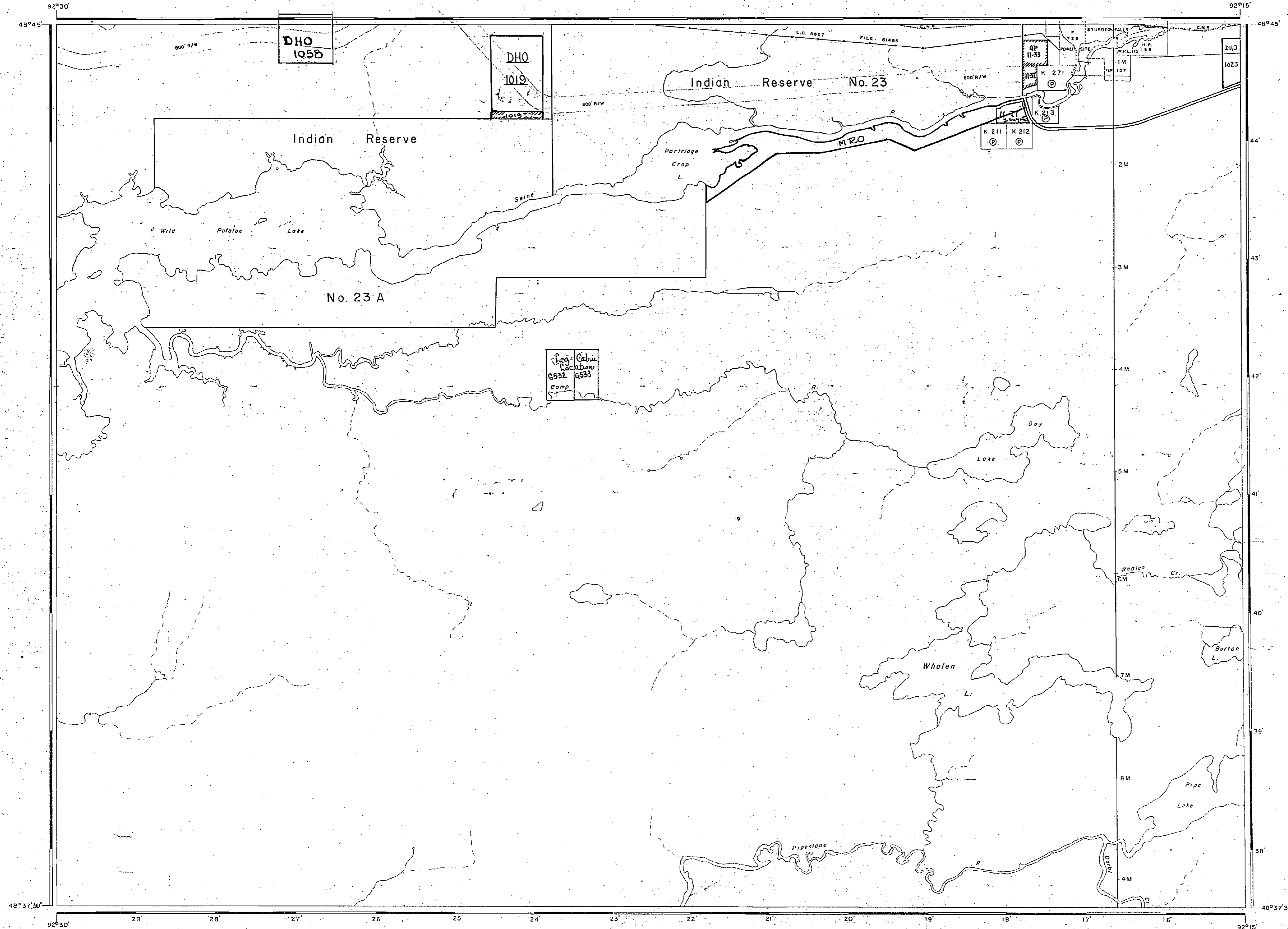

AREA OF
WILD POTATO
WHALEN LAKE

DISTRICT OF
RAINY RIVER

FORT FRANCES
MINING DIVISION

SCALE: 1-INCH = $\frac{1}{40}$ mile
= 40 CHAINS

LEGEND

PATENTED LAND	Ⓟ
CROWN LAND SALE	C.S.
LEASES	Ⓛ
LOCATED LAND	Loc.
LICENSE OF OCCUPATION	L.O.
MINING RIGHTS ONLY	M.R.O.
SURFACE RIGHTS ONLY	S.R.O.
ROADS	—
IMPROVED ROADS	—
KING'S HIGHWAYS	—
RAILWAYS	—
POWER LINES	—
MARSH OR MUSKEG	—
MINES	Ⓧ

NOTES

PLAN NO. M-2397

DEPARTMENT OF MINES

— ONTARIO —

2397

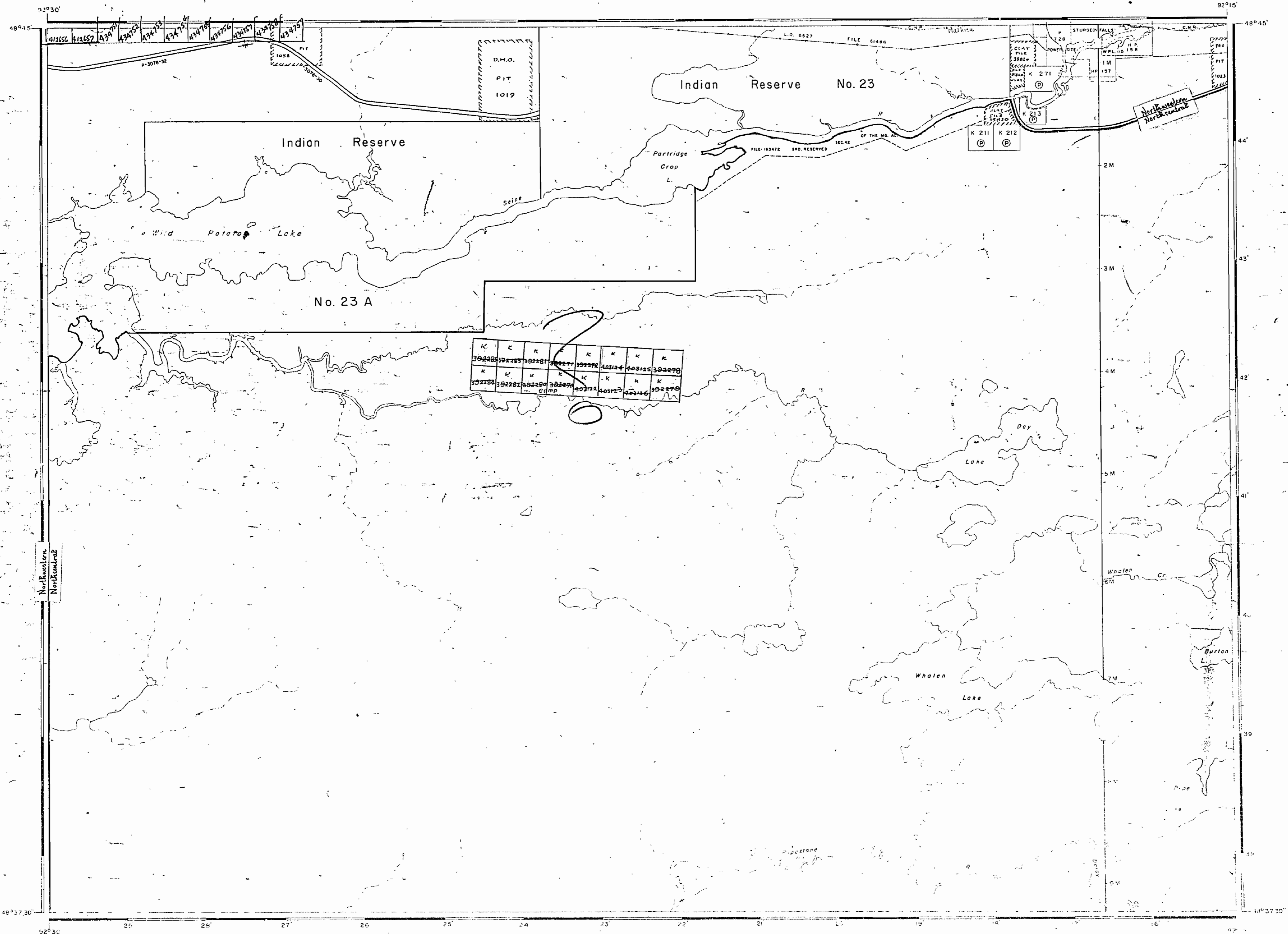

K	K	K	K	K	K	K	K	K	K
39440	39441	39442	39443	39444	39445	39446	39447	39448	39449
K	K	K	K	K	K	K	K	K	K
39450	39451	39452	39453	39454	39455	39456	39457	39458	39459

AREA OF
WILD POTATO LAKE
 DISTRICT OF RAINY RIVER
 KENORA MINING DIVISION
 SCALE: 1-INCH = 40 CHAINS

LEGEND

PATENTED LAND	Ⓟ
CROWN LAND SALE	C.S.
LEASES	Ⓛ
LOCATED LAND	Loc.
LICENSE OF OCCUPATION	L.O.
MINING RIGHTS ONLY	M.R.O.
SURFACE RIGHTS ONLY	S.R.O.
ROADS	
IMPROVED ROADS	
KING'S HIGHWAYS	
RAILWAYS	
POWER LINES	
MARSH OR MUSKES	
MINES	*

NOTES

FILED: **KENORA**
 REC'D. FEB 17 1972
 RECEIPT No. **MINING DIVISION**
 AUG. 20/74

NATIONAL TOPOGRAPHIC SERIES 52 C9
 PLAN NO. **M-2397**
 ONTARIO
 DEPARTMENT OF MINES
 AND NORTHERN AFFAIRS

Wild Potato

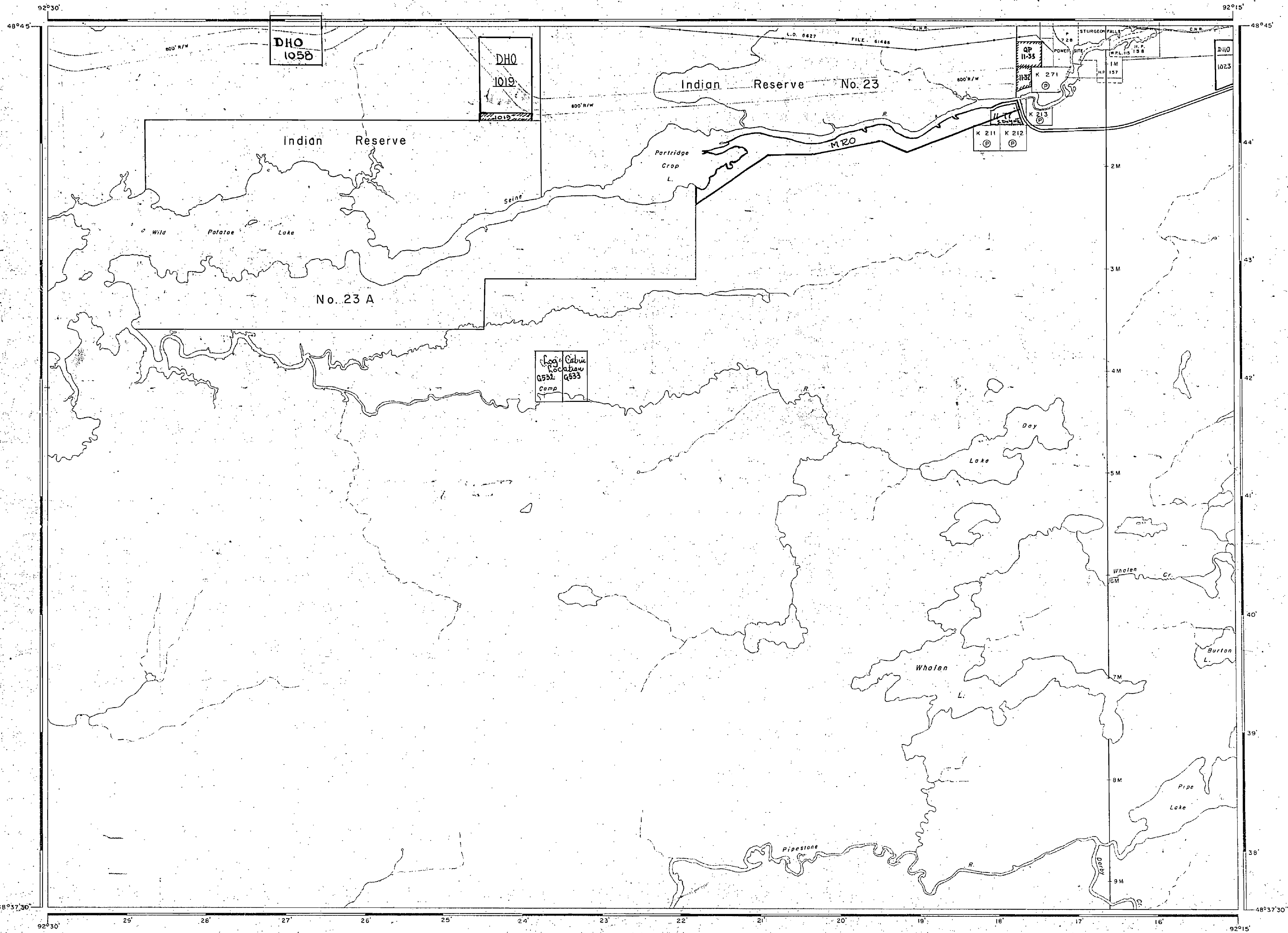

AREA OF
WILD POTATO
WHALEN LAKE

DISTRICT OF
RAINY RIVER

FORT FRANCES
MINING DIVISION

SCALE: 1-INCH = 40 CHAINS

LEGEND

PATENTED LAND	Ⓟ
CROWN LAND SALE	Ⓢ
LEASES	Ⓞ
LOCATED LAND	Ⓛ
LICENSE OF OCCUPATION	Ⓛ.O.
MINING RIGHTS ONLY	M.R.O.
SURFACE RIGHTS ONLY	S.R.O.
ROADS	—
IMPROVED ROADS	—
KING'S HIGHWAYS	—
RAILWAYS	—
POWER LINES	—
MARSH OR MUSKEG	—
MINES	—

NOTES

PLAN NO. M-2397

DEPARTMENT OF MINES
— ONTARIO —

AREA OF
**WILD POTATO
 WHALEN LAKE**
 DISTRICT OF
 RAINY RIVER

FORT FRANCES
 MINING DIVISION

SCALE: 1-INCH = 40 CHAINS

LEGEND

- PATENTED LAND
- CROWN LAND SALE
- LEASES
- LOCATED LAND
- LICENSE OF OCCUPATION
- MINING RIGHTS ONLY
- SURFACE RIGHTS ONLY
- ROADS
- IMPROVED ROADS
- KING'S HIGHWAYS
- RAILWAYS
- POWER LINES
- MARSH OR MUSKEG
- MINES

NOTES

PLAN NO **M-2397**

DEPARTMENT OF MINES
 - ONTARIO -

