

Mining claims staked adjacent to, Maynard, Tide, Bell, Indian, Grass Narrows, Loun, Big Fox, Separation, De-May, Scully, Delaney, Bert, Mavis, Wonderland, Star, Treated Lakes & connecting Rivers, etc. Recorded Subject to Flooding Rights.

Land withdrawn from staking & Reserved for Power Site, L.D.F. file 69307, marked thus:

WONDS INDICATED ON THIS MAP WERE MADE BY THE CANADIAN PACIFIC RAILWAY CO. AND PAPER CO. ARE PRIVATE ROADS BUT MAY BE USED BY PROSPECTORS ONLY AFTER PERMISSION IS OBTAINED FROM THE ABOVE MENTIONED CO. IN WRITING.

RECEIVED
MAY 3 1962
KEMORA MINING DIV.

400' RESERVED BY DEPT. OF L. & F. SHOWN THUS: [Symbol]

M-1977

Scale: 40 Chains = 1 Inch

1977
Wonderland

SCENIC LAKE M.3107

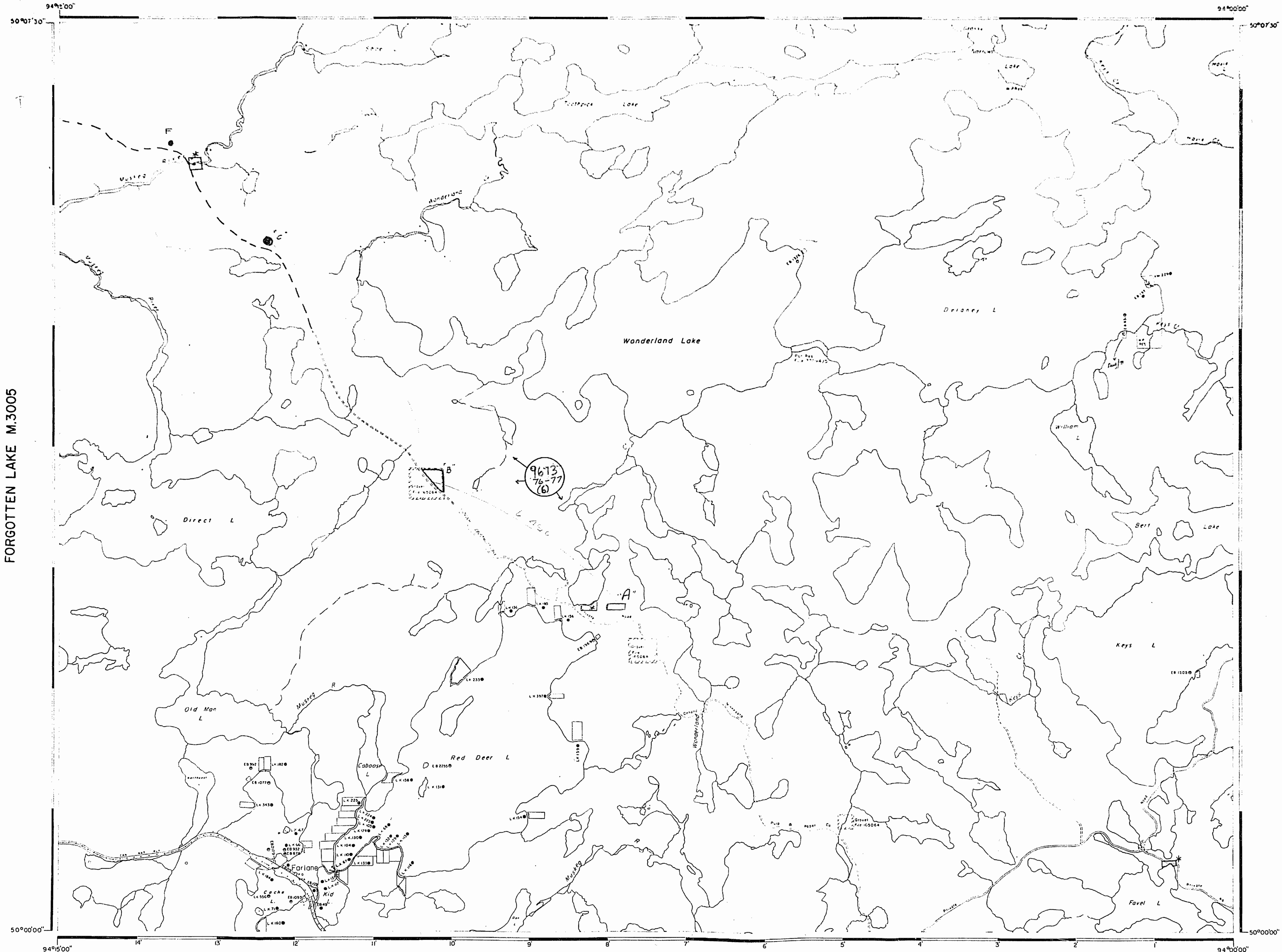

FORGOTTEN LAKE M.3005

KILGOUR LAKE M.1964

MARK LAKE M.2065

AREA OF

WONDERLAND LAKE

DISTRICT OF KENORA

KENORA MINING DIVISION

SCALE: 1-INCH = 40 CHAINS

LEGEND

- PATENTED LAND Ⓟ or Ⓢ
 - PATENTED FOR SURFACE RIGHTS ONLY Ⓢ
 - LEASES Ⓛ
 - LICENSE OF OCCUPATION L.O.
 - CROWN LAND SALE C.S.
 - LOCATED LAND Loc
 - CANCELLED C
 - MINING RIGHTS ONLY M.R.O.
 - SURFACE RIGHTS ONLY S.R.O.
 - HIGHWAY & ROUTE No 17
 - ROADS —
 - TRAILS —
 - RAILWAYS —
 - POWER LINES —
 - MARSH OR MUSKEG —
 - MINES *
- used only with summer resort locations or when space is limited

NOTES

400' Surface Rights Reservation Around the Shores of All Lakes and Rivers.

H.E.P.C. flooding on English River (Grassy Narrows Lake and Snake Lake) from Maynard Falls to Separation Rapids, to contour elevation 5' above high water mark, 30 Nov. 1959. File 34175, vol 3.

FILED. KENORA
 REC'D. MAR - 1971
 RECEIPT No.
 MINING DIVISION

* SURFACE RIGHTS ONLY WITHDRAWN FROM PROSPECTING, STAKING OUT, SALE OR LEASE - ORDER NO. W.65/76

#2

NATIONAL TOPOGRAPHIC SERIES 52L1

PLAN NO. **M.1977**

ONTARIO DEPARTMENT OF MINES AND NORTHERN AFFAIRS

SCENIC LAKE M.3107

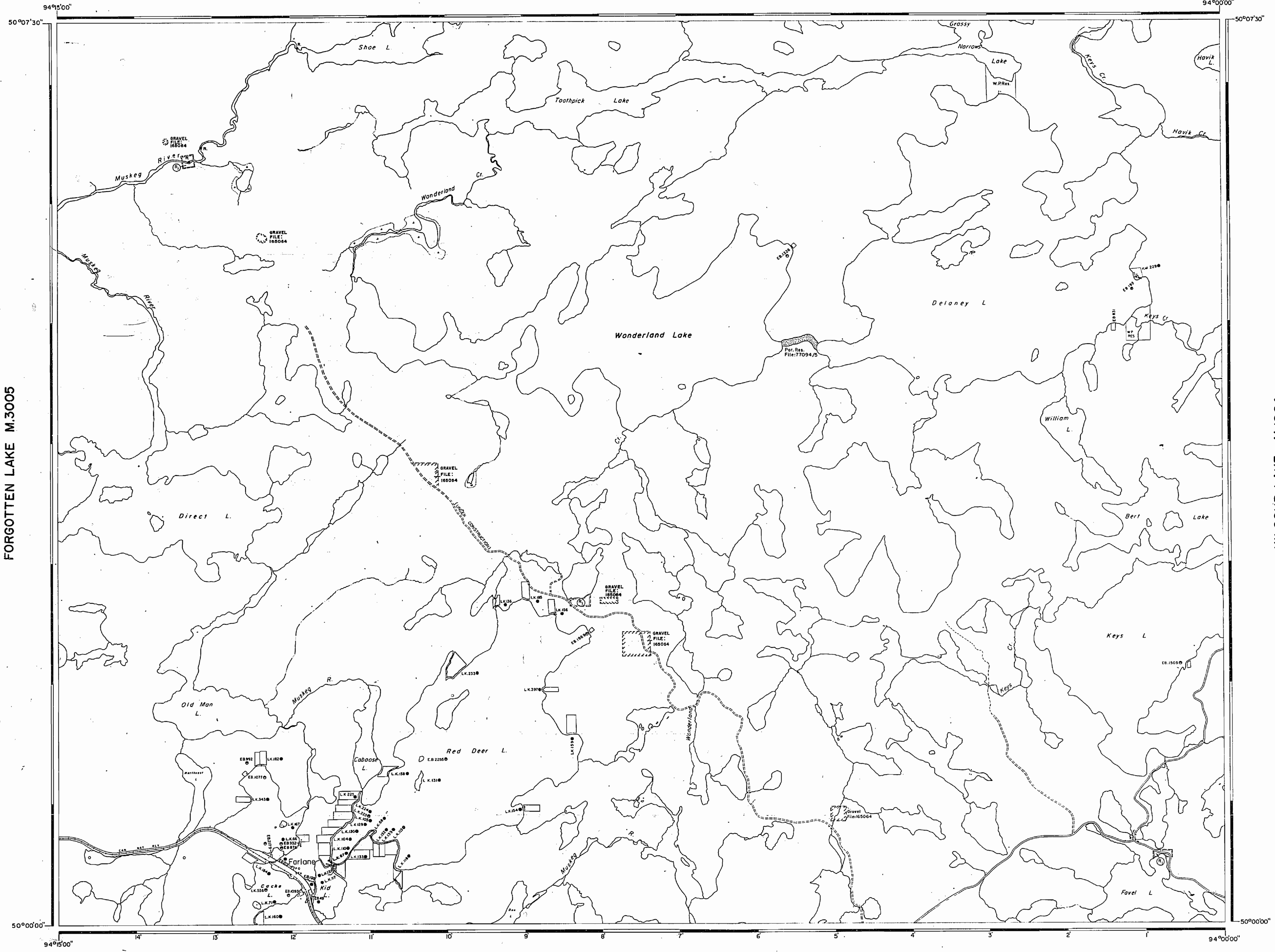

FORGOTTEN LAKE M.3005

KILGOUR LAKE M.1964

AREA OF
WONDERLAND LAKE
 DISTRICT OF KENORA
 KENORA MINING DIVISION
 SCALE: 1-INCH = 40 CHAINS

LEGEND

PATENTED LAND	Ⓟ or ●
PATENTED FOR SURFACE RIGHTS ONLY	Ⓟ
LEASES	○
LICENSE OF OCCUPATION	○
CROWN LAND SALE	○
LOCATED LAND	○
CANCELLED	○
MINING RIGHTS ONLY	M.R.O.
SURFACE RIGHTS ONLY	S.R.O.
HIGHWAY & ROUTE No.	17
ROADS	—
TRAILS	- - -
RAILWAYS	—+—
POWER LINES	—o—
MARSH OR MUSKEG	~
MINES	X

*used only with summer resort locations or when space is limited

NOTES

400' Surface Rights Reservation Around the Shores of All Lakes and Rivers

H.E.P.C. flooding on English River (Grassy Narrows Lake and Shoe Lake) from Maynard Falls to Separation Rapids, to contour elevation 5' above high water mark. 30. Nov. 1959. File: 34179, vol.3.

Areas withdrawn from staking under Section 43 of the Mining Act (R.S.O. 1970).

Order No.	File	Date	Disposition
1	w.65/76	19821	19/11/76 S.R.O.

Charlotte Jones

KENORA MINING DIV.
RECEIVED
 MAR-2-1984
 7:8:9:10:11:12:1:2:3:4:5:6

NATIONAL TOPOGRAPHIC SERIES 52LI
PLAN NO. M.1977
 ONTARIO
 MINISTRY OF NATURAL RESOURCES
 SURVEYS AND MAPPING BRANCH

MARK LAKE M.2065

SCENIC LAKE G-2521

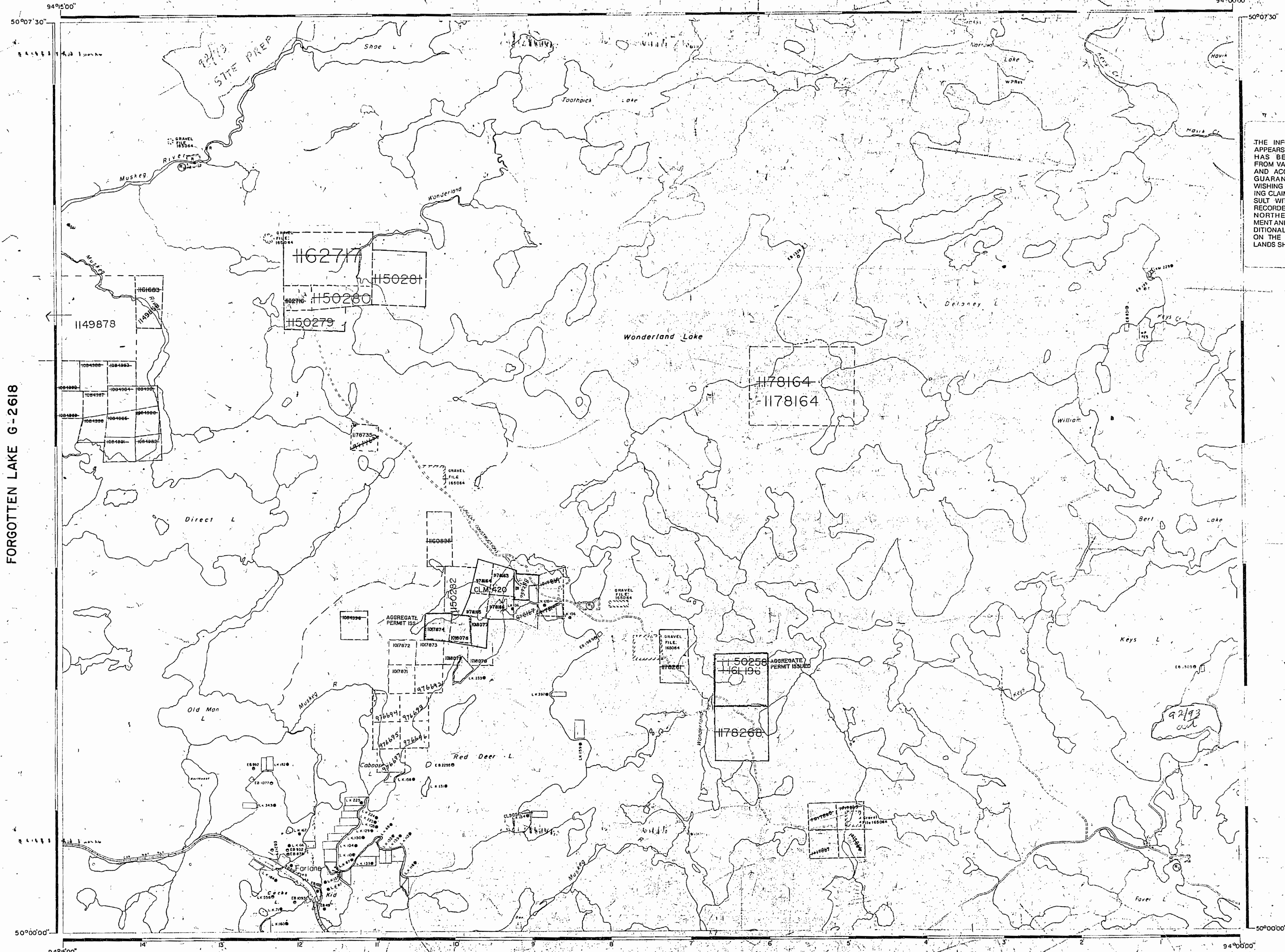

FORGOTTEN LAKE G-2618

KILGOUR LAKE G-2626

MARK LAKE G-2629

LEGEND

- HIGHWAY AND ROUTE No
- OTHER ROADS
- TRAILS
- SURVEYED LINES
- TOWNSHIPS, BASE LINES, ETC.
- LOTS, MINING CLAIMS, PARCELS ETC.
- UNSURVEYED LINES
- LOT LINES
- PARCEL BOUNDARY
- MINING CLAIMS ETC.
- RAILWAY AND RIGHT OF WAY
- UTILITY LINES
- NON-PERENNIAL STREAM
- FLOODING OR FLOODING RIGHTS
- SUBDIVISION OR COMPOSITE PLAN
- RESERVATIONS
- ORIGINAL SHORELINE
- MARSH OR MUSKOG
- MINES
- TRAVERSE MONUMENT
- TOURIST CAMPS

THE INFORMATION THAT APPEARS ON THIS MAP HAS BEEN COMPILED FROM VARIOUS SOURCES, AND ACCURACY IS NOT GUARANTEED. THOSE WISHING TO STAKE MINING CLAIMS SHOULD CONSULT WITH THE MINING RECORDER, MINISTRY OF NORTHERN DEVELOPMENT AND MINES, FOR ADDITIONAL INFORMATION ON THE STATUS OF THE LANDS SHOWN HEREON.

DISPOSITION OF CROWN LANDS

TYPE OF DOCUMENT	SYMBOL
PATENT, SURFACE & MINING RIGHTS	
SURFACE RIGHTS ONLY	
MINING RIGHTS ONLY	
LEASE, SURFACE & MINING RIGHTS	
SURFACE RIGHTS ONLY	
MINING RIGHTS ONLY	
LICENCE OF OCCUPATION	
ORDER-IN-COUNCIL	
RESERVATION	
CANCELLED	
SAND & GRAVEL	

NOTE: MINING RIGHTS IN PARCELS PATENTED PRIOR TO MAY 4, 1913, VESTED IN ORIGINAL PATENTEES BY THE PUBLIC LANDS ACT, R.S.O. 1970, CHAP. 390, SEC. 43.3, 45.2.

REFERENCES

AREAS WITHDRAWN FROM DISPOSITION				
Description	Order No.	Date	Disposition	Fee
M.R.O. - MINING RIGHTS ONLY				
S.R.O. - SURFACE RIGHTS ONLY				
M.L.S. - MINING AND SURFACE RIGHTS				
①	W 62/76	1974/76	S.R.O.	1852

Effective as shown

FLOODING
MEPC flooding on English River, directly west of site and Shoe Lake from Maynard Falls to location in P.O. to contour elevation 5 above high water mark
30 Nov 1959

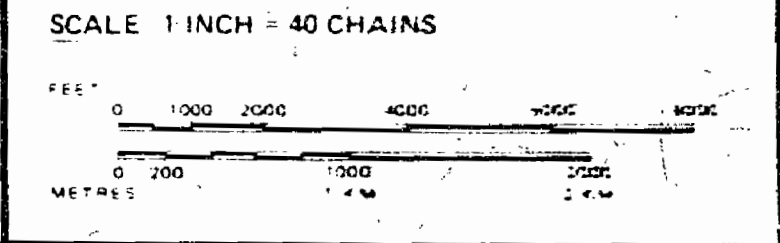

AREA **WONDERLAND LAKE**
M.N.R. ADMINISTRATIVE DISTRICT
KENORA
MINING DIVISION
KENORA
LAND TITLES / REGISTRY DIVISION
KENORA

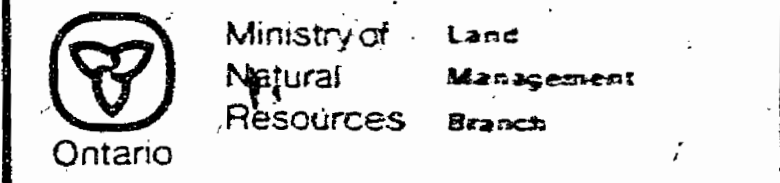

Date FEBRUARY, 1984. Number **G-2658**
M-1977

SCENIC LAKE G-2521

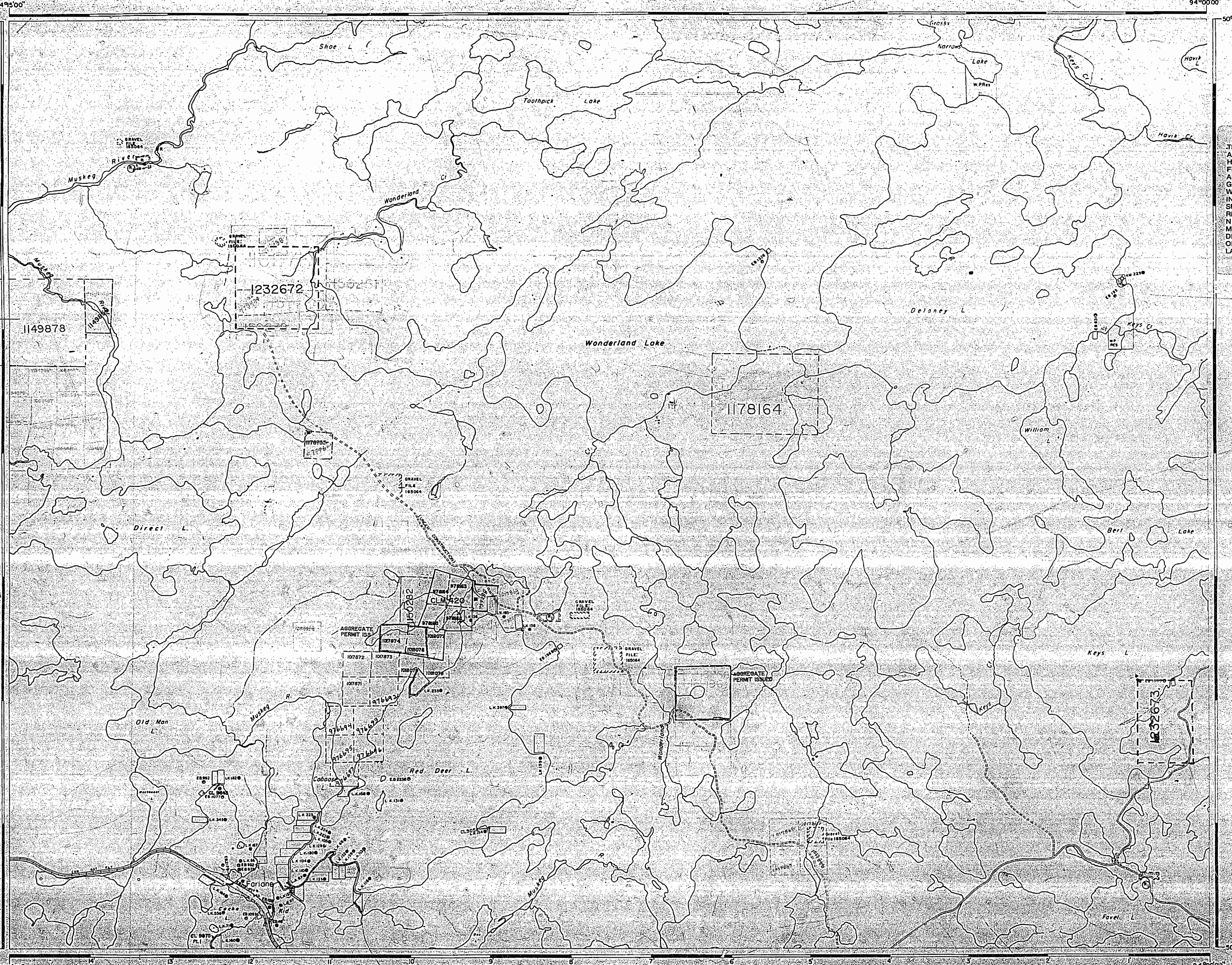

FORGOTTEN LAKE G-2618

KILGOUR LAKE G-2626

MARK LAKE G-2629

LEGEND

- HIGHWAY AND ROUTE No.
- OTHER ROADS
- TRAILS
- SURVEYED LINES
- TOWNSHIPS, BASE LINES, ETC.
- LOTS, MINING CLAIMS, PARCELS, ETC.
- UNSURVEYED LINES
- LOT LINES
- PARCEL BOUNDARY
- MINING CLAIMS ETC.
- RAILWAY AND RIGHT OF WAY
- UTILITY LINES
- NON-PERENNIAL STREAM
- FLOODING OR FLOODING RIGHTS
- SUBDIVISION OR COMPOSITE PLAN
- RESERVATIONS
- ORIGINAL SHORELINE
- MARSH OR MUSKEG
- MINES
- TRAVERSE MONUMENT
- TOURIST CAMPS

THE INFORMATION THAT APPEARS ON THIS MAP HAS BEEN COMPILED FROM VARIOUS SOURCES AND ACCURACY IS NOT GUARANTEED. THOSE WISHING TO STAKE MINING CLAIMS SHOULD CONSULT WITH THE MINING RECORDER, MINISTRY OF NORTHERN DEVELOPMENT AND MINES FOR ADDITIONAL INFORMATION ON THE STATUS OF THE LANDS SHOWN HEREON.

DISPOSITION OF CROWN LANDS

TYPE OF DOCUMENT	SYMBOL
PATENT, SURFACE & MINING RIGHTS	
SURFACE RIGHTS ONLY	
MINING RIGHTS ONLY	
LEASE, SURFACE & MINING RIGHTS	
SURFACE RIGHTS ONLY	
MINING RIGHTS ONLY	
LICENCE OF OCCUPATION	
ORDER-IN-COUNCIL	
RESERVATION	
CANCELLED	
SAND & GRAVEL	

NOTE: MINING RIGHTS IN PARCELS PATENTED PRIOR TO MAY 6 1913, REVERTED TO ORIGINAL PATENTEE BY THE PUBLIC LANDS ACT, R.S.O. 1970, CHAP. 300, SEC. 63, SUBSEC. 1.

REFERENCES

AREAS WITHDRAWN FROM DISPOSITION

M.R.O. - MINING RIGHTS ONLY
S.R.O. - SURFACE RIGHTS ONLY
M.S. - MINING AND SURFACE RIGHTS

Description	Order No.	Date	Disposition	F.A.
	82/76	19/11/75	S.R.O.	10020

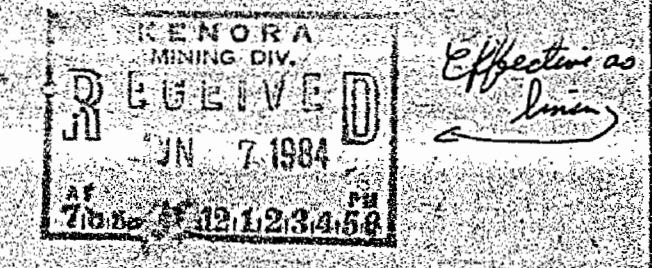

FLOODING
H.E.R.C. flooding on English River (Grassy, Narrows Lake and Shoe Lake) from Maynard Falls to Separation Rapids, to contour elevation 5 above high water mark, 30. Nov. 1959. File 3479, vol. 3.

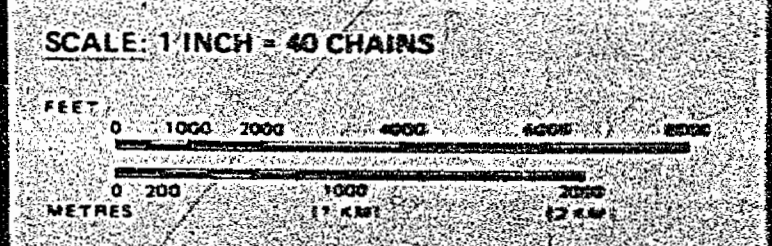

AREA **WONDERLAND LAKE**
M.N.R. ADMINISTRATIVE DISTRICT
KENORA
MINING DIVISION
KENORA
LAND TITLES / REGISTRY DIVISION
KENORA

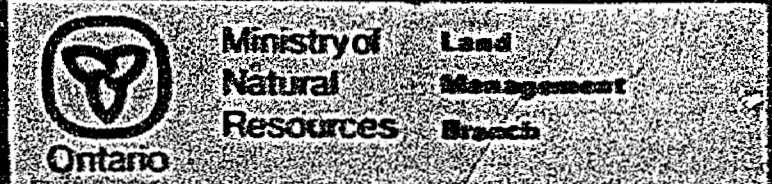

Date: FEBRUARY 1984
M-1977
G-2658

1977

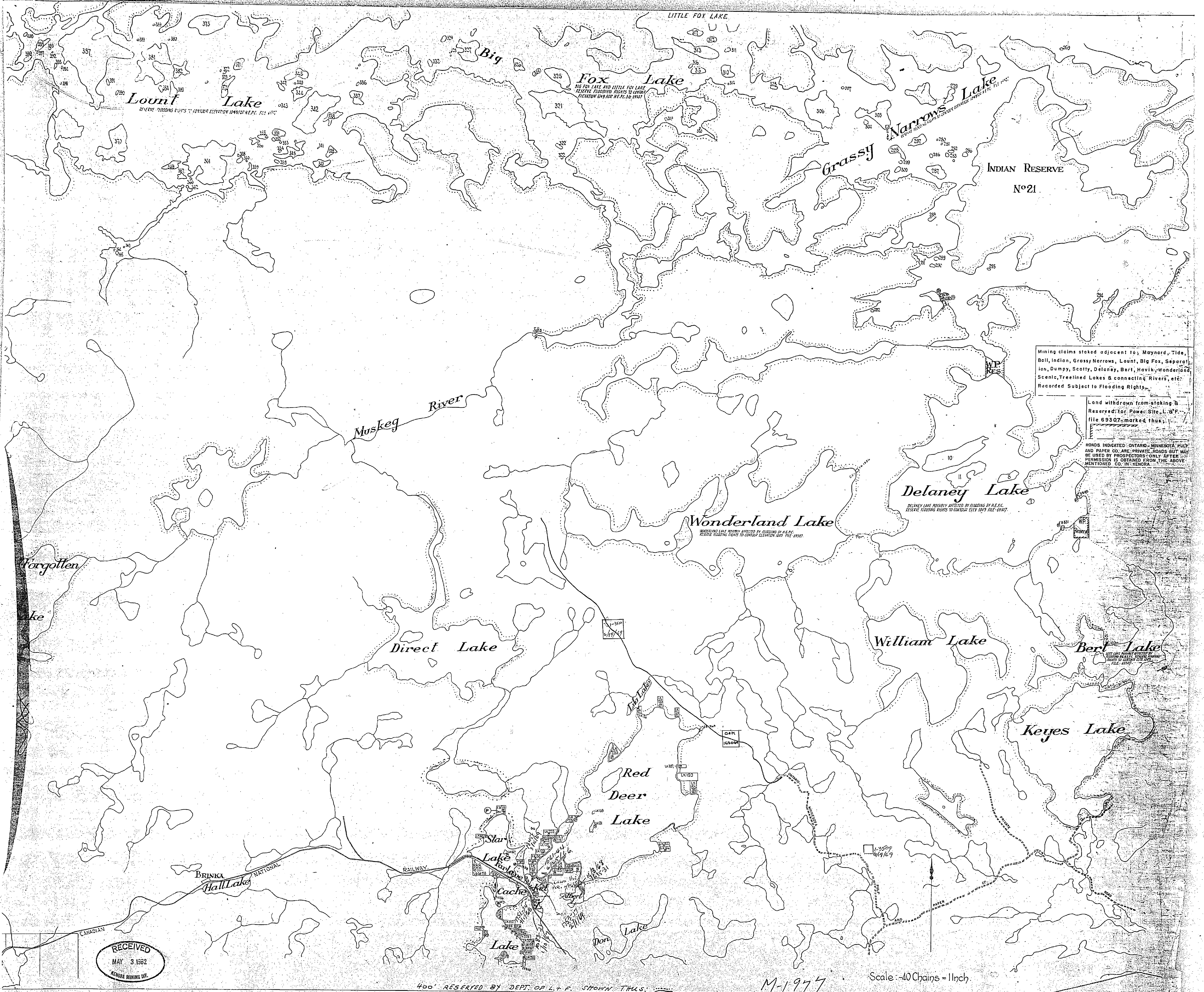

Mining claims staked adjacent to; Maynard, Tide, Ball, Indian, Grassy Narrows, Lount, Big Fox, Separation, Dumpy, Scotty, Delaney, Bert, Havik-Wonderland, Scenic, Treeline Lakes & connecting Rivers, etc. Recorded Subject to Flooding Rights.

Land withdrawn from staking & Reserved for Power Site, L. 69307, file 69307 marked thus.

ROADS INDICATED ONTARIO-MINNESOTA, HUDY AND PAPER CO. ARE PRIVATE, ROADS BUT MAY BE USED BY PROSPECTORS ONLY AFTER PERMISSION IS OBTAINED FROM THE ABOVE MENTIONED CO. IN KENORA.

Delaney Lake
DELANEY LAKE POSSIBLY AFFECTED BY FLOODING BY H.E.S.C. RESERVE FLOODING RIGHTS TO CORRELATE ELEVATION 1957 FILE 69307.

Wonderland Lake
WONDERLAND LAKE POSSIBLY AFFECTED BY FLOODING BY H.E.S.C. RESERVE FLOODING RIGHTS TO CORRELATE ELEVATION 1957 FILE 69307.

Bert Lake
BERT LAKE POSSIBLY AFFECTED BY FLOODING BY H.E.S.C. RESERVE FLOODING RIGHTS TO CORRELATE ELEVATION 1957 FILE 69307.

RECEIVED
 MAY 3 1962
 KENORA MINING DIV.

400' RESERVED BY DEPT. OF L. & F. SHOWN THUS.

M-1977

Scale: 40 Chains = 1 Inch.

1977
 Woodland