

Townsend Twp.

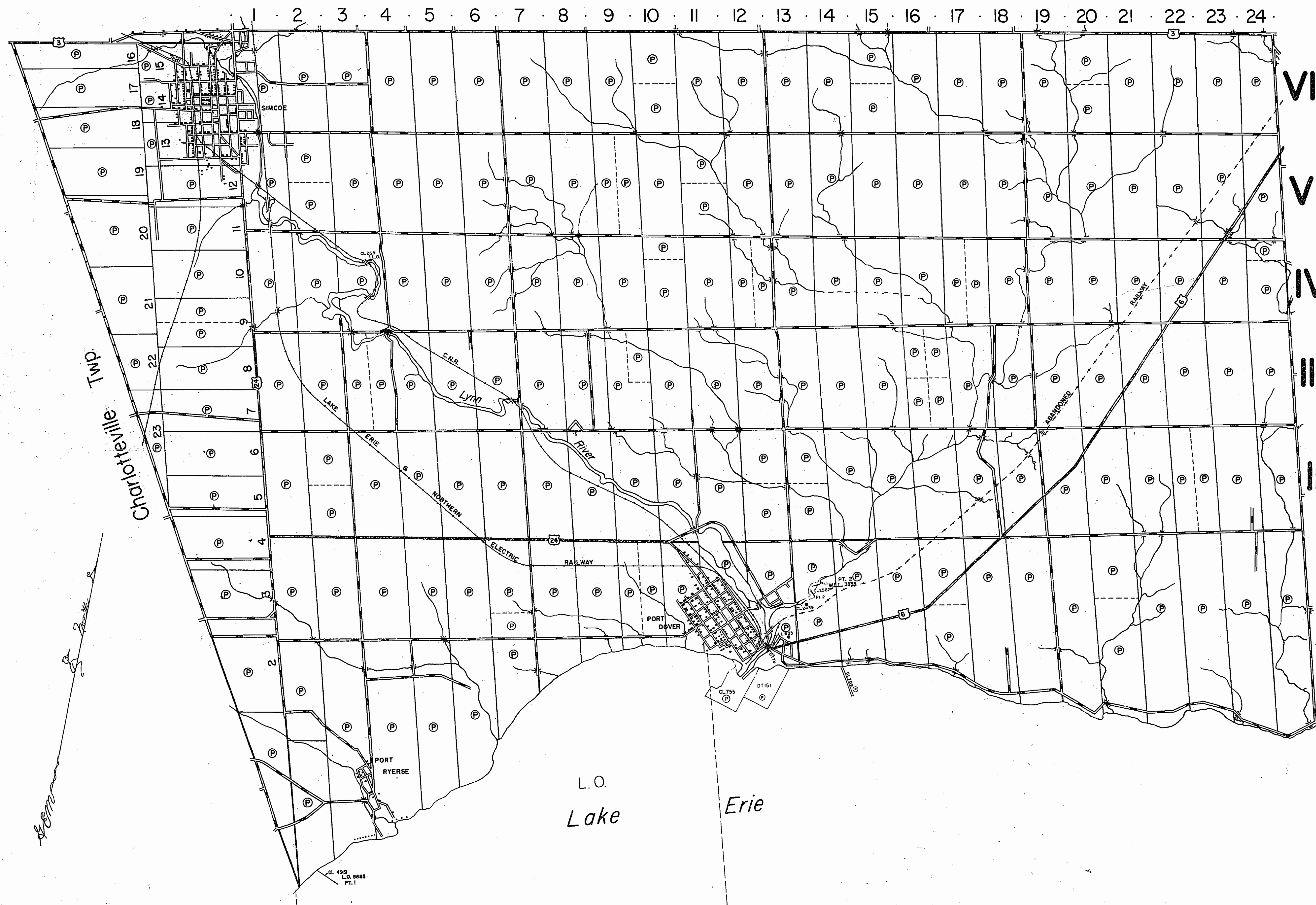

THE TOWNSHIP OF **WOODHOUSE**

COUNTY OF
NORFOLK

**SOUTHERN ONTARIO
MINING DIVISION**

SCALE: 1-INCH=40 CHAINS

LEGEND

PATENTED LAND	● or ○
CROWN LAND SALE	C.S.
LEASES	Ⓛ
LOCATED LAND	Loc.
LICENSE OF OCCUPATION	L.O.
MINING RIGHTS ONLY	M.R.O.
SURFACE RIGHTS ONLY	S.R.O.
ROADS	—
IMPROVED ROADS	—
KING'S HIGHWAYS	—
RAILWAYS	—
POWER LINES	—
MARSH OR MUSKEG	—
MINES	—
PATENTED for S.R.O.	—

NOTES

THIS MAP IS NOT TO BE USED FOR
SURVEY PURPOSES

All Land is Patented in this Township

400' Surface rights reservation around all lakes and rivers.

THE PITS AND QUARRIES CONTROL ACT, 1971
No person shall open, establish or operate a pit or quarry in this township except under authority of a licence issued by the Minister of Natural Resources.

THE INFORMATION THAT APPEARS ON THIS MAP HAS BEEN COMPILED FROM VARIOUS SOURCES, AND ACCURACY IS NOT GUARANTEED. THOSE WISHING TO STAKE MINING CLAIMS SHOULD CONSULT WITH THE MINING RECORDER, MINISTRY OF NORTHERN DEVELOPMENT AND MINES, FOR ADDITIONAL INFORMATION ON THE STATUS OF THE LANDS SHOWN HEREON.

PLAN NO.- M.161.

ONTARIO
MINISTRY OF NATURAL RESOURCES
SURVEYS AND MAPPING BRANCH

RES. GEO. LONDON
M.N.R. DIST. SIMCOE

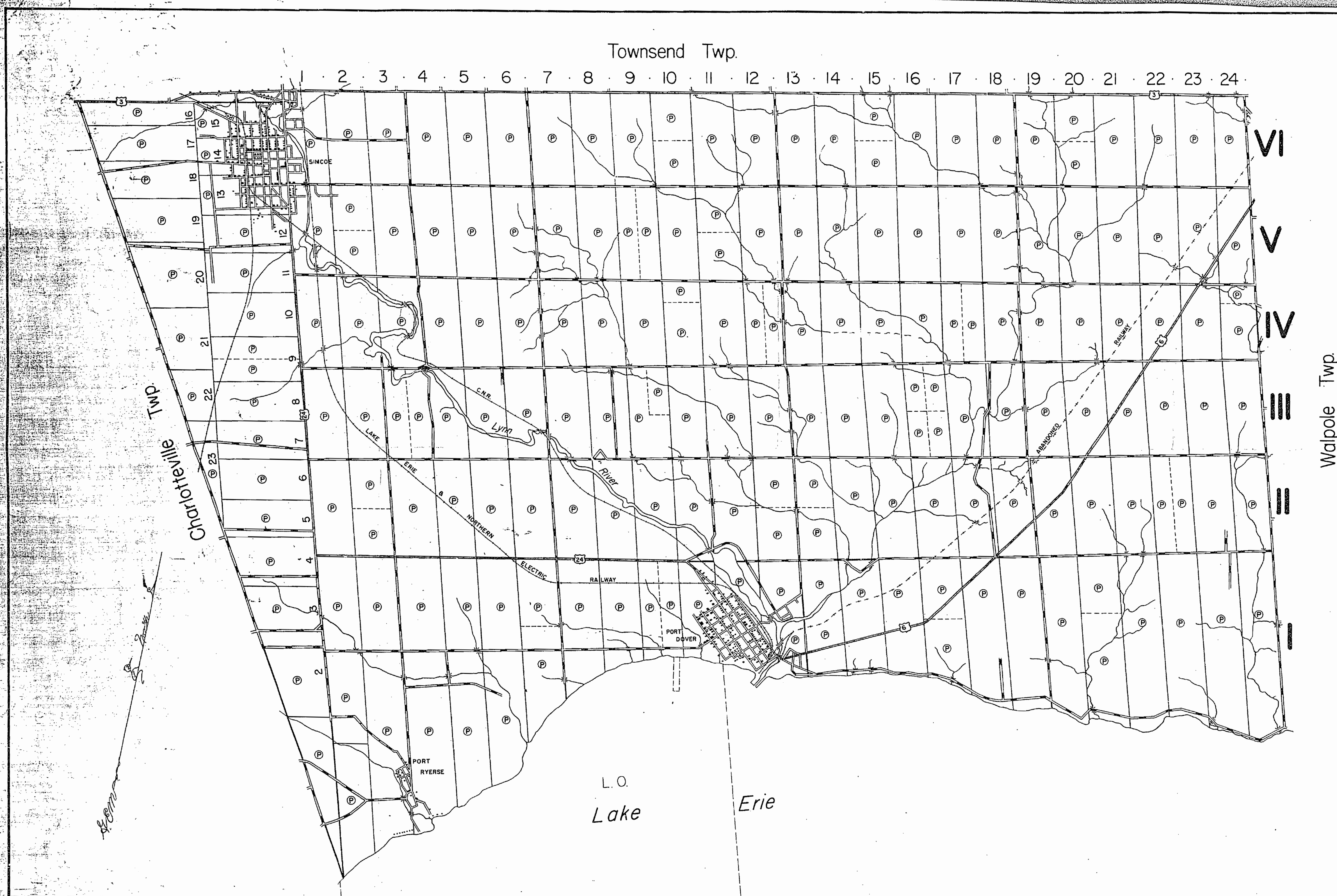

THE TOWNSHIP
OF
WOODHOUSE

COUNTY OF
NORFOLK
EASTERN ONTARIO
MINING DIVISION

SCALE: 1-INCH=40 CHAINS

LEGEND

PATENTED LAND	Ⓟ
CROWN LAND SALE	CS.
LEASES	Ⓛ
LOCATED LAND	Loc.
LICENSE OF OCCUPATION	L.O.
MINING RIGHTS ONLY	M.R.O.
SURFACE RIGHTS ONLY	S.R.O.
ROADS	—
IMPROVED ROADS	—
KING'S HIGHWAYS	—
RAILWAYS	—
POWER LINES	—
MARSH OR MUSKEG	—
MINES	✕

NOTES

THIS MAP IS NOT TO BE USED FOR
SURVEY PURPOSES

All Land is Patented in this Township

400' Surface rights reservation around all lakes and
rivers.

DATE OF ISSUE
FEB 11 1970
ONTARIO DEPT. OF MINES

PLAN NO.- M.161.

DEPARTMENT OF MINES
—ONTARIO—

Townsend Twp.

THE TOWNSHIP
OF
WOODHOUSE

COUNTY OF
NORFOLK

EASTERN ONTARIO
MINING DIVISION

SCALE: 1-INCH=40 CHAINS

LEGEND

PATENTED LAND	Ⓟ
CROWN LAND SALE	C.S.
LEASES	Ⓛ
LOCATED LAND	Loc.
LICENSE OF OCCUPATION	L.O.
MINING RIGHTS ONLY	M.R.O.
SURFACE RIGHTS ONLY	S.R.O.
ROADS	—
IMPROVED ROADS	—
KING'S HIGHWAYS	—
RAILWAYS	—
POWER LINES	—
MARSH OR MUSKEG	—
MINES	✕

NOTES

THIS MAP IS NOT TO BE USED FOR
SURVEY PURPOSES

All Land is Patented in this Township

400' Surface rights reservation around all lakes and
rivers.

MINING LANDS
DATE OF ISSUE
FEB 13 1973
MINISTRY
OF NATURAL RESOURCES

PLAN NO.-M.161

ONTARIO
MINISTRY OF NATURAL RESOURCES
SURVEYS AND MAPPING BRANCH

VI

V

IV

III

II

I

Walpole Twp.

Charltonville Twp.

L.O.
Lake

Erie

PORT
RYERSE

PORT
DOVER

RAILWAY

ELECTRIC

NORTHERN

ERIE

LAKE

C.N.R.

LYN

ABANDONED

RAILWAY

SIMCOE

Townsend Twp.

THE TOWNSHIP
OF
WOODHOUSE

COUNTY OF
NORFOLK

EASTERN ONTARIO
MINING DIVISION

SCALE: 1-INCH= 40 CHAINS

LEGEND

PATENTED LAND	P
CROWN LAND SALE	C.S.
LEASES	L
LOCATED LAND	Loc.
LICENSE OF OCCUPATION	L.O.
MINING RIGHTS ONLY	M.R.O.
SURFACE RIGHTS ONLY	S.R.O.
ROADS	—
IMPROVED ROADS	—
KING'S HIGHWAYS	—
RAILWAYS	—
POWER LINES	—
MARSH OR MUSKEG	—
MINES	X

NOTES

THIS MAP IS NOT TO BE USED FOR
SURVEY PURPOSES

All Land is Patented in this Township

400' Surface rights reservation around all lakes and rivers.

THE PITS AND QUARRIES CONTROL ACT, 1971
No person shall open, establish or operate a pit or quarry in this township except under authority of a licence issued by the Minister of Natural Resources.

- MINING LANDS -
DATE OF ISSUE
NOV 19 1975
MINISTRY
OF NATURAL RESOURCES

PLAN NO.- M.161.

ONTARIO
MINISTRY OF NATURAL RESOURCES
SURVEYS AND MAPPING BRANCH

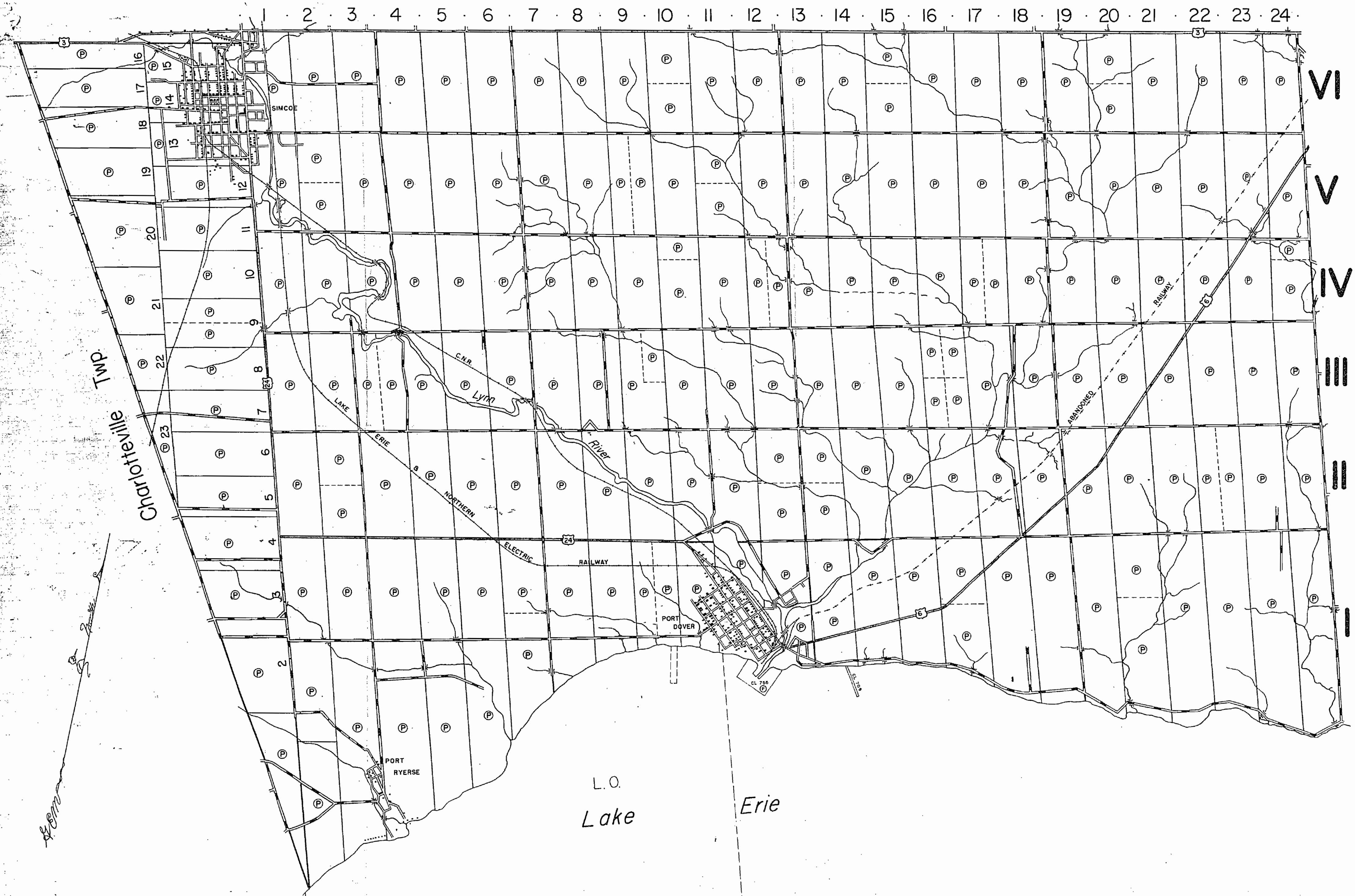

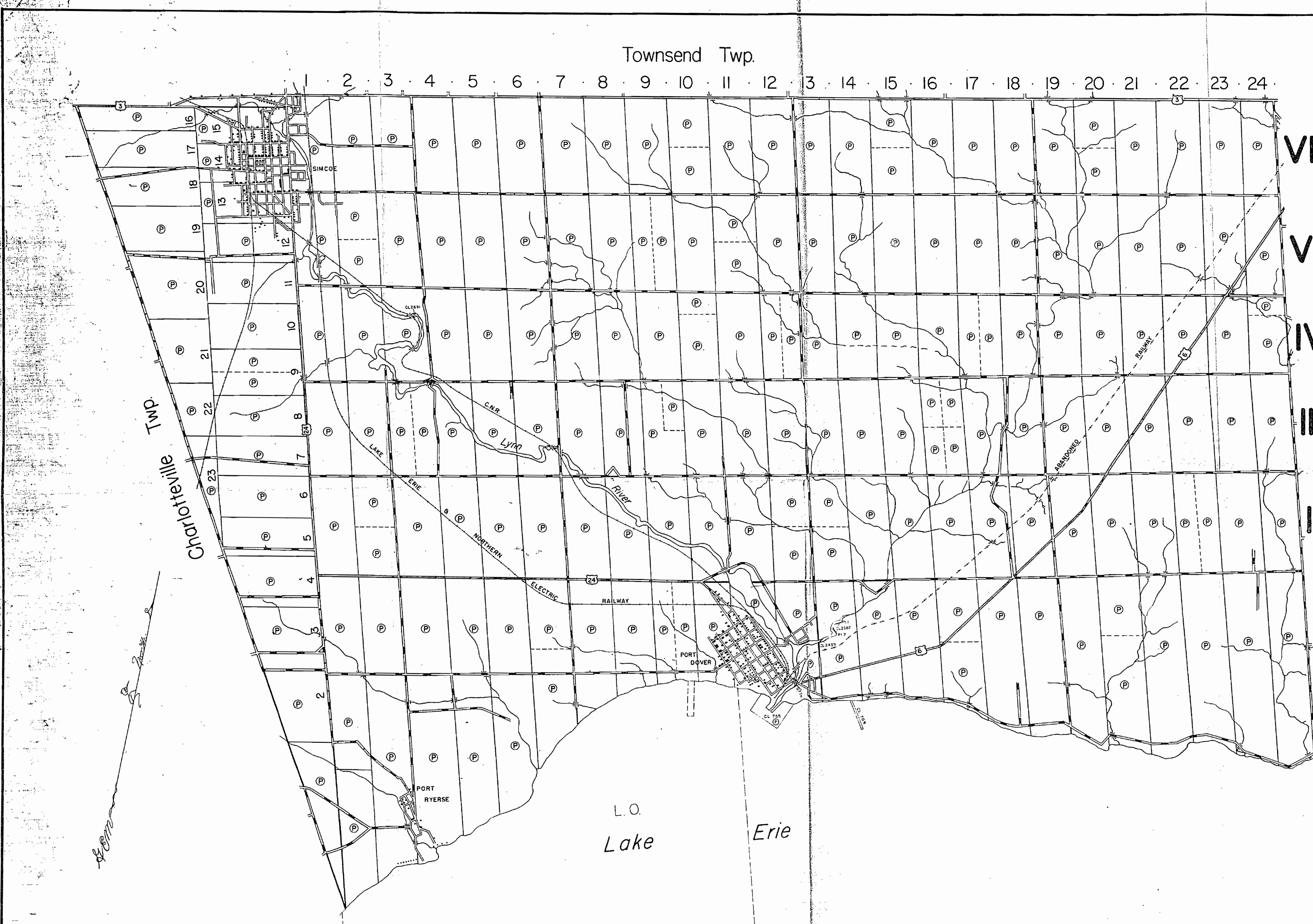

THE TOWNSHIP
OF *m-161*
WOODHOUSE

COUNTY OF
NORFOLK

EASTERN ONTARIO
MINING DIVISION

SCALE: 1-INCH=40 CHAINS

LEGEND

PATENTED LAND	P
GROWN LAND SALE	G.S.
LEASES	L
LOCATED LAND	Loc.
LICENSE OF OCCUPATION	L.O.
MINING RIGHTS ONLY	M.R.O.
SURFACE RIGHTS ONLY	S.R.O.
ROADS	
IMPROVED ROADS	
KING'S HIGHWAYS	
RAILWAYS	
POWER LINES	
MARSH OR MUSKEG	
MINES	

NOTES

THIS MAP IS NOT TO BE USED FOR
SURVEY PURPOSES

All Land is Patented in this Township

400' Surface rights reservation around all lakes and rivers.

THE PITS AND QUARRIES CONTROL ACT, 1971
No person shall open, establish or operate a pit or quarry in this township except under authority of a licence issued by the Minister of Natural Resources.

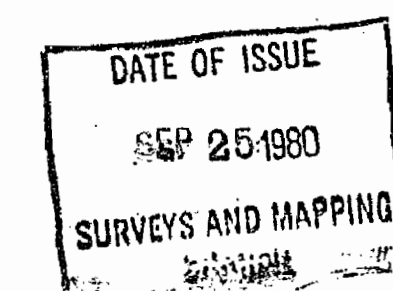

PLAN NO.- M.161.

ONTARIO
MINISTRY OF NATURAL RESOURCES
SURVEYS AND MAPPING BRANCH

Townsend Twp.

THE TOWNSHIP
D.M. OF SW
Simcoe M-161
WOODHOUSE

COUNTY OF
NORFOLK

EASTERN ONTARIO
MINING DIVISION

SCALE: 1-INCH= 40 CHAINS

LEGEND

PATENTED LAND	• or ⊙
CROWN LAND SALE	C.S.
LEASES	⊙
LOCATED LAND	Loc.
LICENSE OF OCCUPATION	L.O.
MINING RIGHTS ONLY	M.R.O.
SURFACE RIGHTS ONLY	S.R.O.
ROADS	—
IMPROVED ROADS	—
KING'S HIGHWAYS	—
RAILWAYS	—
POWER LINES	—
MARSH OR MUSKEG	—
MINES	—
PATENTED for S.R.O.	—

NOTES

THIS MAP IS NOT TO BE USED FOR
SURVEY PURPOSES

All Land is Patented in this Township.

400' Surface rights reservation around all lakes and rivers.

THE PITS AND QUARRIES CONTROL ACT, 1971
No person shall open, establish or operate a pit or quarry in this township except under authority of a licence issued by the Minister of Natural Resources.

DATE OF ISSUE
JUL 26 1982
Ministry of Natural Resources
TORONTO

PLAN NO.- M.161.

ONTARIO
MINISTRY OF NATURAL RESOURCES
SURVEYS AND MAPPING BRANCH

Charlotteville Twp.

Walpole Twp.

VI

V

IV

III

II

I

L.O.
Lake

Erie

SIMCOE

PORT
RYERSE

PORT
DOVER

C.N.R.

LYNN

ERIE

NORTHERN

ELECTRIC

RAILWAY

RAILWAY

ABANDONED

CL 750

CL 750

CL 750

CL 750

CL 750

CL 750

CL 750

CL 750

CL 750

CL 750

CL 750

Townsend Twp.

THE TOWNSHIP
'SW' OF M-161
WOODHOUSE
D.M. SIMCOE
COUNTY OF
NORFOLK

EASTERN ONTARIO
MINING DIVISION

SCALE: 1-INCH = 40 CHAINS

LEGEND

PATENTED LAND	● or P
CROWN LAND SALE	C.S.
LEASES	L
LOCATED LAND	Loc.
LICENSE OF OCCUPATION	L.O.
MINING RIGHTS ONLY	M.R.O.
SURFACE RIGHTS ONLY	S.R.O.
ROADS	—
IMPROVED ROADS	—
KING'S HIGHWAYS	—
RAILWAYS	—
POWER LINES	—
MARSH OR MUSKEG	—
MINES	—
PATENTED for S.R.O.	—

NOTES

THIS MAP IS NOT TO BE USED FOR
SURVEY PURPOSES

All Land is Patented in this Township.

400' Surface rights reservation around all lakes and rivers.

THE PITS AND QUARRIES CONTROL ACT, 1971
No person shall open, establish or operate a pit or quarry in this township except under authority of a licence issued by the Minister of Natural Resources.

DATE OF ISSUE

JUL 21 1983

Ministry of Natural Resources
TORONTO

PLAN NO.- M.161

ONTARIO
MINISTRY OF NATURAL RESOURCES
SURVEYS AND MAPPING BRANCH

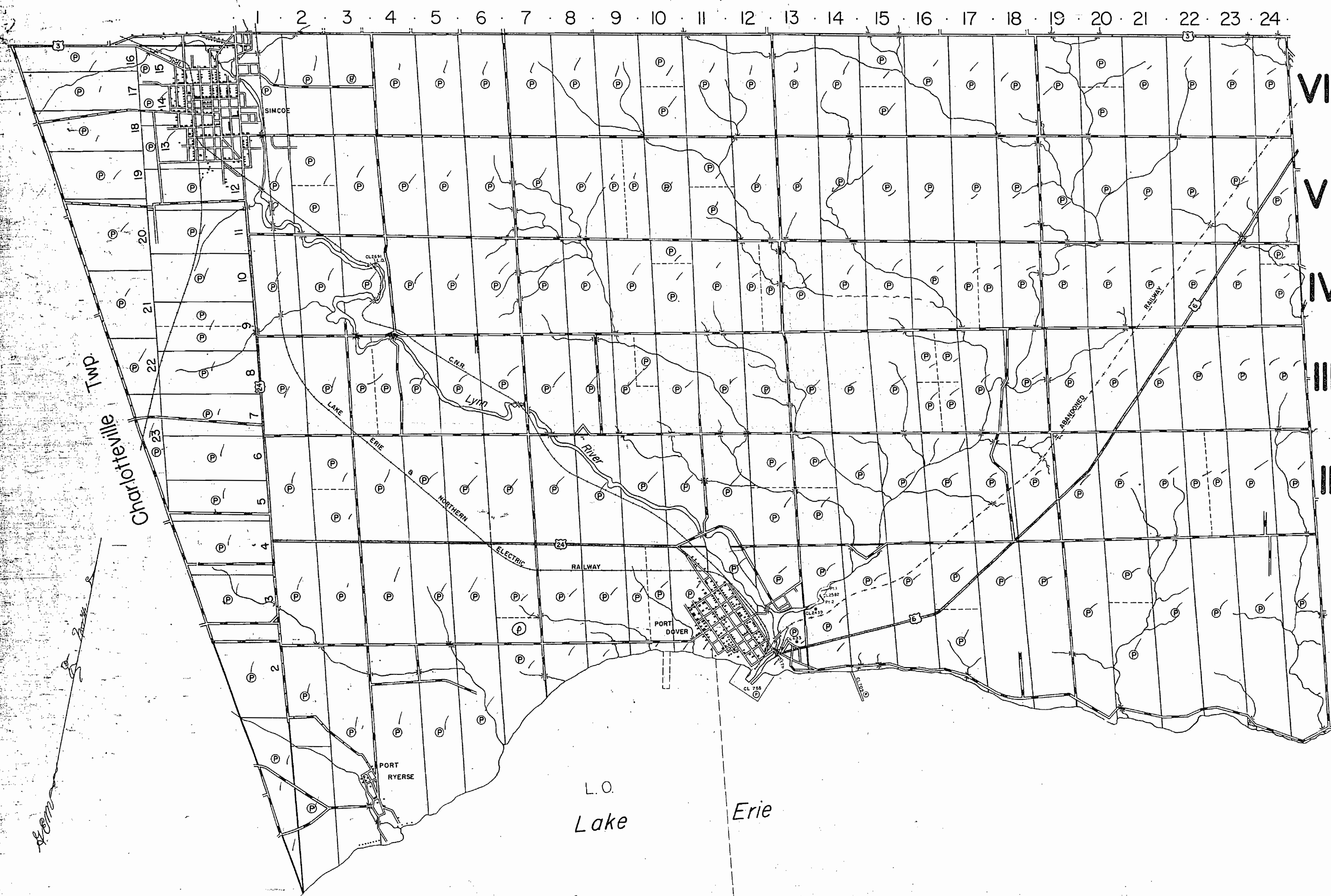

Townsend Twp.

THE TOWNSHIP
S.W. OF M161
REGION

WOODHOUSE

SIMCOE DISTRICT
COUNTY OF
NORFOLK
RESIDENT GEOLOGIST - LONDON

**SOUTHERN ONTARIO
MINING DIVISION**

SCALE: 1-INCH = 40 CHAINS

LEGEND

PATENTED LAND	or P
CROWN LAND SALE	CS.
LEASES	⊙
LOCATED LAND	Loc.
LICENSE OF OCCUPATION	L.O.
MINING RIGHTS ONLY	M.R.O.
SURFACE RIGHTS ONLY	S.R.O.
ROADS	
IMPROVED ROADS	
KING'S HIGHWAYS	
RAILWAYS	
POWER LINES	
MARSH OR MUSKEG	
MINES	
PATENTED for S.R.O.	

NOTES

THIS MAP IS NOT TO BE USED FOR
SURVEY PURPOSES

All Land is Patented in this Township.

400' Surface rights reservation around all lakes and rivers.

THE PITS AND QUARRIES CONTROL ACT, 1971
No person shall open, establish or operate a pit or quarry in this township except under authority of a licence issued by the Minister of Natural Resources.

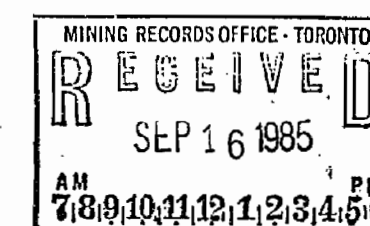

PLAN NO. - M.161

ONTARIO
MINISTRY OF NATURAL RESOURCES
SURVEYS AND MAPPING BRANCH

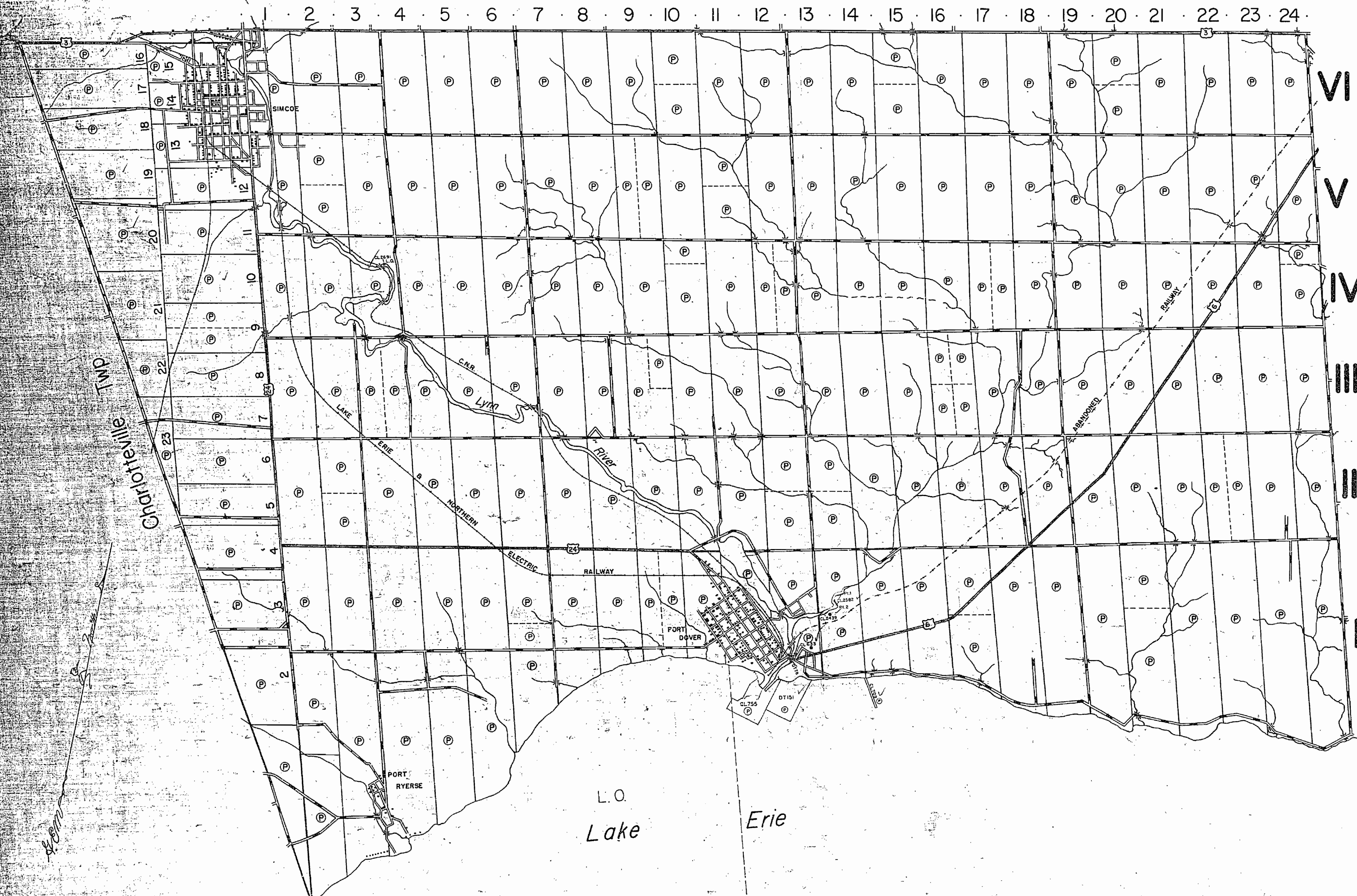

Walpole Twp.

Charlotteville Twp.

L.O.
Lake Erie