

1657-WORK

McMeekin Twp. - M.1981

THE TOWNSHIP OF

WORK

DISTRICT OF
KENORA

KENORA
MINING DIVISION

SCALE: 1-INCH = 40 CHAINS

LEGEND

PATENTED LAND	Ⓟ
CROWN LAND SALE	C.S.
LEASES	Ⓛ
LOCATED LAND	Loc.
LICENSE OF OCCUPATION	L.O.
MINING RIGHTS ONLY	M.R.O.
SURFACE RIGHTS ONLY	S.R.O.
ROADS	
IMPROVED ROADS	
KING'S HIGHWAYS	
RAILWAYS	
POWER LINES	
MARSH OR MUSKEG	
MINES	
CANCELLED	

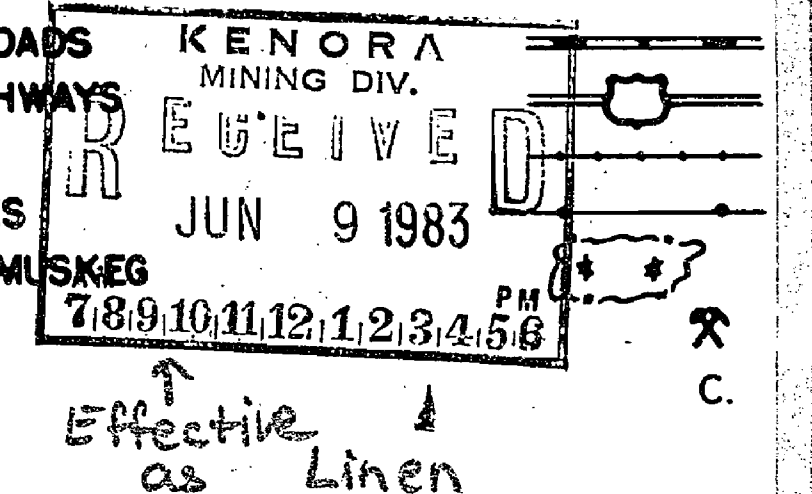

NOTES

400' Surface Rights Reservation around
all lakes and rivers

AREAS WITHDRAWN FROM DISPOSITION

S.R. - SURFACE RIGHTS
M.R. - MINING RIGHTS

Description	Order No.	Date	Disposition	File
Ⓡ1 MNR Reserve				114076
Ⓡ2 M.T.C. Public Park				123032
Ⓡ3 Sec. 36/80	W.23/82	14/4/82	S.R. & M.R.	167579

SAND AND GRAVEL

Ⓢ1 QUARRY PERMIT	
Ⓢ2 M.T.C. GRAVEL PIT NO. 1597	
Ⓢ3 M.T.C. GRAVEL PIT NO. 237	
Ⓢ4 M.T.C. GRAVEL PIT NO. 240	
Ⓢ5 M.T.C. GRAVEL PIT NO. 239	FILE 147681
Ⓢ6 M.T.C. GRAVEL PIT NO. 1707	
Ⓢ7 M.T.C. GRAVEL PIT NO. 238	
Ⓢ8 GRAVEL PIT	FILE 147681

Obsolete Aug. 23/84

PLAN NO. **M.1657**

ONTARIO

MINISTRY OF NATURAL RESOURCES
SURVEYS AND MAPPING BRANCH

Code Twp. - M.1962

Dryberry Lake - M.2699

Devonshire Twp. - M.1966

G1347
McMeekin Twp. - M.1981-

THE TOWNSHIP
OF

WORK

DISTRICT OF
KENORA

KENORA
MINING DIVISION

SCALE: 1-INCH = 40 CHAINS

LEGEND

PATENTED LAND	Ⓟ
CROWN LAND SALE	C.S.
LEASES	Ⓛ
LOCATED LAND	Loc.
LICENSE OF OCCUPATION	L.O.
MINING RIGHTS ONLY	M.R.O.
SURFACE RIGHTS ONLY	S.R.O.
ROADS	
IMPROVED ROADS	
KING'S HIGHWAYS	
RAILWAYS	
POWER LINES	
MARSH OR MUSKEG	
MINES	
CANCELLED	EFFECTIVE DATE

NOTES

400' Surface Rights Reservation around
all lakes and rivers.

AREAS WITHDRAWN FROM DISPOSITION

S.R. — SURFACE RIGHTS M.R. — MINING RIGHTS

Description	Order No.	Date	Disposition	File
Ⓡ1 MNR Reserve				114076
Ⓡ2 M.T.C. Public Park				123032
Ⓡ3 Sec. 36/80	W.23/82	14/4/82	S.R.B.M.R.	167579
Ⓡ4 SEC.35/90	W.K.32.92	20/07/92	S.R.B.M.R.	195150 (TO BE RE-OPENED ON AUG. 1, 1997)
Ⓡ5 SECT.35	W-K-60/95	JULY 25/95	S&M	195150
SAND AND GRAVEL				
Ⓡ6 QUARRY PERMIT				
Ⓡ7 M.T.C. GRAVEL PIT NO. 1597				
Ⓡ8 M.T.C. GRAVEL PIT NO. 237				
Ⓡ9 M.T.C. GRAVEL PIT NO. 240				
Ⓡ10 M.T.C. GRAVEL PIT NO. 239				FILE 147681
Ⓡ11 M.T.C. GRAVEL PIT NO. 1707				
Ⓡ12 M.T.C. GRAVEL PIT NO. 238				
Ⓡ13 GRAVEL PIT				
Ⓡ14 SAND, GRAVEL, BOULDERS				

PLAN NO. M.1657

ONTARIO
MINISTRY OF NATURAL RESOURCES
SURVEYS AND MAPPING BRANCH

G1326
Code Twp. - M.1962-

G2614--
Dryberry Lake - M.2699

G1329--
Devonshire Twp. - M.1966

THE INFORMATION THAT
APPEARS ON THIS MAP
HAS BEEN COMPILED
FROM VARIOUS SOURCES,
AND ACCURACY IS NOT
GUARANTEED. THOSE
WISHING TO STAKE MIN-
ING CLAIMS SHOULD CON-
SULT WITH THE MINING
RECORDER, MINISTRY OF
NORTHERN DEVELOP-
MENT AND MINES, FOR AD-
DITIONAL INFORMATION
ON THE STATUS OF THE
LANDS SHOWN HEREON.

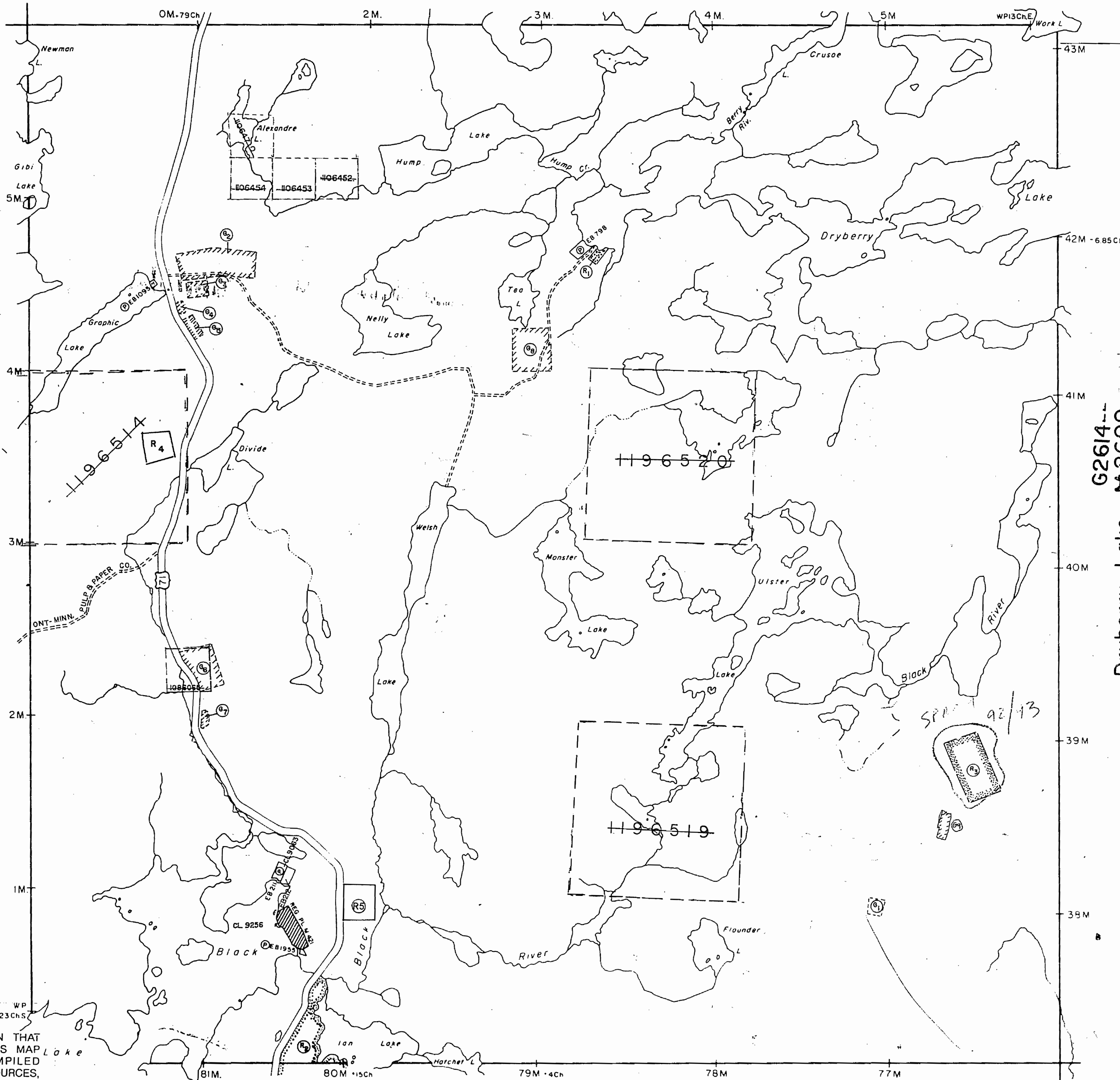

GI347
McMeekin Twp. - M.1981

THE TOWNSHIP
OF

WORK

DISTRICT OF
KENORA

KENORA
MINING DIVISION

SCALE: 1-INCH = 40 CHAINS

LEGEND

PATENTED LAND	(P)
CROWN LAND SALE	C.S.
LEASES	(L)
LOCATED LAND	Loc.
LICENSE OF OCCUPATION	L.O.
MINING RIGHTS ONLY	M.R.O.
SURFACE RIGHTS ONLY	S.R.O.
ROADS	
IMPROVED ROADS	
KING'S HIGHWAYS	
RAILWAYS	
POWER LINES	
MARSH OR MUSKEG	
MINES	
CANCELLED	EFFECTIVE DATE

NOTES

400' Surface Rights Reservation around
all lakes and rivers.

AREAS WITHDRAWN FROM DISPOSITION

S.R. - SURFACE RIGHTS		M.R. - MINING RIGHTS		
Description	Order No.	Date	Disposition	File
(R1) MNR Reserve				114076
(R2) M.T.C. Public Park				123032
(R3) Sec. 36/80	W.23/82	14/4/82	S.R.B.M.R.	167579
(R4) SEC.35/90	W.K.32.92	20/07/92	S.R.B.M.R.	195150 (TO BE RE-OPENED ON AUG. 1, 1997)
(R5) SECT.35	W-K-60/95	JULY 25/95	S8M	195150
(Q1) QUARRY PERMIT				
(Q2) M.T.C. GRAVEL PIT NO. 1597				
(Q3) M.T.C. GRAVEL PIT NO. 237				
(Q4) M.T.C. GRAVEL PIT NO. 240				
(Q5) M.T.C. GRAVEL PIT NO. 239				FILE 147681
(Q6) M.T.C. GRAVEL PIT NO. 1707				
(Q7) M.T.C. GRAVEL PIT NO. 238				
(Q8) GRAVEL PIT				
(Q9) SAND, GRAVEL, BOULDERS				FILE 147681

PLAN NO. **M.1657**

ONTARIO

MINISTRY OF NATURAL RESOURCES
SURVEYS AND MAPPING BRANCH

GI329--
Devonshire Twp. - M.1966

THE INFORMATION THAT
APPEARS ON THIS MAP
HAS BEEN COMPILED
FROM VARIOUS SOURCES,
AND ACCURACY IS NOT
GUARANTEED. THOSE
WISHING TO STAKE MIN-
ING CLAIMS SHOULD CON-
SULT WITH THE MINING
RECORDER, MINISTRY OF
NORTHERN DEVELOP-
MENT AND MINES, FOR AD-
DITIONAL INFORMATION
ON THE STATUS OF THE
LANDS SHOWN HEREON.

