

Powell Twp. (M-241)

THE TOWNSHIP
OF

YARROW

The Corporation of the
Improvement District of
DISTRICT OF
Matachewan-TIMISKAMING

**LARDER LAKE
MINING DIVISION**

SCALE: 1-INCH = 40 CHAINS

LEGEND

- PATENTED LAND (P)
- CROWN LAND SALE (C.S)
- LEASES (L)
- LOCATED LAND (L.C)
- LICENSE OF OCCUPATION (L.O)
- MINING RIGHTS ONLY (M.R.O)
- SURFACE RIGHTS ONLY (S.R.O)
- ROADS
- IMPROVED ROADS
- KING'S HIGHWAYS
- RAILWAYS
- POWER LINES
- MARSH OR MUSKEG
- MINES
- CANCELLED (C)

NOTES

400' Surface Rights Reservation along
the Shores of all Lakes and Rivers.
L.O. 7601 Covers Flooding Rights in
this Township to below Contour 870
for H.E.P.C. File: 12290 vol. 2.

*Known as The Corp. of the Improve-
ment District of Matachewan
of Jan 1/76*

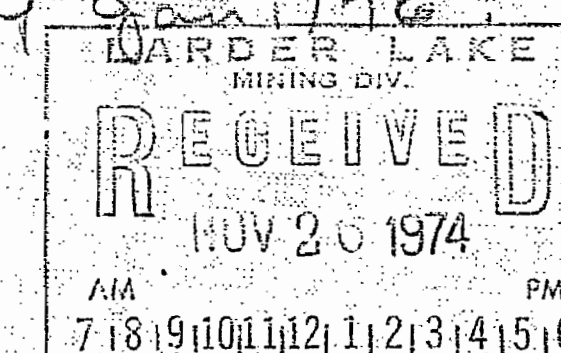

Rep. by Mylar Sept 17/74

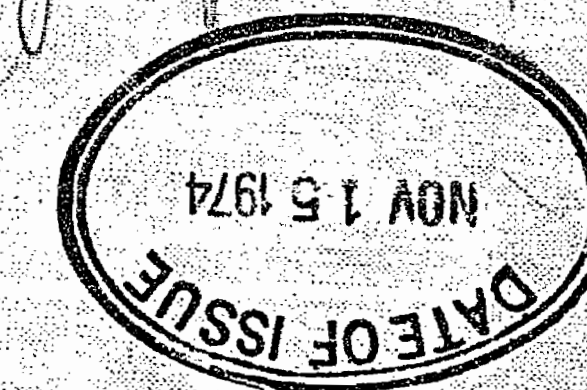

#1

PLAN NO. **M. 260**

MINISTRY OF NATURAL RESOURCES
SURVEYS AND MAPPING BRANCH

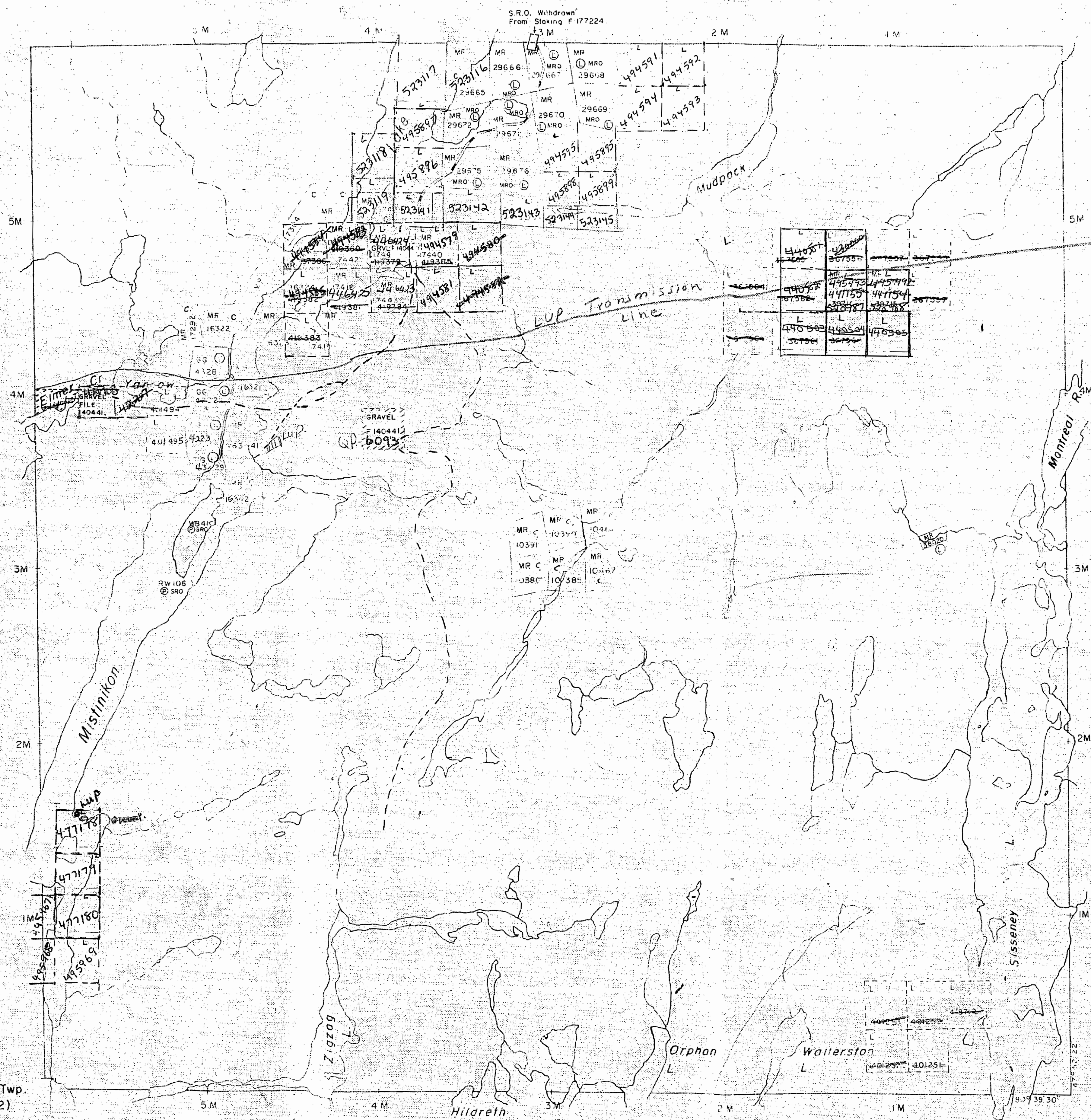

Morel Twp. (M-238)

W.560

W.560

YARROW TWP

YARROW TWP

W.560

W.560

Powell Twp. (M-241)

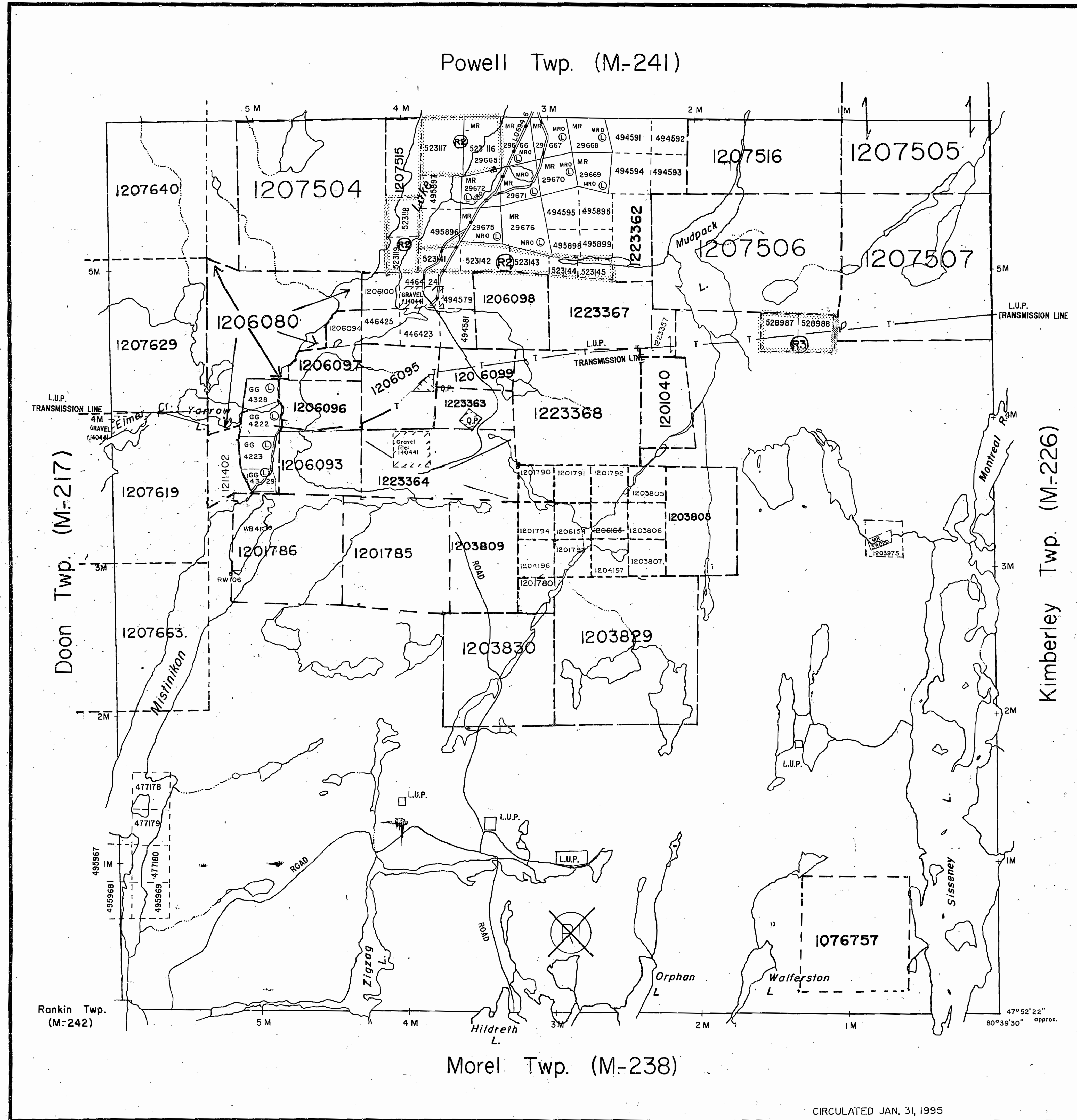

THE TOWNSHIP
OF
YARROW

DISTRICT OF
TIMISKAMING

LARDER LAKE
MINING DIVISION

SCALE: 1-INCH = 40 CHAINS

LEGEND

PATENTED LAND	● or ⊕
CROWN LAND SALE	C.S.
LEASES	⊙
LOCATED LAND	Loc.
LICENSE OF OCCUPATION	L.O.
MINING RIGHTS ONLY	M.R.O.
SURFACE RIGHTS ONLY	S.R.O.
ROADS	—
IMPROVED ROADS	—
KING'S HIGHWAYS	—
RAILWAYS	—
POWER LINES	—
MARSH OR MUSKEG	—
MINES	—
CANCELLED	—
PATENTED S.R.O.	—

NOTES

- 400' Surface Rights Reservation along the Shores of all Lakes and Rivers.
- L.O. 7601 Covers Flooding Rights in this Township to below Contour 870' for Ont. Hydro. File 12290 v.2.
- (R1) MINING & SURFACE RIGHTS WITHDRAWN FROM PROSPECTING, SALE OR LEASE SECTION 36 MINING ACT R.S.O. 1980 ORDER NO. NRW 65/83 DATED NOV. 18, 1983 AT 4:34 PM.
- (R2) MINING AND SURFACE RIGHTS WITHDRAWN ORDER NO. W-L-21/95 DATED MARCH 30, 1995.
- (R3) MINING & SURFACE RIGHTS REOPENED TO PROSPECTING, SALE OR LEASE, ORDER O-L-10/95. PREVIOUSLY WITHDRAWN UNDER ORDER #W 65/83.
- (R4) MINING AND SURFACE RIGHTS WITHDRAWN ORDER NO. W-L-22/95 DATED MARCH 30, 1995. PREVIOUSLY WITHDRAWN UNDER ORDER #NRW 65/83.

NOTICE OF FORESTRY ACTIVITY
THIS TOWNSHIP / AREA FALLS WITHIN THE ELK LAKE MANAGEMENT UNIT AND MAY BE SUBJECT TO FORESTRY OPERATIONS. THE MNR UNIT FORESTER FOR THIS AREA CAN BE CONTACTED AT
BOX 129
SWASTIKA, ONT.
POK 110 705-642-3222

PLAN NO. **M.260**

ONTARIO
MINISTRY OF NATURAL RESOURCES
SURVEYS AND MAPPING BRANCH

THE INFORMATION THAT APPEARS ON THIS MAP HAS BEEN COMPILED FROM VARIOUS SOURCES, AND ACCURACY IS NOT GUARANTEED. THOSE WISHING TO STAKE MINING CLAIMS SHOULD CONSULT WITH THE MINING RECORDER, MINISTRY OF NORTHERN DEVELOPMENT AND MINES, FOR ADDITIONAL INFORMATION ON THE STATUS OF THE LANDS SHOWN HEREON.

CIRCULATED JAN. 31, 1995

RECEIVED ON JUNE 01/95
ARCHIVED APRIL 23/97

Powell Twp. (M-241)

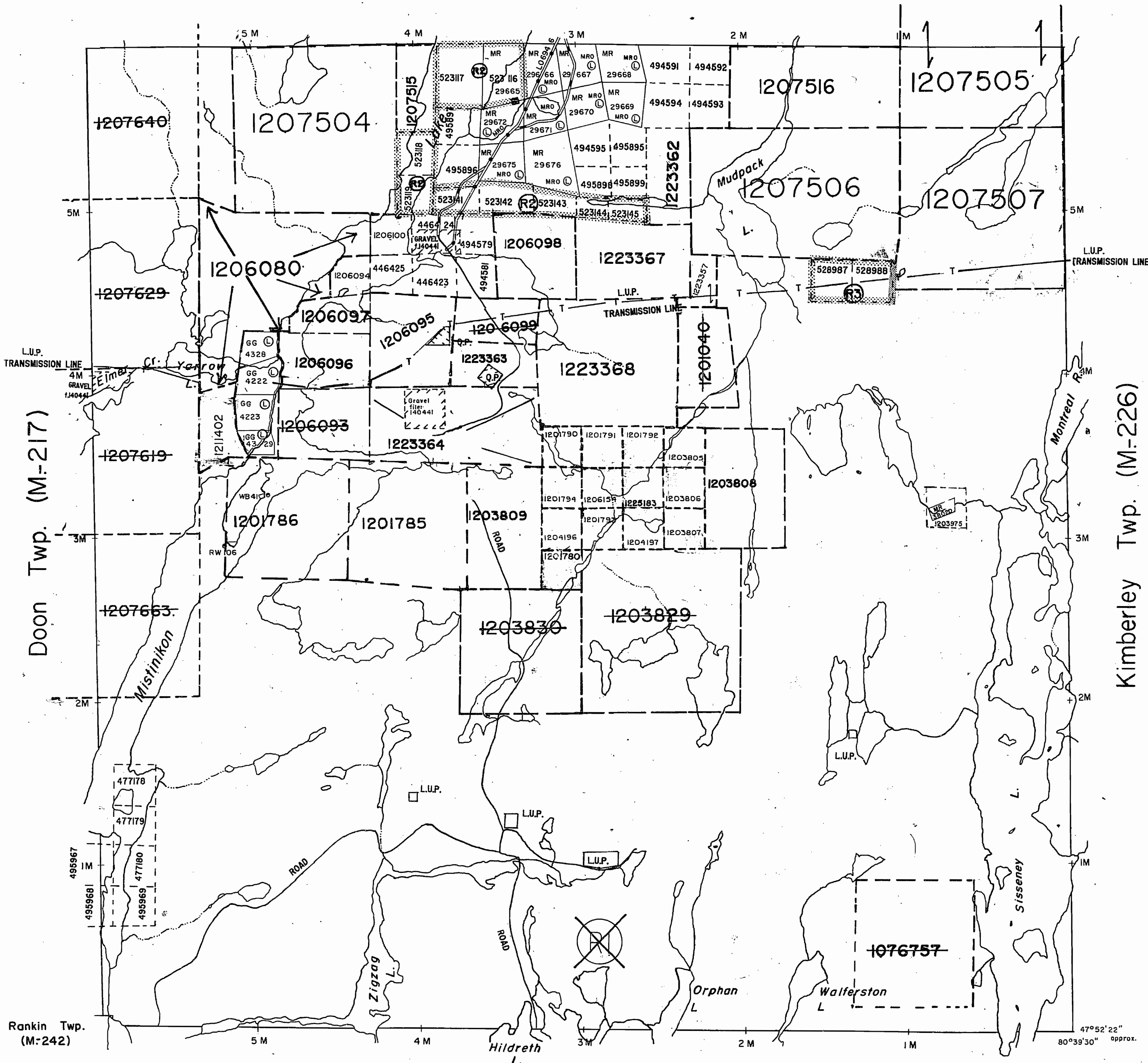

THE TOWNSHIP
OF
YARROW

DISTRICT OF
TIMISKAMING

LARDER LAKE
MINING DIVISION

SCALE: 1-INCH = 40 CHAINS

LEGEND

PATENTED LAND	● or ⊕
CROWN LAND SALE	C.S.
LEASES	L
LOCATED LAND	Loc.
LICENSE OF OCCUPATION	L.O.
MINING RIGHTS ONLY	M.R.O.
SURFACE RIGHTS ONLY	S.R.O.
ROADS	—
IMPROVED ROADS	—
KING'S HIGHWAYS	—
RAILWAYS	—
POWER LINES	—
MARSH OR MUSKEG	—
MINES	⊗
CANCELLED	C.
PATENTED S.R.O.	⊙

NOTES

- 400' Surface Rights Reservation along the Shores of all Lakes and Rivers.
- L.O. 7601 Covers Flooding Rights in this Township to below Contour 870' for Ont. Hydro. File I2290 v.2.
- (R1) MINING & SURFACE RIGHTS WITHDRAWN FROM PROSPECTING SALE OR LEASE SECTION 36, MINING ACT R.S.O. 1980 ORDER NO. NRW 65/83 DATED NOV. 18, 1983 AT 4:34 PM.
- (R2) MINING AND SURFACE RIGHTS WITHDRAWN ORDER NO. W-L-21/95 DATED MARCH 30, 1995
- (R) MINING & SURFACE RIGHTS REOPENED TO PROSPECTING, SALE OR LEASE, ORDER O-L-10/95, PREVIOUSLY WITHDRAWN UNDER ORDER #W 65/83.
- (R3) MINING AND SURFACE RIGHTS WITHDRAWN ORDER NO. W-L-22/95 DATED MARCH 30, 1995. PREVIOUSLY WITHDRAWN UNDER ORDER #NRW 65/83.

NOTICE OF FORESTRY ACTIVITY
THIS TOWNSHIP / AREA FALLS WITHIN THE ELK LAKE MANAGEMENT UNIT AND MAY BE SUBJECT TO FORESTRY OPERATIONS. THE MNR UNIT FORESTER FOR THIS AREA CAN BE CONTACTED AT
BOX 129
SWASTIKA, ONT.
POK ITO 705-642-3222

PLAN NO. M.260

ONTARIO
MINISTRY OF NATURAL RESOURCES
SURVEYS AND MAPPING BRANCH

CIRCULATED JAN. 31, 1995

ARCHIVED ON JUNE 01/95
ARCHIVED APRIL 23/97

Powell Twp. (M-241)

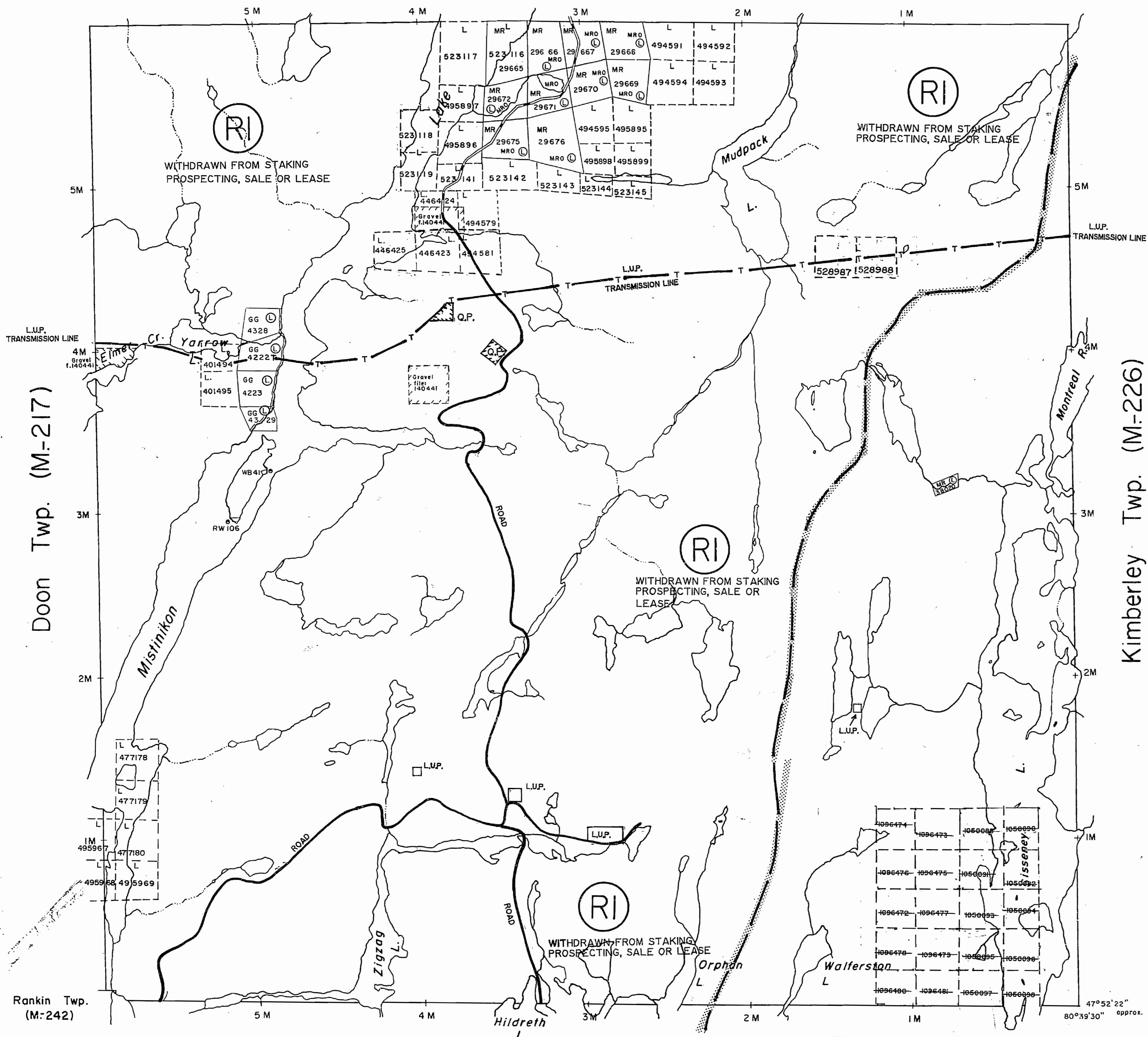

THE TOWNSHIP OF
OF
YARROW

DISTRICT OF
TIMISKAMING

LARDER LAKE
MINING DIVISION

SCALE: 1-INCH = 40 CHAINS

LEGEND

PATENTED LAND	● or ⊕
CROWN LAND SALE	C.S.
LEASES	⊙
LOCATED LAND	Loc.
LICENSE OF OCCUPATION	L.O.
MINING RIGHTS ONLY	M.R.O.
SURFACE RIGHTS ONLY	S.R.O.
ROADS	—
IMPROVED ROADS	—
KING'S HIGHWAYS	—
RAILWAYS	—
POWER LINES	—
MARSH OR MUSKEG	—
MINES	—
CANCELLED	—
PATENTED S.R.O.	—

NOTES

400' Surface Rights Reservation along the Shores of all Lakes and Rivers.
L.O. 7601 Covers Flooding Rights in this Township to below Contour 870' for Ont. Hydro. File 12290 v.2.

RI

MINING & SURFACE RIGHTS WITHDRAWN FROM PROSPECTING, STAKING, SALE OR LEASE - SECTION 36, MINING ACT RSO 1980
ORDER NO. NRW 65/83 DATED NOVEMBER 18, 1983 AT 4:35 P.M.

NOTICE OF FORESTRY ACTIVITY
THIS TOWNSHIP / AREA FALLS WITHIN THE ELK LAKE MANAGEMENT UNIT AND MAY BE SUBJECT TO FORESTRY OPERATIONS. THE MNR UNIT FORESTER FOR THIS AREA CAN BE CONTACTED AT: P.O. BOX 129 SWASTIKA, ONT. POK ITO 705-642-3222

PLAN NO. **M.260**

ONTARIO
MINISTRY OF NATURAL RESOURCES
SURVEYS AND MAPPING BRANCH

Morel Twp. (M-238)

THIS MAP SHOWS THE APPROXIMATE LOCATION OF THE BOUNDARIES OF THE AREA WHICH IS THE SUBJECT OF CURRENT LITIGATION. THE EXACT LOCATION WILL BE SHOWN FOLLOWING

REMOVED FROM CIRCULATION JAN. 3, 1995
PLAN UPDATED NOV 30/90

#10

Powell Twp. (M-241)

THE TOWNSHIP
OF
YARROW

DISTRICT OF
TIMISKAMING

LARDER LAKE
MINING DIVISION

SCALE: 1-INCH = 40 CHAINS

LEGEND

PATENTED LAND	● or ⊕
CROWN LAND SALE	C.S.
LEASES	⊙
LOCATED LAND	Loc.
LICENSE OF OCCUPATION	L.O.
MINING RIGHTS ONLY	M.R.O.
SURFACE RIGHTS ONLY	S.R.O.
ROADS	—
IMPROVED ROADS	—
KING'S HIGHWAYS	—
RAILWAYS	—
POWER LINES	—
MARSH OR MUSKEG	—
MINES	—
CANCELLED	⊘
PATENTED S.R.O.	⊙

NOTES

400' Surface Rights Reservation along the Shores of all Lakes and Rivers.
L.O. 7601 Covers Flooding Rights in this Township to below Contour 870' for Ont. Hydro. File I2290 v.2.

- (R1) MINING & SURFACE RIGHTS WITHDRAWN FROM PROSPECTING SALE OR LEASE SECTION 36, MINING ACT R.S.O. 1980, ORDER NO. NRW 65/83 DATED NOV. 18, 1993 AT 4:34 PM.
- (R2) MINING AND SURFACE RIGHTS WITHDRAWN ORDER NO. W-L-21/95 DATED MARCH 30, 1995
- (R3) MINING & SURFACE RIGHTS REOPENED TO PROSPECTING, SALE OR LEASE, ORDER O-L-10/95, PREVIOUSLY WITHDRAWN UNDER ORDER #W 65/83.
- (R4) MINING AND SURFACE RIGHTS WITHDRAWN ORDER NO. W-L-22/95 DATED MARCH 30, 1995, PREVIOUSLY WITHDRAWN UNDER ORDER #NRW 65/83.

NOTICE OF FORESTRY ACTIVITY
THIS TOWNSHIP / AREA FALLS WITHIN THE ELK LAKE MANAGEMENT UNIT AND MAY BE SUBJECT TO FORESTRY OPERATIONS. THE MNR UNIT FORESTER FOR THIS AREA CAN BE CONTACTED AT:
BOX 129
SWASTIKA, ONT.
POK JTO: 705-642-3222

PLAN NO. **M.260**

ONTARIO
MINISTRY OF NATURAL RESOURCES
SURVEYS AND MAPPING BRANCH

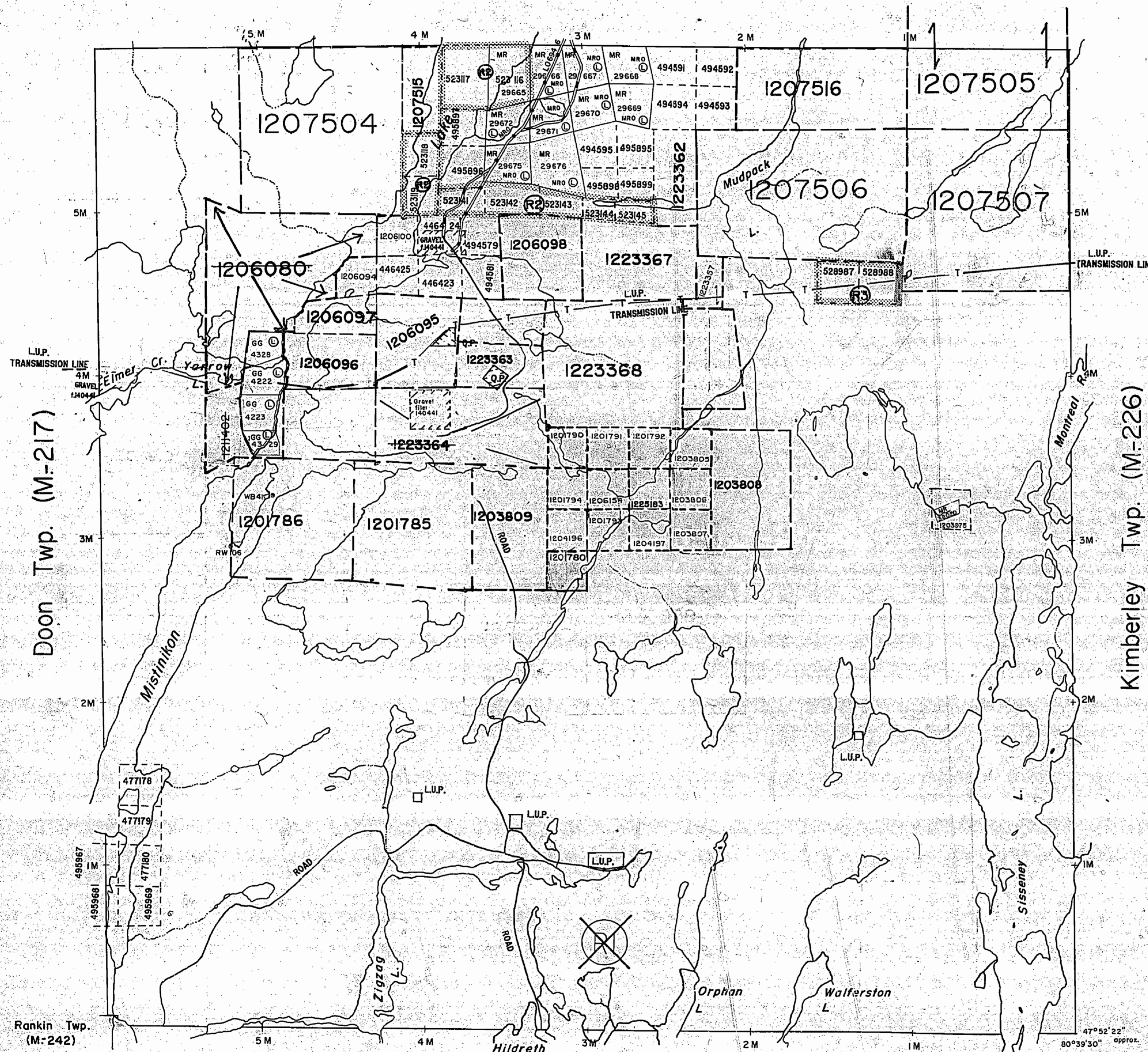

Morel Twp. (M-238)

CIRCULATED JAN. 31, 1995

ARCHIVED ON JUNE 01/95
ARCHIVED APRIL 23/97

ON THAT THIS MAP COMPILED SOURCES IS NOT THOSE TAKE MIN- WOULD CON- MINING INDUSTRY OF DEVELOP- FOR AD- OF THE HEREON

Powell Twp. (M-241)

THE TOWNSHIP
OF

YARROW

DATE OF ISSUE

JAN 2 1995

DISTRICT OF
TIMISKAMING

LARDER LAKE
MINING RECORDER'S OFFICE

LARDER LAKE
MINING DIVISION

SCALE: 1-INCH 40 CHAINS

LEGEND

PATENTED LAND	● or ⊕
CROWN LAND SALE	C.S.
LEASES	⊙
LOCATED LAND	Lac.
LICENSE OF OCCUPATION	L.O.
MINING RIGHTS ONLY	M.R.O.
SURFACE RIGHTS ONLY	S.R.O.
ROADS	—
IMPROVED ROADS	—
KING'S HIGHWAYS	—
RAILWAYS	—
POWER LINES	—
MARSH OR MUSKEG	—
MINES	⊗
CANCELLED	⊘
PATENTED S.R.O.	⊙

NOTES

400' Surface Rights Reservation along the Shores of all Lakes and Rivers.
L.O. 7601 Covers Flooding Rights in this Township to below Contour 870' for Ont. Hydro. File 12290 v.2.

- (R1) MINING & SURFACE RIGHTS WITHDRAWN FROM PROSPECTING SALE OR LEASE SECTION 36, MINING ACT R.S.O. 1980, ORDER NO. NRW 65/83 DATED NOV. 18, 1983 AT 4:34 PM.
- (R2) MINING AND SURFACE RIGHTS WITHDRAWN ORDER NO. W-L-21/95 DATED MARCH 30, 1995
- (R1) MINING & SURFACE RIGHTS REOPENED TO PROSPECTING, SALE OR LEASE, ORDER O-L-10/95, PREVIOUSLY WITHDRAWN UNDER ORDER #W 65/83.
- (R3) MINING AND SURFACE RIGHTS WITHDRAWN ORDER NO. W-L-22/95 DATED MARCH 30, 1995. PREVIOUSLY WITHDRAWN UNDER ORDER #NRW 65/83.

NOTICE OF FORESTRY ACTIVITY
THIS TOWNSHIP / AREA FALLS WITHIN THE ELK LAKE MANAGEMENT UNIT AND MAY BE SUBJECT TO FORESTRY OPERATIONS. THE MNR UNIT FORESTER FOR THIS AREA CAN BE CONTACTED AT
BOX 129
SWASTIKA, ONT.
POK ITO 705-642-3222

PLAN NO. **M.260**

ONTARIO
MINISTRY OF NATURAL RESOURCES

SURVEYS AND MAPPING BRANCH

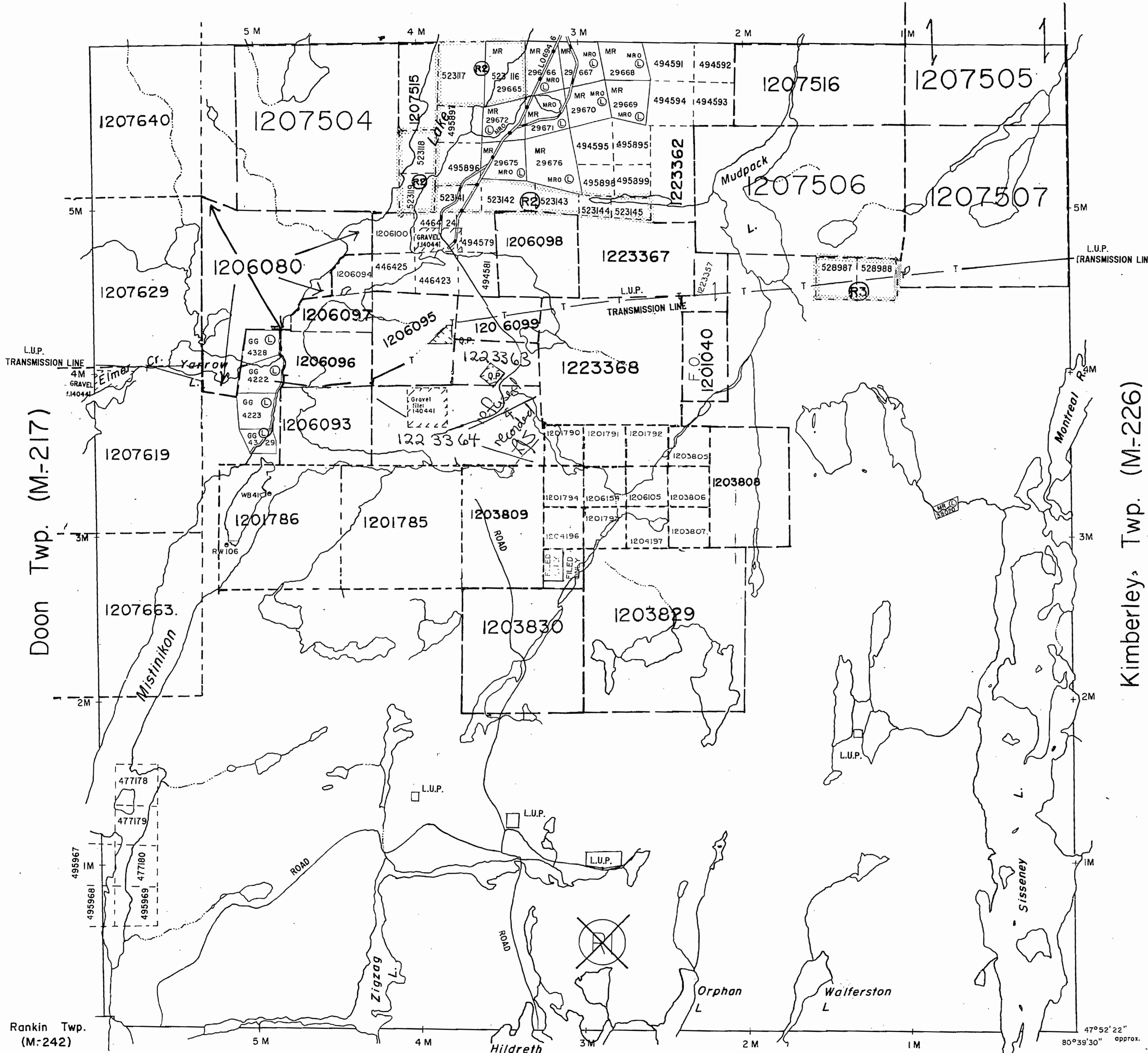

Morel Twp. (M-238)

Powell Twp. (M-241)

THE TOWNSHIP
OF
YARROW

DISTRICT OF
TIMISKAMING

LARDER LAKE
MINING DIVISION

SCALE: 1-INCH 40 CHAINS

LEGEND

- | | |
|-----------------------|--------|
| PATENTED LAND | Ⓟ |
| CROWN LAND SALE | C.S. |
| LEASES | Ⓛ |
| LOCATED LAND | Lac |
| LICENSE OF OCCUPATION | L.O. |
| MINING RIGHTS ONLY | M.R.O. |
| SURFACE RIGHTS ONLY | S.R.O. |
| ROADS | — |
| IMPROVED ROADS | — |
| KING'S HIGHWAYS | — |
| RAILWAYS | — |
| POWER LINES | — |
| MARSH OR MUSKEG | — |
| MINES | Ⓜ |
| CANCELLED | Ⓢ |

NOTES

400' Surface Rights Reservation along the Shores of all Lakes and Rivers.
L.O. 7601 Covers Flooding Rights in this Township to below Contour 870' for H.E.P.C. File: 12290 vol. 2.

LARDER LAKE
MINING DIV.
RECEIVED
MAY 17 1971
7 18 19 10 11 12 13 14 15 16

PLAN NO. **M.260** #1

ONTARIO
DEPARTMENT OF MINES
AND NORTHERN AFFAIRS

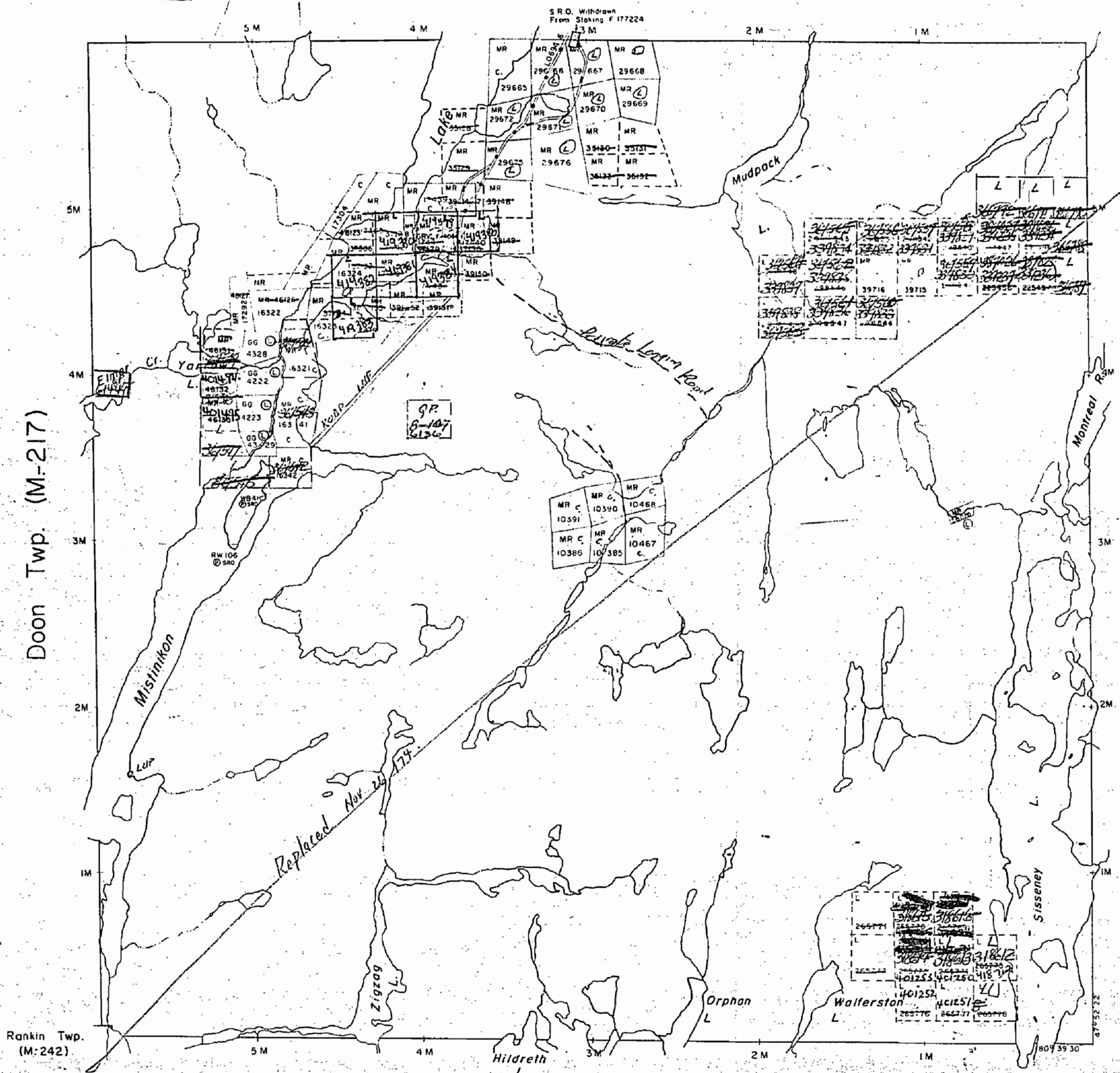

Doon Twp. (M-217)

Kimberley Twp. (M-226)

Rankin Twp. (M-242)

Morel Twp. (M-238)

Powell Twp. (M.-241)

THE TOWNSHIP
OF
YARROW

DISTRICT OF
TIMISKAMING

LARDER LAKE
MINING DIVISION

SCALE: 1-INCH = 40 CHAINS

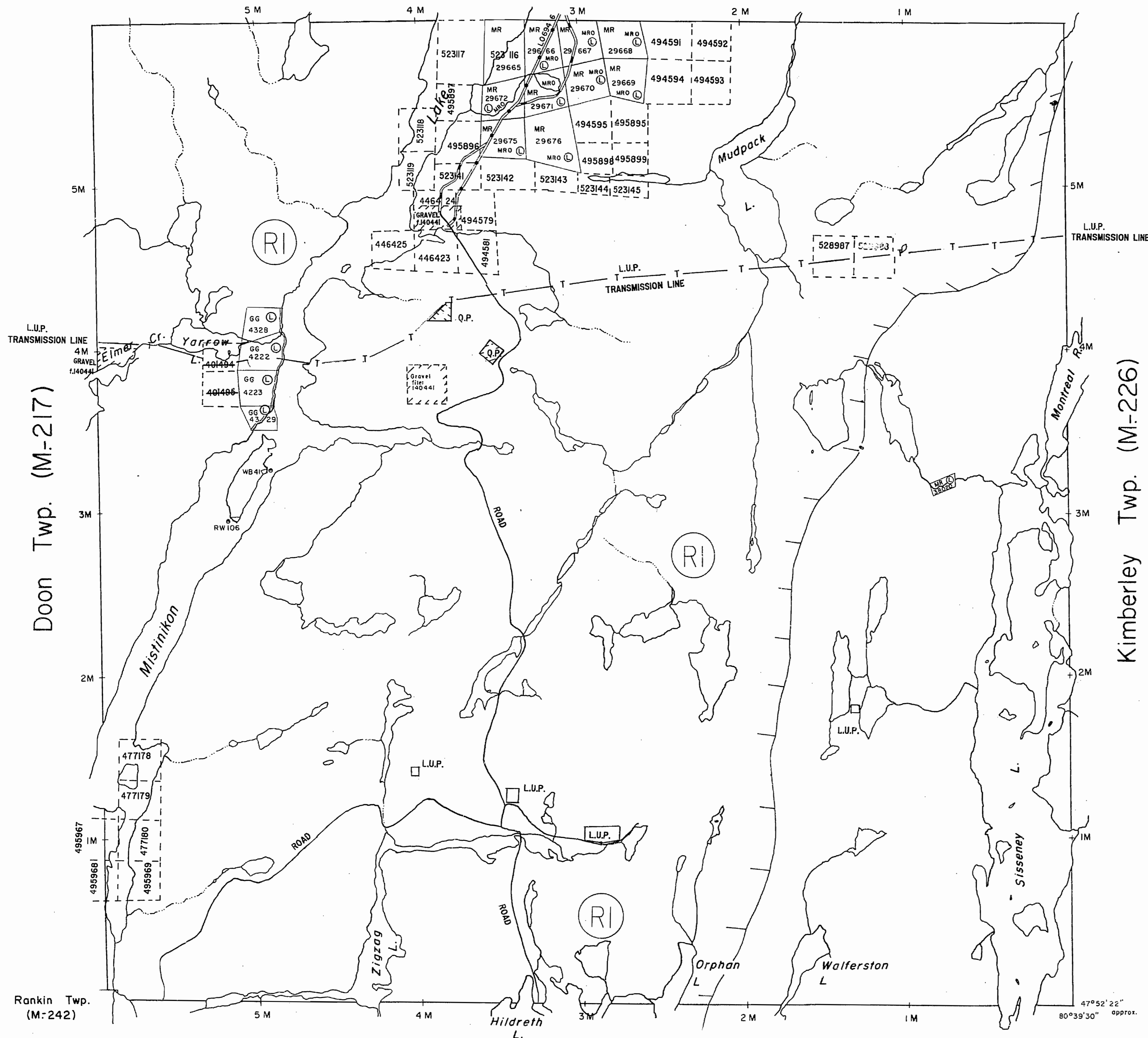

LEGEND

PATENTED LAND	● or (P)
CROWN LAND SALE	C.S.
LEASES	(L)
LOCATED LAND	Loc.
LICENSE OF OCCUPATION	L.O.
MINING RIGHTS ONLY	M.R.O.
SURFACE RIGHTS ONLY	S.R.O.
ROADS	—
IMPROVED ROADS	—
KING'S HIGHWAYS	—
RAILWAYS	—
POWER LINES	—
MARSH OR MUSKEG	—
MINES	—
CANCELLED	—
PATENTED S.R.O.	—

NOTES

400' Surface Rights Reservation along the Shores of all Lakes and Rivers.
L.O. 7601 Covers Flooding Rights in this Township to below Contour 870' for Ont. Hydro. File 12290 v.2.

(RI)

MINING AND SURFACE RIGHTS WITHDRAWN FROM PROSPECTING, STAKING, SALE OR LEASE SECTION 36, MINING ACT RSO 1980 ORDER NO. NRW 65/83 DATED NOVEMBER 18, 1983 AT 4:35 PM.

NOTICE OF FORESTRY ACTIVITY
THIS TOWNSHIP / AREA FALLS WITHIN THE ELK LAKE MANAGEMENT UNIT AND MAY BE SUBJECT TO FORESTRY OPERATIONS. THE MNR UNIT FORESTER FOR THIS AREA CAN BE CONTACTED AT
BOX 129
SWASTIKA, ONT.
POK ITO 705-642-3222

PLAN NO. **M.260**

ONTARIO
MINISTRY OF NATURAL RESOURCES
SURVEYS AND MAPPING BRANCH

PLAN OF
YARROW TWP.
 TIMAGAMI FOREST RESERVE.
 MONTREAL RIVER MINING DIVISION.
 DISTRICT OF TIMISKAMING.

SCALE 40 CHAINS TO AN INCH.

M-260



POWELL TWP.

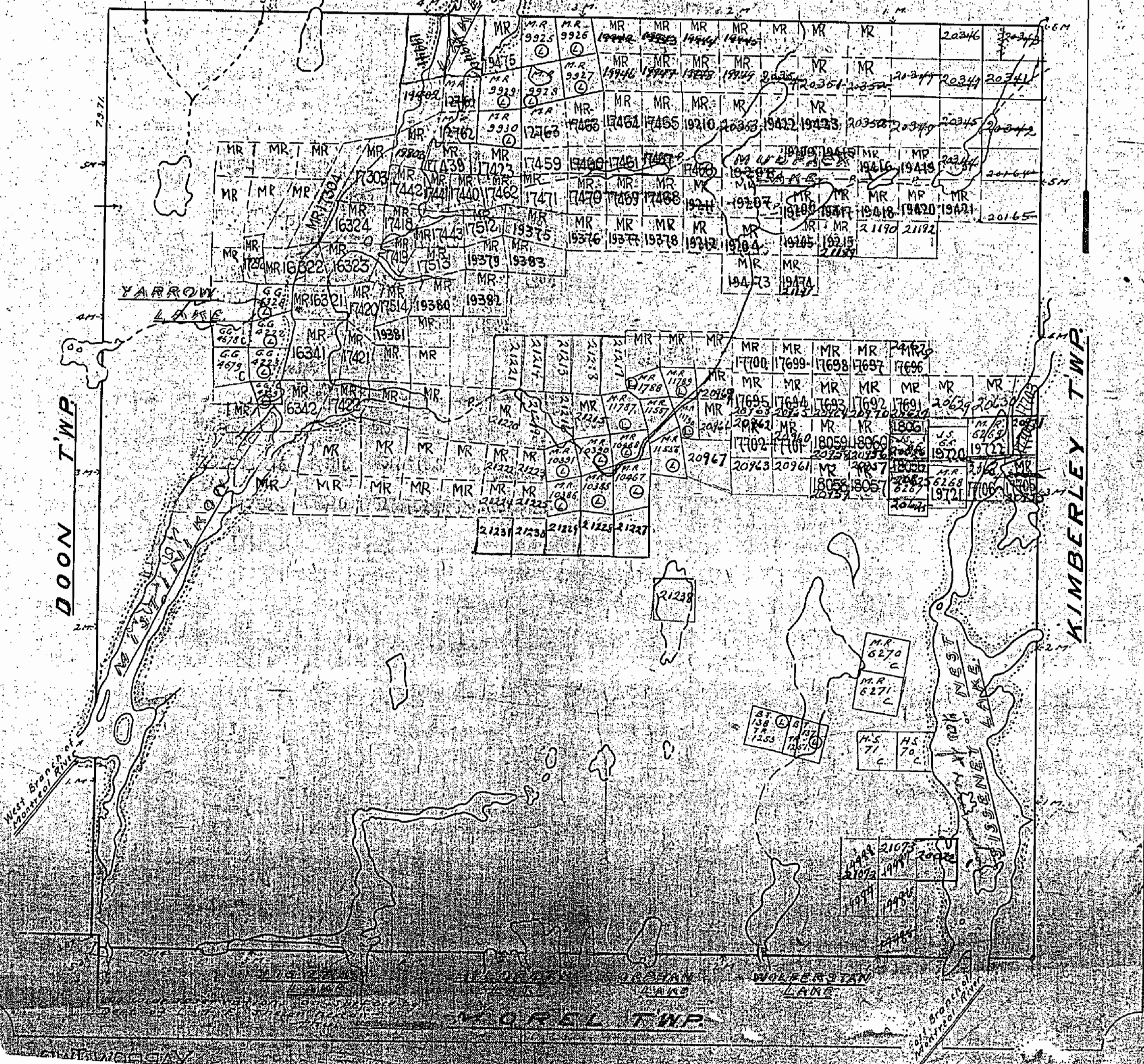

Powell Twp.

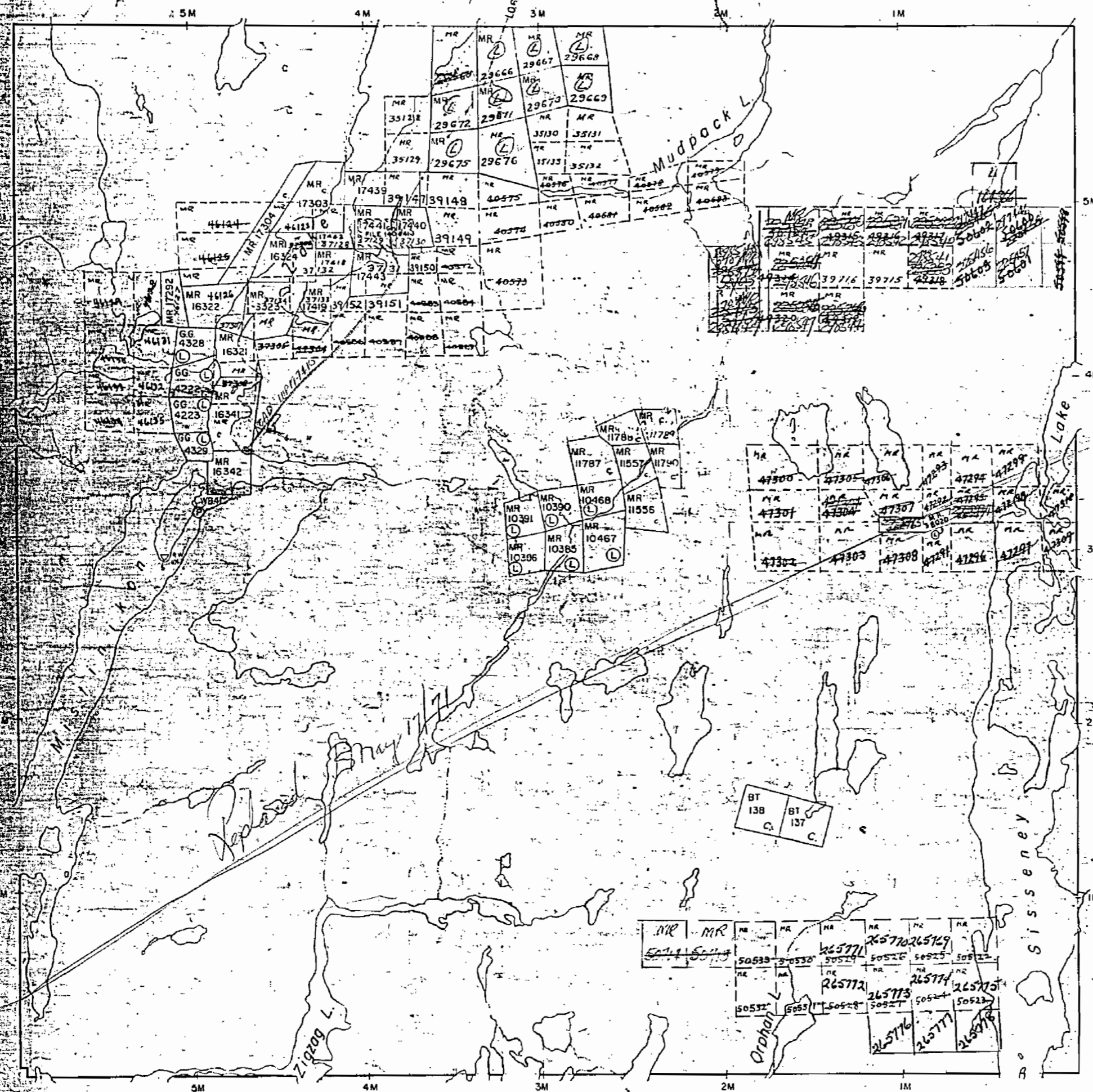

Morel Twp.

THE TOWNSHIP OF

YARROW

DISTRICT OF
TIMISKAMING

MONTREAL RIVER
MINING DIVISION

SCALE: 1-INCH=40 CHAINS

LEGEND

PATENTED LAND	Ⓟ
CROWN LAND SALE	C.S.
LEASES	Ⓞ
LOCATED LAND	Loc.
LICENSE OF OCCUPATION	LO.
MINING RIGHTS ONLY	M.R.O.
SURFACE RIGHTS ONLY	S.R.O.
ROADS	—
IMPROVED ROADS	—
KING'S HIGHWAYS	—
RAILWAYS	—
POWER LINES	—
MARSH OR MUSKEG	—
MINES	Ⓧ
CANCELLED	C.

NOTES

CO. 7601 COVERS FLOODING RIGHTS IN THIS TWP
TO BELOW CONTOUR 87000 H.E.P.C. FILE 12290 VOL. 2

400' Surface rights-reservation around all lakes and
rivers.

MONTREAL RIVER
MINING DIV.
RECEIVED
SEP 23 1968
AM 7 8 9 10 11 12 1 2 3 4 5 6 PM

PLAN NO. M-260

DEPARTMENT OF MINES

— ONTARIO —

Powell Twp.

*Lease units 121 & 21
(400' R.R.)*

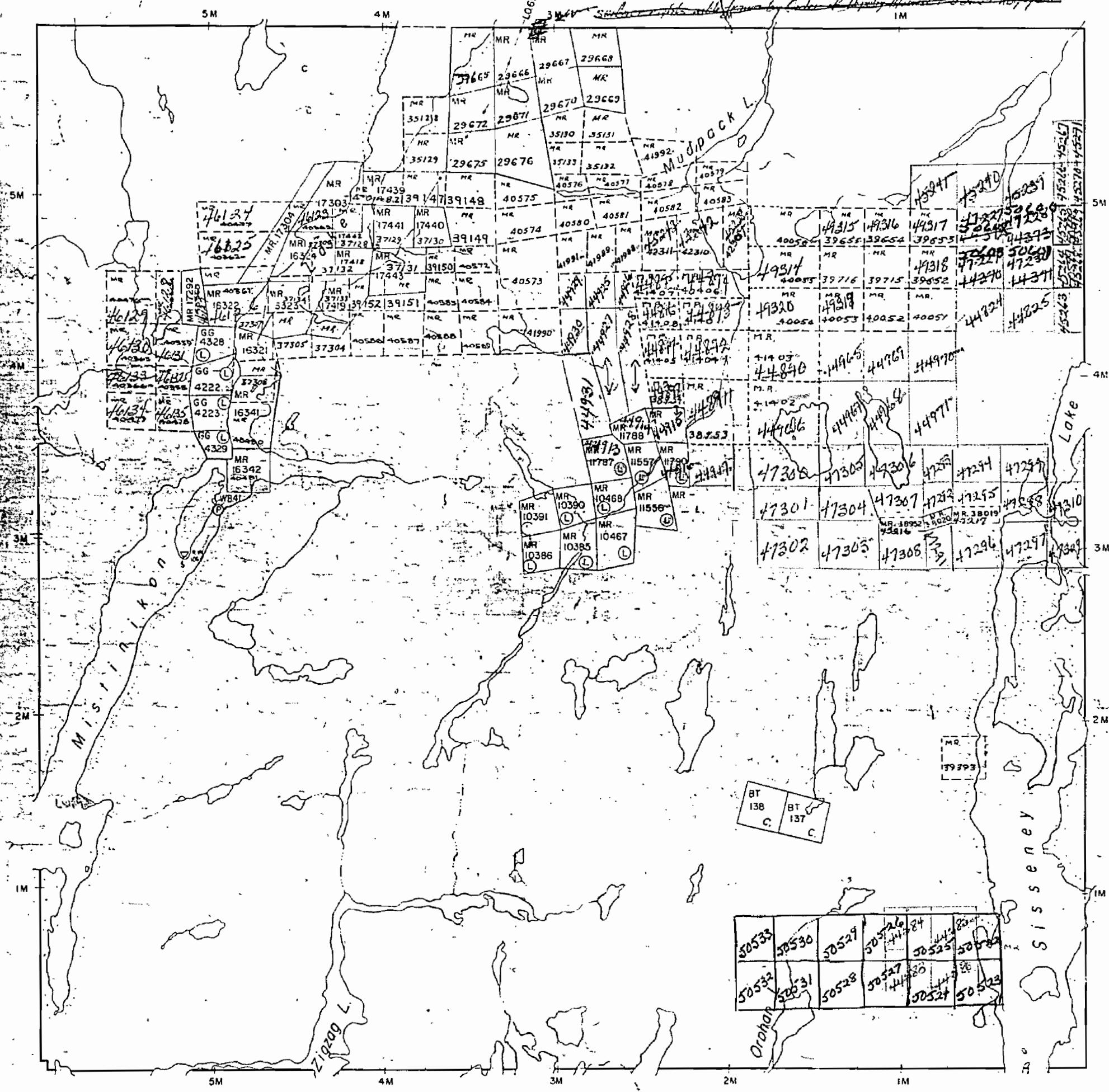

Deer Twp.

Kimberly Twp.

Morel Twp.

THE TOWNSHIP OF

YARROW

DISTRICT OF
TIMISKAMING

MONTREAL RIVER
MINING DIVISION

SCALE: 1-INCH=40 CHAINS

LEGEND

- PATENTED LAND Ⓟ
- CROWN LAND SALE C.S.
- LEASES Ⓛ
- LOCATED LAND Loc.
- LICENSE OF OCCUPATION L.O.
- MINING RIGHTS ONLY M.R.O.
- SURFACE RIGHTS ONLY S.R.O.
- ROADS —
- IMPROVED ROADS —
- KING'S HIGHWAYS —
- RAILWAYS —
- POWER LINES —
- MARSH OR MUSKEG —
- MINES —
- CANCELLED —

NOTES

LO 7601 COVERS FLOODING RIGHTS IN THIS TWP TO BELOW CONTOUR 870.00 HE.P.C.F. [L.E. 12290 VOL. 2]

400' Surface rights reservation around all lakes and rivers.

MONTREAL RIVER
MINING DIV.
RECEIVED
JUL 12 1965
AM 7 8 9 10 11 12 1 2 3 4 5 6 PM

PLAN NO.- M-260

DEPARTMENT OF MINES

— ONTARIO —

Powell Twp.

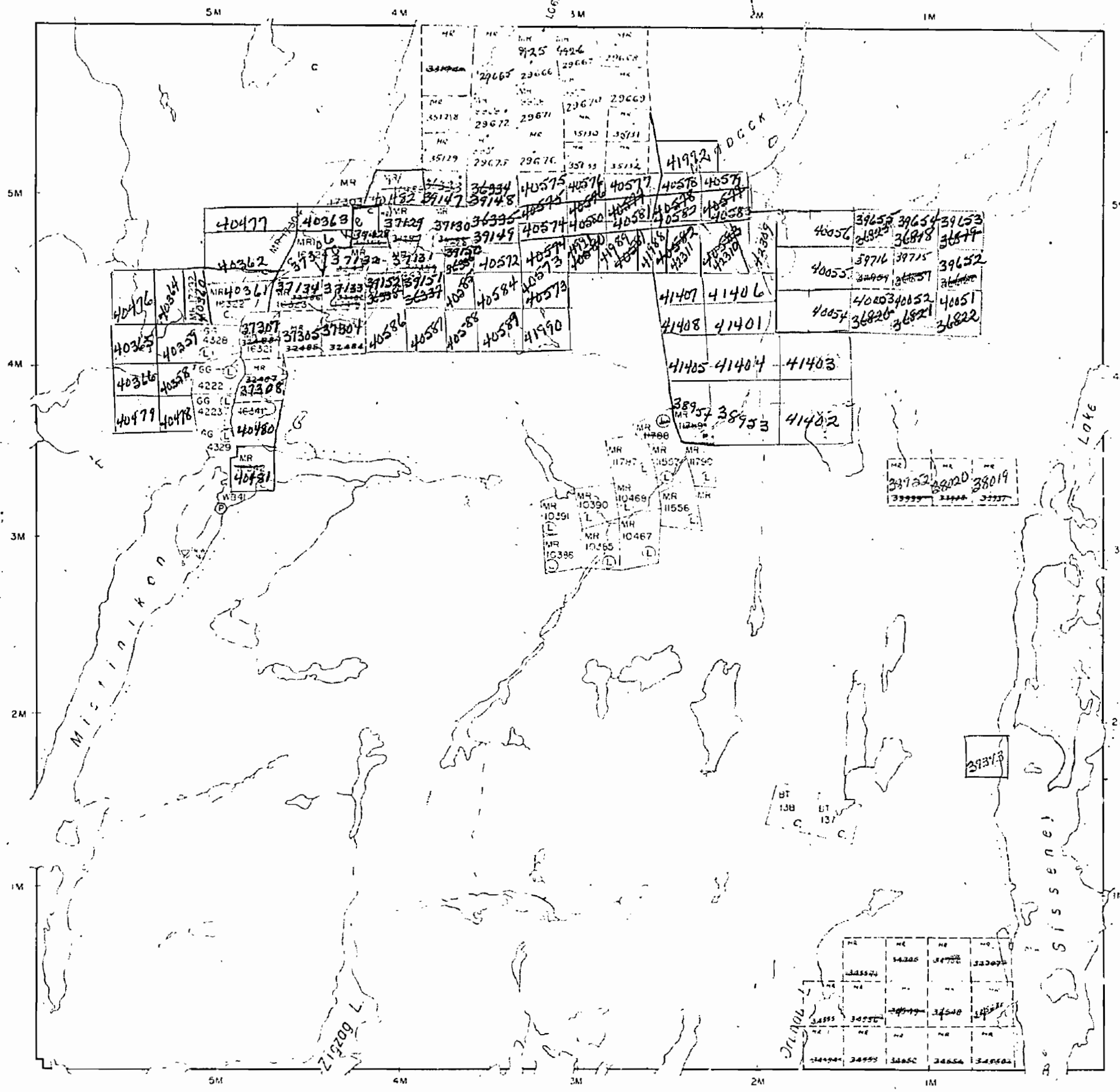

THE TOWNSHIP OF
OF
YARROW
DISTRICT OF
TIMISKAMING
MONTREAL RIVER
MINING DIVISION

SCALE: 1-INCH=40 CHAINS

LEGEND

- | | |
|-----------------------|--------|
| PATENTED LAND | Ⓟ |
| CROWN LAND SALE | C.S. |
| LEASES | Ⓛ |
| LOCATED LAND | Loc. |
| LICENSE OF OCCUPATION | L.O. |
| MINING RIGHTS ONLY | M.R.O. |
| SURFACE RIGHTS ONLY | S.R.O. |
| ROADS | — |
| IMPROVED ROADS | — |
| KING'S HIGHWAYS | — |
| RAILWAYS | — |
| POWER LINES | — |
| MARSH OR MUSKEG | — |
| MINES | X |
| CANCELLED | C. |

NOTES

LO 7601 COVERS FLOODING RIGHTS IN THIS TWP TO BELOW CONTOUR 870.00 H.E.P.C. FILL 12290 VOL. 2
400' Surface rights reservation around all lakes and rivers.



PLAN NO. M-260
DEPARTMENT OF MINES
— ONTARIO —

Doon Twp.

Kimberly Twp.

Morel Twp.

YARROW DISTRICT

Powell Twp.

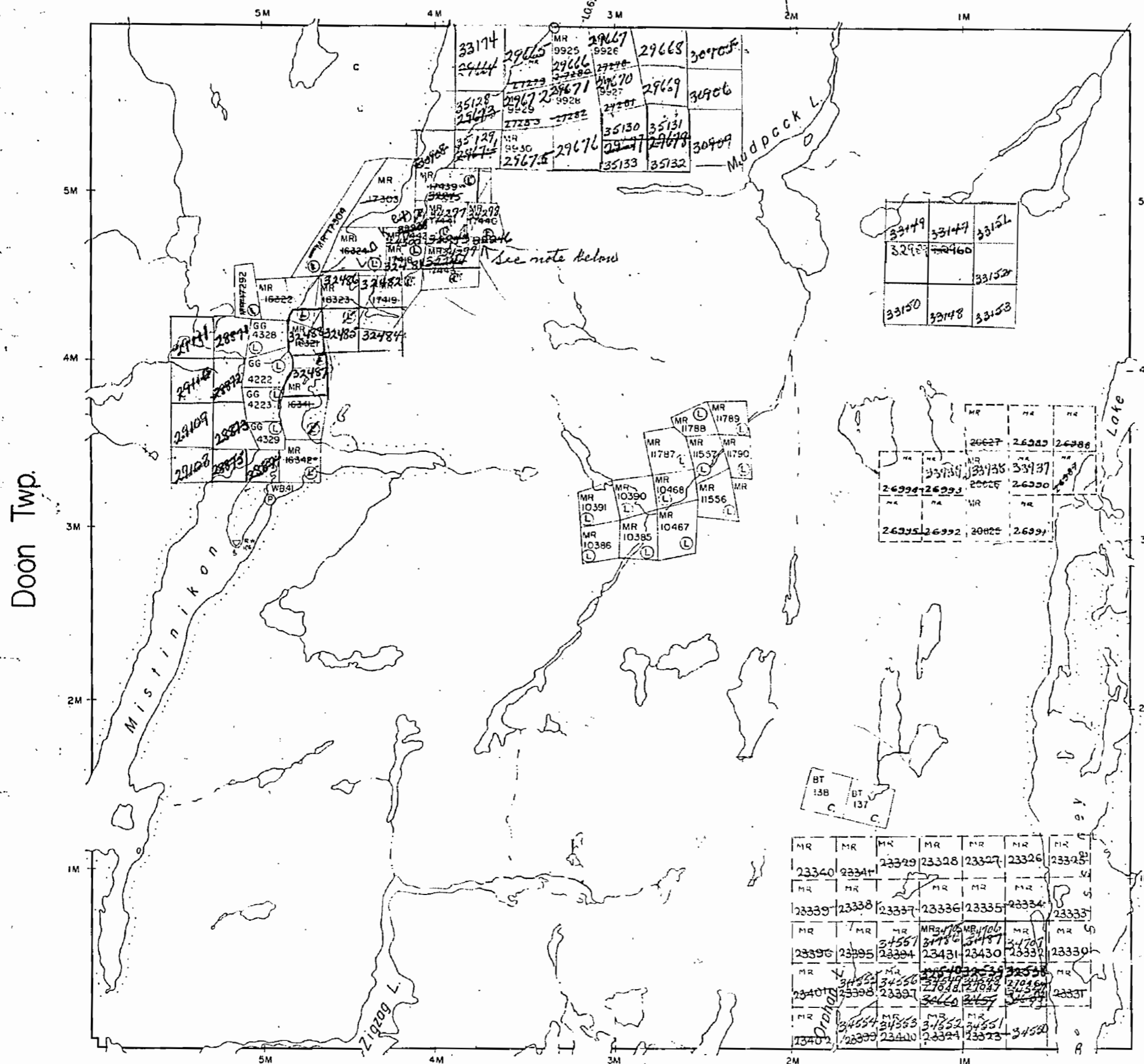

Doon Twp.

Kimberly Twp.

Morel Twp.

THE TOWNSHIP OF
OF

YARROW

DISTRICT OF
TIMISKAMING

MONTREAL RIVER
MINING DIVISION

SCALE: 1-INCH=40 CHAINS

LEGEND

- PATENTED LAND Ⓟ
- CROWN LAND SALE C.S.
- LEASES Ⓛ
- LOCATED LAND Loc.
- LICENSE OF OCCUPATION L.O.
- MINING RIGHTS ONLY M.R.O.
- SURFACE RIGHTS ONLY S.R.O.
- ROADS — — — — —
- IMPROVED ROADS — — — — —
- KING'S HIGHWAYS — — — — —
- RAILWAYS — — — — —
- POWER LINES — — — — —
- MARSH OR MUSKEG — — — — —
- MINES X
- CANCELLED C.

NOTES

Flooding Ris. L.O. 1004 File: 90972
H.E.P.C. of Ontario

400' Reserve to Dept. of Lands & Forests
shown thus: — — — — —

*Buildings on MR 17439 to 43 inc.
to be reserved to Crown (when
leases cancelled)*

PLAN NO. M-260

DEPARTMENT OF MINES
— ONTARIO —

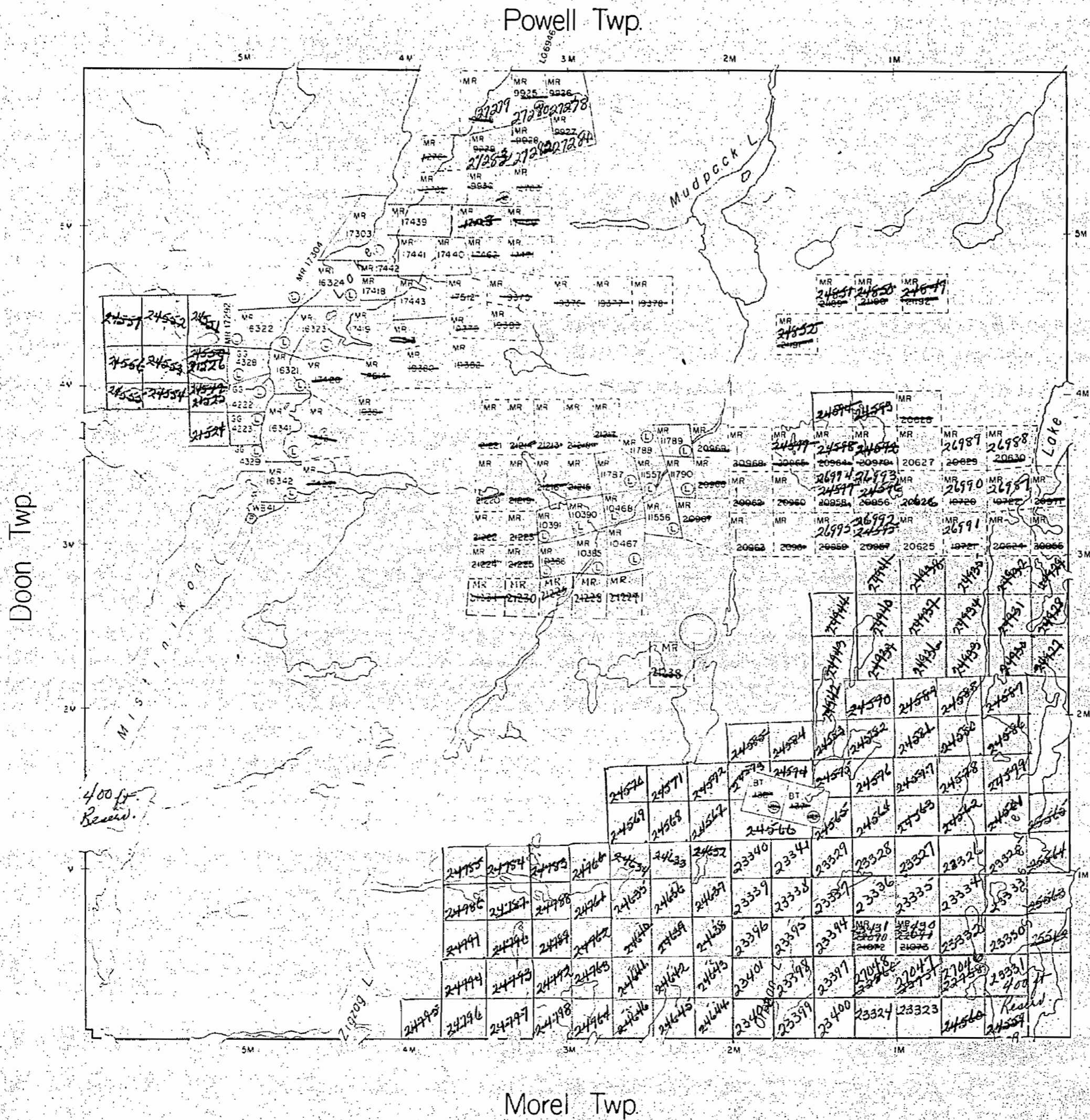

THE TOWNSHIP OF
YARROW

DISTRICT OF
TIMISKAMING

MONTREAL RIVER
MINING DIVISION

SCALE: 1-INCH=40 CHAINS

LEGEND

- PATENTED LAND Ⓢ
- CROWN LAND SALE C.S.
- LEASES Ⓞ
- LOCATED LAND Loc.
- LICENSE OF OCCUPATION L.O.
- MINING RIGHTS ONLY M.R.O.
- SURFACE RIGHTS ONLY S.R.O.
- ROADS —
- IMPROVED ROADS —
- KING'S HIGHWAYS —
- RAILWAYS —
- POWER LINES —
- MARSH OR MUSKEG —
- MINES Ⓜ
- CANCELLED C.

NOTES

Flooding Rts. L.O. 1004 File: 90972
H.E.P.C. of Ontario
400' Reserve to Dept. of Lands & Forests
shown thus:

PLAN NO. - ~~MR 59~~ M 260

DEPARTMENT OF MINES
— ONTARIO —