

ORDER

SECTION 35, THE MINING ACT, R.S.O. 1990

ORDER NO. O-P-94/20

The SURFACE RIGHTS and MINING RIGHTS of the areas outlined in red on the attached sketch, situated in the Township of Lennox, Porcupine Mining Division, were withdrawn from prospecting, mining claim registration, sale and lease by Order W-P-88/20.

Withdrawal Order W-P-88/20 is hereby revoked and the lands are reopened for prospecting, mining claim registration, sale and lease, unless the lands are otherwise not open for these activities under any other provision of the Mining Act.

This order comes into effect on November 18, 2020 at 10:00 a.m. eastern standard time or eastern daylight saving time, as the case may be.

Originally signed by Robert Cormier
Robert Cormier, A Provincial Mining Recorder
Mining Lands Section
Mines and Minerals Division

Copies:
Senior Manager, Mining Lands Section, ENDM, Sudbury
Provincial Mining Recorder, ENDM, Sudbury
Provincial Lands Specialist - CLR

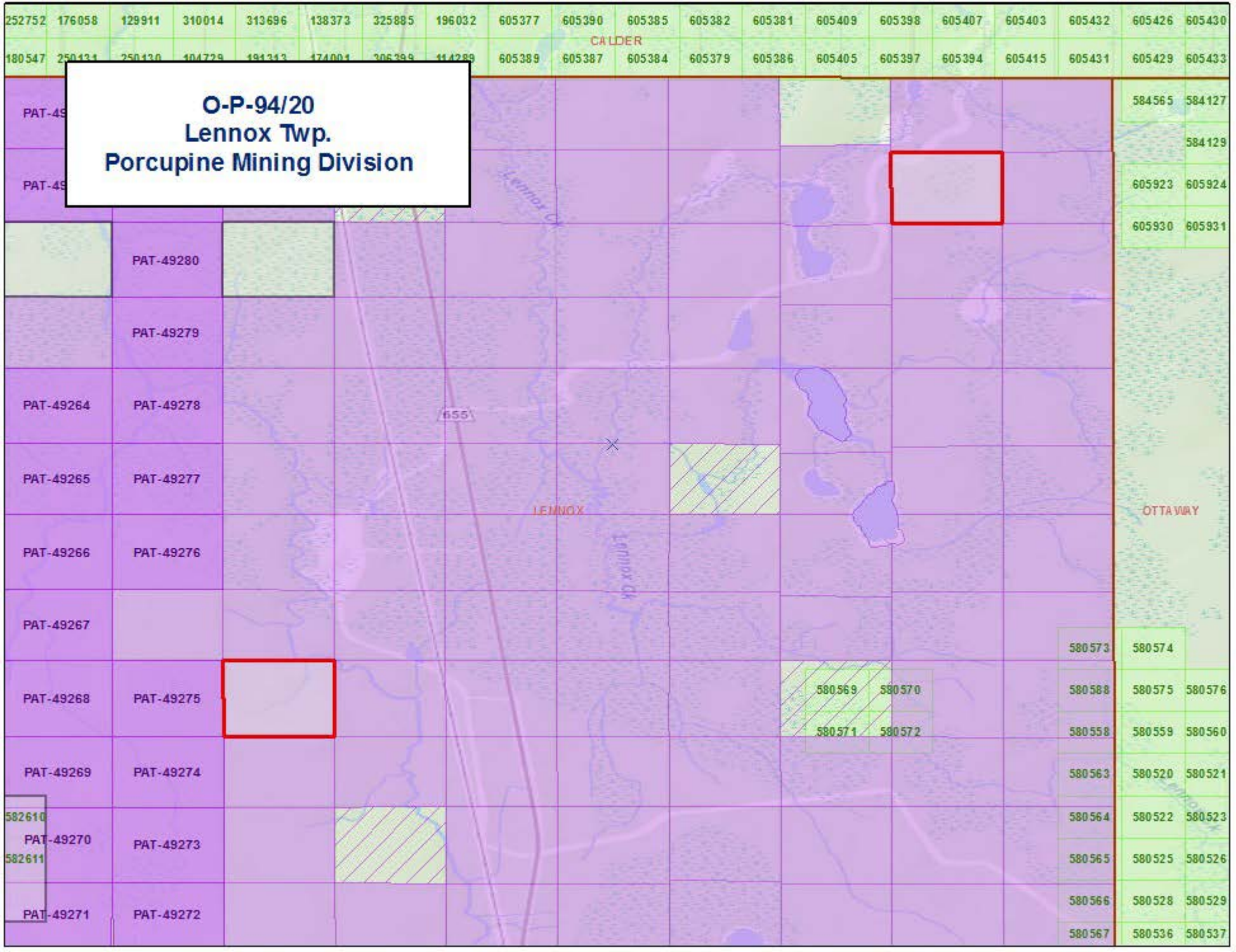

O-P-94/20
Lennox Twp.
Porcupine Mining Division

252752	176058	129911	310014	313696	138373	325885	196032	605377	605390	605385	605382	605381	605409	605398	605407	605403	605432	605426	605430
180547	250131	250130	104729	191313	174001	306399	114259	605389	605387	605384	605379	605386	605405	605397	605394	605415	605431	605429	605433

584565	584127
	584129
605923	605924
605930	605931

PAT-49280	
PAT-49279	
PAT-49264	PAT-49278
PAT-49265	PAT-49277
PAT-49266	PAT-49276
PAT-49267	
PAT-49268	PAT-49275
PAT-49269	PAT-49274
582610 PAT-49270	PAT-49273
582611	
PAT-49271	PAT-49272

580569	580570
580571	580572

580573	580574	
580588	580575	580576
580558	580559	580560
580563	580520	580521
580564	580522	580523
580565	580525	580526
580566	580528	580529
580567	580536	580537

OTTAWA

LENNOX

655

Lennox Cr.

