

ORDER

SECTION 35, THE MINING ACT, R.S.O. 1990

ORDER NO. W-L-18/15

The SURFACE RIGHTS and MINING RIGHTS of the area outlined in red on the attached sketch, situated in the Township of Arnold, in the Larder Lake Mining Division, containing 208 hectares more or less, are hereby WITHDRAWN from prospecting, staking out, sale or lease.

This area is WITHDRAWN while the Ministry determines the status of the lands.

Saving, excepting and reserving hereto and herefrom, all other lands patented, sold, leased or otherwise alienated by the Crown at the date of this Order.

Any alienated lands lying within the limits of this withdrawn area that revert to the Crown subsequent to the date of this Order will automatically be considered to be withdrawn as part of this Order.

This order comes into effect upon signing.

Date: March 25/15

Time: 4:45 P.M.

ORIGINAL SIGNED BY "BRIAN LAINE"
for Tony Scarr, Provincial Mining Recorder
Mining Lands Section
Mines and Minerals Division

Copies:

Senior Manager, Mining Lands Section, MNDM, Sudbury
Provincial Mining Recorder, MNDM, Sudbury
Provincial Lands Specialist – CLR

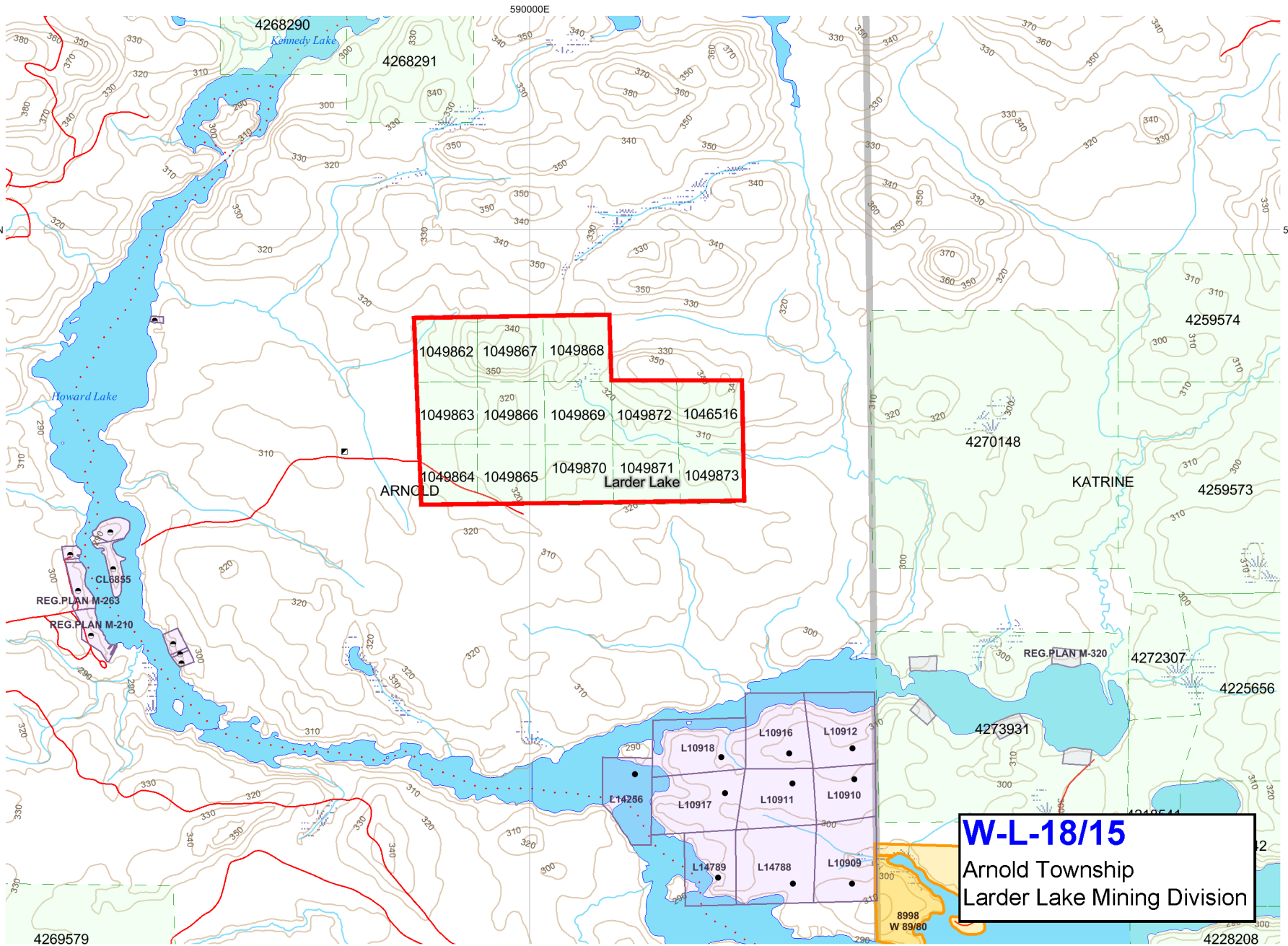

1049862	1049867	1049868			
1049863	1049866	1049869	1049872	1046516	
1049864	1049865	1049870	1049871	1049873	

W-L-18/15
 Arnold Township
 Larder Lake Mining Division