

ORDER

SECTION 35, THE MINING ACT, R.S.O. 1990

ORDER NO. W-L-75/07

The MINING RIGHTS of the area outlined in red on the attached sketch, being patented claims L32137, L32897 and L32898, situated in Melba Township (G-3216), Larder Lake Mining Division, containing 40.92 hectares, more or less, are hereby WITHDRAWN from prospecting, staking out, sale or lease in accordance with the terms of this Order.

This area is WITHDRAWN while the Ministry considers an application to annul the forfeiture of the mining rights.

Saving, excepting and reserving hereto and herefrom, all other lands patented, sold, leased or otherwise alienated by the Crown at the date of this Order.

Any alienated lands lying within the limits of this withdrawn area that revert to the Crown subsequent to the date of this order will automatically be considered to be withdrawn as part of this order.

This order comes into effect upon signing.

Date: Oct. 10, 2007

Originally Signed by "Roy Denomme"

Roy Denomme A/Sr. Manager

Mining Lands Section

Time: 3:01 p.m.

Mines and Minerals Division

Copies:

Senior Manager, Mining Lands Section, Sudbury, MNM

Provincial Mining Recorder, MNM, Sudbury

MNR File (Peterborough): 195150

MLC – Larder Lake/Kirkland Lake

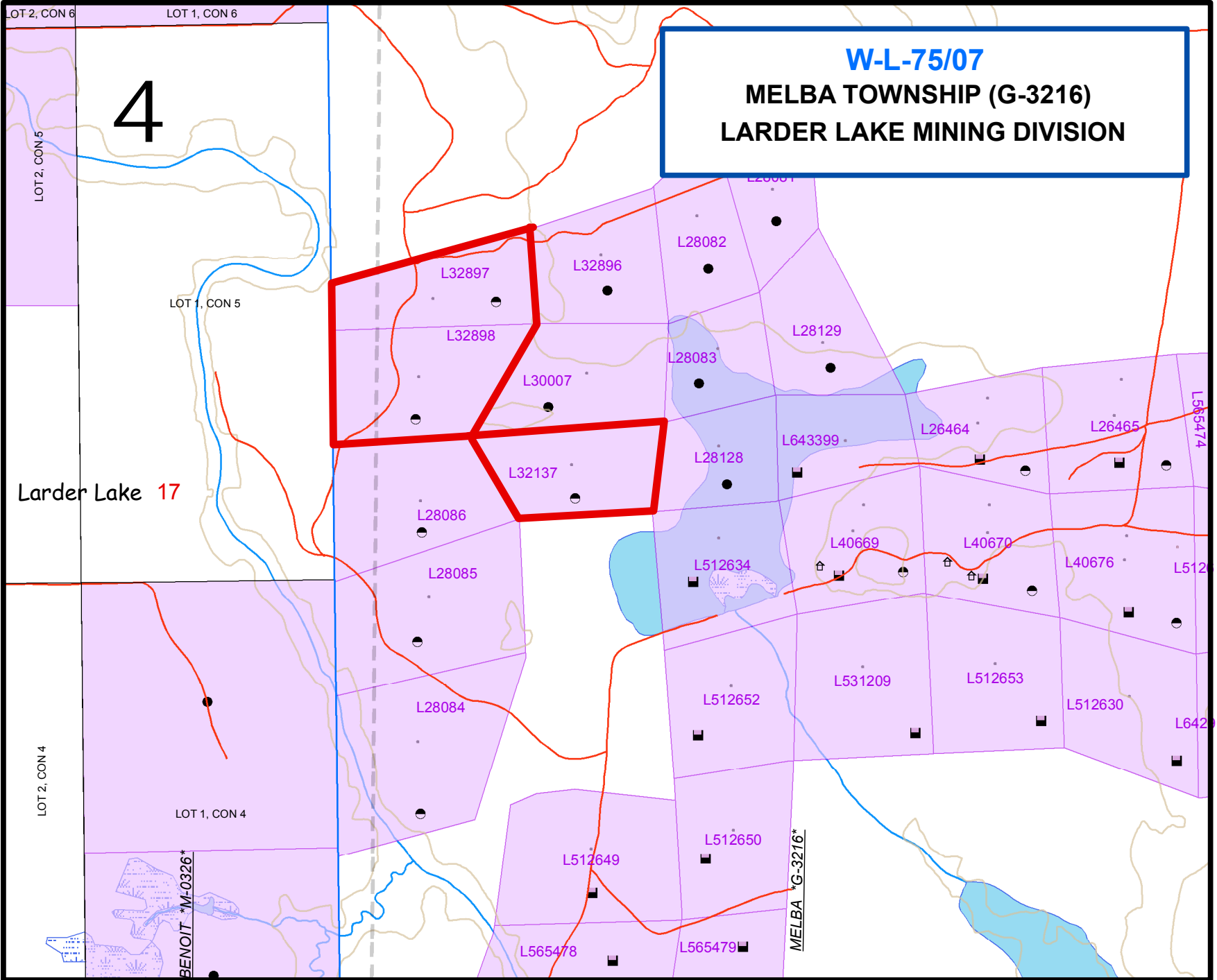

W-L-75/07
MELBA TOWNSHIP (G-3216)
LARDER LAKE MINING DIVISION

4

Larder Lake 17

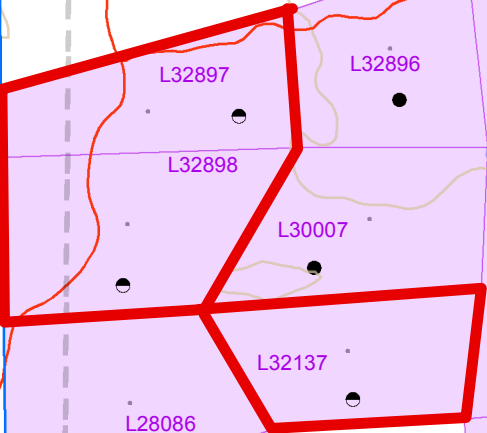

L32897

L32896

L28082

L32898

L28129

L30007

L28083

L32137

L28128

L643399

L26464

L26465

L28086

L40669

L40670

L28085

L512634

L40676

L28084

L512652

L531209

L512653

L512630

L512649

L512650

L6420

L565478

L565479

MELBA *G-3216*

BENOIT *M-0326*

LOT 2, CON 6

LOT 1, CON 6

LOT 2, CON 5

LOT 1, CON 5

LOT 2, CON 4

LOT 1, CON 4

L565474