



ORDER

SECTION 35, THE MINING ACT, R.S.O. 1990

ORDER NO. W-P-01/19

The MINING RIGHTS of the area outlined in red on the attached sketch, situated in Templeton Township, in the Porcupine Mining Division, containing 378.5 hectares, more or less, are hereby WITHDRAWN from prospecting, registering, sale or lease.

These areas are WITHDRAWN while the Ministry of Energy, Northern Development and Mines review the lands.

Saving, excepting and reserving hereto and herefrom, all other lands patented, sold, leased or otherwise alienated by the Crown at the date of this Order.

Any alienated lands lying within the limits of this withdrawn area that revert to the Crown subsequent to the date of this Order will automatically be considered to be withdrawn as part of this Order.

This order comes into effect upon signing.

Date: January 2, 2019

Time: 12:19pm

Original signed by Patrick Brown

Patrick Brown, A/Provincial Mining
Recorder

Mines and Minerals Division

Copies:

Senior Manager, Mining Lands Section, MENDM, Sudbury

Provincial Mining Recorder, MENDM, Sudbury

Provincial Lands Specialist – CLR

W-P-01/19

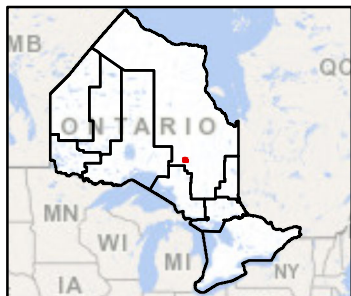

Legend

- W-P-01/19
- ~ Rivers / Streams
- Waterbodies
- Provincial Boundary
- MENDM Mining Divisions
- MENDM Lots Cons
- MENDM Administrative Boundaries
- Native Reserves
- Aggregate Site - Authorized**
- Pit
- Quarry
- Both (Pit and Quarry)
- Underwater
- Aggregate Site - Authorized (Inactive)
- Aggregates Site - MTO
- Parks and Protected Areas**
- Provincial Park
- Protected Area - Far North
- Conservation Reserve
- Operational Alienations**
- Withdrawal
- Notice
- Operational Cell Claims**
- Single Cell Mining Claim
- Multi Cell Mining Claim
- Boundary Cell Mining Claim



MAP SCALE: 1:88,226

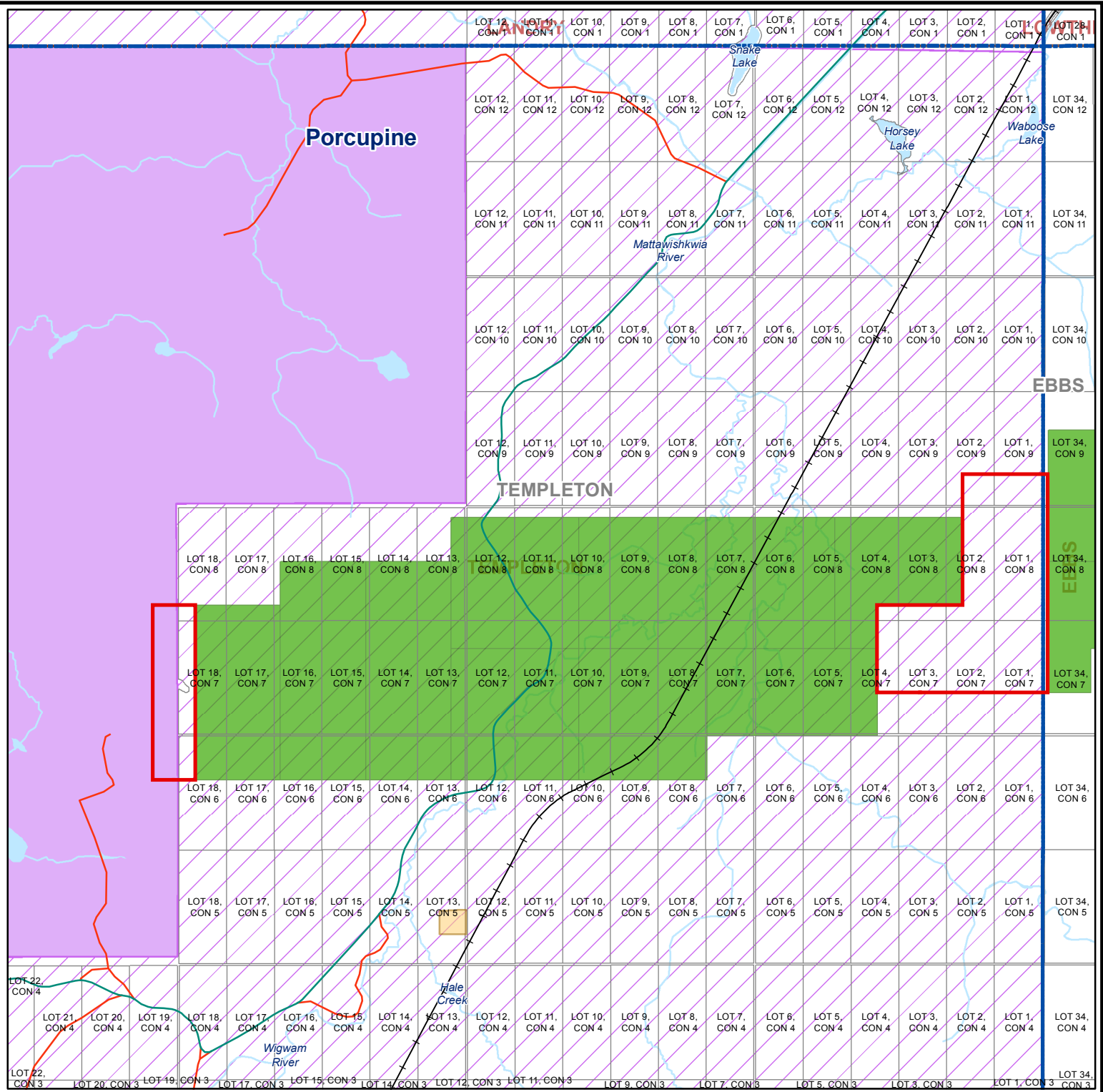
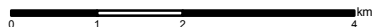

Those wishing to stake mining claims should consult with the Provincial Mining Recorders' Office of the Ministry of Energy, Northern Development and Mines for additional information on the status of the lands shown hereon. This map is not intended for navigational, survey, or land title determination purposes as the information shown on this map is compiled from various sources. Completeness and accuracy are not guaranteed. Additional information may also be obtained from the local Land Titles and Registry Office, or the Ministry of Natural Resources and Forestry.

This map may not show unregistered land tenure and interests in land including certain patents, leases, easements, right of ways, flooding rights, licenses, or other forms of disposition of rights and interest from the Crown. Also, certain land tenure and land uses that restrict or prohibit free entry to access mining claims may not be illustrated.

Map Datum: NAD 83
Projection: Web Mercator
Topographic Data Source: Land Information Ontario
Mining Land Tenure Source: Provincial Mining Recorder's Office

Date: 01/02/2019