

**ORDER****SECTION 35, THE MINING ACT, R.S.O. 1990****ORDER NO. W-P-35/17**

The SURFACE RIGHTS and MINING RIGHTS of the area outlined in red on the attached sketch, being cancelled mining claim P 4275466, situated in the Township of Ogden (G-3979), in the Porcupine Mining Division, containing 16 hectares more or less, are hereby WITHDRAWN from prospecting, staking out, sale or lease.

This area is WITHDRAWN as the Ministry determines the status of the lands.

Saving, excepting and reserving hereto and herefrom, all other lands patented, sold, leased or otherwise alienated by the Crown at the date of this Order.

Any alienated lands lying within the limits of this withdrawn area that revert to the Crown subsequent to the date of this Order will automatically be considered to be withdrawn as part of this Order.

This order comes into effect upon signing.

Date: JUN 21 2017

Time: 1:41 p.m.

ORIGINAL SIGNED BY TONY SCARR

Tony Scarr, Provincial Mining Recorder  
Mines and Minerals Division

Copies:

Senior Manager, Mining Lands Section, MNDM, Sudbury

Provincial Mining Recorder, MNDM, Sudbury

Provincial Lands Specialist – CLR

**W-P 35/17**  
**Ogden Township (G-3979)**  
**Porcupine Mining Division**

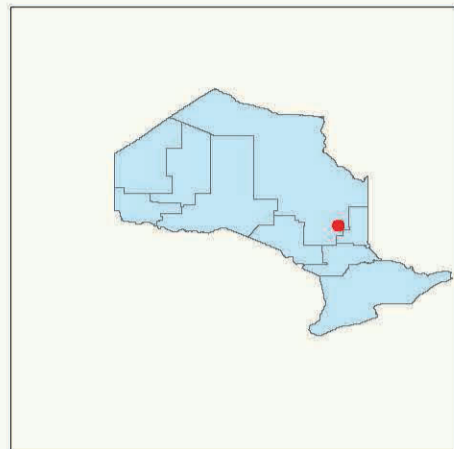

**Base Features**

- Area to be Withdrawn
- Tower
- Work Camp
- Utility Site
- MNDM Administrative Boundaries
- Lot Fabric Improved

**Utility Line - Hydro Line**

- Transmission Line  
Ligne de transmission
- Pipeline  
Pipeline

**Road Segment**

- Other Existing Roads  
Autres routes actuelles
- Primary  
Route principale
- Highway  
Autoroute
- Trail Segment
- Railway Segment

**Airports**

- Airports
- Airport Airstrip
- Airport Official

**Federal Protected Area**

- Federal Protected Area
- Federal Land Other
- Indian Reserve

**Waterbodies**

- River / Stream
- Waterbody

**Provincial Park Regulated**

- Provincial Park Regulated
- Conservation Reserve Regulated

**Mining Lands Features**

- Area to be Withdrawn

**Dispositions Symbols**

- Freehold Patent, S+M
- Freehold Patent, SRO
- Freehold Patent, MRO
- Leasehold Patent, S+M
- Leasehold Patent, SRO
- Leasehold Patent, MRO
- Licence of Occupation, S+M
- Licence of Occupation, SRO
- Licence of Occupation, MRO
- Licence of Occupation, not specified
- Tower
- Camp
- Unknown

**Order in Council**

- OIC Order in Council
- LUP Land Use Permit
- WPLA WPLA

**MNDM Alienations**

- Active, Withdrawal
- Active, Notice
- Cancelled, Withdrawal
- Cancelled, Notice

**MNDM Mining Claims**

- Active
- Cancelled
- Pending

**MNDM Dispositions**

- Active
- Cancelled

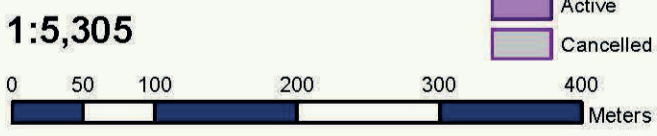
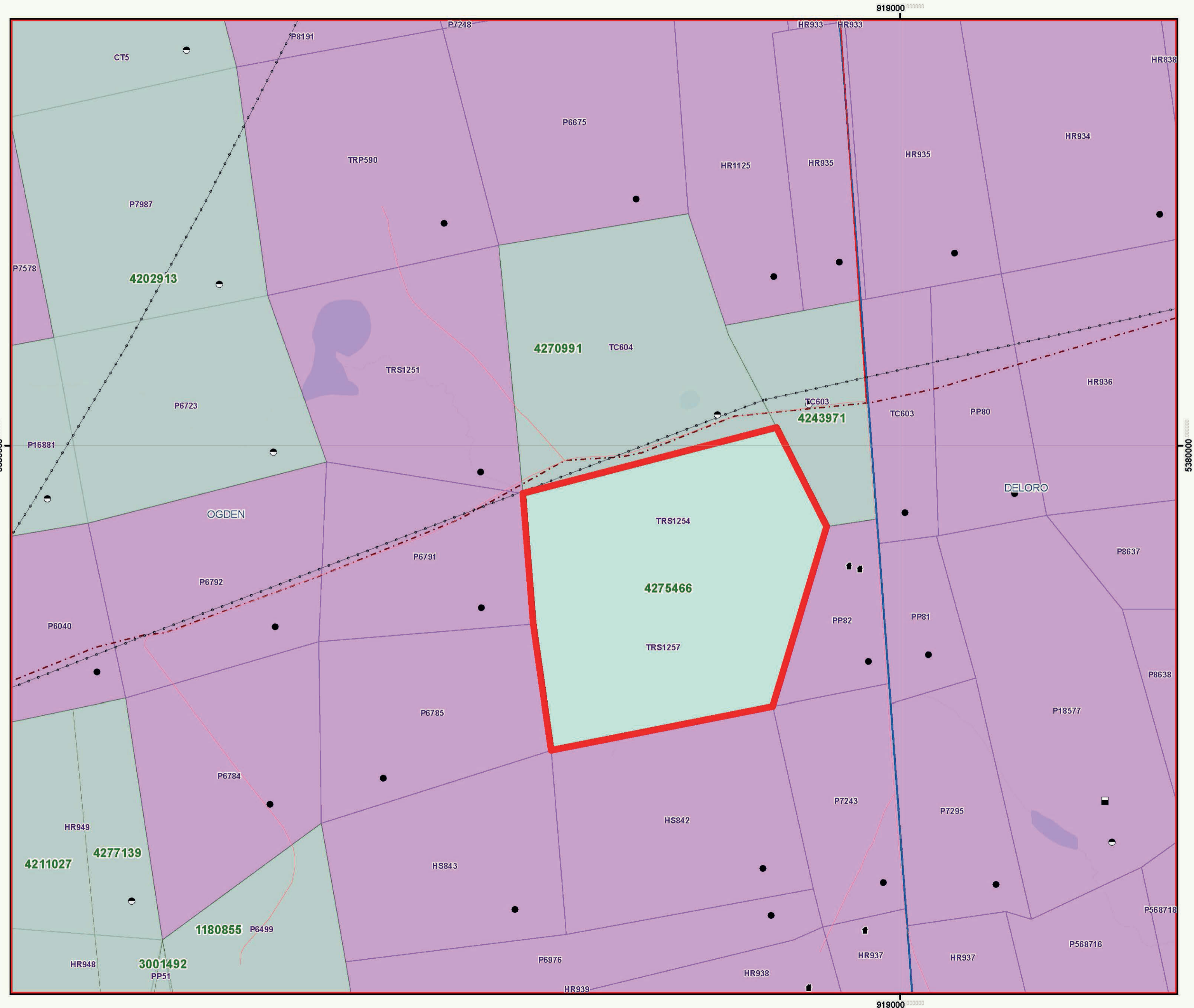

This map should not be relied on as a precise indicator of routes or locations, nor as a guide to navigation. The Ontario Ministry of Natural Resources (OMNR) shall not be liable in any way for the use of, or reliance upon, this map or any information on this map.  
 Il ne faut pas présumer que cette carte indique précisément les voies et les lieux, ni s'en servir comme guide à la navigation. Le ministère des Richesses naturelles de l'Ontario (MRN) n'assume aucune responsabilité quelle qu'elle soit relativement à l'utilisation de cette carte ou de la confiance qui serait mise en celle-ci.

