

O R D E R

SECTION 35, THE MINING ACT, R.S.O. 1990

ORDER NO. W-P-42/06

THE SURFACE AND MINING RIGHTS of the area outlined in red on the attached sketch, being the south half of Lot 3, Concession 3, in the Township of Chewett, in the Porcupine Mining Division, containing 64 hectares, more or less, are hereby withdrawn from prospecting, staking out, sale or lease.

This area is withdrawn to allow the Ministry of Transportation to evaluate the aggregate potential.

Saving, excepting and reserving hereto and herefrom, all other lands patented, sold, leased or otherwise alienated by the Crown at the date of this Order.

Any alienated lands lying within the limits of this withdrawn area that revert to the Crown subsequent to the date of this order will automatically be considered to be withdrawn as part of this order.

This order comes into effect upon signing.

Date: May 16/06

Original signed by "Ron C. Gashinski"

Time: 11:15 a.m.

Ron C. Gashinski, Senior Manager
Mining Lands Section
Mines and Minerals Division

Copies:

Senior Manager, Mining Lands Section, 6th Floor, Sudbury, MNDM

Provincial Mining Recorder, Sudbury, MNDM

Mining Lands Consultant Timmins
District Manager, Chapleau, Ontario, MNR

MNR File (Peterborough): 195150

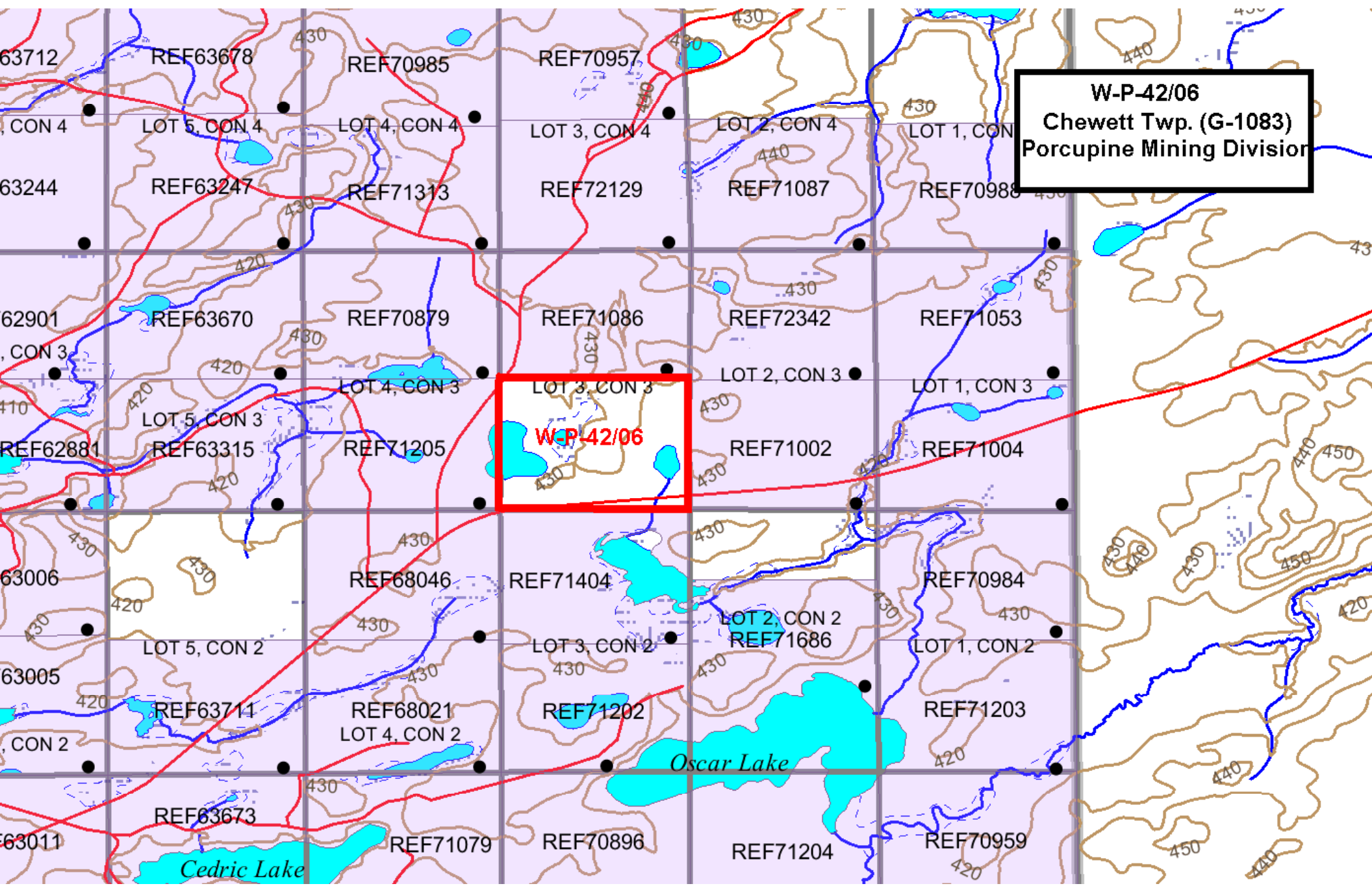

W-P-42/06
Chewett Twp. (G-1083)
Porcupine Mining Division

W-P-42/06