

ORDER

SECTION 35, THE MINING ACT, R.S.O. 1990

ORDER NO. W-P-42/18

The MINING RIGHTS of the area outlined in red on the attached sketch, situated in the Township of Hoyle (G-3987), Porcupine Mining Division, containing 66.0 hectares more or less, are hereby WITHDRAWN from prospecting, registering, sale or lease.

This area is WITHDRAWN while the Ministry reviews an application in accordance with Section 183(2) of the Mining Act.

Saving, excepting and reserving hereto and herefrom, all other lands patented, sold, leased or otherwise alienated by the Crown at the date of this Order.

Any alienated lands lying within the limits of these withdrawn areas that revert to the Crown subsequent to the date of this Order will automatically be considered to be withdrawn as part of this Order.

This order comes into effect upon signing.

Date: Wednesday, June 6, 2018

Time: 12:43 pm

Originally signed by Patrick Brown

Patrick Brown, A/Provincial Mining Recorder
Mines and Minerals Division

Copies:

Senior Manager, Mining Lands Section, MNDM, Sudbury
Provincial Mining Recorder, MNDM, Sudbury
Provincial Lands Specialist – CLR

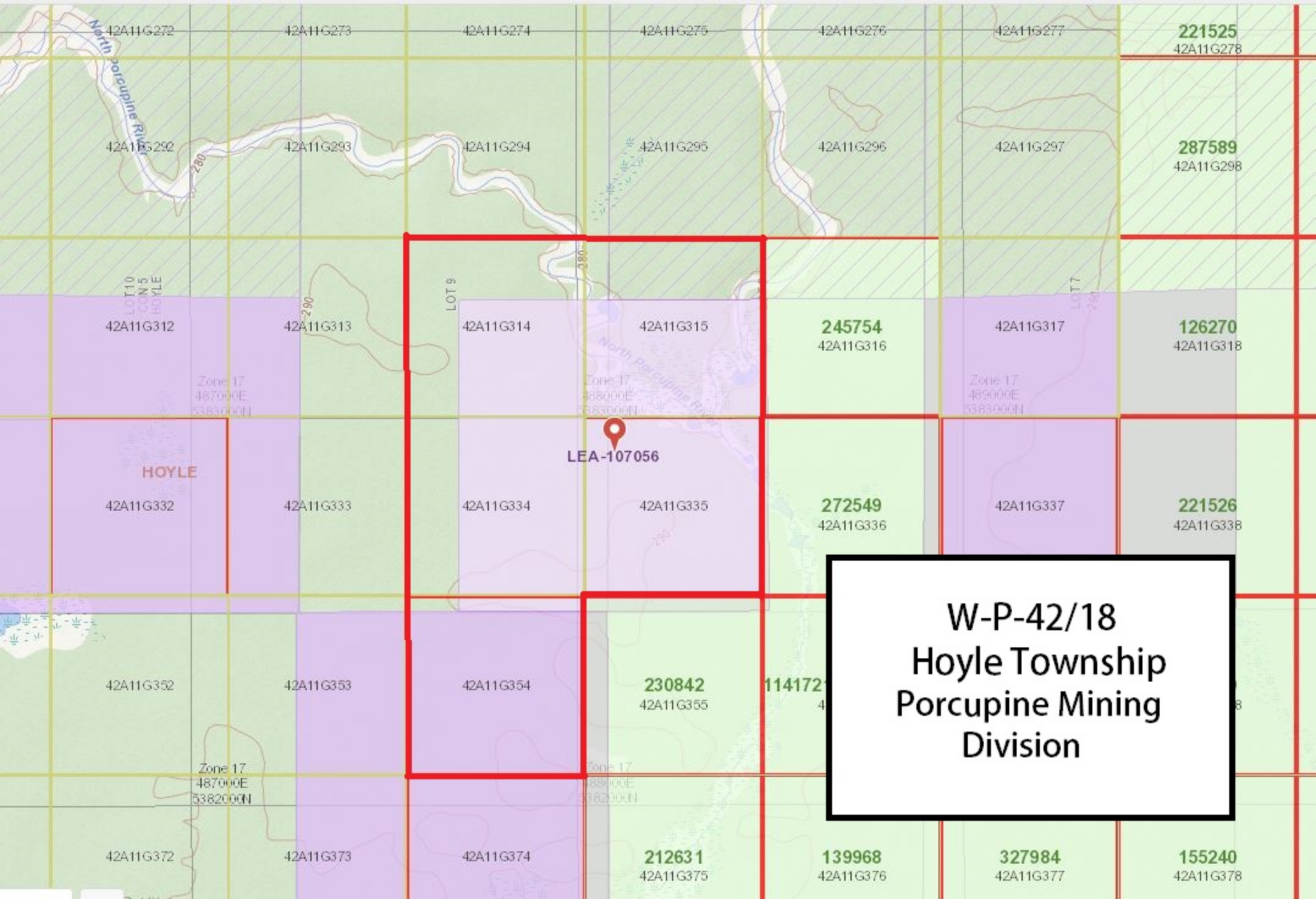

221525

42A11G278

287589

42A11G298

245754

42A11G316

126270

42A11G318

LEA-107056

272549

42A11G336

221526

42A11G338

W-P-42/18
Hoyle Township
Porcupine Mining
Division

230842

42A11G355

114172

42A11G354

212631

42A11G375

139968

42A11G376

327984

42A11G377

155240

42A11G378

42A11G272

42A11G273

42A11G274

42A11G275

42A11G276

42A11G277

42A11G292

42A11G293

42A11G294

42A11G295

42A11G296

42A11G297

42A11G312

42A11G313

42A11G314

42A11G315

42A11G332

42A11G333

42A11G334

42A11G335

42A11G352

42A11G353

42A11G354

42A11G372

42A11G373

42A11G374

Zone 17
487000E
5383000N

Zone 17
488000E
5383000N

Zone 17
489000E
5383000N

Zone 17
487000E
5382000N

Zone 17
488000E
5382000N

LOT 10

LOT 9

LOT 7

HOYLE

North Porcupine River