

ORDER**SECTION 35, THE MINING ACT, R.S.O. 1990****ORDER NO. W-P-46/16**

The SURFACE RIGHTS of the area outlined in red on the attached sketch, situated in Borden (G-1056) Township, in the Porcupine Mining Division, containing 1 hectare, more or less, is hereby WITHDRAWN from prospecting, staking out, sale or lease.

This area is WITHDRAWN for the Ministry of Natural Resources and Forestry for the purpose of a waste disposal site.

Saving, excepting and reserving hereto and herefrom, all other lands patented, sold, leased or otherwise alienated by the Crown at the date of this Order.

Any alienated lands lying within the limits of this withdrawn area that revert to the Crown subsequent to the date of this Order will automatically be considered to be withdrawn as part of this Order.

This order comes into effect upon signing.

Date: July 5/16

Time: 4:42 P.M.

Original Signed by Brian Laine

for Tony Scarr, Provincial Mining Recorder
Mines and Minerals Division

Copies:

Senior Manager, Mining Lands Section, MNDM, Sudbury
Provincial Mining Recorder, MNDM, Sudbury
Provincial Lands Specialist – CLR

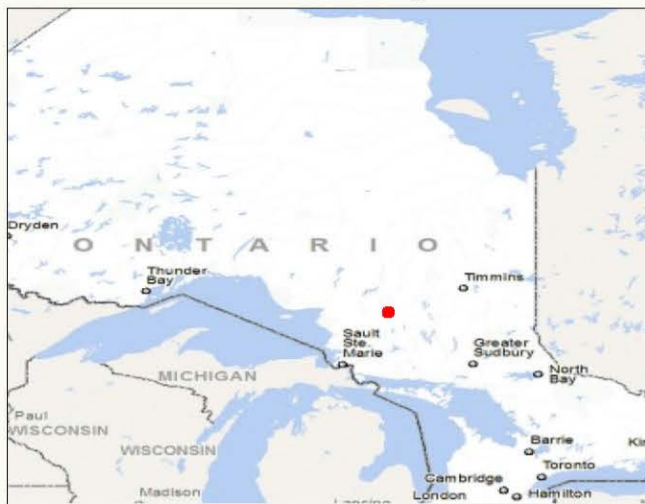

Base Features

- + Tower
- △ Work Camp
- ▽ Utility Site
- MNDM Administrative Boundaries
- Lot Fabric Improved
- Utility Line - Hydro Line
 - Transmission Line / Ligne de transmission
 - Pipeline / Pipeline
- Road Segment
 - Other Existing Roads / Autres routes actuelles
 - Primary / Route principale
 - Highway / Autoroute
 - Trail Segment
 - Railway Segment
- Airports
 - Airports
 - Airport Airstrip
 - Airport Official
- Federal Protected Area
 - Federal Protected Area
 - Federal Land Other
 - Indian Reserve
- Waterbodies
 - River / Stream
 - Waterbody
- Provincial Park Regulated
 - Provincial Park Regulated
 - Conservation Reserve Regulated

Mining Lands Features

- Mining_and_Surface_BordenWithdrawal2-2016-05-31

Dispositions Symbols

- Freehold Patent, S+M
- Freehold Patent, SRO
- ⊖ Freehold Patent, MRO
- Leasehold Patent, S+M
- ▣ Leasehold Patent, SRO
- ▤ Leasehold Patent, MRO
- ◆ Licence of Occupation, S+M
- ◇ Licence of Occupation, SRO
- ◇ Licence of Occupation, MRO
- ◇ Licence of Occupation, not specified
- + Tower
- △ Camp
- ? Unknown
- OIC Order in Council
- LUP Land Use Permit
- WPLA WPLA

MNDM Alienations

- Active, Withdrawal
- Active, Notice
- Cancelled, Withdrawal
- Cancelled, Notice

MNDM Mining Claims

- Active
- Cancelled
- Pending

MNDM Dispositions

- Active
- Cancelled

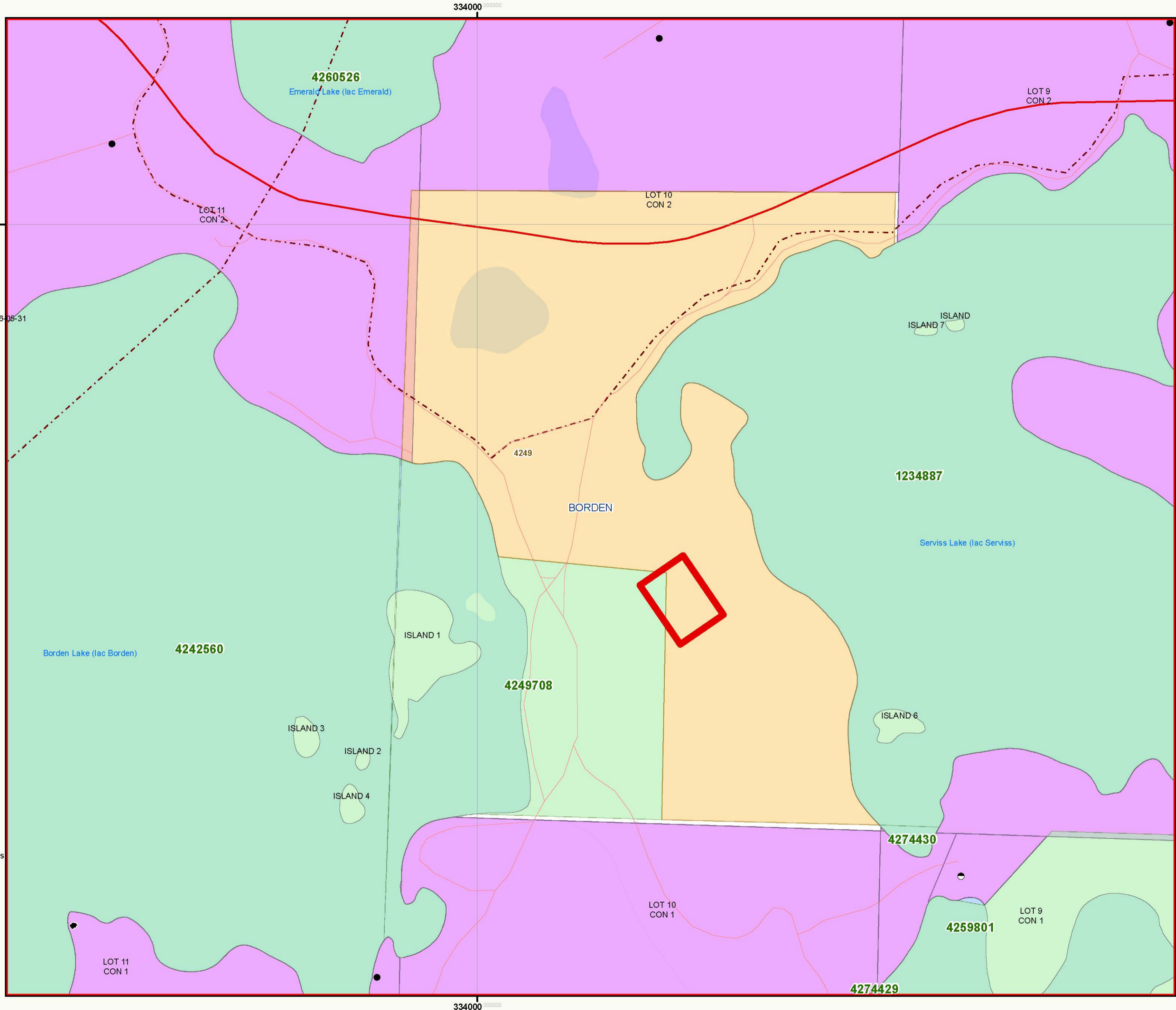

This map should not be relied on as a precise indicator of routes or locations, nor as a guide to navigation. The Ontario Ministry of Natural Resources (OMNR) shall not be liable in any way for the use of, or reliance upon, this map or any information on this map.

Il ne faut pas présumer que cette carte indique précisément les voies et les lieux, ni s'en servir comme guide à la navigation. Le ministère des Richesses naturelles de l'Ontario (MRN) n'assume aucune responsabilité quelle qu'elle soit relativement à l'utilisation de cette carte ou de la confiance qui serait mise en celle-ci.

© Queen's Printer for Ontario, <May 12, 2016>