

## ORDER

### SECTION 35, THE MINING ACT, R.S.O. 1990

#### ORDER NO. W-P-63/11

The MINING RIGHTS of the area outlined in red on the attached sketch, being the N1/2 of Lot 2 Con3 Beck Township, N1/2 of Lot 3 Con 3 Lucas Township, S1/2 Lot 7 Con 4 Lucas Township, S1/2 Lot 7 Con 6 Lucas Township, S1/2 Lot 6 Con 4 Lucas Township situated in the Townships of Beck (M-0413) and Lucas (G-3534) , in the Porcupine Mining Division, containing 310 hectares more or less, are hereby WITHDRAWN from prospecting, staking out, sale or lease.

This area is WITHDRAWN while the Ministry reviews the status of the land.

Saving, excepting and reserving hereto and herefrom, all other lands patented, sold, leased or otherwise alienated by the Crown at the date of this Order.

Any alienated lands lying within the limits of this withdrawn area that revert to the Crown subsequent to the date of this Order will automatically be considered to be withdrawn as part of this Order.

This order comes into effect upon signing.

Date: May 11/11

Time: 3:44 p.m.

ORIGINAL SIGNED BY "LISETTE PRUDHOMME"  
Lisette Prudhomme, A/Provincial Mining Recorder  
Mining Lands Section  
Mines and Minerals Division

Copies:

Senior Manager, Mining Lands Section, MNDMF, Sudbury

Provincial Mining Recorder, MNDMF, Sudbury

Provincial Lands Specialist - CLR

RLUG – NE Region

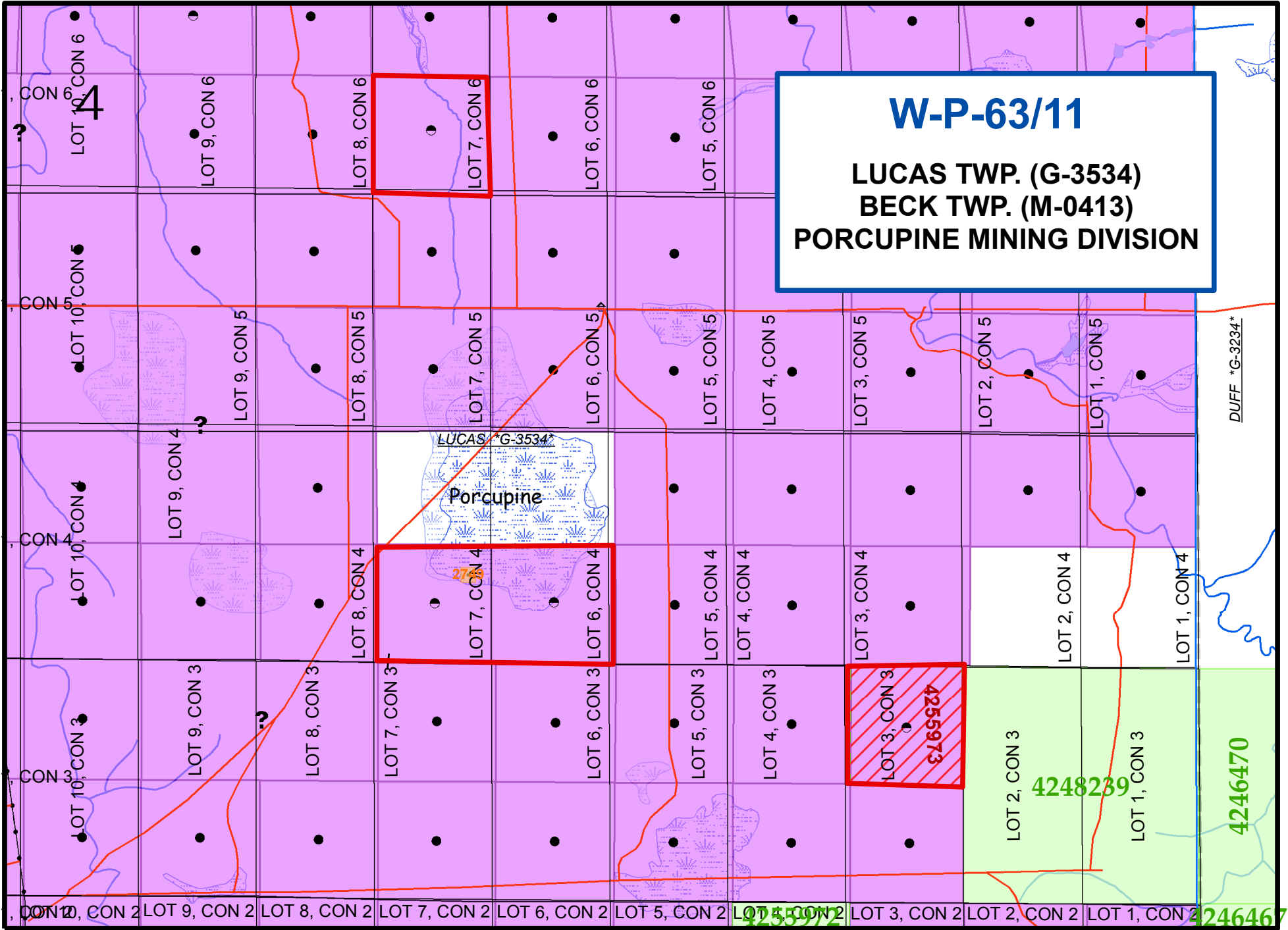

**W-P-63/11**  
**LUCAS TWP. (G-3534)**  
**BECK TWP. (M-0413)**  
**PORCUPINE MINING DIVISION**

LUCAS TWP. (G-3534)

Porcupine

27

4255973

4248239

4246470

4255972

4246467

DUFF \*G-3234\*

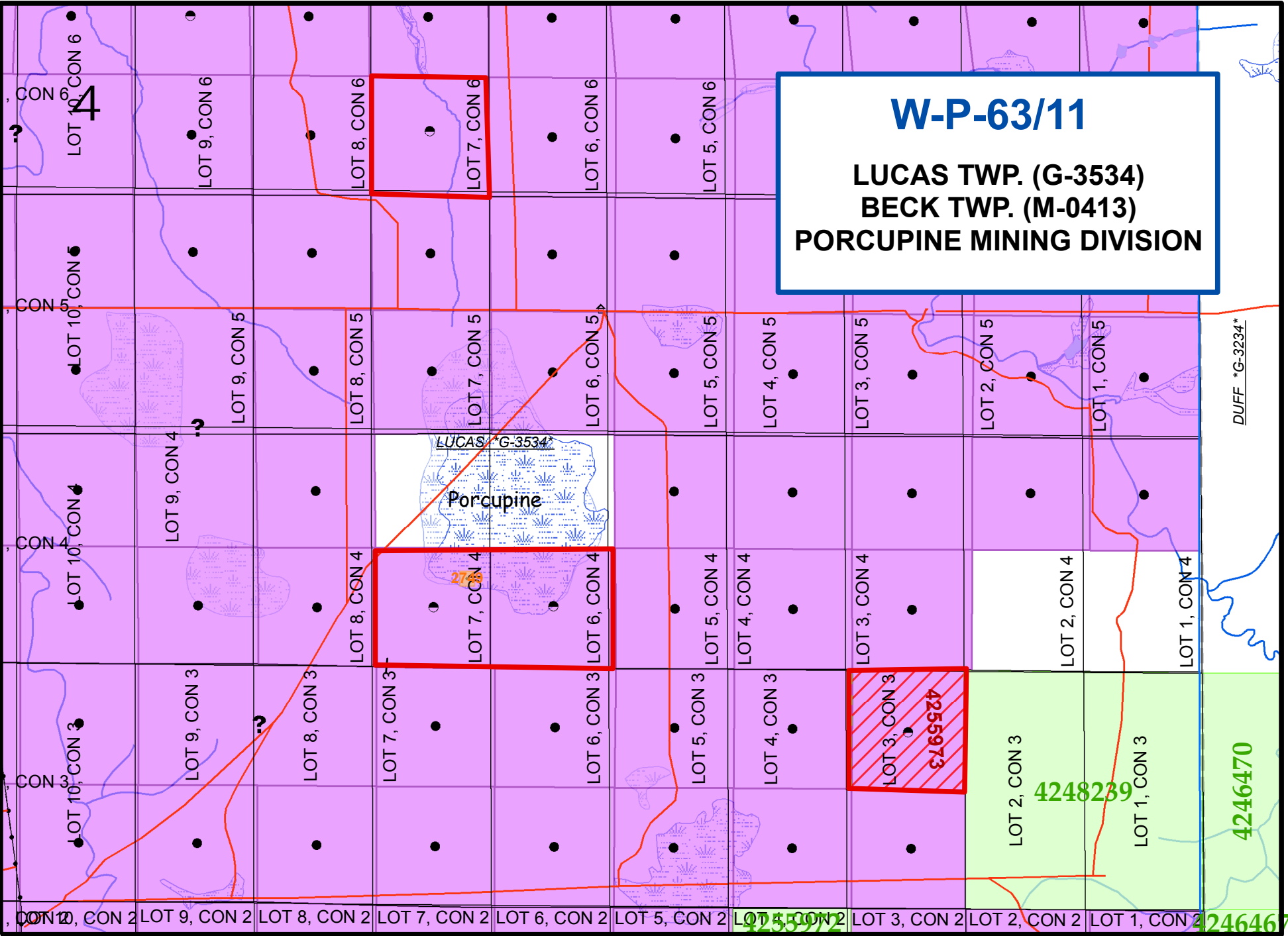

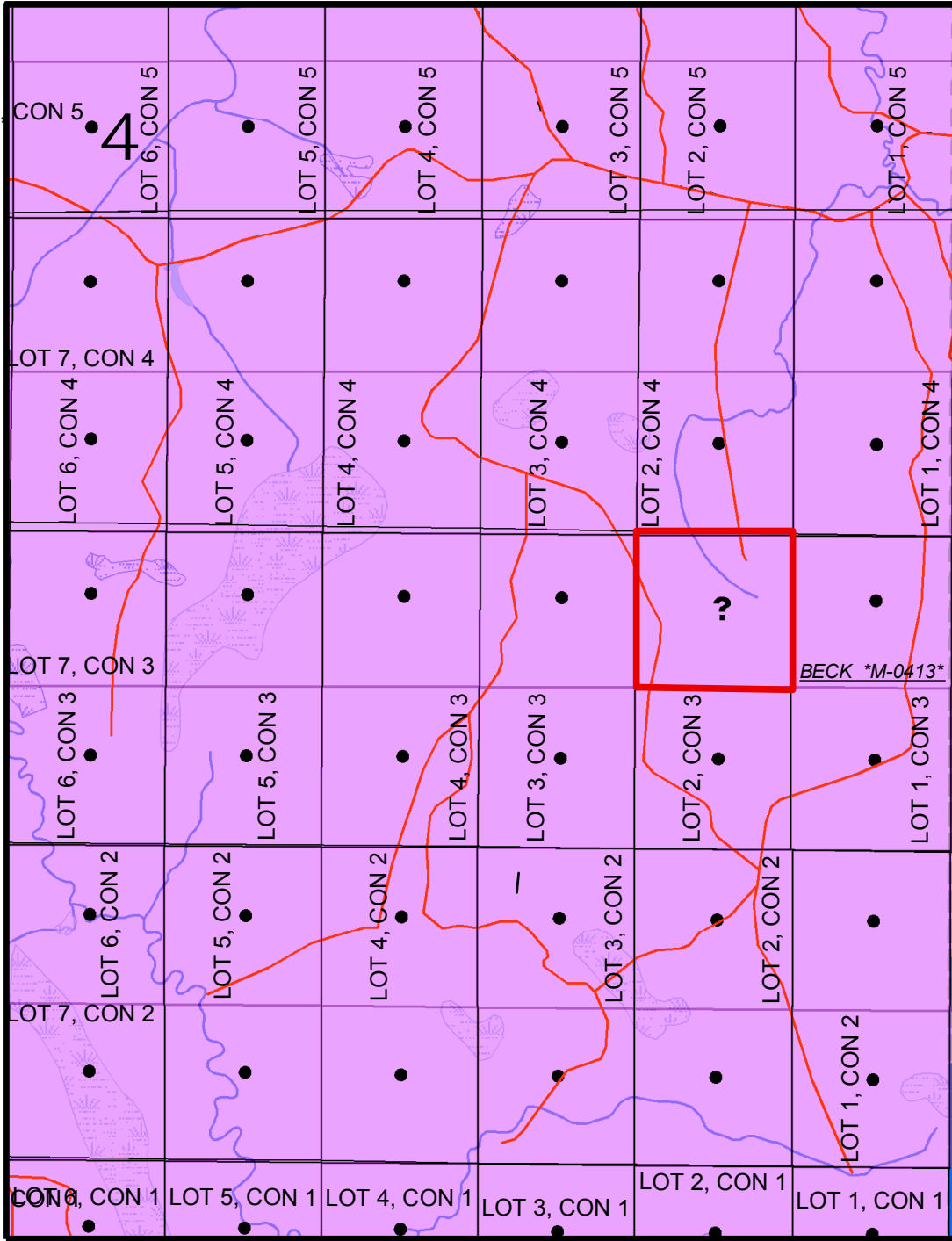

3013087 3016467 4257991

**W-P-63/11**  
**LUCAS TWP. (G-3534)**  
**BECK TWP. (M-0413)**  
**PORCUPINE MINING DIVISION**

