

ORDER

SECTION 35, THE MINING ACT, R.S.O. 1990

ORDER NO. W-S-75/02

The MINING RIGHTS of the area outlined in red on the attached sketch located in Notman Township (G-1625), containing 80 hectares more or less, are hereby WITHDRAWN from prospecting, staking out, sale or lease in accordance with the terms of this order.

This area is withdrawn to allow the Ministry of Transportation to evaluate the bedrock for aggregate potential.

Saving, excepting and reserving hereto and herefrom, all other lands patented, sold, leased or otherwise alienated by the Crown at the date of this Order.

Any alienated lands lying within the limits of this withdrawn area that revert to the Crown subsequent to the date of this order will automatically be considered to be withdrawn as part of this order.

This order comes into effect upon signing.

Date: Jan 13, 2003

Original signed by "Ron C. Gashinski"

Time: 1:50 pm

Ron C. Gashinski, Senior Manager
Mining Lands Section
Mines and Minerals Division

Copies:

Senior Manager, Mining Lands Section, 6th Floor, Sudbury, MNDM

Provincial Mining Recorder, Sudbury, MNDM (2)

District Geologist Sudbury

District Manager, North Bay, Ontario, MNR

MNR File (Peterborough) : 195150

Internet: Yes / No

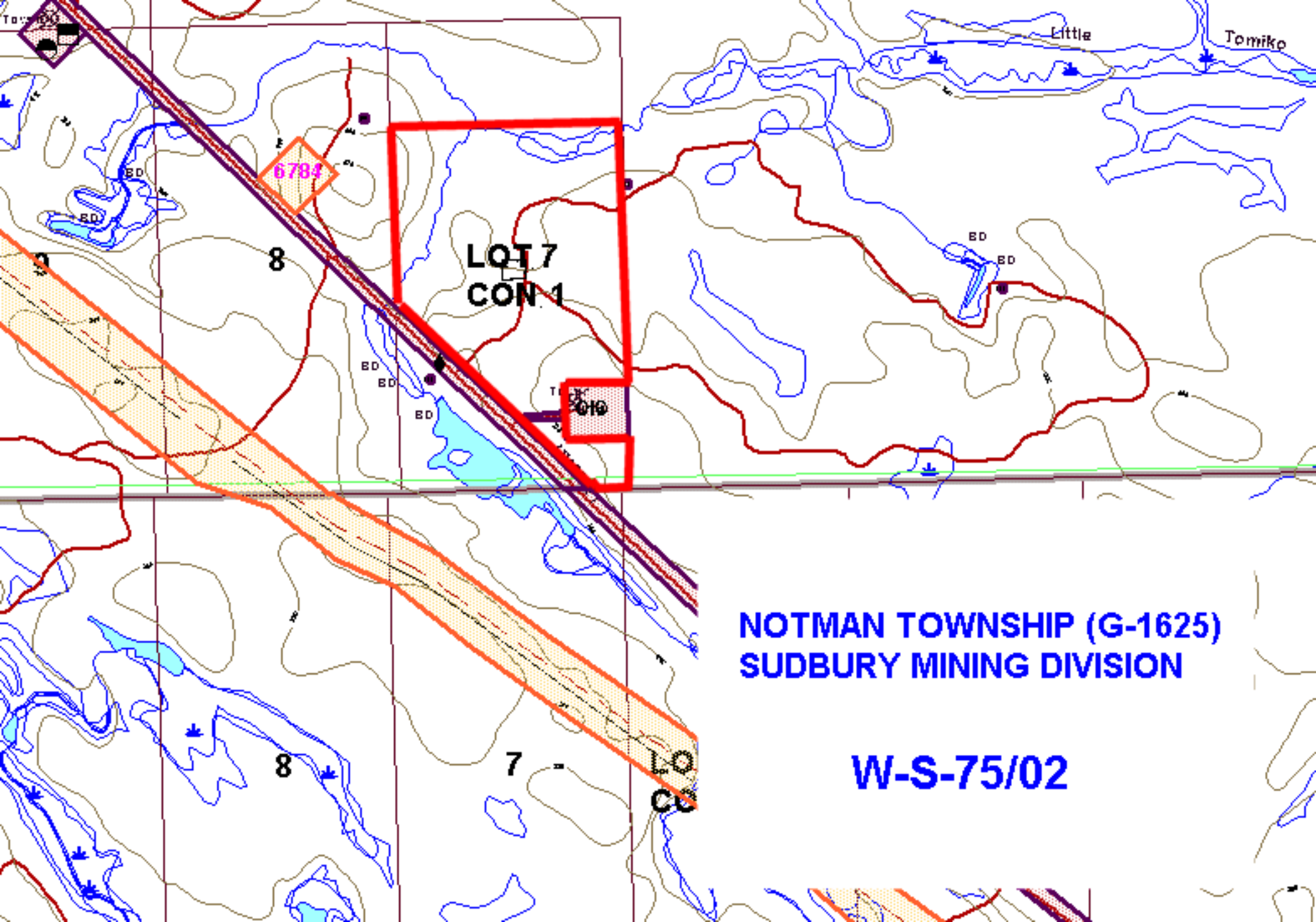

6784

LOT 7
CON 1

LOT 9

8

8

7

LOT 8
CON 1

Little

Tomiko

**NOTMAN TOWNSHIP (G-1625)
SUDBURY MINING DIVISION**

W-S-75/02