

ORDER

SECTION 35, THE MINING ACT, R.S.O. 1990

ORDER NO. W-SO-13-06

THE SURFACE RIGHTS of the area outlined in red on the attached sketch, situated in Radcliffe Township, in the Southern Ontario Mining Division, containing 18 hectares, more or less, are hereby withdrawn from prospecting, staking out, sale or lease.

The land is being withdrawn at the request of the Ministry of Natural Resources for use as a waste disposal site.

Saving, excepting and reserving hereto and herefrom, all other lands patented, sold, leased or otherwise alienated by the Crown at the date of this Order.

Any alienated lands lying within the limits of this withdrawn area that revert to the Crown subsequent to the date of this order will automatically be considered to be withdrawn as part of this order.

This order comes into effect upon signing.

Date: April 11th, 2006

Original signed by "Roy Denomme"

Time: 2:43 p.m.

Roy Denomme, Provincial Mining Recorder
Mineral Development and Lands Branch
Mines and Minerals Division

Copies:

Senior Manager, Mining Lands Section, 6th Floor, Sudbury, MNDM

Provincial Mining Recorder, Sudbury, MNDM

Mining Lands Consultant Southern Ontario
District Manager, Pembroke , Ontario, MNR

MNR File (Peterborough) : 195150

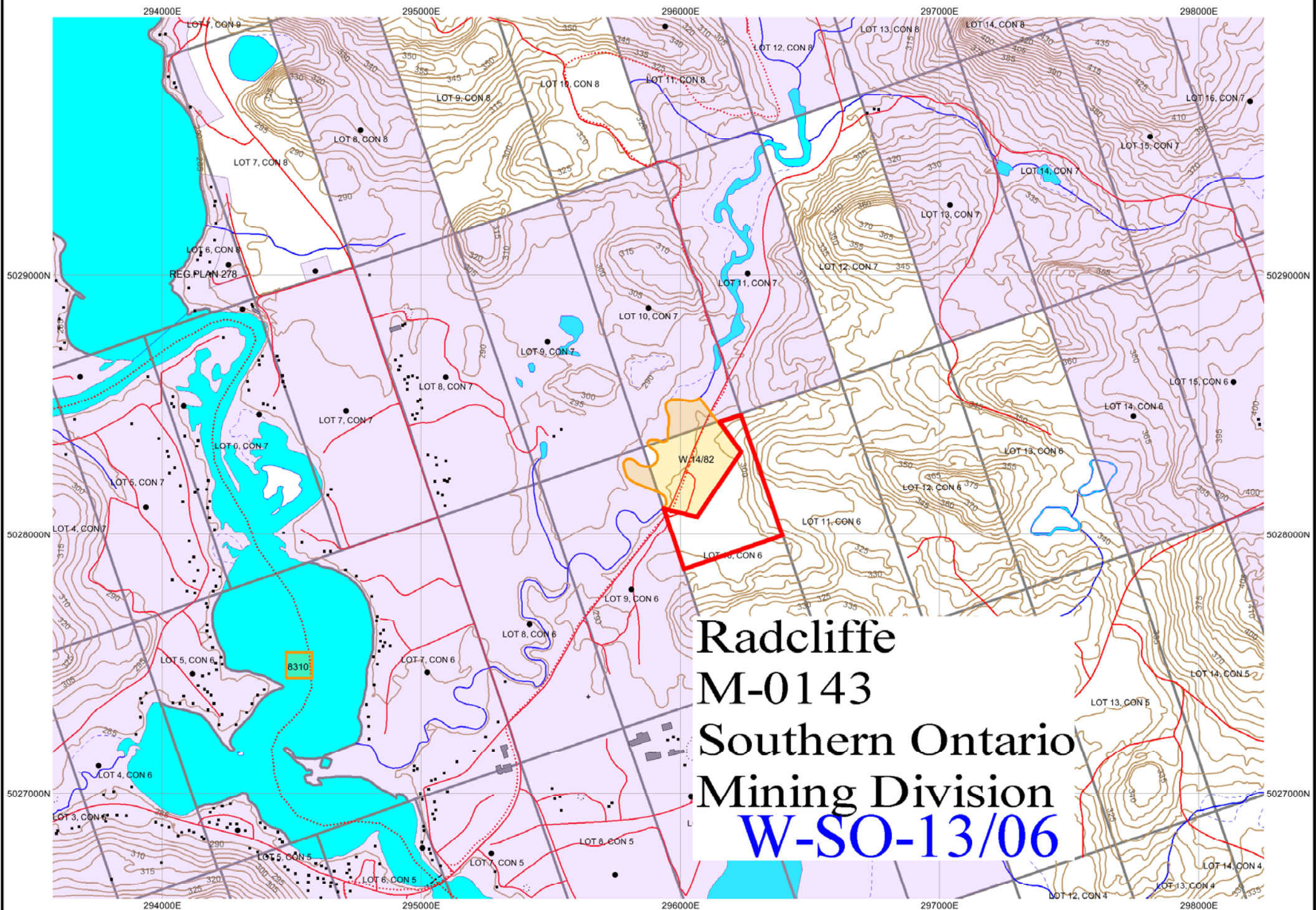

Radcliffe
M-0143
Southern Ontario
Mining Division
W-SO-13/06