

ORDER

SECTION 35, THE MINING ACT, R.S.O. 1990

ORDER NO. W-SO-26/09

The SURFACE RIGHTS of the area outlined in red on the attached sketch, situated in the Township of Hardy (M-0179), in the Southern Ontario Mining Division, containing 5.2 hectares more or less, are hereby WITHDRAWN from prospecting, staking out, sale or lease.

This area is WITHDRAWN to protect an active waste disposal site.

Saving, excepting and reserving hereto and herefrom, all other lands patented, sold, leased or otherwise alienated by the Crown at the date of this Order.

Any alienated lands lying within the limits of this withdrawn area that revert to the Crown subsequent to the date of this Order will automatically be considered to be withdrawn as part of this Order.

This order comes into effect upon signing.

Date: Feb 26/09

Time: 2:51 pm

ORIGINAL SIGNED BY "RANDY SCHIENBEIN"

Randy Schienbein, A/Provincial Mining Recorder

Mining Lands Section

Mines and Minerals Division

Copies:

Senior Manager, Mining Lands Section, MNDM, Sudbury

Provincial Mining Recorder, MNDM, Sudbury

Provincial Lands Specialist - CLR

RLUG – Southern Ontario

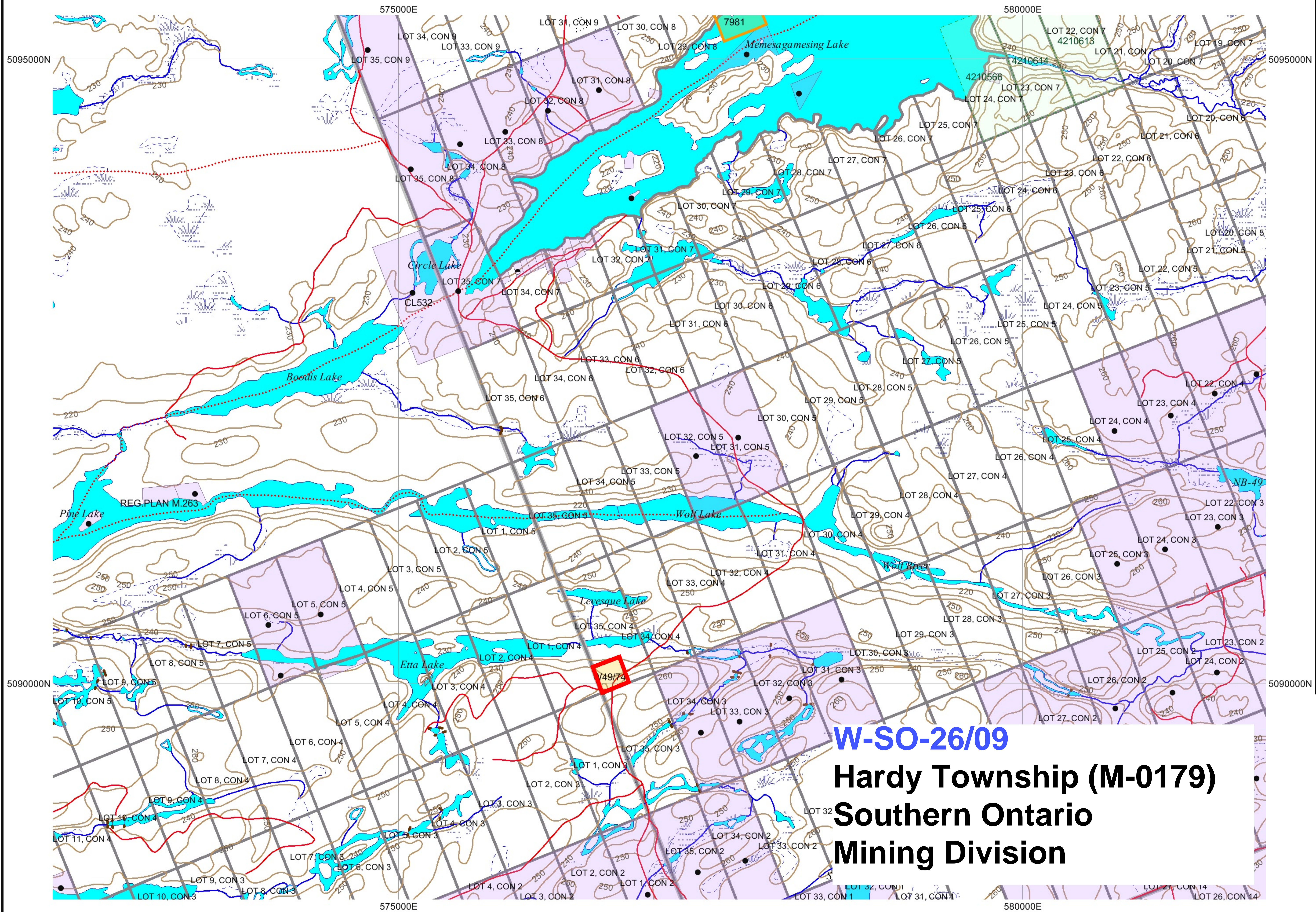

W-SO-26/09
Hardy Township (M-0179)
Southern Ontario
Mining Division