



O R D E R

SECTION 35, THE MINING ACT, R.S.O. 1990

ORDER NO. W-SO-39/06

THE SURFACE RIGHTS of the area outlined in red on the attached sketch, situated in the Township of Horton (M-1786) , in the Southern Ontario Mining Division, containing 10 hectares, more or less, are hereby withdrawn from prospecting, staking out, sale or lease.

The area is withdrawn at the request of the Ministry of Natural Resources for the development of a water power site.

Saving, excepting and reserving hereto and herefrom, all other lands patented, sold, leased or otherwise alienated by the Crown at the date of this Order.

Any alienated lands lying within the limits of this withdrawn area that revert to the Crown subsequent to the date of this order will automatically be considered to be withdrawn as part of this order.

This order comes into effect upon signing.

Date: May 5th, 2006

Original signed by "Roy Denomme"

Time: 8:50 a.m.

Roy Denomme, Provincial Mining Recorder
Mining Lands Section
Mines and Minerals Division

Copies:

Senior Manager, Mining Lands Section, 6th Floor, Sudbury, MNDM

Provincial Mining Recorder, Sudbury, MNDM

District Geologist, Tweed
District Manager, Pembroke , Ontario, MNR

MNR File (Peterborough): 195150

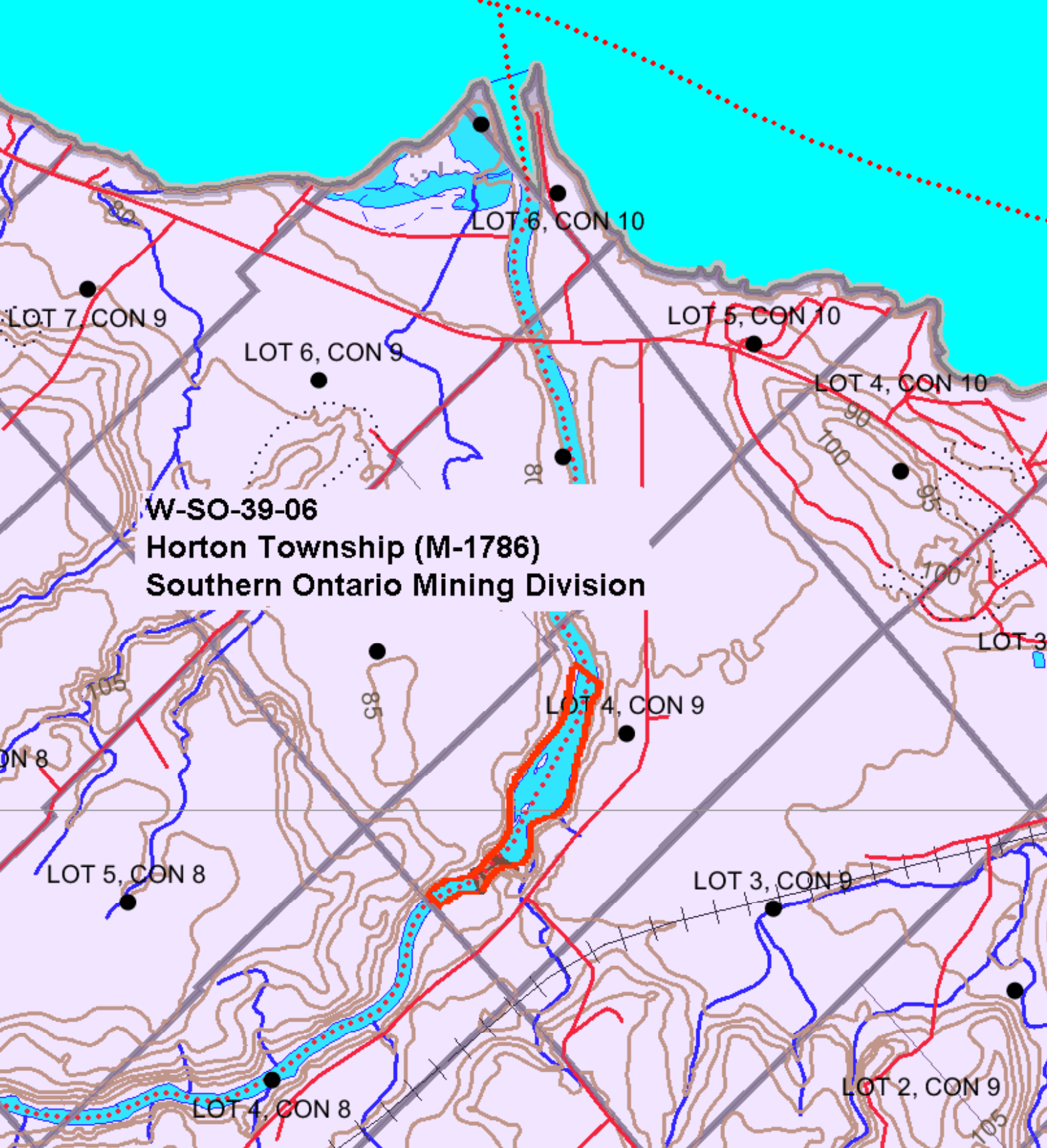

W-SO-39-06

Horton Township (M-1786)

Southern Ontario Mining Division