

**ORDER**

**SECTION 35, THE MINING ACT, R.S.O. 1990**

**ORDER NO. W-TB-75/18**

The SURFACE RIGHTS and MINING RIGHTS of the area outlined in red on the attached sketch, situated in the Townships of Priske (G-0631) in the Thunder Bay Mining Division, containing 63.798 hectares more or less, are hereby WITHDRAWN from prospecting, mining claim registration, sale or lease.

This area is withdrawn while the Ministry determines the status of the lands.

Saving, excepting and reserving hereto and herefrom, all other lands patented, sold, leased or otherwise alienated by the Crown at the date of this Order.

Any alienated lands lying within the limits of this withdrawn area that revert to the Crown subsequent to the date of this Order will automatically be considered to be withdrawn as part of this Order.

This order comes into effect upon signing.

Date: Nov 21, 2018

Time: 2:06pm

Originally signed by Patrick Brown

---

Patrick Brown, A/Provincial Mining Recorder  
Mines and Minerals Division

Copies:

Senior Manager, Mining Lands Section, MNDM, Sudbury  
Provincial Mining Recorder, MNDM, Sudbury  
Provincial Lands Specialist – CLR

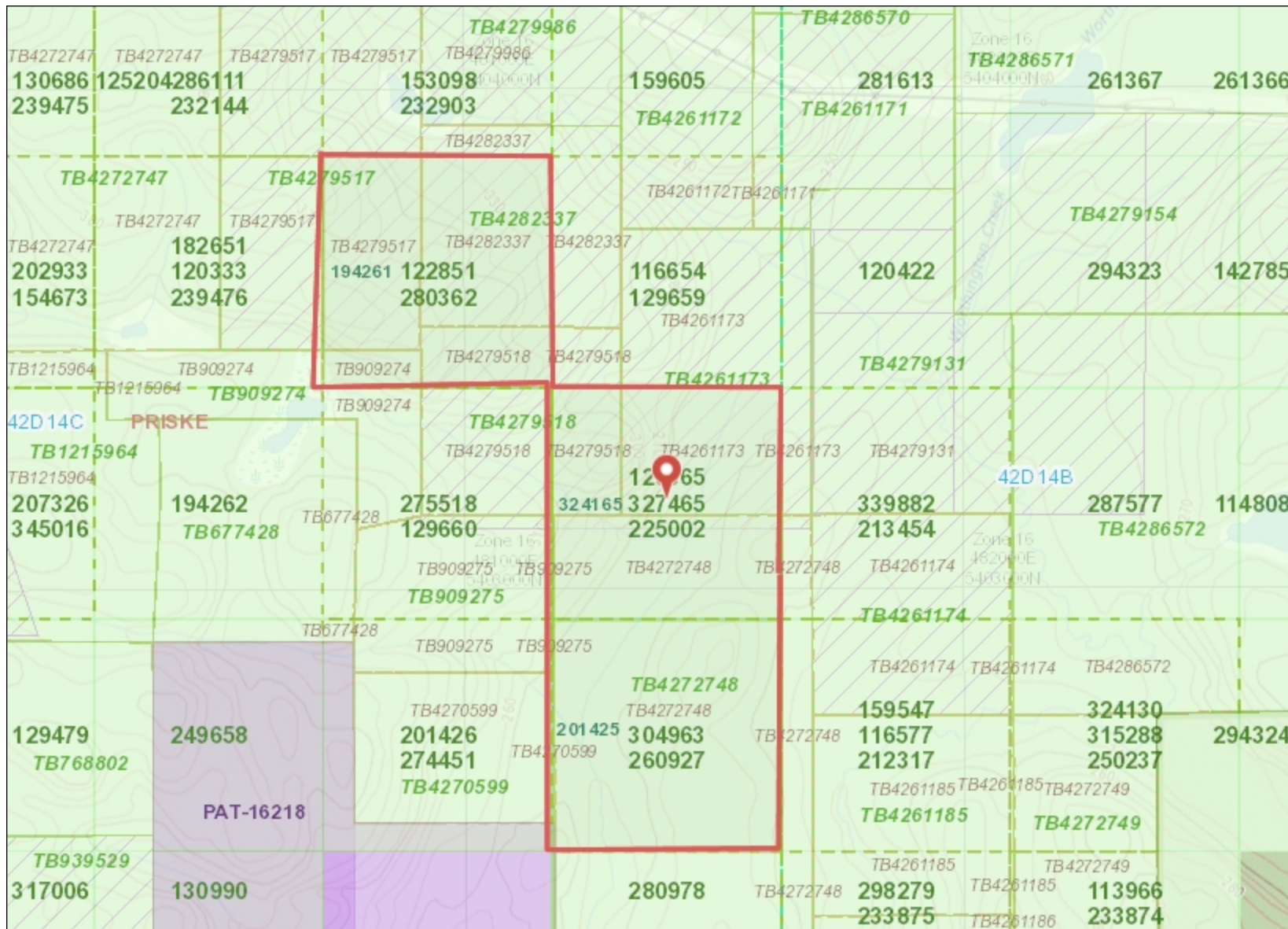

### Legend

- Mining Claim
- Mining Lease**
  - Surface Rights Only
  - Mining Rights Only
  - Surface and Mining Rights
- Mining Licence of Occupation**
  - Surface Rights Only
  - Mining Rights Only
  - Surface and Mining Rights
- Mining Patent**
  - Surface Rights Only
  - Mining Rights Only
  - Surface and Mining Rights
- Boundary Claim
- Legacy Claim
- Mining Claim - History
- Mining Land Tenure - History
- Mining Division
- MNDM Townships and Areas
- Provincial Grid Group
- Non-Mining Land Tenure**
  - Patent, Surface Rights Only
  - Patent, Mining Rights Only
  - Patent, Surface and Mining Rights
  - Lease, Surface Rights Only
  - Lease, Mining Rights Only
  - Lease, Surface and Mining Rights
  - Water Power Lease Agreement
  - Licence of Occupation, Surface Rights Only



Projection: Web Mercator



The Ontario Ministry of Northern Development and Mines shall not be liable in any way for the use of, or reliance upon, this map or any information on this map. This map should not be used for: navigation, a plan of survey, routes, nor locations.

Imagery Copyright Notices: Ontario Ministry of Natural Resources and Forestry; NASA Landsat Program; First Base Solutions Inc.; Aéro-Photo (1961) Inc.; DigitalGlobe Inc.; U.S. Geological Survey.

