

Prospecting Report on Sauve Lake Property

By

2-30506

Brian Youngs

RECEIVED
Incomplete Rept.
SEP - 7 2005
GEOSCIENCE ASSESSMENT
OFFICE

RECEIVED
Complete Rept. rec'd.
SEP - 9 2005
GEOSCIENCE ASSESSMENT
OFFICE

September 6, 2005

This report covers the prospecting work carried out Sept. 5 2005, on claim 1229485 located south of Sauve Lake in Cassels Township.

A two-unit claim was staked in September of 2002 to cover a portion of the volcanics, which are an extension of the Link Lake shear zone. This is recorded in the name of Brian Youngs.

The claim is located to the north east of the town of Temagami in the Sudbury mining division. Access to the claim is had by following the hydro transmission service trail north from Snake Lake road approx. 7 k, then along an ATV trail 2 k to Sauve Lake. Then a 2k canoe trip to the southern most shore.

One day was spent prospecting by myself and Scott Youngs.

Sept. 24, 2003

We were attempting to find evidence of quartz veining along the eastern edge of our claim. We were stripping and cleaning up what appeared to be old trenches in the northern portion of the claim. We acquired two samples one from diabase with small veins in it and one from quartz type vein. These were taken to the lab in Swastika and results will be forwarded to be added to this report.

Brian Youngs Scott Youngs

Lic# C38755



Lic#1002087

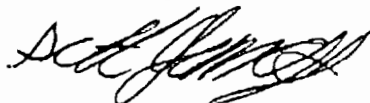

CASSELS TWP
SUDBURY MINING DIV
G-3415

SAUVE
LAKE

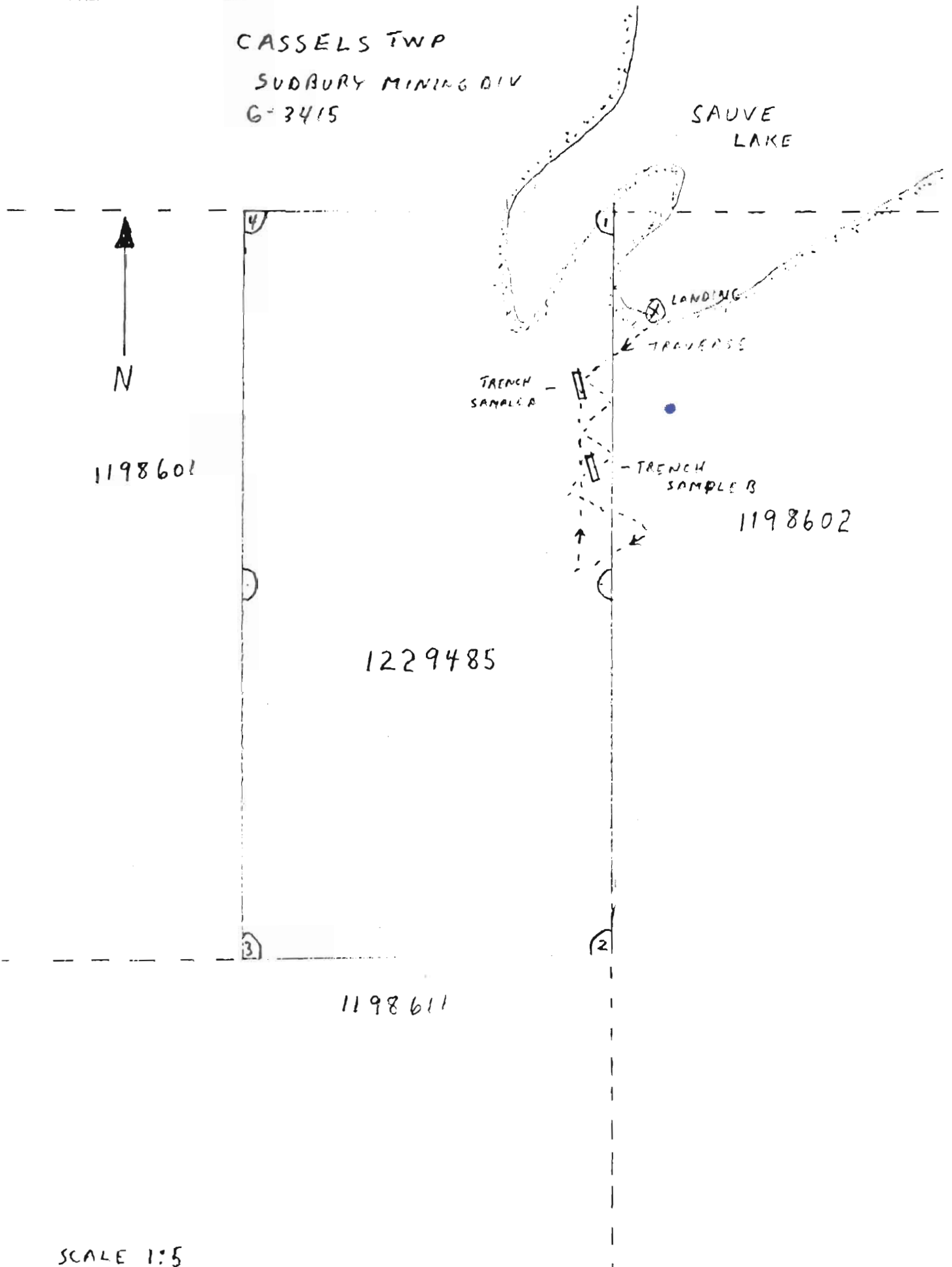

SCALE 1:5



Established 1928

Swastika Laboratories Ltd

Assaying - Consulting - Representation

Assay Certificate

5W-2118-RA1

Company: **BRIAN YOUNGS**

Date: **SEP-08-05**

Project:

Att: **B. Youngs**

We hereby certify the following Assay of 2 Rock samples submitted SEP-06-05 by .

Sample Number	Au g/tonne	Au Check g/tonne	Multi Element
090505 A	0.01	-	Results
090505 B	2.61	2.47	to follow

RECEIVED
 SEP - 9 2005
 GEOSCIENCE ASSESSMENT
 OFFICE

Certified by: *Dennis Choudhary*

1 Cameron Ave., P.O. Box 10, Swastika, Ontario P0K 1T0
 Telephone (705) 642-3244 Fax (705) 642-3300