

# REPORT OF PHYSICAL WORK 2.30591

## Overview

Prospecting by the recorded holder of claim 1194773, Michael Grieve, showed traces of amethyst in float boulders. The author of this report, Michael D. Grieve, of 59 Peter Street, Thunder Bay, Ontario, accompanied the recorded holder to the area on September 14, 2005. The two performed manual stripping and trenching in the area, in hope of discovering in-situ mineralization.

## Location and Access

Access to mining claim 1194773 (Tartan Lake sheet, G-2706) is gained by traveling north of Thunder Bay, Ontario, via highway 527, to the Magone Road. Magone Road is followed easterly for approximately 13km, at which point a branch road leads toward the claim group (see map attached to this report).

## Nature of terrain and rocks

Numerous granite boulders containing amethyst veining were observed, with increasing frequency, scattered on the forest floor approaching the base of a north-south trending slope. An area exhibiting the greatest concentration of amethyst-bearing rubble was targeted for manual stripping and trenching.

Overburden in the area consists of coarse glacial till with bouldery and gravelly areas hosted in coarse sandy matrix. Vegetation is a mix of poplar, birch, balsam and spruce amongst a dense alder undergrowth.

Surficial float boulders, and rubble encountered during excavation, were comprised of medium-grained pink granite, and locally, granite/quartz breccia. Amethyst vugs to 20cm were found containing hematite-coated, lavender, smoky, and on occasion, dark purple crystals from 0.5 to 2cm. Larger fragments of amethystine quartz, exhibiting pronounced banding, suggest that veins of 10 or more centimeters in width are present in the area of the stripping. Although trenching up to 1 meter deep failed to locate bedrock, the size and blocky nature of the boulders encountered indicate that they have not traveled far.

## Equipment Used

Suzuki King Quad and trailer, pry bars, shovels, grub-hoes and Husqvarna 257 chainsaw.

Prepared by

Michael D. Grieve

  
September 19, 2005

Thunder Bay  
Mining Division

SEP 20 2005

RECEIVED

3:43pm

# DETAILED PLAN OF WORKINGS. - claim 1194773



MAGNETIC.

2.30591

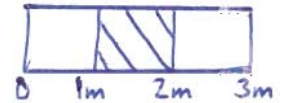

1cm = 1m.

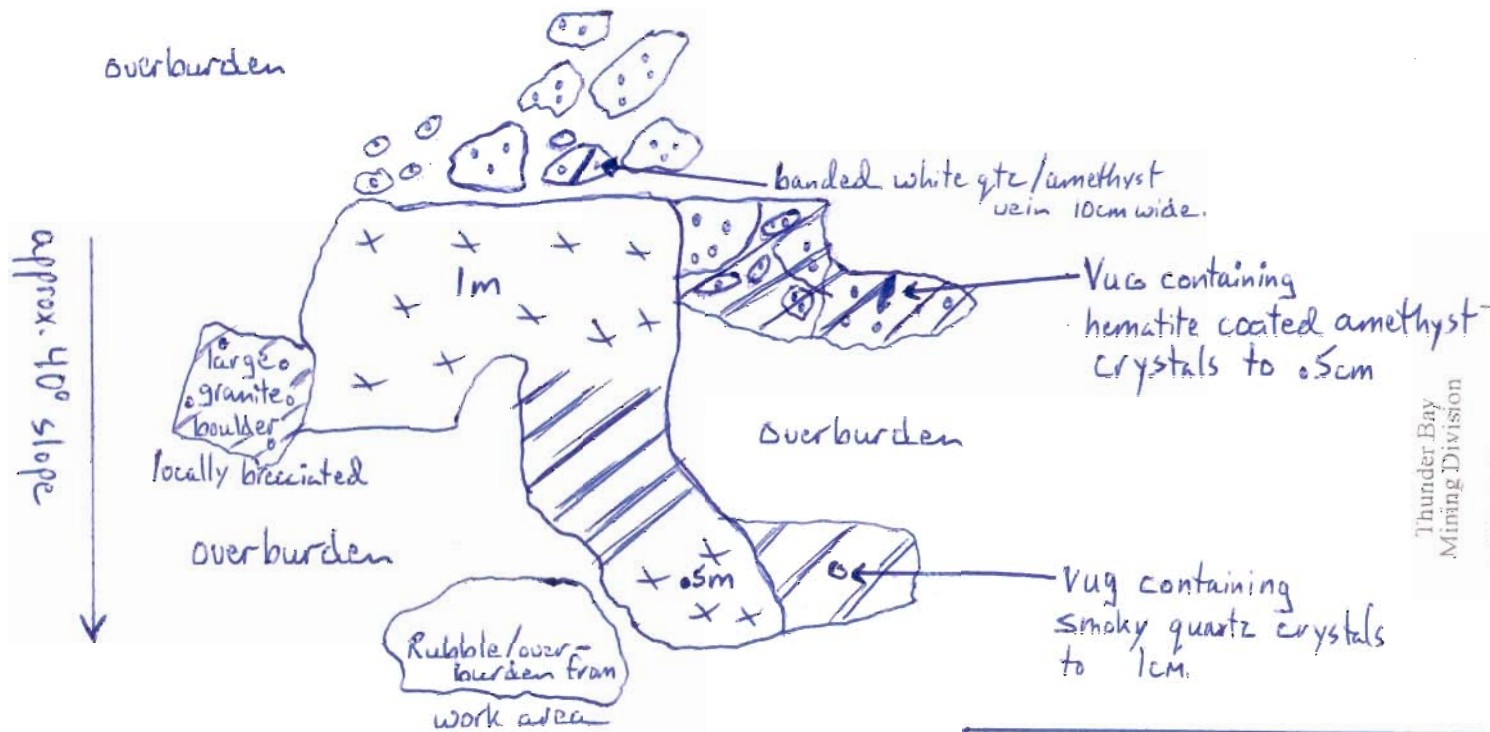

bottom of slope

generally flat lands  
gently sloping to south

## LEGEND

- /// = stripped area
- xx = trenched (depth noted as well).
- ⊙ = granite, med-gr, pink

Thunder Bay  
Mining Division

SEP 20 2005  
RECEIVED

2.30591

LOCATION / OUTLINE OF CLAIM GROUP

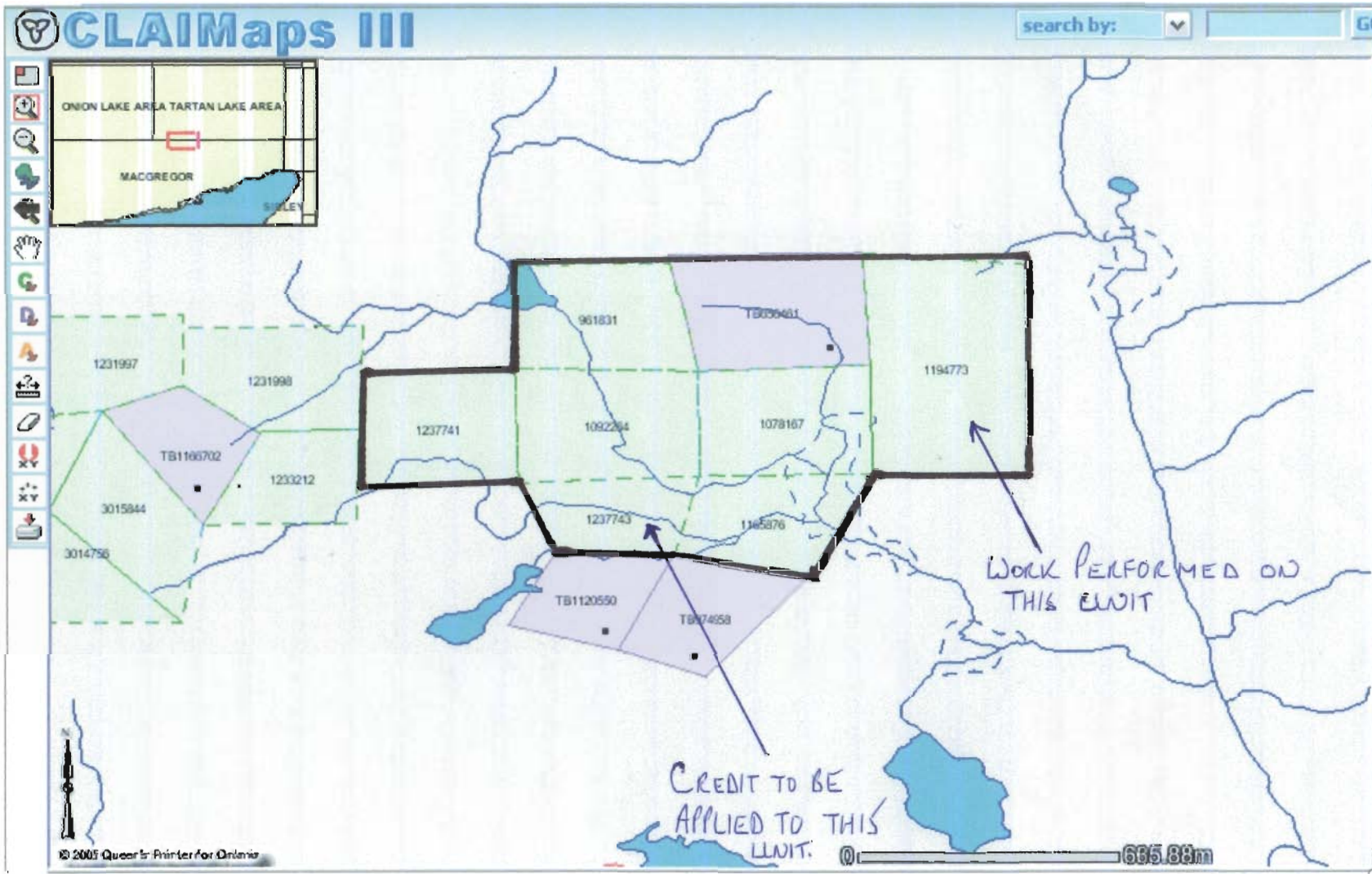

Thunder Bay  
Mining Division  
SEP 20 2005 4:34pm  
RECEIVED

# LOCATION OF WORK PERFORMED

2.30591

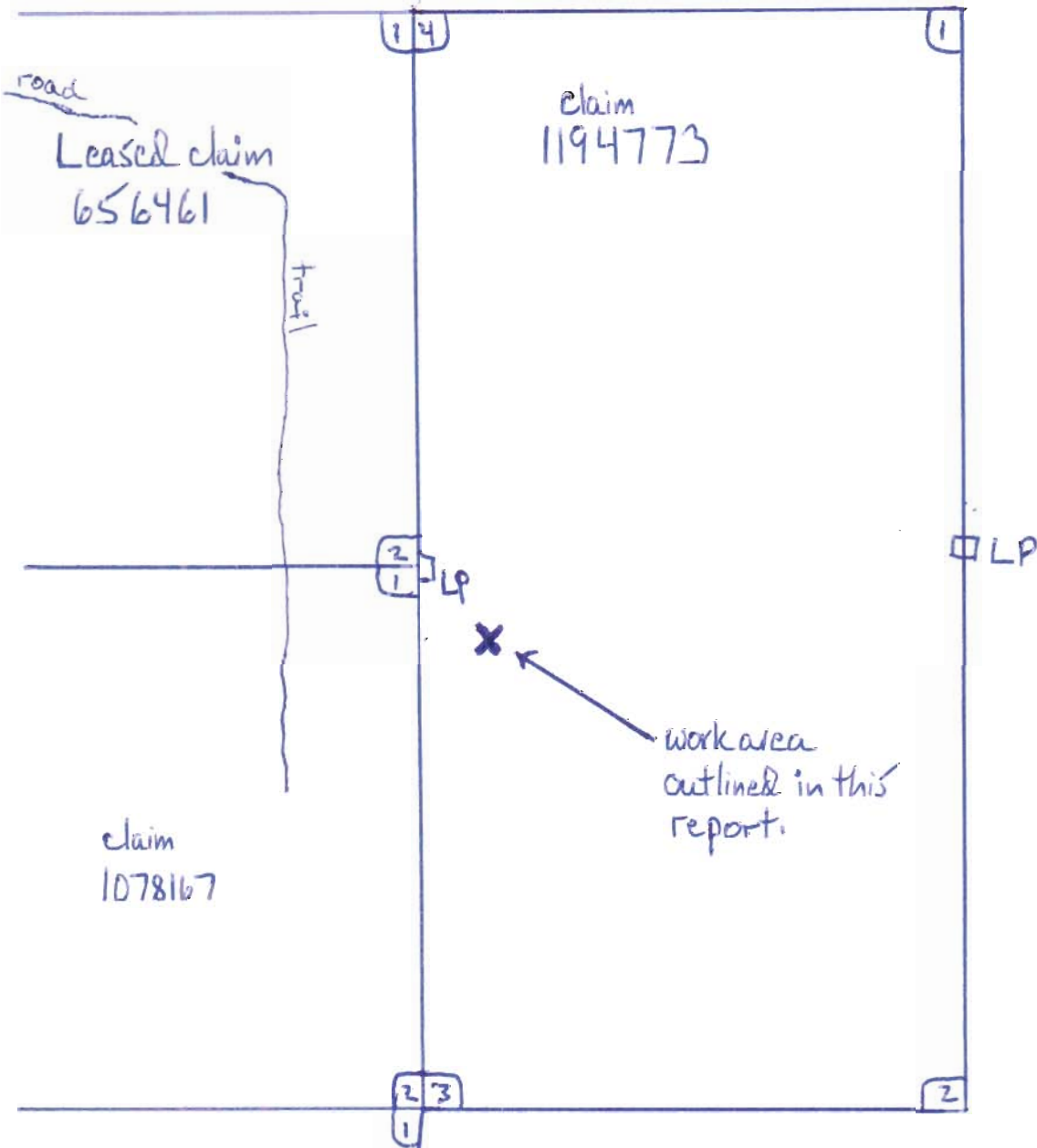

Thunder Bay  
Mining Division

SEP 20 2005

RECEIVED



0 50m 100m 150m

1cm = 50m.

*Handwritten signature and date:*  
SEP 20 2005  
3:30pm