

2. 30682

**Musher Lake
Final Report**

(OEC GRANT 2005-111)

Submitted by Harold Griggs
October 10th, 2005

Table of Contents

	<u>Page</u>
Introduction	1
Location and Access	1
Geology	2
Work Done	2
Prospecting Daily Log	2
Project Expenditures	3
Sample Locations and Descriptions	4
Assay Table	6
Results and Recommendations	6

Appendices

- Appendix 1 - Analytical Results
- Appendix 2 - Invoices

Attachments

Property Geology (Scale 1:2500)

Introduction

The property is host to a copper/silver showing (zone C – McIntyre Mines, 1962) in the north-central part of the western claim. A second zone of silver mineralization (zone B – McIntyre Mines, 1962) lies near the central portion of the western boundary of the property. This zone represents a strong airborne electromagnetic feature as seen on OGS Map #60 036. Of greater significance is a ‘feldspathic unit’ that merges with the east end of the Lunny Lake Porphyry in the southern part of the eastern claim. **Drilling by Hemlo Gold in 1996 encountered 1 meter of 37.4 g/t Au approx. 200 meters southeast of the Musher Lake claims. A second drill hole, 200 meters further east, encountered 3 meters of 3.9 g/t Au, including 1 meter of 10.6 g/t Au.** The Lunny Lake Porphyry and the feldspathic unit both represent excellent targets for additional gold mineralization.

The property has seen several operators since the discovery of base metal mineralization in the area in 1962 by C. Von Klein. McIntyre Porcupine Mines examined the property in 1962, Caravelle Mines in 1964 and then Falconbridge optioned the property from Caravelle in 1966. There was an exploration lull until the discovery of the Hemlo ore body in 1982, at which time Pryme Energy staked the area. Noranda Exploration (and their predecessors Hemlo Gold and Battle Mountain) held the property under option from 1982 onwards and did extensive work including trenching and drilling prior to relinquishing their option in 2002.

The ‘north limb’ represents one of few areas in the Hemlo belt outside of the mine horizon where there has been gold intersected in drilling. The Lunny Lake Porphyry strikes across the full length of the Musher Lake property (2.5 km). Alteration within the porphyry consists of quartz-eye sericite schist with weak feldspathic alteration and minor pyrite mineralization. Similarities to the Moose Lake Porphyry at Hemlo are evident. Strong gold-in-soil anomalies (Hemlo Gold, 1995) lie just south of the central portion of the western claim. It is possible they represent gold mineralization in bedrock up-ice on the property.

Location and Access

Claims T.B. 4204985 and T.B. 4204986
Wabikoba Lake Area (G-0620), Schreiber - Hemlo District, Thunder Bay Mining Division
NTS 42C/13SW, UTM 5410000N, 588000E

The Musher Lake property consists of 14 claim units located in the Wabikoba Lake Area of the Thunder Bay Mining District, approximately 17 km northeast of the three producing Hemlo Gold Mines. The property can be accessed by a logging road (Dotted Lake road) thirteen kilometers north of Highway 17, for about 3 kilometers east to the Twist Lake road, then east along the Twist Lake road for another 3 kilometers. At this point a logging road heading south towards Musher Lake cuts southward into the southern portion of the property.

2.1 mtrs 3.2g/t Au, 52.8g/t Ag,
2.9% Cu, 2.1% Zn

MUSHER LAKE PROPERTY

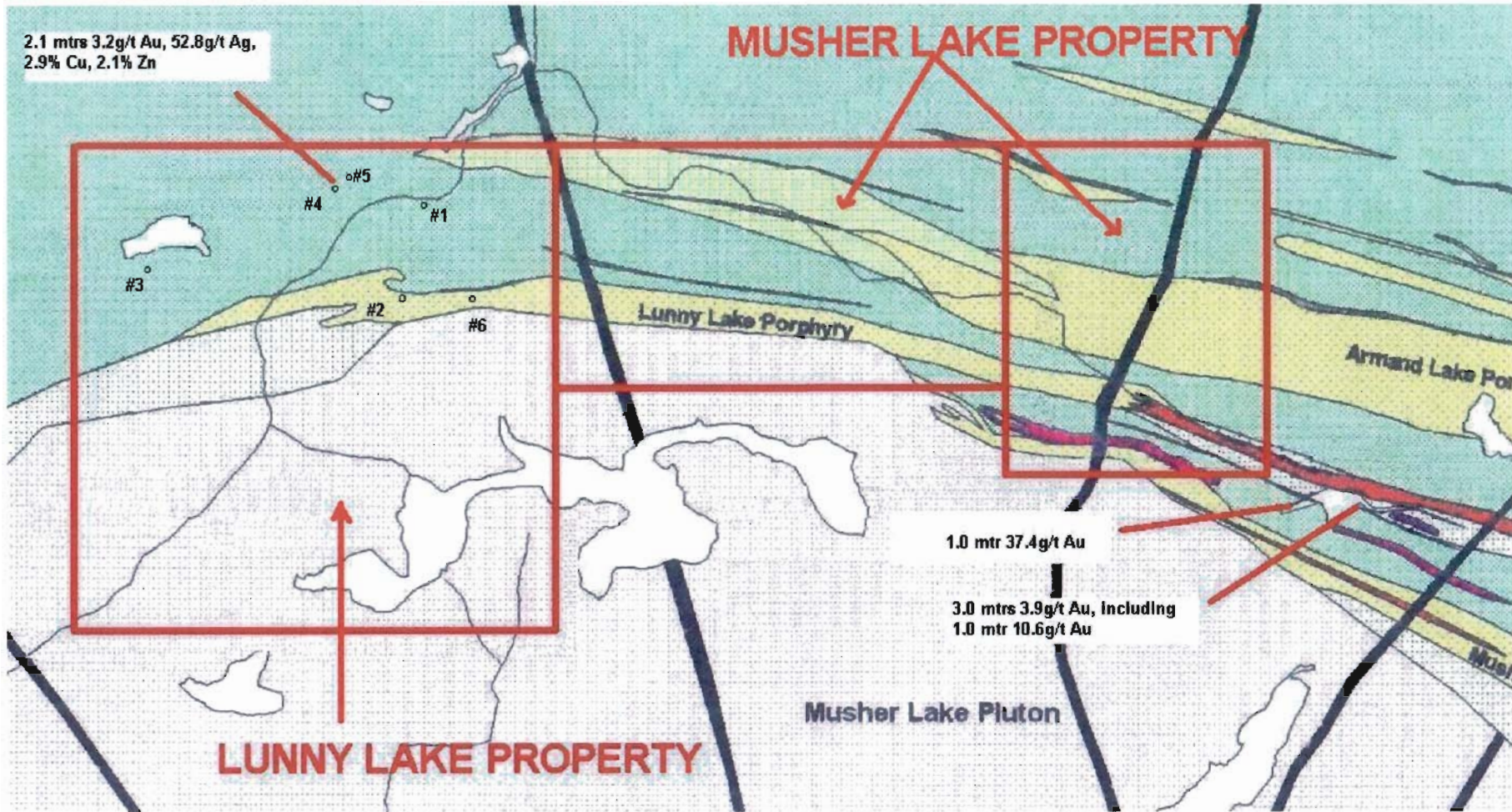

LUNNY LAKE PROPERTY

Musher Lake Pluton

Armard Lake Por

Mush

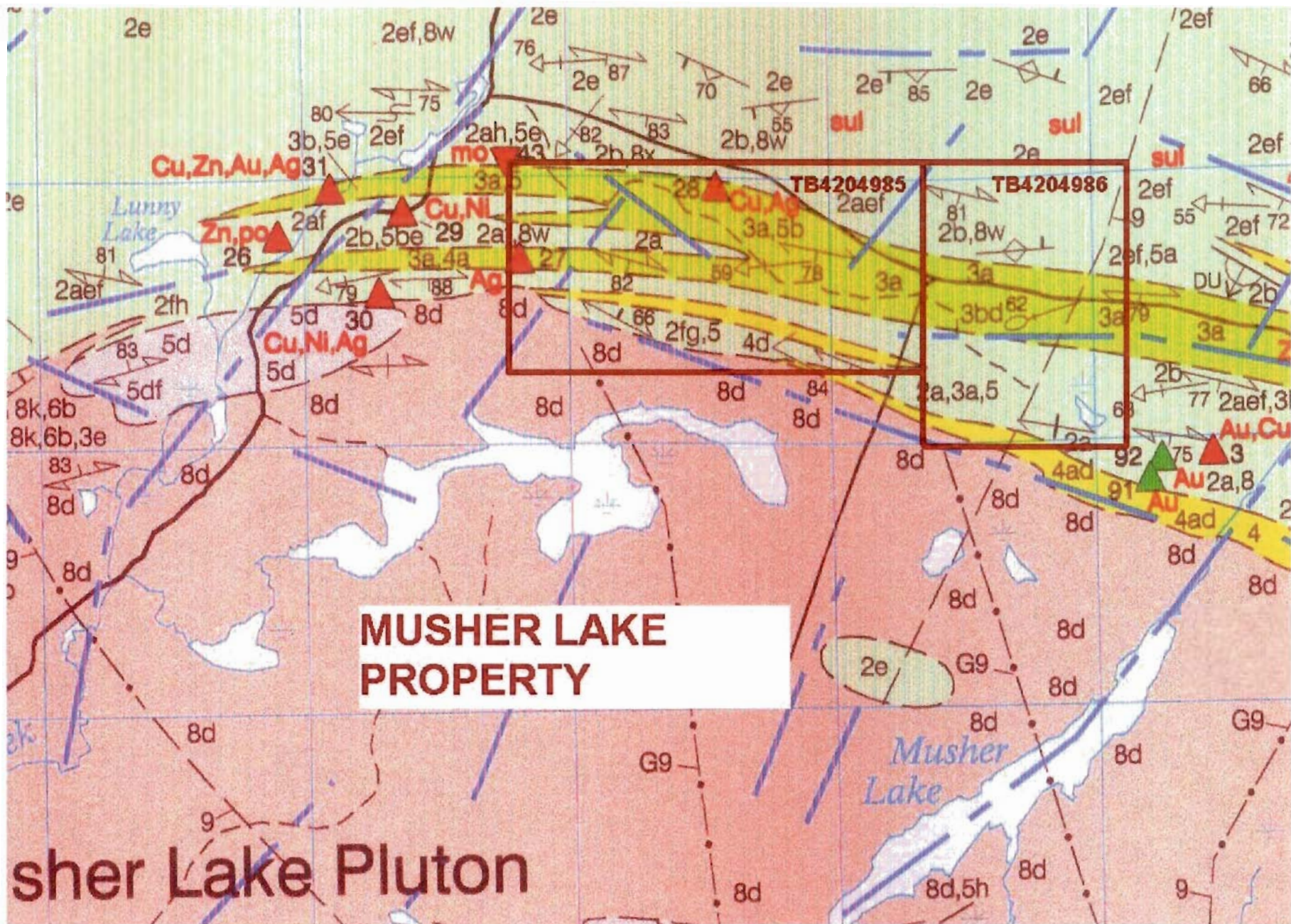

Geology

The Musher Lake property is located within the Archean Schreiber-Hemlo Greenstone Belt that is part of the Abitibi-Wawa-Shebandowan Subprovince of the Superior Province. The property is situated on the northern portion of the Hemlo synform and dominated by east-west striking sequences of metavolcanic and metasedimentary rocks bounded to the south by the Musher Lake Pluton. The supracrustal rocks consist principally of tholeiitic basaltic flows and subordinate turfs, intercalated with epiclastic arkosic wacke and siltstone. Feldspar porphyry dykes and sills intrude both volcanics and sediments.

Work Done

Line cutting was contracted to Danny Thibeault of Rouyn-Noranda, Quebec. A total of 5.5 kilometers of grid was cut. A mag survey over 5.45 kilometres of the grid was contracted to Ray Bernatchez, Consulting Geologist, Atikokan, Ontario.

Three days were spent prospecting the grid by the author and my helper, Brian Fowler of Marathon, Ontario between August 20th and September 17th. A total of twenty three (23) samples were collected from the property and sent to Chemex Labs in Thunder Bay for assay.

Prospecting Daily Log

<u>Date</u>	<u>Work Performed</u>
Aug-20	- traversed the area of Zone C on L14, L15 and L16 between 5+00N and the road. Found numerous old pits and took 4 samples.
Sep-11	- traversed L9E, 10E, 11E, 12E and L13E and collected 9 samples.
Sep-17	- traversed L13E, and L14E, L15E and L16E from south of 5+00N to 0+00 and collected 10 samples.

Project Expenditures

<u>Date</u>	<u>Recipient of Payment</u>	<u>Explanation</u>	<u>Amount</u>
Jun-19	Danny Thibeault	line cutting	\$2571.86
Aug-19	Ray Bernatchez	mag survey & geological mapping	\$1826.70
Sep-3	Chemex Labs	assays (4 samples)	\$ 138.67
Sep-06	Chaltrek	flagging tape, bags & hoe handles	\$ 87.98
Sep-06	Greyhound	Chaltrek order	\$ 19.37
Sep-12	Greyhound	shipment of rock samples	\$ 13.28
Sep-17	Greyhound	shipment of rock samples	\$ 13.28
Sep-18	Brian Fowler	3 days prospecting	\$ 600.00
Sep-18	Food	3 days x \$20/day/ea	\$ 120.00
Sep-18	Travel	3 trips x 120km/day x 40c/km	\$ 144.00
Sept-26	Chemex Labs	assays (9 samples)	\$ 307.90
Sept-28	Chemex Labs	assays (10 samples)	\$ 338.41
		Total:	\$6,181.45
		Grant:	\$6,000.00

Sample Locations and Descriptions

Sample #	Location	Rock Type	Mineralization	Comments
L1	10 mtrs west of L16E at 5+30N	iron formation	2-3% py, minor cpy	rusty, strongly magnetic, banding
L2	pit along road 50 mtrs west of L16E	quartz vein	1% py	sheared gossan, non-magnetic, pyrite has a silvery look, strongly sericitic,
L3	same location as L2	quartz vein	1% py	non-magnetic, minor sericite
L4	pit along road 25 mtrs west of L16E	mafic volcanic	1% py	minor qtz veining, weakly magnetic
L19	L9+00E at 2+65N	quartz vein	5-7% py/po	strongly magnetic
L20	L9+00E at 2+65N	int. volcanic	3-5% py	rusty, garnets, strongly magnetic
L21	10+85E on BL2+00N	int. volcanic	2% diss. py	rusty, bleached look, altered
L22	10+85E on BL2+00N	int. volcanic	2-3% diss. py	similar to L21, green mica
L23	10+85E on BL2+00N	int. volcanic	2% py	
L24	11+35E & 5+50N (trench)	int. volcanic	2-3% py	
L25	11+35E & 5+47N (trench)	int. volcanic	2-3% py	biotite
L26	L12+00E & 2+25N	int. volcanic	5% py/po	strongly magnetic
L27	L12+00E & 2+25N	porphyry	minor py	qtz eyes, kspar, iron oxide stain

Sample Locations and Descriptions (cont.)

Sample #	Location		Rock Type	Mineralization	Comments
L28	16+20E & 3+90N	East grid	int. volcanic	2% pyrite	rusty
L29	15+85E & 3+18N	East grid	quartz vein	1-2% pyrite	
L30	15+85E & 3+18N	East grid	int. volcanic	2-3% pyrite	rusty, siliceous
L31	16+07E & 1+70N	East grid	mafic volcanic	10-15% pyrite	rusty, gossan
L32	16+10E & 2+08N	East grid	int. volcanic	10-15% pyrite	rusty, siliceous
L33	16+08E & 1+95N	East grid	int. volcanic	5-7% pyrite	siliceous
L34	16+25E & 0+60N (trench)	East grid	porphyry	2-3% pyrite	rusty, qtz eyes, bleached appearance
L35	15+05E & 1+30N	East grid	porphyry	1% pyrite	mod. sericitic, green quartz in veins
L36	15+05E & 1+30N	East grid	porphyry	1-2% pyrite	rusty, sericitic, iron oxide stain
L37	14+93E & BL2+00N	East grid	int. volcanic	3-5% py/po	rusty, biotite, strongly magnetic

Musher Lake Assay Table

Sample #	Au ppm	Ag ppm	Cu ppm	Mo ppm	Ni ppm	Pb ppm	Zn ppm
L1	0.088	1.5	431	1	122	<2	630
L2	0.102	0.9	65	1	4	11	173
L3	0.027	0.6	102	1	15	18	1290
L4	0.007	0.4	40	<1	40	2	98
L19	0.002	<0.2	20	<1	10	4	45
L20	0.008	0.4	33	4	28	8	235
L21	0.001	<0.2	10	2	30	2	23
L22	0.002	<0.2	29	3	48	3	39
L23	0.002	<0.2	72	3	42	<2	25
L24	0.036	0.2	9	<1	10	<2	45
L25	0.156	0.5	31	1	12	<2	168
L26	0.003	<0.2	37	<1	22	<2	27
L27	<0.001	<0.2	2	<1	4	<2	16
L28	0.007	0.2	29	1	6	<2	19
L29	0.003	<0.2	18	14	6	3	8
L30	0.012	<0.2	62	2	13	5	28
L31	0.013	<0.2	21	1	23	4	8
L32	0.012	<0.2	7	1	35	<2	5
L33	0.012	<0.2	18	3	74	4	19
L34	0.003	<0.2	68	20	6	2	8
L35	<0.001	<0.2	7	1	10	<2	7
L36	<0.001	<0.2	17	11	2	2	5
L37	0.002	<0.2	8	<1	48	2	102

Results and Recommendations

A total of 23 rock samples were taken from the Musher Lake property within or near the grid area (western half of Claim TB 4204985). Several areas of mineralization were discovered throughout the grid. McIntyre Porcupine Zones' B and C were located and sampled.

L1 from Zone C returned 0.09 g/t Au, 1.5 g/t Ag, 0.06% Zn, 0.04% Cu and 0.01% Ni. Sample L3 taken from a pit along the side of the Twist Lake Road about 50 metres north of Zone C returned 0.13% Zn. Zone B was sampled across a 200 metre strike length (from L9E to L11E) but returned only anomalous zine (0.02% Zn).

Sampling just east of L16E at the BL2+00N located a zone of rusty, siliceous intermediate volcanics with 10-15% pyrite. The results here were disappointing. About 125 metres south of this sampling is a trench that crosses the grid line. A sample was taken from the bottom end of the trench in a mineralized porphyry. The porphyry contains anomalous molybdenum (20ppm).

Finally, an old trench was located just east of the north end of L11E. A sample from the south end of the trench returned 0.16 g/t Au and 0.02% Zn in intermediate volcanics.

The mag highs on L10E north of the baseline could not be checked due to lack of outcrop. However, a north-south running trench (Trench 202E, Noranda Exploration, 1985) assumed to be about 70 metres west of L9E (near the claim boundary with the Lunny Lake Property) would likely expose any possible mineralization associated with these mag highs. It is important to note that a moly occurrence is located in or near the trench at roughly our grid co-ordinate 5+00N. Neither the trench nor the moly occurrence were located in this program.

The relief south of the baseline is generally quite low lying and hence outcrop exposure is very poor. This proved to be a detriment, as the Lunny Lake Porphyry was a high priority target for the OEC grant and few samples could be gathered from it, since it lies in the southern portion of the grid.

Further work on the property should concentrate on the potential of the Lunny Lake Porphyry on the remaining 1.5 kilometre strike length across the property to the east boundary. At a point about 1.2 kilometers east of L16E the Lunny Lake Porphyry grades into a feldspathic sedimentary horizon and contains a zone of gold mineralization. Drilling by Hemlo Gold in 1996 encountered 1 meter of 37.4 g/t Au approx. 200 meters southeast of the Musher Lake claims. A second drill hole, 200 meters further east, encountered 3 meters of 3.9 g/t Au, including 1 meter of 10.6 g/t Au. The Lunny Lake Porphyry and the feldspathic unit both represent excellent targets for additional gold mineralization. A grid should be put down in the southern part of claim TB 4204986 to see if this gold mineralization persists across this section of the property.

In addition, the moly occurrence in the trench west of L9E should be located and evaluated for its gold potential as well.

Yours truly,

A handwritten signature in cursive script that reads "Harold Griggs". The signature is written in black ink and is positioned above the printed name.

Harold Griggs

APPENDIX 1

ANALYTICAL RESULTS



ALS Chemex

EXCELLENCE IN ANALYTICAL CHEMISTRY

ALS Canada Ltd.

212 Brooksbank Avenue

North Vancouver BC V7J 2C1

Phone: 604 984 0221 Fax: 604 984 0218 www.alschemex.com

FOWLER, BRIAN
 PO BOX 2174
 APT 19, 3 HELMO DR
 MARATHON ON P0T 2E0

Page: 2 - A
 Total # Pages: 2 (A - C)
 Finalized Date: 3-SEP-2005
 Account: KBS

Project: LUNNY LAKE

CERTIFICATE OF ANALYSIS	TB05070633
-------------------------	------------

Sample Description	Method Analyte Units LOR	WEI-21 Recvd Wt. kg	ME-ICP41 Ag ppm	ME-ICP41 Al %	ME-ICP41 As ppm	ME-ICP41 B ppm	ME-ICP41 Ba ppm	ME-ICP41 Be ppm	ME ICP41 Bi ppm	ME-ICP41 Ca %	ME-ICP41 Cd ppm	ME-ICP41 Co ppm	ME-ICP41 Cr ppm	ME-ICP41 Cu ppm	ME-ICP41 Fe %	ME-ICP41 Ga ppm
		0.02	0.2	0.01	2	10	10	0.5	2	0.01	0.5	1	1	1	0.01	10
L1		0.59	1.5	0.65	28	<10	10	<0.5	<2	0.87	0.9	16	366	431	11.50	<10
L2		0.30	0.9	0.45	3	<10	60	<0.5	<2	0.01	<0.5	5	6	65	11.00	<10
L3		0.39	0.6	0.27	13	<10	10	<0.5	<2	0.07	4.6	12	12	102	1.67	<10
L4		0.44	0.4	1.84	6	<10	90	<0.5	<2	1.92	<0.5	18	53	40	3.95	<10
L5		0.74	0.3	2.44	<2	<10	40	<0.5	<2	1.30	2.1	16	58	138	4.16	10
L6		0.57	0.4	3.75	<2	<10	10	<0.5	<2	0.34	<0.5	19	28	1420	8.15	10
L7		0.92	0.8	3.48	<2	<10	10	<0.5	<2	0.35	<0.5	17	24	3810	6.09	10
L8		0.81	3.1	5.86	3	<10	110	<0.5	3	2.74	3.0	12	99	2070	6.67	20



ALS Chemex

EXCELLENCE IN ANALYTICAL CHEMISTRY

ALS Canada Ltd.

212 Brooksbank Avenue

North Vancouver BC V7J 2C1

Phone: 604 984 0221 Fax: 604 984 0218 www.alschemex.com

FOWLER, BRIAN
 PO BOX 2174
 APT 19, 3 HELMO DR
 MARATHON ON P0T 2E0

Page: 2 - B
 Total # Pages: 2 (A - C)
 Finalized Date: 3-SEP-2005
 Account: KBS

Project: LUNNY LAKE

CERTIFICATE OF ANALYSIS TB05070633

Sample Description	Method	ME-ICP41	ME-ICP41	ME-ICP41	ME ICP41	ME-ICP41	ME-ICP41	ME-ICP41	ME-ICP41	ME-ICP41	ME-ICP41	ME-ICP41	ME-ICP41	ME-ICP41	ME-ICP41	
	Analyte	Hg	K	La	Mg	Mn	Mo	Na	Ni	P	Pb	S	Sb	Sc	Sr	Ti
	Units LOR	ppm	%	ppm	%	ppm	ppm	%	ppm	ppm	ppm	%	ppm	ppm	ppm	%
		1	0.01	10	0.01	5	1	0.01	1	10	2	0.01	2	1	1	0.01
L1		<1	0.04	<10	0.50	260	1	0.05	122	820	<2	2.73	<2	4	23	0.06
L2		<1	0.25	<10	0.02	37	1	0.01	4	240	11	0.79	<2	1	10	0.03
L3		<1	0.07	<10	0.14	116	1	0.01	15	80	18	0.76	<2	1	3	0.02
L4		<1	0.22	<10	1.07	553	<1	0.14	40	720	2	0.36	<2	9	21	0.33
L5		1	0.43	10	1.29	261	<1	0.07	62	650	5	1.90	<2	4	29	0.17
L6		<1	0.07	10	3.29	447	3	0.03	46	690	<2	2.14	<2	5	5	0.13
L7		<1	0.06	<10	3.08	338	<1	0.05	43	790	<2	0.79	<2	4	7	0.09
L8		<1	0.93	10	1.76	593	<1	0.31	40	720	313	1.00	<2	17	94	0.23



ALS Chemex

EXCELLENCE IN ANALYTICAL CHEMISTRY

ALS Canada Ltd.

212 Brooksbank Avenue

North Vancouver BC V7J 2C1

Phone: 604 984 0221 Fax: 604 984 0218 www.alschemex.com

FOWLER, BRIAN
PO BOX 2174
APT 19, 3 HELMO DR
MARATHON ON P0T 2E0

Page: 2 - C
Total # Pages: 2 (A - C)
Finalized Date: 3-SEP-2005
Account: KBS

Project: LUNNY LAKE

CERTIFICATE OF ANALYSIS TB05070633

Sample Description	Method Analyte Units LOR	ME-ICP41	ME-ICP41	ME-ICP41	ME-ICP41	ME-ICP41	Au-ICP21
		Ti	U	V	W	Zn	Au
		ppm	ppm	ppm	ppm	ppm	ppm
		10	10	1	10	2	0.001
L1		<10	<10	67	<10	630	0.088
L2		<10	<10	13	<10	173	0.102
L3		<10	<10	8	<10	1290	0.027
L4		<10	<10	83	<10	98	0.007
L5		<10	<10	73	<10	1540	0.003
L6		<10	<10	105	<10	222	0.001
L7		<10	<10	92	<10	66	0.011
L8		<10	<10	138	<10	799	0.064



ALS Chemex

EXCELLENCE IN ANALYTICAL CHEMISTRY

ALS Canada Ltd.

212 Brooksbank Avenue

North Vancouver BC V7J 2C1

Phone: 604 984 0221 Fax: 604 984 0218 www.alschemex.com

To: FOWLER, BRIAN

PO BOX 2174

APT 19, 3 HELMO DR

MARATHON ON P0T 2E0

Page: 2 - A

Total Pages: 2 (A - C)

Finalized Date: 26-SEP-2005

Account: KBS

Project: MUSER LAKE

CERTIFICATE OF ANALYSIS TB05076904

Sample Description	Method Analyte Units LOR	WEI-21	Au-ICP21	ME-ICP41	ME-ICP41	ME-ICP41	ME-ICP41	ME-ICP41	ME-ICP41	ME-ICP41	ME-ICP41	ME-ICP41	ME-ICP41	ME-ICP41	ME-ICP41	ME-ICP41
		Recvd Wt.	Au	Ag	Al	As	B	Ba	Be	Bi	Ca	Cd	Co	Cr	Cu	Fe
		kg	ppm	ppm	%	ppm	ppm	ppm	ppm	ppm	%	ppm	ppm	ppm	ppm	%
		0.02	0.001	0.2	0.01	2	10	10	0.5	2	0.01	0.5	1	1	1	0.01
L19		0.33	0.002	<0.2	0.37	<2	<10	40	<0.5	<2	0.25	<0.5	4	39	20	3.48
L20		0.63	0.008	0.4	4.23	<2	<10	70	0.6	<2	0.96	<0.5	9	50	33	8.84
L21		0.83	0.001	<0.2	1.53	3	<10	40	<0.5	<2	1.58	<0.5	7	39	10	1.00
L22		0.65	0.002	<0.2	0.99	<2	<10	50	<0.5	<2	0.59	<0.5	22	33	29	1.72
L23		0.38	0.002	<0.2	1.64	2	<10	50	<0.5	<2	0.97	<0.5	21	31	72	1.91
L24		0.67	0.036	0.2	2.25	10	<10	80	<0.5	<2	0.62	<0.5	9	31	9	2.38
L25		0.48	0.156	0.5	1.60	19	<10	50	<0.5	<2	0.56	<0.5	12	24	31	2.58
L26		0.71	0.003	<0.2	3.37	2	<10	40	<0.5	<2	2.22	<0.5	17	69	37	7.49
L27		0.35	<0.001	<0.2	0.64	2	<10	20	<0.5	<2	0.03	<0.5	2	27	2	1.96



ALS Chemex

EXCELLENCE IN ANALYTICAL CHEMISTRY

ALS Canada Ltd.

212 Brooksbank Avenue

North Vancouver BC V7J 2C1

Phone: 604 984 0221 Fax: 604 984 0218 www.alschemex.com

To: FOWLER, BRIAN
 PO BOX 2174
 APT 19, 3 HELMO DR
 MARATHON ON P0T 2E0

Page: 2 - B
 Total Pages: 2 (A - C)
 Finalized Date: 26-SEP-2005
 Account: KBS

Project: MUSHER LAKE

CERTIFICATE OF ANALYSIS TB05076904

Sample Description	Method	ME-ICP41	ME-ICP41	ME-ICP41	ME-ICP41	ME-ICP41	ME-ICP41	ME-ICP41	ME-ICP41	ME-ICP41	ME-ICP41	ME-ICP41	ME-ICP41	ME-ICP41	ME-ICP41	
	Analyte	Ga	Hg	K	La	Mg	Mn	Mo	Na	Ni	P	Pb	S	Sb	Sc	Sr
	Units LOR	ppm	ppm	%	ppm	%	ppm	ppm	%	ppm	ppm	ppm	%	ppm	ppm	ppm
		10	1	0.01	10	0.01	5	1	0.01	1	10	2	0.01	2	1	1
L19		<10	<1	0.07	<10	0.22	736	<1	0.03	10	430	4	1.18	3	1	12
L20		10	1	0.29	10	1.96	1300	4	0.09	28	740	8	1.46	4	9	47
L21		<10	1	0.16	10	0.37	195	2	0.04	30	720	2	0.13	<2	2	29
L22		<10	<1	0.23	10	0.47	136	3	0.03	48	760	3	0.80	<2	2	15
L23		<10	<1	0.22	10	0.52	186	3	0.09	42	720	<2	0.91	2	2	43
L24		10	1	1.05	10	1.11	569	<1	0.20	10	580	<2	0.56	2	8	42
L25		<10	<1	0.57	10	0.70	438	1	0.11	12	520	<2	2.08	<2	4	44
L26		10	<1	0.07	10	0.45	615	<1	0.35	22	840	<2	1.96	<2	7	146
L27		<10	<1	0.06	10	0.37	215	<1	0.06	4	100	<2	0.01	<2	1	7



ALS Chemex

EXCELLENCE IN ANALYTICAL CHEMISTRY

ALS Canada Ltd.

212 Brooksbank Avenue
North Vancouver BC V7J 2C1

Phone: 604 984 0221 Fax: 604 984 0218 www.alschemex.com

To: FOWLER, BRIAN
PO BOX 2174
APT 19, 3 HELMO DR
MARATHON ON P0T 2E0

Page: 2 - C
Total Pages: 2 (A - C)
Finalized Date: 26-SEP-2005
Account: KBS

Project: MUSHER LAKE

CERTIFICATE OF ANALYSIS TB05076904

Sample Description	Method Analyte Units LOR	ME-ICP41	ME-ICP41	ME-ICP41	ME-ICP41	ME-ICP41	ME-ICP41
		Ti	Ti	U	V	W	Zn
		%	ppm	ppm	ppm	ppm	ppm
		0.01	10	10	1	10	2
L19		0.02	<10	<10	12	<10	45
L20		0.10	<10	<10	83	<10	235
L21		0.11	<10	<10	29	<10	23
L22		0.09	<10	<10	22	<10	39
L23		0.09	<10	<10	26	<10	25
L24		0.20	<10	<10	80	<10	45
L25		0.09	<10	<10	37	<10	168
L26		0.07	<10	<10	100	<10	27
L27		0.03	<10	<10	18	<10	16



ALS Chemex

EXCELLENCE IN ANALYTICAL CHEMISTRY

ALS Canada Ltd.
 212 Brooksbank Avenue
 North Vancouver BC V7J 2C1
 Phone: 604 984 0221 Fax: 604 984 0218 www.alschemex.com

To: FOWLER, BRIAN
 PO BOX 2174
 APT 19, 3 HELMO DR
 MARATHON ON P0T 2E0

Page: 2 - A
 Tot. Pages: 2 (A - C)
 Finalized Date: 28-SEP-2005
 Account: KBS

Project: MUSER LAKE

CERTIFICATE OF ANALYSIS TB05077399

Sample Description	Method Analyte Units LOR	WEI-21	Au-ICP21	ME-ICP41	ME-ICP41	ME-ICP41	ME-ICP41	ME-ICP41	ME-ICP41	ME-ICP41	ME-ICP41	ME-ICP41	ME-ICP41	ME-ICP41	ME-ICP41	ME-ICP41
		Recvd Wt.	Au	Ag	Al	As	B	Ba	Be	Bi	Ca	Cd	Co	Cr	Cu	Fe
		kg	ppm	ppm	%	ppm	ppm	ppm	ppm	ppm	%	ppm	ppm	ppm	ppm	ppm
		0.02	0.001	0.2	0.01	2	10	10	0.5	2	0.01	0.5	1	1	1	0.01
L28		0.40	0.007	0.2	1.38	<2	<10	210	<0.5	<2	0.16	<0.5	4	37	29	3.17
L29		0.57	0.003	<0.2	0.88	5	10	10	<0.5	<2	1.02	<0.5	6	39	18	1.12
L30		0.42	0.012	<0.2	1.12	7	<10	40	<0.5	<2	0.64	<0.5	12	27	62	2.94
L31		0.39	0.013	<0.2	1.22	<2	<10	80	<0.5	<2	0.88	<0.5	11	31	21	4.85
L32		0.54	0.012	<0.2	0.95	<2	<10	40	<0.5	<2	1.42	<0.5	9	31	7	1.88
L33		0.35	0.012	<0.2	1.62	2	10	30	<0.5	<2	1.90	<0.5	25	49	18	2.93
L34		0.43	0.003	<0.2	1.50	2	<10	250	<0.5	<2	1.29	<0.5	6	28	68	1.38
L35		0.93	<0.001	<0.2	1.07	<2	<10	90	<0.5	<2	0.14	<0.5	5	37	7	0.55
L36		0.41	<0.001	<0.2	0.44	<2	<10	90	<0.5	<2	0.03	<0.5	1	28	17	1.51
L37		0.63	0.002	<0.2	2.11	<2	<10	60	<0.5	<2	0.07	<0.5	23	43	8	8.86



ALS Chemex

EXCELLENCE IN ANALYTICAL CHEMISTRY

ALS Canada Ltd.

212 Brooksbank Avenue

North Vancouver BC V7J 2C1

Phone: 604 984 0221 Fax: 604 984 0218 www.alschemex.com

To: FOWLER, BRIAN

PO BOX 2174

APT 19, 3 HELMO DR

MARATHON ON POT 2E0

Page: 2 - B

Tot. Pages: 2 (A - C)

Finalized Date: 28-SEP-2005

Account: KBS

Project: MUSER LAKE

CERTIFICATE OF ANALYSIS TB05077399

Sample Description	Method Analyte Units LOR	ME-ICP41	ME-ICP41	ME-ICP41	ME-ICP41	ME-ICP41	ME-ICP41	ME-ICP41	ME-ICP41	ME-ICP41	ME-ICP41	ME-ICP41	ME-ICP41	ME-ICP41	ME-ICP41	
		Ga	Hg	K	La	Mg	Mn	Mo	Na	Ni	P	Pb	S	Sb	Sc	Sr
		ppm	ppm	%	ppm	%	ppm	ppm	%	ppm	ppm	ppm	%	ppm	ppm	ppm
		10	1	0.01	10	0.01	5	1	0.01	1	10	2	0.01	2	1	1
L28		10	<1	0.82	<10	0.73	221	1	0.09	6	490	<2	0.72	<2	7	11
L29		<10	<1	0.09	<10	0.21	133	14	0.02	6	510	3	0.26	<2	1	37
L30		<10	<1	0.23	10	0.43	172	2	0.05	13	580	5	1.64	<2	2	19
L31		10	<1	0.28	10	0.45	175	1	0.05	23	450	4	2.59	<2	3	64
L32		<10	<1	0.06	<10	0.15	87	1	0.03	35	630	<2	0.82	<2	2	59
L33		<10	1	0.18	10	0.40	162	3	0.08	74	710	4	2.51	<2	3	57
L34		10	<1	0.09	<10	0.52	93	20	0.06	6	240	2	0.87	<2	1	20
L35		<10	<1	0.18	10	0.17	50	1	0.06	10	450	<2	0.01	<2	2	18
L36		<10	<1	0.18	10	0.10	27	11	0.03	2	330	2	0.12	<2	<1	14
L37		10	<1	0.49	<10	0.95	571	<1	0.02	48	240	2	0.12	<2	6	7



ALS Chemex

EXCELLENCE IN ANALYTICAL CHEMISTRY

ALS Canada Ltd.

212 Brooksbank Avenue

North Vancouver BC V7J 2C1

Phone: 604 984 0221 Fax: 604 984 0218 www.alschemex.com

To: FOWLER, BRIAN
PO BOX 2174
APT 19, 3 HELMO DR
MARATHON ON P0T 2E0

Page: 2 - C
Total Pages: 2 (A - C)
Finalized Date: 28-SEP-2005
Account: KBS

Project: MUSHER LAKE

CERTIFICATE OF ANALYSIS TB05077399

Sample Description	Method Analyte Units LOR	ME-ICP41	ME-ICP41	ME-ICP41	ME-ICP41	ME-ICP41	ME-ICP41
		Ti	Tl	U	V	W	Zn
		%	ppm	ppm	ppm	ppm	ppm
		0.01	10	10	1	10	2
L28		0.17	<10	<10	64	<10	19
L29		0.08	<10	<10	20	<10	8
L30		0.12	<10	<10	33	<10	28
L31		0.06	<10	<10	40	<10	8
L32		0.19	<10	<10	26	<10	5
L33		0.08	<10	<10	36	<10	19
L34		0.06	<10	<10	14	<10	8
L35		<0.01	<10	<10	23	<10	7
L36		<0.01	<10	<10	7	<10	5
L37		0.11	<10	<10	112	<10	102

1030

APPENDIX 2

INVOICES

FROM :

FAX NO. 8075974638

Jun 19 2005 12:26PM P1

Dany Thibault
 107 Gatineau
 Rouyn Noranda, Qc.
 J9Y 1M9

819-797-6337

NOTRE NUMÉRO / OUR NUMBER	203667
DATE	June 19 2005
COMMANDE DU CLIENT / CUSTOMER'S ORDER	

VENDU À / SOLD TO	Ray Bernatchez
ADRESSE / ADDRESS	Brian Fowler Marathon On.

LIVRÉ À / SHIP TO	Lunny Ik
ADRESSE / ADDRESS	Valley Ik Marathon On.

852 510 932 Rt 0001

N° D'ENR. DE TAXE TAX REG. NO.	VENDEUR SALESPERSON
-----------------------------------	------------------------

FAS FOB	CONDITIONS TERMS	VIA
------------	---------------------	-----

QUANTITÉ QUANTITY	DESCRIPTION	PREX PRICE	MOYENS AMOUNT
9830 m.	Cross lines	375 -	3686 25
2150 m.	Base lines	395 -	849 25
700 km	Mobilisation, Domb Thunder Bay return	1 -	700 -
			5235 50
			TPS/GST 366 49
			IVT/PST
			TOTAL 5601 98

Invoice

To

Harold T. Griggs
Marathon, Ontario

From

Raymond A. Bernatchez, P. Eng.
Consulting Geologist
Box 1376, 126 Willow Road
Atikokan, Ontario, P0T 1C0

For services rendered: Magnetic survey, geological mapping, report and map.

Magnetic survey 5.5km @ \$ 125.00/km.....	\$ 687.50
Geological mapping 1days @ \$450.00/day.....	\$ 450.00
Geological report and map 1 day @ \$450.00/day.....	\$ 450.00
Hotel room 1 day @ \$78.94/day.....	\$ 78.94
Gas 1 days @ \$32.89/day.....	\$ 32.89
Meals 1 days @ \$16.25/day.....	\$ 16.25
Sub-total.....	\$ 1,715.58
GST 7% on \$ 1,587.50.....	\$ 111.13
Total.....	\$ 1,826.70



ALS Chemex

EXCELLENCE IN ANALYTICAL CHEMISTRY

ALS Canada Ltd

212 Brooksbank Avenue
North Vancouver BC V7J 2C1

Phone: 604 984 0221 Fax: 604 984 0218 www.alschemex.com

To: FOWLER, BRIAN
PO BOX 2174
APT 19, 3 HELMO DR
MARATHON ON P0T 2E0

INVOICE NUMBER 1269128

BILLING INFORMATION

Certificate: **TB05070633**
Account: **KBS**
Date: **3-SEP-2005**
Project: LUNNY LAKE
P.O. No.:
Quote:
Terms: **Due on Receipt** C1
Comments:

ANALYSED FOR			UNIT	TOTAL
QUANTITY	CODE	DESCRIPTION	PRICE	
1	BAT-01	Administration Fee	30.00	30.00
8	PREP-31	Crush, Split, Pulverize	6.00	48.00
4.76	PREP-31	Weight Charge (kg) - Crush, Split, Pulverize	0.25	1.19
8	ME-ICP41	34 Element Aqua Regia ICP-AES	6.50	52.00
8	GEO-AR01	Aqua regia digestion	2.50	20.00
8	Au-ICP21	Au 30g FA ICP-AES Finish	13.50	108.00

To: FOWLER, BRIAN
PO BOX 2174
APT 19, 3 HELMO DR
MARATHON ON P0T 2E0

*Paid via chq # 4
Sept 28/05*

SUBTOTAL (CAD)	\$	259.19
R100938885 GST	\$	18.14
TOTAL PAYABLE (CAD)	\$	<u>277.33</u>

Payment may be made by: Cheque or Bank Transfer

Beneficiary Name:	ALS Canada Ltd.
Bank:	Royal Bank of Canada
SWIFT:	ROYCCAT2
Address:	Vancouver, BC, CAN
Account:	003-00010-1001098

Please Remit Payments To :
ALS Chemex
212 Brooksbank Avenue
North Vancouver BC V7J 2C1

CHALTREK GEOLOGICAL
581-11TH AVENUE F7B2R5
THUNDER BAY ON 50018036

Name: *BIZIAN FOWLER*
Acct # 5491395015717324

Date 05/09/06 Time 16 03 51
Exp Date 0905 Auth # 274392
Card Type MC Tran Code 00
N22360479001 001321005

Subtotal
Tax
Total \$87.98

Signature X TELEPHONE
I agree to pay above total amount
according to card issuer agreement
Retain this copy for your records

Top copy-customer Bottom copy-merchant

LIABILITY FOR LOSS, DAMAGE OR DELAY IS LIMITED BY CARRIER.
 LIABILITY LIMITED TO \$50 FOR LOSS OR DAMAGE UNLESS OTHERWISE SPECIFIED.
 UNLESS A GREATER VALUE DECLARED AT TIME OF SHIPPING. REFER TO
 TERMS AND CONDITIONS OF CARRIER FOR DETAILS OR CONSULT AGENT.



GREYHOUND LINES OF CANADA

GST NO. 891646655RT1 WAYBILL NO. 71435636580

THUNDER BAY ON		MARATHON 435 222406	
PREPAID CASH		09/12/05 12:33 PM 4	
CONSIGNEE		ACTUAL WEIGHT 12.0 LBS	
CHEMEX LABS		DECLARED VALUE 100.00	
THUNDER BAY ON		REF: 1 PIECE	
SHIPPER		EXPRESS 12.41	
BRIAN FOWLER		CSTON 0.87	
MARATHON ON		TOTAL 13.28	
REFERENCE:			

SHIPPER RECEIPT

STATION TO STATION

FORM 256 REV 01/18/03

2.30682

GREYHOUND LINES OF CANADA

GST NO. 891646655RT1 WAYBILL NO. 71435637162

LIABILITY FOR LOSS, DAMAGE OR DELAY IS LIMITED BY CARRIER
LIABILITY LIMITED TO \$50 FOR LOSS OR DAMAGE UNLESS OTHERWISE OCCASIONED
UNLESS A GREATER VALUE DECLARED AT TIME OF SHIPPING REFER TO
TERMS AND CONDITIONS OF CARRIER FOR DETAILS OR CONSULT AGENT.



THUNDER BAY ON
PREPAID CASH

MARATHON 435 222633
09/17/05 6:11 PM 4
ACTUAL WEIGHT 12.0 LBS
DECLARED VALUE 100.00

CONSIGNEE

REF:

1 PIECE

CHEMEX LABS

EXPRESS 12.41
GSTON 0.87

THUNDER BAY ON

475-3329

SHIPPER
BRIAN FOWLER

MARATHON ON
REFERENCE:

TOTAL 13.28

SHIPPER RECEIPT

STATION TO STATION

FORM 256 REV 01/10/03

Received from Harold Griggs \$600.00 for prospecting assistance on the Musher Lake Property between August 20th and September 17th.

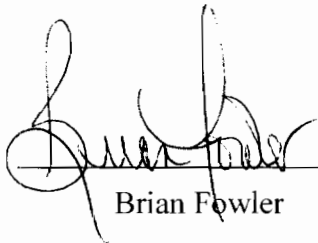

Brian Fowler

September 17th, 2005

Date



ALS Chemex

EXCELLENCE IN ANALYTICAL CHEMISTRY

ALS Canada Ltd.

212 Brooksbank Avenue
North Vancouver BC V7J 2C1

Phone 604 984 0221 Fax 604 984 0218 www.alschemex.com

To: FOWLER, BRIAN
PO BOX 2174
APT 19, 3 HELMO DR
MARATHON ON POT 2E0

INVOICE NUMBER 1297792

BILLING INFORMATION

Certificate: **TB05076904**
Account: **KBS**
Date: **26-SEP-2005**
Project: **MUSHER LAKE**
P.O. No.:
Quote:
Terms: **Due on Receipt** C1
Comments:

ANALYSED FOR			UNIT	TOTAL
QUANTITY	CODE	DESCRIPTION	PRICE	
1	BAT-01	Administration Fee	30.00	30.00
9	PREP-31	Crush, Split, Pulverize	6.00	54.00
5.03	PREP-31	Weight Charge (kg) - Crush, Split, Pulverize	0.25	1.26
9	Au-ICP21	Au 30g FA ICP-AES Finish	13.50	121.50
9	ME-ICP41	34 Element Aqua Regia ICP-AES	6.50	58.50
9	GEO-AR01	Aqua regia digestion	2.50	22.50

SUBTOTAL (CAD) \$ 287.76

R100938885 GST \$ 20.14

TOTAL PAYABLE (CAD) \$ 307.90

To: FOWLER, BRIAN
PO BOX 2174
APT 19, 3 HELMO DR
MARATHON ON POT 2E0

Payment may be made by: Cheque or Bank Transfer

Beneficiary Name: ALS Canada Ltd.
Bank: Royal Bank of Canada
SWIFT: ROYCCAT2
Address: Vancouver, BC, CAN
Account: 003-00010-1001098

Please Remit Payments To :
ALS Chemex
212 Brooksbank Avenue
North Vancouver BC V7J 2C1



ALS Chemex

EXCELLENCE IN ANALYTICAL CHEMISTRY

ALS Canada Ltd.

212 Brooksbank Avenue
North Vancouver BC V7J 2C1

Phone: 604 984 0221 Fax: 604 984 0218 www.alschemex.com

To: **FOWLER, BRIAN**
PO BOX 2174
APT 19, 3 HELMO DR
MARATHON ON P0T 2E0

INVOICE NUMBER 1301831

BILLING INFORMATION

Certificate: **TB05077399**
Account: **KBS**
Date: **28-SEP-2005**
Project: **MUSHER LAKE**
P.O. No.:
Quote:
Terms: **Due on Receipt** C1
Comments:

ANALYSED FOR			UNIT	
QUANTITY	CODE	DESCRIPTION	PRICE	TOTAL
1	BAT-01	Administration Fee	30.00	30.00
10	PREP-31	Crush, Split, Pulverize	6.00	60.00
5.07	PREP-31	Weight Charge (kg) - Crush, Split, Pulverize	0.25	1.27
10	Au-ICP21	Au 30g FA ICP-AES Finish	13.50	135.00
10	ME-ICP41	34 Element Aqua Regia ICP-AES	6.50	65.00
10	GEO-AR01	Aqua regia digestion	2.50	25.00

SUBTOTAL (CAD) \$ 316.27

R100938885 GST \$ 22.14

TOTAL PAYABLE (CAD) \$ 338.41

To: **FOWLER, BRIAN**
PO BOX 2174
APT 19, 3 HELMO DR
MARATHON ON P0T 2E0

Payment may be made by: Cheque or Bank Transfer

Beneficiary Name: ALS Canada Ltd.
Bank: Royal Bank of Canada
SWIFT: ROYCCAT2
Address: Vancouver, BC, CAN
Account: 003-00010-1001098

Please Remit Payments To :
ALS Chemex
212 Brooksbank Avenue
North Vancouver BC V7J 2C1

Musher Lake Property

PROPERTY GEOLOGY

2.30682

Legend

- 1 ■ mafic volcanic
- 2 ■ intermediate volcanic
- 3 ■ felsic volcanic / Porphyry
- - - rock contact
- rock outcrop
- road
- ⊙ drill hole
- ⋆ Swamp
- ▨ VLF conductor
- 19 → ● rock sample

- ↘ creek
- ⌋ trench

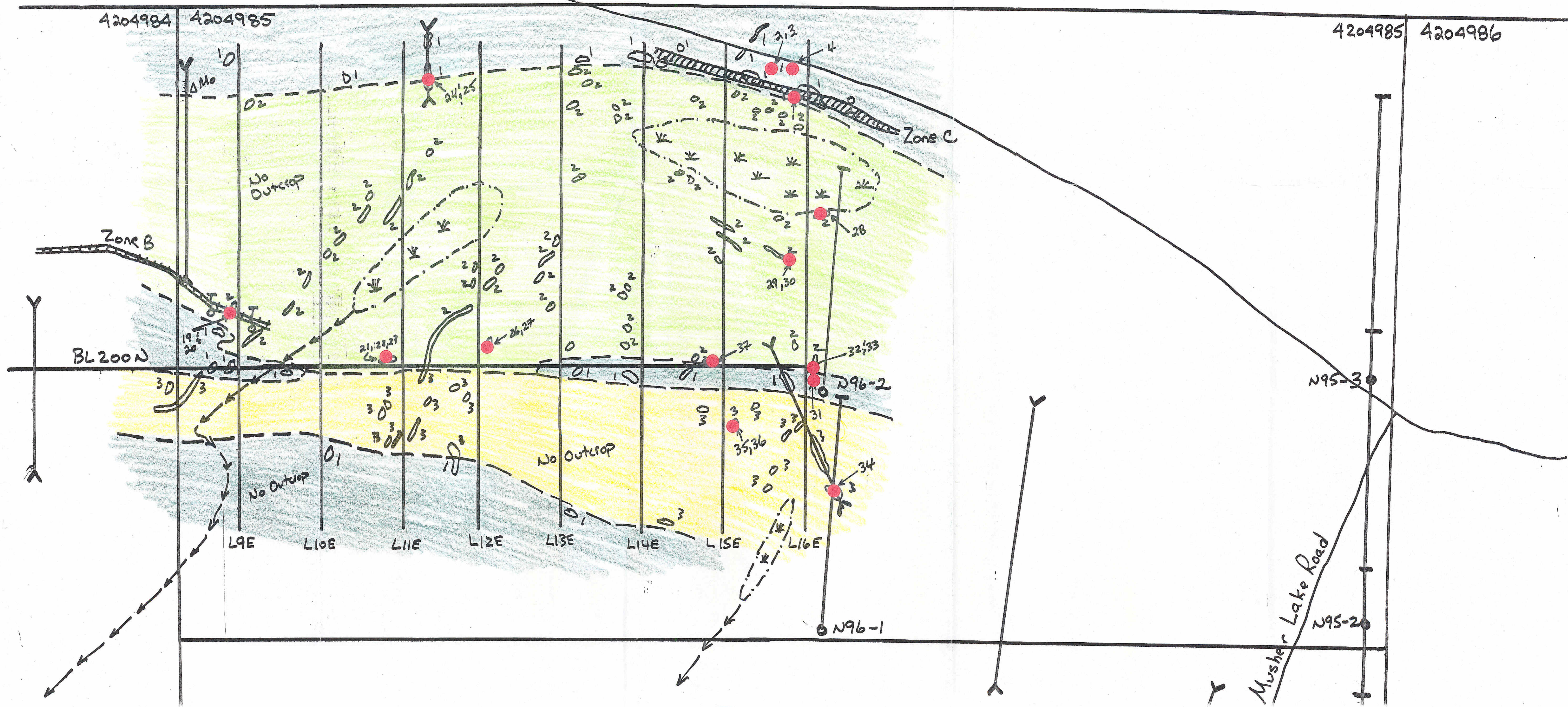
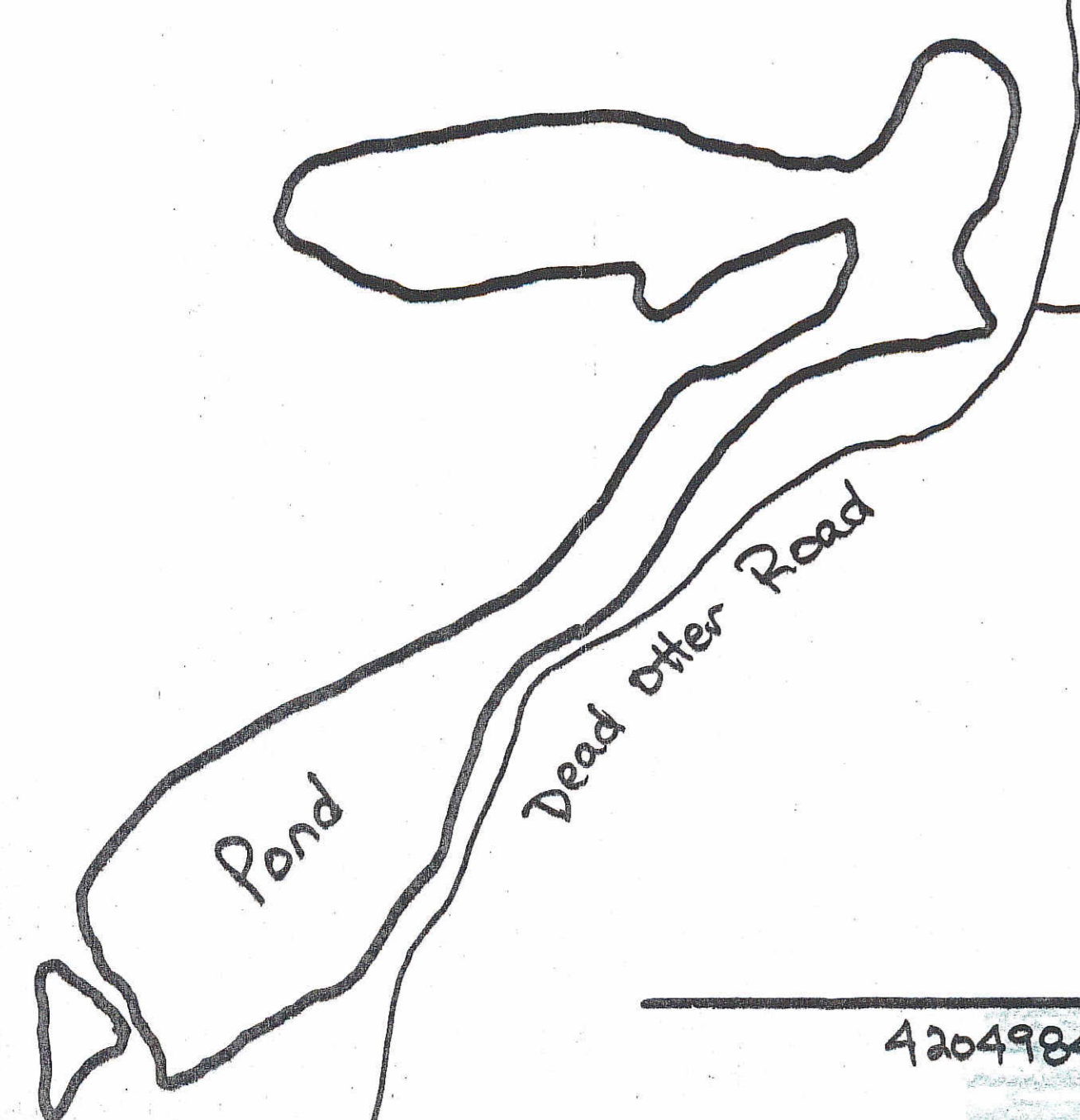
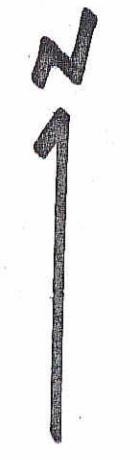

Scale - 1: 2500
 Drawn by - Brian Fowler
 Date - October 2005
 NTS - 42C13