

2-42692

Prospecting Report

September 22, 2009

Todd Mathieu

Owaissa Property

Best Township/Strathy Township

Sudbury Mining Division



Table of Contents

Property Location	Page 3
Access	Page 3
Owaissa Property Claim Group	Page 3
Brief Summary of Work Completed, Discoveries, Theories.....	Page 3 - 4
Forward Looking Statements	Page 4
Appendix.....	Page 5-25

Property Location

The property is located approximately 11 km north of the town of Temagami and approximately 108 km north of the town of North Bay. The property resides in the south part of Best Township and the north part of Strathy Township.

Access

There is excellent access to most portions of the property.

On the north section access is gained through the use of the Whispering Pines cemetery road. Where the road hits the pipeline it turns into an ATV/walking trail that proceeds to Owaissa Lake. There is also a portage trail branching off shortly before Owaissa Lake that heads north to a tiny lake on the north portion of the claims. In late 2006 Temex Exploration proceeded to open up a skidder/drill road that proceeds north of the claim group off of this ATV/walking trail.

On the south part of the Owaissa property access is gained via Red Squirrel road and or by boat via Net Lake or Black Duck Lake.

Owaissa Property Claim Group

The Owaissa property currently consists of 9 claim blocks totalling 72 claims. The property consists of the following claim blocks.

4212255 – block of 8 – Best twp.
4248081 – block of 3 – Best twp.
1223732 – block of 9 – Best twp.
4227412 – block of 12 – Best twp.
4212254 – block of 2 – Best twp.
4227417 – block of 9 – Best/Strathy twp.
1223725 – block of 6 – Strathy twp.
4212253 – block of 7 – Strathy twp.
4227393 – block of 16 – Strathy twp.

Brief Summary of Work Completed, Discoveries, Theories,

The Owaissa property begins approximately 2.6 km northeast of the Kanichee mine (past producer - old Ajax property). The property continues for approximately 7km to the northeast. Most geologic structures on the property appear to be trending directly north or northeast. This leads me to believe that the Owaissa property is on trend with the Kanichee mine and may contain similar geological structures. Further north of the property lies the Latchford Gold Project (notably the location of the 6,222 g/t Au chip sampled boulder containing VG) held by Temex Exploration.

Additional detailed prospecting and light trenching has been completed in the vicinity of the Mathieu showing on claim 1223725. A new similar intrusive structure, known as sample location ZA was located northeast of the Mathieu Zone. To date ZA appears to be the widest intrusive structure carrying similar mineralization to the Mathieu showing.

Also a new series of intrusive structures was discovered approximately 186 meters to the northwest of the Y zone of the Mathieu showing. The new series of intrusive structures appear to run parallel to one another at 13 degrees east of magnetic north with a slight dip to the east. The new structures contain quartz, iron, minor iron sulphides and one in particular (sample zone Z) an extreme (approximately 80%) quantity of chalcopyrite, bornite and malachite staining. Due to the rich visible nature of the sulphides within the Z intrusive, it is my belief that the new series of intrusive structures are related to the Mathieu showing.

Additional prospecting was also completed along the southeast shore of Black Duck Lake and southwest of Owaissa Lake, but failed to produce any interesting results.

The discovery of the new set of parallel intrusive structures (Mathieu B) 186 meters northeast of the Mathieu showing indicates to me that the cross strike of the Mathieu showing maybe much larger then expected. The discovery of sample zone ZA has also increased the strike length of the Mathieu zone by 60 meters for a total strike of 138 meters.

One to two meters of overburden covers most of this area and so it is my belief a Beep Mat 8 would help delineate any additional intrusive structures carrying significant amounts of sulphides and that have broken surface. For the time being I continue to use detailed prospecting as my tool for locating additional mineralized zones and extending the cross strike and length of the Mathieu zone.

Forward Looking Statements

It is still my belief that the Owaissa property has been under explored. Over the course of the summer of 2009 I have had three creditable geologists on site who have agreed and are interested in the project.

The possible extensions of the Mathieu showing both to the northeast and northwest have significantly increased the possible size of the mineralized zone. Three samples have been sent to Swastika Laboratories for assaying.

Geophysics and mechanical stripping are required over the Mathieu showing to advance the project and delineate the host structure at depth. At a very minimum it is my belief that the use of a Beep Mat 8 would increase the chances of locating additional intrusive structures carrying similar mineralization to the Mathieu showing.

I will continue to develop the project while seeking a reputable company to option the property.

Appendix

Mathieu, Todd Anthony Claim Groups

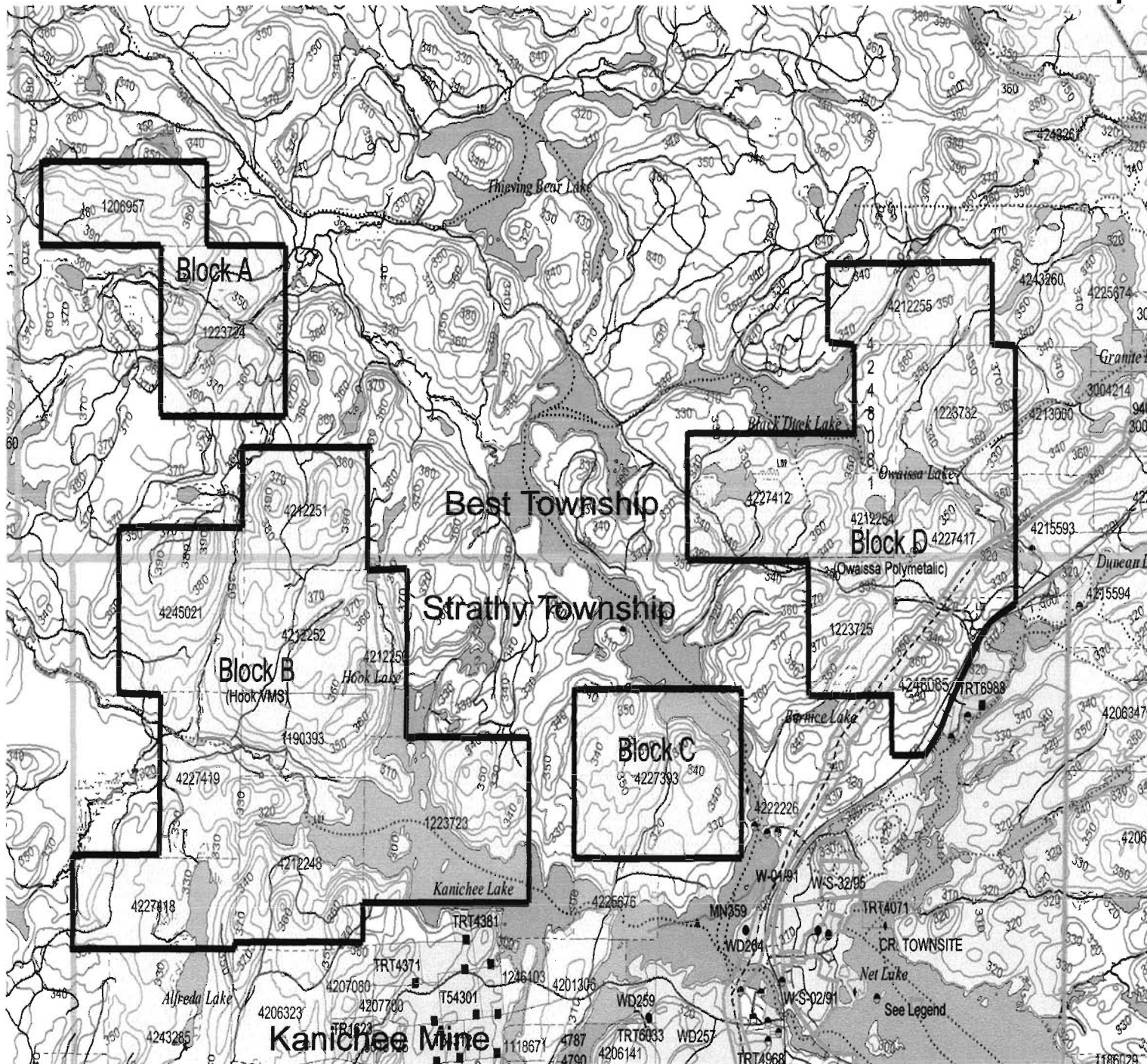
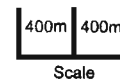

mathieu Showing VS New Intrusives - GPS Locations

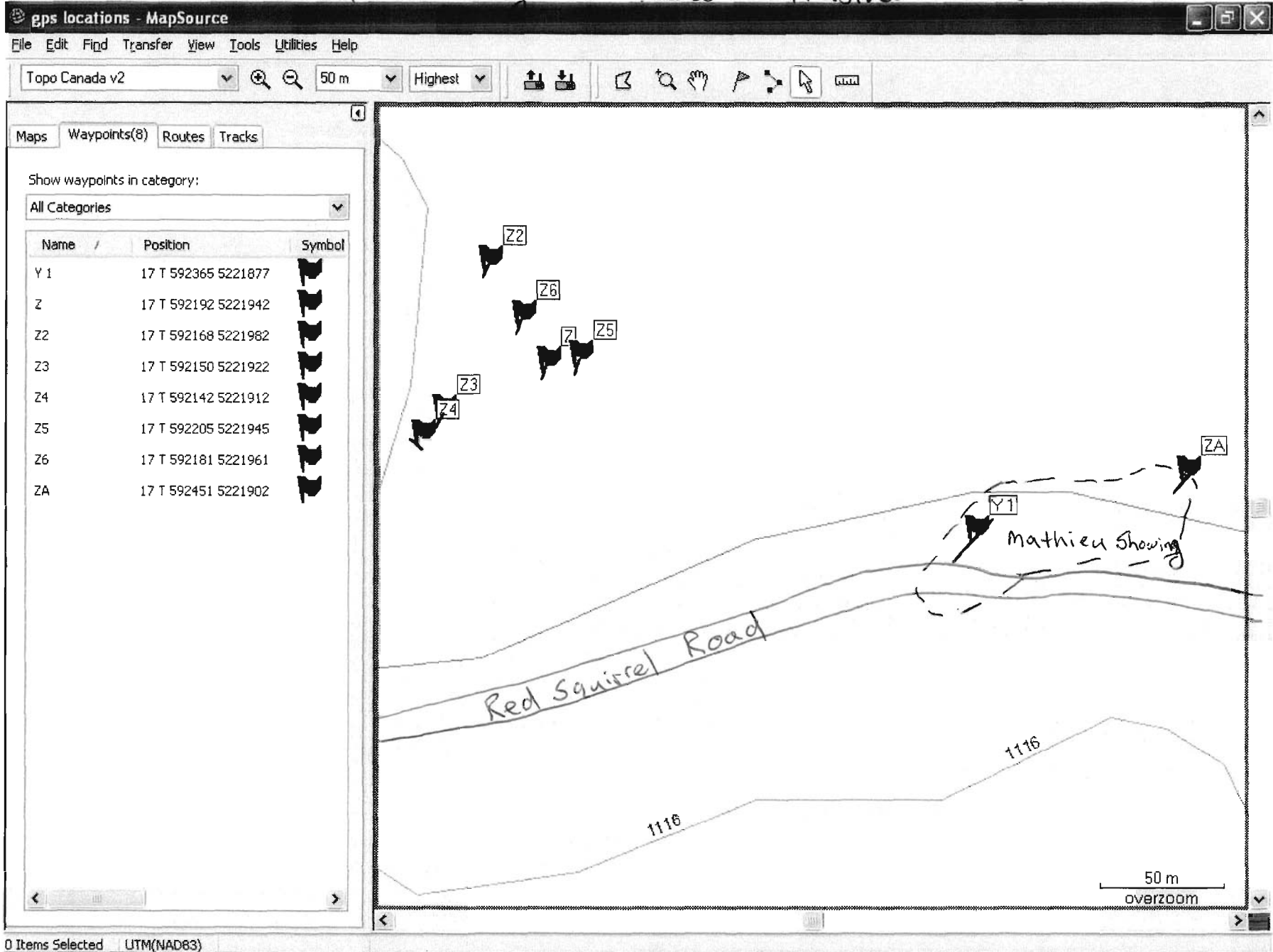

N

Z2
Z6 Z5
Z3 Z
Z4

Y1 Y4
V1&2
T
S
ZA

U-road

Red Square 158

101 m

© 2009 Tele Atlas
Image © 2009 DigitalGlobe

2005 Google

Owaissa Property - Mathieu Sampling - Historic

Sample	Notes	Au (gpt)	Au (gpt) check	Ag (ppm)	Co (ppm)	Cu (ppm)	Ni (ppm)	Zn (ppm)	Pt (gpt)	Pd (gpt)
A-04-06-1		0.05		0.1	n/a	481	n/a	n/a	n/a	n/a
A-04-06-2	All 4 A samples within the same intrusive	0.1		1.6	n/a	7410	n/a	n/a	n/a	n/a
A-04-06-3		0.04		0.2	20	5450	40	129	n/a	n/a
B-04-06-1		0.01		0.1	n/a	112	n/a	n/a	n/a	n/a
A-05-06-1	Solid sample of sulfides from A intrusive	0.08				87700			n/a	n/a
C-05-06-1		0.02		<0.2	24	491	19	108	n/a	n/a
D-05-06-1	No GPS location -located and sample by brother	0.03		<0.2	9	749	13	48	n/a	n/a
E-05-06-1		0.02		<0.2	34	52	61	113	n/a	n/a
F-05-06-1	No GPS location - rough location on map	0.05		<0.2	15	89	46	38	n/a	n/a
G-05-06-1		n/a		<0.2	35	52	29	79	n/a	n/a
H-05-06-1		0.01		0.1		29	6		<.005	0.01
H-06-06-2		0.002		<.02	11	<1	10	52	<.005	<.005
H-06-06-3		0.002		<.02	10	<1	8	49	<.005	<.005
I-10-06-1	Few hundred meters east of H - rough location on map	0.086		<.02	12	3	12	46	n/a	n/a
		0.02		n/a	n/a	n/a	n/a	n/a	n/a	n/a
K-10-06-1		0.075		3.9	27	197000	33	49	<.005	<.005
L-10-06-1	No GPS - 2 inch quartz vein approx. 12m northwest of sample K	0.01		<.02	8	312	33	46	n/a	n/a
M-10-06-1		n/a		<.02	41	1347	637	186	<.005	<.005
N-10-06-1	All 3 were along same outcrop - several phases of Lamprophre dikes	n/a		<.02	34	38	524	131	<.005	<.005
O-10-06-1		n/a		<.02	20	106	194	36	n/a	n/a
R	Resample of sample L.	n/a		<.02	45	169	61	190	n/a	n/a
S		0.302	0.309	90.8	417	239600	55	402	n/a	n/a

T		1.416		12	34	11900	67	34	n/a	n/a
U		1.008		43.5	536	57400	106	126	<.005	<.005
V1	both from same intrusive	5.074	4.999	192	>10000	23200	712	7061	<.005	<.005
V2		2.441		23	1189	11100	116	2068	n/a	n/a
J		n/a		<.02	29	3090	19	67	n/a	n/a
X	East Southeast of sample U - about 50m up the road	n/a		<.02	55	293	44	88	n/a	n/a
Y-1		16.869	15.909	122.6	>10000	137900	667	655	n/a	n/a
Y-2		9.257	8.434	50	4910	35400	152	169	<.005	<.005
Y-3		17.143	21.12	37.5	>10000	63500	256	289	<.005	<.005
Y-4-07		3.593	3.49	110	4130	>10000	117	386	n/a	n/a
Y-5-07	1.5 ft west of Y-4-07	nil	nil	1.6		145			n/a	n/a

Legend

Symbol	Description
C	Cedar
P	Pines
M	Mixed
H	Hardwoods
S	Swamp



Declination
11° 25' West

Scale
1 inch = 200m

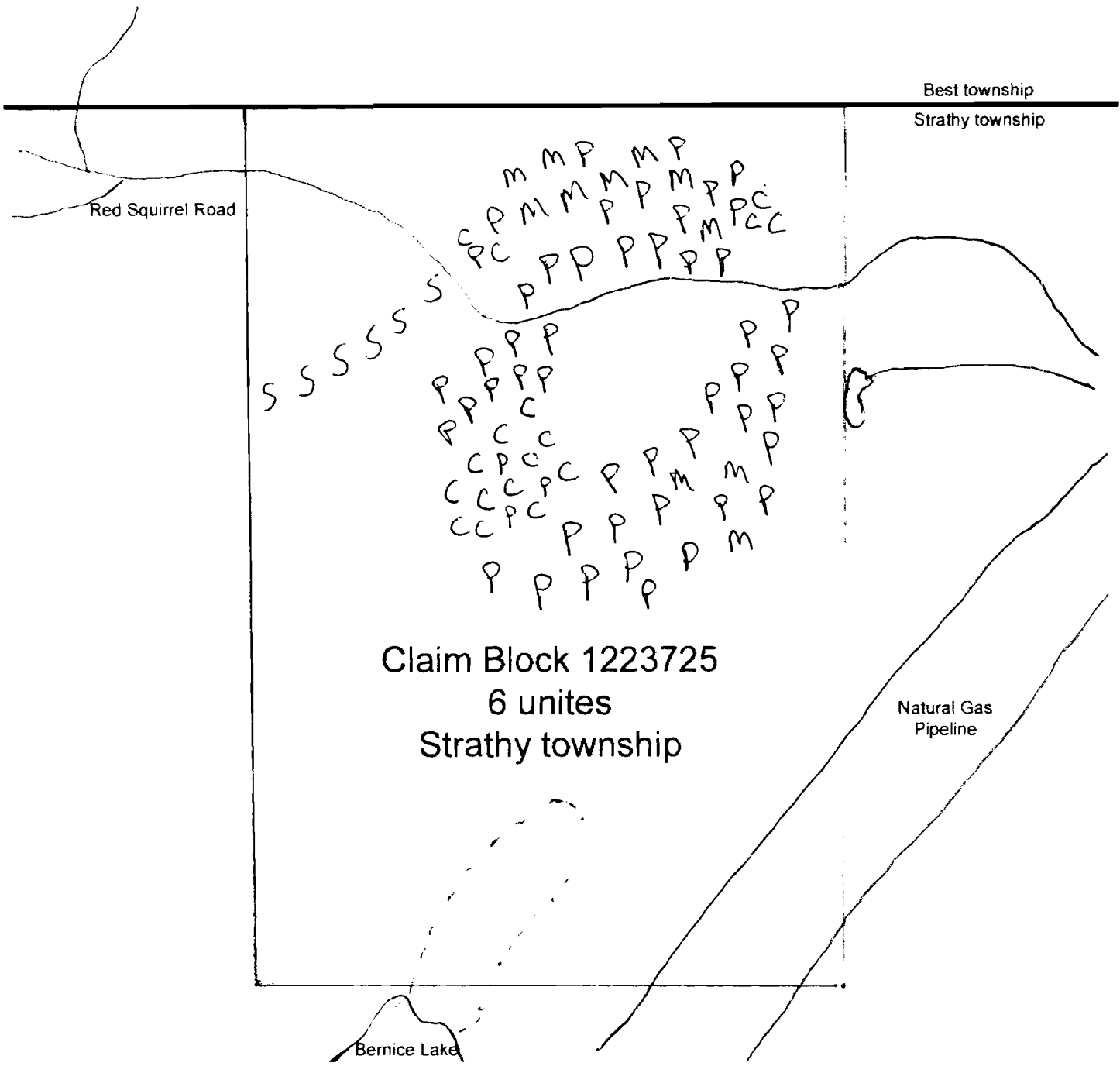
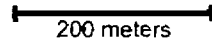

Legend

Symbol	Description
C	Cedar
P	Pines
M	Mixed
H	Hardwoods
S	Swamp



Declination
11° 25' West

Scale
1 inch = 200m

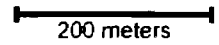

Black Duck Camp ■

Black Duck Lake

Claim Block 4227412
12 unites
Best township

Red Squirrel Road

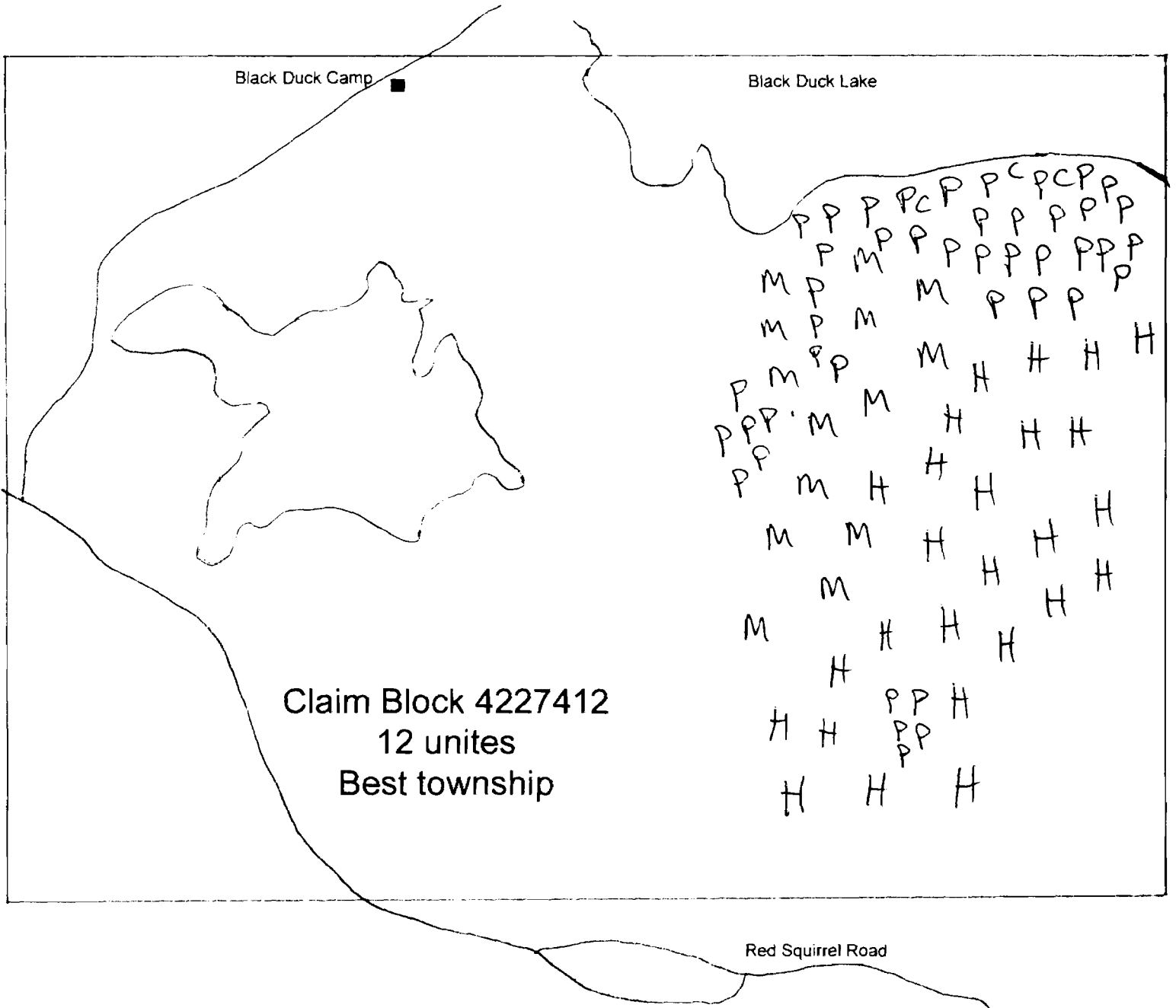

Legend

Symbol	Description
C	Cedar
P	Pines
M	Mixed
H	Hardwoods
S	Swamp



Declination
11° 25' West

Scale
1 inch = 200m

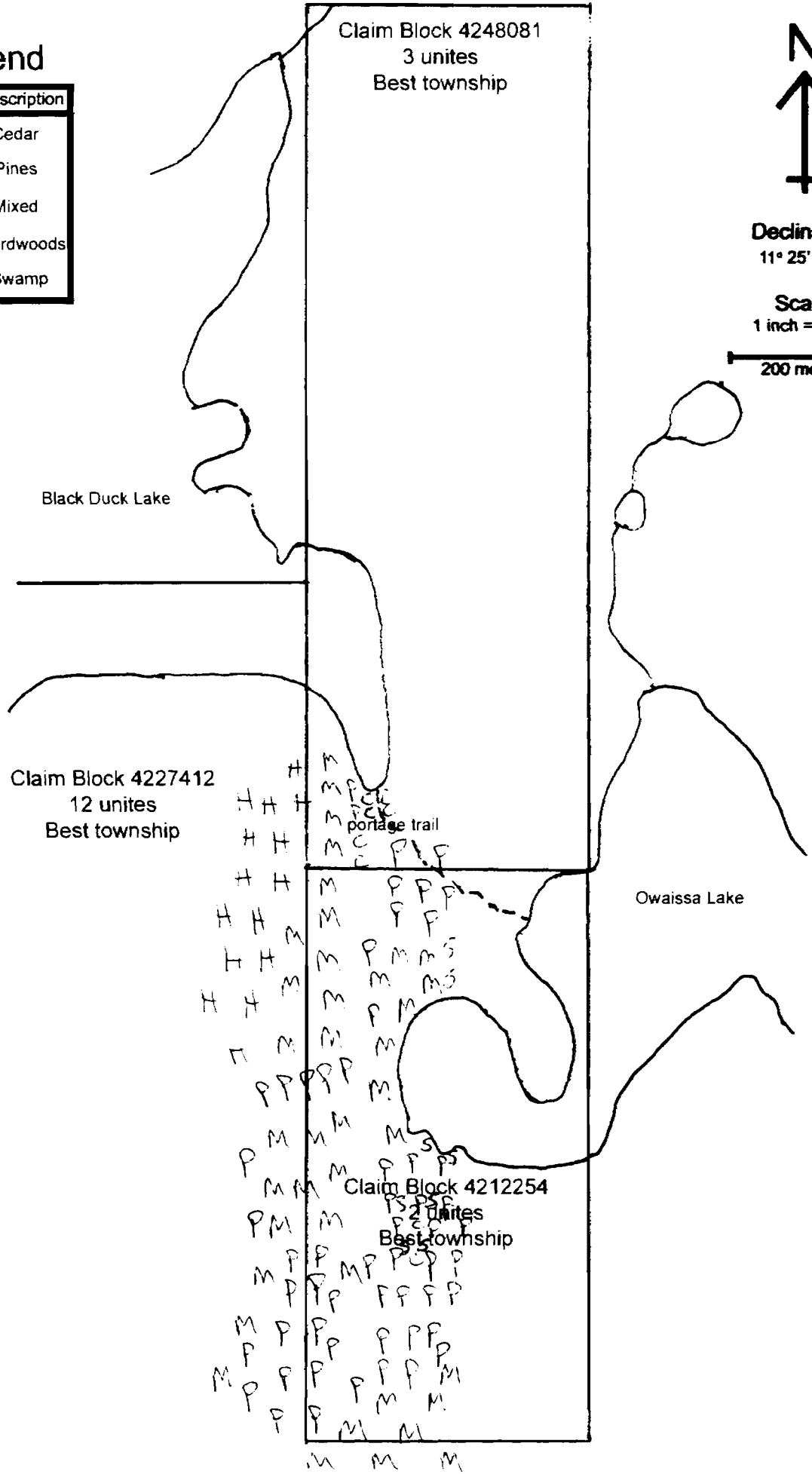

Days Worked

Date	Claim Number Worked	Mileage in KM	Mileage Sub Total (\$0.40/km)	Assays	Person	Portion of day worked	Total Worked	Claim 1223725	Claim 4227412	Claim 4212254	
01-May-09	1223725	258	\$103.20	\$0.00	Todd Mathieu	0.5	\$100.00	\$203.20			
19-Jul-09	1223725	256	\$102.40	\$0.00	Todd Mathieu	1	\$200.00	\$302.40			
03-Aug-09	1223725	262	\$104.80	\$0.00	Todd Mathieu	0.5	\$100.00	\$204.80			
26-Aug-09	4227412	127	\$50.80	\$0.00	Todd Mathieu	1	\$200.00		\$450.80		
				\$0.00	Jimmy Mathieu	1	\$200.00				
27-Aug-09	4227412 / 4212254	127	\$50.80	\$0.00	Todd Mathieu	1	\$200.00		\$225.40	\$225.40	
				\$0.00	Jimmy Mathieu	1	\$200.00				
20-Sep-09	1223725	258	\$103.20	\$0.00	Todd Mathieu	1	\$200.00	\$303.20			
22-Sep-09	report/mapping	0	\$0.00	\$0.00	Todd Mathieu	1	\$200.00	\$66.67	\$66.67	\$66.67	Sub Total
Sub total		1030	\$515.20	\$0.00		8	\$1,600.00	\$1,080.27	\$742.87	\$292.07	\$2,115.20

Sub Total \$2,115.20

Final Total \$2,115.20

Daily Log
May 2009 to September 2009
Owaissa Property
Best Township/Strathy Township
Sudbury Mining Division

Participants

Todd Mathieu	<u>Todd Mathieu</u> Signature	<u>September 22, 2009</u> Date
Jimmy Mathieu	<u>Jimmy Mathieu</u> Signature	<u>Sept. 23, 2009</u> Date

May 9, 2009

I traveled to Temagami and mobilized equipment to site. Intention this trip was to strip back small amounts of the intrusive showings along Red Squirrel Road and a detailed prospecting trip along the northern edge of the Mathieu showing. After proceeding with the additional stripping along the road to properly expose and examine the intrusive structures I proceeded north. Upon intersecting the run off ditch to the northeast of the Mathieu showing I came across another intrusive structure containing what I believe to be pyrite, chalcopyrite (with malachite staining) and an iron sulphide (possible pyrrhotite). This new discovery extends the Mathieu showing 60 meters to the northeast. A majority of the sulphides are very fine-grained and only visible under a glass. Several samples were taken and contained what I believe to be approximately 1-2 % sulphides on average. The intrusive structure widens to approximately 3 feet wide. Sample ZA was taken and will be sent for assaying.

Todd Mathieu ½ day (claim # 1223725)

Mileage = 258km

July 19, 2009

I traveled to Temagami and mobilized equipment to site. Intention this trip was to proceed with detailed prospecting to the west and southwest of the Mathieu showing. Proceeding south of Red Squirrel Road I traversed from ridge to ridge examining anything that appeared to be related to the Mathieu showings intrusive nature. One entire ridge appears to be made up of a very soft type of rock containing a variety of minerals such as quartz, iron, and mica. It is very similar to the iron pile of sand/boulders directly on Red Squirrel Road and is part of the northwest/southeast dike. Most of the area to the south west of the Mathieu showing was overburden covered.

Unable to locate anything of interest I proceeded directly northwest of the Mathieu showing. On the opposite side of this ridge I located an intrusive structure very similar to the Mathieu showing. It is approximately half an inch thick and appears to be 80% sulphides. It appears to be chalcopyrite and bornite with heavy iron and what I believe to be malachite staining. The intrusive appears to be heading 13 degrees northeast of magnetic north and has a slight dip to the east. This new showing is approximately 186 meters northeast of the last known intrusive structure on the Mathieu showing (cross strike). I have labelled this new sulphide intrusive as sample location Z and a sample has been sent for assaying.

In addition I located 3 other thin intrusive structures (Z2, Z3, Z4) containing quartz, iron, and in some cases less than one percent sulphides. Intrusive structures Z2 and Z3 are heading approximately 13 degrees east of magnetic north and have a slight dip to the east. Sample Z3 has been sent for assaying. Sample Z4 appears to be heading 47 degrees west of magnetic north.

Todd Mathieu 1 day (claim #1223725)

Mileage = 256km

Date: May 9, 2009



Team members:

Todd Mathieu 1/2 day

Interesting Discoveries:

ZA-1 - 3 Feet intrusive of
2% sulphides, chalcopyrite +
Malachite staining, iron sulfides

Legend

Symbol	Description
	Outcrop
	sample name and sample location
	direction of line traversed



Declination
11° 25' West

Scale
1 inch = 200m

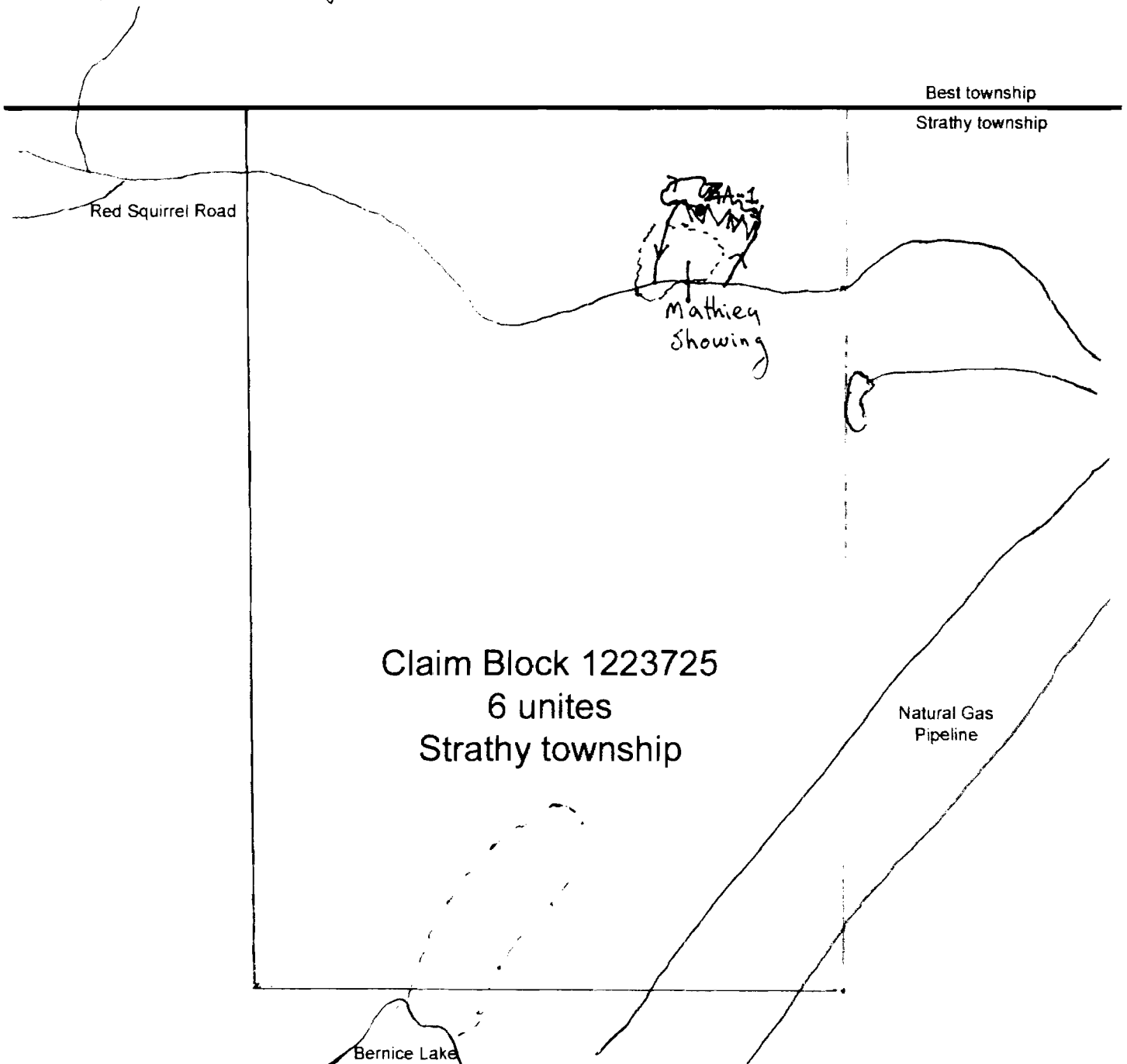
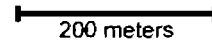

Date: July 19, 2009

Team members:

Todd Mathieu today



Interesting Discoveries:

3^m parallel intrusives (quartz + iron)

Z intrusive - 1/2 inch vein of
80% sulphides, chalcopyrite, bornite
iron/sulphide, malachite staining
iron/rust

1 intrusive of bluish rock with iron
sulphides + rust.

Legend

Symbol	Description
	Outcrop
	sample name and sample location
	direction of line traversed



Declination
11° 25' West

Scale
1 inch = 200m

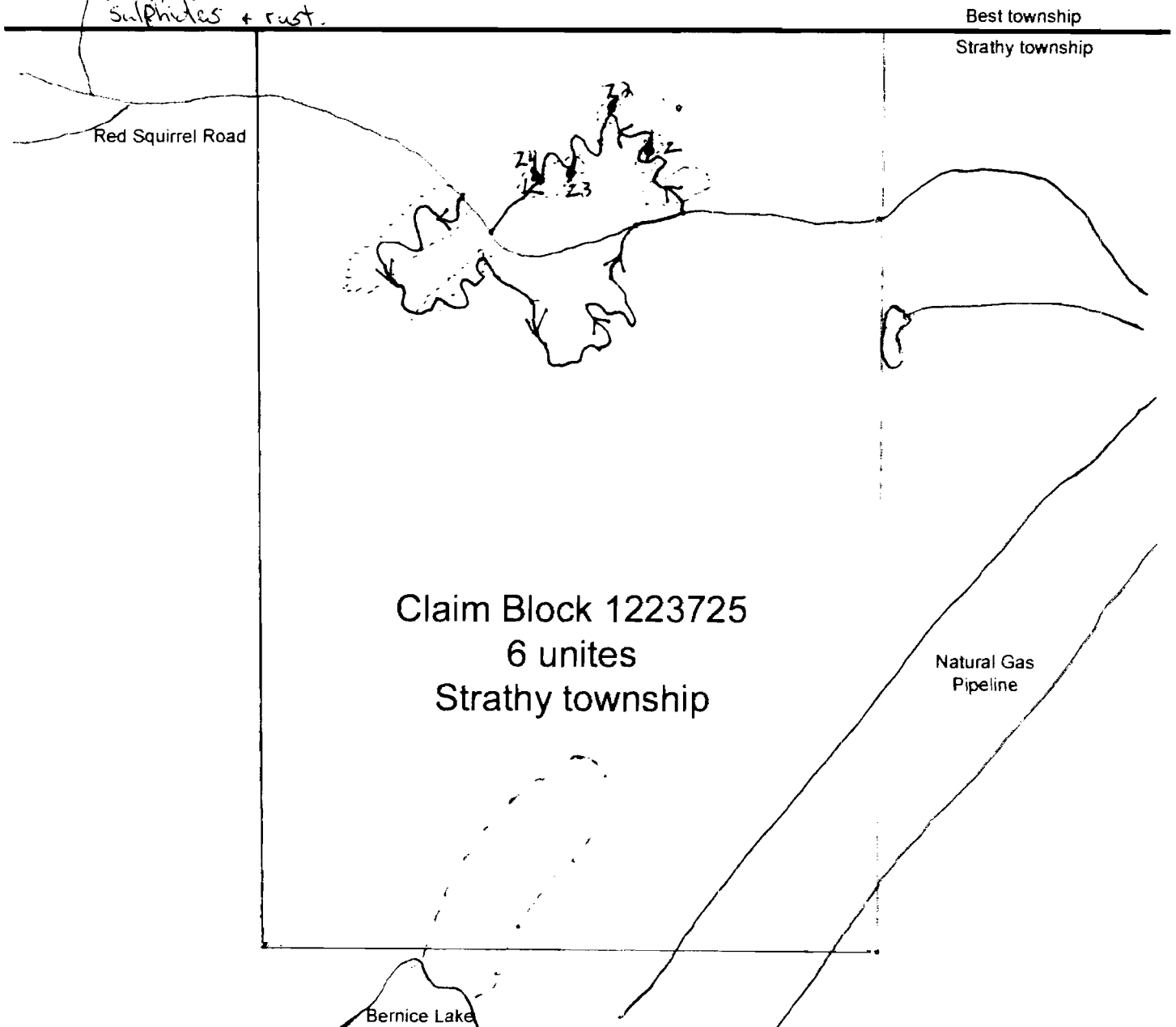
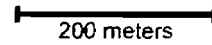

August 3, 2009

I travelled to Temagami and mobilized equipment. Intention this trip was to re examine the structures found on July 19, 2009 that I had now plotted on my current map and distinguish how they relate to the Mathieu showing.

A new intrusive structure (Z5) was located approximately 14 meters to the northeast. It appears to contain quartz and iron and is approximately one eighth to a quarter inch wide. It heads approximately 13 degrees northeast of magnetic north and dips slightly to the east. It appears the new series of intrusive structures are related to a portion of the outcrop that has seen general trending/fracturing/shearing in a northeast/southwest direction.

Additional prospecting was completed to the north, east and southeast of the new intrusive sulphide showing referred to as Z. Unfortunately a meter or more of overburden covers a majority of the area prospected.

Todd Mathieu ½ day (claim # 1223725)

Mileage = 262km

August, 26, 2009

Jimmy Mathieu and I traveled to Temagami and mobilized equipment including a boat at the shore of Black Duck Lake. Our intension this day was to examine a key point of interest I had listed while examining the Temagami North Operation Treasure Hunt data.

We proceed via boat to the south shore of Black Duck Lake. We set our compasses to magnetic south, separated by approximately 50-60 meters and weaved our way south. During the prospecting I stopped to verify one of the points of interest. According to the Operation Treasure Hunt data there is an electromagnetic high in this area. While examining the magnetic data I noticed there is a magnetic low that appears to correspond with the EM high. I had attempted to locate this area previously but felt I was too far west. I now had the location recorded in my GPS. Unfortunately this location was at a low elevation location with significant boulders deposited. Could be an under ground stream or run off ditch which in turn maybe causing the EM high and it does run north/south which does resemble the EM high. We continued to proceed south approximately 900 meters from the south shore of Black Duck Lake. We crossed over to the east and proceeded back to Black Duck Lake. We once again crossed over along Black Duck Lake and proceeded to complete an additional loop. This loop we cut short and only proceeded approximately 400 meters from Black Duck Lake due to most of the area being within the old wood lot and overburden covered.

The area prospected resides along Black Duck Lake and up into an old wood lot. The area in the wood lot has significant overburden with rolling hills and fairly large timber. We were able to locate several outcrops along steep ridges and along Black Duck Lake, but all appeared to resemble white or pink granite. Jim noted one intrusive along Black Duck Lake. Approximately 8 inches wide, fine grained greenish bluish rock, no metallic mineralization.

Todd 1 day (claim # 4227412)

Jim 1 day (claim # 4227412)

Date: August 3, 2009



Team members:

Todd Mathews Yodag

Interesting Discoveries:

1/8 inch intrusive, quartz +
iron

Legend

Symbol	Description
	Outcrop
	sample name and sample location
	direction of line traversed



Declination
11° 25' West

Scale
1 inch = 200m

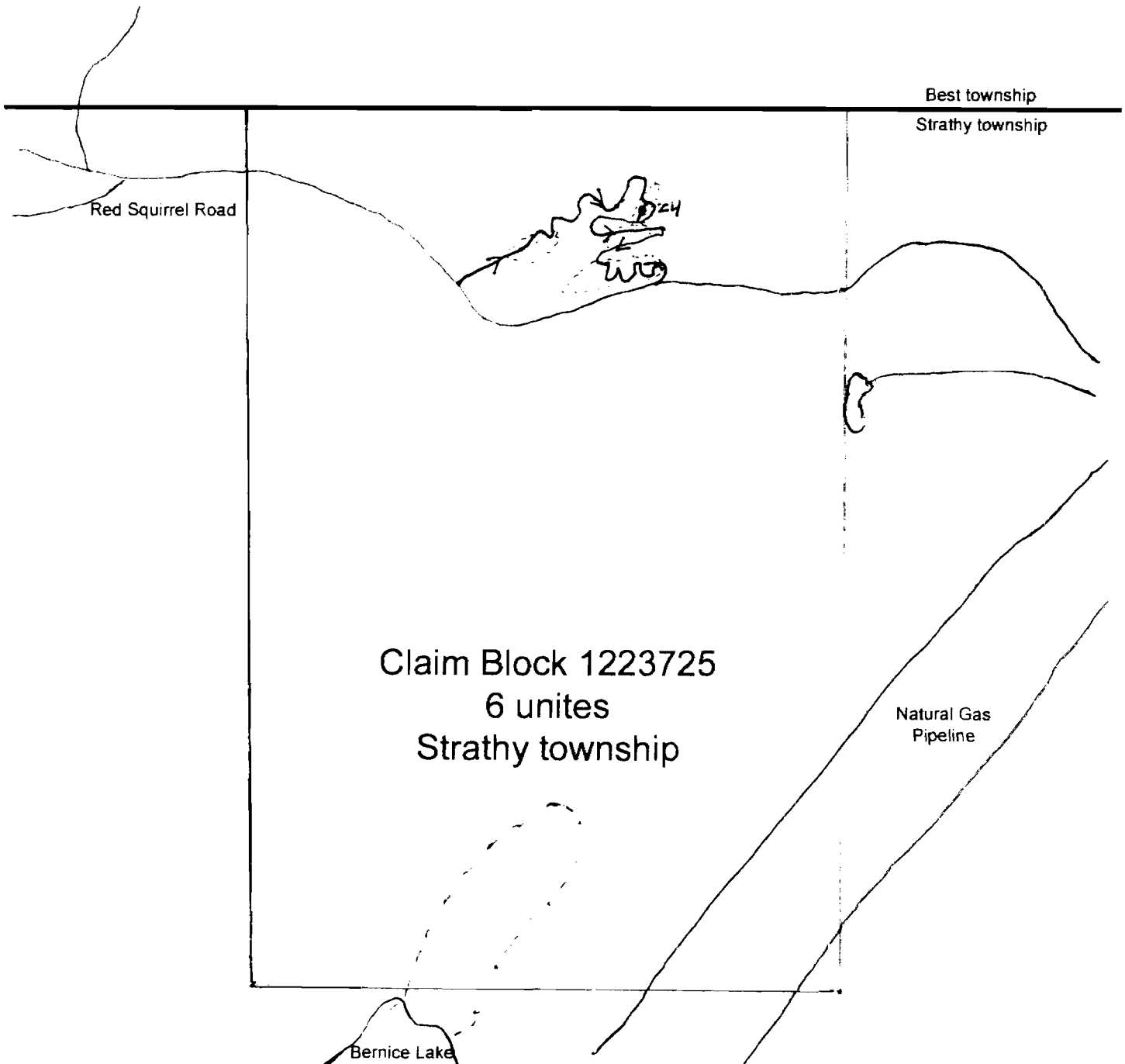
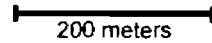

Date: August 26, 2009

Team members:



Todd Mathieu
Simmy Mathieu

Interesting Discoveries:

bluish green intrusive
8 inch.

All outcrops are granite

Legend

Symbol	Description
	Outcrop
	sample name and sample location
	direction of line traversed



Declination
11° 25' West

Scale
1 inch = 200m

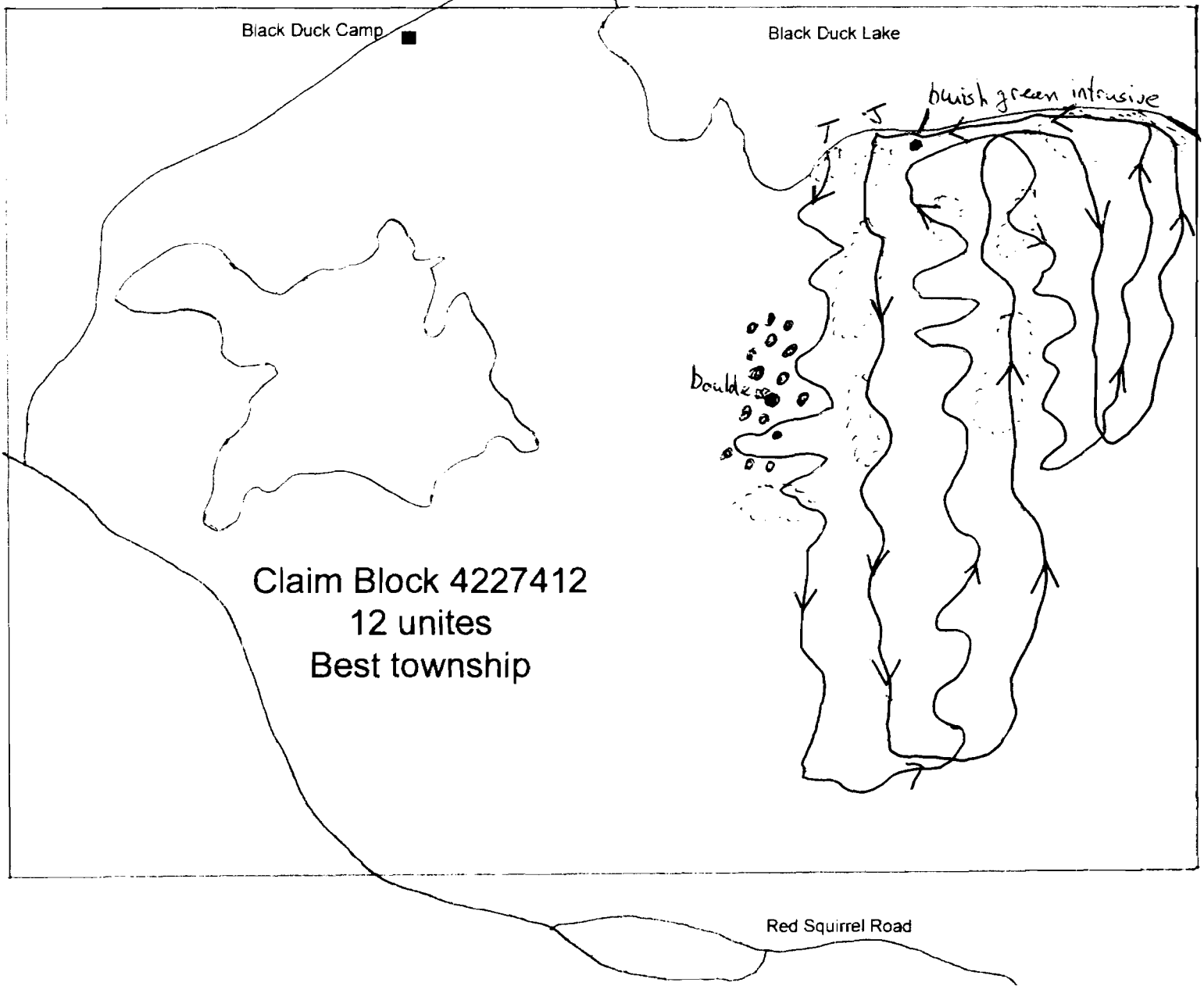
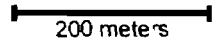

August 27, 2009

Jimmy Mathieu and I traveled via boat to the most southeast shore of Black Duck Lake. Intention this day was to prospect the geology along the west side of claim 4212254 and to obtain samples from two key points of interest.

Together we worked our way sampling up the ridge westward until we hit the number four corner post of claim 4212254. From the number four-corner post we separated by approximately 50-60 meters and began heading south. I proceeded down the west side of the north/south claim line while Jim prospected the claim line and to its east. I stopped to examine key point A that showed on the Operation Treasure Hunt data as a substantial increase in EM and resides along the northwest side of what I believe to be a northeast trending fault. Unfortunately it appears to be a run off ditch/creek system as it was a ditch with boulders and significant overburden in the entire area.

Both Jim and I examined key point B located close to the number three-corner post of claim 4212254. According to Operation Treasure Hunt data it demonstrates a slight increase in EM associated with a magnetic high and directly overlaying what I believe to be a northeast trending fault. The key point was located in a low-lying area with considerable short pine trees. We located a few spots where outcrop was near surface. We were unable to obtain any actual samples due to its smoothness and thickness of overburden, but the outcrop itself was weathered to a very soft sandy like surface. With my travel grub hoe I was able to scratch almost half a centimetre deep. The outcrop appears to be very much like several of the other outcrops I've sampled to the north along the same fault.

From corner post three; remaining 50 meters apart, we prospected east for approximately 75 meters. We then headed back north towards Owaissa Lake. The area up to Owaissa Lake was covered with swamp spruce and cedar swamps. Several boulders were sampled, but all appeared to be glacial till.

Together we sampled along Owaissa Lake sampling up each outcrop ridge that intersected the lake. Nothing of interest was noted, as all appear to be granite like. On the northwest corner of the westerly bay of Owaissa Lake I located one boulder that appears to be approximately 2 tones or larger. It appears to be volcanic/agglomerate as it have the appearance of volcanic bombs within it. It contains significant amounts of what appears to be an iron sulphide (possibly pyrrhotite) and chalcopyrite. Some malachite staining was also visible. We once again separated and continued sampling north. There was a considerable amount of outcrops in this area, but all appeared to be similar in nature and what we believe to be a granite like rock. The outcrops in this area did seem to be a bit more altered (sheared) and headed in a northeast direction. I can only assume this is due to the proximity to the northeast fault to the east. Additional boulder trains were examined on our way to the north claim line, but nothing of interest was noted. Other than the possible northeast fault, the outcrops in the survey area appear to be granite.

We demobilized equipment.

Jimmy Mathieu 1 day (claim # 4227412 / 4212254)

Todd Mathieu 1 day (claim # 4227412 / 4212254)

Mileage = 254

Date: August 27, 2009

Team members:

Todd Mathew

Sony Mathew

Interesting Discoveries:

2 ton volcanic boulders
chalcoprysite + iron sulphide

Claim Block 4248081
3 unites
Best township

Claim Block 4227412
12 unites
Best township

Claim Block 4212254
2 unites
Best township



Declination
11° 25' West

Scale
1 inch = 200m



Legend

Symbol	Description
	Outcrop
	sample name and sample location
	direction of line traversed

Black Duck Lake

Owaissa Lake

portage trail

Boulders

Volcanic Boulders

Pine + Cedar Swamp

run off ditch

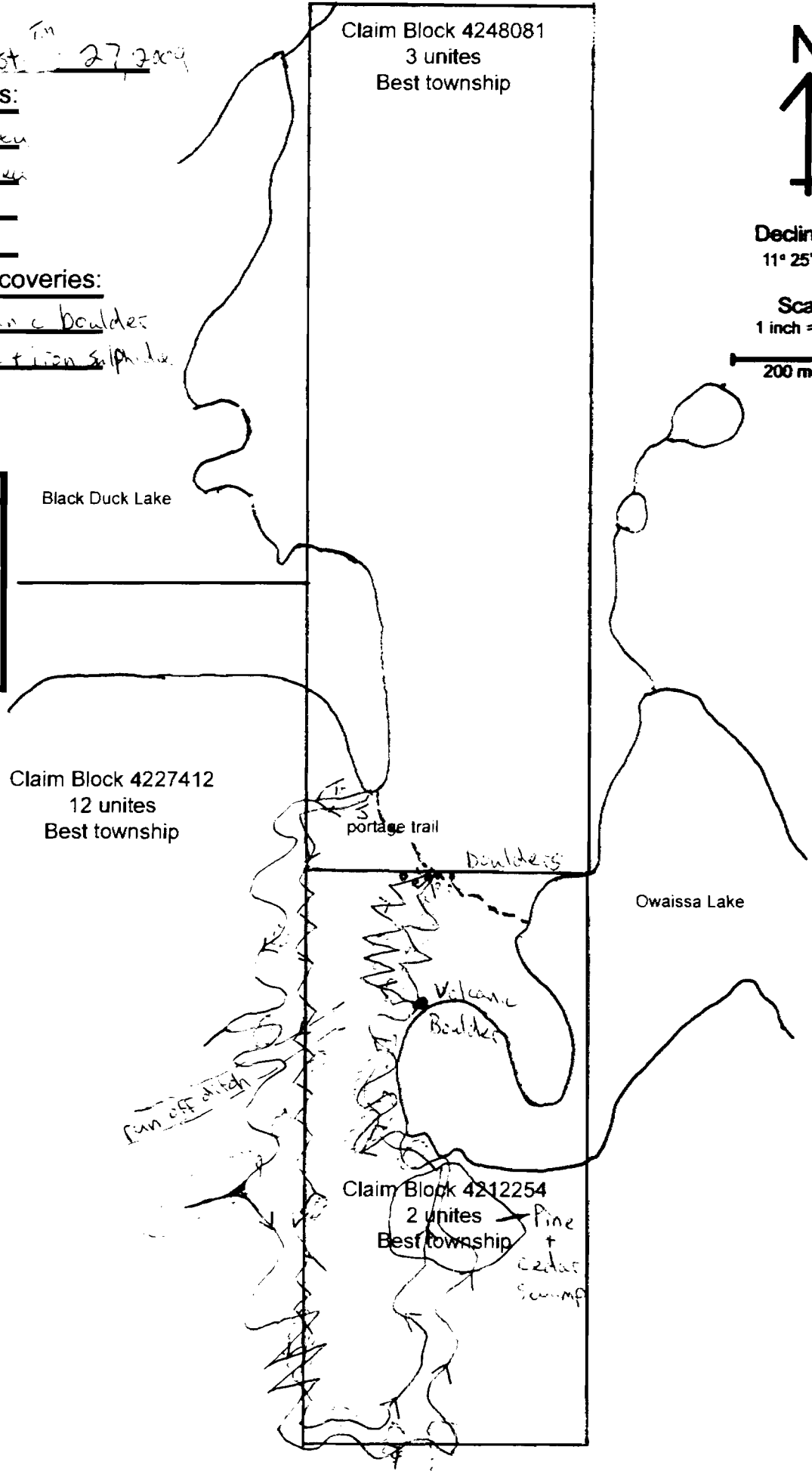

September 20, 2009

I mobilized equipment to Black Duck camp on September 19, 2009. Intention this trip was to prospect southeast of the Mathieu showing along a main ridge that stretches down to Bernice Lake. Work reports filed by the Guppy family indicate the belief of a Bernice Lake fault system that I believe if it exists would follow along the east portion of this ridge.

I prospected the top of the ridge for approximately 500 meters southwest. The outcrops exposed appear to be similar in nature, sandy grainy bluish rock, except for the northwest/south east iron dike passing through the area. Over the last 200 meters of prospecting the area became overburden covered with the odd boulder. This location appears to be part of the area that was selectively logged in the mid 1990's. As the geology remained the same along the ridge it is my belief any further prospecting along the top of this ridge is senseless and so I headed west until intersecting a logging road that carried me out to Red Squirrel Road.

I then traversed west and northwest of the Mathieu B zone in a short detailed grid of 15 meters searching for additional showings. A new (Z6) intrusive structure was located approximately 21 meters northwest of sample Z. It appears to be a narrow (one eighth to one quarter inch) quartz vein with iron and heading 13 degrees east of magnetic north with a slight dip to the east. I traversed south attempting to locate additional strike length of the Mathieu B showing, but was unable to locate any additional mineralization.

Todd Mathieu 1 day (claim # 1223725)

Mileage = 258km

Date: September 20, 2009



Team members:

Todd Mathieu

Interesting Discoveries:

Z6 - additional intrusive
iron + quartz $\frac{1}{2}$ to 4 inch

Legend

Symbol	Description
	Outcrop
	sample name and sample location
	direction of line traversed



Declination
11° 25' West

Scale
1 inch = 200m

