

NORWEST PROPERTY

Geological Assessment Report

25 October 2005

2.307-3



Gordon Salo

A handwritten signature in black ink that reads "Gordon Salo".

George Katchan

A handwritten signature in black ink that reads "George Katchan".

Norwest Property

Geological Assessment Report

Location

The claim unit is centered on the boundary between the Townships of Dieppe and Truman. Half of the unit is located in the north west quarter of Dieppe Township and the other half in the north east quarter of Truman (Figure 1).

Access

Claim can be accessed from Sudbury on highway 55 westerly for 40km turning south onto Highway 10 for 15km, turning west onto North Shore Road for a further 6km then taking ATV northwards 3.2km from North Shore Road (Figure 1).

Property

The property consists of one unpatented mining claim unit S1117800 in good standing.

Ownership

Unpatented mining claim unit S1117800 is 100% owned by Mr Gordon Salo.

Geology

Geology of the claim unit is dominated by Precambrian aged Huronian metasediments. Metasedimentary rock types seen within the claim include quartzites and well-foliated phyllites, all belonging to the Espanola Formation. Also exposed within the claim is Nipissing Diabase.

Mineralization

Debicki (1977) described work by Hoyle Mining Company Limited in 1957 at which time they located “pyrrhotite, pyrite and minor chalcopyrite impregnations in a quartz vein system striking N70E and dipping vertically”. The company conducted geological, geophysical and geochemical surveys in the area as well as completing 14 diamond drill holes totaling 210m. Hoyle reported assays that ranged between 0.04 – 0.52% nickel, 0.01 – 0.14% copper over 0.3 – 0.6m lengths (Debicki, 1977).

Present Work

Work covered under this report is in respect of a 1 day site visit made on the 18th October 2005. The main reason for the visit was to examine the eastern extension of the mineralisation beyond the main pit at the center of the claim unit. The visit included the collection of 2 samples for assay purposes; at this time assays are still pending (Table 1).

Sample A3401 is a composite chip sample along a 3m width of mineralized vein taken adjacent to a 2m deep exploration pit. The strike of the vein is 261° (true north). Although the quartz sulphide vein adjacent to this pit is approximately 6m in width, sulphides are restricted in occurrence to a central 2 to 3m wide core. Sulphides are visible along an exposed strike length of approximately 10m. Main sulphide phases are pyrrhotite and pyrite with lesser chalcopyrite. Wallrocks to the vein are quartzites and phyllites. Westwards along strike the vein can be followed for approximately 100m; here the vein consists of white - smoky milky quartz with negligible associated sulphides.

Sample A3402 was taken some 150m eastwards along strike where a “slabby” breccia is exposed on small outcrops adjacent to a beaver pond (Plate 1). The breccia is characterized by rectangular slabs of quartzite wallrock material that are rimmed with crystalline dogtooth quartz and infilled with carbonate. The elongate slabby clasts of quartzite are oriented parallel to the east – west strike direction of the vein/breccia.

Dates Worked on Project

1 day: 18th October 2005

1 day x 2 workers = 2 days prospecting

Names & Addresses of workers:

Gordon Salo: 2005 North Shore Road, Whitefish Ontario P0M3E0

George Katchan: 57 Labouchere Rd, South Perth, WA Australia

Table 1: Norwest Claim Samples

<u>Name</u>	<u>Location</u>	<u>Description</u>	<u>mE*</u>	<u>mN*</u>	<u>RL</u>
A3401	main pit area	Composite chip across 3m outcrop; quartz-pyrrhotite-chalcopyrite-pyrite veined quartzite & phyllite; also breccia with quartz clasts in sulphide; ~6m wide subvertical vein/breccia strike 261° (true) locally massive sulphide	466 273	5 124 274	276 m
A3402	near beaver dam	Grab outcrop sample of breccia; tabular clasts of quartzite oriented parallel to E-W strike; dogtooth quartz lining clasts; no visible sulphides	466 428	5 124 305	291 m

* UTM NAD83 17T



Plate 1: Breccia exposed at A3402

References

- Debicki, R.L. 1977 Traman Township, District of Sudbury, Ontario Geological Survey Preliminary Map P.1497, Geol. Ser. Scale 1:15,840 or 1 inch to $\frac{1}{4}$ mile. Geology 1974, 1976. Compilation 1977.

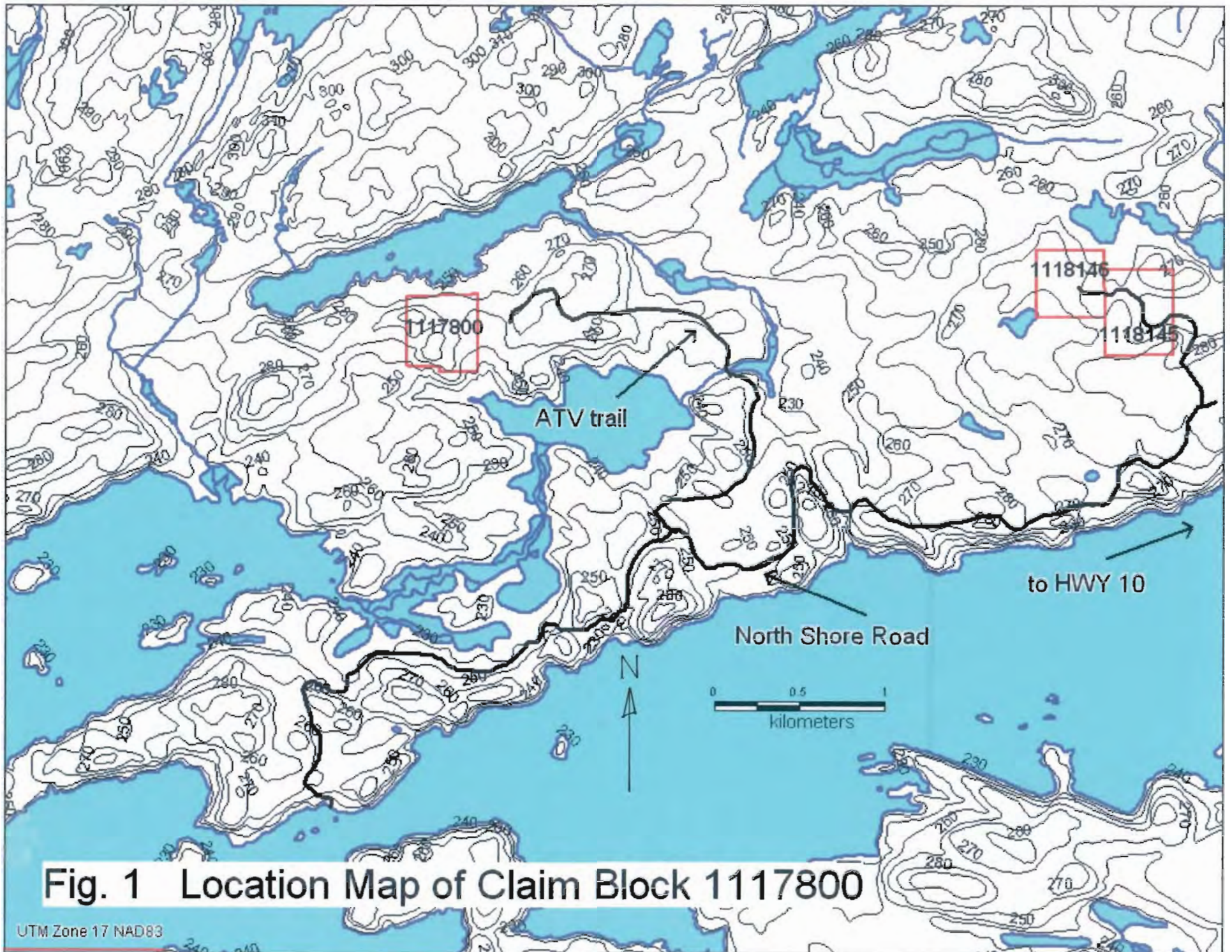

Fig. 1 Location Map of Claim Block 1117800

UTM Zone 17 NAD83

466 073 mE

466 273 mE

466 473 mE

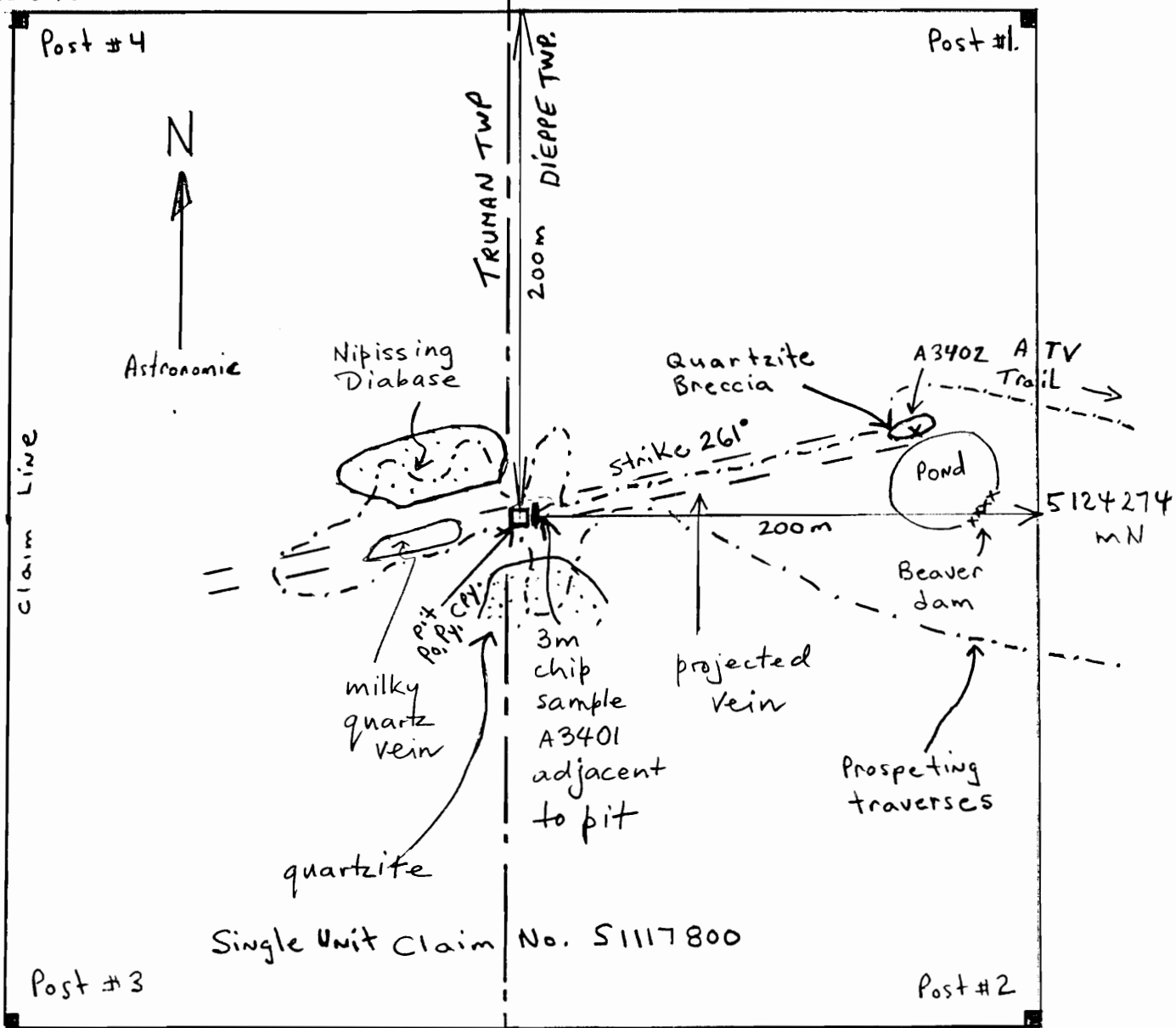
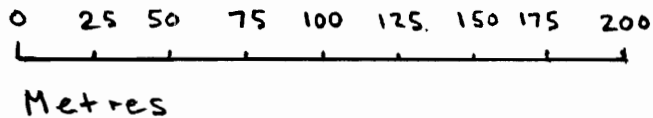

Figure 2.

Scale 1:2,500 1 cm = 25m



- · - · - · Prospecting traverses
- xxxx Beaver dam
- claim post
- Pit
- == Quartz Vein
- ⊙ outcrop
- | Chip Sample
- x Grab Sample

