

2.31633

YEAR 2005 ASSESSMENT WORK REPORT AND PROPOSED
PROGRAM OF DEVELOPMENT ON OUR CLAIM GROUP
IN VINCENT TOWNSHIP

Our claim group consists of twenty three (23) mineral claims all in good standing of which five (5) are leased claims and situated in Vincent Twp. (map G163) Thunder Bay Mining Division.

Our work program was to do major mechanical stripping and trenching along strike of the several parallel veins to get a better knowledge of continuity, geology, structure and trench and sampling locations followed by diamond drilling if warranted. We were unable to start this (2005-06) program due to very dry conditions in the bush at the time a backhoe was available to us. As our claims are mostly in timbered areas the danger of starting a bush fire was very great. This work program is re-scheduled for the 2006 prospecting season.

Areas of proposed stripping and trenching are shown on attached base claim map.

However, we were able to do some field work of minor stripping and trenching by hand as shown on enclosed drawings to keep our claims in good standing.

Respectfully submitted,

Neil Makin

Certificate of Analysis

Tuesday, January 17, 2006

Maki, Neal
 RR14
 Thunder Bay, ON, CA
 P7B5E5
 Ph#: (807) 767-2194
 Fax#:
 Email

Date Received : 06-Jan-06
 Date Completed : 17-Jan-06
 Job # 200640009
 Reference :
 Sample #: 3 Rock

Accurassay #	Client Id	Au ppb	Au oz/t	Au g/t (ppm)
576	BY 15-10-05	<5	<0.001	<0.005
577	BP 15-10-05	<5	<0.001	<0.005
578	AM 15-08-05	29	<0.001	0.029
579 Check	AM 15-08-05	15	<0.001	0.015

PROCEDURE CODES: AL4Au3

Certified By:

 Derek Demianluk H.Bsc., Laboratory Manager

The results included on this report relate only to the items tested

The Certificate of Analysis should not be reproduced except in full, without the written approval of the laboratory

Page 1 of 1

AM EXTENSION.

CLEAN OUT MUCK AND DEBRIS FROM
THE BOTTOM OF A 6' X 3' X 4' DEEP
PREVIOUSLY DUG TRENCH, EXPOSING
A 6' SECTION OF RUSTY IRON FORMATION
CONTAINING MINOR RECRYSTALLIZED
ASP AND MAGNETITE AND 5%.

GLASSY QTZ. A GRAB SAMPLE
WAS TAKEN OVER 5' MOSTLY QTZ.
SAMPLE NO. AM EXT. 15/08/05
R. MAKI AUG 16/05 1 DAY @ 160.00 = 160.00
M. MOORE AUG 16/05 1 DAY @ 160.00 = 160.00

TOTAL LABOUR.
\$320.00

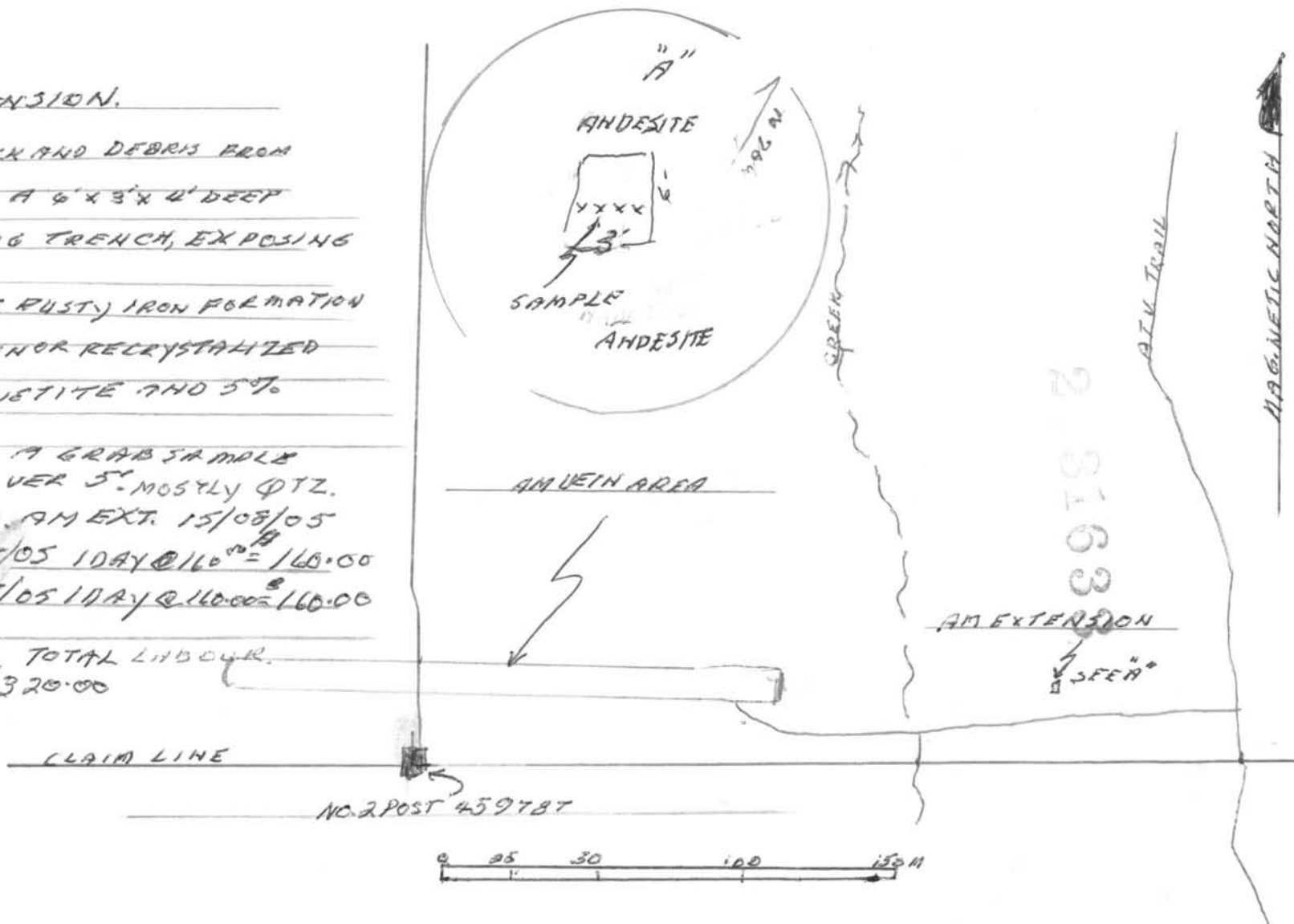

BIG PIT

DETAIL "A"

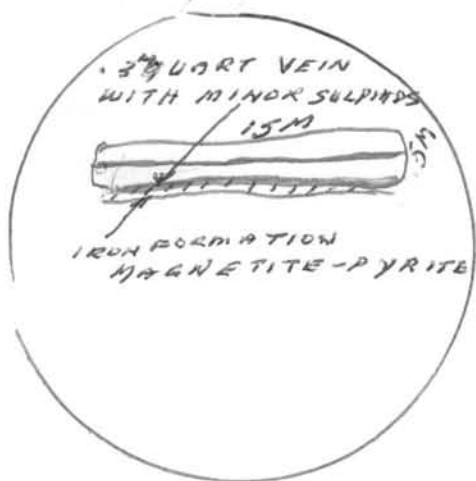

CLEAN OUT MUCK AND DEBRIS FROM
BOTTOM OF TRENCH, BREAK OFF ROCK FROM
FOOT WALL PREVIOUSLY UNDER WATER, EXPOSING
A .3M VEIN OF QUARTZ CARBONATE WITH
SPECKS OF PYRITE AND MAGNETITE. A CHIP
SAMPLE ACROSS THE .3M WAS TAKEN.

SAMPLE NO. BP 15/10/05

N. MAKI - 15/AUG/05 1 DAY @ \$160.00 = \$160.00

S. MOORE - 15/AUG/05 1 DAY @ \$160.00 = \$160.00

TOTAL LABOUR \$320.00



ATV TRAIL

BIG PIT
SEE DETAIL "A"

2.31633

POST NO. 2 POST NO. 3
4184312 513154

0 25 50 100 150M

SCALE 1:2000

2.31633

BYRON ROAD

BYRONS SHOWING

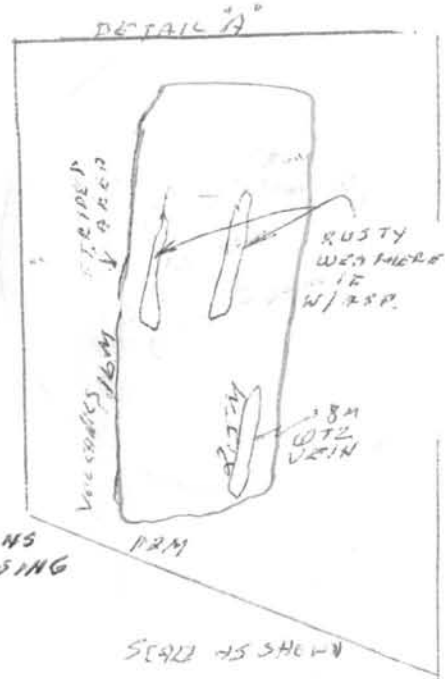

SEE DETAIL A

SEE DETAIL A

BYRONS SHOWING

MINOR STRIPPING AND TRENCHING ON THE SOUTH END OF CONTINUATION OF BYRONS MAIN IRON FORMATION. PREVIOUSLY REPORTED. A 0.8M QUARTZ VEIN, OVERLAYING THE IRON FORMATION, SHOWED MINOR TOURMALINE STREAKS. NO OTHER MINERALIZATION WAS NOTED A GRAB SAMPLE ACROSS THE QUARTZ WAS TAKEN FOR ASSAYING (NO BY 15/10/05

LABOUR

A MAKI - 15/10/05 - 1 DAY @ \$160.00 DAY - \$160.00
 M MOORE - 15/10/05 - 1 DAY @ \$160.00 DAY - \$160.00
 TOTAL LABOUR 2 MANDAYS \$320.00

MAGNETIC NORTH

POST NO 3
418481 (L)



SCALE 1:2000

MAIN KEY CLAIM SHOWINGS

BREAK UP PREVIOUSLY BLASTED ROCK
FROM QTZ VEINS 4" TO 6" WIDE ACROSS .7M,
METRES OF CHERTY SEDIMENTS INFLECTED WITH
ANKERITE AND HORNBLEDE. VG. WAS NOTED IN
QUARTZ AND ANKERITE. WE BACK-PACKED THE
BROKEN ROCK TO OUR ATV PARKED AT THE BEAVER
DAMS, THENCE TO CAMP AND TOWN FOR PROCESSING.
(DAMS, BLOCKING OUR ROAD.) SEE MAP.

K. MAKI - AUG. 16-23, 24, 25 - 4 DAYS @ \$160/DAY = \$640.00
S. MOORE - AUG. 16, 23, 24, 25 - 4 DAYS @ \$160/DAY = \$640.00
M. MOORE - AUG. 16, 23, 24, 25 - 4 DAYS @ \$160/DAY = \$640.00
A. MAKI - R. MOORE (HELPERS - NO CHARGE)
11 DAYS TOTAL LABOR @ \$160/DAY = \$1760.00

2.31633

CHERTY
SEDIMENTS VOLCANICS
STRIPPED AREA
QTZ VEINS



MAGNETIC NORTH

NO. 2, '05
T8645346

CLAIM LINE



SCALE - 1" = 100'

2.31633

MAKI CLAI

PROPOSED

(200

NE CORNER VINCENT TWP PLAN 6763

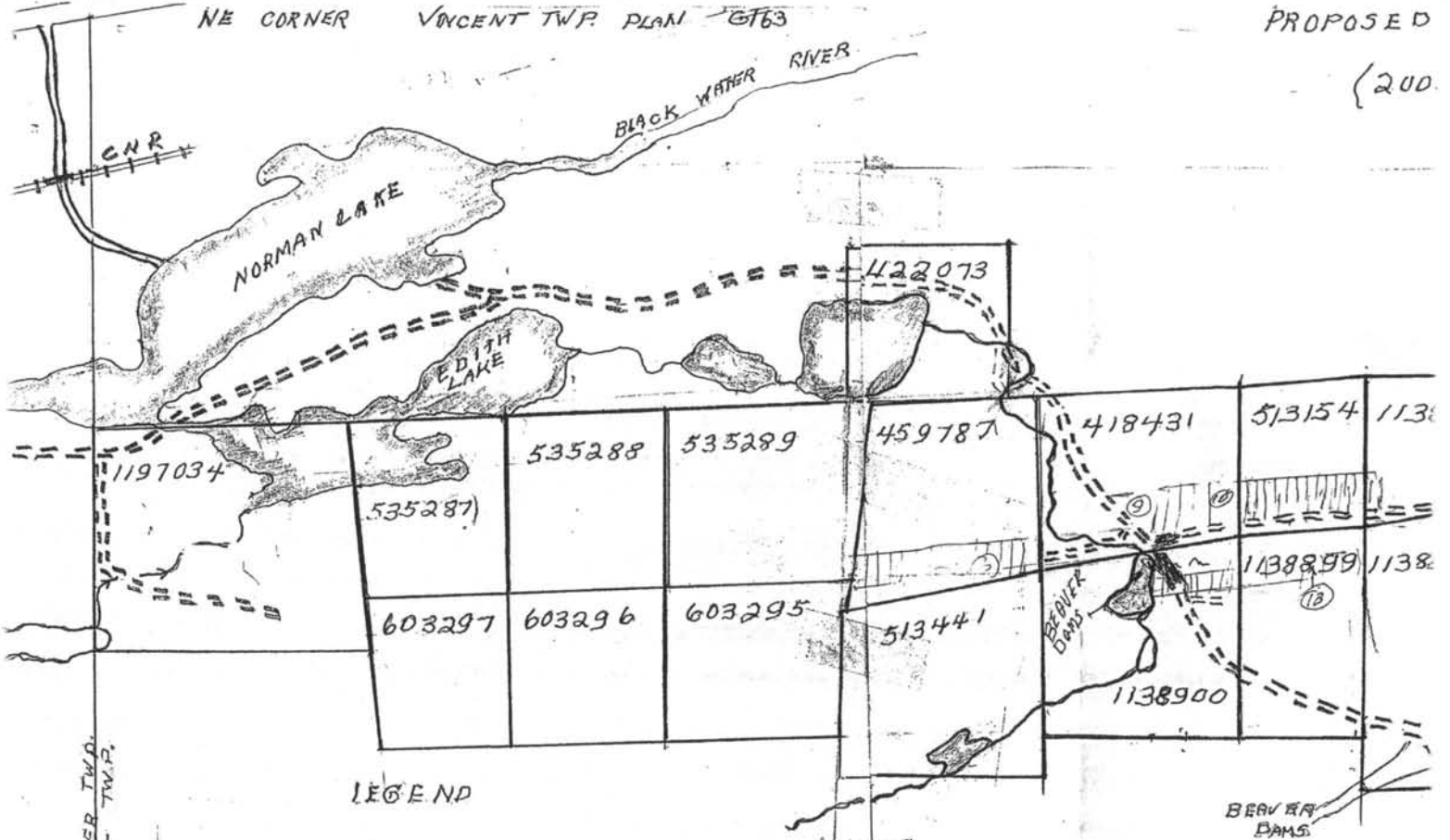

LEGEND



PROPOSED AREA OF
MECHANICAL STRIPPING
AND PROGRESIVE CROSS
TRENCHING AS SHOWN

Ⓢ NAME OF SHOWING

RECEIVED
MAR 01 2006
GEOSCIENCE ASSESSMENT
OFFICE

200008

GOLD SHOWINGS

6) The AM Showing is an iron formation in places 4m+ wide consisting of banded arsenopyrite and magnetite. Assays range from .02 to .40 oz. au. Massive quartz veins with abundant arsenopyrite is prevalent in places alongside the iron formation and assays up to .16 oz. au are noted. A X-ray diamond drill hole in the forties located on the east end of the AM Vein intersected gold values and another hole was reported by the drill owner and not published and intersected a 3m wide iron formation assaying .25 oz. au and a similar quartz vein carrying visible gold alongside the iron formation.

9) Rachel's Showing is an iron formation in volcanics exposing a 75m x 1.5m wide quartz vein carrying po. asp. and magnetite. A sample taken from an old trench (1940's) on west end showed 2.5 oz. au along strike. Samples taken in 2000 and 2001 gave assays of 0.01 and 0.05 oz. au. Latest assay from east end showed 0.329 oz. au over 2m.

10) Skidder Trench is a continuation of the AM Vein and Rachel's Showing. Vg was noted in a 10" wide outcrop on south side of showing in sugary quartz. One drill hole by Eldor Resources showed .25 oz. au over 1m+.

12) NRM Showing is an irregular flow pattern of rusty quartz in greenstone running 8 to 12 degrees north of east and is 6 to 20 inches wide containing galena and chalcopyrite. We traced it for 100 feet and an assay of 0.40 oz. au was noted in 1983.

18) Strawberry Vein is an iron formation up to 6m wide in places carrying py and po in quartz. Surface samples on one section showed 0.13 and 0.20+ oz. au (1983). Noranda drilled one hole on the west end (1988) with minor values in gold (0.04g). A 20' sulphide showing 1200' west panned moderate gold.

MAKI CLAIM GROUP
 AND
 PROPOSED MECHANICAL WORK
 (2005 - 2006)

