

Legend

- Lake
- Swamp, wetland
- River, creek
- Topographic contour
- Road, track
- Camp Location
- Survey grid line
- Claim Boundary with Claim ID number
- Township boundary

Ontario Base Map (OBM) topographic data provided in digital form by Land Information Ontario

UTM Grid North

2.31641

Scale 1:20000

0 250 500 750 1000 1250 1500

Meters

NAD83 / UTM zone 17N

WenCan Gold
CORPORATION

Cayenne, Chili and Gagne Properties
Swayze Area
Heenan, Marion, Genoa, and Benton Townships
Ontario

Claim and Grid Location

Map 1

Map prepared February 2018 by Director Management Inc.

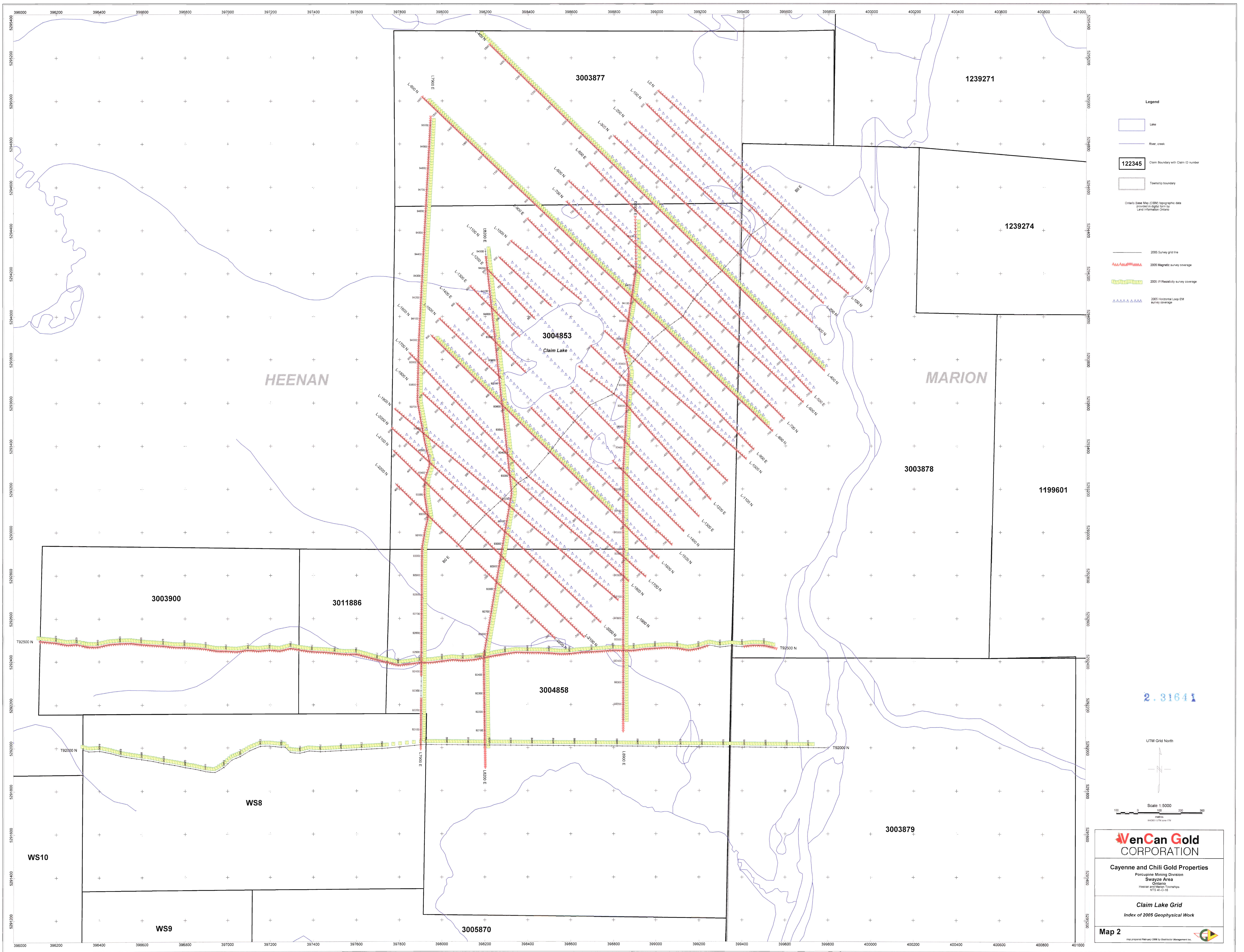

- Legend**
- Lake
 - River, creek
 - Claim Boundary with Claim ID number
 - Township boundary
 - Ontario Base Map (OBM) topographic data provided in digital form by Land Information Ontario
 - 2005 Survey grid line
 - 2005 Magnetic survey coverage
 - 2005 IP/Resistivity survey coverage
 - 2005 Horizontal Loop EM survey coverage

2.31641

UTM Grid North

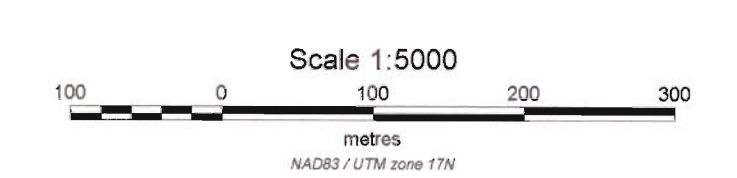
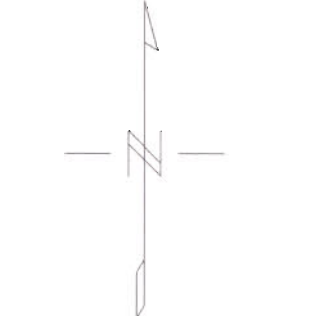

WenCan Gold CORPORATION

Cayenne and Chili Gold Properties
 Porcupine Mining Division
 Swayze Area
 Ontario
 Heenan and Marion Townships
 N7S 41-C-16

Claim Lake Grid
 Index of 2005 Geophysical Work

Map 2

Map prepared February 2006 by Earthstar Management Inc.

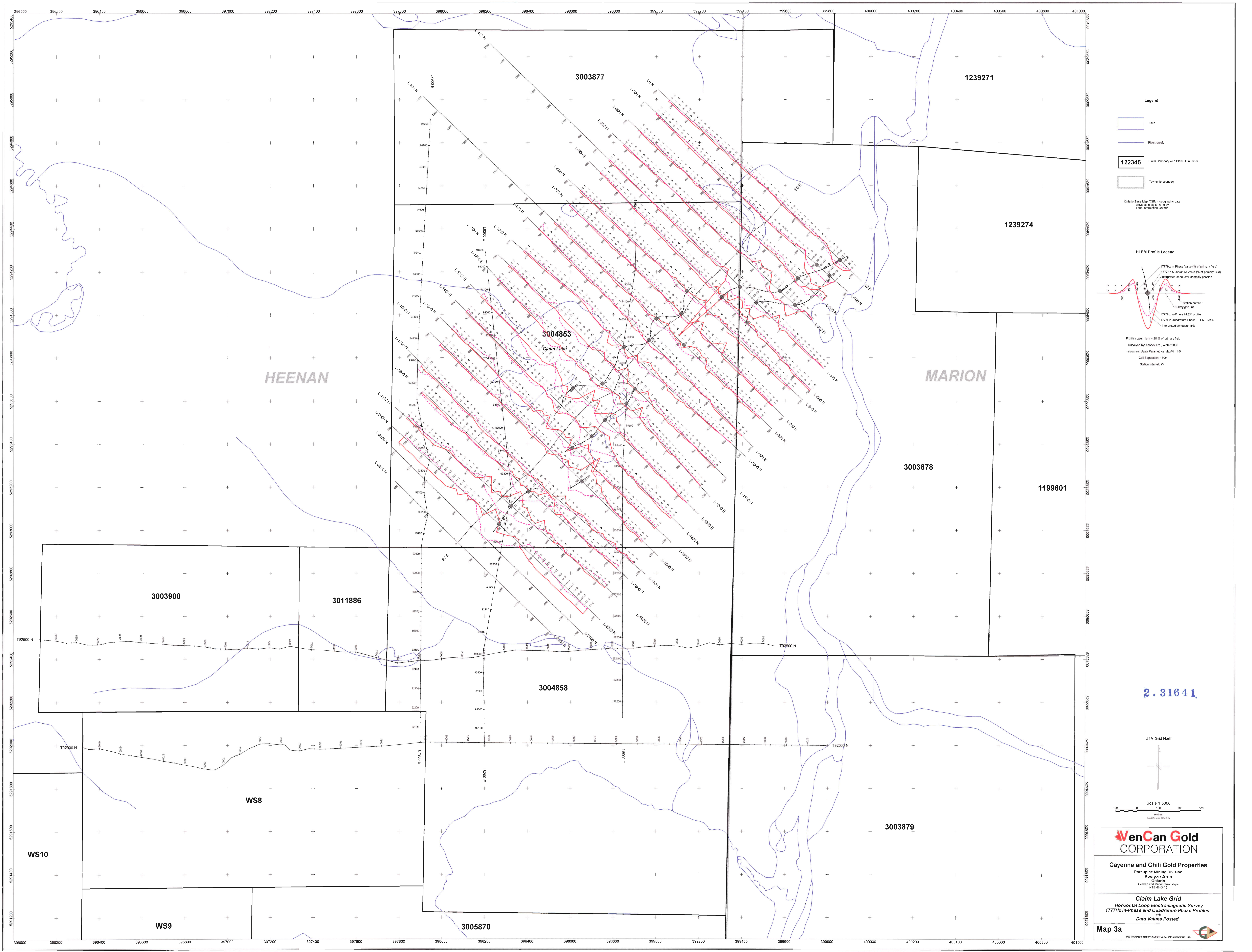

WenCan Gold CORPORATION

Cayenne and Chili Gold Properties
 Percipine Mining Division
 Swayze Area
 Ontario
 Heenan and Marion Townships
 N1S 4T-0-16

Claim Lake Grid
 Horizontal Loop Electromagnetic Survey
 177Hz In-Phase and Quadrature Phase Profiles
 with
 Data Values Posted

Map 3a
 Map prepared February 2008 by GeoScience Management Inc.

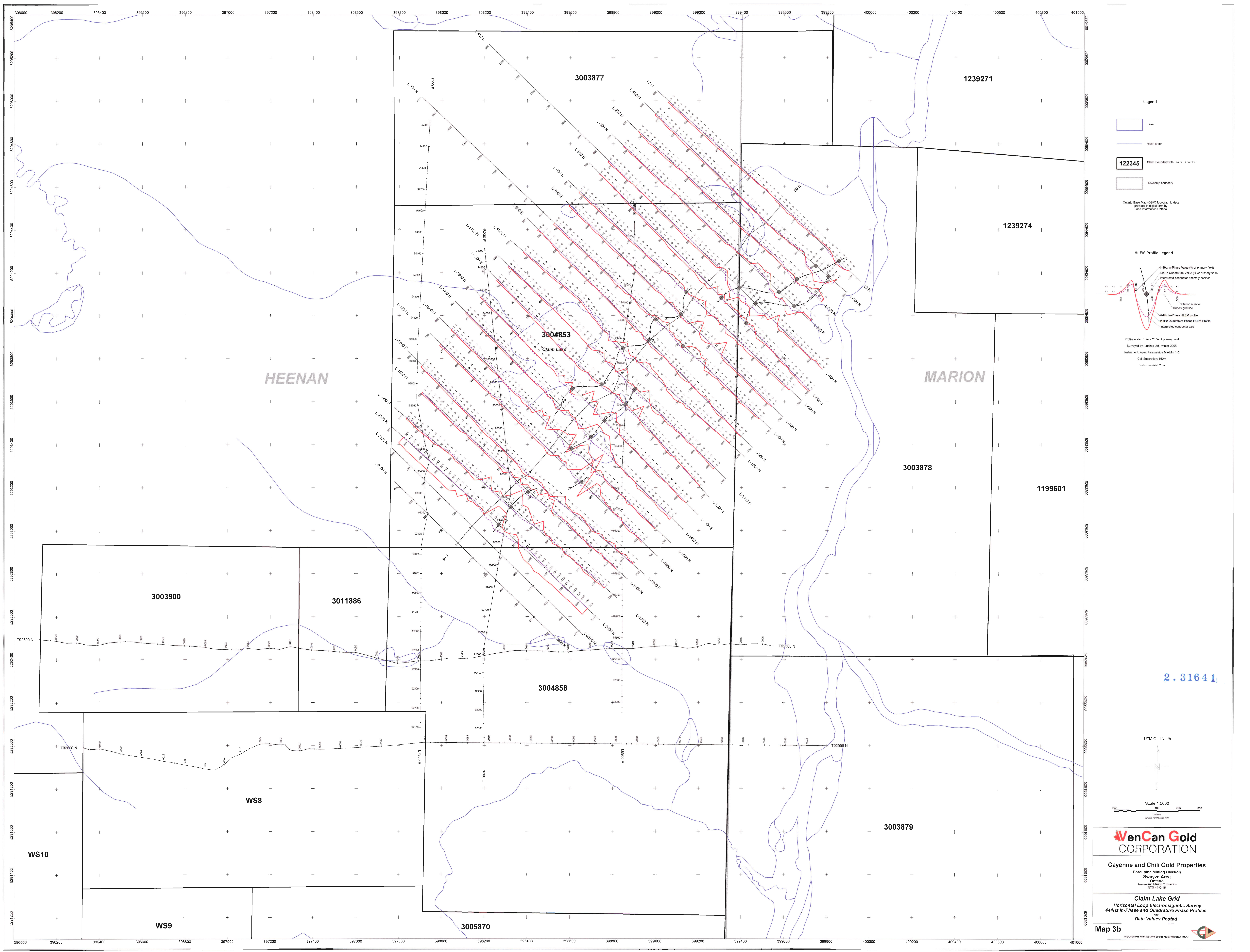

Legend

- Lake
- River, creek
- Claim Boundary with Claim ID number
- Township boundary

Ontario Base Map (OBM) topographic data provided in digital form by Land Information Ontario

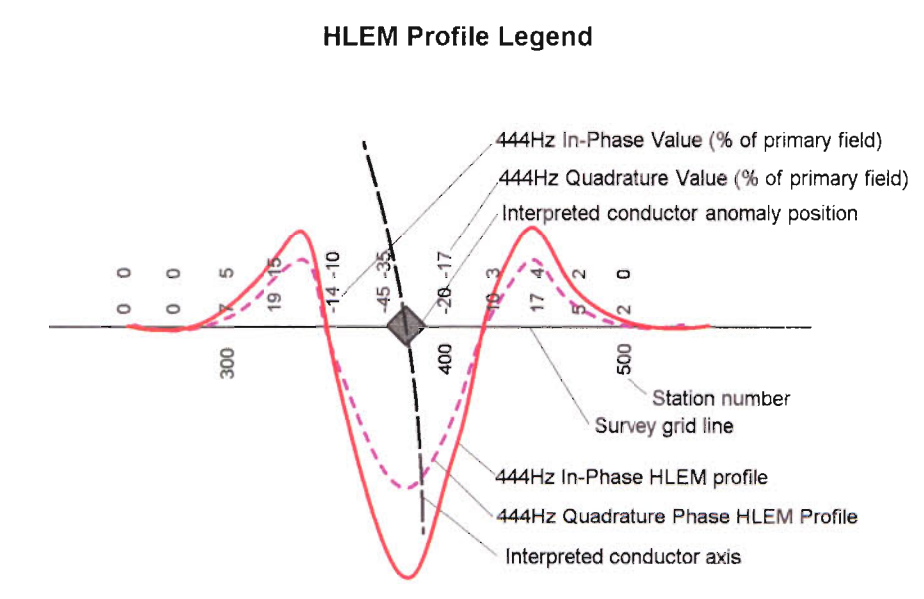

2.31641

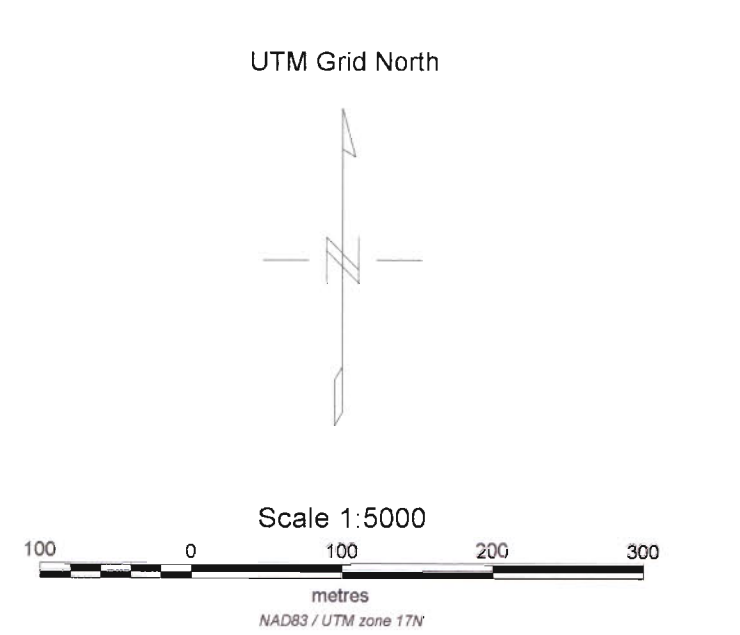

WenCan Gold CORPORATION





Cayenne and Chili Gold Properties
 Porcupine Mining Division
 Swayze Area
 Ontario
 Heenan and Marion Townships
 NTS 41-0-18

Claim Lake Grid
 Horizontal Loop Electromagnetic Survey
 44Hz In-Phase and Quadrature Phase Profiles
 with
 Data Values Posted

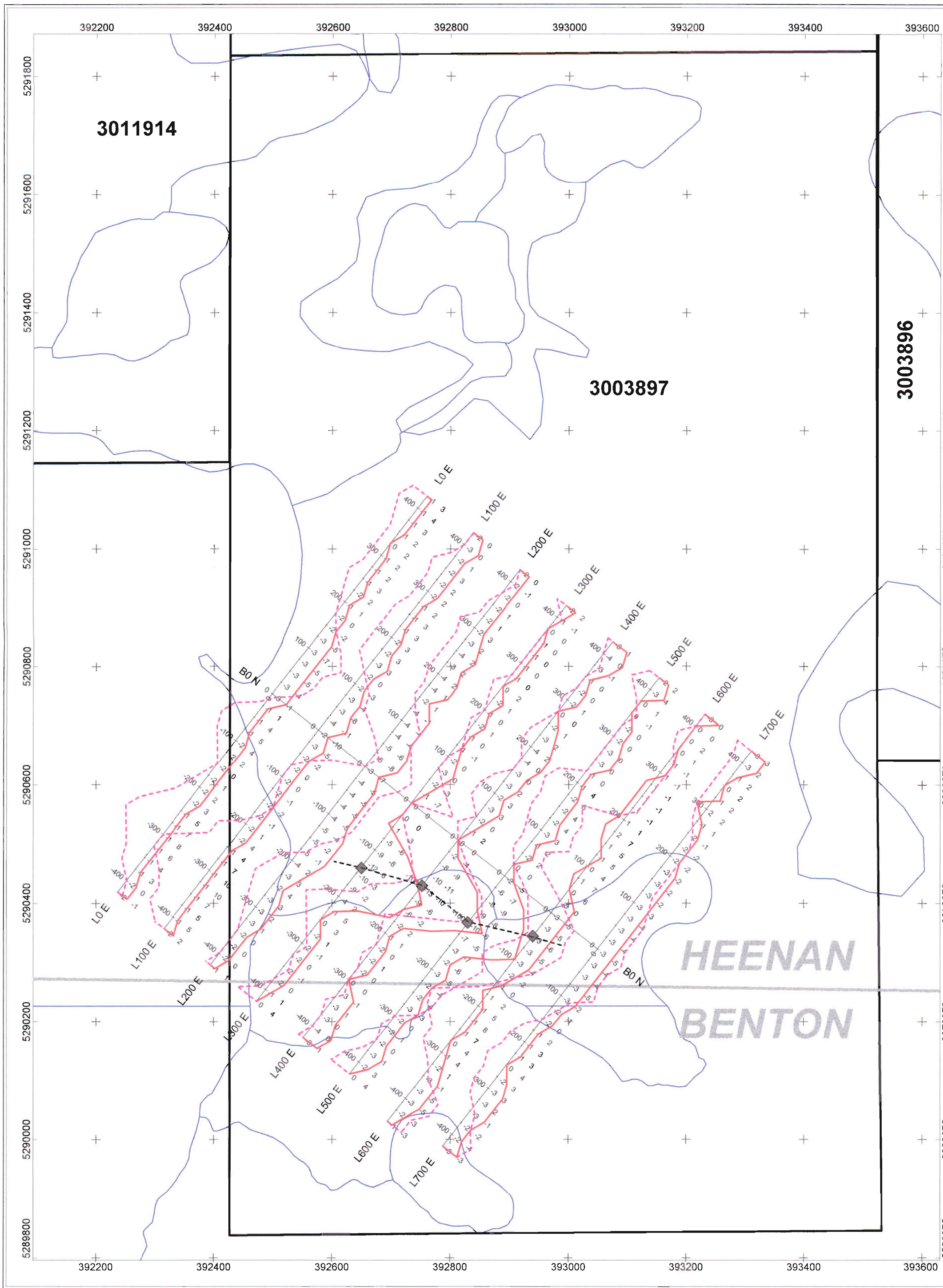
Map 3b

Map prepared February 2004 by geoscientist/management inc.



- Legend**
-  Lake
 -  River, creek
 -  Claim Boundary with Claim ID number
 -  Township boundary

Ontario Base Map (OBM) topographic data provided in digital form by Land Information Ontario

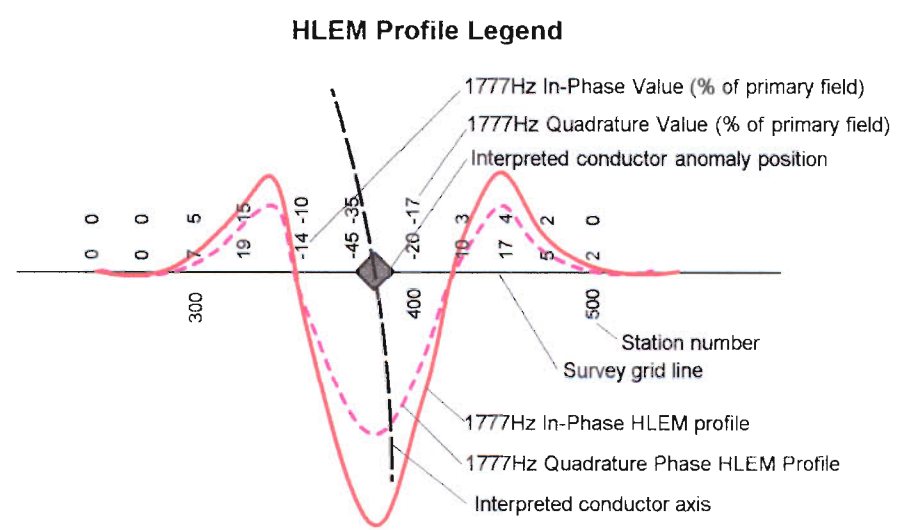

Profile scale: 1cm = 20% of primary field
 Surveyed by: Lashex Ltd., winter 2005
 Instrument: Apex Parametrics MaxMin 1-5
 Coil Separation: 150m
 Station interval: 25m

2.31641 UTM Grid North

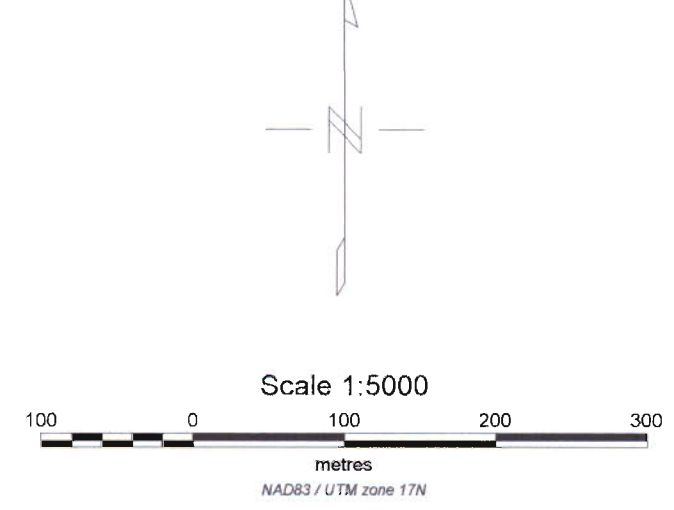

VenCan Gold CORPORATION

Cayenne and Chili Gold Properties
 Porcupine Mining Division
 Swayze Area
 Ontario
 Heenan and Benton Townships
 NTS 41-O-16

October Lake Grid
 Horizontal Loop Electromagnetic Survey
 1777Hz In-Phase and Quadrature Phase Profiles
 with Data Values Posted

Map 4a
map prepared February 2006 by GeoVector Management Inc.



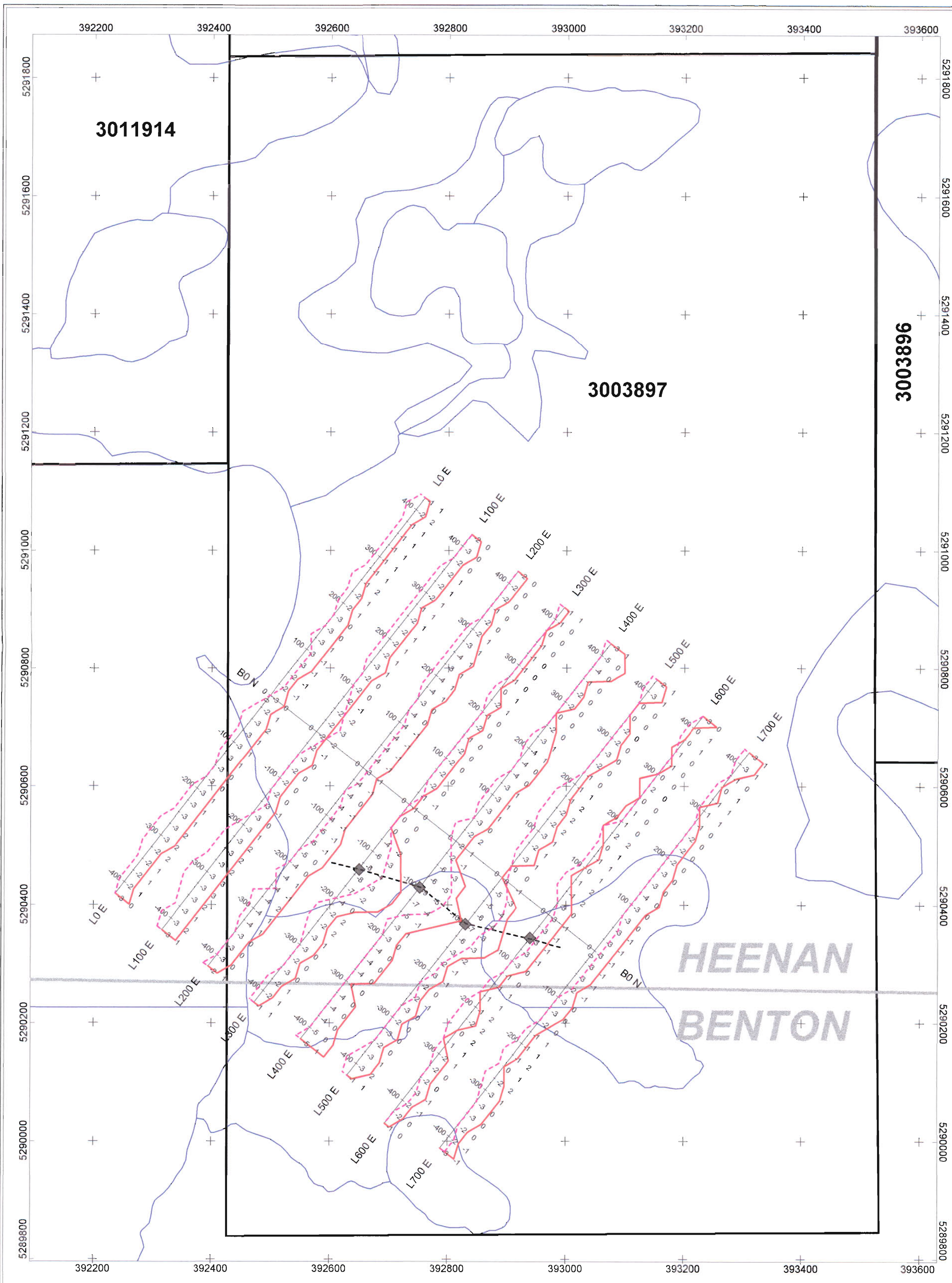

- Legend**
- Lake
 - River, creek
 - Claim Boundary with Claim ID number
 - Township boundary

Ontario Base Map (OBM) topographic data provided in digital form by Land Information Ontario

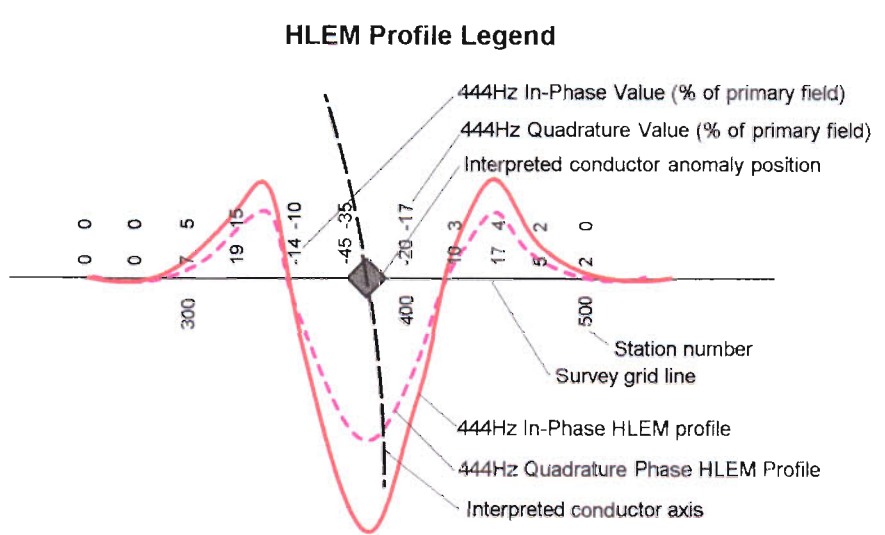

Profile scale: 1cm = 5 % of primary field
 Surveyed by: Lashex Ltd., winter 2005
 Instrument: Apex Parametrics MaxMin 1-5
 Coil Separation: 150m
 Station interval: 25m

2.31641
 UTM Grid North

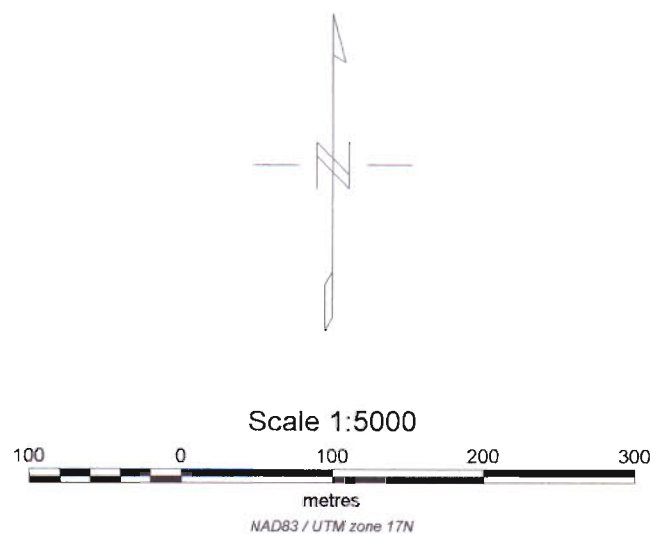

VenCan Gold CORPORATION

Cayenne and Chili Gold Properties
 Porcupine Mining Division
 Swayze Area
 Ontario
 Heenan and Benton Townships
 NTS 41-O-16

October Lake Grid
 Horizontal Loop Electromagnetic Survey
 444Hz In-Phase and Quadrature Phase Profiles
 with Data Values Posted

Map 4b
 map prepared February 2006 by GeoVector Management Inc.

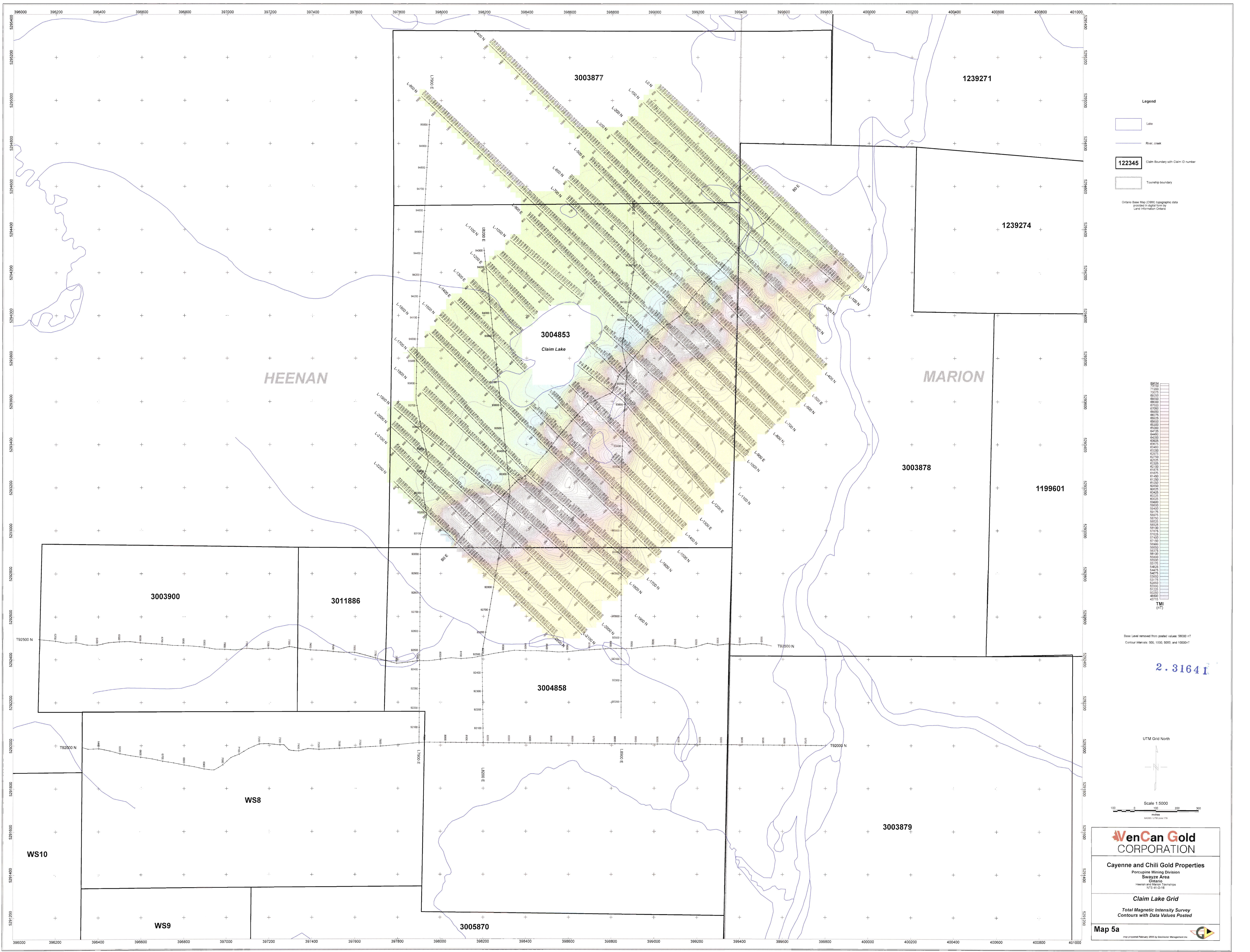

- Legend**
- Lake
 - River, creek
 - Claim Boundary with Claim ID number
 - Township boundary

Ontario Base Map (OBM) topographic data provided as digital data by Land Information Ontario

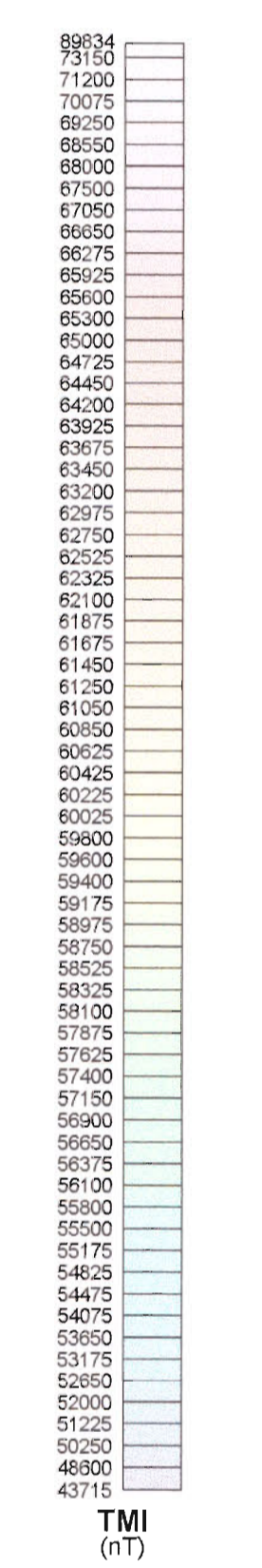

Base Level removed from posted values: 90000 nT
 Contour intervals: 500, 1000, 5000, and 10000 nT

2.3164 I

UTM Grid North

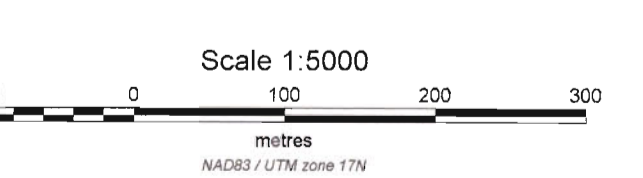
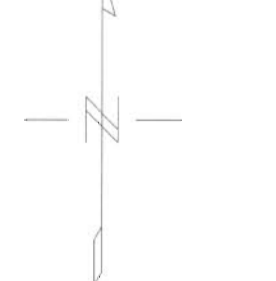

WenCan Gold CORPORATION

Cayenne and Chili Gold Properties
 Porcupine Mining Division
 Swayze Area
 Ontario
 Heenan and Marion Townships
 N7S 41-Q-16

Claim Lake Grid

Total Magnetic Intensity Survey
 Contours with Data Values Posted

Map 5a

Map prepared February 2006 by Geoservices Management Inc.

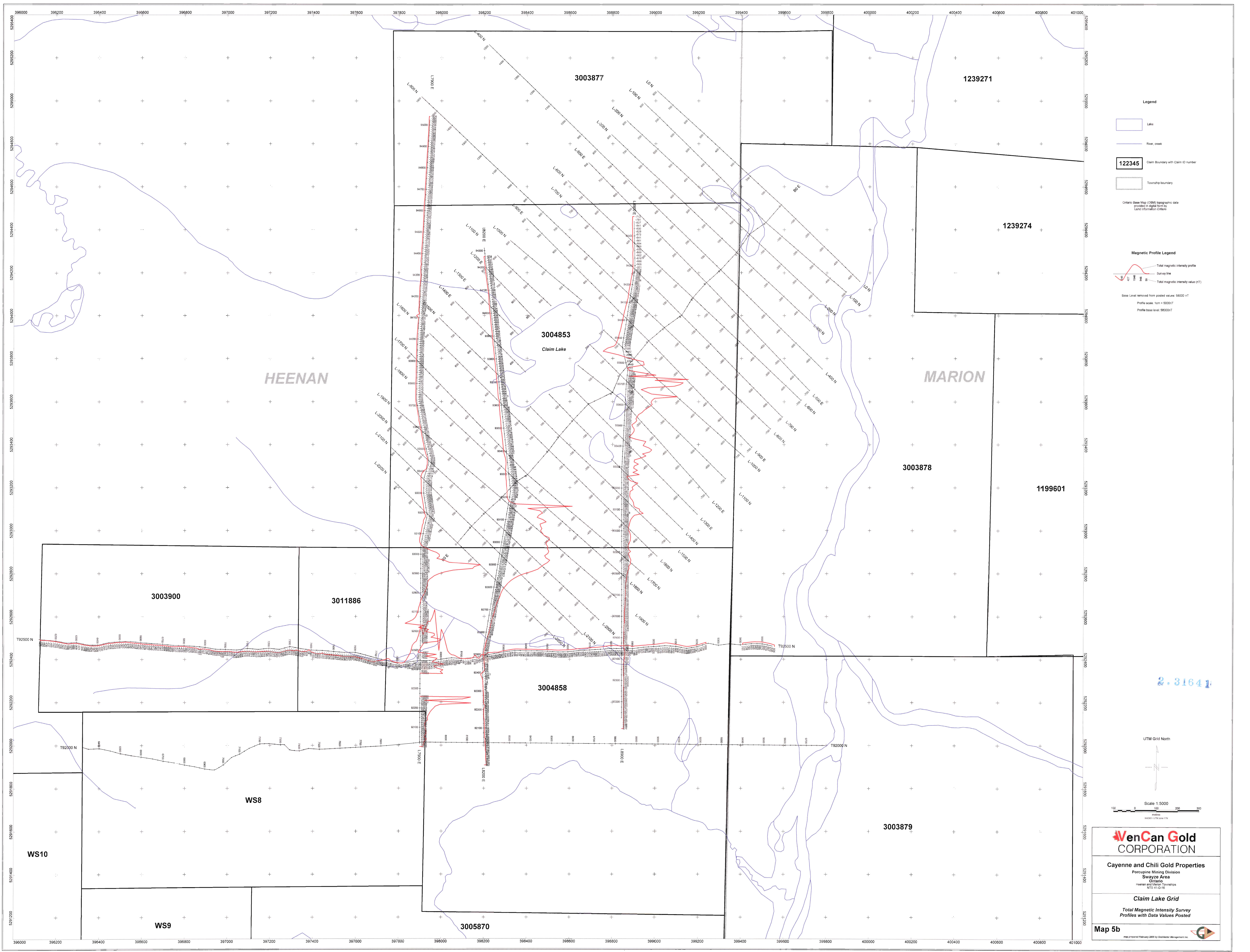

- Legend**
- Lake
 - River, creek
 - 122345** Claim boundary with Claim ID number
 - Township boundary

Ontario Base Map (OBM) topographic data provided in digital form by Land Information Ontario

- Magnetic Profile Legend**
- Total magnetic intensity profile
 - Survey line
 - Total magnetic intensity value (nT)

Base Level removed from posted values: 56000 nT
 Profile scale: 1cm = 5000nT
 Profile base level: 56000nT

2.31641

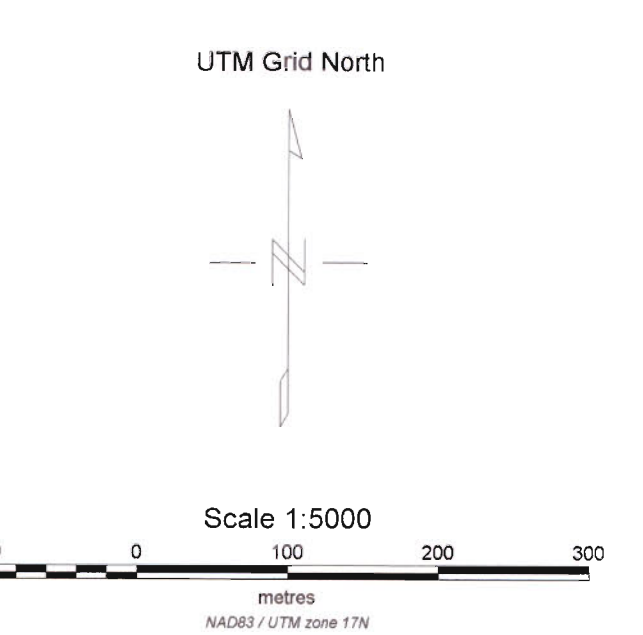

WenCan Gold CORPORATION

Cayenne and Chili Gold Properties
 Porcupine Mining Division
 Swayze Area
 Ontario
 Heenan and Marion Townships
 NTS 41-Q-16

Claim Lake Grid

Total Magnetic Intensity Survey
 Profiles with Data Values Posted

Map 5b

Map produced February 2009 by Geomatics Management Inc.

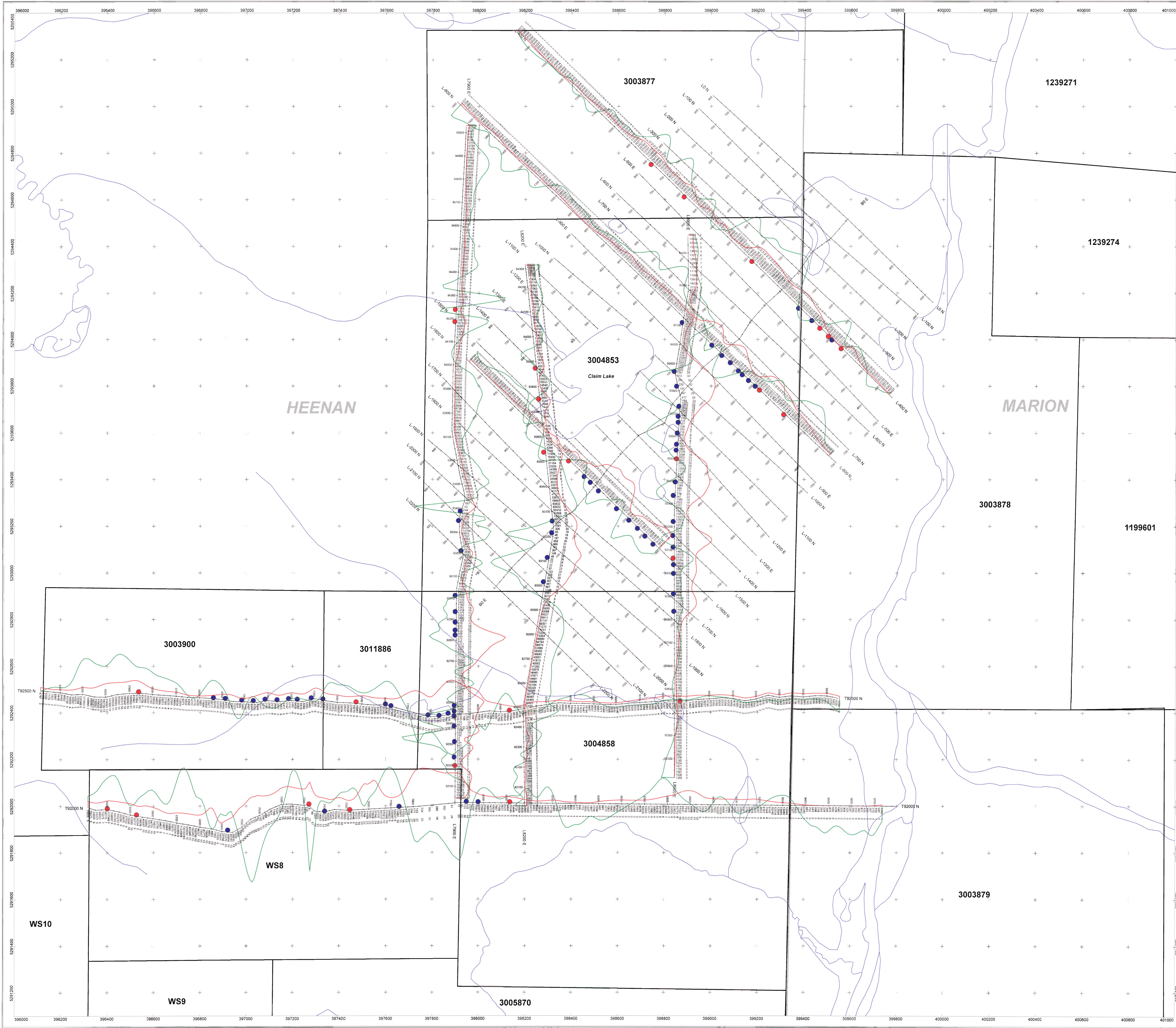

Legend

- Lake
- River, creek
- Claim Boundary (in Claim ID number)
- Township boundary

Ontario Base Map (OBM) topographic data provided in digital form by Land Information Ontario.

Profile Legend

Survey line

Survey station number

- 55m depth slice IP profile (IP value: 100V/V, profile base: 120V/V per cm)
- 55m depth slice resistivity profile (resistivity value: 100 ohm-m, profile base: 120 ohm-m per cm)
- 55m depth slice resistivity profile (resistivity value: 100 ohm-m, profile scale: logarithmic at 1 decade/decade per 0.5 cm)

Note: Refer to stacked IP-resistivity inversion sections for further details on anomalies.

- Chargeability anomaly location with high resistivity association
- Chargeability anomaly location with low resistivity association

2.31641

UTM Grid North

Scale 1:5000

VenCan Gold CORPORATION

Cayenne and Chili Gold Properties
Porcupine Mining Division
Swayze Area
Heenan and Marion Townships
N.T.S. 47-C-16

Claim Lake Grid
Resistivity and Induced Polarization Survey
55m Depth Slice
From 100000 to 120000 mE
Profiles with Modelled Values Posted

Map 6

© 2014 VenCan Gold Corporation

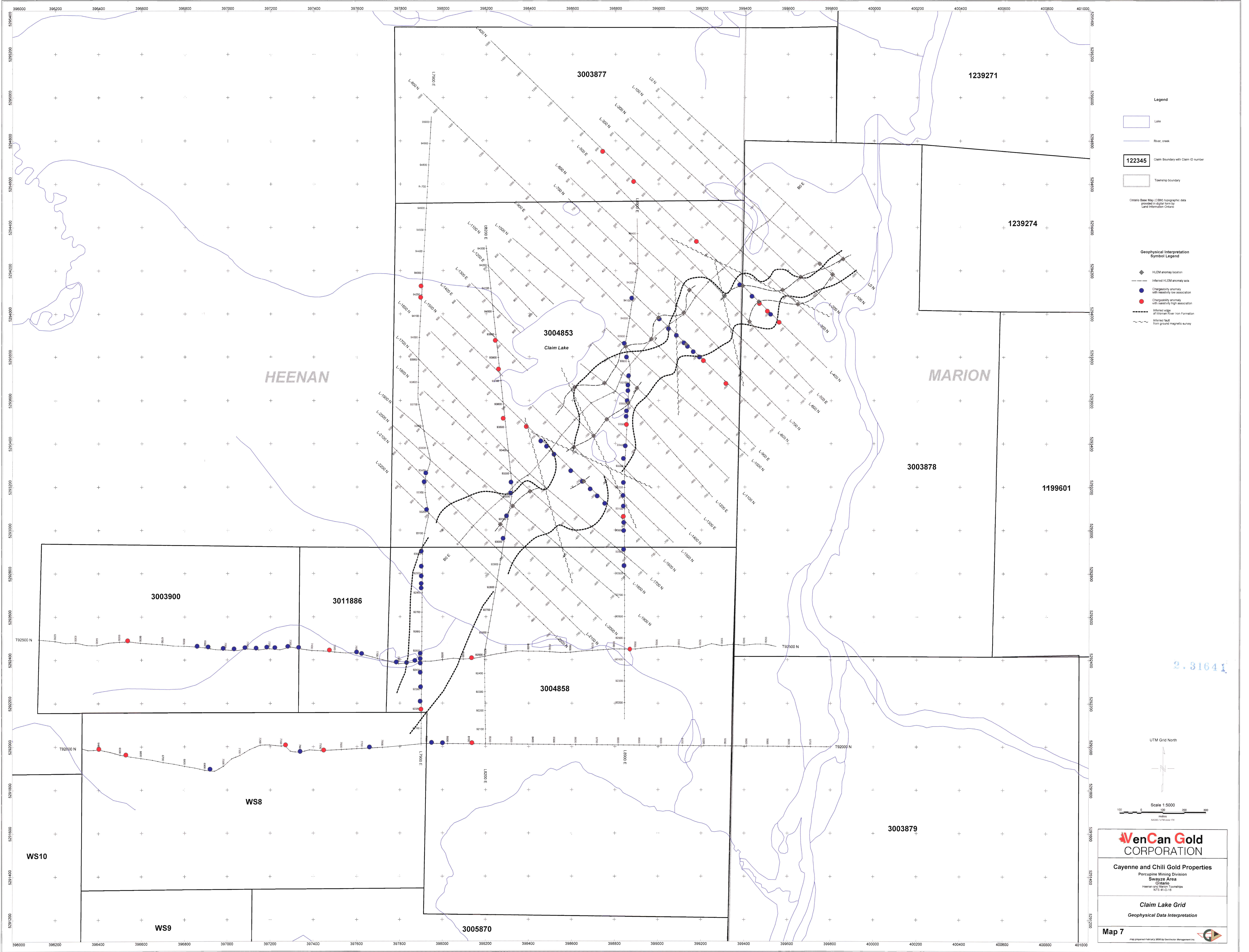

- Legend**
- Lake
 - River, creek
 - Claim boundary with Claim ID number
 - Township boundary

Ontario Base Map © BMG topographic data provided digital format Land Information Ontario

- Geophysical Interpretation Symbol Legend**
- HEM anomaly location
 - Inferred HEM anomaly axis
 - Chargeability anomaly with resistivity low association
 - Chargeability anomaly with resistivity high association
 - Inferred edge of Western Iron Formation
 - Inferred fault from ground magnetic survey

2.3164

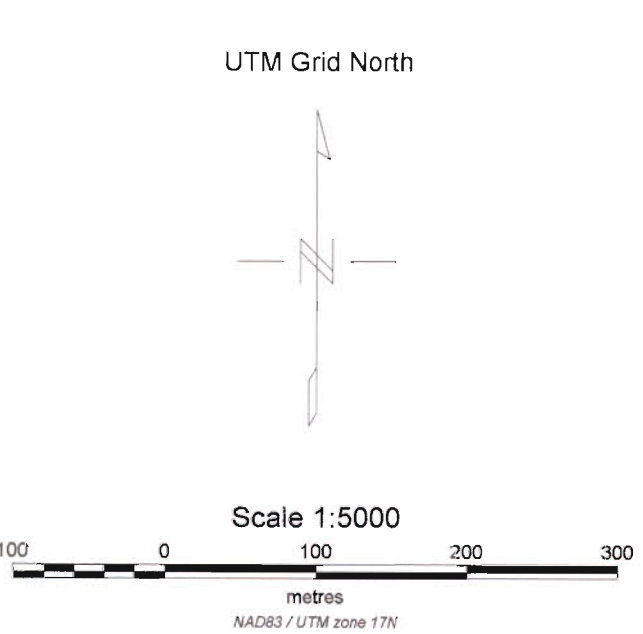

VenCan Gold CORPORATION

Cayenne and Chili Gold Properties
Porcupine Mining Division
Swayze Area
Ontario
Heenan and Marion Townships
NTS 41-D-16

Claim Lake Grid
Geophysical Data Interpretation

Map 7

Map prepared February 2008 by Detectors Management Inc.