

May 22/06

2.02286

On May 18/06 J. Richard Morin & Denis Morin carried out physical work (re establishing boundary claim lines) on claims 1177542 & 1177543 Mallard Twp.

Property Access:

Map NTS 41-0/NE Ridout Map 1(a) and Tenure Map 1(b).

Property is in Mallard Twp. Porcupine Mining Division claim map sheet G-1171.

Vehicular access is gained from Timmins via paved Hwy 50 101 & 144 south to the junction of Hwy. 144 and the Sultan industrial road, thence west along Sultan Road for 46 km. to a road junction in Edith Twp. and then north via a gravel road (Domtar) for 26 km. to the bridge on the Opepeesway River, then 1/2 mile to claims.

RECEIVED
MAY 25 2006
R)
GEOSCIENCE ASSESSMENT
OFFICE

Claim Nos.
1177542 1 unit
1177543 1 unit
Client No. 172554
Licence No. G36269

PROVINCIAL RECORDING
OFFICE - SUDBURY
RECEIVED
MAY 25 2006
A.M. P.M.
7 8 9 10 11 12 1 2 3 4 5 6

J.R. Morin

Geology:

Mallard Twp is in the Abitibi greenstone belt, Porcupine Mining Division. Predominant rock types are mafic metavolcanic flows with a few local mafic intrusives. A pervasive schistosity in the area strikes at 30° - 40° .

Regional geology of Mallard is covered in Ontario Geological Survey report 248 - Geology of the Garnet Area 1987.

General

Map outlining claims outer boundary and flooded area (Beaver) is appended.

Access and Location Figure No. 1(a)

N.T.S. 41-0/NE RIDOUT

82° 16.00'

Location of Project

47° 41.70'

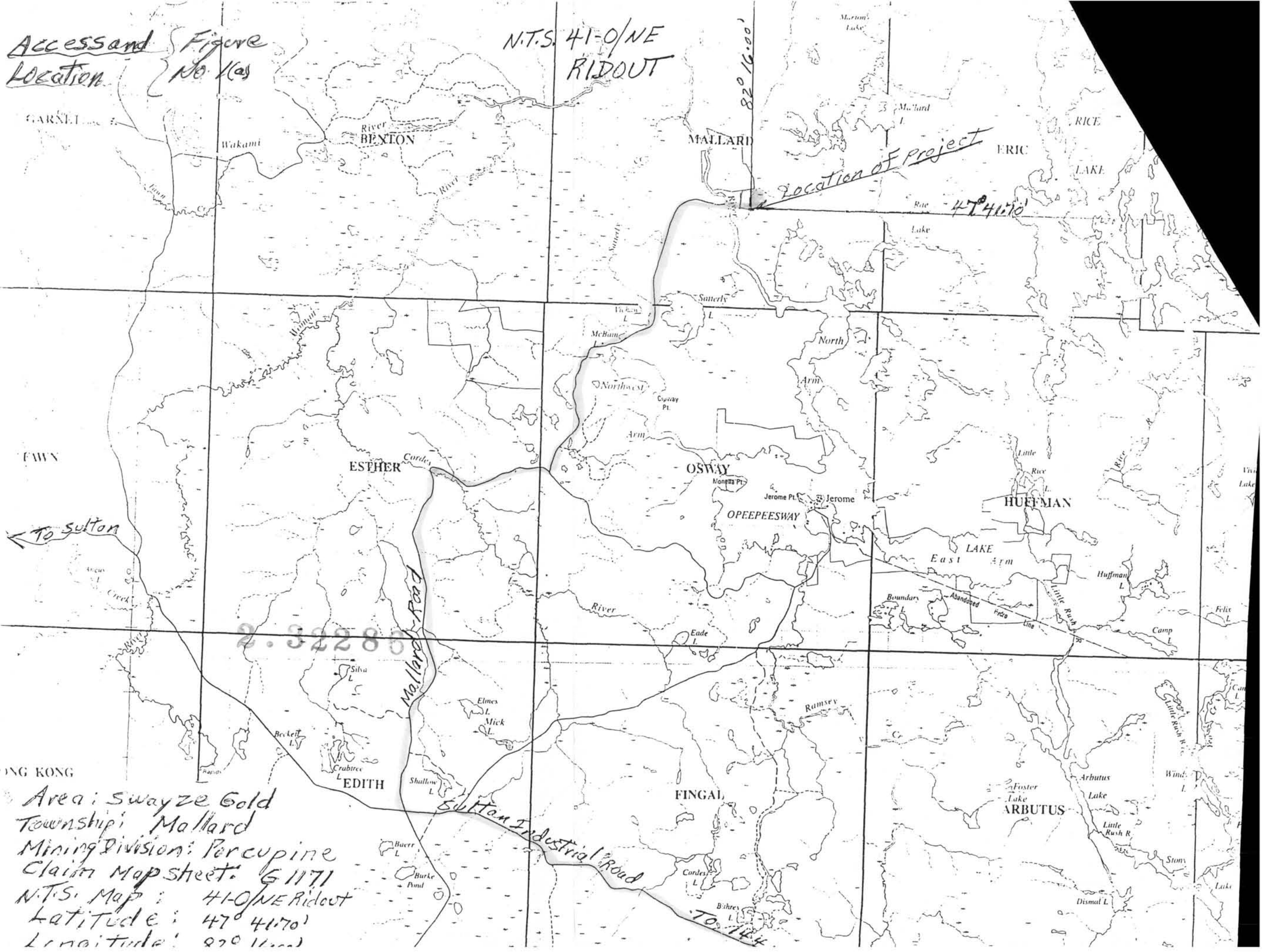

← To Sultan

2.32283

Area: Swayze Gold
 Township: Mallard
 Mining Division: Porcupine
 Claim Map sheet: G1171
 N.T.S. Map: 41-0/NE Ridout
 Latitude: 47° 41.70'
 Longitude: 82° 16.00'

TO 144

1(b) Mining Land Tenure Map
Plan G1171

Mallard TWP.
Porcupine Mining Division

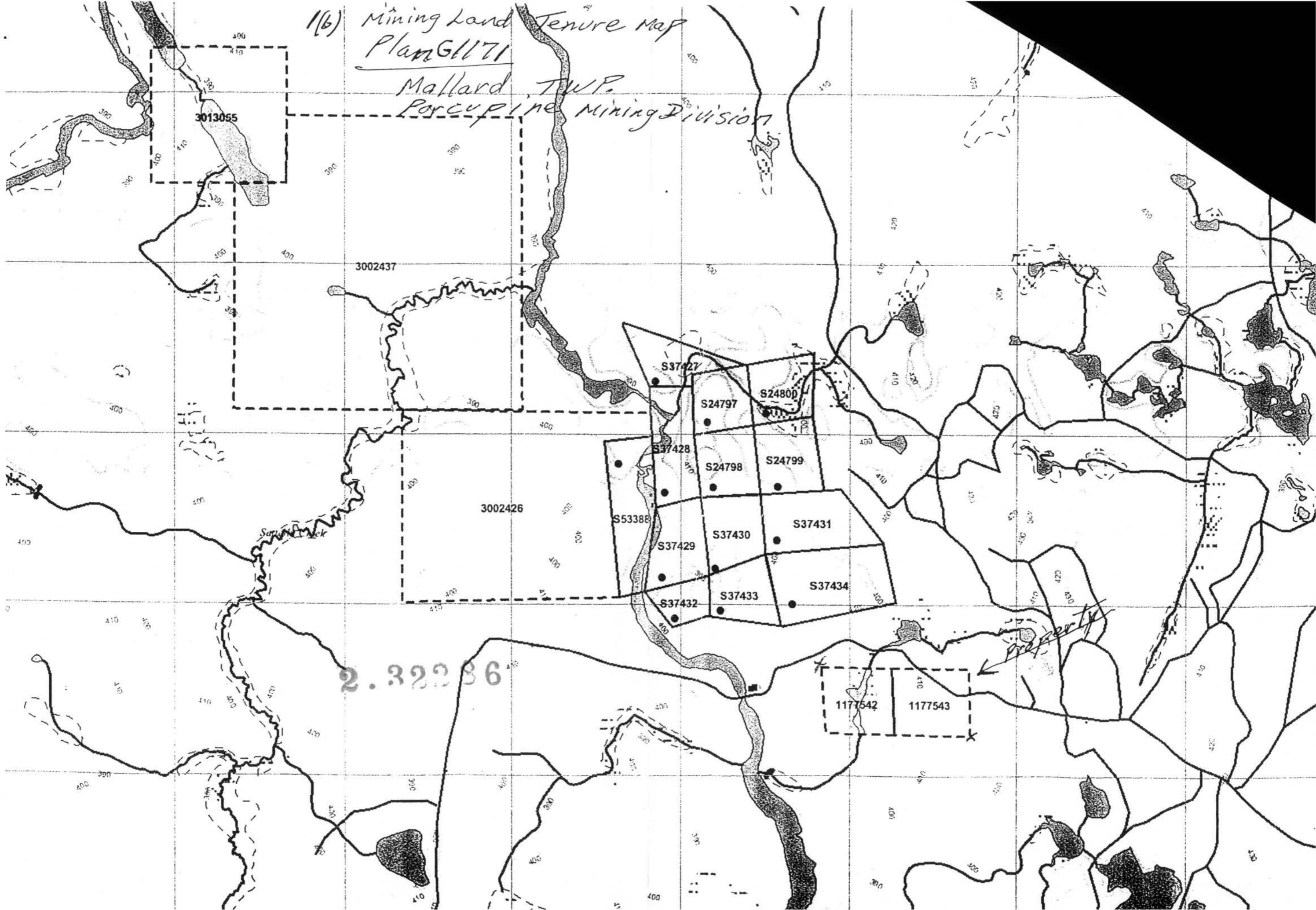

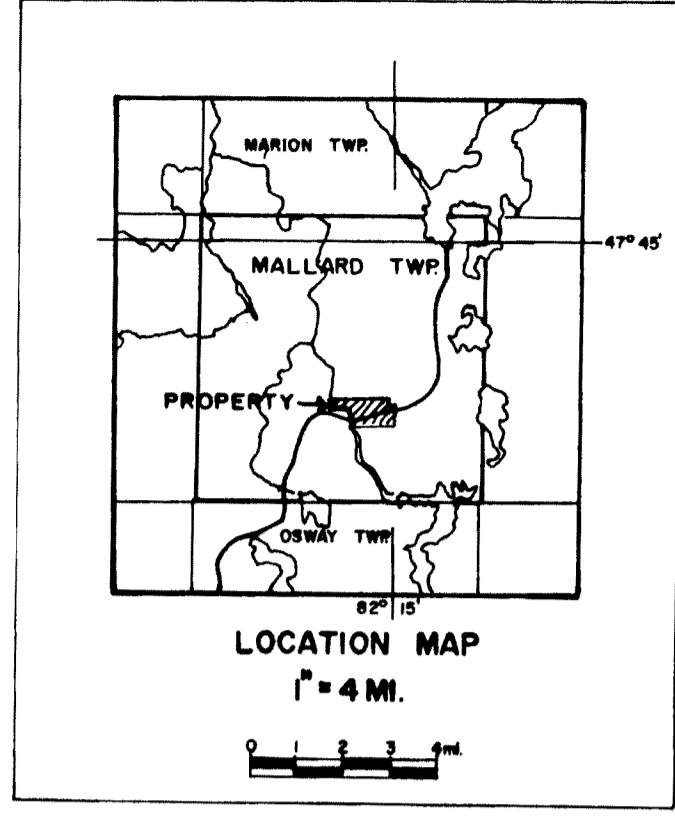

- LEGEND**
- CLAIM LINE
 - LOCATED CLAIM POST
 - SWAMP
 - CUT-OVER (C/O), BUSH (B) BOUNDARY
 - ROAD

MORIN PROPERTY

MALLARD TOWNSHIP, ONT.



Drawn By: R.L. LABREX LTD. Scale: 1:2500
 Date: JULY, AUG. 1988 M.T.S.: 41-D/8

2.3228