

2 • 32550

Channel Sample Program on Mining Claim L - 1211524, Bernhardt Township, Larder Lake Mining Division in the District of Timiskaming.

| <u>Table of Contents</u> | <u>Page</u> |
|---------------------------------|--------------------|
| Claim Map | 1 |
| Geological Map | 2 |
| Introduction | 3 |
| Location & Access | 3 |
| Geology | 3 |
| The Program & Results | 4 - 5 |
| Conclusions | 5 |
| Maps showing sample locations | 6 - 7 |
| Assays Certificate | 8 |
| Statement of Costs | 9 |

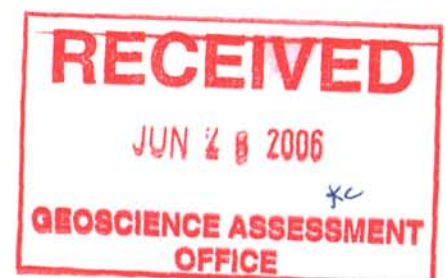

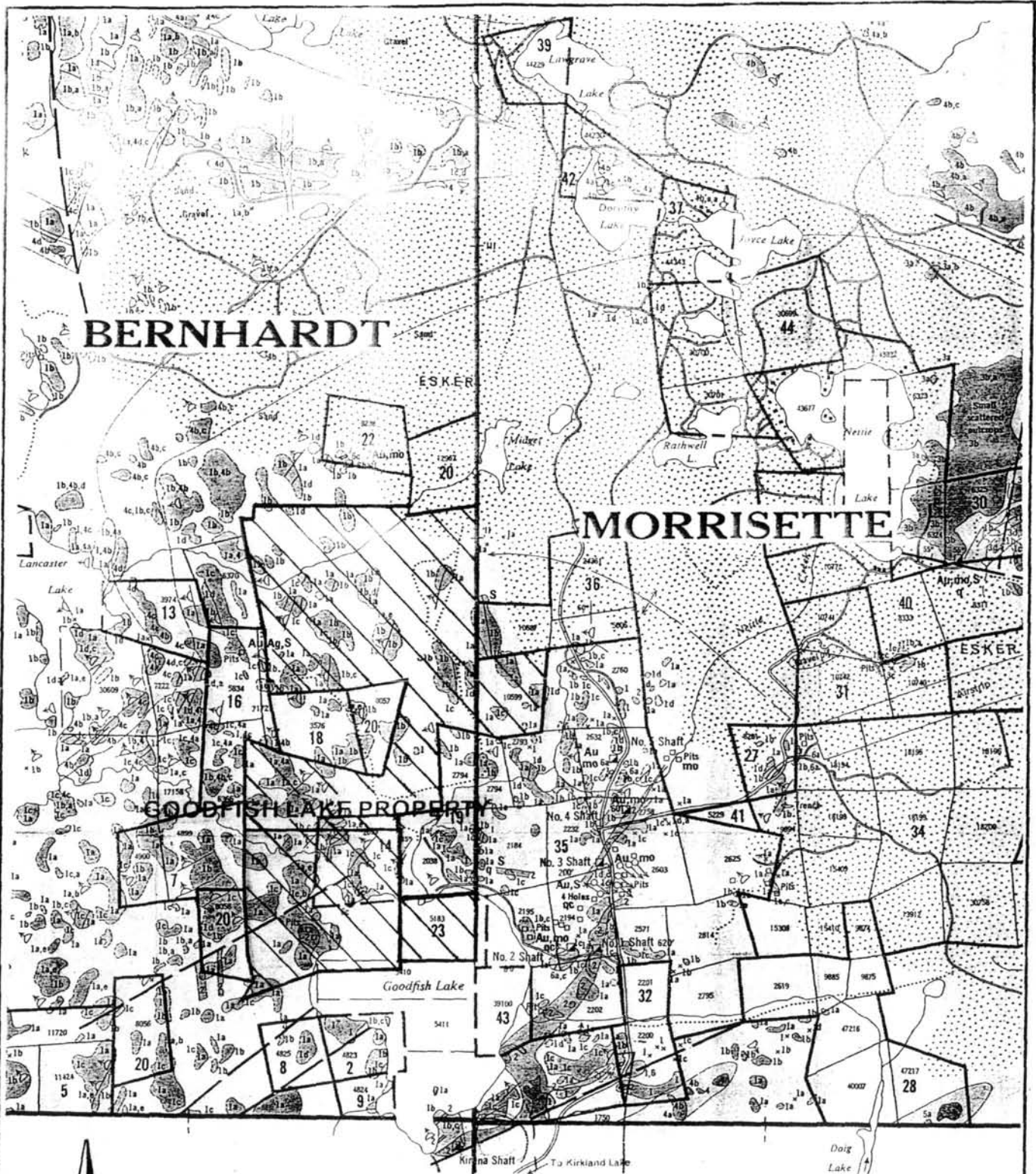

1" = 1/2 mile

42A/SE

32D/SW

DAVE GAMBLE
GEOSERVICES INC

Geology of Bernhardt
and
Morrisette Townships

| | |
|----------------|-----------------------|
| Date Nov. 1996 | N.T.S. 42A/SE 32D/SW |
| Scale | Drawn/Refer to Fig. 4 |

From Map # 2193 after Rupert and Lovell, 1970

Introduction

A two unit claim L - 1211524 , located approximately 400 metres north of the north shore of Goodfish Lake in Bernhardt Township. The claim group is located in the south - eastern part of the Township.

Location & Access

The Goodfish Lake Property is approximately 5 km due north of Kirkland Lake, in the southeast corner of Bernhardt Township. The airport road is used to access Goodfish Lake via Harvey Drive. The only access from the end of Harvey Drive is a drill road that is located along the north shore of the lake, then heads in a north west direction to the gold showing covered in this report..

Geology

The Goodfish Lake property is shown to be underlain by massive and pillowed mafic basalt volcanic flows that are striking northeast, and dipping to the northwest. Minor agglomeritic and porphyritic basalt are also present in the area. The stratigraphy is facing northwest as determined from the pillow facing determinations. A small quartz - feldspar porphyry dyke is located on the west shore of Goodfish Lake in the west central part of the claim. A northeast trending fault is also indicated by Rupert and Lovell located transecting the property near the northeast end of Goodfish Lake. A similar structure is located on mining claim L - 1211524. Stripped area "A" is located in the eastern central part of the claim. The stripped area is approximately 50 metres long in a northeast direction and approximately 20 metres wide. The geology of the sampled area is underlain by a sequence of coarse grained crystalline basalt flows that are massive gabbroic . A basalt volcanoclastic tuff-breccia with fine grained granular matrix carrying fine and cubic pyrite. The 1995 exploration program chip samples from the shear/fault zones in mafic volcanics that hosts significant pyrite and gold mineralization. The best assays returned 3422 ppb over two metres. The structure strikes at 40 degrees and has a known strike of 1400 ft determined by a previous I P survey.

The Program

Channel sampling took place from March 25/06 to March 28/06. On March 25/06 trail was broken into the site, and snow clearing took place. Brush and dead fall were removed from the stripped area. A fire and forty five gallon drum was used to melt snow for the channel saw pump. The work is still on going. A total of sixteen channels were taken in the first phase of the 2006 exploration program which is to try to reproduce the previous assays taken in 1995 by Mr. Dave Gamble. All channels were taken at 1 metre intervals except channels T - 14 & T - 15 which were .5 metres. The results are as follows:

| <u>Sample #</u> | <u>Description</u> | <u>AU,g/tonne/ CU,ppm</u> | |
|------------------------|--|----------------------------------|-----|
| T - 1 | Basalt, fine grained, medium green in colour 1% sulfides. | .02 | 024 |
| T - 2 | Basalt, fine grained, medium green in colour, 1% fine sulfides. | nil | 044 |
| T - 3 | Fine grained basalt, medium green in colour, 1% fine sulfides | nil | 091 |
| T - 4 | Fine grained basalt, medium green in colour, 1 - 2 % fine sulfides. | nil | 028 |
| T - 5 | Fine grained basalt, medium green in colour, 1 - 2 % fine sulfides. | nil | 027 |
| T - 6 | Fine grained basalt, medium green in colour, 1 - 2 % fine sulfides. | nil | 067 |
| T - 7 | Fine grained basalt, medium green in colour, 1 - 2 % sulfides, quartz stringers 1- 2mm wide | .02 | 083 |
| T - 8 | Fine grained basalt, medium green in colour, 1 % fine sulfides. | .02 | 071 |
| T - 9 | Fine grained basalt, medium green in colour, 1 % fine sulfides. | .01 | 053 |

The Program

| <u>Sample #</u> | <u>Description</u> | <u>Au ,g/tonne/CU,ppm</u> | |
|------------------------|--|----------------------------------|-----|
| T - 10 | Fine grained basalt, medium green in colour, 1 % fine sulfides. | .01 | 055 |
| T - 11 | Coarse grained basalt, medium green in colour. carbonate stringers 1-2 mm wide, 1% fine sulfides | .02 | 070 |
| T - 12 | Coarse grained basalt, medium to light green in colour, carbonate - quartz veins , 1 - 2 mm Wide, 1 % fine sulfides. | nil | 127 |
| T - 13 | Coarse grained basalt, medium green in colour, carbonate - quartz veins 1 -2 mm wide, 1 % fine sulfides. | nil | 128 |
| T - 14 | 6mm Quartz - carbonate vein, 2 % fine sulfides, altered basalt, sheared, rusty in colour. | 1.07 | 041 |
| T - 15 | 6 - 8 mm quartz - carbonate vein, 2 % fine sulfides, altered basalt, sheared , rusty in colour. | 1.62 | 043 |
| T - 16 | Altered basalt, quartz - carbonate stringers, 2 mm wide, 2 % fine sulfides, rusty in colour. | .23 | 353 |

Conclusions

Although only two channels returned assays over a gram per tonne, it is felt that further channel sampling will give more favourable results. Copper assays were low and no further sampling will be done for that metal. Due to the snow conditions at the time of this sampling program , the target shear zone which gave 3422 ppb over 2 metres was missed by the channelling process. Also, at the time of this program, a early spring break up had occurred which ended the program due access problems.

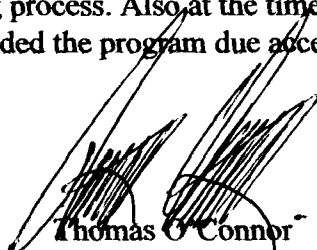

Thomas O'Connor

SKETCH SHOWING
LOCATION OF SAMPLE
AREA "A" ON
CLAIM L-1211524

- PIT "E" 3m x 5m
9546
9547
9548
- PIT "D" 3m x 2m
GFL 96 - 05
- PIT "C"
No Sample
- Quartz Feldspar Porphyry Py
- PIT "B" 3m x 3m
9545
- PIT "A" 3m x 3m
9541
9542
9543
9544
- GFL 96 - 02
- GFL 96 - 03
- GFL 96 - 04

2-32550

LEGEND

- I.P. Surveyed Lines
- Axis of I.P. Anomaly and Limits of Anomaly
- VLF EM Surveyed Grid Lines
- Weak VLF EM Anomalies
- Sample Locations
- Claim Boundaries

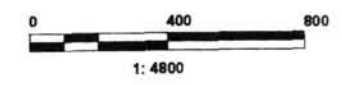

GOODFISH LAKE PROPERTY
T. O'CONNOR

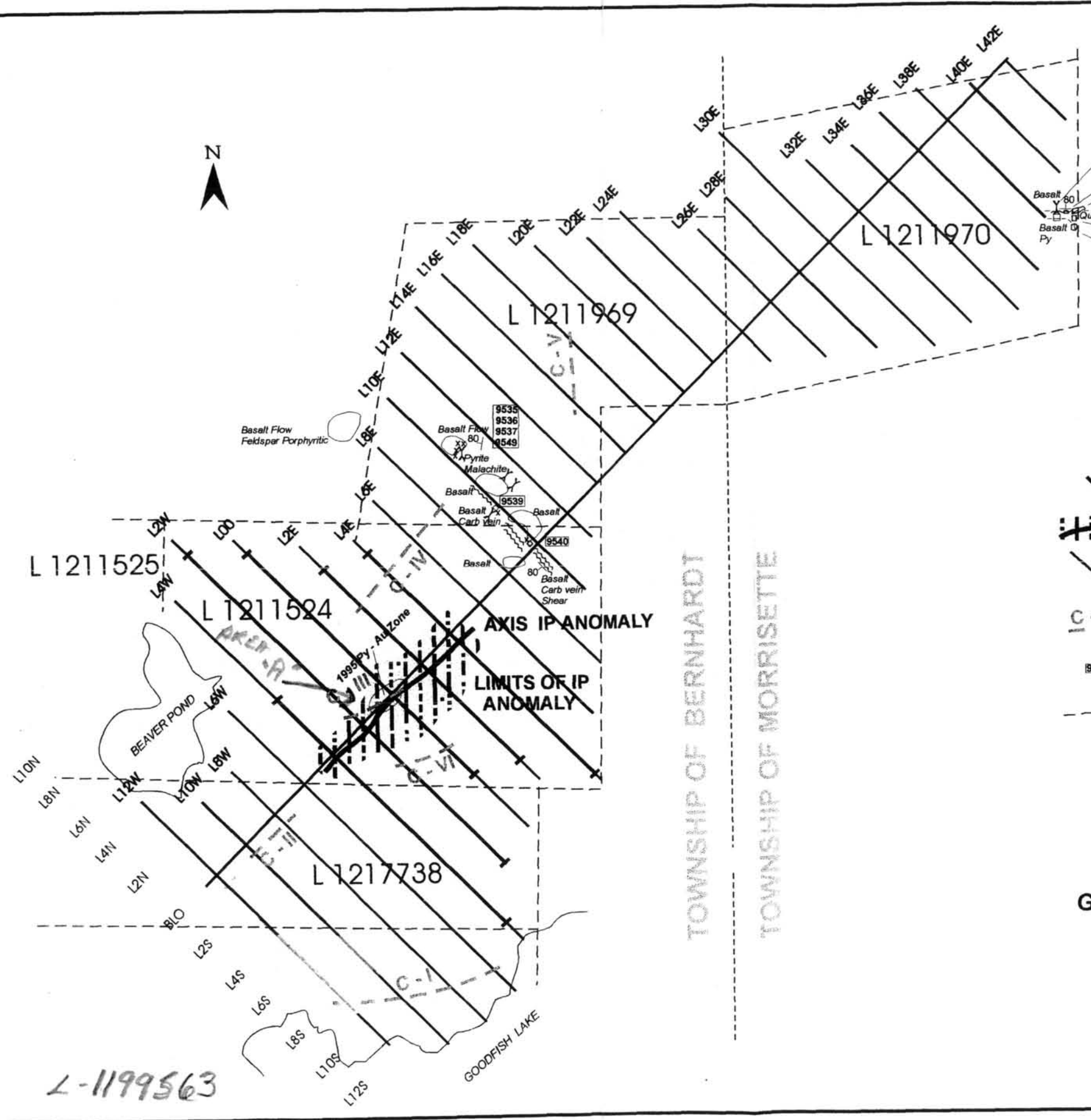

CHANNEL SAMPLING PLAN FOR MINING CLAIM
L-1211524, BERNHART TOWNSHIP

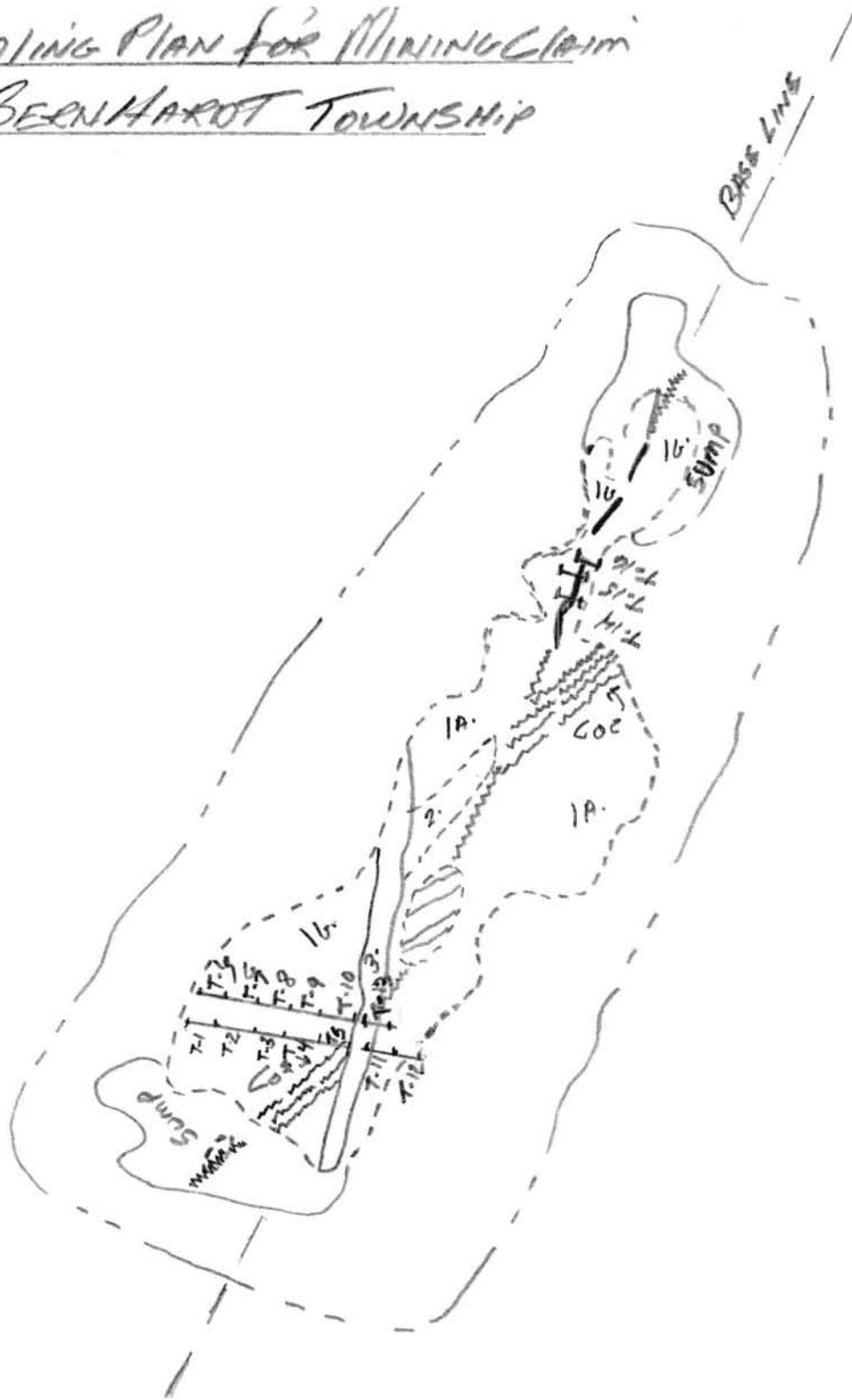

- LEGEND
- GEOLOGY
- 1A BASALT FLOW
MEDIUM GRAINED
 - 1b FINE GRAINED
 - 2. BASALT tuff BRECCIA
 - 3. MAGNETITE
 - ~ QUARTZ VEIN
 - SHEAR/FAULT ZONE
 - CO₂ CARBONATED
 - ⊥ SAMPLE LOCATION
 - ⊗ - OVER BURDEN

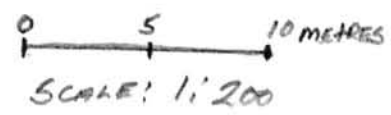



Established 1928

Swastika Laboratories Ltd

Assaying - Consulting - Representation

Assay Certificate

6W-0877-RA1

Company: **TOM O'CONNOR**
Project: Goodfish Lake
Attn: T. O'Connor

Date: APR-07-06

We hereby certify the following Assay of 26 Channel/Rock samples submitted MAR-29-06 by .

| Sample Number | Au g/tonne | Au Check g/tonne | Ag g/tonne | Cu PPM |
|---------------|------------|------------------|------------|--------|
| FGFL-01/06 | 0.05 | 0.03 | 0.1 | 100 |
| FGFL-02/06 | 0.03 | - | 0.1 | 99 |
| FGFL-03/06 | 0.07 | - | 0.3 | 353 |
| FGFL-04/06 | 0.05 | - | 0.1 | 101 |
| FGFL-05/06 | 0.05 | - | 0.1 | 100 |
| FGFL-06/06 | 0.11 | 0.11 | 0.1 | 65 |
| FGFL-07/06 | 0.07 | - | 0.1 | 111 |
| FGFL-08/06 | 0.10 | - | 0.1 | 115 |
| FGFL-09/06 | 0.31 | 0.27 | 0.2 | 82 |
| FGFL 10/06 | Nil | - | 0.3 | 12 |
| T-01/06 | 0.02 | - | 0.1 | 24 |
| T-02/06 | Nil | - | 0.1 | 44 |
| T-03/06 | Nil | - | 0.1 | 91 |
| T-04/06 | Nil | - | 0.1 | 28 |
| T-05/06 | Nil | - | 0.1 | 27 |
| T-06/06 | Nil | - | 0.1 | 67 |
| T-07/06 | 0.02 | - | 0.1 | 83 |
| T-08/06 | 0.02 | - | 0.1 | 71 |
| T-09/06 | 0.01 | - | 0.1 | 53 |
| T-10/06 | 0.01 | 0.03 | 0.1 | 55 |
| T-11/06 | 0.02 | - | 0.1 | 70 |
| T-12/06 | Nil | - | 0.1 | 127 |
| T-13/06 | Nil | - | 0.1 | 128 |
| T-14/06 | 1.07 | 1.15 | 1.2 | 41 |
| T-15/06 | 1.62 | 1.56 | 0.7 | 43 |
| T-16/06 | 0.23 | - | 0.1 | 353 |
| Blank | Nil | - | - | 1 |
| STD OxJ36 | 2.35 | - | - | - |
| STD MA-2c | - | - | - | 93 |

Certified by Denis Chantre

March 29/06

Persons present on Mining Claim L - 1211524, Bernhardt Township, Larder lake Mining
Division in the District of Timiskaming.

March 25/06 to March 28/06

C Webster, 60 Tower Str., Kirkland Lake Ont. P2N 1P2 (705 - 567 - 4759)

T. O Connor PO Box 834, Kirkland Lake Ont, P2N 3K4 (705 - 568 - 0128)

