

Attachment to work report W0660.00815

On April 25,2006 ,Matamec Exploration Inc. signed and executed a contract to have Norex

Drilling to perform 2,000 meters of diamond drilling on the montclergue property.The

contractor was on the property on June 2,2006 and completed Diamond drill hole

MAT-06-01 to a depth of 200 meters. the drillhole was located on Pentland grid

(1997) line 49+00 east Base line 0 tthe hole orientation at the collar was

90 Degrees. The drillhole was started on June 5,2006 and completed on June 7,2006.

2.32508

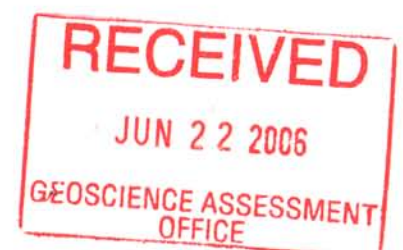



NOREX DRILLING LIMITED
 7210 ~~1450~~ HWY 101 EAST
 PORCUPINE, ONTARIO P0N 1C0

INVOICE

Tel: (705) 235-2222 Fax: (705) 235-2806

NO 1403

DATE 06/16/2006

PAGE 1 of 2

SOLD TO

SHIP TO

Matamec Explorations Inc.
 Att: Aline Leclerc
 1000 rue de la Gauchetiere Ouest
 Bureau 2432
 Montreal, QC H3B 4W5

Matamec Explorations Inc.
 Att: Lionel Bonhomme
 Fax # 268-1725
 Re: Clergue Twp (Montieth Area)
 Drill #8
 June 2-15/06

| ITEM NO | QUANTITY | UNIT | DESCRIPTION | GST | PST | UNIT PRICE | AMOUNT |
|---------|----------|------|--------------------------------|-----|-----|------------|----------|
| | | | HOLE #MAT-06-01, Casing 18m | | | | |
| | 15.0 | m | | G | | 52.00 | 780.00 |
| | 3.0 | m | | G | | 60.50 | 181.50 |
| | 132.0 | m | 18 to 150 | G | | 52.00 | 6,864.00 |
| | 50.0 | m | 150 to 200 | G | | 53.95 | 2,697.50 |
| | 2.0 | ea | Test | G | | 55.00 | 110.00 |
| | 1.0 | hr | pulling casing | G | | 120.00 | 120.00 |
| | | | HOLE # MAT-06-02, Casing 21.7m | | | | |
| | 15.0 | m | | G | | 52.00 | 780.00 |
| | 6.7 | m | | G | | 60.50 | 405.35 |
| | 128.3 | m | 21.7 to 150 | G | | 52.00 | 6,671.60 |
| | 50.0 | m | 150 to 200 | G | | 53.95 | 2,697.50 |
| | 1.0 | ea | Test | G | | 55.00 | 55.00 |
| | 7.0 | 3m** | NW Casing | G | | 172.00 | 1,204.00 |
| | 1.0 | 2*** | NW Casing | G | | 58.80 | 58.80 |
| | 1.0 | ea** | NW Casing Shoe | G | | 290.00 | 290.00 |
| | 1.0 | ea** | NW Casing Cap | G | | 55.00 | 55.00 |
| | | | HOLE #MAT-06-03, Casing 18.7m | | | | |
| | 15.0 | m | | G | | 52.00 | 780.00 |
| | 3.7 | m | | G | | 60.50 | 223.85 |
| | 82.3 | m | 18.7 to 101 | G | | 52.00 | 4,279.60 |
| | 1.0 | ea | Test | G | | 55.00 | 55.00 |
| | 6.0 | 3m** | NW Casing | G | | 172.00 | 1,032.00 |
| | 1.0 | 2*** | NW Casing | G | | 58.80 | 58.80 |
| | 1.0 | ea** | NW Casing Shoe | G | | 290.00 | 290.00 |
| | 1.0 | ea** | NW Casing Cap | G | | 55.00 | 55.00 |
| | | | HOLE #MAT-06-04, Casing 18m | | | | |
| | 15.0 | m | | G | | 52.00 | 780.00 |
| | 3.0 | m | | G | | 60.50 | 181.50 |
| | 132.0 | m | 18 to 150 | G | | 52.00 | 6,864.00 |
| | 47.0 | m | 150 to 197 | G | | 53.95 | 2,535.65 |
| | 2.0 | ea | Test | G | | 55.00 | 110.00 |

COMMENTS

Thank You !

TOTAL ▶

Continued...



NOREX DRILLING LIMITED
 7210 ~~1450~~ HWY 101 EAST
 PORCUPINE, ONTARIO P0N 1C0

INVOICE

Tel: (705) 235-2222 Fax: (705) 235-2806

NO 1403

DATE 06/16/2006

PAGE 2 of 2

SOLD TO

SHIP TO

Matamec Explorations Inc.
 Att: Aline Leclerc
 1000 rue de la Gauchetiere Ouest
 Bureau 2432
 Montreal, QC H3B 4W5

Matamec Explorations Inc.
 Att: Lionel Bonhomme
 Fax # 268-1725
 Re: Clergue Twp (Montieth Area)
 Drill #8
 June 2-15/06

| ITEM NO. | QUANTITY | UNIT | DESCRIPTION | GST | PST | UNIT PRICE | AMOUNT |
|----------|----------|-------|---|-----|-----|------------|----------|
| | 1.5 | hr | Pulling casing | G | | 120.00 | 180.00 |
| | | | HOLE #MAT-06-05, Casing 15m | | | | |
| | 150.0 | m | | G | | 52.00 | 7,800.00 |
| | 14.0 | m | 150 to 164 | G | | 53.95 | 755.30 |
| | 2.0 | ea | Test | G | | 55.00 | 110.00 |
| | 7.0 | 3m** | NW Casing | G | | 172.00 | 1,204.00 |
| | 1.0 | ea** | NW Casing Shoe | G | | 290.00 | 290.00 |
| | 1.0 | ea** | NW Casing Cap | G | | 55.00 | 55.00 |
| | | | HOLE #MAT-06-06, Casing 30m | | | | |
| | 15.0 | m | | G | | 52.00 | 780.00 |
| | 15.0 | m | | G | | 60.50 | 907.50 |
| | 2.0 | m | 30 to 32 | G | | 52.00 | 104.00 |
| | 1.0 | month | EZ Shot Inst # 214 Start Date: June 2 to July 1/06 | G | | 1,650.00 | 1,650.00 |
| | | | Note: Core Boxes supplied by Matamec ** Material Charge \$ 4,592.60 @ 7% | G | | | 321.48 |
| | | | G - GST 7.00% | | | | |
| | | | GST | | | | 3,806.13 |

Norex Drilling Ltd. GST: #10390 4504

COMMENTS

Thank You !

TOTAL

58,179.06

Diamond Drill Log
Montclerg Project - Lot 2 Conc. 1, Clergue Township.

Drill Hole - 06MAT-01 **Hole Location -** Baseline at 4900 m East (Pentland Firth grid)

Hole orientation @ collar -90°

@ 101 m Az. - 228.3°, Dip -88.8° with Reflex EZ-SHOT™

@ 200 m Az. - 253.3°, Dip -88.7° with Reflex EZ-SHOT™

Total Depth - 200 m

Started - June 5, 2006

End - June 7, 2006

Logged by - A. LeClerc

Supervised by E.H. van Hees, P.Geol

| <u>Metres</u> <u>(m)</u> | <u>Description</u> | <u>Samples - Interval</u> |
|-----------------------------|--|---------------------------|
| 0.00 - 18.00 | Casing in Overburden | |
| 18.00 - 87.70 | Felsic to Intermediate volcanic, grey to yellow-green in colour | |
| | 23.70-54.95m - sericite alteration with carbonatization and silicification | |
| (1.00) | 23.70-25.50m - Quartz veins with 2% Py + Aspy | 122101 - 23.70-24.70 |
| (1.00) | 32.00-35.00m - Quartz veins with trace Py + Aspy | 122102 - 24.70-25.70 |
| (1.20) | | 122103 - 25.70-26.90 |
| (1.00) | | 122104 - 32.00-33.00 |
| | 35.00-36.50m - First marker horizon - Greyish-Black volcanoclastic | |
| (1.50) | 40.00-42.50m - Brecciated quartz-chlorite vein and fracture zone | 122105 - 39.50-41.00 |
| | 52.00-52.10m - Fracture zone | |
| (1.00) | 51.00-54.00m - 2 to 3% Py + Aspy | 122106 - 51.00-52.00 |
| (1.00) | | 122107 - 52.00-53.00 |
| (1.00) | | 122108 - 53.00-54.00 |
| (1.00) | 62.75-65.75m - Quartz veins with 1 to 2% Py Aspy | 122109 - 62.75-63.75 |

| | | |
|---|---|----------------------------------|
| (1.00) | | 122110 - 63.75-64.75 |
| (1.00) | | 122111 - 64.75-65.75 |
| 36.50m) | 70.50-71.20m - Flow top breccia 71.20-76.10m - Second marker horizon (similar to marker at 35.00- | |
| (1.00) | 74.20-75.40m - Quartz-carbonate vein | 122112 - 74.80-75.80 |
| (0.50) | | 122113 - 75.80-76.40 |
| | 76.10m - massive pyrite seam | |
| <u>Metres</u> <u>(m)</u> | <u>Description</u> | <u>Samples - Interval</u> |
| (1.00) | 76.10-78.40 - 5% disseminated Py and Aspy | 122114 - 76.40-77.40 |
| (1.00) | | 122115 - 77.40-78.40 |
| | 78.40-79.60 - Fractured and altered with intense limonite alteration | |
| (1.00) | 79.50-83.65 - Quartz - j vein with 1% Aspy-Py | 122116 - 80.00-81.00 |
| (1.00) | with 1% Aspy-Py | 122117 - 81.00-82.00 |
| (1.00) | with 1% Aspy-Py | 122118 - 82.00-83.00 |
| (1.00) | with 1% Aspy-Py | 122119 - 83.00-83.65 |
| (0.65) | | |
| 87.70 - 94.25 (1.20) | Leucoxene Basalt with trace Py | 122120 - 92.00-93.20 |
| 94.25 -117.40 | Felsic to intermediate lava, that is altered to yellow-green colour because of sericite, contains disseminated Py + Aspy and is carbonatized. There are veinlets of quartz in numerous small fractures. | |
| 102.00 (0.70) | - disseminated Aspy and Py | 122121 - 101.30- |
| 105.30 (1.30) | - 2% fine-disseminated Py | 122122 - 104.00- |
| 106.30 (1.00) | - >5% Py | 122123 - 105.30- |
| 107.25 (0.95) | - Trace - 2% Py | 122124 - 106.30- |

108.00 (0.75) - Trace - 2% Py 122125 - 107.25-

108.10-111.50 - Brecciated Zone with small rounded fragments that
contain fine Aspy 122126
- 111.50-112.25 (0.75)

113.25 (0.75) 122127 - 112.50-

117.40 - 200.00 Andesite with fine greyish grains and minor accumulations of Py here
and there. Quartz filled vesicles. Flow top breccia from 135.80-136m, 136.60- 137m
and 138.70-141.40m with small accumulations of Py and Pyrr. 122128 - 135.00-

136.00 (1.00)

200.00 End of Hole (EOH).

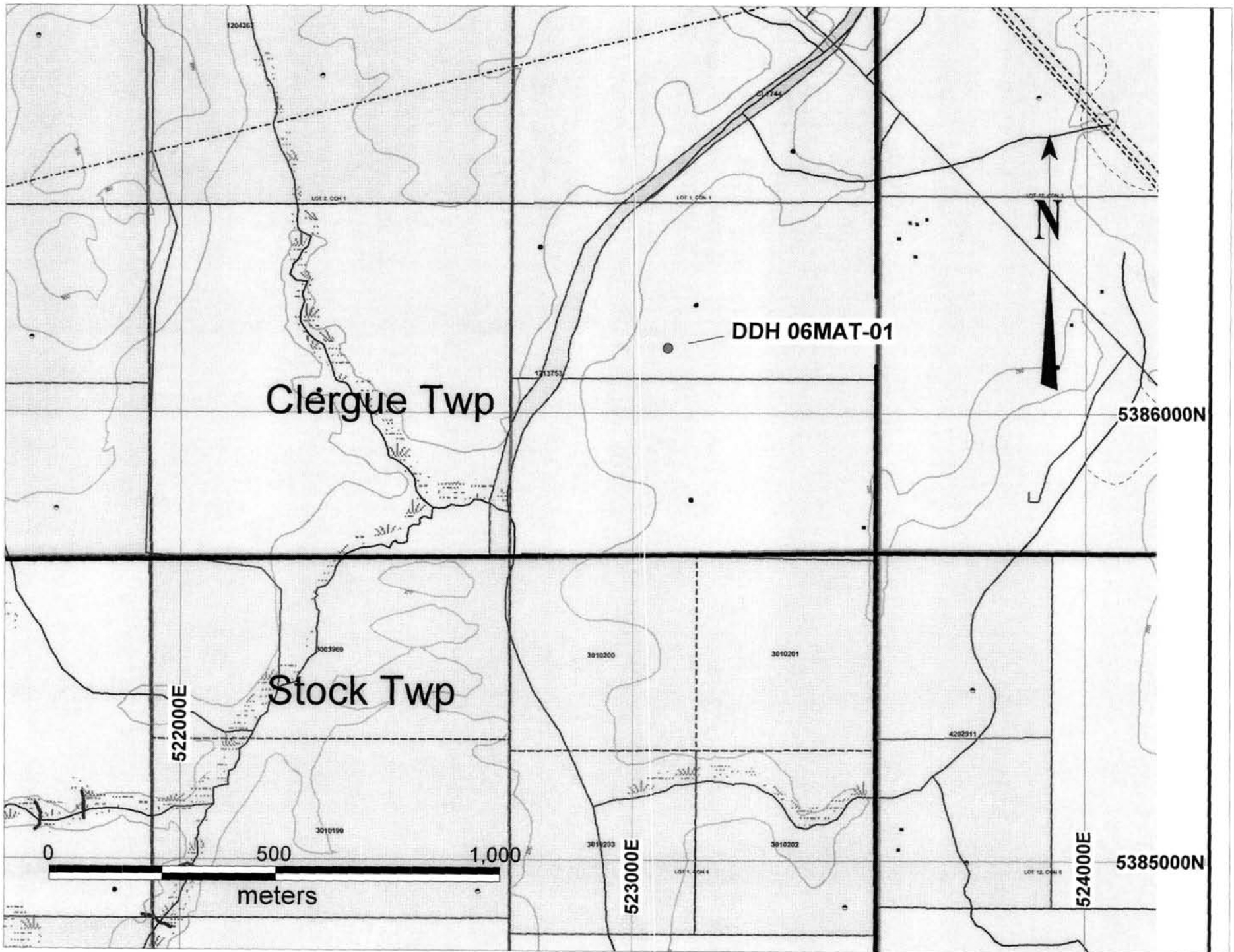

Drill Hole Location Map

Clergue Twp

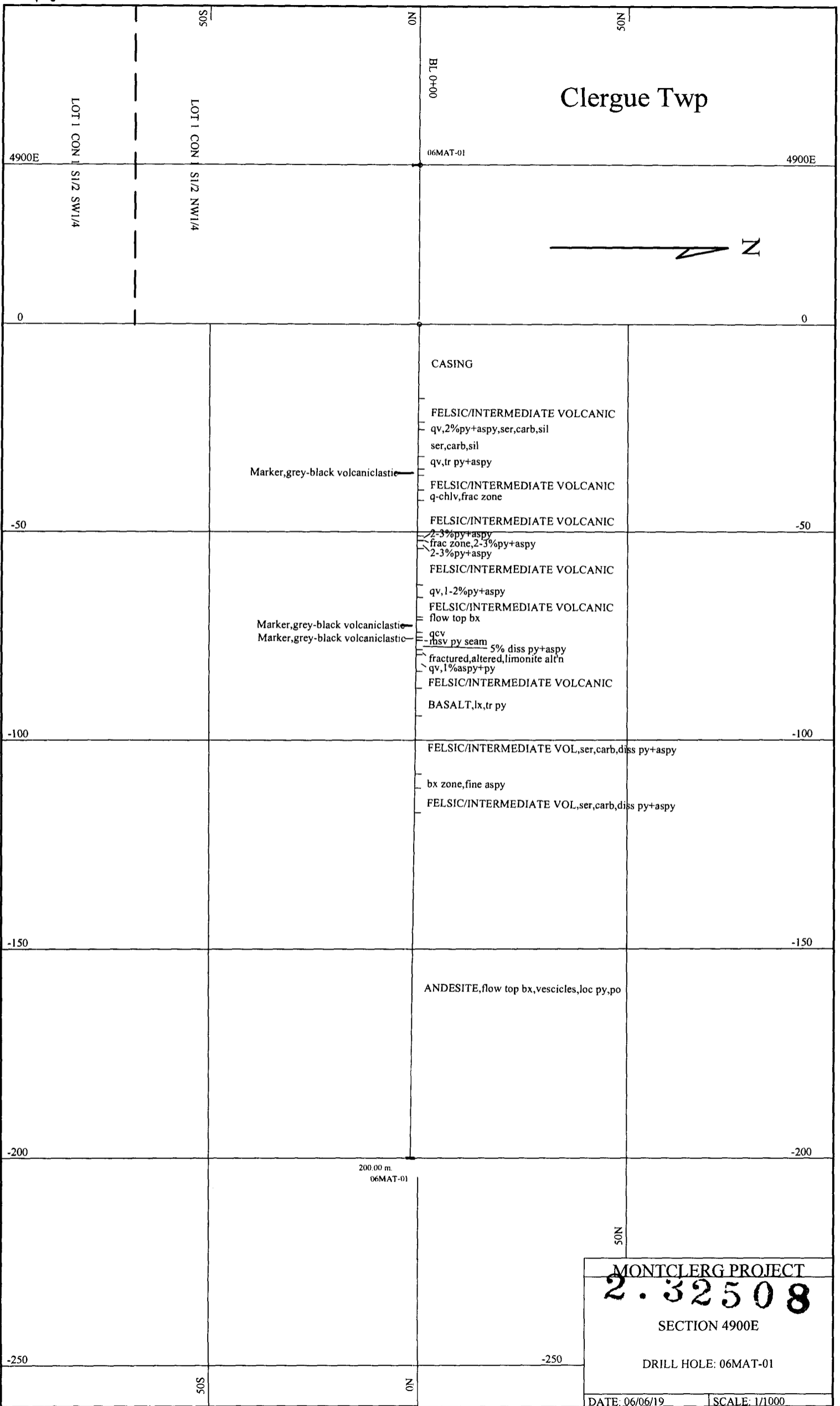

MONTCLERG PROJECT
2.32508
 SECTION 4900E
 DRILL HOLE: 06MAT-01
 DATE: 06/06/19 SCALE: 1/1000