

Magnetic North
Declination = 11 deg

2.32890'

Beaumont Property Boundary

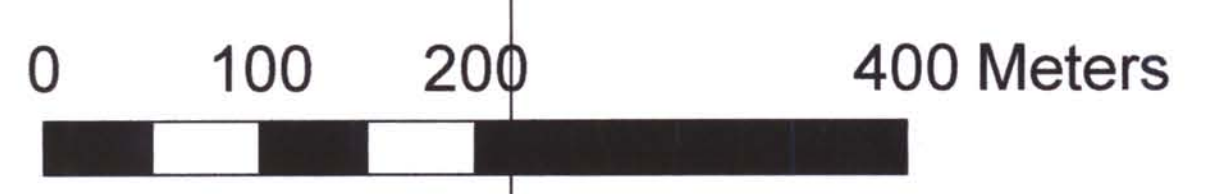

Placer Dome

UTM, Zone 17
NAD 83
1986 Spheroid
Datum: S. Harding
Date: 11/24/2005
Scale: 3500
Location: Timmins, ON

Porcupine Joint Venture
Timmins, Ontario

**Beaumont Property
Diamond Drill Plan Map**

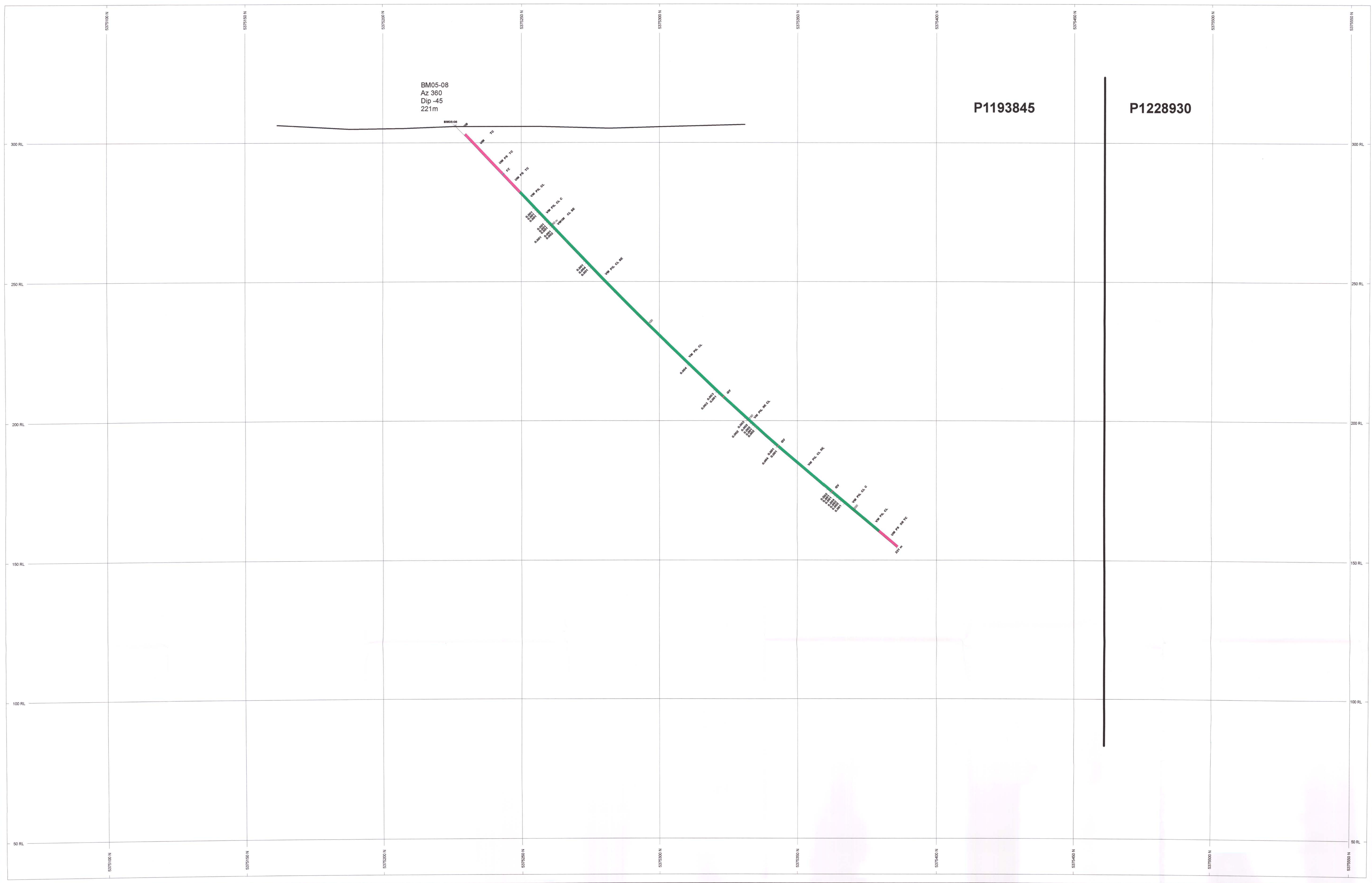
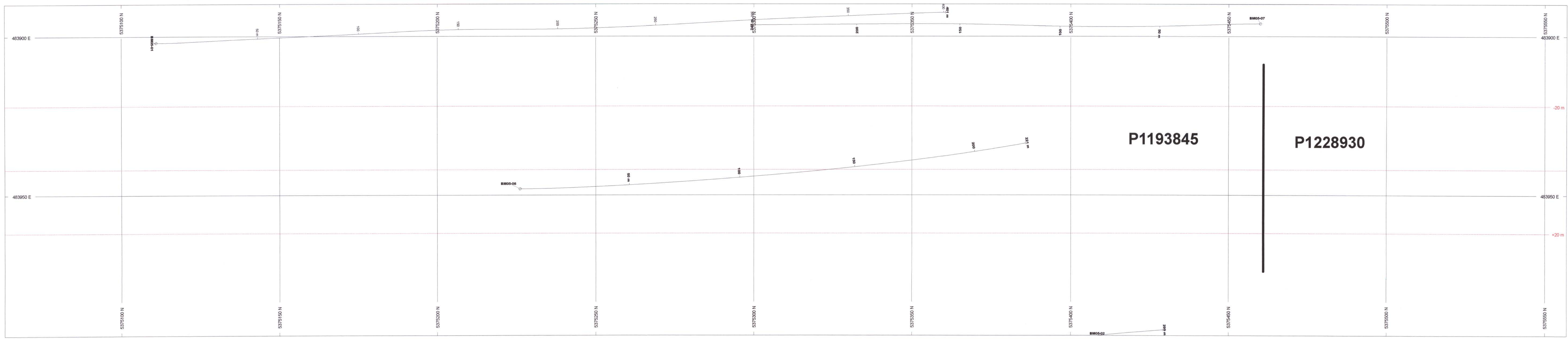

2.02090

ROCK CODES	LIR	PAT	LABEL	DESCRIPTION
Lithology	R	FZ	FZ	Fault Zone
	R	QV	QV	Quartz Vein
	R	WM	WM	Weakly Metamorphosed
	R	WH	WH	High Fe Basalts
	R	LM	LM	Lithologic Metamorphosis

ASSAYS	LIR	TEXT
Au_AA_3pm (ppm)	L	---

POSTED TEXT	LIR	TEXT	ITEMS
Lithology	R	---	AL
Texture	R	---	AL
Alteration	R	---	AL
Alteration2	R	---	AL

SECTION SPECS
 REF. PT. E: N
 EXTENTS: 403.9 m 312.7 m
 SECTION TOP: 348.8 m 371.1 m
 TOLERANCE: +/- 20 m

SCALE 1 : 500
 (m)
 0 5 10 15 20
 "unknown"

AZIMUTH = 0°
 N
 W
 E
 S

Porcupine Joint Venture
 Beaumont Property
 Drill Section L14+50E
 BM05-08

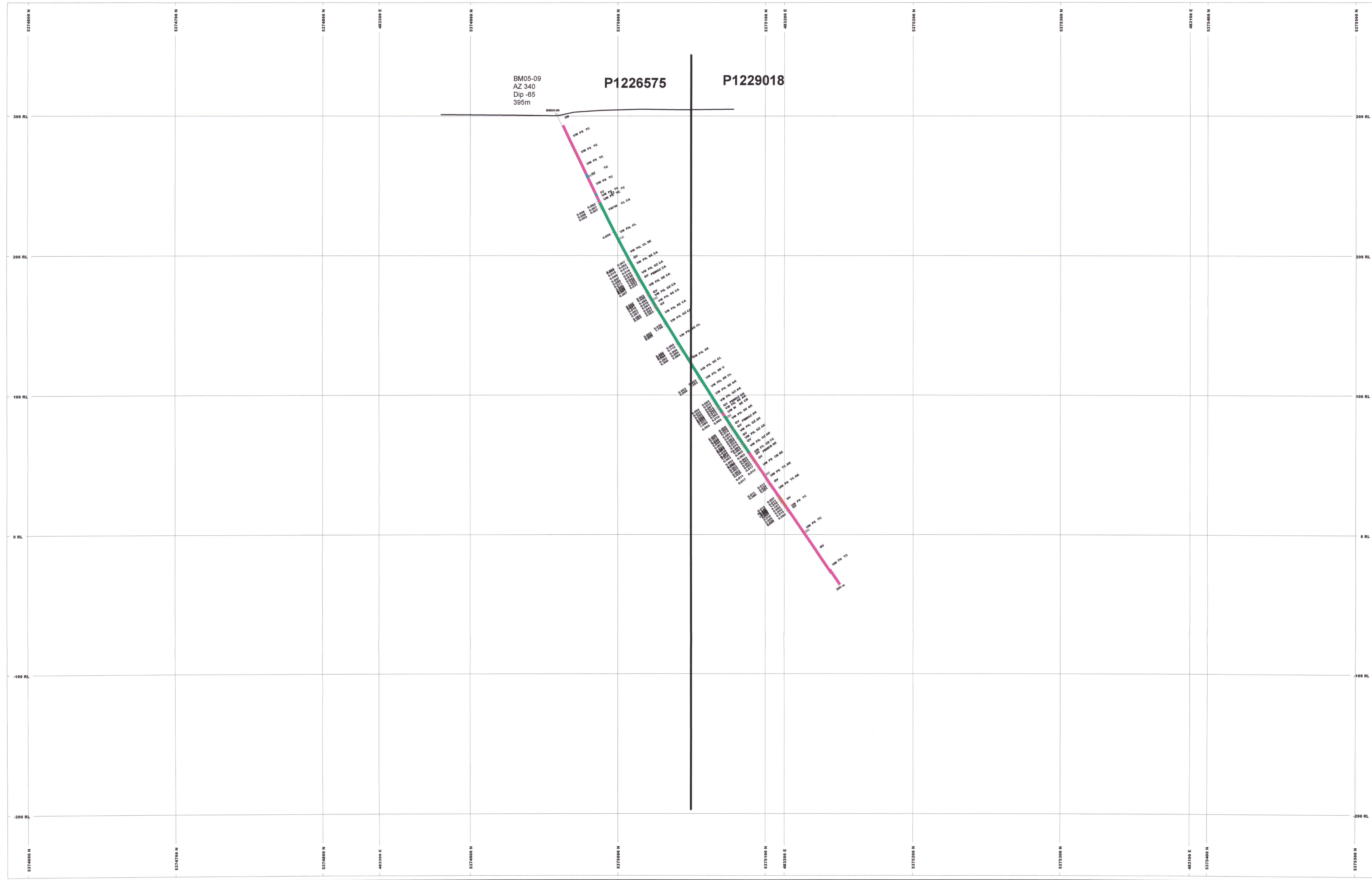
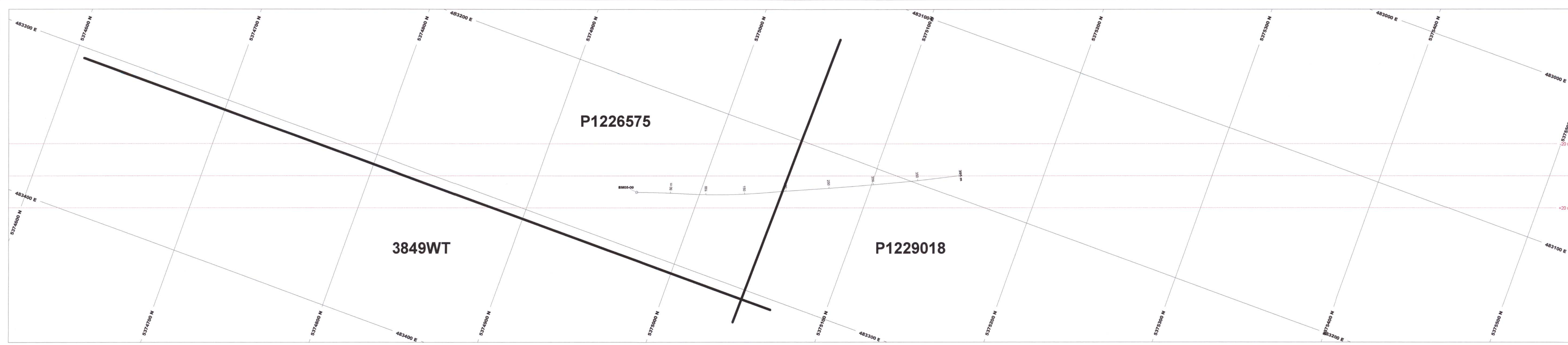

2.32890

ROCK CODES	LIR	PAT	LABEL	DESCRIPTION
Lithology	R	---	FZ	Field Zone
			QV	Quartz Vein
			VM	Meta-Metabasalt
			VM1	High Fe Basalts
			UM	Ultramafic Metabasalt

ASSAYS	LIR	TEXT
Al ₂ O ₃	L	---

POSTED TEXT	LIR	TEXT	ITEMS
Lithology	R	---	AL
Texture	R	---	AL
Alteration	R	---	AL
Alteration2	R	---	AL

SECTION SPECS:
 REF. PT. E, N 462228 m 5375000 m
 EXTENTS 987.8 m 625.3 m
 SECTION TOP, BOT 381 m -244.3 m
 TOLERANCE +/- 20 m

SCALE 1 : 1000
 0 10 20 30 40
 m
 "unknown"

AZMUTH = 340°

 N
 S
 E
 W

Porcupine Joint Venture
 Beaumont Property
 Drill Section L7+40E (Az 340)
 BM05-09

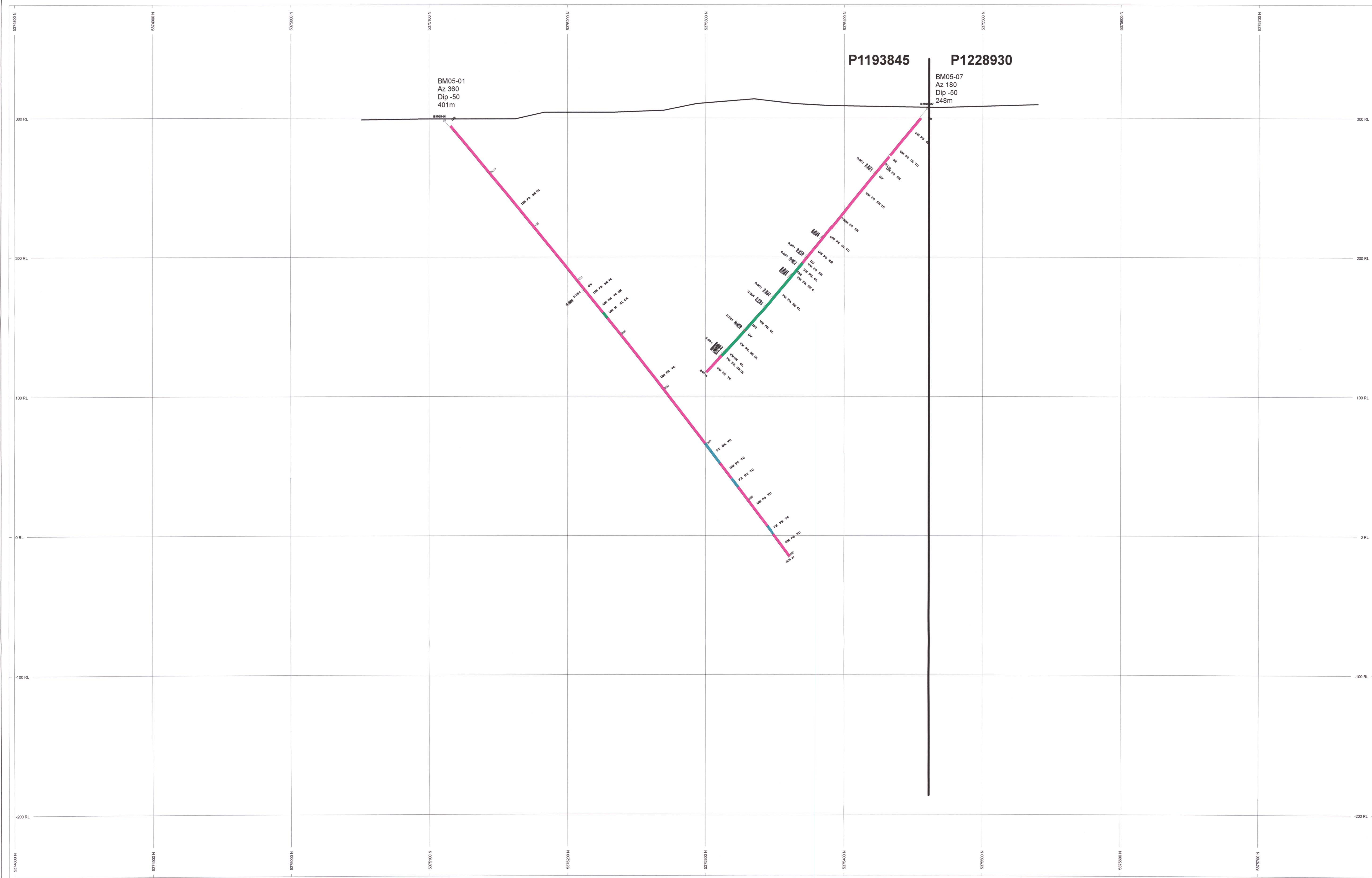
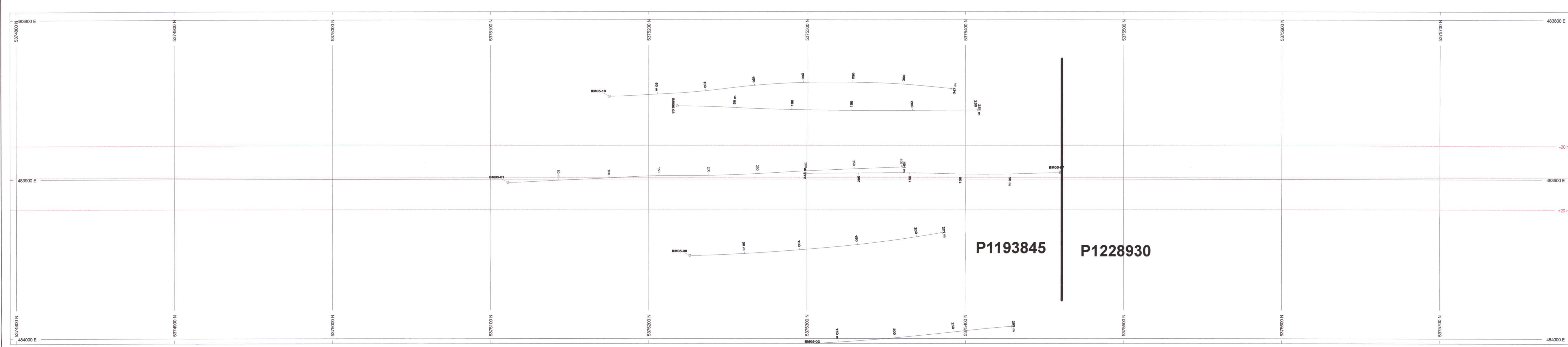

ROCK CODES	L/R	PAT	LABEL	DESCRIPTION
Lithology	R	FZ	Fault Zone	
	R	CV	Quartz Vein	
	R	WM	Meta-Metabasalts	
	R	W1	High Fe Basalts	
	R	UM	Ultramafic Metabasalts	

ASSAYS	L/R	TEXT
Az,Al,Spm (ppm)	L	

POSTED TEXT	L/R	TEXT	ITEMS
Lithology	R		AI
Tectonic	R		AI
Alteration	R		AI
Alteration2	R		AI

SECTION SPECS	
REF. PT. E, N	483950 m 537500 m
EXTENTS	807 m - 825.3 m
SECTION TOP, BOT	361 m - 244.3 m
TOLERANCE +/-	20 m

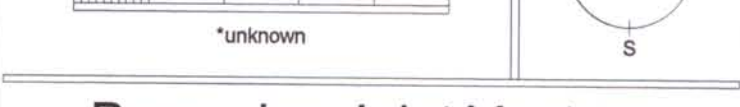

Porcupine Joint Venture
 Beaumont Property
 Drill Section L14+00E
 BM05-01 & BM05-07

2.32890

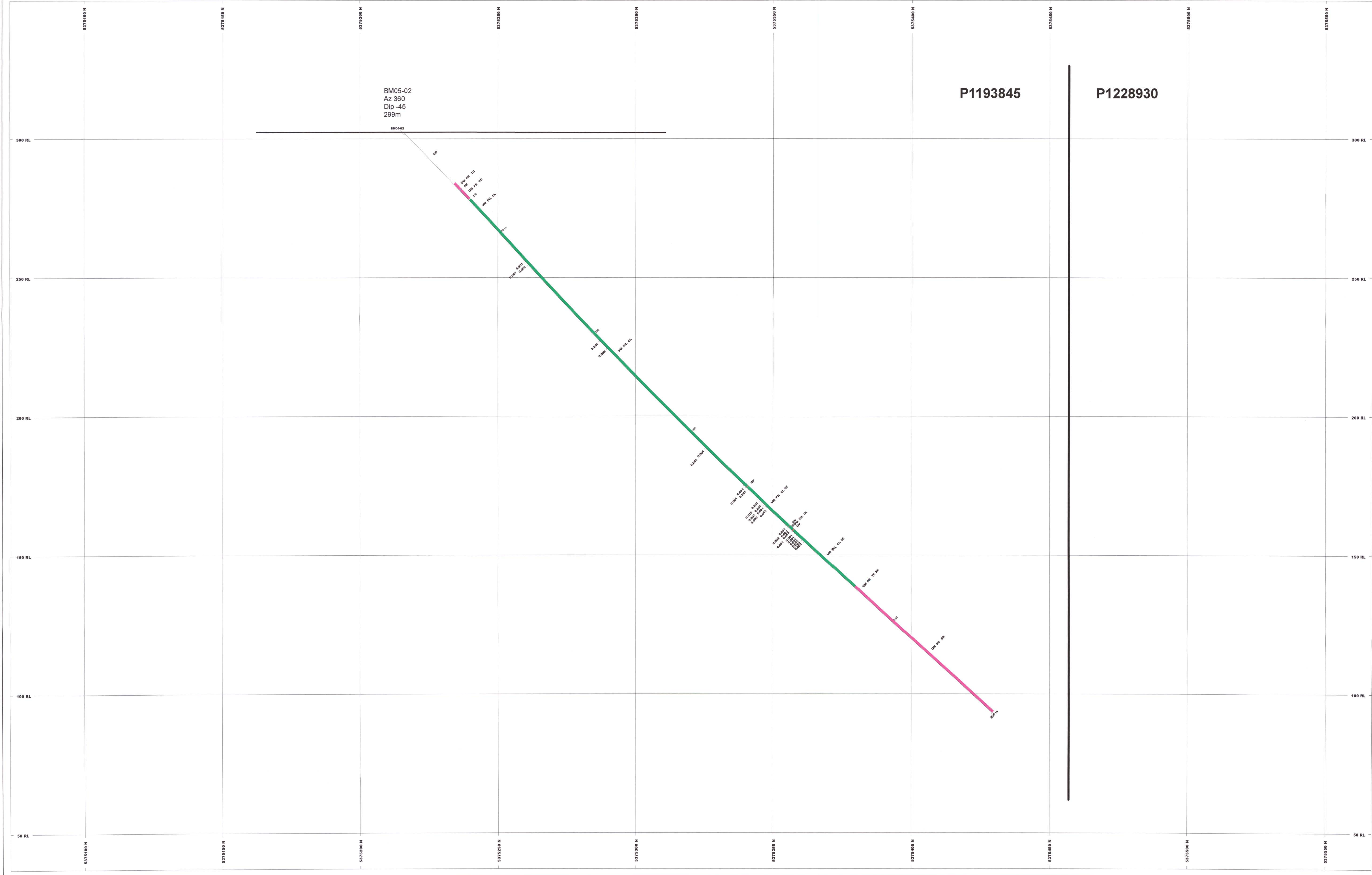
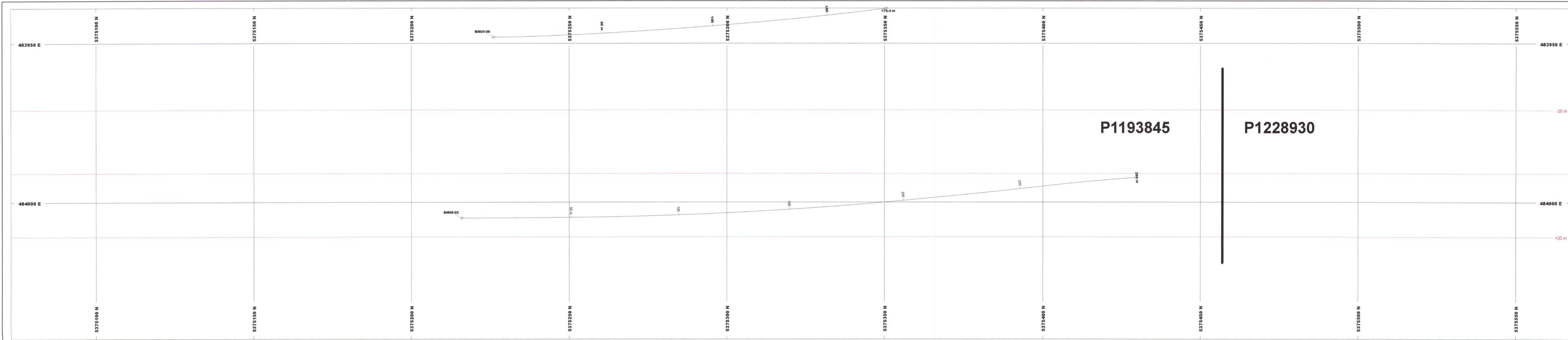

BM05-02
Az 360
Dip -45
299m

ROCK CODES	LR	PAT	LABEL	DESCRIPTION
Lithology	R	FZ	Fault Zone	
	R	CV	Crack Vein	
	R	VM	Mafic Metavolcanics	
	R	UM	Ultramafic Metavolcanics	

ASSAYS	LR	TEXT	ITEMS
Al_gsm	L	---	---

POSTED TEXT	LR	TEXT	ITEMS
Lithology	R	---	All
Tecton	R	---	All
Alteration	R	---	All
Alteration2	R	---	All

SECTION SPECS:

REF. PT. E, N: 483950, 5371500

EXTENTS: 4839.9, 5371.7

SECTION TOP, BOT: 300.0, 171.1

TOLERANCE +/-: 20 m

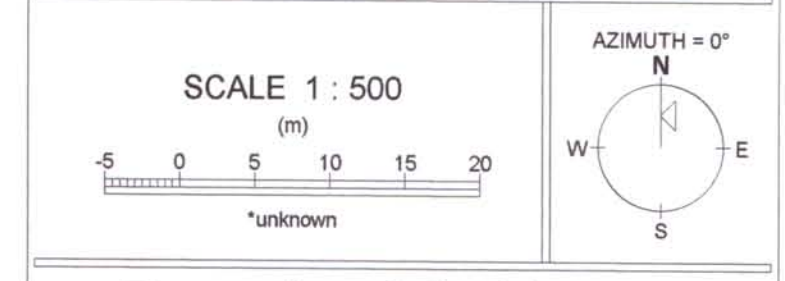

Porcupine Joint Venture
Beaumont Property
Drill Section L15+00
BM05-02

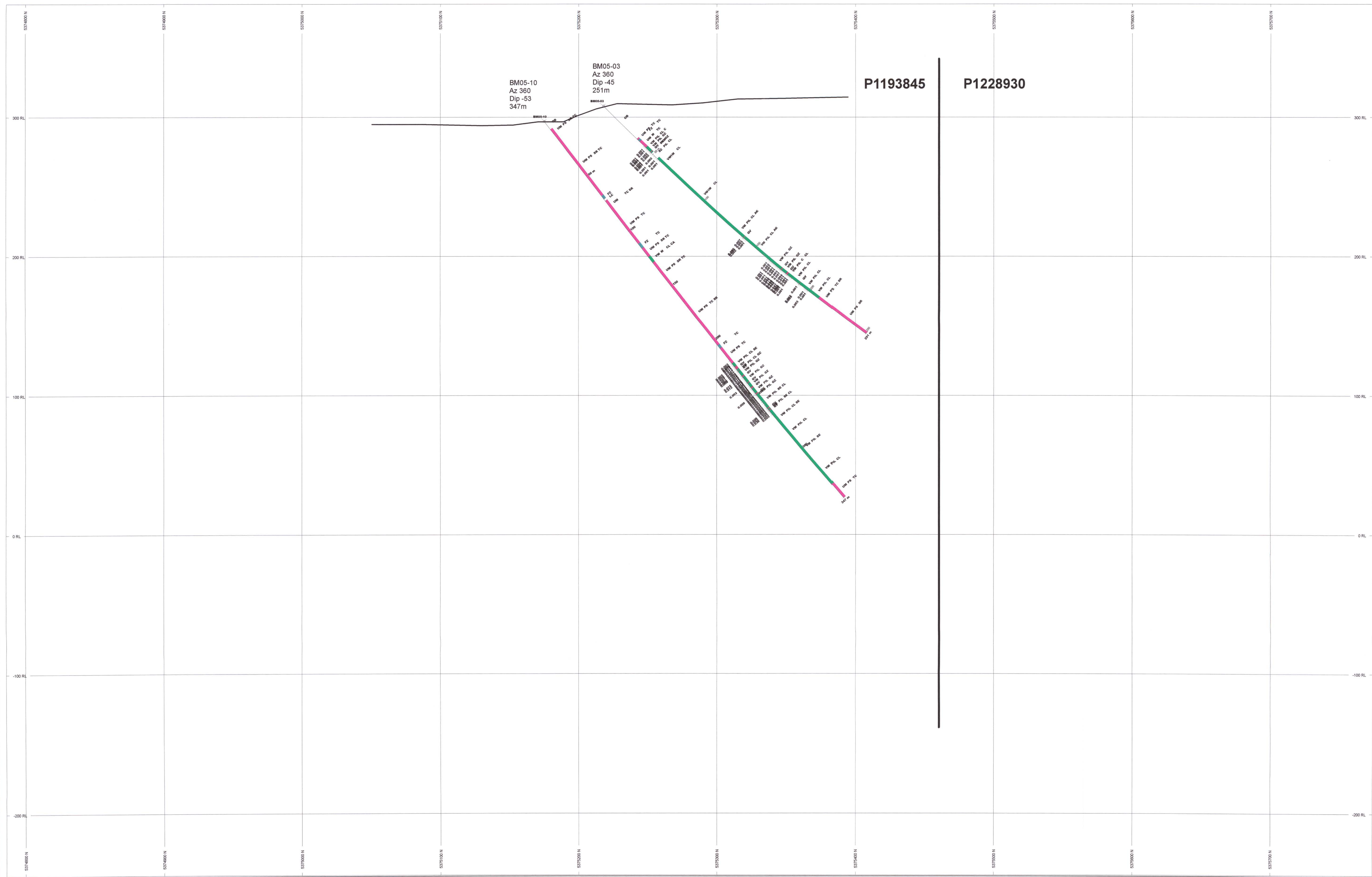
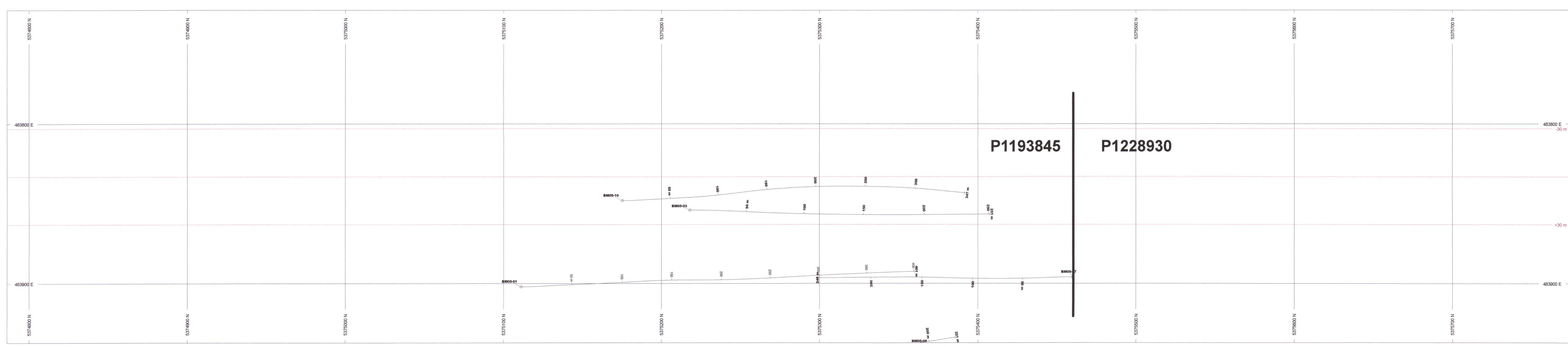

ROCK CODES	L/R	PAT	LABEL	DESCRIPTION
Lithology	R	---	FZ	Fault Zone
	R	---	QV	Quartz Vein
	R	---	SM	Metals Metachronics
	R	---	VMI	High Fe Banded
	R	---	UM	Ultramafic Metachronics

ASSAYS	L/R	TEXT
Az/Az_Spm (ppm)	L	---

POSTED TEXT	L/R	TEXT	ITEMS
Lithology	R	---	AI
Taxite	R	---	AI
Alteration	R	---	AI
Alteration2	R	---	AI

SECTION SPECS.
 REF. PT. E.N. 483833 m 5375200 m
 EXTENTS 467.8 m 625.3 m
 SECTION TOP, BOT 381 m -244.3 m
 TOLERANCE +/- 30 m

SCALE 1 : 1000
 AZIMUTH = 0°
 Porcupine Joint Venture
 Beaumont Property
 Drill Section L13+50E
 BM05-03, BM05-10

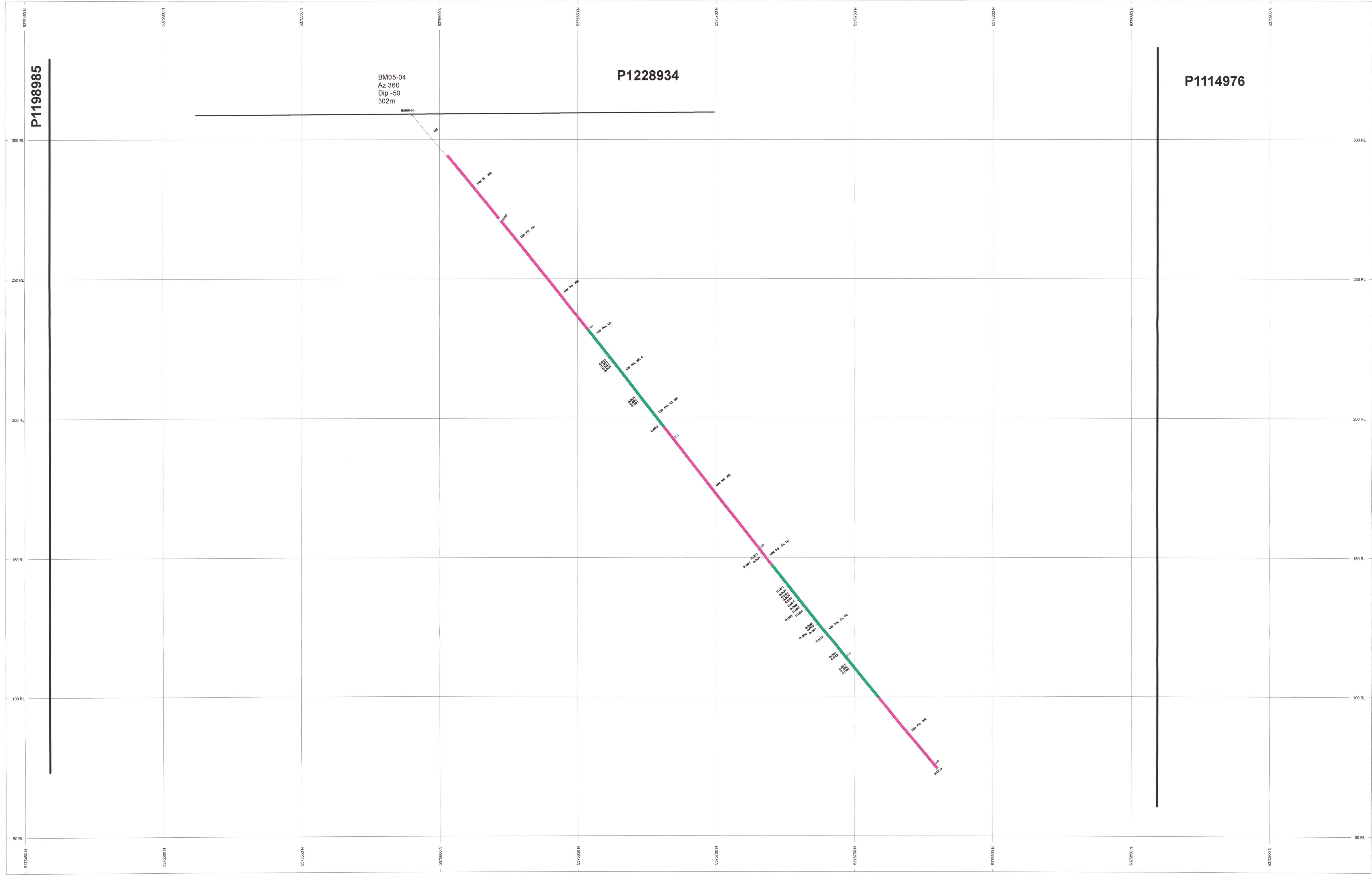
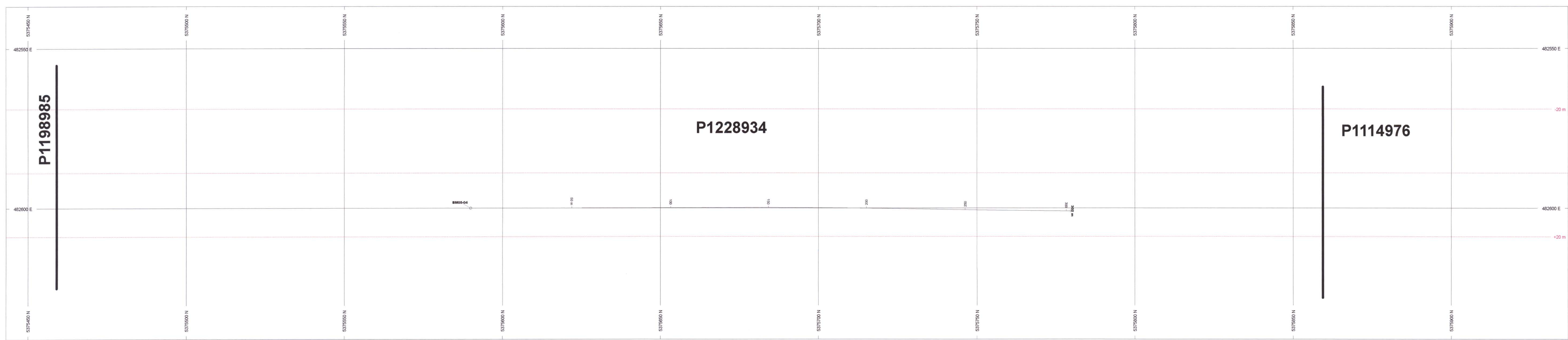

BM05-04
Az 360
Dip -50
302m

ROCK CODES	LR	PAT	LABEL	DESCRIPTION
Lithology	R	VM	LM	Mafic Metabasalt Ultramafic Metabasalt
ASSAYS	LR	TEXT		
Au_AA_ppm	L			
POSTED TEXT	LR	TEXT	ITEMS	
Lithology	R		All	
Texture	R		All	
Alteration	R		All	
Alteration2	R		All	

SECTION SPECS:
REF. PT. E. N. 452599 m 5375960 m
EXTENTS 493.9 m 312.7 m
SECTION TOP, BOT. 368.8 m 37.1 m
TOLERANCE +/- 20 m

SCALE 1 : 500
(m)
0 5 10 15 20
Unknown

AZIMUTH = 0°
N
E
S
W

Porcupine Joint Venture
Beaumont Property
Drill Section L1+00E
BM05-04

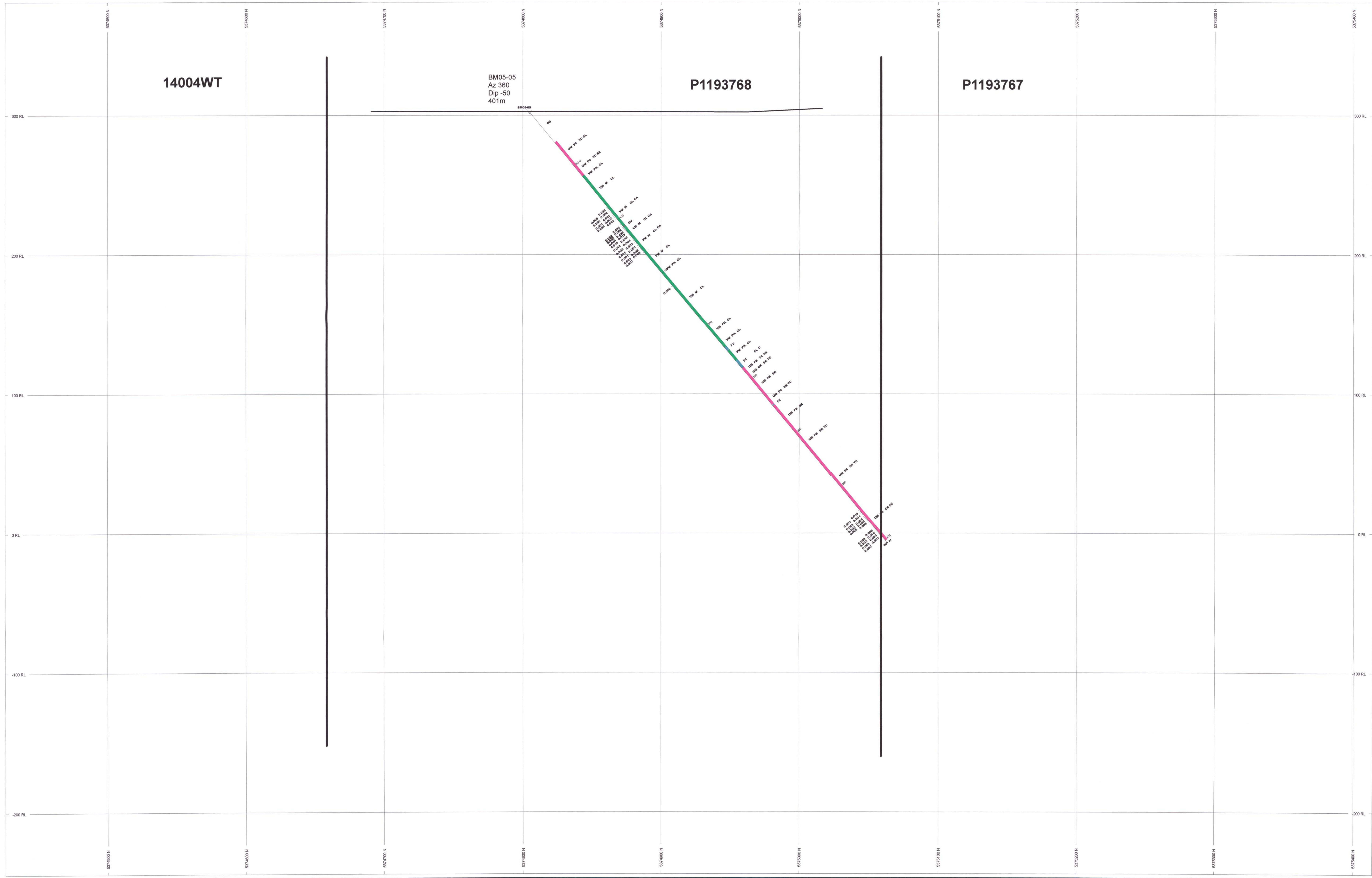
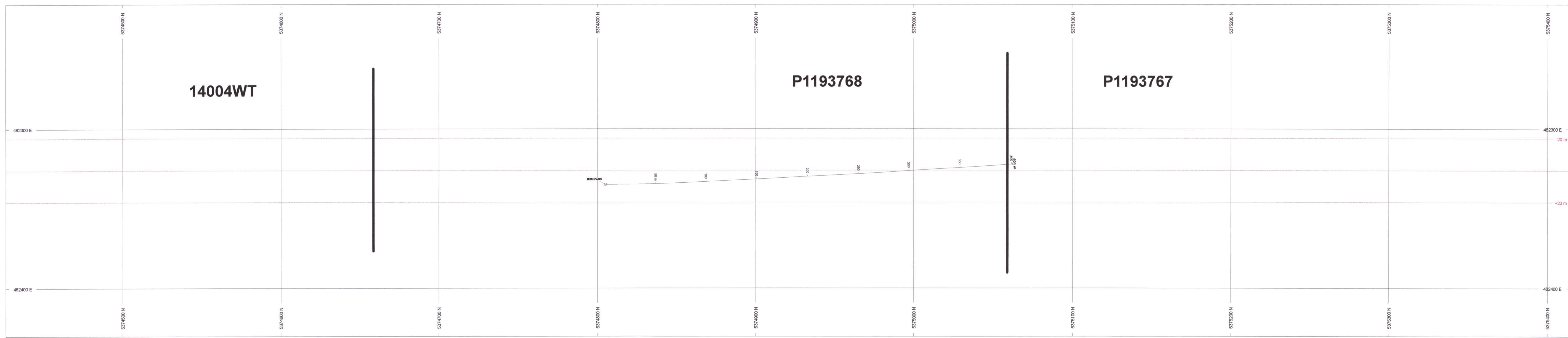

ROOM CODES	LR	DAT	LABEL	DESCRIPTION
Lithology	R		FZ	Fract Zone
	R		QV	Quartz Vein
	R		UM	Ultramic Metasomatics
	R		LM	Ultramafic Metasomatics

ASSAYS	LR	TEXT
Al ₂ O ₃ ppm (ppm)	L	

POSTED TEXT	LR	TEXT	ITEMS
Lithology	R		
Labels	R		
Alteration	R		
Alterations	R		

SECTION SPECS:
 REF PT. E N 482306 m 5374620 m
 EXTENTS 687.6 m 622.3 m
 SECTION TOP BOT 381 m -244.3 m
 TOLERANCE +/- 20 m

SCALE 1 : 1000
 (m)
 -10 0 10 20 30 40
 *unknown

AZIMUTH = 0°
 N
 E
 S
 W

Porcupine Joint Venture
 Beaumont Property
 Drill Section L1+50W
 BM05-05

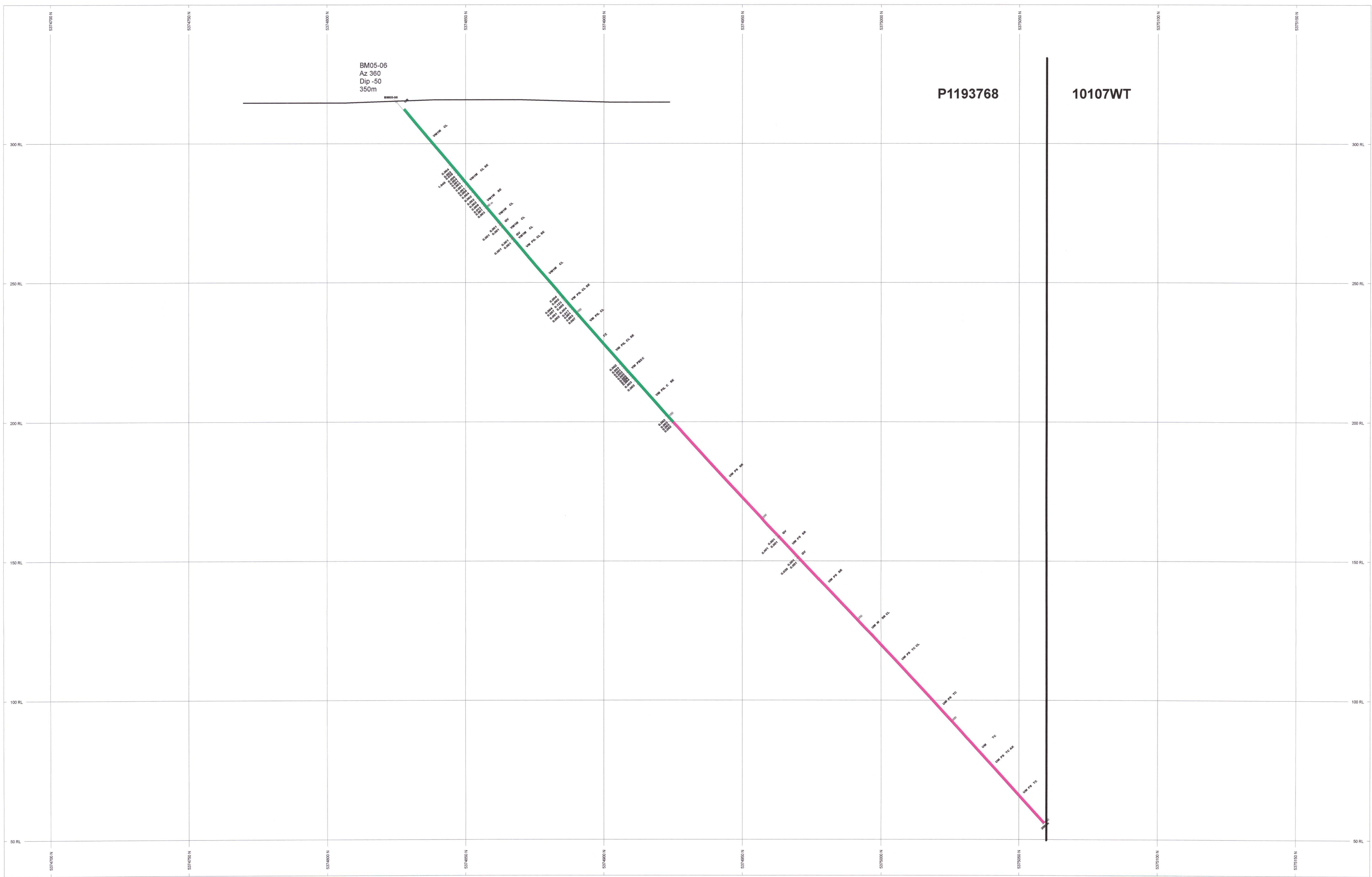
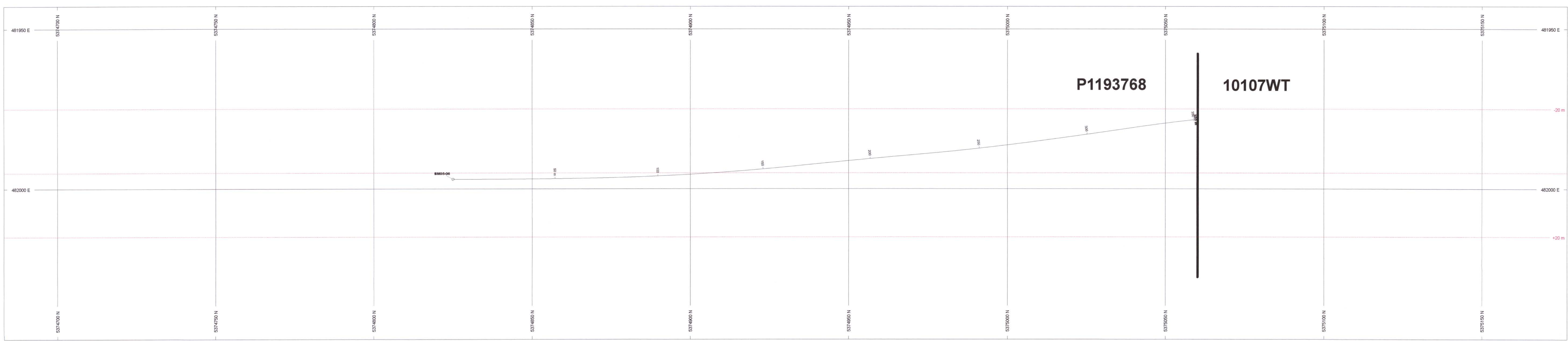

BM05-06
Az 360
Dip -50
350m

ROCK CODES	LIR	PAT	LABEL	DESCRIPTION
Lithology	R	FZ	Fail Zone	
	R	CV	Quartz Vein	
	R	VM	Mafic Metavolcanics	
	R	VM	High Fa Basalts	
	R	UM	Ultramafic Metavolcanics	

ASSAYS	LIR	TEXT
Au_AA_ppm	L	---

POSTED TEXT	LIR	TEXT	ITEMS
Lithology	R	---	AI
Texture	R	---	AI
Alteration	R	---	AI
AlterationC	R	---	AI

SECTION SPECS

REF. PT. E. N 481905 m 5374900 m
 EXTENTS 493.9 m 312.7 m
 SECTION TOP, BOT 346.6 m 37.1 m
 TOLERANCE +/- 20 m

SCALE 1 : 500
 (m)
 0 5 10 15 20
 *unknown

AZIMUTH = 0°
 N
 E
 S
 W

Porcupine Joint Venture
 Beaumont Property
 Drill Section L5+00W
 BM05-06

2.32890

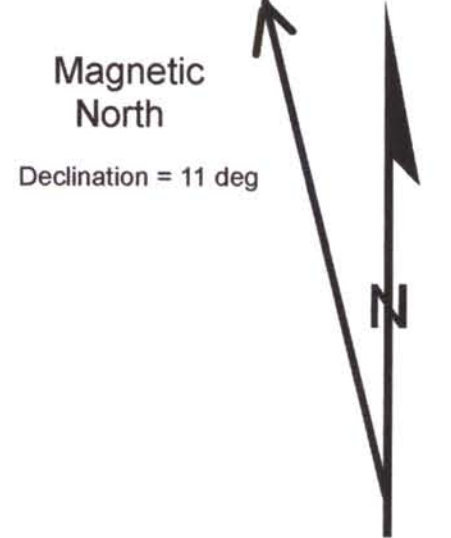
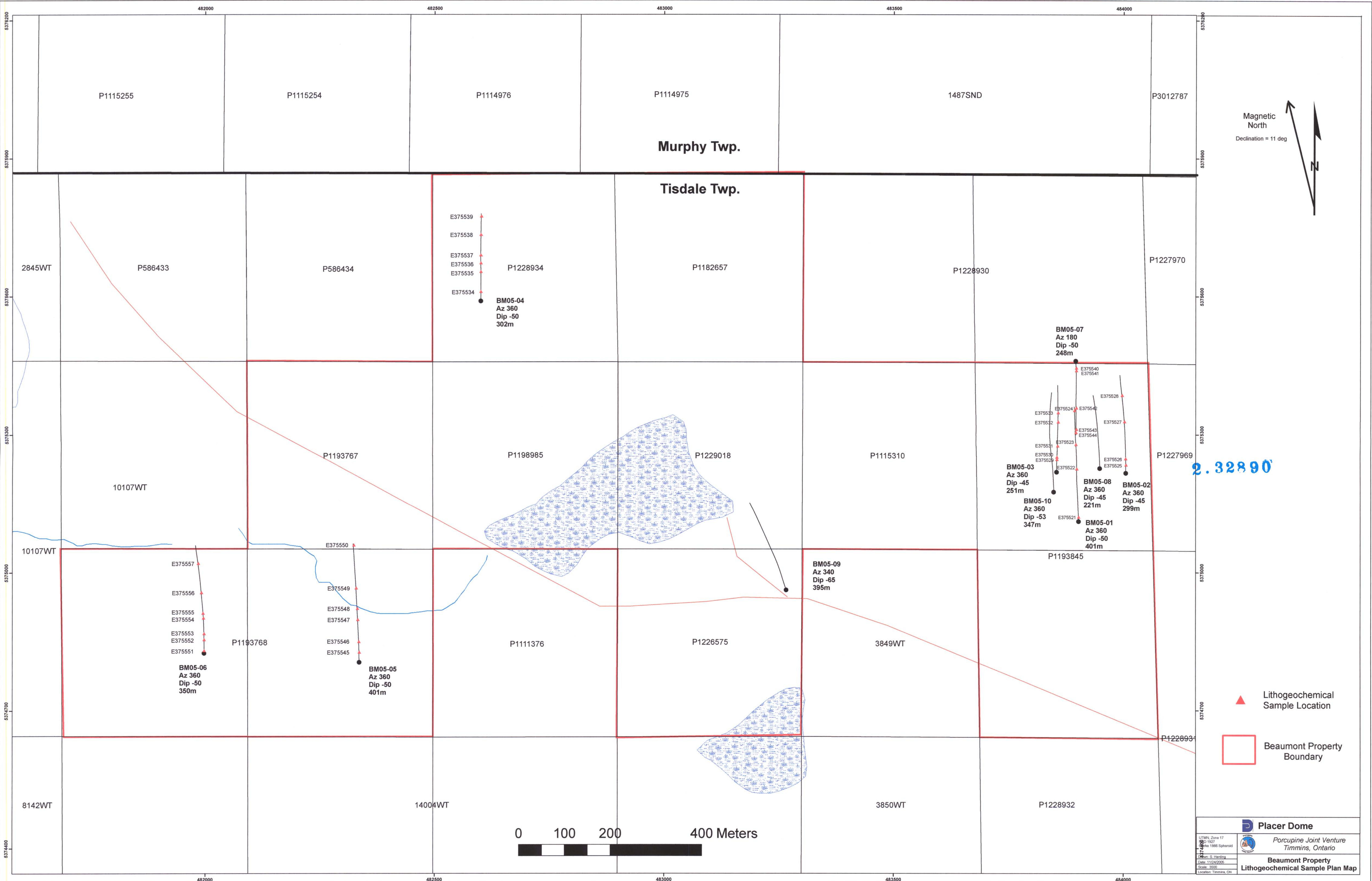

2.32890

- ▲ Lithochemical Sample Location
- Beaumont Property Boundary



Placer Dome	
UTM, Zone 17 Datum: 1986 Spheroid Zone: 17 Drawn: S. Harding Date: 11/26/2008 Scale: 3500 Location: Timmins, ON	Porcupine Joint Venture Timmins, Ontario Beaumont Property Lithochemical Sample Plan Map