

2 • 35 1 12

*Sampling Program on Mining Claim L - 1226091, located in Kimberly Township,
Larder Lake Mining Division.*

<u>Contents</u>	<u>Page</u>
Claim Map	1
Access & location	2
Geology and Previous work	2
Work performed	3
Results & Conclusions	3
Location Map of the Work Performed	6
Sample Location Map	7
Assay Certificate	8
Statement of Costs	9





4201442

4201443

3005936

3005947

3005894

1241565

Agg. Permit Cat. 11

1206317

AP 77837
1226091

1206318

AP #119149

03005894

3005999

3006024

4208490

4208489

3005984

Location & Access

Mining Claim L - 1226091 is located approximately 50 km south west of the town of Kirkland Lake and 25 km northwest of the village of Elk Lake in the central part of Kimberly Township. The property is accessed by a well maintained gravel road and is located approximately 7 km west of Highway 65.

Geology & Previous Work

Kimberly Township is underlain by foliated to massive granodioritic to tonalitic felsic plutonic rocks which represent the western limits of the composite Round Lake batholith. The type of deposit on mining claim L - 1226091 is a quartz vein which extends across the single unit claim in a northeastern - southwestern direction with a strike length of 400 metres. In places the quartz vein is up to 10 metres wide and is well exposed in several locations. The quartz vein has a general strike of 060 degrees and dips 70 degrees southeast. Thin veinlets, veins and stockworks of quartz extend into the granitoid and tend to parallel the main vein. Disseminated iron staining (hematization) is located along the grain boundaries and on fracture surfaces. In most places the quartz vein is milky white in colour and runs up to 99.60 % in silica. The vein dimensions are approximately 400 + m x 10 + m x ?.

Little or no work was reported until August of 2000. Power stripping was done and a bulk sample was blasted and left on site.

Work Performed

On May 10th 2007 Mr. Joe Rosko , Russ Williams and myself visited the property to locate any mineralization along the blast area of 2000. The object of this sample program was to obtain gold values in the quartz to enhance it's flux properties. If gold could be recovered even in small amounts it would help offset the costs of shipping to a smelter. The area that was sampled was along the south edge of the vein which is still in place. The mottled orangey - coloured sections with finely disseminated iron staining (hematization) were the areas of interest and sampling. A total of six areas along the vein were sampled. The results are as follows:

<u>Sample #</u>	<u>Description</u>	<u>Sample width</u>	<u>Au, g/tonne</u>
243815	rusty quartz	1 metre	0.02
243816	rusty quartz	1 metre	Nil
243817	rusty quartz	1 metre	Nil
243818	rusty quartz	1 metre	Nil
243819	rusty quartz	1 metre	Nil
243820	rusty quartz	1 metre	Nil

Results & Conclusions

Although the assay results were very poor, the silica deposit is still a very viable product. More work such as power stripping and power washing should be done to determine the true width of the vein for tonnage calculations. This deposit can easily quarried due to high exposers east of the original blast site.

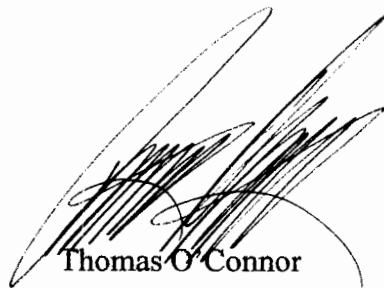

Thomas O'Connor

Sample locations for CIM # 1226091 2007

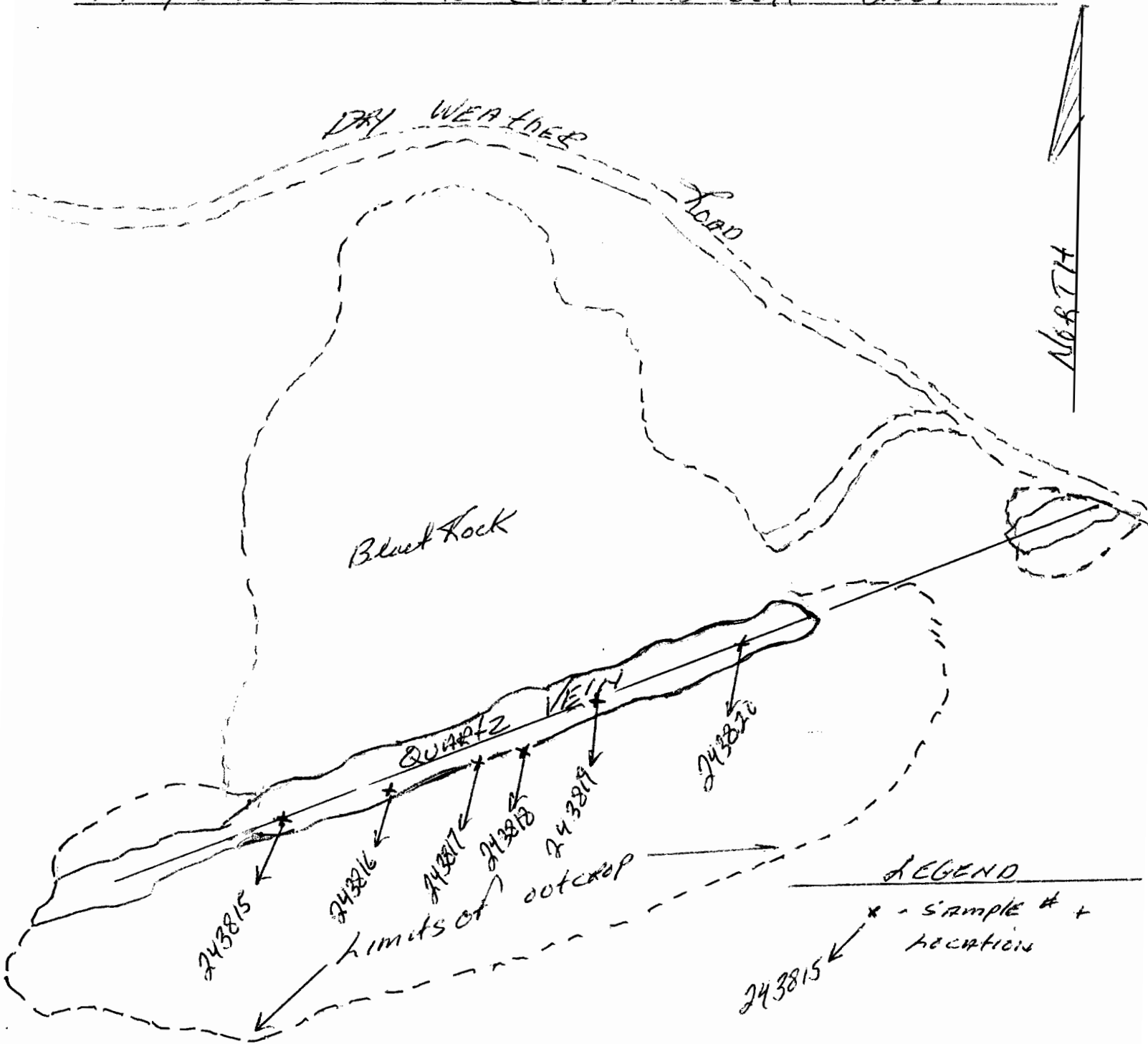

0 5 10 15 20 25 30 35 40 45 METRES

SCALE: 1cm = 5 metres



Established 1928

Swastika Laboratories Ltd

Assaying - Consulting - Representation

Assay Certificate

7W-1864-RA1

Company: **KIRKLAND ROCKS**
 Project: Kimberly Quartz
 Attn: T. O'Connor

Date: MAY-18-07

We hereby certify the following Assay of 6 Chip samples
 submitted MAY-15-07 by .

Sample Number	Au g/tonne	Au Check g/tonne
243815	0.02	-
243816	Nil	Nil
243817	Nil	-
243818	Nil	-
243819	Nil	Nil
243820	Nil	-

Certified by 

Statement of Costs for Sampling Program on Mining Claim L - 1226091, located in Kimberly Township, Larder Lake Mining Division in the District of Timiskaming

<u>Date</u>	<u>Description</u>	<u>Cost</u>
May 10/07	Travel from Kirkland lake to L - 1226091 75km @ \$ 0.45/km	33.75
	Mr Joe Rosko @ \$ 250.00/day Kirkland Lake Rock LTD	250.00
	Mr. Russ Williams @ \$ 250.00/day Kirkland Lake Rocks LTD	250.00
	Mr. Thomas O'Connor @ \$ 250.00/day Travel, Return to Kirkland Lake from Mining claim L- 1226091. 75 km @ \$ 0.45/km	250.00 33.75
May 15/07	6 Assays (gold)	73.14
June 02/07	Report, T. O' Connor, 2 Days @ \$ 250.00/day	<u>500.00</u>
	Total amount claimed	\$ 1390.64

Thomas O'Connor