

2 . 36424

**REPORT ON THE
2007 SUMMER PROSPECTING PROGRAM
NAIRN SOUTH PROPERTY
TRELAWNEY RESOURCES INC.**

SUDBURY MINING DIVISION, ONTARIO

GEORGE GIGA, B.Sc.

NOVEMBER 12, 2007



TABLE OF CONTENTS

Introduction	1
Property Location and Access	1
Claim Information	1
Regional Geology	4
Property Geology	4
History of Previous Work	4
2007 Prospecting Program	5
Conclusions and Recommendations	6
References	7
Certificate of Qualification	8

LIST OF FIGURES

- Figure 1: Property Location Map
- Figure 2: Claim Location Map
- Figure 3: Geology Sketch Map

LIST OF APPENDICES

- Appendix A: List of Samples and Assay Results

INTRODUCTION

This report evaluates the data gathered during a four day prospecting program performed during the period of July 8 to July 30, 2007 on Trelawney Resources Inc.'s Nairn South property. The aim of the program is to locate two known mineralized Cu, Ni showings, and determine whether the property warrants any further exploration.

The field work was undertaken by geologist George Giga of Montreal, Quebec with the assistance of Jean Robert of Foleyet, Ontario.

PROPERTY LOCATION AND ACCESS

The Nairn South property is located within the lower half portion of the Nairn Township area NTS 041I05, approximately 55 km west of Sudbury, Ontario (*Figure 1*).

The property is located in the Sudbury Mining Division, and shown on the Nairn Township Map Sheet (G-2976). The eight claim units are found in the following lot: South half of Lots 8 and 9, Concession 2.

The property is road accessible 2 km south of Highway 17. There exists a logging road that allows for easy access to a portion of the property.

CLAIM INFORMATION

The Nairn South property (*Figure 2*), consists of the following claim:

- TownshipArea: Nairn
- Claim Number: 4207271
- Recording Date: 2005-Nov-18
- Claim Due Date: 2007-Nov-18
- Work Required: \$ 3,200
- Recorded Holder: Patrie, Daniel F.

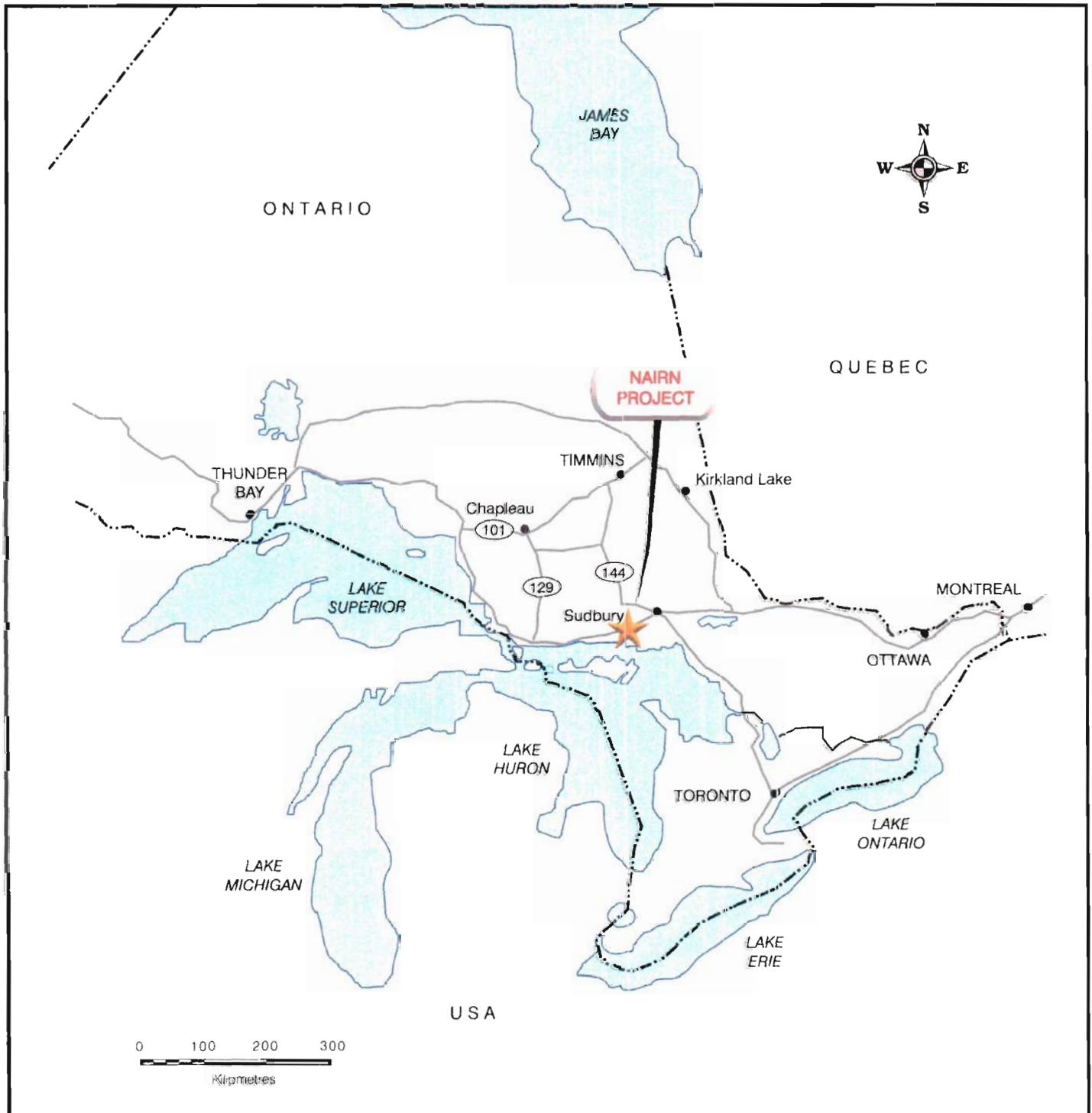

Nairn South Property, Ontario

FIGURE 1:

**NAIRN PROJECT
LOCATION MAP**

NOV 2007

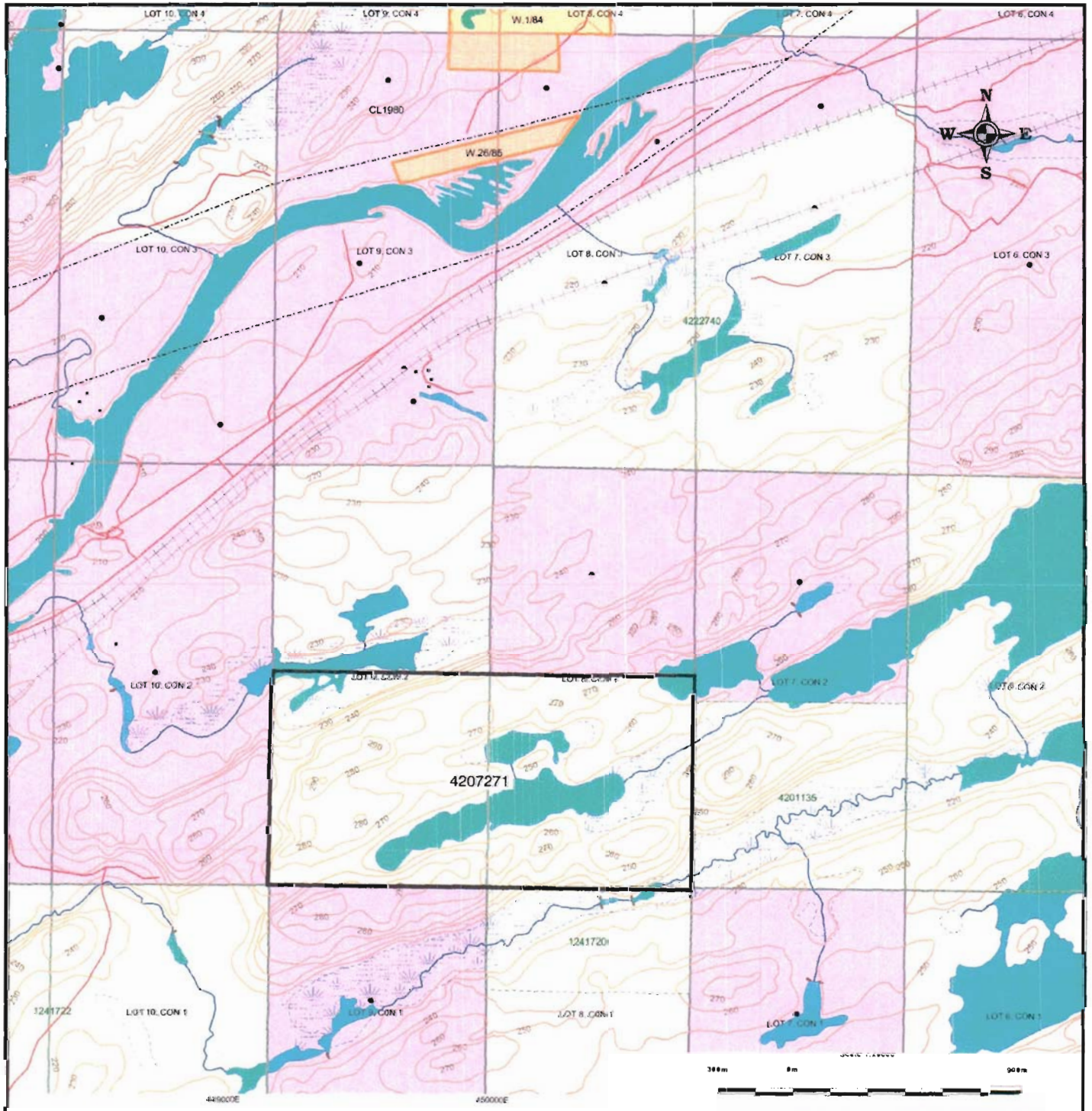

Nairn South Property, Ontario

FIGURE 2:

Nairn Project
CLAIM MAP

NOV 2007

REGIONAL GEOLOGY

The regional geology is of Precambrian age. The rocks are overlain unconformably by unconsolidated sediments of Pleistocene to Recent age. The Precambrian rock consists of basic to intermediate metavolcanics with minor metasediments (oldest), followed by intrusive granitic rocks. The main group of metasedimentary rocks of Huronian age lies unconformably on, or in fault contact with, the two older groups. Nipissing gabbroic rocks, intrude all above mentioned groups, and are in turn intruded by diabase dikes (youngest) (Card, K.D., 1965).

PROPERTY GEOLOGY

Based upon the 2007 mapping program, the Nairn South property appears entirely underlain with Nipissing gabbro, with the narrow lens like occurrence of quartzite northwest of Tenho Lake. This observation appears to concur with the geology map from the Nairn and Lorne Townships (Ginn, R.M., 1965).

HISTORY OF PREVIOUS WORK

There is evidence that work was performed on the property in the past, seen by a number of surface trenches and several drill holes (McCannell, J.D., 1974).

In 1955, Mogul Mining Corporation carried out an airborne magnetometer, ground EM and magnetometer surveys. Mogul Mining Corporation carried out their diamond drilling entirely to the area of the copper-nickel showing in the north part of Lot 9 Concession I.

In 1956, the Pays Bas Prospecting Syndicate performed surface geological examinations and some geophysics, while discovering a Cu, Ni showing on the east end of Tenho Lake.

In 1968, three short holes were drilled in the vicinity of the Cu, Ni showing of Tenho Lake. Records reveal that three holes were drilled by D. Rastall. No significant assay values were recorded from the 1968 drill program.

2007 PROSPECTING PROGRAM

A mapping and prospecting program was performed on the Nairn South property from July 8 to July 30, 2007 by a two man crew, consisting of one geologist and one assistant. Given the limited time frame, the aim of the field work was to map and sample the entire property, locate two known Cu, Ni showings and determine potential areas of interest for further exploration. Rock sample locations and geological contacts were tied into the topography and plotted on the accompanying map at a scale of 1:5000 (*Figure 3*).

Mineralization found in the Nipissing gabbro consists of chalcopyrite, pyrrhotite, and pyrite. In general, the sulphides appear disseminated, but occasionally seen as massive. Samples taken near the vicinity of one of the showings, reveal assay values of the following:

Sample Number: 85251

- Au 0.37g/tonne, Cu 0.456%, Ni 0.193%, Pt 0.72g/tonne, Pd 1.21g/tonne

Sample Number: 85252

- Au 0.1g/tonne, Cu 0.491%, Ni 0.321%, Pt 0.19g/tonne, Pd 0.06g/tonne

CONCLUSIONS AND RECOMMENDATIONS

2007 assay values (*Appendix A*), proximal to the Cu, Ni showing of Pays-Bas Prospecting Syndicate, concession 2, lot 8, suggests that Trelawney Resources Inc.'s Nairn South property possesses potential for further exploration. Further prospecting and sampling is warranted. Based on results of further field work, subsequent geophysical work should be considered to determine potential drill targets.

Respectfully submitted

A handwritten signature in black ink, appearing to read 'G. Giga' with a stylized flourish at the end.

George Giga, B.Sc.

November 12, 2007

REFERENCES

Card, K.D. 1965. Geology of Hyman and Drury Townships. Ontario Department of Mines, Geological Report No. 34. 38 pp.

Ginn, R.M. 1965. Geology of Nairn and Lorne Townships. Ontario Department of Mines, Geological Report No. 35. 46 pp.

McCannell, J.D. 1974. Golden Sabre Mines Ltd. Nairn Township Report. 10 pp.

Rastall, D. 1968. 1968 Drilling Report performed on Claim No. S 13765, Report No. 13

CERTIFICATE OF QUALIFICATION

I, George Giga do hereby certify:

1. That I am a geologist residing at 6954 Molson Street, Montreal, Quebec, H2A 3K1,
2. That I graduated from Concordia University, with a B.Sc. (Specialization in Geology),
3. That I have practised my profession since 1986,
4. That I visited the Nairn South property during the period of July 8, 2007 to July 30, 2007,
5. That as of the date of this certificate, I am not aware of any material fact or material change with regards to the property that would make my report misleading,
6. That my report on the Nairn South property is based on my general knowledge of the geology of the area, my property visits and a review of published and unpublished information on the property area,
7. That I own no direct or indirect interest in Trelawney Resources Inc., the Nairn South property or any adjacent properties and I do not expect to acquire any and,
8. I have written this report as a totally independent geologist.

DATED AT Kingston, this 12th day of November 2007

A handwritten signature in black ink, appearing to read 'G. Giga', written in a cursive style.

George Giga, B.Sc.

APPENDIX A

List of Samples and Assay Results



Established 1928

Swastika Laboratories Ltd

Assaying - Consulting - Representation

Page 2 of 2

Assay Certificate

7W-2532-RA1

Company: **DUESS GEOLOGICAL SERVICES**
Project: N-07
Attn: R. Duesss

Date: AUG-15-07

We hereby certify the following Assay of 36 Core samples submitted JUL-23-07 by .

Sample Number	Au g/tonne	Au Check g/tonne	Cu %	Ni %	Pt g/tonne	Pd g/tonne
4085	Nil	-	0.052	0.018	<0.005	<0.005
4086	0.01	-	0.039	0.023	<0.005	<0.005
85251	0.37	0.49	0.456	0.193	0.72	1.21
85252	0.10	-	0.491	0.321	0.19	0.06
85253	0.12	-	0.215	0.58	0.03	0.07
85254	0.09	0.08	0.70	0.56	0.15	0.78
Blank	Nil	-	-	-	-	-
STD OxJ47	3.55	-	-	-	-	-

Note: Insufficient sample on numbers 4073,4074, for Cu,Ni

Certified by 