



RAWLUK LAKE PROPERTY
WORK ASSESSMENT REPORT

Proprietor: Gilles Gionet
Technical report by: Michael Gionet
Work done: Summer 2007
Cecil Township, Thunder Bay District
Work Assessment report completed: November 18, 2007

2 • 36482

Gilles Gionet
Claim number: 1022625, Cecil Township, G-2857
November 18, 2007

Thunder Bay District

Summary

Please find enclosed the work assessment report done on the physical work to Rawluk Lake property September 10th, 2007 until October 20th, 2007. There was no beep-matting done on this property this year.

The reason we developed these trenches this fall was to ascertain whether or not there was viable mineralization under the overburden. Interesting outcrops containing garnets are found on this property. This property was not shown this year, due to the lateness of the work done. However we anticipate showing this property to potential investors in the spring of next year. The pits uncovered 1 to 1 ½ inch bands or stringers of copper that moved in the same direction as volcanic/ feldspar and quartz veins.

Unfortunately, we have not received any assay results on this property yet. We are told by the MNM office in Thunder Bay that assay results can take up to four months.

All of the work done on this property was done by owner Gilles Gionet and two associates, namely Sam Gionet and Emmanuel Martel, also of the Manitowadge area. Due to the lack of employment opportunities in our area since the closure of the Hemlo group mines, we are really hoping to find a viable deposit in our area. Herein lies the reason for our continues efforts in this area.

We hope that you find this work assessment report to your standard and that you enjoy the many photos dispersed throughout.

Thank you,

Mike Gionet

Work assessment report completed

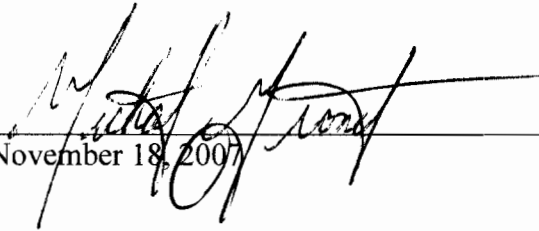
by:  Michael Gionet
On November 18, 2007

Gilles Gionet
Claim number: 1022625, Cecil Township, G-2857
November 18, 2007

Thunder Bay District

Physical Work Submissions for Assessment Credit

Work done includes manual and mechanical stripping, bedrock trenching, and pit digging. All of the work is comprised of three pits located on claim number#1022625. The location of this claim is north of our Fairies Lake property. It is approximately 17 km east of the town of Manitouwadge, accessible by the camp 70 industrial road, then the industrial Twist road. An area map as well as an access map can be found in Appendix A of this report. The purpose this physical work was done was in order to ascertain the type of mineralization found below the surface, in order to option this property. A topographical map also found in the Appendix A of this report. No re-cutting of boundary lines was done. No assays are done for this property at this time.

A pit map, with accompanies each pit diagram maps out the location of the new pits, Rawluk lake and claim boundary lines. Each pit diagram is a detailed plan of each pit showing the dimensions of the pits, the nature of the observed rock and mineralization.

All the work is done by Gilles Gionet, Sam Gionet and Emmanuel Martel during September and October 2007. Each man's work coming in at \$200.00 per day and travel being claimed at \$0.40/km x 34 kilometres (for return trip). They have traveled together.

The following is the daily log of each pit, followed by its pit diagram and pit location map. We hope you enjoy the many photographs taken of the mineralization of the area as well as the pits.

The daily log of the work done follows.

September 10, 2007----Pit 1----8am-3pm

Gilles Gionet strips and trenched with backhoe while Sam and Emmanuel trench manually. There is much overburden consisting of brush, dark topsoil and tree roots. Overburden is at least 4 feet deep in certain areas.

September 11, 2007----Pit 1----8am-4pm

Gilles and Sam Gionet and Emmanuel Martel continue to remove overburden, which consists mostly of black earth, tree roots and some floater rocks. Gilles operates the backhoe, whereas the other two men take turns with the physical trenching and waste removal. The pit is now about 2 metres deep and about 10 metres long.

September 12, 2007-Pit 1-8am-3:30pm

Gilles and Sam Gionet and Emmanuel Martel continue to remove overburden, which consists mostly of black earth, tree roots and some floater rocks. Gilles operates the backhoe, whereas the other two men take turns with the physical trenching and waste removal. The mineralization seems to be present in bands, more trenching needs to be done to ascertain this. The mineralization is rusty and contains quartz.

Gilles Gionet
Claim number: 1022625, Cecil Township, G-2857
November 18, 2007

Thunder Bay District

September 13, 2007-PIT 1-8am-4pm

Gilles operates backhoe in order to continue the trench. Sam and Emmanuel remove waste and do a little washing in order to see if the mineralization bands continue and are clear-cut. Some quartz in veins present. The pit is now approximately 15 metres long by 4 metres wide.

September 14, 2007-PIT1-8am-4:30pm

Gilles continues to trench lengthwise with the backhoe. Sam and Emmanuel continue to manually remove waste. Pit is about 16 metres long and 10 metres wide, and about 2.5 metres deep. Mineralization consists of heavy mafic "ore", with visible copper, feldspar, and quartz. Please refer to photo below.



Gilles Gionet
Claim number: 1022625, Cecil Township, G-2857
November 18, 2007

Thunder Bay District

September 17, 2007----PIT 1- 7am-3pm

Trenching continues and removal of overburden with backhoe and Gilles operating. Overburden still consists of black topsoil and tree roots. Heavy mineralization uncovered, still mafic rock. The rock is heavy, dense, rusty, contains visible copper, quartz, feldspar. The pit is now 20 metres long by 10 metres wide.

September 18, 2007-----PIT 1—8am-4pm

Trenching continues and removal of overburden with backhoe and Gilles operating. Overburden still consists of black topsoil and tree roots. Same mineralization present.

September 19, 2007----PIT 1-9am-5pm

Trenching and burden removal continues as above. Pit is now 30 metres long, 11 metres wide and approximately 1 metre deep with less overburden. Same heavy minerals present.

September 20, 2007---PIT 1—8am-4pm

Gilles continues operating the backhoe, while Sam and Emmanuel trench manually. There is visible copper. The mineralization is brittle in sections. Pit is now 37 metres long by 13 metres wide.

September 21, 2007---PIT 1-7am-4pm

Gilles continues operating the backhoe, while Sam and Emmanuel trench manually. Pit is now 41 metres long by 15 metres wide. Mineralization continues in bands. Please refer to photos below.



Gilles Gionet
Claim number: 1022625, Cecil Township, G-2857
November 18, 2007

Thunder Bay District

September 22, 2007----PIT 1—7:30am-5pm
Gilles trenches with backhoe and Sam and Emmanuel trench manually. Pit is now 50 metres long by 15 metres wide. Mineralization is the same. The bands move in a north south direction.

September 24, 2007-----Pit 1----8am-4pm
Gilles trenches with backhoe, Sam and Emmanuel trench manually. Pit is now 54 metres long by 15 metres wide. Mineralization is the same.

September 25, 2007----Pit 1-----7am-3pm
Gilles trenches with backhoe, Sam and Emmanuel trench manually. Pit is now completed at 60 metres long and approximately 15 metres wide. Mineralization consists of rusty bands of feldspar/volcanic rock with visible copper, quartz and pyrite. Copper veins being about 1 inch wide and continuing in lengths of about 7 feet. Sam washes pit.

Please refer to following pit location map and pit diagram for further details.



Gilles Gionet
Claim number: 1022625, Cecil Township, G-2857
November 18, 2007

Thunder Bay District

PIT 1 DIAGRAM

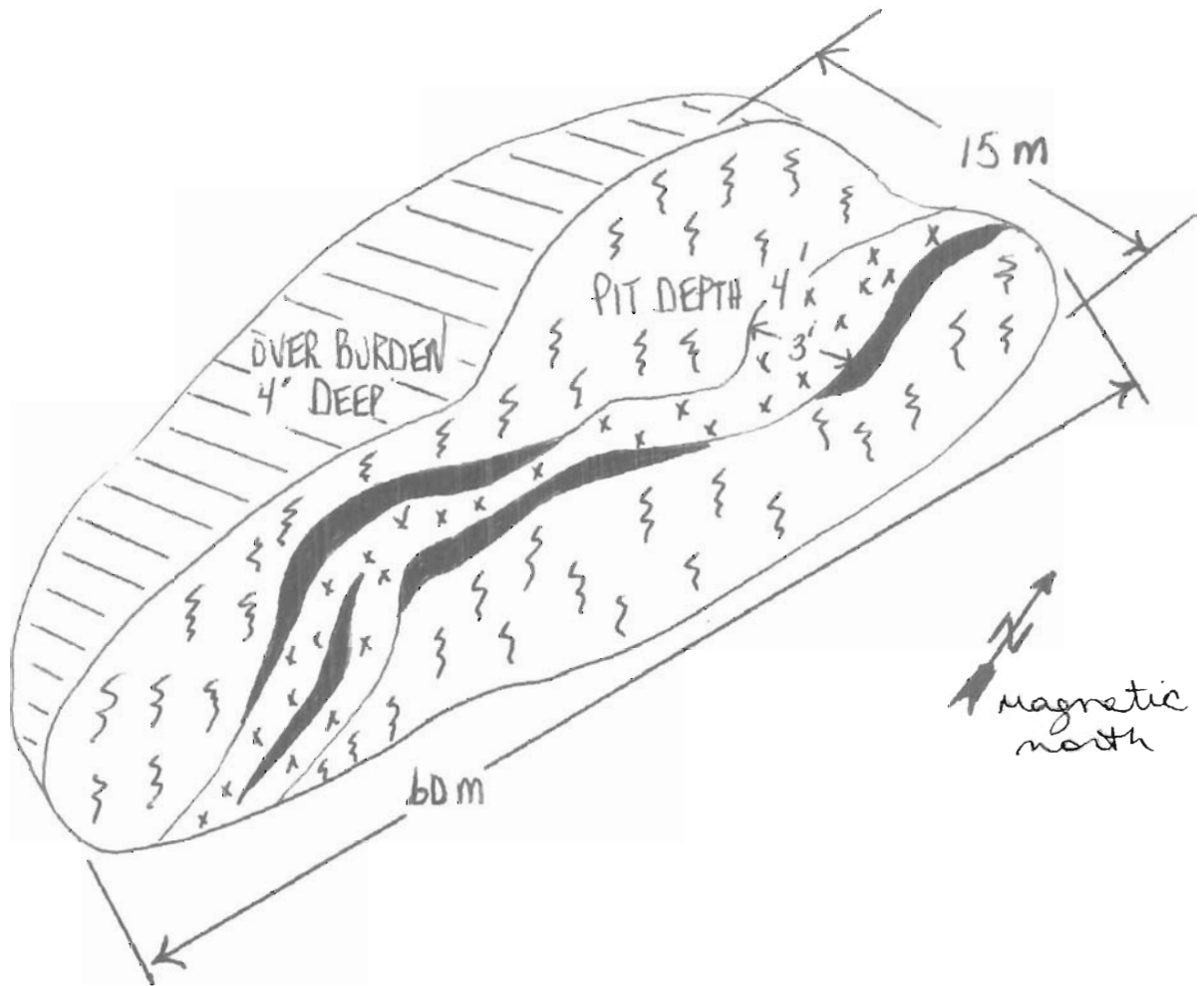

 - MAFIC VOLCANIC

 - QUARTZ VEIN

 - BANDED COPPER + PYRITE 1/2" TO 1" WIDE

Gilles Gionet
Claim number: 1022625, Cecil Township, G-2857
November 18, 2007

Thunder Bay District

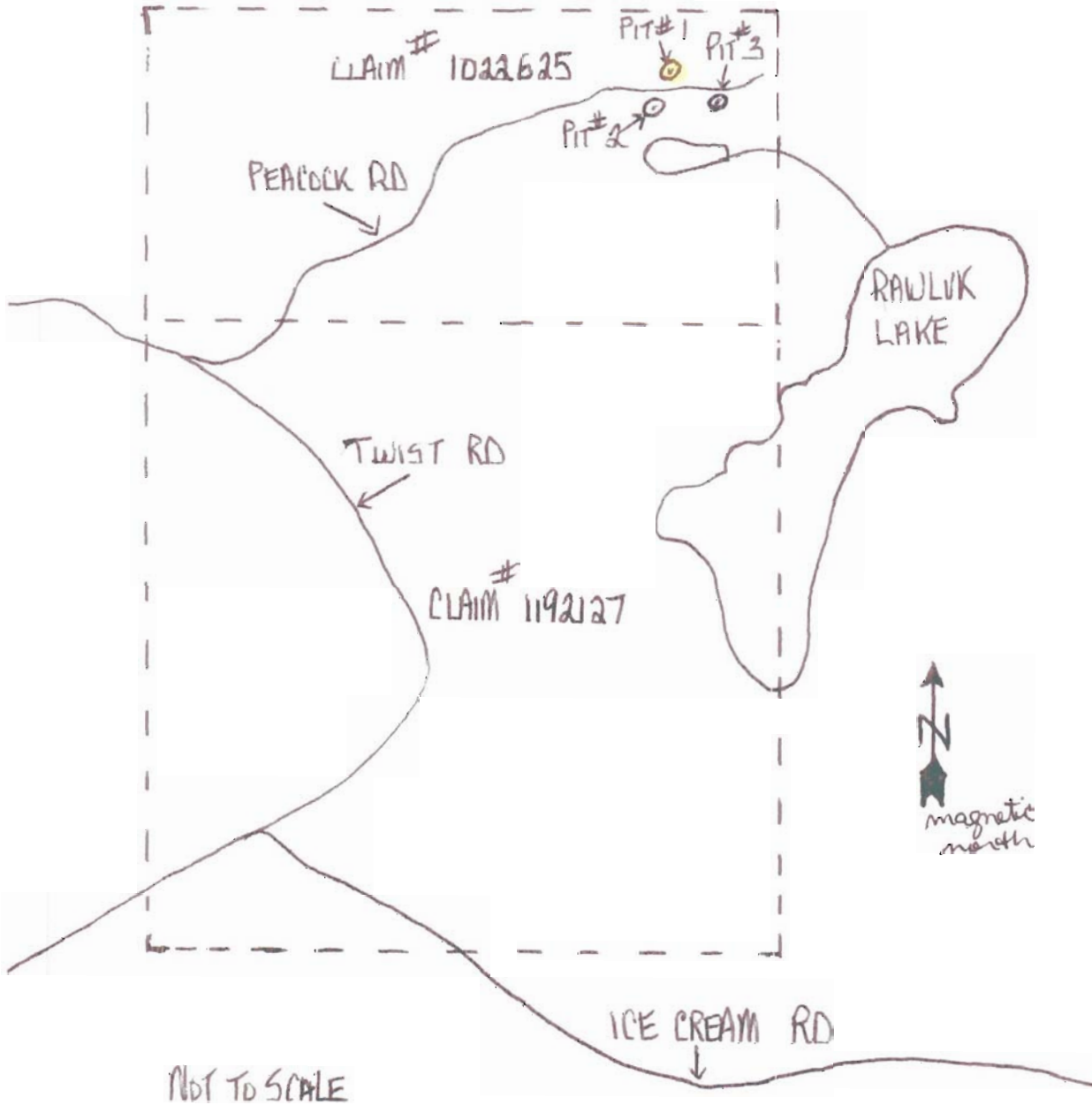

Gilles Gionet
Claim number: 1022625, Cecil Township, G-2857
November 18, 2007

Thunder Bay District

September 26, 2007----PIT 2---7am-4pm

Trenching of Pit 2 begins, Gilles operates the backhoe and Sam and Emmanuel trench manually. The overburden consists of black top soil and brush. The same mineralization from pit 1 seems to be present with quartz and feldspar/volcanic ore visible.

September 27, 2007---PIT 2---8am-4pm

Gilles trenches with backhoe, removing overburden which consists of moss, back topsoil, trees, and tree roots. Sam and Emmanuel are also working with axes and shovels to remove overburden. Some copper seen at the surface, see photo below. This pit is dug to ascertain whether this mineralization continues and in which direction.

September 28, 2007---PIT 2-7am-3pm

Gilles continues to trench and dig with backhoe while Sam and Emmanuel continue trenching manually. Pit is now 10 metres long by 3 metres wide. Mineralization consists of feldspar/volcanic ore, a wide quartz vein and visible copper strings.

September 29, 2007----Pit 2---8am-4pm

Gilles continues to trench with backhoe while Sam and Emmanuel continue to clear debris. Trench is now 15 metres long by 3 metres wide. Mineralization same as above.

October 1, 2007----PIT 2---7am-5pm

Gilles continues to trench with backhoe while Sam and Emmanuel continue to clear debris. Trench is now 25 metres long by 3 metres wide. Mineralization same as above and moves in a north/south direction. Please refer to photos below.



Gilles Gionet
Claim number: 1022625, Cecil Township, G-2857
November 18, 2007

Thunder Bay District

October 2, 2007----PIT 2---8am-4pm

Gilles trenches with backhoe, pit is about 30 metres long by 6 metres wide. Mineralization continues. Sam and Emmanuel continue to trench manually.

October 3, 2007----PIT 2----8am-5pm

Gilles continues trenching with backhoe while Sam and Emmanuel continue to trench manually. Mineralization continues, pit is now about 35 metres long by 8 metres wide.

October 4, 2007----PIT 2---8am-5pm

Gilles, Sam and Emmanuel continue trenching, mineralization is the same.

October 5, 2007----PIT 2---7am-4pm

Same as above, pit is now 44 metres long by 14 metres wide by about 5 feet deep.

October 6, 2007----PIT 2---8am-5pm

Same as above, pit is now 47 metres long by 14 metres wide. Mineralization continues in a north/south direction. Quartz veing is 3 feet wide at this end of the pit.

October 9, 2007----Pit 2---9am-3pm

Pit is now completed. Trenching pit is completed at 50 metres long, 14 metres wide and 5 feet deep. Washing is done. Please refer to photos below, pit location map and pit diagram #2 for further details.



Gilles Gionet
Claim number: 1022625, Cecil Township, G-2857
November 18, 2007

Thunder Bay District

PIT Z DIAGRAM

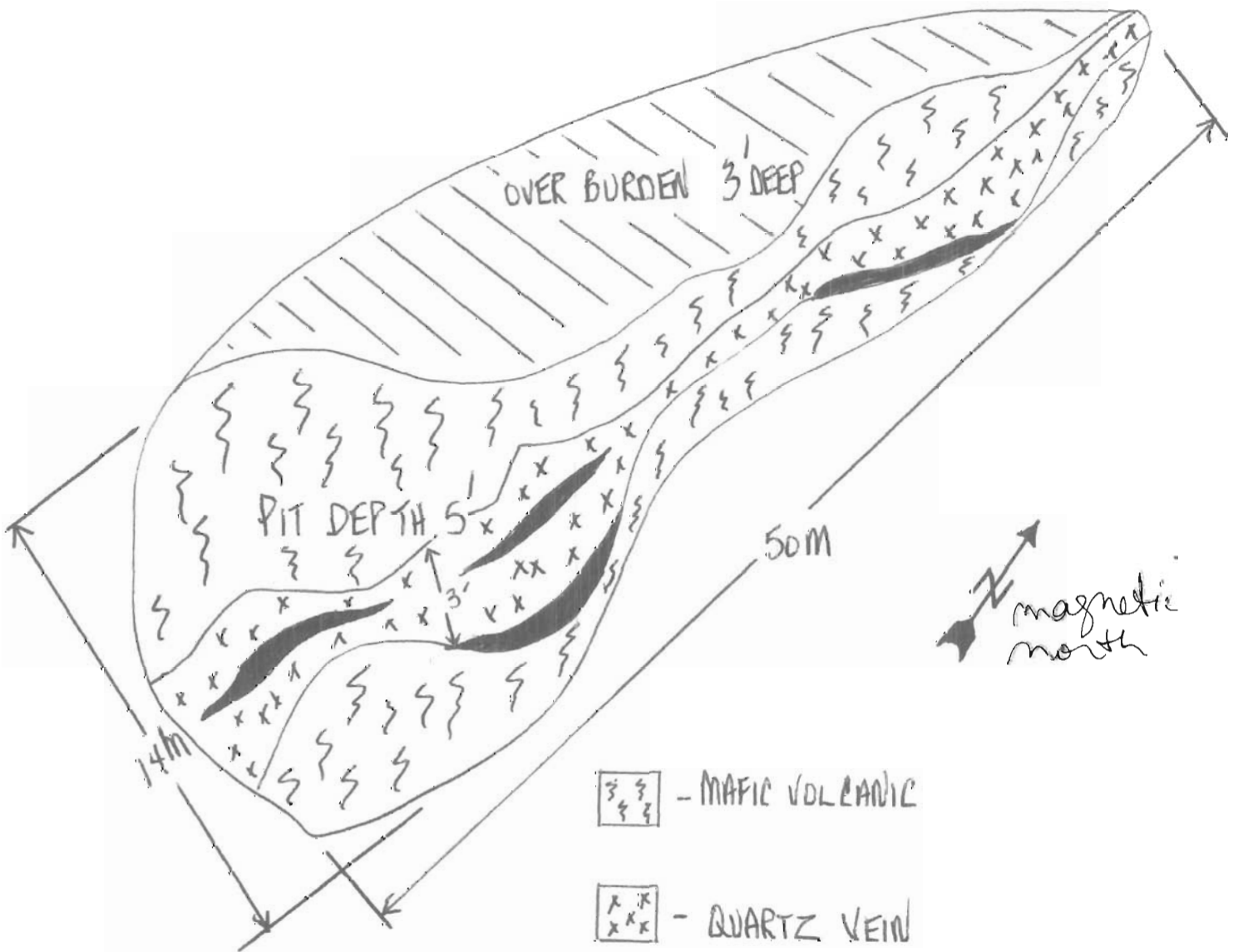

 - MAFIC VOLCANIC

 - QUARTZ VEIN

 - BANDDED COPPER + PYRITE 1/2" TO 1" WIDE

Gilles Gionet
Claim number: 1022625, Cecil Township, G-2857
November 18, 2007

Thunder Bay District

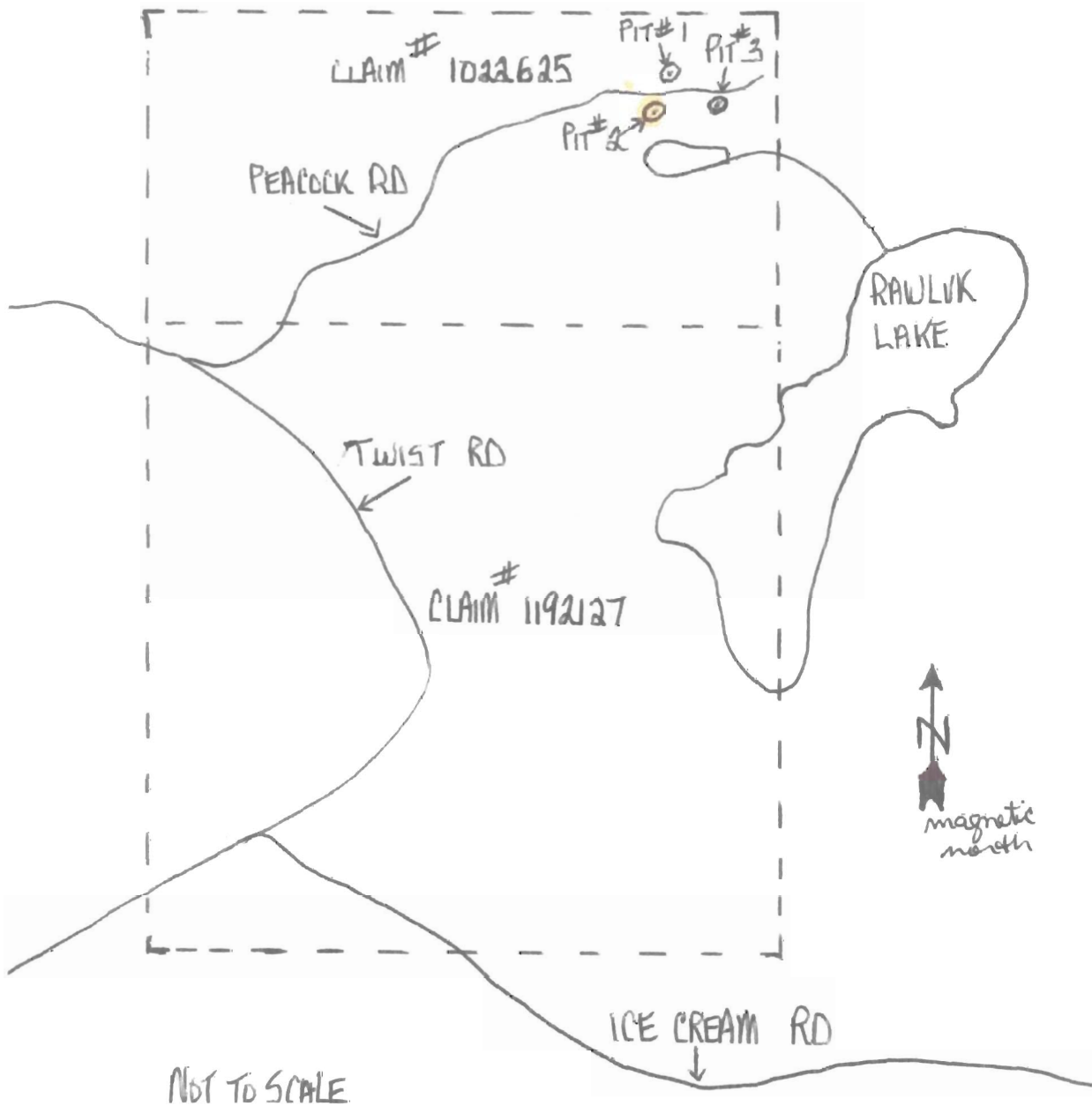

Gilles Gionet
Claim number: 1022625, Cecil Township, G-2857
November 18, 2007

Thunder Bay District

October 10, 2007---PIT 3---7am-4pm

Work on pit three starts. Gilles is on the backhoe, Sam and Emmanuel trench manually. Overburden consists of topsoil and brush.

October 11, 2007---PIT 3---8am-4pm

Gilles trenches with backhoe, Sam and Emmanuel keep removing overburden by hand, mineralization of copper/feldspar formation continues in north/south direction. Visible garnets in outcrops. See photo below.



October 12, 2007---PIT 3---7am-5pm

Gilles trenches with backhoe, Sam and Emmanuel trench manually. Overburden of black soil and tree roots not as deep as in other location, perhaps 3 feet. Mineralization of copper/volcanic formation is present here as well. Pit is now about 5 metres long by 6 metres wide. Mineralization appears to follow a north/east direction. Bands of feldspar/granite run parallel to the copper stringers.

October 13, 2007-----PIT 3---7am-4pm

Gilles trenches with backhoe, Sam and Emmanuel continue clearing debris. Copper/volcanic formation continues, pit is now 10 metres long by 6 metres wide.

October 15, 2007---PIT 3---8am-4pm

Same as above, pit is now 17 metres long by 7 metres wide.

October 16, 2007---Pit 3- 7am-5pm

Same as above, pit is now 23 metres long by 8 metres wide.

Gilles Gionet
Claim number: 1022625, Cecil Township, G-2857
November 18, 2007

Thunder Bay District

October 17, 2007---Pit 3---8am-5pm

Gilles trenches with backhoe, Sam and Emmanuel trench manually and clear out pit. Pit is now 27 pit long, 10 metres wide. Mineralization continues.

October 18, 2007---PIT 3---7am-5pm

Same as above. Pit is now 33 metres long by 10 metres wide.

October 19, 2007---PIT 3---8am-6pm

Same as above. Pit is now 39 meters long by 10 metres wide.

October 20, 2007---PIT 3-9am-4pm

Pit is now complete at 40 metres long, 10 metres wide and 5 feet deep. See photos below, pit diagram 3 and pit location map for further details.

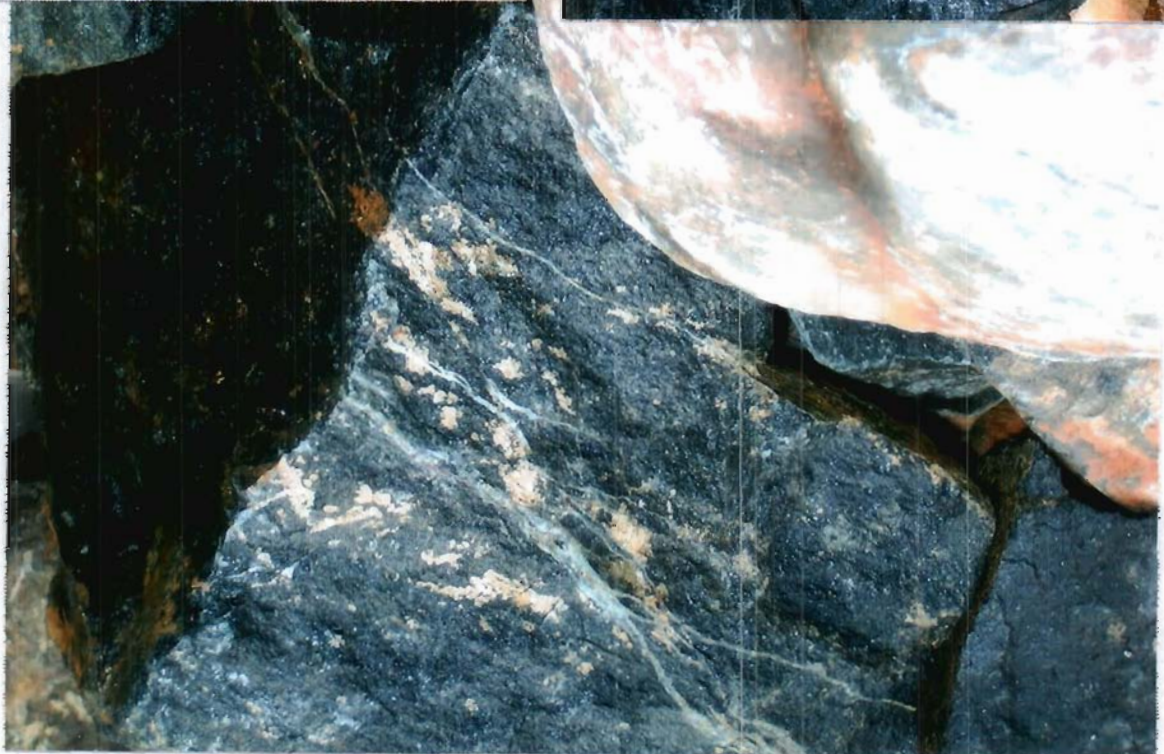

Gilles Gionet
Claim number: 1022625, Cecil Township, G-2857
November 18, 2007

Thunder Bay District

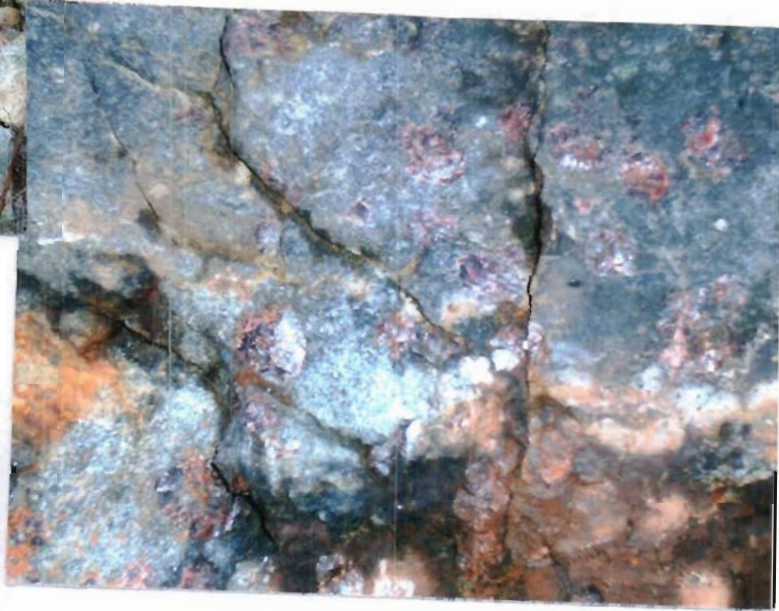

Gilles Gionet
Claim number: 1022625, Cecil Township, G-2857
November 18, 2007

Thunder Bay District

PIT 3 DIAGRAM

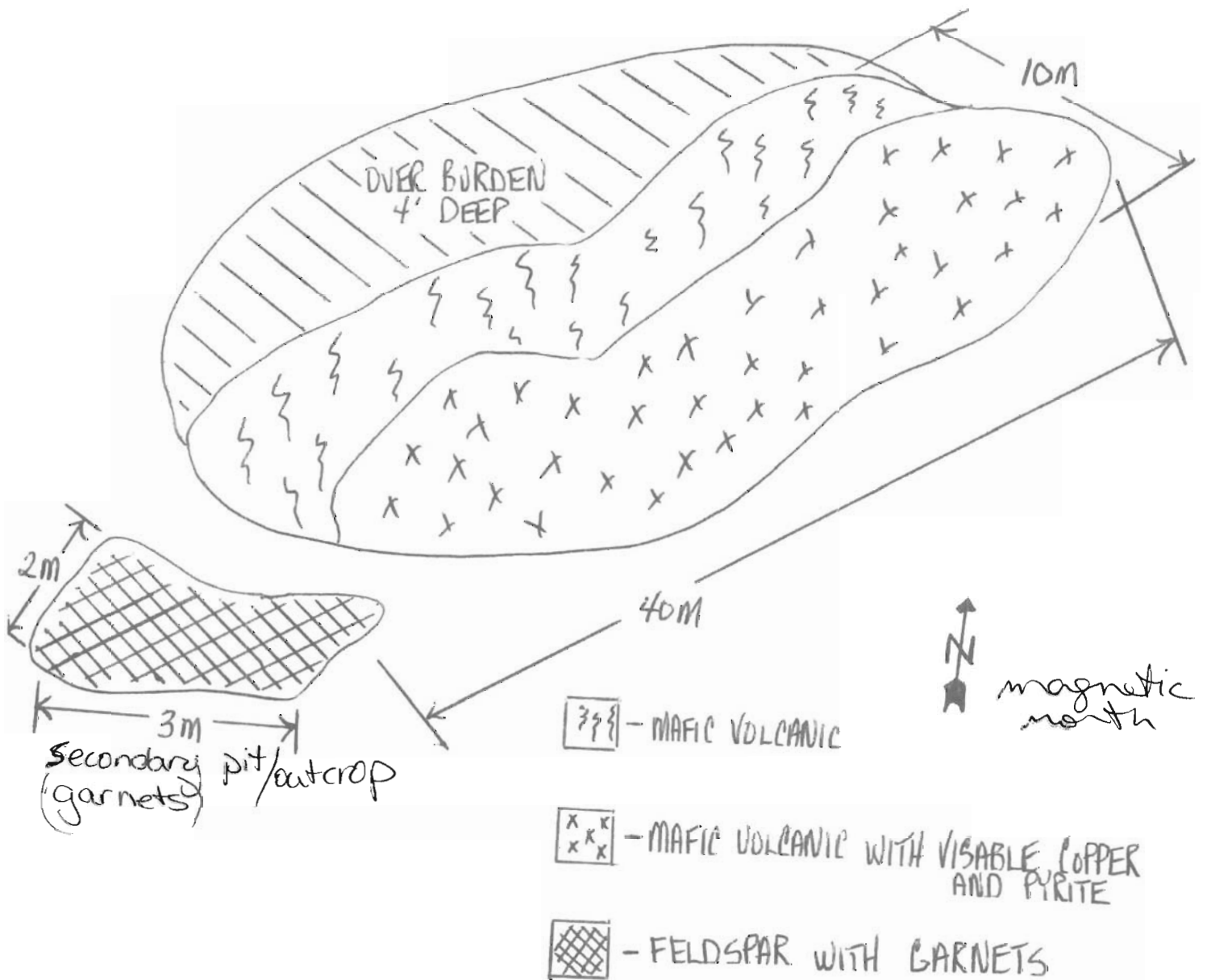

Gilles Gionet
Claim number: 1022625, Cecil Township, G-2857
November 18, 2007

Thunder Bay District

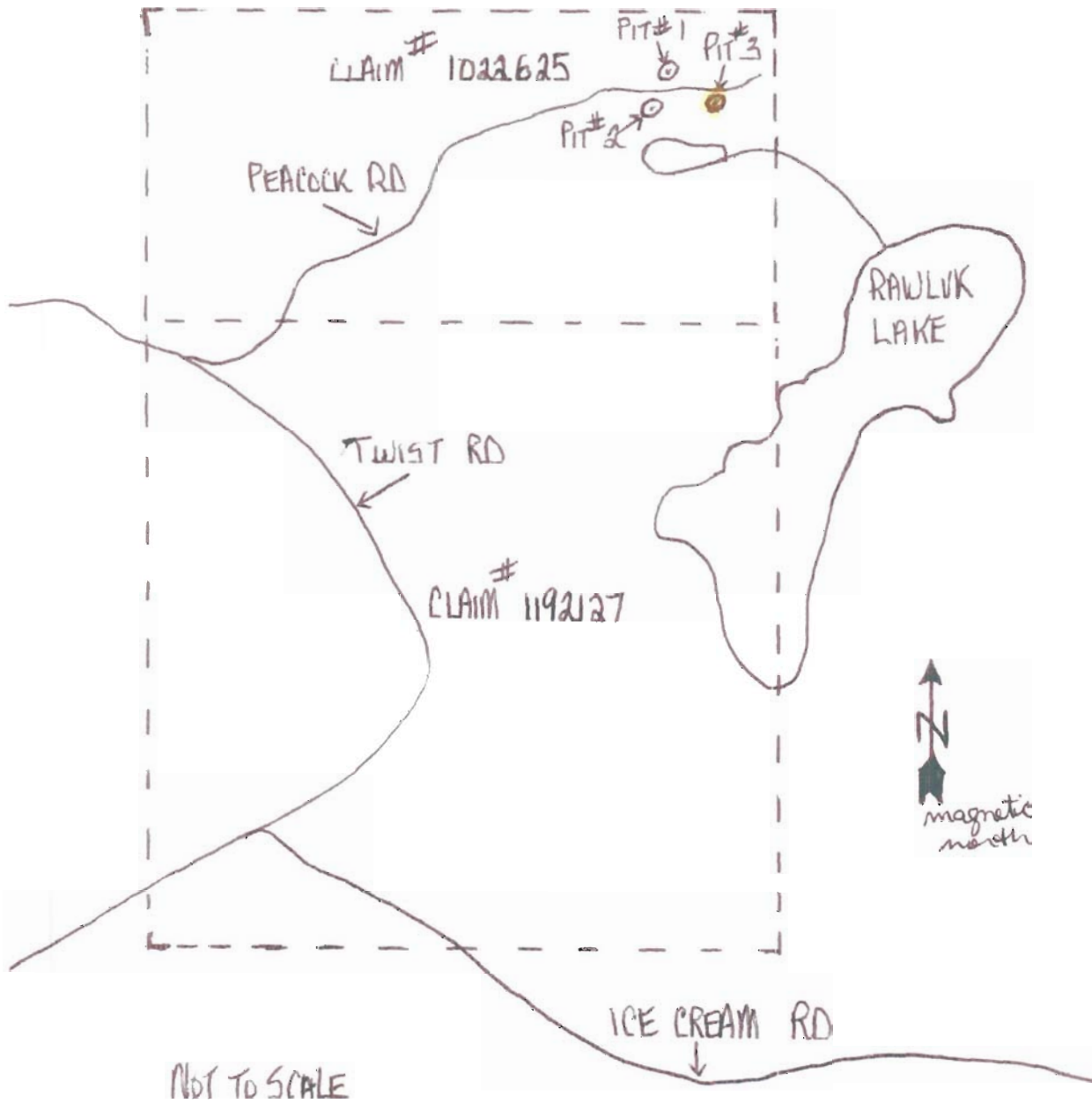

Gilles Gionet
Claim number: 1022625, Cecil Township, G-2857
November 18, 2007

Thunder Bay District

Appendix A

Maps

Gilles Gionet
Claim number: 1022625, Cecil Township, G-2857
November 18, 2007

Thunder Bay District

PIT LOCATION MAP

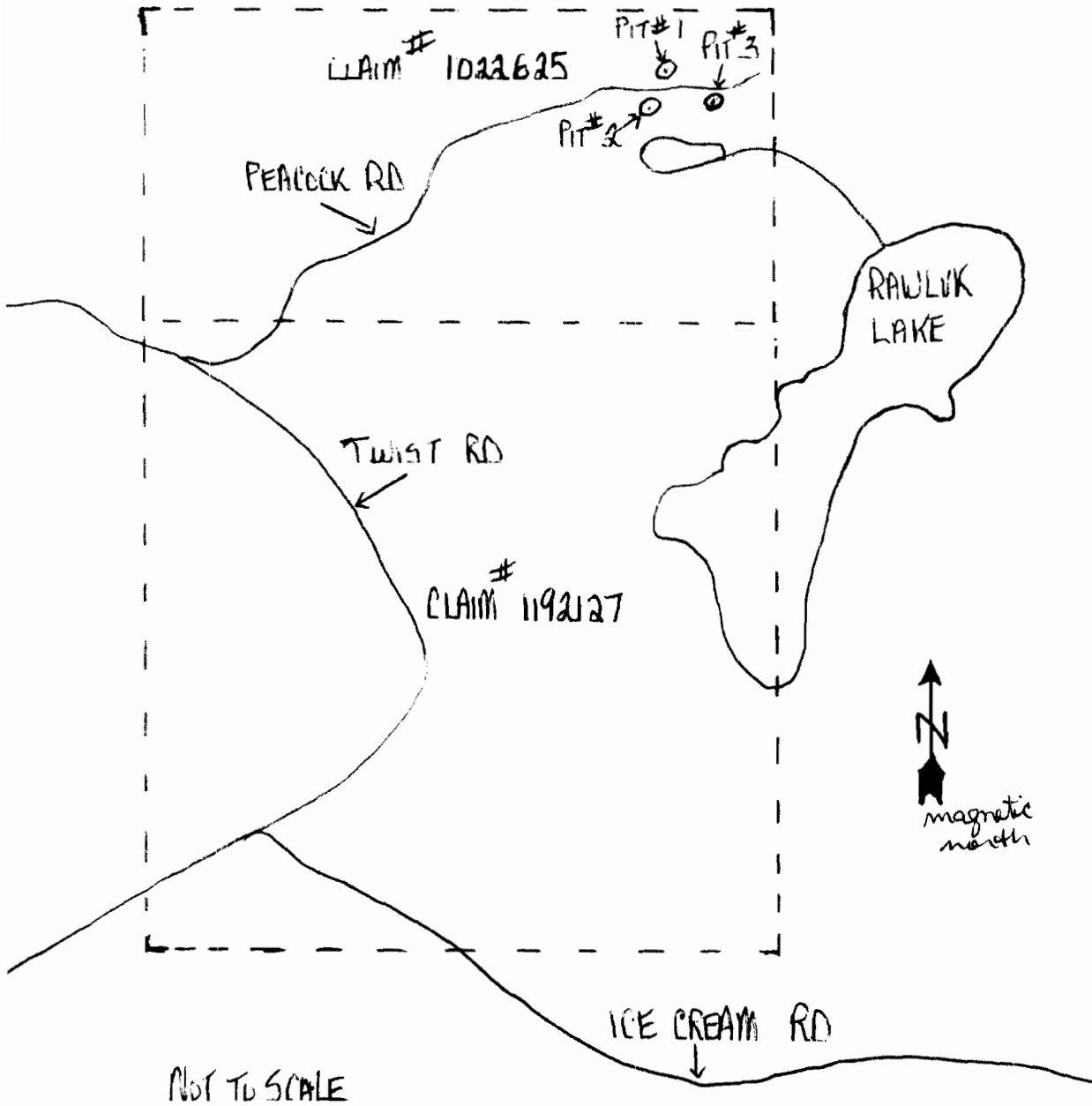

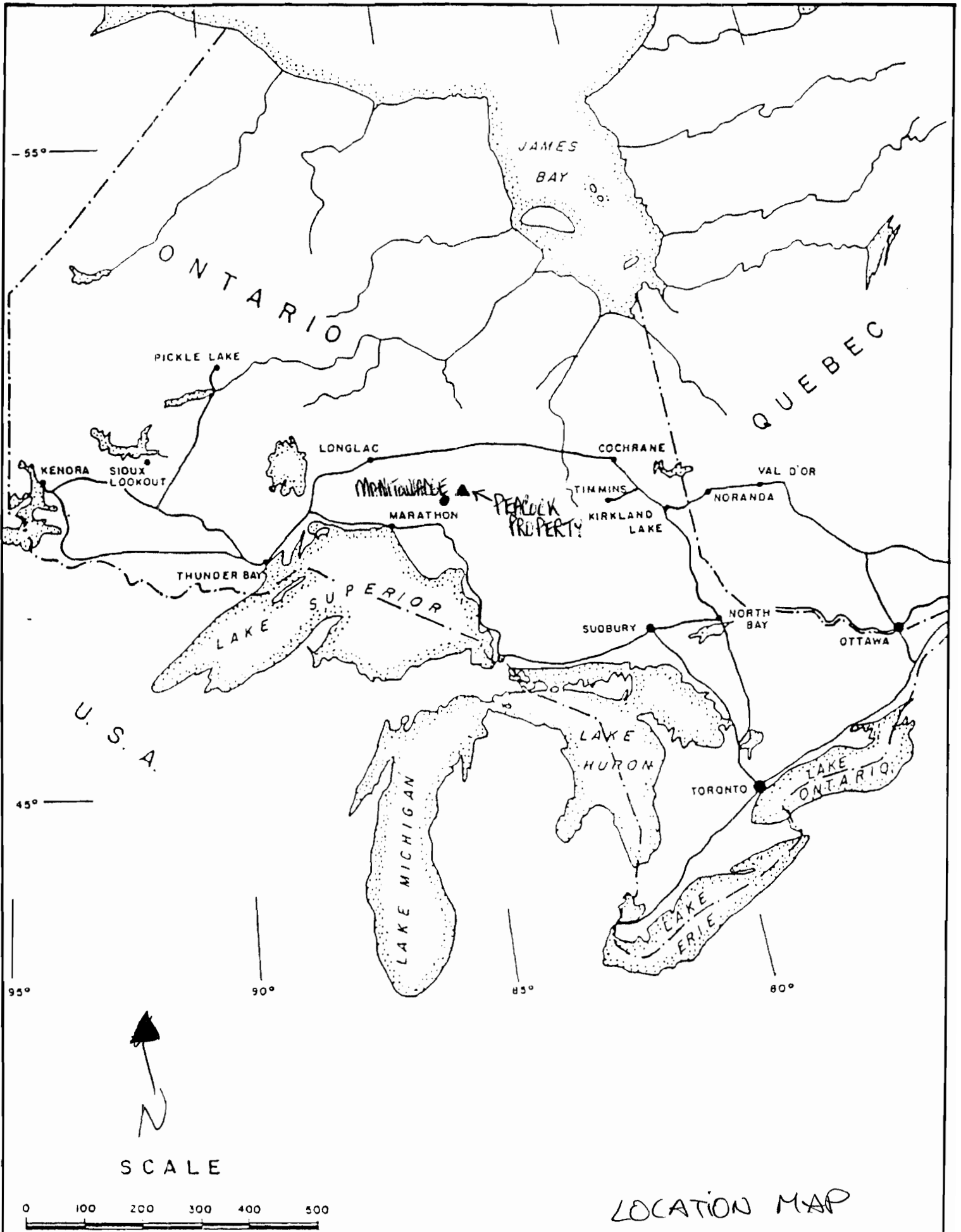

LOCATION MAP

Claim Location Topographical Map G-2857

