

EXPLORATION TRENCHING REPORT ON A NEW GRAPHITE ZONE  
FOR INDUSTRIAL MINERALS CANADA INC.  
ON THEIR MARIA TWP. PROPERTY  
SOUTHERN ONTARIO MINING DIVISION

2.36473

**RECEIVED**  
NOV 16 2007  
GEOSCIENCE ASSESSMENT  
OFFICE



## Ministry of Northern Development and Mines

[| central site](#) | [| feedback](#) | [| search](#) | [| site map](#) | [| français](#)

[| WHO WE ARE](#) | [| MINES AND MINERALS](#) | [| NORTHERN DEVELOPMENT](#) | [| THE MNDM NETWORK](#) | [| NEWS RELEASES](#)

Location: [Ministry Home](#) > [Mines and Mineral Division](#) > [Mining Lands](#) > [Mining Claims](#) Tuesday, November 13th, 2007  
Information

Mining Claim Client Reports

[| Main Menu](#) | [| Back](#) |

### SOUTHERN ONTARIO Mining Division - 400757 - INDUSTRIAL MINERALS CANADA INC.

Township Area	Claim Number	Recording Date	Claim Due Date	Status	Percent Option	Work Required	Total Applied	Total Reserve	Claim Bank
MARIA	1234705	2001-Sep-24	2007-Nov-24	A	100 %	\$ 535	\$ 3,465	\$ 0	\$ 0
MARIA	1249711	2001-Sep-17	2007-Nov-24	A	100 %	\$ 3,400	\$ 18,600	\$ 0	\$ 0
MARIA	1249723	2001-Sep-17	2007-Nov-24	A	100 %	\$ 900	\$ 5,100	\$ 0	\$ 0
MARIA	4200146	2006-Jun-15	2008-Jun-15	A	100 %	\$ 1,200	\$ 0	\$ 0	\$ 0
MARIA	4200147	2007-Jul-05	2009-Jul-05	A	100 %	\$ 3,600	\$ 0	\$ 0	\$ 0
MARIA	4200148	2007-Jul-05	2009-Jul-05	A	100 %	\$ 4,000	\$ 0	\$ 0	\$ 0

Last Web Design Change: d/m/y 31/05/2006

[| central site](#) | [| feedback](#) | [| search](#) | [| site map](#) | [| français](#) |

[| Who We Are](#) | [| Mines and Minerals](#) | [| Northern Development](#) | [| The MNDM Network](#) | [| News Releases](#) |



This site is maintained by the Government of Ontario, Canada.

Comments, feedback, technical and general inquiries to: [terry.binkley@ontario.ca](mailto:terry.binkley@ontario.ca)

Copyright information: © Queen's Printer for Ontario, 2007  
[External Links Disclaimer](#) | [General Disclaimer](#)

TOTAL DATES OF WORK PROGRAM

OCTOBER 17, 2007

GO TO WORK SITE AND FLAG OUT THE EXTENT OF THE WORK AREA, 100M. FROM THE CREEK TO THE SOUTH.

MARK THE CLAIM LEASE LINE BOUNDARY.

VIEW THE EXTENT OF THE WORK AREA.

CHECK OUT THE EXSISTING ROADS AND TRAILS

MAKE A LIST OF SUPPLIES I WOUL NEED, FOR PICK UP.

OCTOBER 19,20,21, 2007

DATES OF THE MECHANIZED STRIPPING PROGRAM.

OCTOBER 22, 2007

CLOSE WITH THE MACHINE ALL UNNECESSARY TRENCHES

TAKE SAMPLES.

INSTALL SAFETY BARRIER AT TRAIL IN TO T-11 TO T-16 AREA.

CLOSE UP WITH MORE DANGER TAPE AND FLAGGING FOR TRAILS INTO T-4, T-5, AND T-6, FROM THE OLD ROAD USED FOR ACESS.

REPORT PREPERATION

OCTOBER 26 AND 27, 2007- CORRELATION OF INFORMATION AND PREPARE MAPS

NOVEMBER 1 AND 2 , 2007 - START REPORT, AND DO PHOTO COPIES OF MAPS

NOVEMBER 12, 13, AND 14 , 2007- TYPE FORMAL REPORT X2 AND BIND FOR FINISHING WITH MAPS AND GOVERNMENT DOCUMENTS.

1 COPY TO COMPANY.

TOTAL COSTS OF PROGRAM

MACHINE 325 CAT EXCAVATOR AT 200 HR. AS INDUSTRY STANDARD WITH OPERATOR AND FUEL.

OCT. 17 50% TO LEASE EO608346 = \$ 150 + 25  
50% TO CLAIM # 1249723 = \$ 150 + 25  
\$350.00

OCT 19 AND 20 CLAIM 1249723  
24HRS . 2 DAYS 4800.  
+ 600  
+ 100  
\$ 5,500

OCT 21 TO EO 608346  
10 HRS = 2000  
+ 300  
+ 50  
\$2350

OCT. 22 TO CLAIM 1249723  
8HRS 1600  
+300  
+50  
\$1950

REPORT 2 DAYS  
TO LEASE EO608346 \$600

REPORT 5 DAYS  
TO CL # 1249723 \$1500

TOTAL ASSESSMENT 12,250.00

EXTENT OF REPORT

THIS REPORT IS PREPARED BY, MR. GUY SHOUINARD, PROSPECTOR IN THE PROVINCE OF ONTARIO, AND CONSULTANT IN BASIC AND EARLY EXPLORATION.

MR. SHOUINARD, IS NOT IN ANY WAY CONNECTED, NOR, IS HE A SHARE HOLDER OF THE COMPANY.

HE IS ACTING ONLY AS AN CONSULTANT, IN BASIC EXPLORATION, ON BEHALF OF THE COMPANY, IN THE MATTER, OF THIS REPORT, WHICH WILL BECOME PUBLIC KNOWLEDGE.

THE INFORMATION CONTAINED IN THIS REPORT IS NOT NR-43-101 COMPLIANT AND SHOULD NOT BE VIEWED AS SUCH.

MR. SHOUINARD IS NOT ACTING AS A QUALIFIED PERSON FOR THE COMPANY.

GUY SHOUINARD  
MATTAWA, ONTARIO

## PROJECT OVERVIEW

THE OBJECT OF THE PROGRAM IS TO UNDERSTAND ANY AREAS ON THE BISSET CREEK PROPERTY, THAT MAY CONTAIN UNKNOWN RESOURCES NOT LOCATED WITHIN THE PRESENT MINE SITE LEASES. THIS PROGRAM WAS STARTED BY THE COMPANY IN 2006.

PRESENT KNOWN RESOURCES, AS WELL AS THE TEST MILL SITE ARE CONTAINED WITHIN AN AREA OF 28 LEASES OF 50 ACRE EACH, IN MARIA TWP. OF THE SOUTHERN ONTARIO MINING DIVISION. THE LEASES ARE CENTRAL TO MINING CLAIMS STAKED ON THE EAST, NORTH, AND WEST, OF THE CORE PROPERTY.

IT IS THE CURRENT VIEW OF THE COMPANY, TO BRING TO FINAL PRODUCTION, A FULL SCALE OPERATION AS SOON AS POSSIBLE.

WITH THIS IN MIND, ANY OTHER RESERVES OR EXTENSIONS OF RESERVES OF ECONOMICAL SIZE AND GRADE MAY, BECOME IMPORTANT. THE EXPLORATION WILL ALSO HELP THE COMPANY DECIDE IF THERE ARE CLAIMS THAT ARE NOT VIABLE.

PEOPLE AND EQUIPMENT AND SUPPLIES

PEOPLE

COMPANY OPERATOR  
AND  
GUY SHOINARD

EQUIPMENT USED

COMPANY SUPPLIED CATERPILLAR 235 MODEL EXCAVATOR  
GPS.

HIP CHAIN

SHOVELS, PAILS, WATER AS NECESSARY

SAFETY TAPE AND FLAGGING TAPE

1 SMALL ROLL OF PLASTIC SNOW FENCE FOR SAFETY FENCE LEFT ON SITE TRAIL.

## BEGINNING THE EXPLORATION

IN AUGUST, I WAS CONTACTED BY A COMPANY REPRESENTATIVE, OF INDUSTRIAL MINERALS CANADA INC. THIS WAS IN REGARD TO DO SOME EXPLORATION WORK TO FORWARD TO SOME CLAIMS THAT WERE COMING OPEN.

MANAGEMENT HAD JUST CHANGED HANDS AND SOME OF THE CLAIMS WERE UP FOR ASSESSMENT WORK. THEY DID NOT, IT SEEMS, BECOME AWARE OF THIS UNTIL THEY WERE ALMOST DUE. I IMMEDIATELY FILED FOR AN EXTENSION, EXPLAINING THE CIRCUMSTANCES.

THERE WAS A MATTER OF ALSO GETTING THEIR EXCAVATOR FIXED, WHICH APPEARED TO HAVE BEEN DONE BY THE BEGINNING OF OCTOBER, BUT ALL OF THE PROBLEMS HAD NOT BEEN FIXED AND WE ALMOST LOST A TRACK ON THE ROAD TO WHERE WE WERE HEADING, WE THEN HAD TO PUT THE PROJECT ON HOLD AGAIN.

I WAS FOLLOWING UP ON AN FLAT LYING OUTCROP, WHICH I HAD SEEN ON THE ROAD LAST YEAR, AND HAD SOME MINOR EXPLORATION AT THAT TIME CONFIRMED THAT THERE WAS MORE GRAPHITE BEARING ROCK, FROM THE EAST SIDE OF THE CLAIM, EXTENDING INTO THE LEASE JUST WEST OF THE CLAIM. I HAD FOUND SOME RICH GRAPHITE UNDER SOME UPROOTED TREES ABOUT 75M TO THE SOUTH OF THE ROAD SHOWING, ON THE CLAIM, #1249723, AND SOME MINOR GRAPHITE SOUTH OF THE ROAD AND JUST TO THE EAST IN THE LEASE PROPERTY.



PRELUDE TO WORK PROGRAM  
OCTOBER 17, 2007

I WENT TO THE EXPLORATION AREA, TO DO AN OVERVIEW OF THE AREA, AND TO SEE WHAT I WILL NEED FOR SUPPLIES TO PICK UP BEFORE WE GET ON THE GROUND. THIS AREA ALONG THE ROAD IS WELL USED BY HUNTERS AND OTHER TRAFFIC AND WE MUST BE SAFETY CONSCIOUS OF THE ATV. TRAFFIC ETC. ON ALL ROADS IN THE AREA.

I CONCLUDED, THAT I WOULD NEED 1 LENGTH OF SNOW FENCE AND 1 ROLL OF DANGER TAPE AND SEVERAL ROLLS OF FLAGGING TAPE. THIS I WOULD GET ON THE 18<sup>TH</sup>. THIS IS SUPPLIED AT MY COST EXCEPT FOR THE FENCING.

I HAD PICKED OUT AS WELL, TWO CONNECTED AREAS I WISH TO LOOK AT. ONE, ON AN OLD BUSH ROAD TO THE SOUTH AND JUST EAST OF THE SHOWINGS, WHICH FLANKS A RIDGE OF GLACIAL DEBRIS. THIS IS STILL IN GOOD SHAPE, EXCEPT FOR A FEW ROCKS STICKING UP, FROM THE SKIDDERS, AND THE SECOND AN OLD SKID TRAIL IN BAD SHAPE JUST TO THE EAST, WHICH RUNS FROM THE CLAIM 1249723 INTO LEASE EO 608346, AND CROSSES THE SHOWING AREA.

I ALSO HAD TO MEASURE OUT A 100M DISTANCE NORTH OF A CREEK TO THE SOUTH OF THE WORK AREA, JUST TO BE SURE I DID NOT GET INTO TROUBLE HERE. IN THE FUTURE THE COMPANY MAY HAVE TO APPLY FOR A PERMIT OF ADVANCED EXPLORATION, IF THEY WISH TO COVER A LARGER AREA.

WE WILL START THE ACTUAL MECHANICAL STRIPPING ON SITE ON THE 19<sup>TH</sup> OF OCTOBER.

TODAYS WORK \$ 300.00 DAY PAY  
PLUS TRAVELLING. \$ 50.00

DAY 1 OF THE MECHANICAL STRIPPING PROGRAM  
OCTOBER 19, 2007

THE OPERATOR WARMED HIS MACHINE AT 7AM AND FUELED UP. WE WALKED THE MACHINE FROM THE MINE SITE BUILDING A DISTANCE OF 400M. I HAD MARKED OUT 6 SITES ALONG THE OLD ROAD TO THE SOUTH ON THE 17<sup>TH</sup>, SO I STARTED HIM ON THE GOOD ROAD AT SITE T-1, AND WHILE HE WORKED I WENT BACK AND CLOSED OFF THE ROAD WITH DANGER TAPE. I AM LOOKING TO SEE IF THERE IS A CONTACT TO BE FOUND IN THIS AREA FROM THE WHITE FELDSPAR GNEISS ON THE WEST OF THE ROAD AND THE GRAPNITIC UNIT ON THE EAST OF THE GLACIAL RIDGE.

I RETURNED TO THE MACHINE, AND CHECKED ON THE PROGRESS, AT T-1. WE DID NOT TOUCH BOTTOM HERE. OR AT T-2A OR T-2B. AT T-3 WE HIT BEDROCK BUT THIS IS ON THE SHALLOW WESTERN SIDE OF THE RIDGE NEAR SOME WHITE FELDSPAER GNEISS OUTCROPS . THIS IS WHAT WAS IN THE TRENCH AS WELL, BUT NO SIGN OF GRAPHITE.

T-4 AND T-5 WERE DUG ON THE TOP OF THE GLACIAL RIDGE AND NO BEDROCK WAS SEEN OR TOUCHED. A FEW SCATTERED PIECES OF GRAPHITE BEARING FLOAT IN BROKEN CHUNCKS WAS SEEN AND MAY BE FROM A CLOSE LOCAL SOURCE, BECAUSE THE REST OF THE FLOAT IS 95% ROUNDED BOULDERS. THE COMPANY WILL HAVE TO DECIDE TO PURSE THIS BY DRILLING OR MORE EXTENSIVE STRIPPING. IT IS NOT WITHIN THE PROGRAM BUDGET FOR NOW. ALL TRENCHES ARE BEING LEFT OPEN FOR THE PRESENT, UNTIL I GET CONFIRMATION, OF WHAT THEY WISH TO DO.

WE FINISHED OFF AT 5PM.

MACHINE FOR DAY	
ON EQUIVALENT TO INDUSTRY	
10 HRS. @ 200.00 PER HR. , INCLUDES FUEL AND OPERATOR	= \$2000.00
MY DAY PAY	= \$300.00
TRAVELLING	= \$50.00

DAY 2 OF THE MECHANICAL STRIPPING PROGRAM  
OCTOBER 20,2007

TODAY WE STARTED AT 7 AM ON TRENCH T-6. THIS IS AT THE NORTH END OF THE GLACIAL RIDGE, AND VERY NEAR THE MAIN ROAD. THERE BEDROCK WAS HIT BUT WAS NO GRAPHITE WAS SEEN, IN ANY FORM. IN THIS TRENCH THE BEDROCK IS A PINK, BIOTITE RICH GNEISS, WHICH IS SEEN IN AREAS OVER THE PROPERTY. THIS TRENCH IS VERY NEAR THE GRAPHITE RICH TRENCH, T-11. THE CONTACT IS PRESUMED TO BE VERY NEAR ONE OF THESE TRENCHES. FURTHER TRENCHING IS RECOMMENDED BETWEEN THE TWO AREAS.

WE ENTERED THE ROAD AND AS THE OPERATOR WORKED ON THE MAIN ROAD I KEPT AN EYE TO TRAFFIC. TRENCHES T-7 TO T-9 WERE NOT ABLE TO OVER COME THE WATER INFLOW. ON REACHING A LAYER OF CLAY AND HARD PAN MATERIAL ALONG THE SOUTH EDGE OF A DRY SURFACE SPRUCE UNDER WHICH THERE IS AN UNKNOWN DEPTH OF LARGE BROKEN BOULDERS AS A WATER COLLECTION ZONE ( IS A DEEP SHEAR ZONE ) SWAMP THE WATER BEGAN HYDRALIC ACTION AND CAME IN VERY QUICKLY AT 2 METERS DEPTH, THIS SEEMS TO BE AN AREA OF MULTIPLE SPRINGS OR BACKED UP GROUND WATER. NO BEDROCK WAS HIT HERE ONLY SAND WITH A FEW SMALL BOULDERS OVERLYING CLAY.

AT T-10 , BEDROCK BEARING FINE FLAKE GRAPHITE WAS HIT, I WAS ABLE TO JUMP IN AND GRAB A SAMPLE, IN AN HOUR THIS TRENCH HAD 2 FEET OF WATER IN THE BOTTOM. THE SPRING HERE WAS IN A BROCKEN ROCK SEAM AND WAS FLOWING AT LEAST AT 10 GALLONS PER MINUTE. ALL THESE TRENCHES WERE LEFT OPEN AT THE TIME. ALL BUT THE T-10 WAS CLOSED LATER. ALL OF THESE TRENCHES WERE ALONG THE NORTH SIDE OF THE ROAD.

ACROSS THE ROAD FROM T-9 WE ENTERED, THE SOUTH AREA OF EXPLORATION. WHILE THE OPERATOR MADE A TRAIL I FLAGGED OUT THE SITE. WHERE I WANTED HIM TO WORK. ORIGINALLY T-11 WAS TO BE EAST - WEST BUT AFTER DIGGING IT, THE TRENCH WAS FOUND TO BE VERY GRAPHITE RICH IN COARSE FLAKE GRAPHITE. I GOT THE OPERATOR TO DIG OFF A NORTH - SOUTH TRENCH AS A "T" SHAPE.

I WAS MUCH ENCOURAGED BY THIS AND ASKED THE OPERATOR IF HE WOULD STAY LATER, FOR 1 DAY, HE HAD ENOUGH FUEL TO DO THIS. WE OPENED THE TRAIL TO T-12 AND FINISHED UP THERE IN THE DARK. HERE WE FOUND MORE GOOD GRADE COARSE FLAKE GRAPHITE.

WE FINISHED UP AT JUST AFTER 7 PM.

MACHINE FOR DAY

ON EQUIVALENT TO INDUSTRY

12 HRS. @ 200.00 PER HR. INCLUDES FUEL AND OPERATOR.

= \$2400.00

MY DAY PAY

= \$300.00

TRAVELLING

= \$ 50.00

DAY 3 OF MECHANICAL STRIPPING

OCTOBER 21, 2007

*LEASE E0608346*

I HAD CLOSED UP THE AREA WITH DANGER TAPE LAST NIGHT, BUT AT 7AM I HAD TO LET HIM GO BACK TO THE SITE TO FUEL UP. HE DID NOT WANT TO WALK THE MACHINE IN THE DARK.

TODAY WE START ON THE LEASE PROPERTY. WHEN HE DID WHAT HE DOES AND GOT BACK WE STARTED IN ON THE LAST OF THE TRENCHES. T-13 WAS FOUND TO HOLD GRAPHITE AS WELL, OF GOOD SIZE AND GRADE, EST. 3% WITH A FEW PIECES OF AMPHOROUS MATERIAL PRESENT IN 3-4 CM. CLOTS. WE HAVE NOT HAD ANY SPRING ACTION SINCE WE LEFT T-10. JUST NORMAL GROUND WATER, SLOWLY COMING IN, FROM THE RECENT RAINS.

AT T-14 WHICH IS THE FURTHEST EAST WE WENT, THERE WAS A FEW PIECES OF GRAPHITE FLOAT BUT NO BED ROCK. AT T-15 WE AGAIN HIT GRAPHITE IN BED ROCK. HERE I ESTIMATE THE GRADE AT 3% FINE FLAKE. THESE TRENCHES ARE ALONG A LEDGE, OF SHEARING.

AT T-16 WE HIT BEDROCK AND GRAPHITE FLAKE OF A MEDIUM GRAIN OF ABOUT 3%. THIS TRENCH IS OVER A SMALL HILL ON THE NORTH SIDE OF THE FORMATION. WE THEN WENT BACK OUT TO THE ROAD AND OPENED A SMALL AREA OFF THE ROAD JUST NORTHEAST OF T-16.

THE TRENCH T-17 IS FILLED WITH GRAPHITE FLOAT TO BED ROCK, WHICH IS GRAPHITE AS WELL. HERE A GRADE OF MEDIUM FLAKE 3% IS VISIBLE. WE FINISHED UP AT 5 PM. I WILL SAMPLE AND FINISH ANY CLOSURES TOMORROW, AND INSTALL THE SAFETY BARRIER AND MAKE SURE ALL IS SECURE UNTIL THE COMPANY MAKES THEIR DECISIONS.

MACHINE FOR THE DAY  
ON EQUIVALENT TO INDUSTRY  
10 HRS. @ 200.00 PER HR.  
MY DAY PAY 300.00  
TRAVELLING 50.00

= \$2000.00  
= \$300.00  
= \$ 50.00

OCTOBER 22, 2007

TODAY IS THE LAST FIELD DAY FOR US. I HAD THEIR OPERATOR CLOSE UP SOME OF THE UNECESSARY TRENCHES FOR NOW WHILE I TOOK SAMPLES, FROM WHAT I BELIEVE ARE APPROPRIATE SITES, AND PUT THEM IN A WOODEN BOX SO THAT THE APPROPRIATE PEOPLE CAN LOOK THEM OVER WHEN THEY ARRIVE. NONE OF THESE SAMPLES WILL BE SENT OUT FOR ANY TESTS. THEY WERE TAKEN ONLY FOR THE COMPANIES VIEWING. WHEN THE RIGHT PEOPLE COME TO THE SITE THEY WILL REVIEW THE TRENCHES AS WELL.

THE COMPANY WANTS TO LEAVE THE SITES AT T4, T5, AND T6, OPEN FOR NOW, SO HE GAVE ME A HAND TO CLOSE AND SAFTEY FLAGG THE SITES, AS WE WENT BACK FROM T-17, TO T-1.

AS WELL WE INSTALLED THE PIECE OF SNOW FENCE AT THE T-11 TRAIL SITE, BECAUSE OF THESE OPEN TRENCHES, SOME OF WHICH ARE QUITE DEEP.

TODAY WE STARTED AT 8 AM AND FINISHED AT 4 PM AND RETURNED THE MACHINE TO THE MINE SITE.

SEE THE ENCLOSED SHEET FOR SITES LEFT OPEN AND CLOSED FOR NOW.

MACHINE FOR THE DAY  
ON EQUIVALENT TO INDUSTRY  
8 HRS. @ 200.00 PER HR.  
MY DAY PAY 300.00  
TRAVELLING 50.00

= \$1,600.00  
= \$ 300.00  
= \$ 50.00

OCTOBER 22, 2007 DAY 4 OF PROGRAM TAKING SAMPLES FOR THE COMPANY  
AND CLOSING OF UNNECESSARY TRENCHES WITH EXCAVATOR

TRENCHES SAMPLED - T- 10, T-11, T-12, T-13, T-14, T-15,T-16

TRENCHES LEFT OPEN FOR FURTHER EXPLORATION T-4, , T-5, T-6, LEFT OPEN FOR  
POSSIBLE FUTURE DRILLING

T-10, T-11 ,T-12, T-13, T-14, T-15, T-16.LEFT OPEN FOR GRAPHITE INSPECTION POSSIBLE  
FUTURE STRIPPING, OR DRILLING, OF SOME AREA BETWEEN T-11 AND T-16.

TRENCHES CLOSED T-1 ,T-2A , T-2B, T-3, T-7, T-8, T-9, T-17.

20°W LOT LINES  
AST NORTH

032288 AGFA-GEVAERT

20th PATH  
BISSETT ROAD

MINE COAL

WORK AREA

RD.

87-1605  
16-124

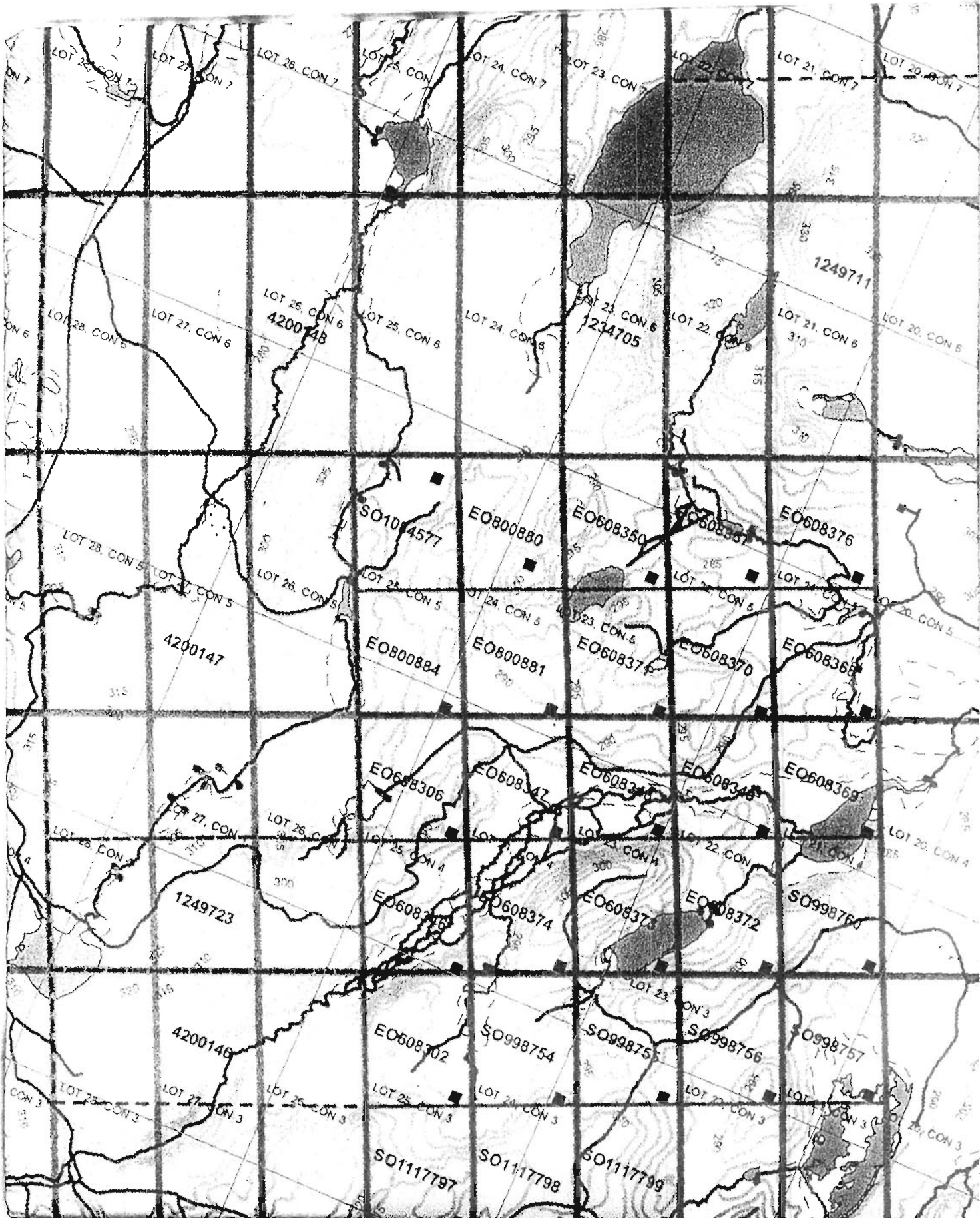



MAP SECTION MARIATWP. ONTARIO G13-87  
 SOUTHERN ONTARIO MINING DIVISION  
 DRAWN BY GUY SHOHINARD.

CLAIM ...  
 SOUTH 1/2 OF LOTS 28, 27, 26  
 CON. 04. MARIATWP.

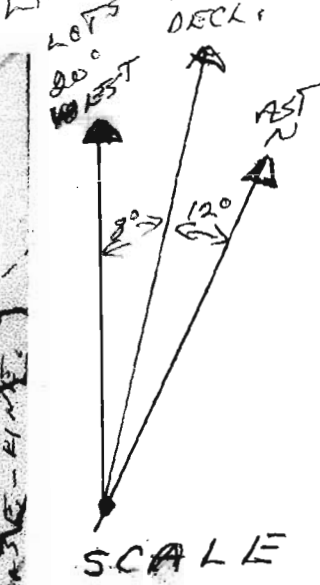
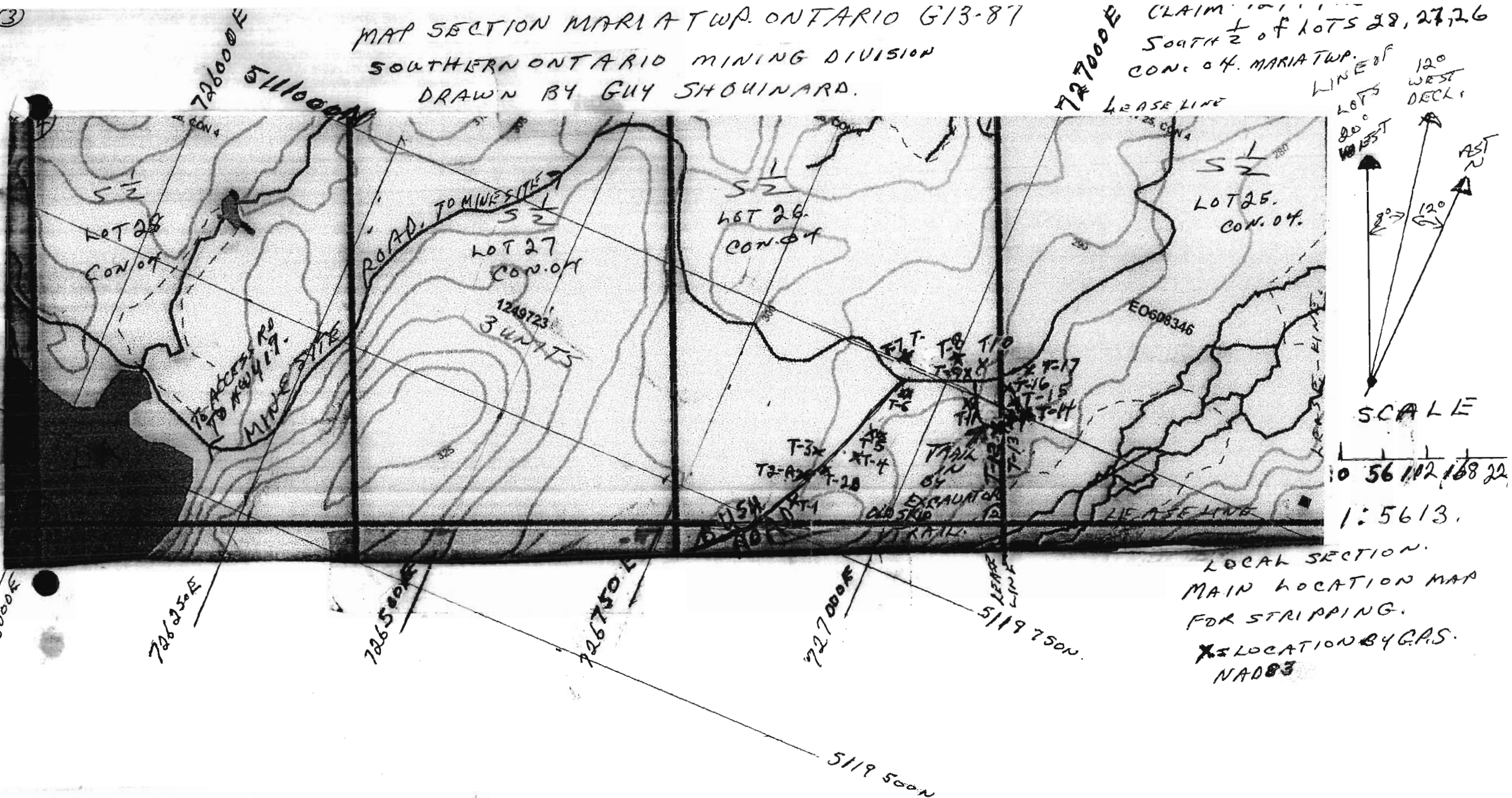

10 56 102 168 22  
 1:5613.

LOCAL SECTION.  
 MAIN LOCATION MAP  
 FOR STRIPPING.  
 X = LOCATION BY G.P.S.  
 NAD83

STRIPPING LOCATIONS FOR DAY 1 OF PROJECT  
OCTOBER 19, 2007

X = LOCATION BY G.P.S. / N.A.D. 83  
PLACED ON MAIN LOCATION MAP CLAIM # 1249723 MARIA TWP.

T-1 = 0726883E/5110819N

T-2 A= 0726904E/5110820N

T-2-B= 0726916E/5110843N

T-3= 0726881E/5110853N

T-4 = 0726912E/ 5110882N

T-5= 0726944E/5110914N

# OVERBURDEN TRENCHING DETAIL #T-1

DRAWN BY  
A. SHOLIMARD.

CLAIM # 1249723 MARIA TWP. G1387

SOUTHERN ONTARIO DIV. 5 1/2 LOT 26. CON. OF

FOR INDUSTRIAL MINERALS CANADA INC.

WORK ON SOUTH PART OF LOT 26 CON. OF MARIA TWP.

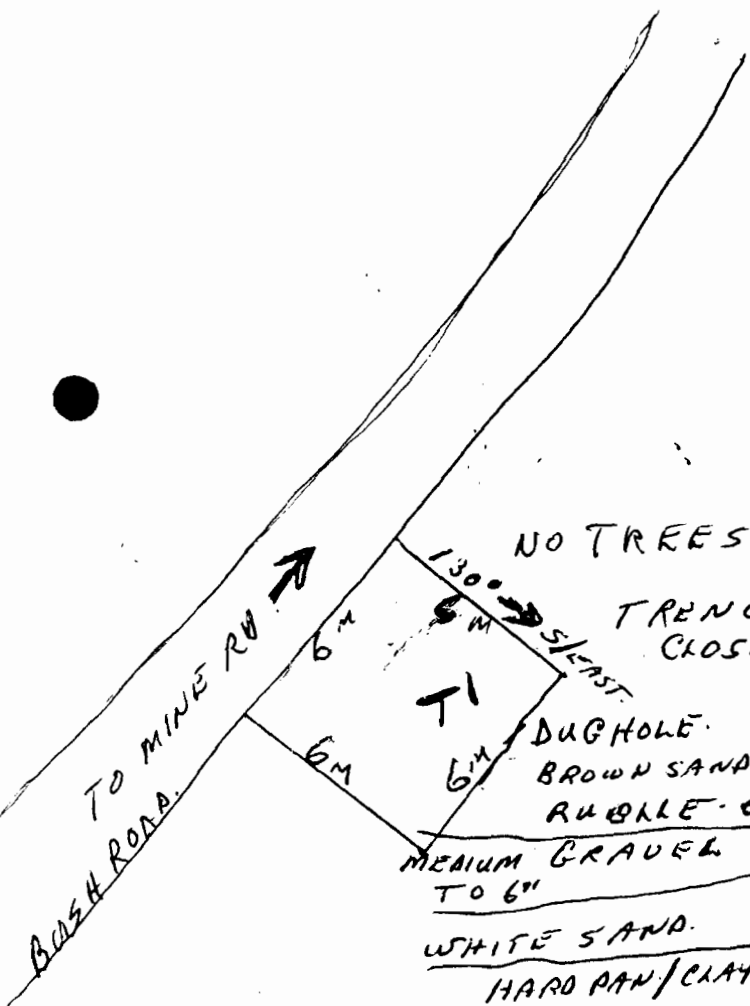
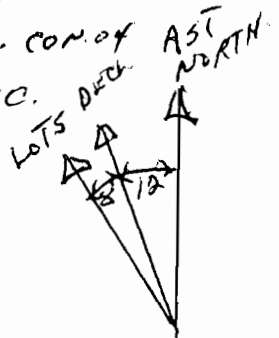
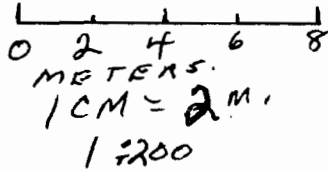

NO TREES CUT - LOGGED OVER BUSH.

TRENCH DUG OCTOBER 19/2007.  
CLOSED ON OCTOBER 28/2007.

BROWN SAND	2M
RUBBLE	2M
MEDIUM GRAVEL	.5M
TO 6"	
WHITE SAND	2M
HARD PAN/CLAY	.5M

BOTTOM NOT REACHED.



LOC. SEE SHEETS  
0726883E  
05110819N

NO BEDROCK SEEN.  
NO GRAPHITE FLOAT SEEN  
WHILE DIGGING.

OVERBURDEN TRENCHING DETAIL T2A/T2B.

(12)

DRAWN BY  
G. SHOHINARD.

CLAIM # 1249723 MARIA TWP. G1387  
SOUTHERN ONTARIO DIV. S 1/2 LOT 26 CON. OF  
FOR INDUSTRIAL MINERALS CANADA INC.

WORK ON SOUTH PART LOT 26 CON. OF MARIA TWP.

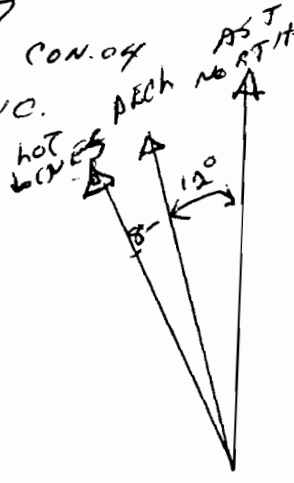
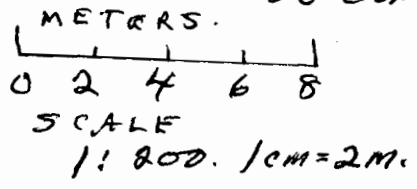

LOC. 0726904E  
0511082N

DUG ON OCT 19/2007

HOLE FILLED  
ON OCT 22/2007.

DUG HOLE 6M X 6M X 6M

NO BEDROCK NO GRAPHITE  
FLOAT  
WHILE  
DIGGING.

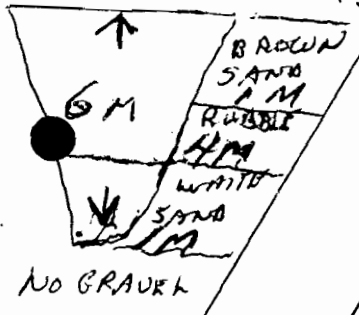
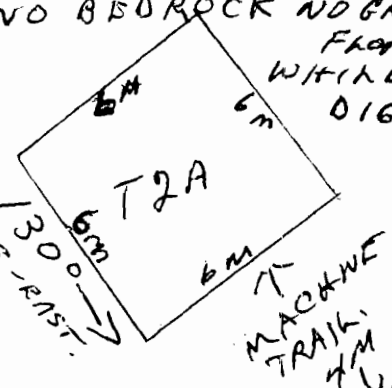

NO CLAY.

DUSH RD. TO MINE RD. →  
20 METERS

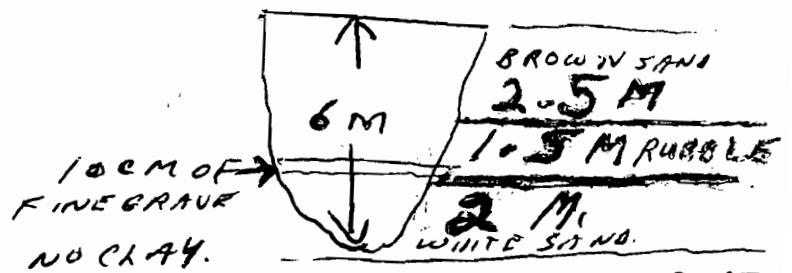
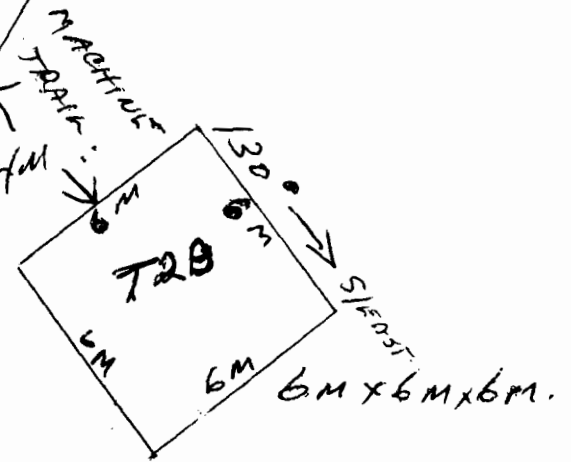

DUG ON OCT. 19/07.  
FILLED ON OCT 22/07.  
NO GRAPHITE FLOAT  
SEEN WHILE DIGGING.

LOC. 0726916E  
05110843N

OVERBURDEN TRENCHING DETAIL. T-3

(12)

DRAWN BY  
H. SHOHINARA.

CLAIM # 1249723 MARIA TWP. G1387  
SOUTHERN ONTARIO DIV. 5 1/2 LOT 26. CON. OF  
FOR INDUSTRIAL MINERALS CANADA INC.

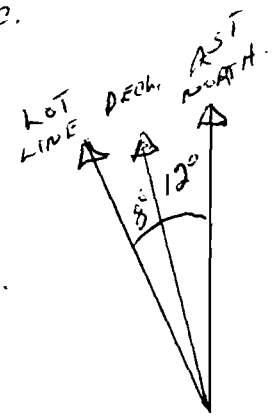
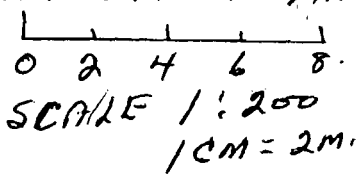

OUTCROPS  
OF  
WHITE FELDSPAR  
GNEISS, IN AREA.

TRENCH DUG ON OCTOBER 19/07.  
CLOSED ON OCTOBER 22/07.

OCCASIONAL FLAKE  
OF GRAPHITE  
DISSEMINATED  
IN O/C.

NO VISIBLE GRAPHITE  
NO GRAPHITE FLOAT. SEEN.

LOCATION: 8726881E  
5110853N

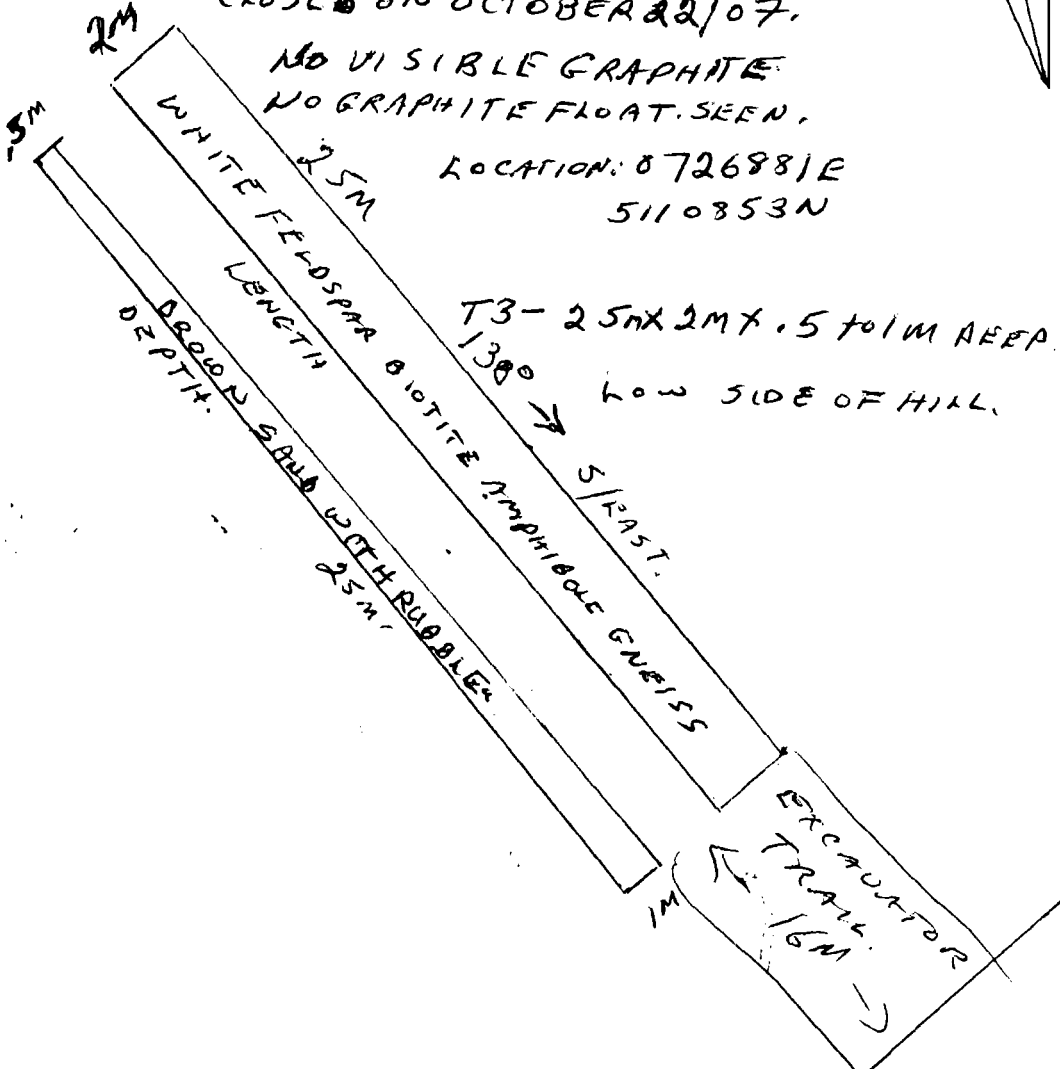

T3 - 2.5m x 2m x .5 to 1m DEEP.  
130° → S/EAST.  
LOW SIDE OF HILL.

EXCAVATOR  
TRAIL  
1.6m

RUSH ROAD TO MINE RD. →

# OVERBURDEN TRENCHING DETAIL. T-4

DRAWN BY  
G. SHOLINARD.

CLAIM # 1249723 MARIA TWP. G1387  
SOUTHERN ONTARIO DIV. 5 1/2 LOT 26. CON 04.  
FOR INDUSTRIAL MINERALS CANADA INC.

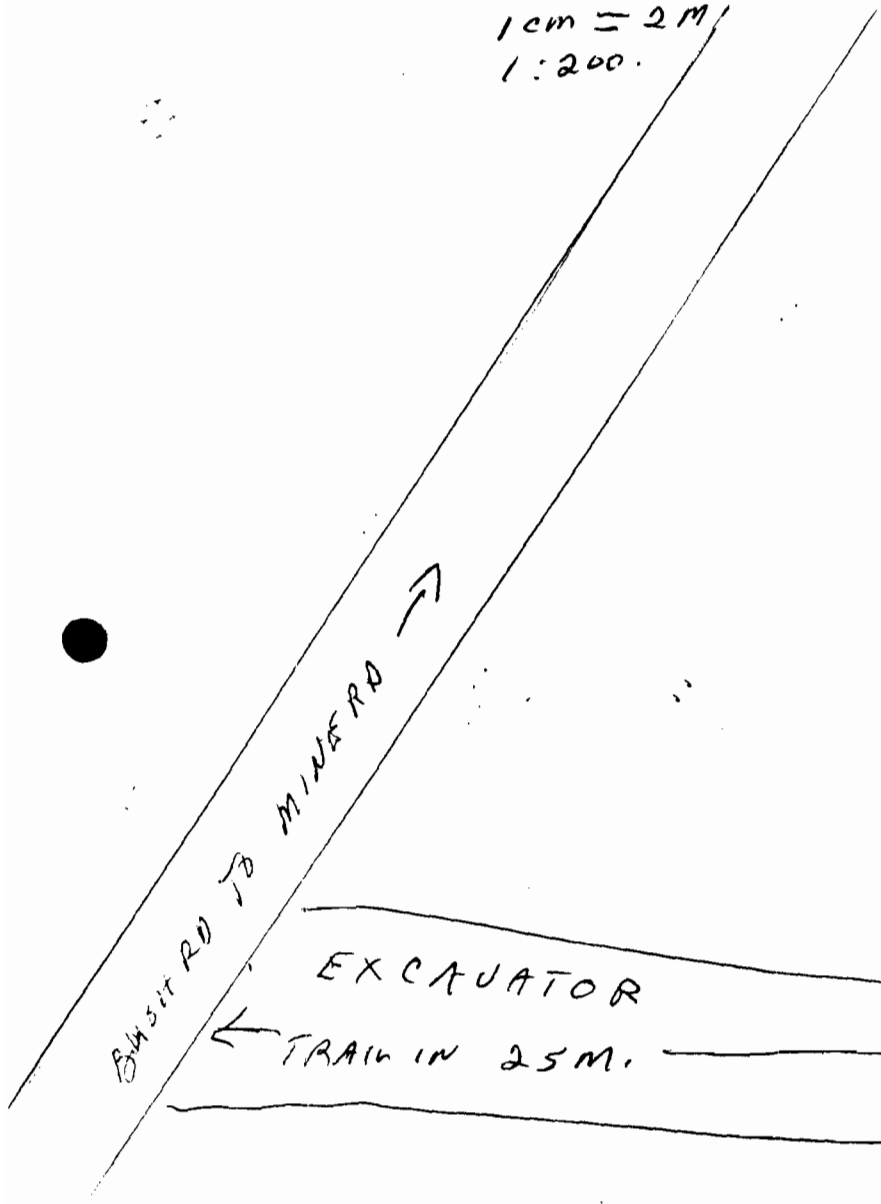
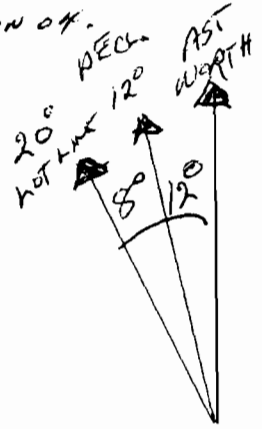
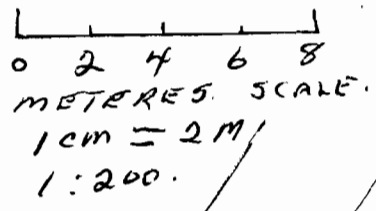

TRENCH AUG. 19/OCTOBER/07.  
TX 10M X 3M X 5-6M DEEP.

SMALL PINE TREES.  
ACROSS FOR  
SAFETY.

LOCATION  
0726912E  
5110882N.  
10M

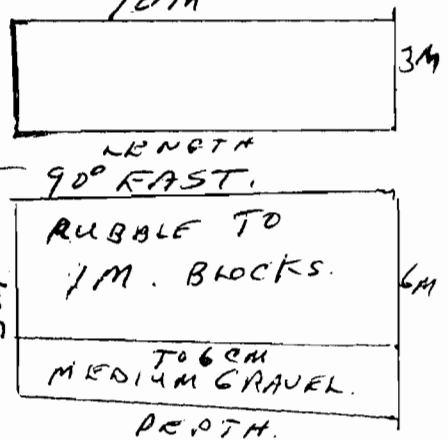

TOP OF HEIGHT  
OF LAND.

TRENCH LEFT OPEN  
FOR NOW.

SOME GRAPHITE  
BEARING FLOAT OUT  
OF HOLE.  
NO BEDROCK.

OVERBURDEN TRENCHING DETAIL, T-5.

DRAWN BY  
SHOHINARA

CLAIM # 1249723 MARIA TWP. G1387  
SOUTHERN ONTARIO DIV. S 1/2 LOT 26. CON. 64  
FOR INDUSTRIAL MINERALS CANADA INC.

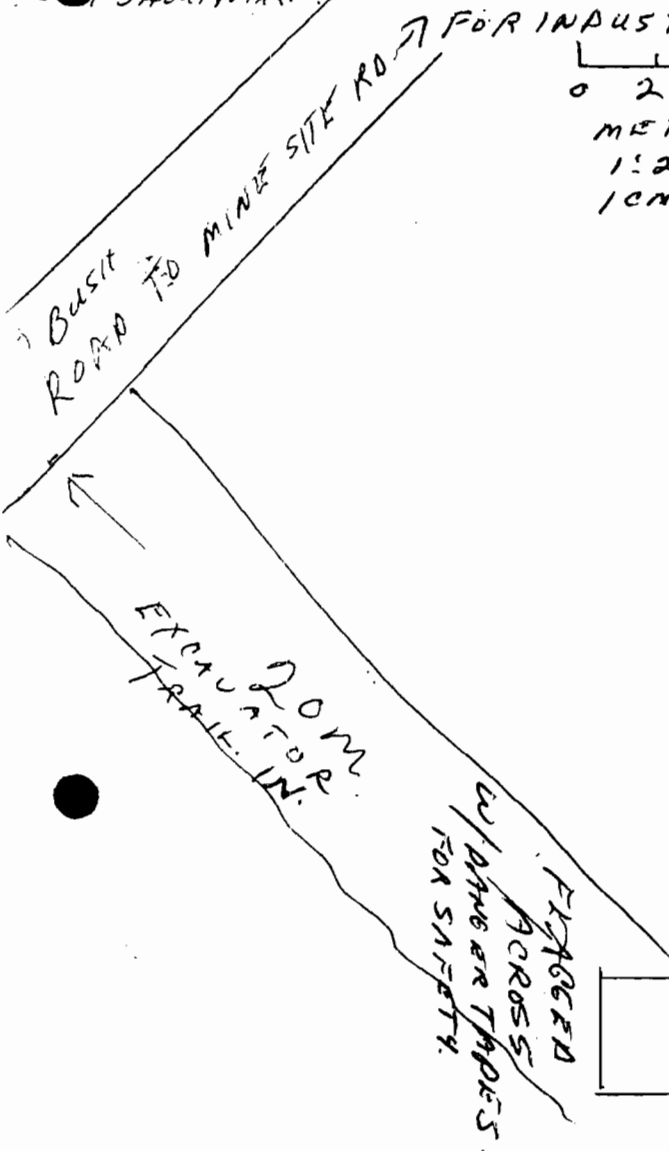
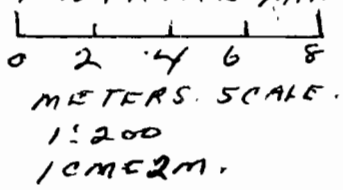

LOCATION T-5 OPENED 19/OCT./07.  
0726944E/5110914N.

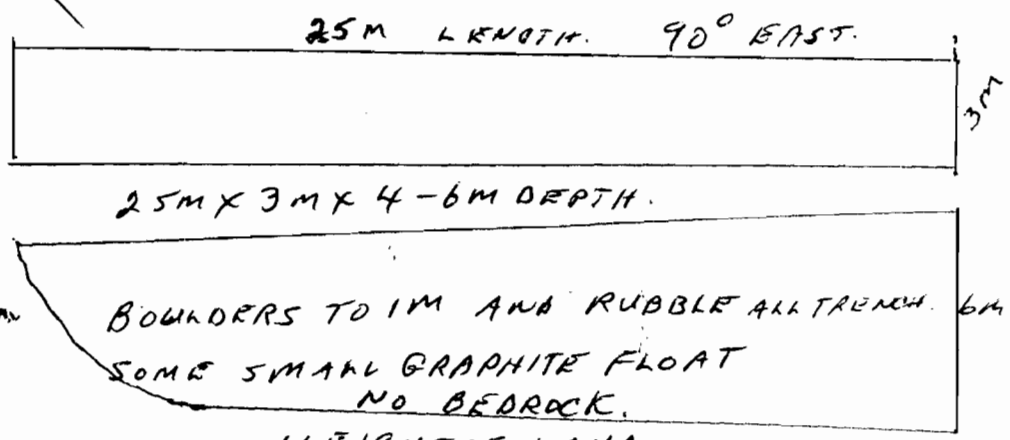

TRENCH LEFT OPEN AT PRESENT.

STRIPPING LOCATIONS FOR DAY 2 OF PROJECT  
OCTOBER 20,2007

X=LOCATION BY G.P.S./ N.A.D.83  
PLACED ON MAIN LOCATION MAP CLAIM # 1249723 MARIA TWP.

T-6 = 0726963E/5110959N

T-7 = 0726956E/5111015N

T-8 = 0727005E/5111032N

T-9 = 0727015E/5111022N

T-10= 0727030E/5111037N

T-11= 0727034E/5110990N

T-12= 0727080E/5110990N



# OVERBURDEN TRENCHING DETAIL, T-6.

DRAWN BY  
SHOCHINARA

CLAIM # 1249723 MARIA TWP. G1387  
SOUTHERN ONTARIO DIV. S 1/2 LOT 26 CONOIF  
FOR INDUSTRIAL MINERALS CANADA INC.

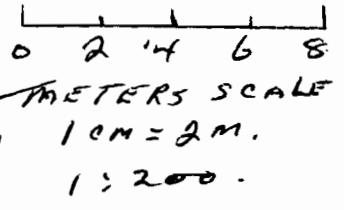

BUS RD TO  
MINE SITE RD.  
PLACED HERE WITH  
DANGER TAPES.

EXCAVATOR TRACK  
30M TRAIL

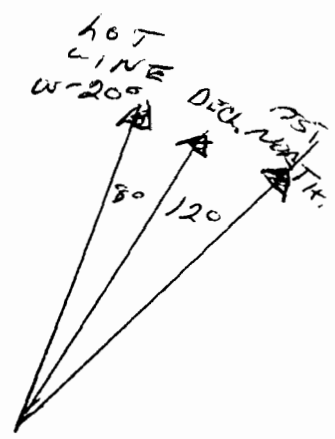

LOCATION T-6: 5110959N.  
0726963E / 25M 90 EAST  
LENGTH: 25M DEEP.

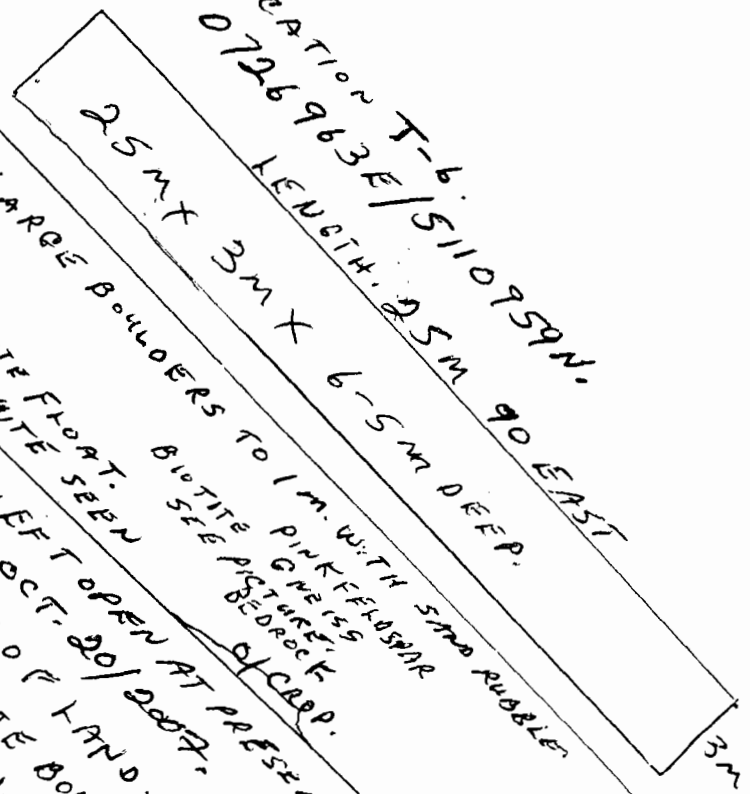

LARGE BOULDERS TO 1M. WITH SAND RUBBLE  
NO GRAPHITE FLOAT. BIOTITE PINK FELDSPAR  
NO GRAPHITE SEEN SEE PICTURE OF CLIP.  
TRENCH LEFT OPEN AT PRESENT  
HEIGHT OF LAND  
WEST OF GRAPHITE BODY IN  
TRENCH - T-11.

5m

DRAWN BY  
C. SHOLINARD.

OVERBURDEN TRENCHING DETAIL, T-7  
CLAIM # 1249723 MARIA TWP. G1387  
SOUTHERN ONTARIO DIV. 5 1/2 LOT 26 CON. OF.  
FOR INDUSTRIAL MINERALS CANADA INC.

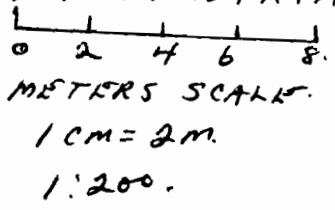

MUD AND  
WATER FLOWING IN  
AT 2 METERS.  
STOPPED.  
HOLE CLOSED  
ON OCT. 22/07.  
NO GRAPHITE  
IN FLOW AT.  
BOULDERS IN SANDY  
SOIL. 30 CM.

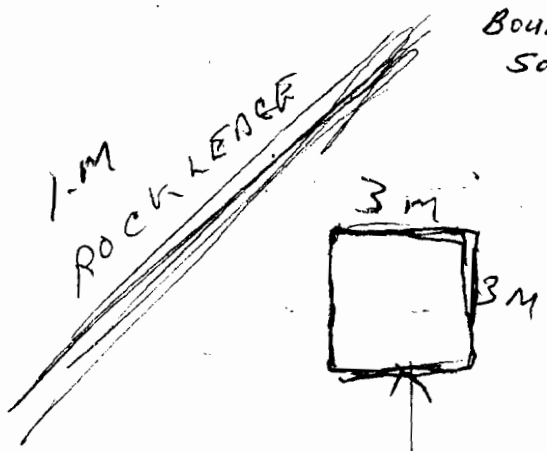

3 x 3 x 2 M AREA.

LOW  
GROUND.

MINERO →

OVERBURDEN TRENCHING DETAIL. T-8; T-9. T-10. (12)

DRAWN BY SHOHINARA.

CLAIM # 1249723 MARIA TWP. G1387  
SOUTHERN ONTARIO DIV. 5 1/2 LOT 26, CONOT.  
FOR INDUSTRIAL MINERALS CANADA INC.

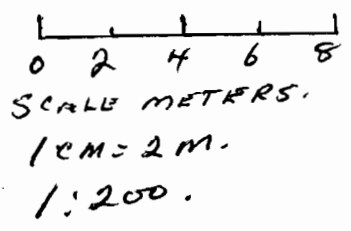

T-10  
0727030E  
5111037N

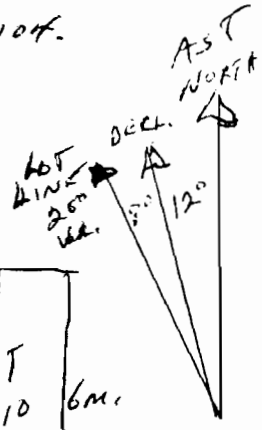
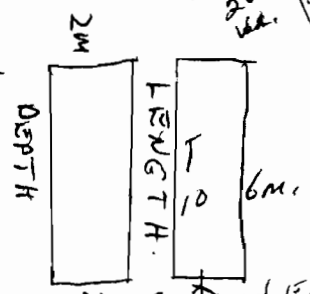

LOGS ACROSS TRENCH FOR SAFETY  
TRENCH 6X2X2 DEEP.  
2M LEFT OPEN  
HIT A SPRING IN ROCK.  
GRAPHITE IN BOTTOM.

19 M.  
QUICK SAMPLE  
39% FINE FLAKE

TO SWAMP.

LOW GROUND AREA

T-8

0727005E  
5111032N  
STOPPED HOLE  
W/ WATER COMING IN

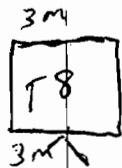

FILLED ON OCT. 22/07.

3x3x2M DEEP.

NO GRAPHITE IN FLOAT

T-9-0727015E  
5111022N

3M 3x3x2M DEEP.

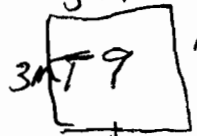

HIT SPRING AT 2M DEPTH.

STOPPED HOLE.  
HYDRAULIC ACTION.  
IN BASAL CLAY.  
NO BEDROCK.

FILLED ON OCT. 22/07.

NO GRAPHITE IN FLOAT

WSB

SMALL FLAT OUTCROP OF GRAPHITE ON ROAD.  
MINER ROAD.

OVERBURDEN TRENCHING DETAIL, T-11.

12

DRAWN BY  
H SHOHINARD.

CLAIM # 1249723 MARIA TWP. G1387  
SOUTHERN ONTARIO DIV. S<sup>1</sup>/<sub>2</sub> LOT 26, CON 04.  
FOR INDUSTRIAL MINERALS CANADA INC.

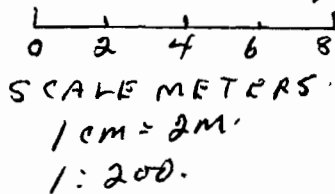

← MINE ROAD →

DANGER TAPE  
ACROSS FOR  
SAFETY.

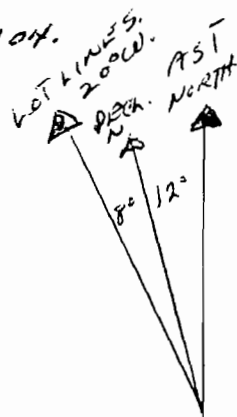

15m. TO MINE RD. →

EXCAVATOR TRAIL.

25m. EAST 90°

5% - 6% FLAKE GRAPHITE LARGER FLAKE  
SAMPLE TAKEN HERE ⊗ THIN TAPE

PICTURE  
TAKEN  
HERE

T-11 25x2m x 8m DEEP.  
0727034E

5110990M  
DUG OUT ON OCT 20/2007.  
LEFT OPEN.

FOR NOW.  
1M OVERBURDEN  
DUG THROUGH 1M OF  
DETERIORATED CAP  
ROCK. GETTING MORE  
SOLID NEAR BOTTOM  
OF TRENCH. SOIL IS  
RUBBLE ON FIRST 1M.

BELOW 1M SOIL IS  
PURE DETERIORATED

IRON OXIDE WITH HIGH  
FLAKE GRAPHITE CONTENT.

FROM FREEZE ACTION AT WATER TABLE

15m. ON

2m

TO T-12 →

# OVERBURDEN TRENCHING DETAIL, T-12

DRAWN BY  
GUY SHONIMARD.

CLAIM # 1249723 MARIA TWP. G1387  
SOUTHERN ONTARIO DIV. S 1/2 LOT 26 CONOF.  
FOR INDUSTRIAL MINERALS CANADA INC.

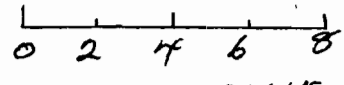

METERS SCALE.

1 CM = 2 M.

1:200

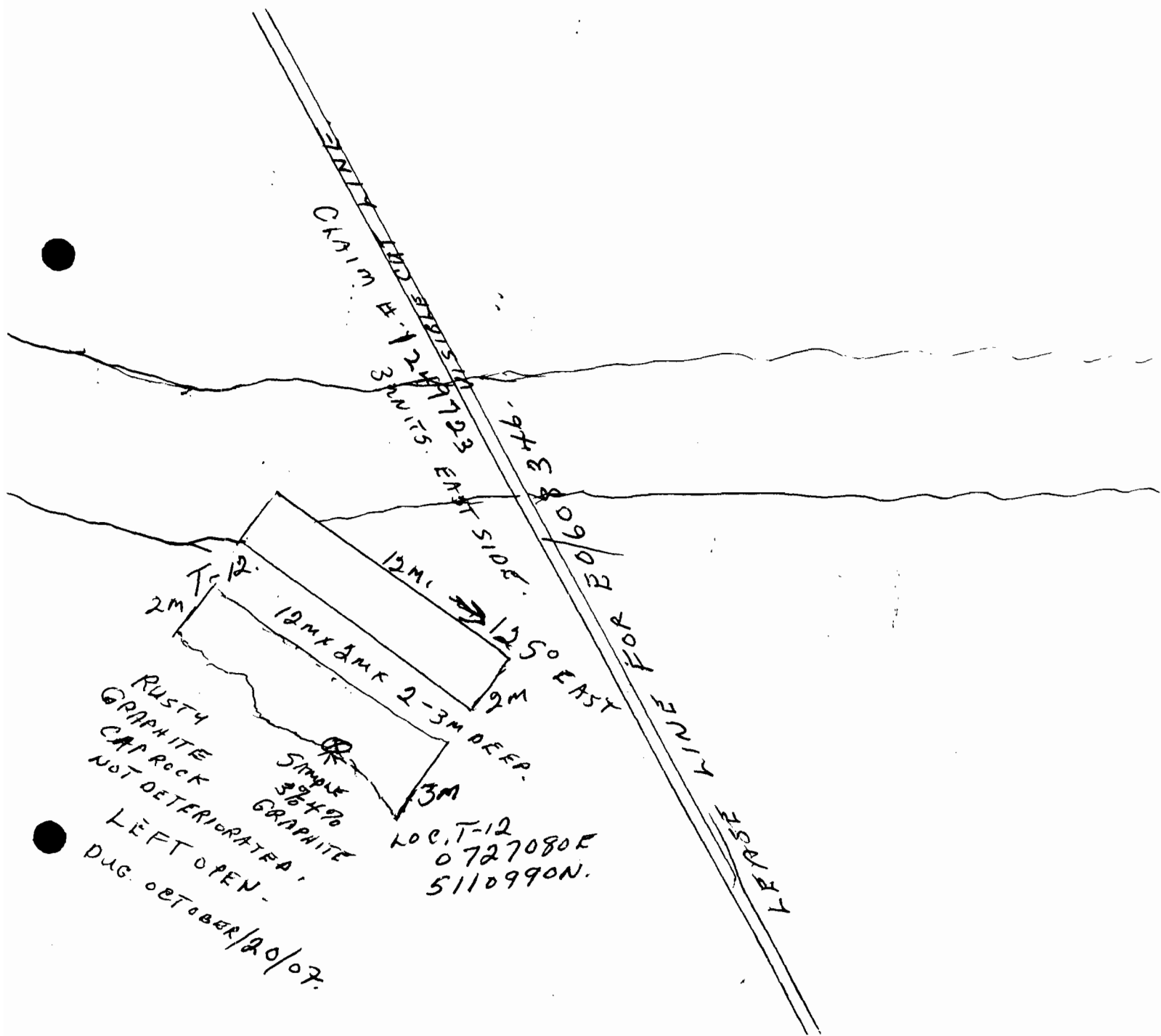
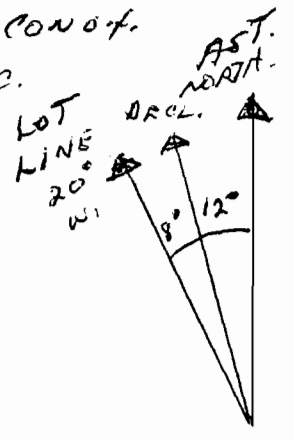

STRIPPING LOCATIONS FOR DAY 3 OF PROJECT  
OCTOBER 21, 2007

X= LOCATION BY G.P.S./N.A.D. 83  
PLACED ON MAIN LOCATION MAP ON LEASE EO608346

T-13= 0727089E/5110991N

T-14= 0727131E/5111016N

T-15= 0727113E/5111011N

T-16= 0727101E/5111030N

T-17=0727092E/5111043N

5

DRAWN BY

CUY SHOUINARO

OVERBURDEN TRENCHING DETAIL T-13.  
LEASE E0608346 MARIATWP. G-1387  
SOUTHERN ONTARIO DIV. S 1/2 LOT 25. CONO 4  
FOR INDUSTRIAL MINERALS CANADA INC.

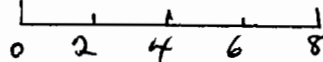

METRES SCALE

1cm = 2m.

1:200.

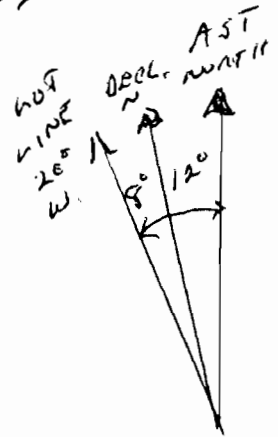

HEIGHT OF  
LAND.  
5' M'  
ABOVE TRENCH.

TRENCH DUG OCT. 21/07.  
LEFT OPEN. 0727089E  
T13. 511099N.

LARGE  
FLAKE  
GRAPHITE  
BEARING  
BEDROCK  
QUARTZITE.  
3%.  
SPOTS OF  
AMPHIBOLIS  
GRAPHITE.



CLAIM #

1249723

3 UNITS

EXCAVATOR TRAIL.



200 WEST OF T.N.  
E0608346

5

DRAWN BY

GUY SHOHINARO

OVERBURDEN TRENCHING DETAIL T-14  
 LEASE E0608346 MARIATWP. G-1387  
 SOUTHERN ONTARIO DIV.  
 FOR INDUSTRIAL MINERALS CANADA INC.

0 2 4 6 8  
 METERS SCALE  
 1CM = 1M  
 1:200



HEIGHT OF  
 BANK.

OVERBURDEN  
 ROCK LEAVE 2M MINOR GRAPHITE  
 CONTACT OR CAP ROCK?



LEFT OPEN.  
 SOME PIECES  
 OF GRAPHITE FLOAT.

← 90° →  
 EAST.

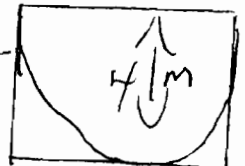
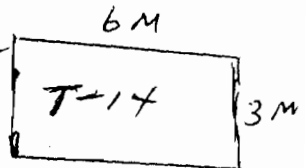

LOC. 0727131E  
 S11101N.

GRAVEL  
 1" FINE TO  
 MEDIUM 6"  
 NO BEDROCK



(5)

DRAWN BY  
GUY SHOHINARD

OVERBURDEN TRENCHING DETAIL T-15  
LEASE E0608346 MARIATWP. G-1397  
SOUTHERN ONTARIO DIV. S 2 1/2 LOT 25 CON 04  
FOR INDUSTRIAL MINERALS CANADA INC.

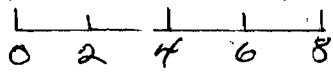

METERS SCALE

1 CM = 2 M.

1:200.

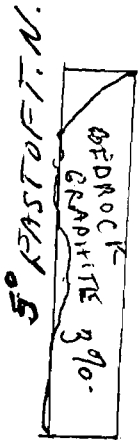
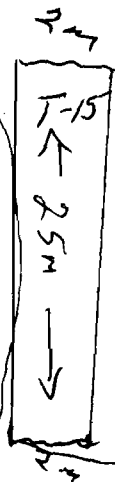
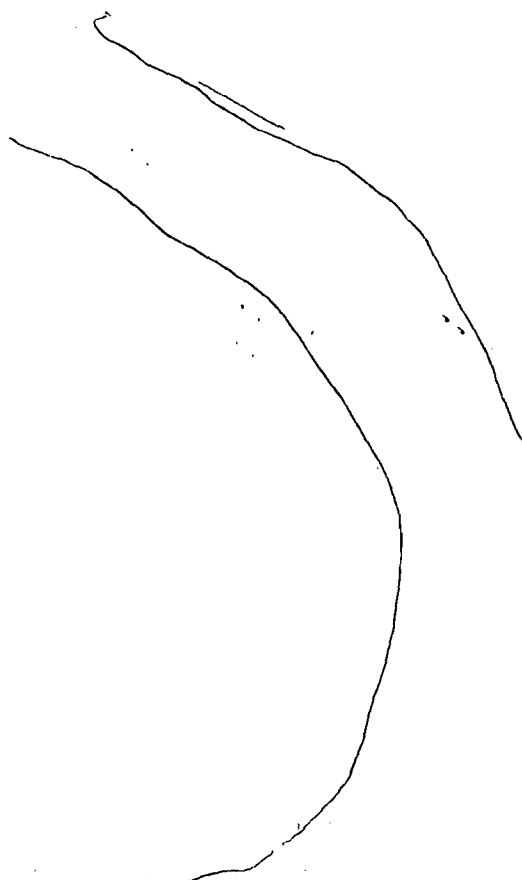
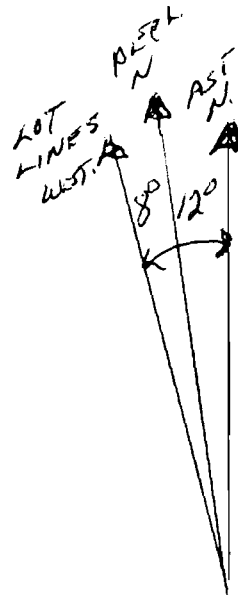

LOC.  
0727113E  
511101N.  
BROWN SAND  
1M

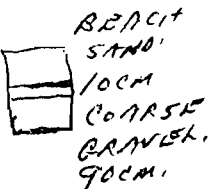

LEFT OPEN  
DUG ON OCT. 21/07

GRAPHITE BEARING  
FINE GRAIN EST 3%.

EXCAVATOR TRAIL

(5)

DRAWN BY  
GUY SHOHIN TRO.

OVERBURDEN TRENCHING DETAIL. T-16  
LEASE E0608346 MARIATWP. G-1387  
SOUTHERN ONTARIO DIV.  
FOR INDUSTRIAL MINERALS CANADA INC.

0 2 4 6 8  
METERS SCALE  
1 CM = 2 M  
1:200.

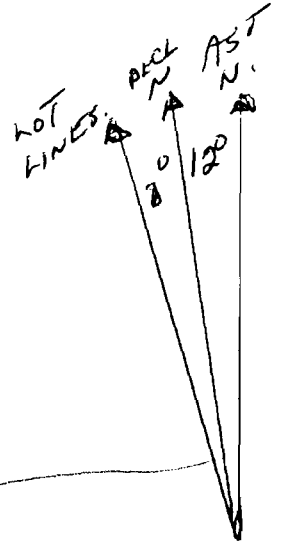

AUG. ON OCT. 21/07.  
0727101E  
5111030N

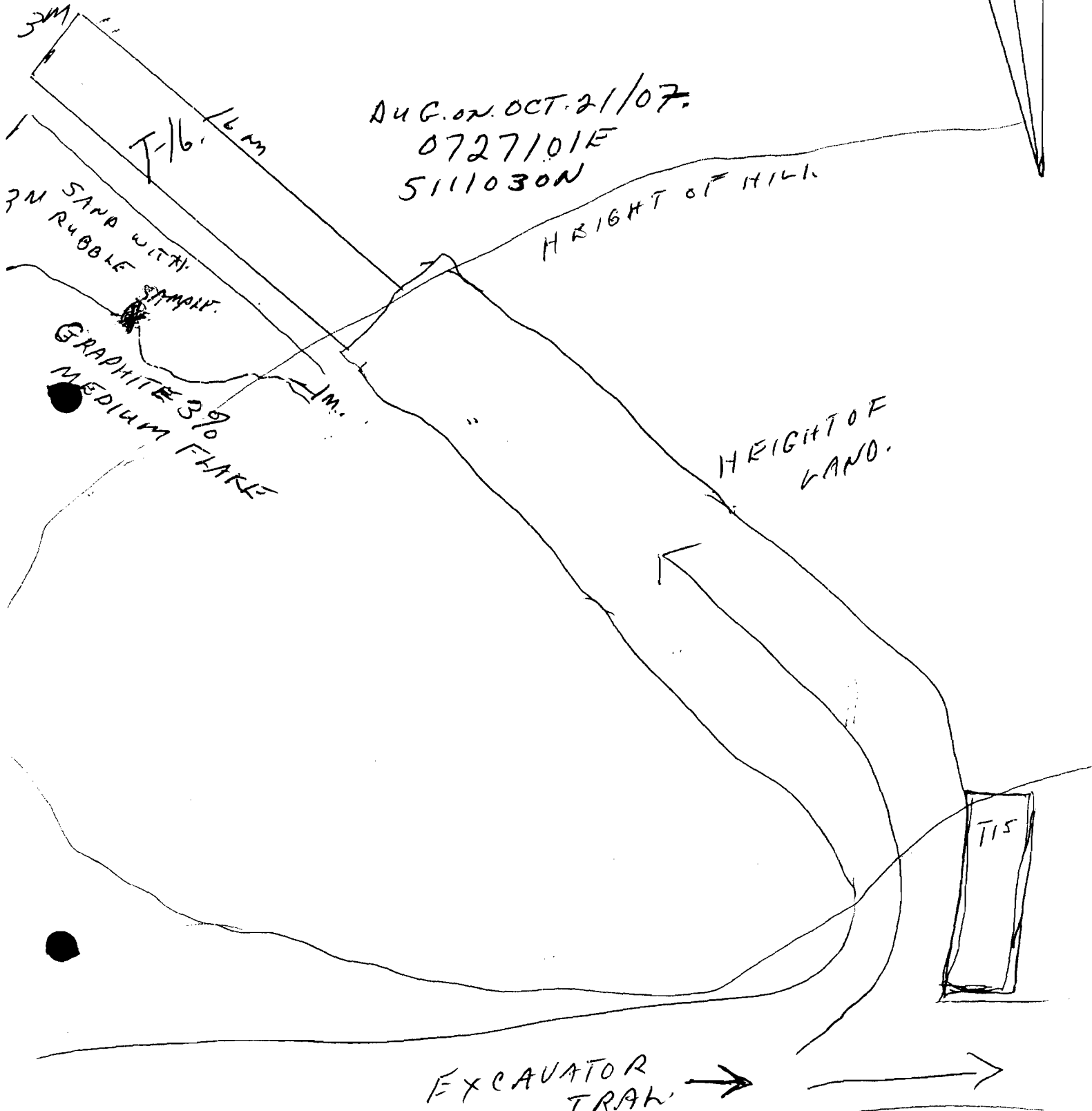

(5)

DRAWN BY

GUY SHOHINARD

OVERBURDEN TRENCHING DETAIL T-17  
 LEASE E0608346 MARIATWP. G-1387  
 SOUTHERN ONTARIO DIV. 5 1/2 LOT 25 CONO#4  
 FOR INDUSTRIAL MINERALS CANADA INC.

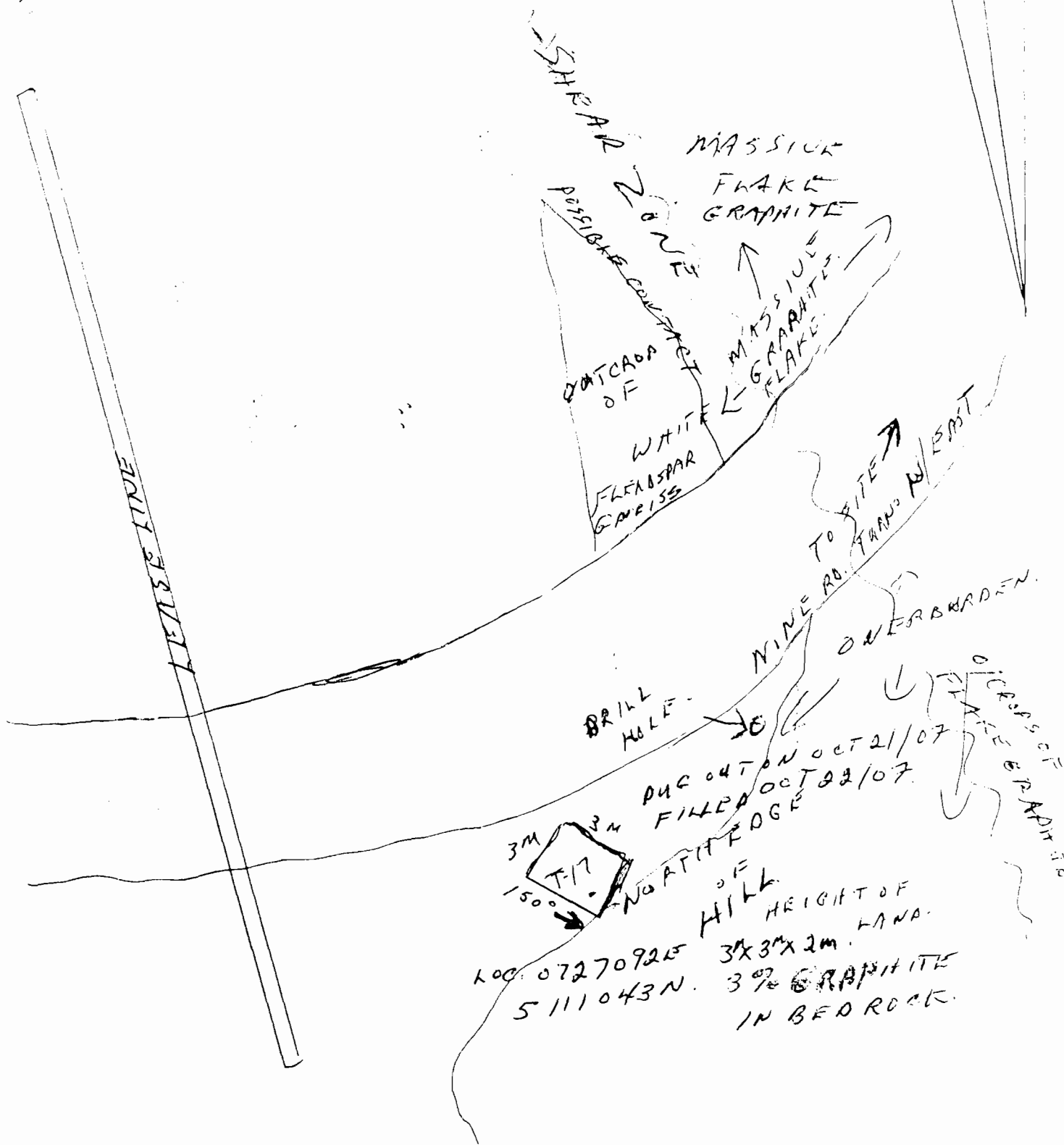
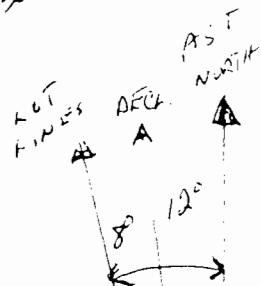
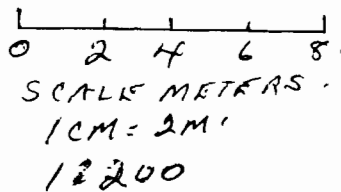



MINE ROAD  
AT BUSHRO  
SOUTH.  
LOOKING  
EAST



T //

E - W





TII

SOUTH.

INTERSECT.



T-16.



T-11  
DAY  
AFTER  
TRENCH

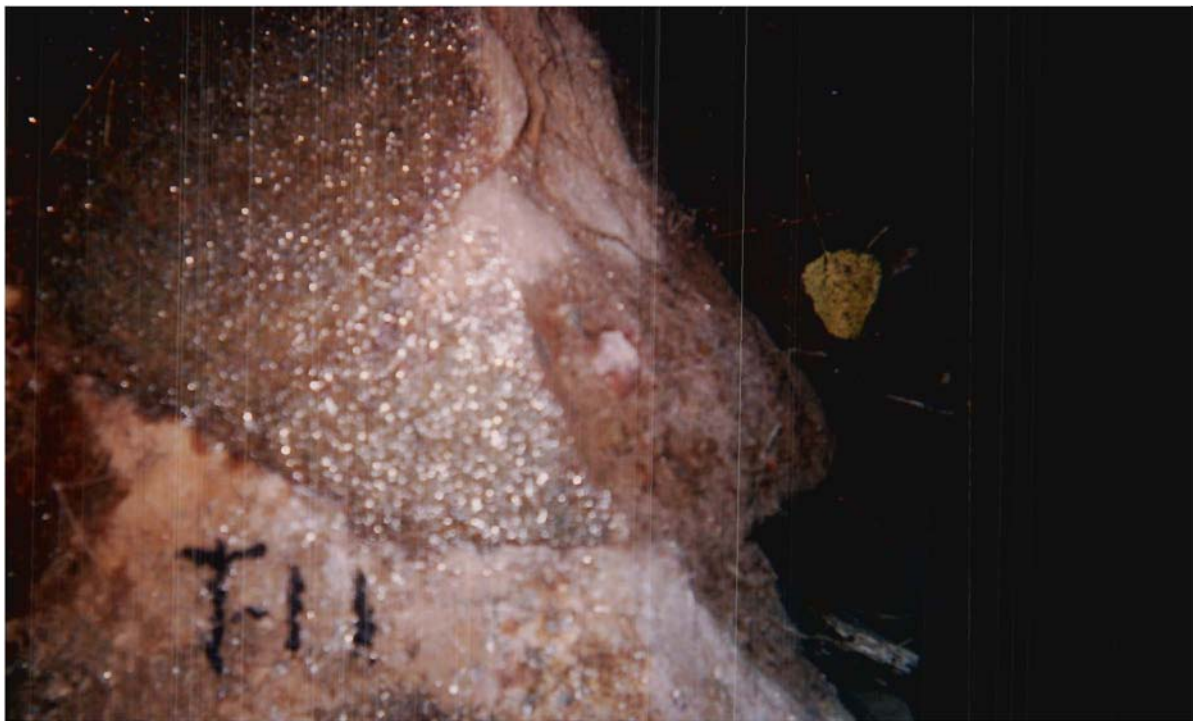

GOOD GRADE  
FLAKE GRAPHITE  
INT.-11  
5%+





T-4



T-5.



TRAIL TO  
T-6.



T-15.





76P.

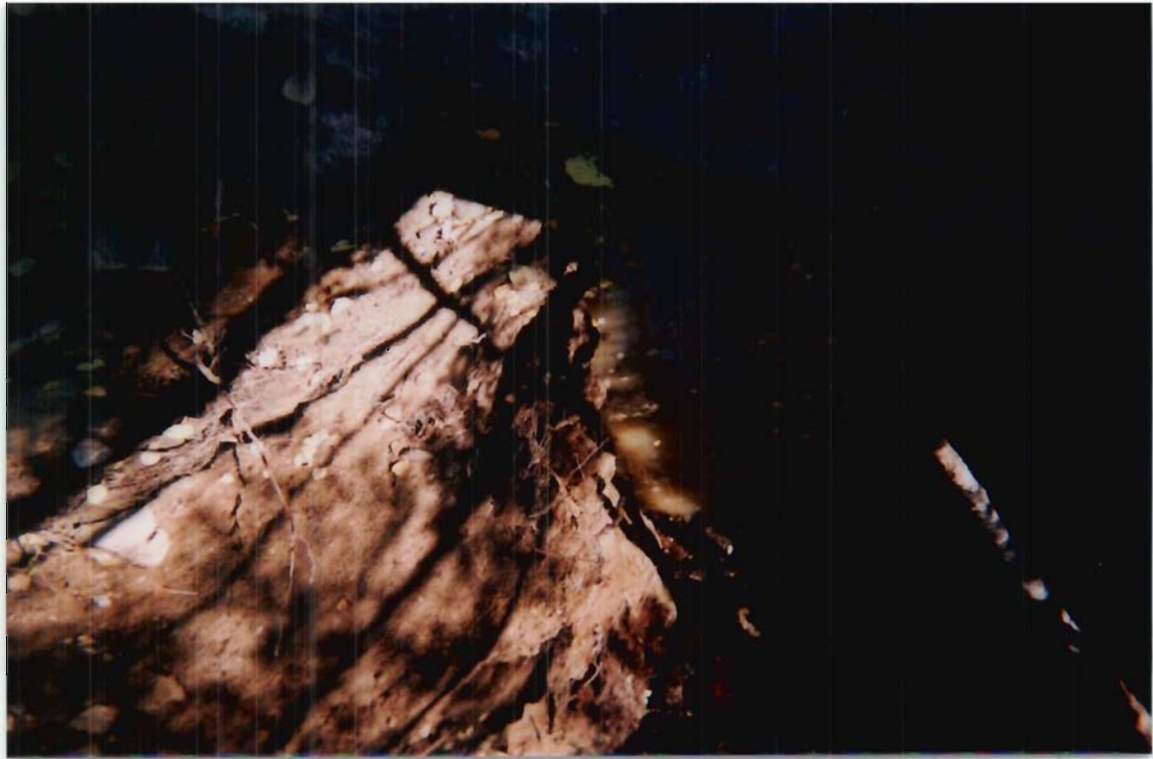

↓ T-9.



T-1



T-9.