

Prospecting Report

2007

Claim 4205130

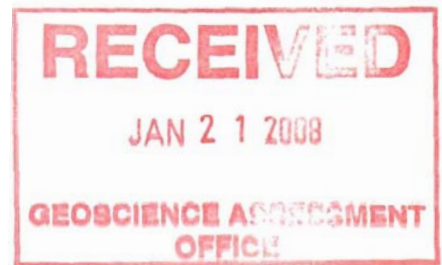

January 18, 2008

by

Alex Glatz

2 • 36898

Name: Claim 4205130 Gold project

Claim: 4205130, held by Alex Glatz of Dryden

Access: Located in Audrey Twp., Lot 2 Con II about 12 kilometres SW of Dryden, it can be reached via Hwy. 594 and Hwy. 502.

History: The claim is located at the west end of the old “Dryden Gold Fields” where many shafts have been sunk more than one hundred years ago.

Target: Gold

Geology: Regional – The area south of Dryden is underlain by the Lower Wabigoon Volcanics (Trowel et al 1980).

The project area exhibits rocks of felsic and intermediate composition which are intruded by at least two QFP dikes.

Prospecting:

Recent prospecting consisted mainly of mapping the mineralized tuff and to find new rock outcroppings. It was found that the volcanic rock strike in an ENE direction whereas the QFP strike in a NW direction. The tuff formation carries sulfide along the shear planes. The sulfide consists mainly of cubed pyrite.

The amount of sulfide of sulfide has no relation to the gold content. The limited sampling suggests that the gold is related to quartz or silicified zones rather than the softer carbon-rich rock.

Conclusion and recommendations

Further work in the form of mechanical stripping to expose the boundary of the quartz-stockwork is recommended.



Established 1928

Swastika Laboratories Ltd

Assaying - Consulting - Representation

Geochemical Analysis Certificate

7W-3925-RG1

Company: A. GLATZ

Date: JAN-10-08

Project:

Attn: A. Glatz

We hereby certify the following Geochemical Analysis of 25 Rock samples submitted DEC-05-07 by .

Sample Number	Au PPB	Au Check PPB
0883	Nil	-
0884	Nil	-
0885	Nil	Nil
0886	Nil	-
0887	1461	-
0888	117	-
0889	219	-
0890	641	-
0891	106	-
0892	39223	29829
0893	219	-
0894	Nil	-
0895	178	-
0896	Nil	-
0897	483	-
0898	528	-
0899	Nil	-
0900	17	-
0901	10	-
0902	7	-
0903	Nil	-
0904	51	-
0905	82	65
0906	9532	-
0907	26743	-
Blank	Nil	-
STD OXK48	3518	-

Certified by 

1 Cameron Ave., P.O. Box 10, Swastika, Ontario P0K 1T0
 Telephone (705) 642-3244 Fax (705) 642-3300

Sample Summary for Claim 4205130

Claim #	Sample #	Sample Type	Lithology	Mineral	Au ppb
4205130	903	2m chip	sheared tuff		1%nil
4205130	904	2m chip	altered intermediate	1 - 4 % sulf	51
4205130	905	2m chip	sheared felsic tuff	10 % sulfid	82
4205130	906	grabs	tuff & quartz stockwork	Q, 3% sulf	9532
4205130	907	loose piece	pce of mineralized tuff	5% sulfide	26743

Date	Claim	Work Description	Sampl/Truck taken km	Milage \$	boat canoe \$	ATV \$	Lunch \$	Persons working	Days X \$150
71108	4205130	traversed claim south of road	3	25	\$10.00				
71108	4205130	traversed north part and centre of c few outcrops found	2	25	\$10.00				

400 M

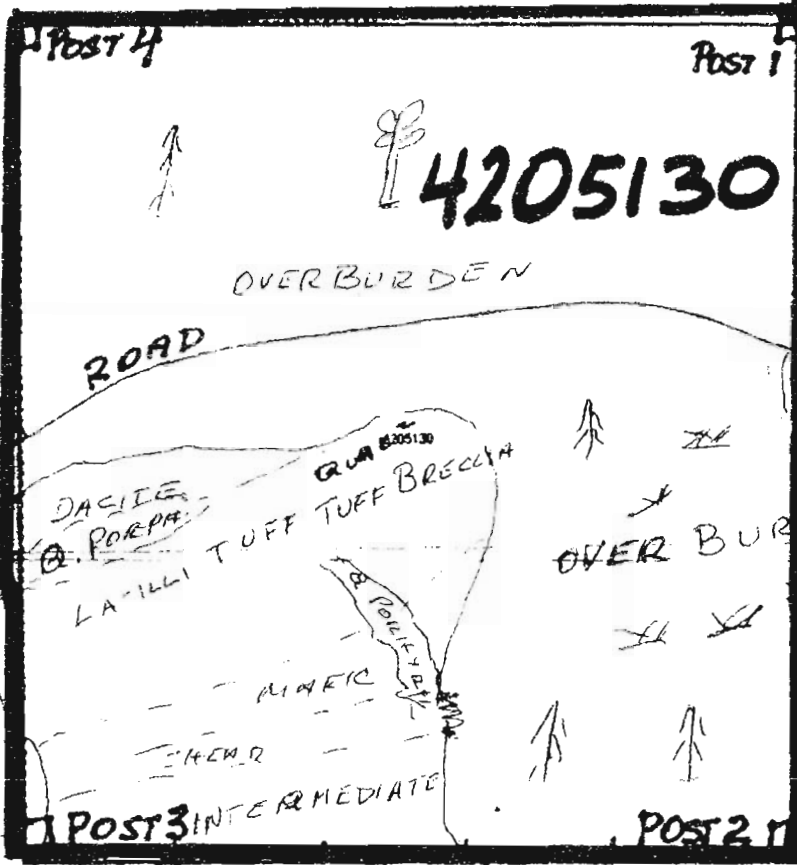

4806160

SCALE: 80 M 1:3500

AUBREY TWP. LOT 2, CON. I

110

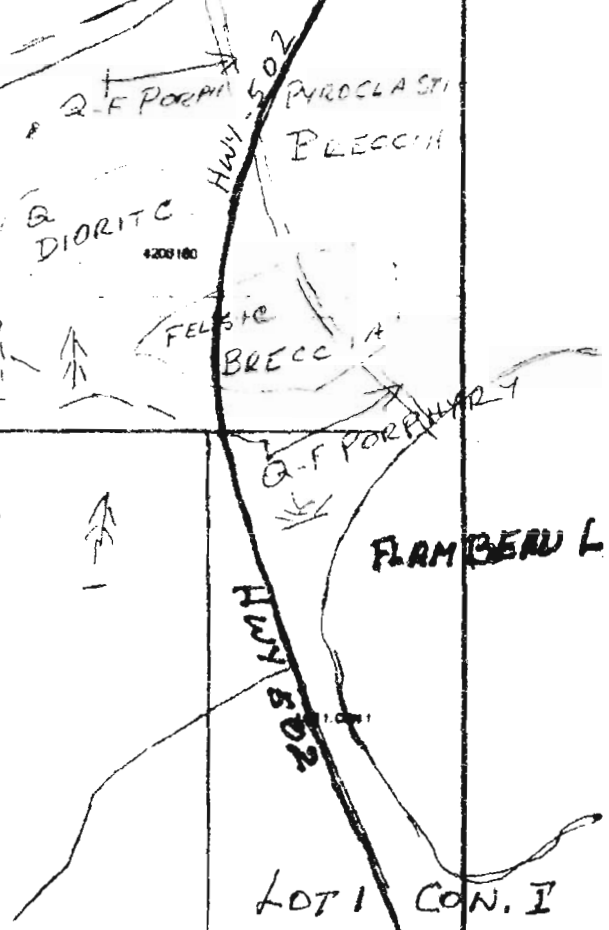

LOT 1 CON. I

