

SURVEY SPECIFICATIONS:
 Survey date: September 3 - 11, 2007
 Survey base: Timmins, Ontario
 Aircraft: Astar 350-FX2 helicopter, Registration C-FXJU
 Nominal Flight Line Spacing: 75 metres
 Nominal Tie Line Direction: N0°E
 Nominal Tie Line Spacing: 750 metres
 Nominal Tie Line Direction: N90°E
 Nominal helicopter terrain clearance: 75 metres
 EM Loop is 40 metres under helicopter
 Magnetic sensor is 15 metres under helicopter

INSTRUMENTS:
 Geotech Time Domain Electromagnetic System (VTEM) with concentric Rx/Tx geometry
 Transmitter Loop Diameter 26 m, Base Frequency 30 Hz
 Dipole Moment: 441,700 N/A
 Transmitter Wave Form: Trapezoid, Pulse Width 7.2 ms
 Geometrics Optically-pumped,
 High Sensitivity Cesium Magnetometer
 Magnetometer Resolution 0.02 nT at 10 samples/sec

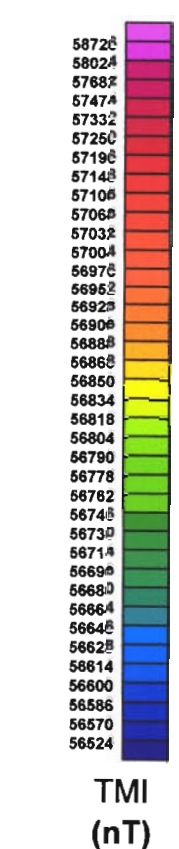

contour intervals:
 2 nT
 5 nT
 50 nT

- Legend:**
- Roads
 - Lakes, Rivers
 - Power lines
 - Railways
 - Swamps
 - Topographic contours
 - Property claims
 - ◆ Buildings and industrial areas

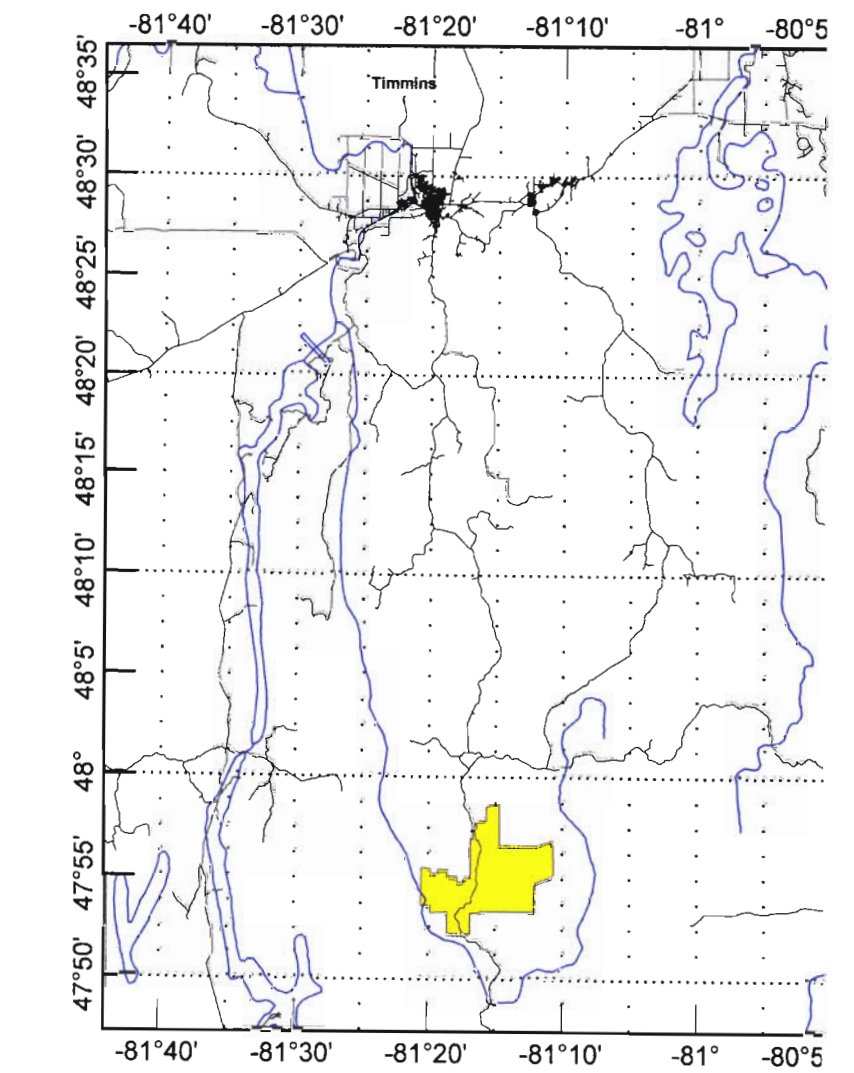

RECEIVED
 FEB 13 2008
 GEOSCIENCE ASSESSMENT OFFICE

Scale 1:20000
 (metres)
 NAD83/UTM Zone 18N

SEDEX Mining Corp.
 Serpentine Nickel block
 Ontario, Canada

Geotech VTEM System
 Total Magnetic Intensity Map

Flown and processed by Geotech Ltd.
 30 Industrial Parkway South,
 Aurora, Ontario, Canada L4G 3W2
 www.geotechairborne.com

October 2007

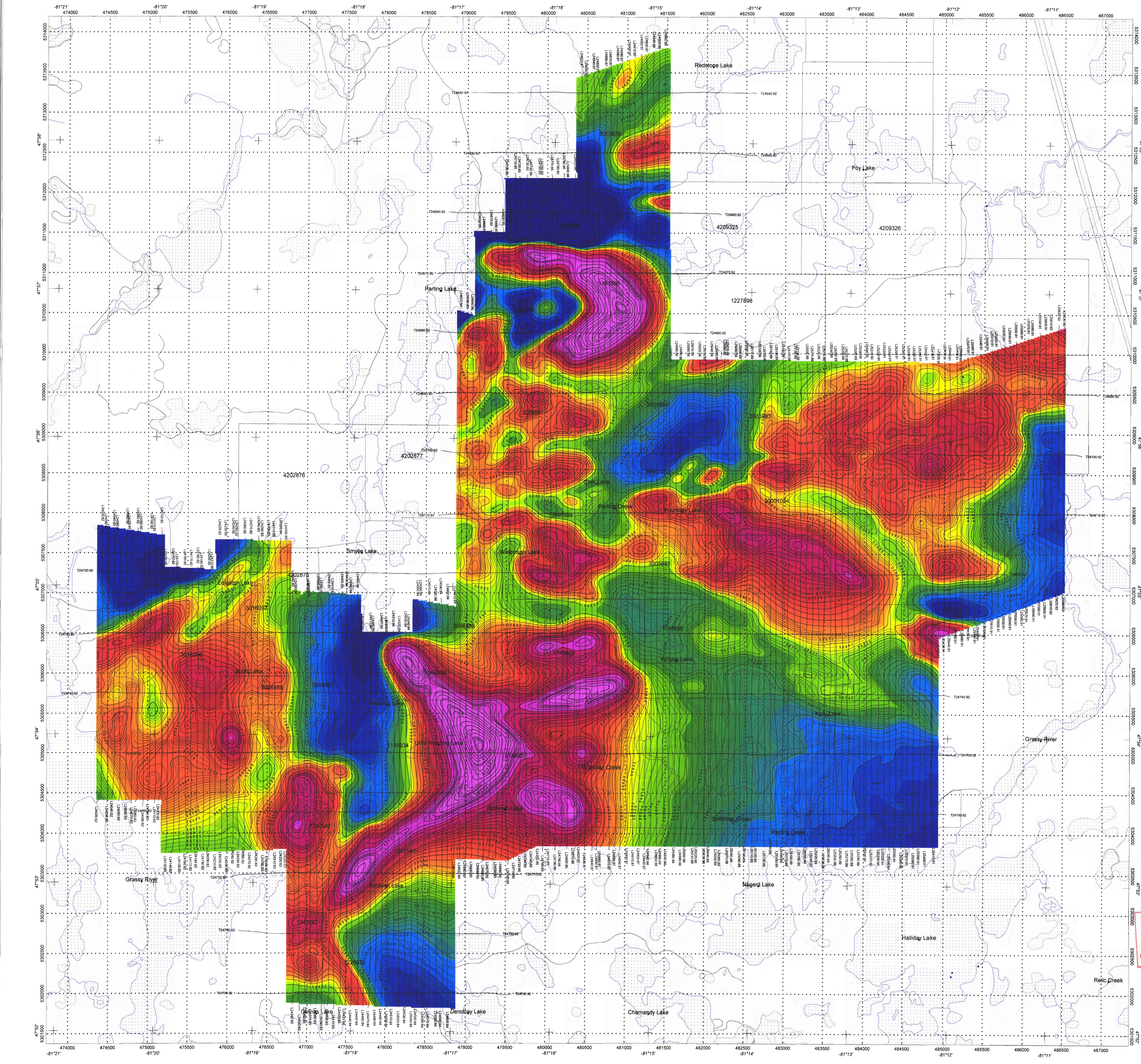

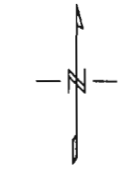

SURVEY SPECIFICATIONS:
 Survey date: September 3 - 11, 2007
 Survey base: Timmins, Ontario
 Aircraft: Astar 350-FX2 helicopter, Registration C-FXU
 Nominal Flight Line Spacing: 75 metres
 Nominal Flight Line Direction: N0°E
 Nominal Tie Line Spacing: 750 metres
 Nominal Tie Line Direction: N90°E
 Nominal helicopter terrain clearance: 75 metres
 EM Loop is 40 metres under helicopter
 Magnetic sensor is 15 metres under helicopter
INSTRUMENTS:
 Geotech Time Domain Electromagnetic System (VTEM)
 with concentric Rx/Tx geometry
 Transmitter Loop Diameter 26 m, Base Frequency 30 Hz
 Dipole Moment: 441,700 NIA
 Transmitter Wave Form: Trapezoid, Pulse Width 7.2 ms
 Geometrics Optically-pumped,
 High Sensitivity Cesium Magnetometer
 Magnetometer Resolution 0.02 nT at 10 samples/sec

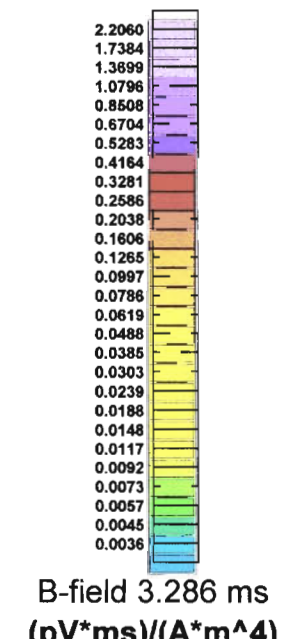

contour intervals:
 0.01 $(pV*ms)/(A*m^4)$
 0.05 $(pV*ms)/(A*m^4)$
 0.20 $(pV*ms)/(A*m^4)$

Legend:
 Roads
 Lakes, Rivers
 Power lines
 Railways
 Swamps
 Topographic contours
 Property claims
 Buildings and industrial areas

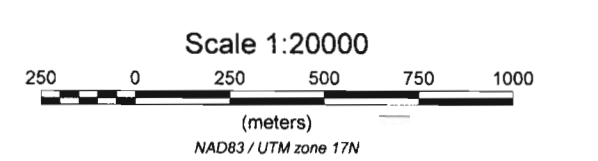
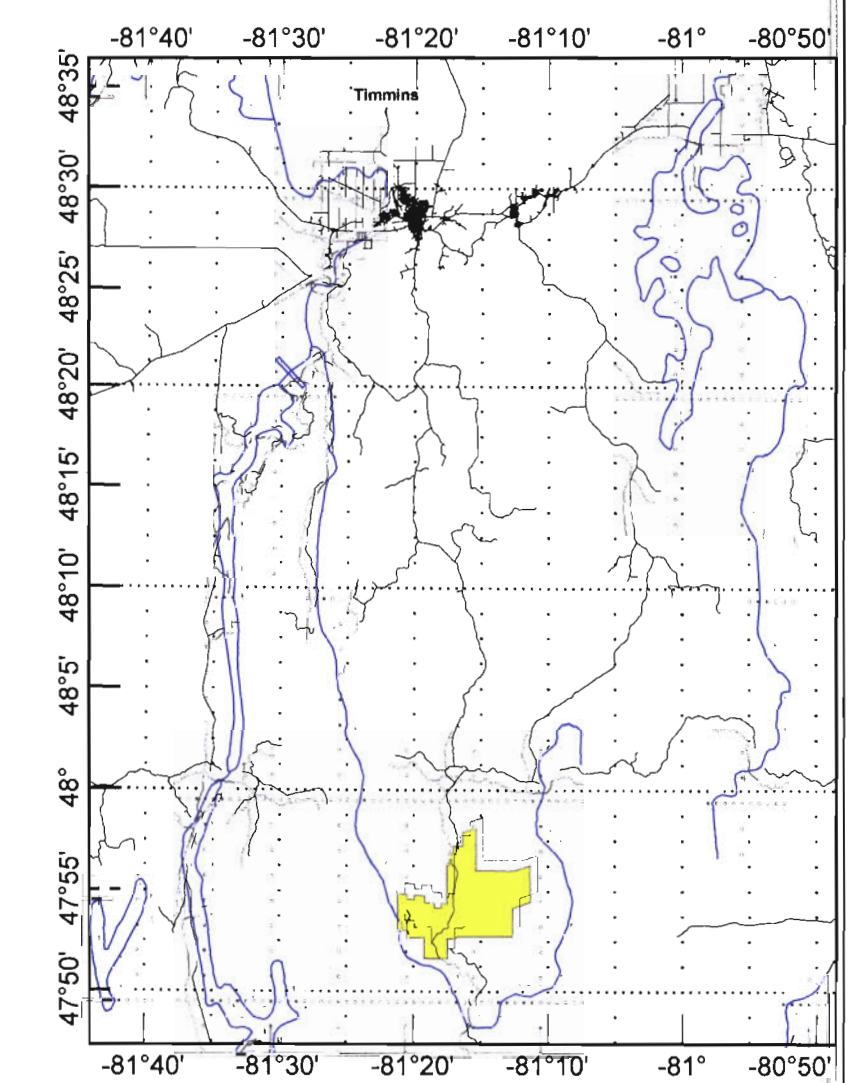

SEDEX Mining Corp.
 Serpentine Nickel block
 Ontario, Canada
 Geotech VTEM System
 B-Field Time channel 3.286 ms
 Flown and processed by Geotech Ltd.
 30 Industrial Parkway South,
 Aurora, Ontario, Canada L4G 3W2
 www.geotechairborne.com
 October 2007

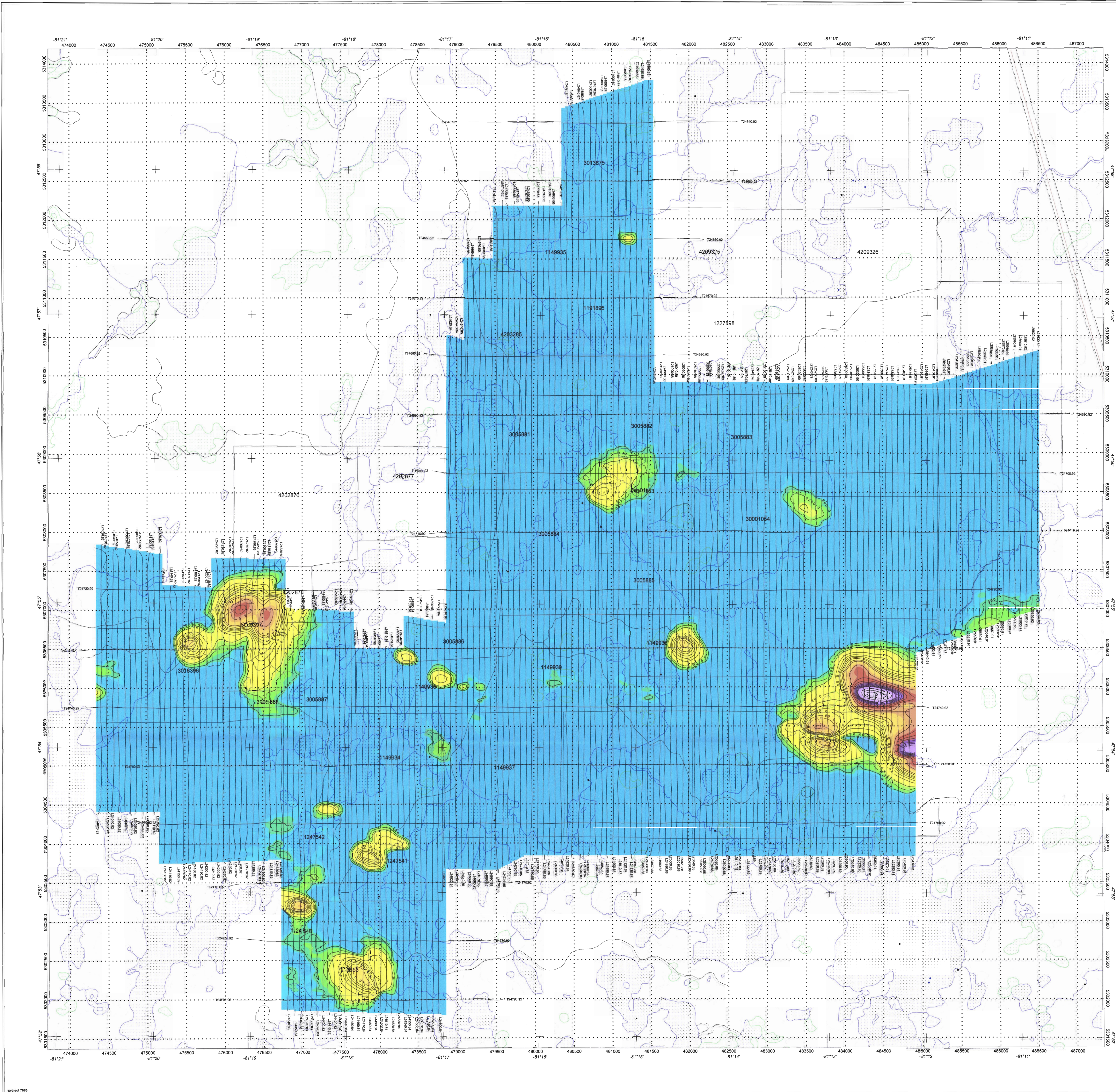

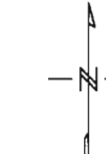

SURVEY SPECIFICATIONS:
 Survey date: September 3 - 11, 2007
 Survey base: Timmins, Ontario
 Aircraft: Astar 350-FX2 helicopter, Registration C-FXU
 Nominal Flight Line Spacing: 75 metres
 Nominal Flight Line Direction: N0°E
 Nominal Tie Line Spacing: 750 metres
 Nominal Tie Line Direction: N90°E
 Nominal helicopter terrain clearance: 75 metres
 EM Loop is 40 metres under helicopter
 Magnetic sensor is 15 metres under helicopter

INSTRUMENTS:
 Geotech Time Domain Electromagnetic System (VTEM)
 with concentric Rx/Tx geometry
 Transmitter Loop Diameter 26 m, Base Frequency 30 Hz
 Dipole Moment: 441,700 N/A
 Transmitter Wave Form: Trapezoid, Pulse Width 7.2 ms
 Geometrics Optically-pumped,
 High Sensitivity Cesium Magnetometer
 Magnetometer Resolution 0.02 nT at 10 samples/sec

Profiles scale 1 mm = 0.1 (pV*ms)/(A*m⁴)
 (Linear between +/-0.4 (pV*ms)/(A*m⁴)
 logarithmic above 0.4 (pV*ms)/(A*m⁴)

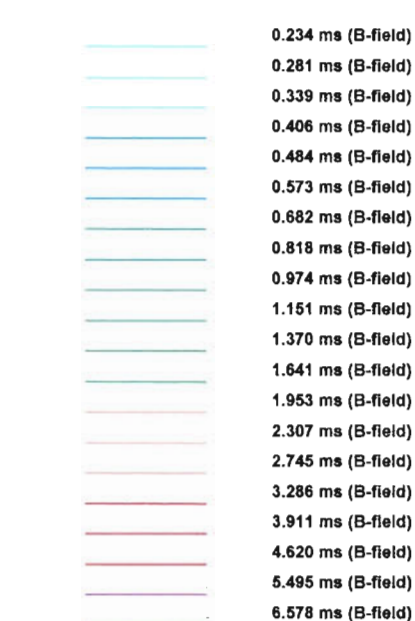

Legend:

- Roads
- Lakes, Rivers
- Power lines
- Railways
- Swamps
- Topographic contours
- Property claims
- ◆ Buildings and industrial areas

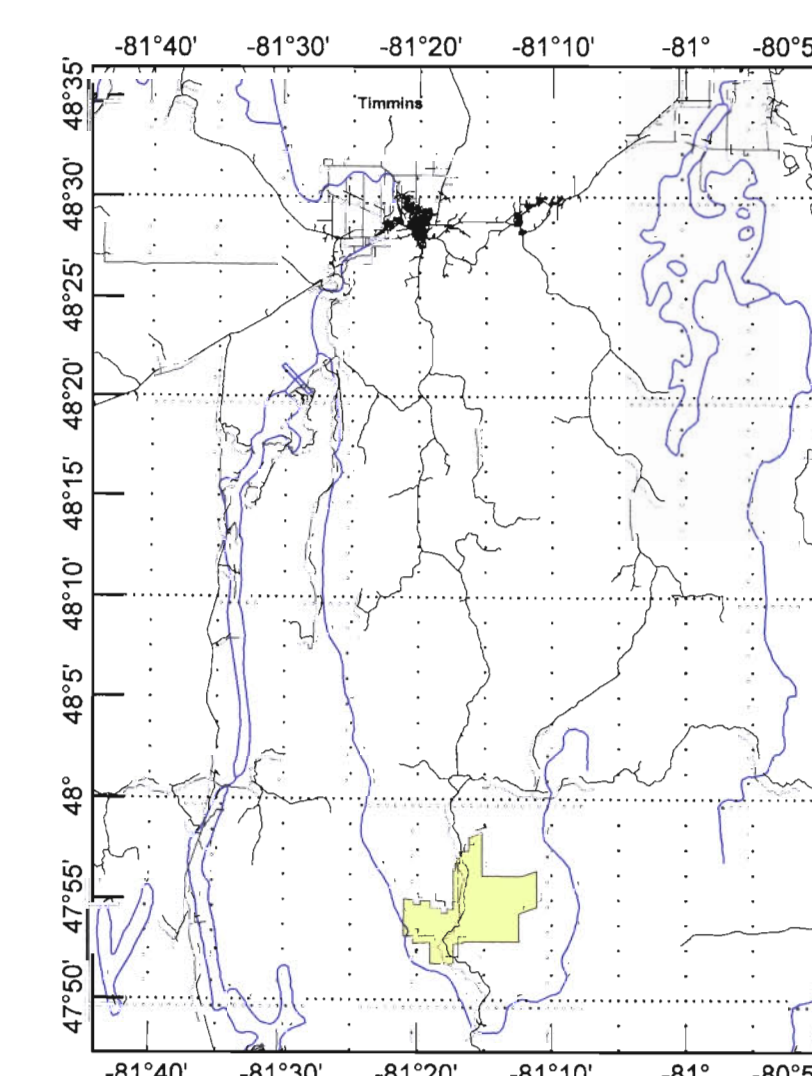

Scale 1:20000
 0 250 500 750 1000
 (meters)
 NAD83/UTM zone 17N

SEDEX Mining Corp.
 Serpentine Nickel block
 Ontario, Canada

Geotech VTEM System
 B-Field Profiles
 Time Channels 0.234 - 6.578 ms

Flown and processed by Geotech Ltd.
 30 Industrial Parkway South,
 Aurora, Ontario, Canada L4G 3W2
 www.geotechairborne.com

October 2007

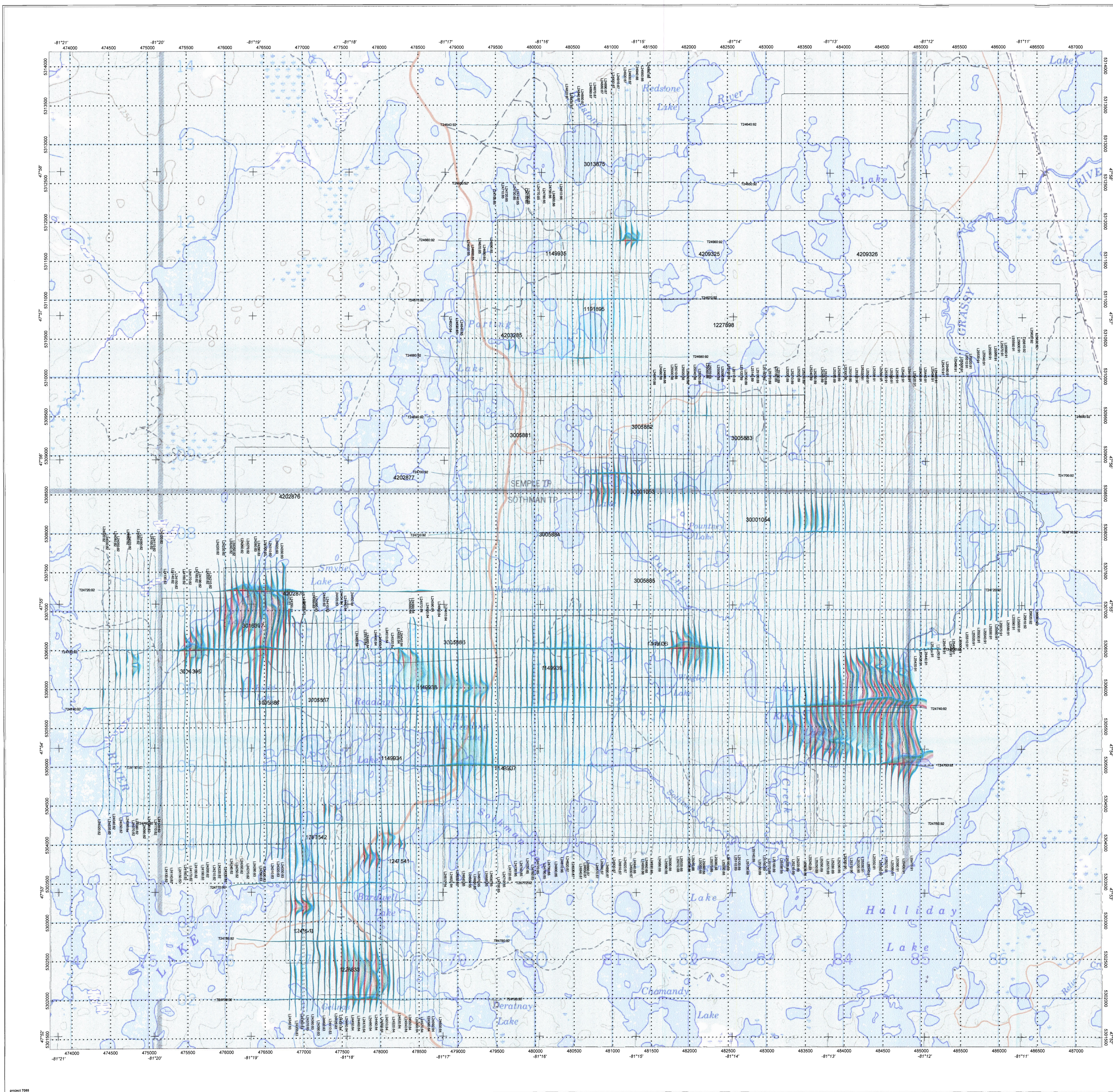

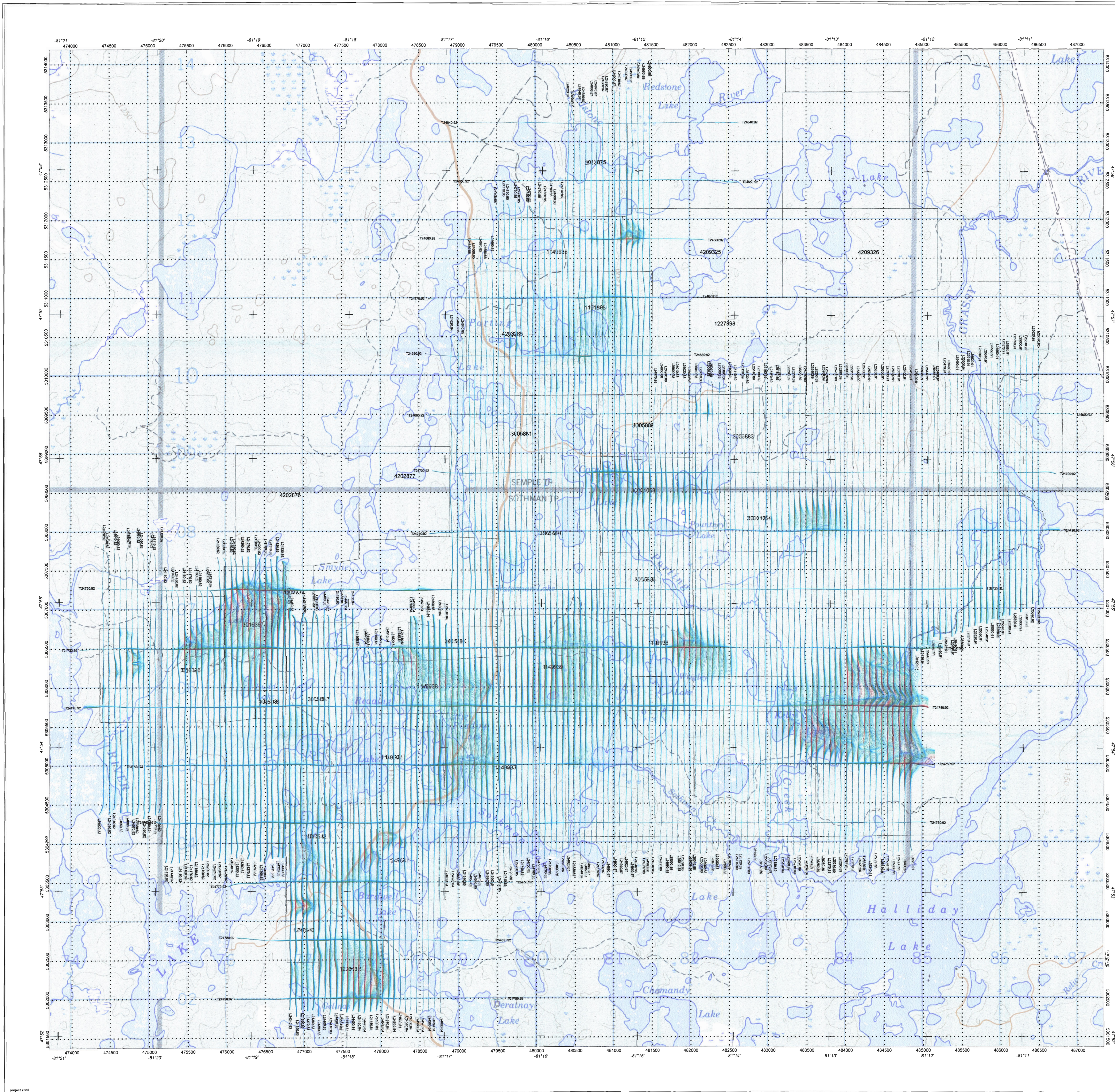

SURVEY SPECIFICATIONS:
 Survey date: September 3 - 11, 2007
 Survey base: Timmins, Ontario
 Aircraft: Astar 350-FX2 helicopter, Registration C-FXFU
 Nominal Flight Line Direction: N0°E
 Nominal Tie Line Spacing: 750 metres
 Nominal Tie Line Direction: N90°E
 Nominal helicopter terrain clearance: 75 metres
 EM Loop is 40 metres under helicopter
 Magnetic sensor is 15 metres under helicopter

INSTRUMENTS:
 Geotech Time Domain Electromagnetic System (VTEM) with concentric Rx/Tx geometry
 Transmitter Loop Diameter: 28 m, Base Frequency 30 Hz
 Dipole Moment: 441,700 N/A
 Transmitter Wave Form: Trapezoid, Pulse Width 7.2 ms
 Geometrics Optically-pumped,
 High Sensitivity Cesium Magnetometer
 Magnetometer Resolution 0.02 nT at 10 samples/sec

Profiles scale 1 mm = 0.1 pV/A/m⁴
 (Linear between +0.4 pV/A/m⁴
 logarithmic above 0.4 pV/A/m⁴)

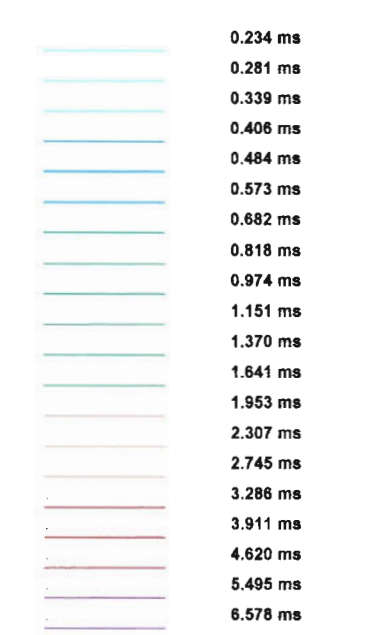

Legend:
 Roads
 Lakes, Rivers
 Power Lines
 Railways
 Swamps
 Topographic contours
 Property claims
 Buildings and industrial areas

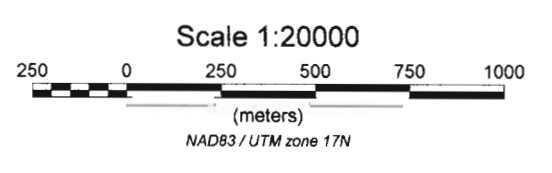
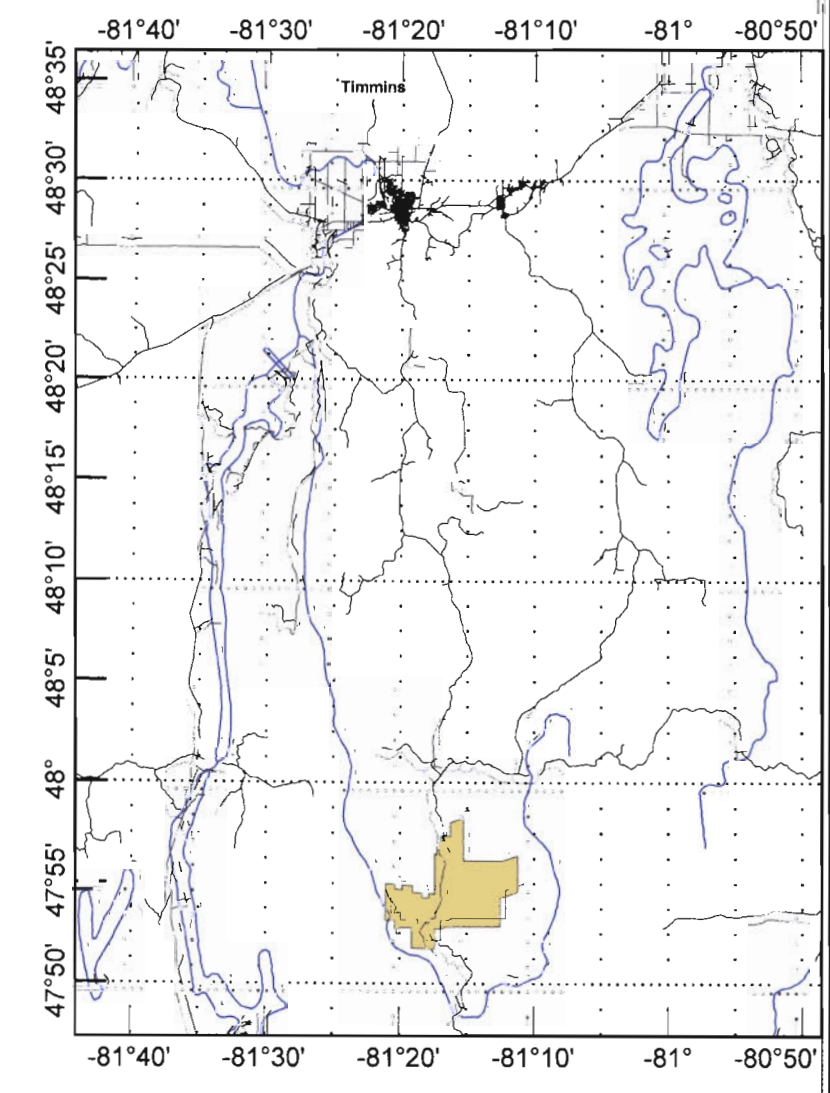

SEDEX Mining Corp.
 Serpentine Nickel block
 Ontario, Canada

Geotech VTEM System
 dB/dt Profiles
 Time Channels 0.234 - 6.578 ms

Flown and processed by Geotech Ltd.
 30 Industrial Parkway South,
 Aurora, Ontario, Canada L4G 3W2
 www.geotechinc.com

October 2007