

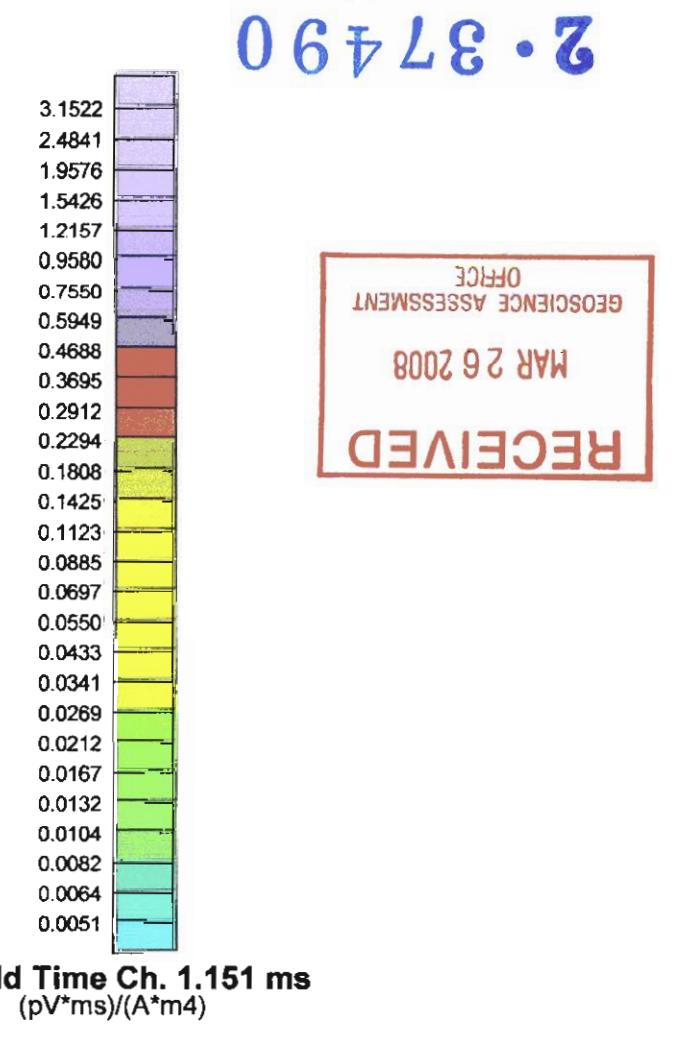

SURVEY SPECIFICATIONS:
 Survey Date: January 8th to 22nd, 2008
 Survey Base: Lost Lake, Ontario
 Aircraft: Aerospaciale Atlas 300 FX-2 (C-PRW)
 Nominal Survey Line Spacing: 100 Meters
 Nominal Survey Line Direction: N 0° E
 Nominal Line Spacing: 1000 Meters
 Nominal Line Direction: N 90° E
 Nominal Terrain Clearance: 45 Meters
 EM Loop: Towed 42 meters beneath the Helicopter
 Magnet: Sensor Towed 15 meters under the Helicopter

INSTRUMENTS:
 Geotech Time Domain Electromagnetic System (VTEM)
 Concentric Rx/Tx Geometry
 Transmitter Loop: Diameter 26 Meters, Base Frequency 30 Hz
 Dipole Moment: 654,000 NA
 Transmitter Wave Form: Trapezoidal, Pulse Width 7.27 ms
 Geometrics High Sensitivity Cesium Magnetometer
 Map Resolution: 0.02 x 0.17 at 10 samples/cm

MAP PROJECTION:
 Datum: WGS 84
 Projection: Universal Transverse Mercator
 Central Meridian: 81°W (Zone 17)
 Central Scale Factor: 0.9996
 False Easting/Heighting: 100,000m/0m
 Major Axis: 6378137.000
 Eccentricity: 0.081819191
 NTS: 041915

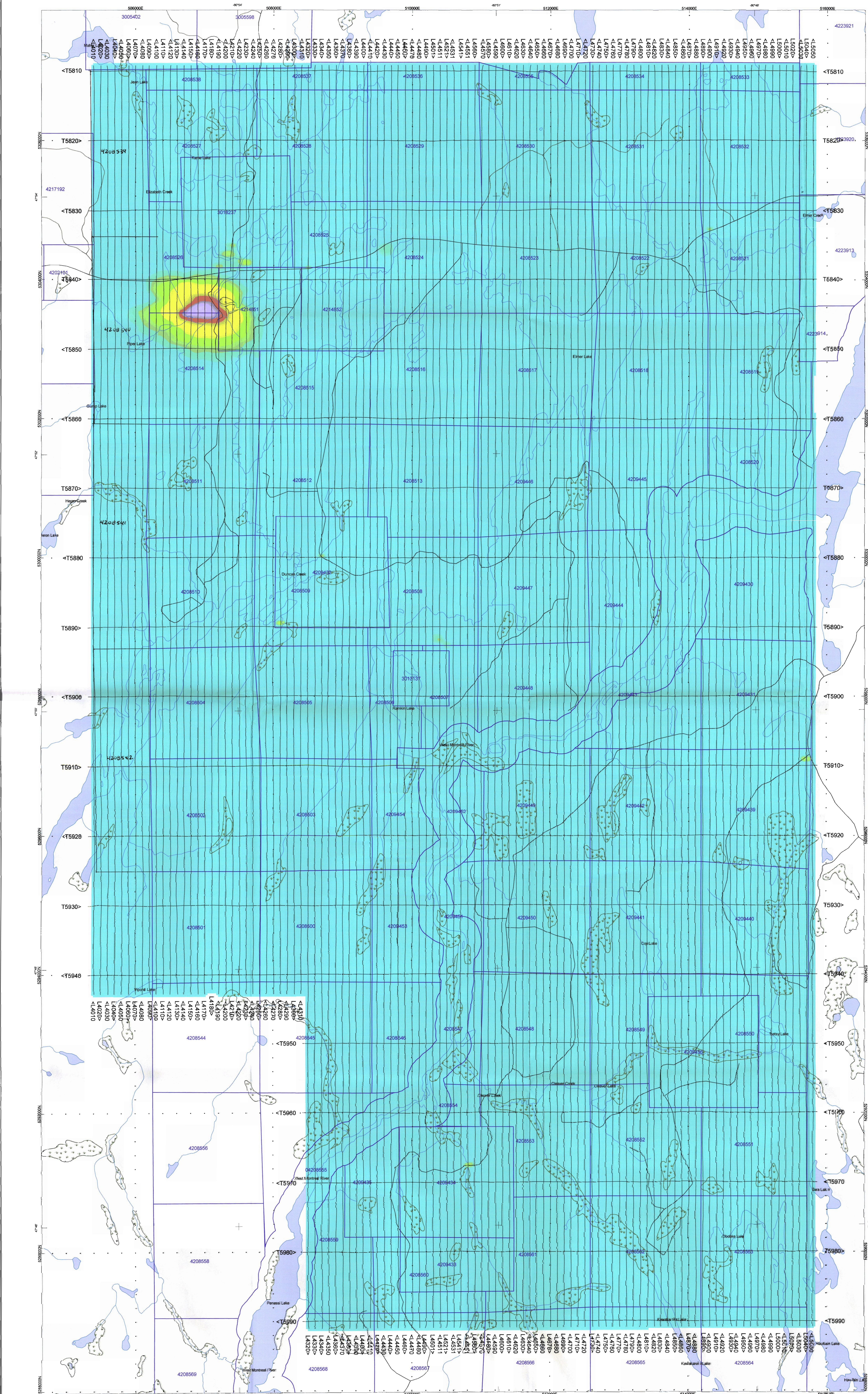

TOPOGRAPHIC LEGEND:
 Contours
 Roads
 Trails
 Rivers & Streams
 Lakes/Rivers
 Wetlands
 Ontario Mining Claims

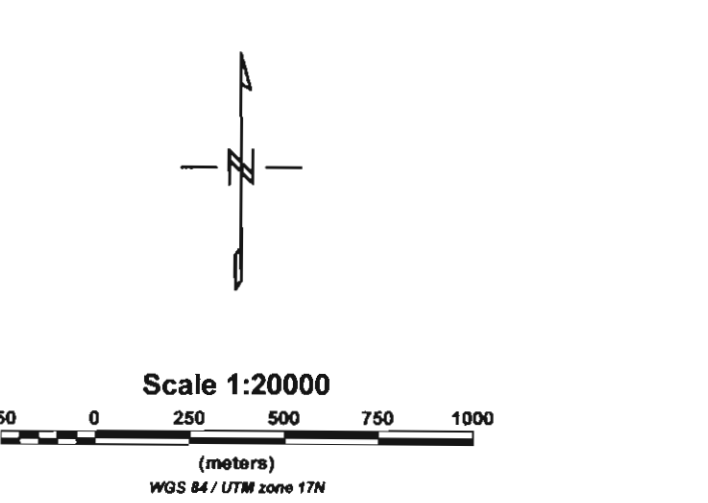

The topographic data base was derived from 1:50000 NRC (Natural Resources Canada) NTDS data.
 Background shading is derived from NASA SRTM (Shuttle Radar Topography Mission) data.
 (most data derived from Geonames.com: 1:250,000 Canadian National Topographic Database.
 (www.geonames.ca) (www.geonames.com)

Golden Chalice Resources Inc.
 Shillington West Block
 Lost Lake, Ontario

Geotech VTEM System
 VTEM B-Field Channel 23
 Time Gate 1.151 ms.

Flown and processed by Geotech Ltd.
 245 Industrial Parkway North
 Aurora, Ontario, Canada L4G 4C4
 www.geotech.ca

MARCH 2008

2-37490





SURVEY SPECIFICATIONS:
 Survey Date: January 4th to 22nd, 2008
 Survey Base: Lost Lake, Ontario
 Aircraft: Aerospaciale A-Star 300 FX-2 (C-FBTW)
 Nominal Survey Line Spacing: 100 Meters
 Nominal Survey Line Direction: N 60° E
 Nominal Tie Line Spacing: 1000 Meters
 Nominal Tie Line Direction: N 60° E
 Nominal Terrain Clearance: 45 Meters
 EM Loop: Towed 42 meters beneath the Helicopter
 Magnetic Sensor: Towed 15 meters under the Helicopter

INSTRUMENTS:
 Geotech Time Domain Electromagnetic System (VTEM)
 Concentric RefTx Geometry
 Transmitter Loop: Diameter 26 Meters, Base Frequency 30 Hz
 Dipole Moment: 454,000 N/A
 Transmitter Wave Form: Triangular, Pulse Width 7.27 ms
 Geometrics: High Sensitivity Cesium Magnetometer
 Map Resolution: 0.02 nT at 10 samples/sec

MAP PROJECTION:
 Datum: WGS 84
 Projection: Universal Transverse Mercator
 Central Meridian: 81°W (Zone 17)
 Central Scale Factor: 0.9996
 False Easting/Northing: 500,000m/0m
 Map Scale: 1:250,000
 Eccentricity: 0.081818181
 NTS: 041P15

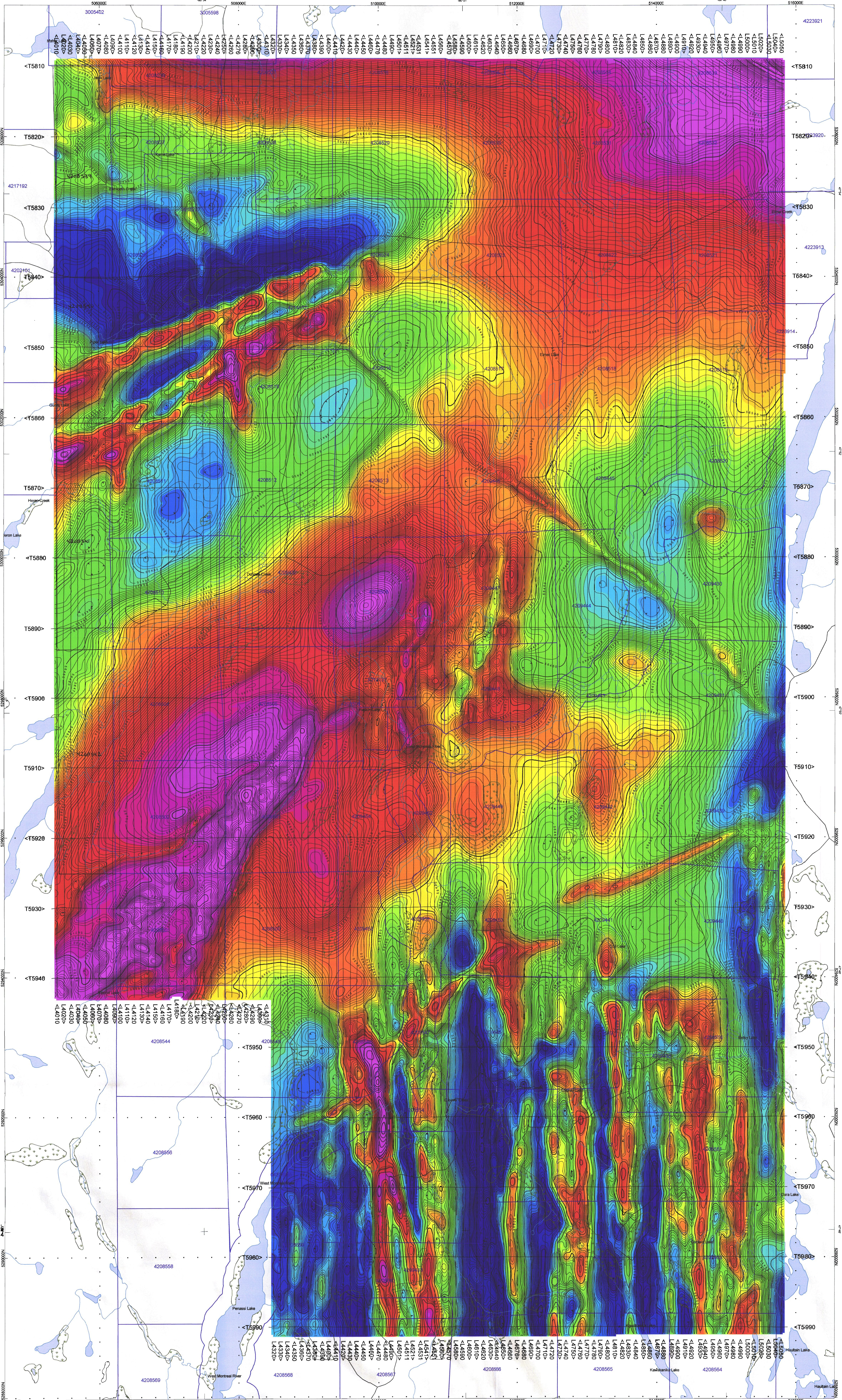

RECEIVED
 MAR 2 8 2008
 GEOTECH LTD.
 2-37490

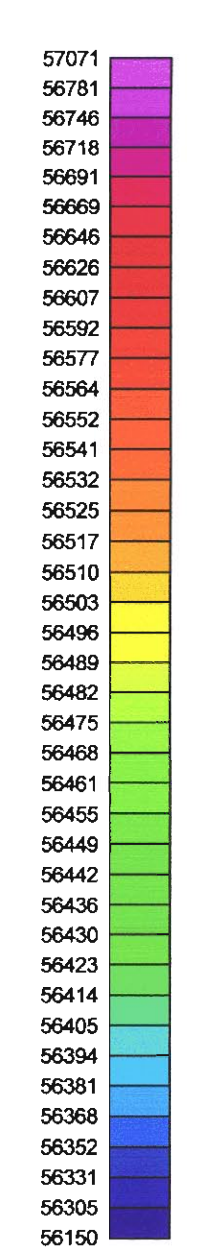

VTEM Contour intervals:
 5 nT
 10 nT
 50 nT
 250 nT

TOPOGRAPHIC LEGEND:
 Contours
 Roads
 Trails
 Rivers & Streams
 Lakes & Rivers
 Wetlands
 Ontario Mining Claims

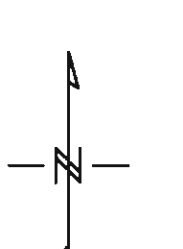

Scale 1:20000
 (Meters)
 0 250 500 750 1000
 WGS 84 (UTM zone 17M)

The topographic data base was derived from 1:50000 NRC (Natural Resources Canada) NTDB data. Background shading is derived from NASA SRTM (Shuttle Radar Topography Mission) data. Inset data derived from Geonames 1:250,000 Canadian National Topographic database (www.geonames.ca) (www.geonames.com)

Golden Chance Resources Inc.
 Shillington West Block
 Lost Lake, Ontario

Geotech VTEM System
 Total Magnetic Intensity

Flown and processed by Geotech Ltd.
 245 Industrial Parkway North,
 Aurora, Ontario, Canada L4G 4C4
 www.geotech.ca

MARCH 2008