

2.38029

Page 1

May 11/08

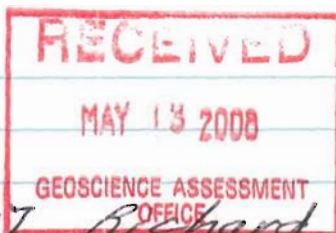

Introduction:

On June 28/07 Richard Morin carried out traditional prospecting and sample collection which were forwarded for assaying.

Geology: Mallard Twp. is in the Abitibi greenstone belt, Porcupine mining Division. Predominant rock types are mafic intrusives. A pervasive schistosity in the area strikes at  $30^{\circ}$  -  $40^{\circ}$ .

Regional geology of Mallard is covered in the Ontario Geological Survey report 248 Geology of the Garnet Area 1987.

Property Location and Access:

Map NTS 41-0/NE Ridout Figure 1(a)  
Property is in Mallard Twp. Porcupine mining Division, claim map G1171 Figure 1(b)  
Vehicular access is gained from Timmins via paved Hwy 101 to 144 South to the junction of Sultan industrial road, thence west along the Sultan road for 46 km to a road junction in Edith Twp. then North via a gravel road for 26 km to a bridge on the Opepeesway River then  $\frac{1}{2}$  mile to claims.

Claim Nos.

1177542                      1 unit  
1177543                      1 unit

Client No. 172554

Project:

Investigated area where work was carried out during the 1980's on a shear zone approx. 65' wide with pyrite, calcite and visible gold. Manually digging with pick and shovel removing ~~rock~~ breaking rock with hammer collected samples (4) that were forwarded to SES Geochemical Lab 1885 Leslie Street, Toronto ON. M3B 2M3 (1-800-387-0255.)

- 7974 { shearing quartz veins  
7975 { with massive pyrite + calcite  
7976 {  
7977 { quartz with massive pyrite.

sample locations are shown on attached MAP. App. 1  
Assay results are appended, App. 2

B. Martin  
May 11/08



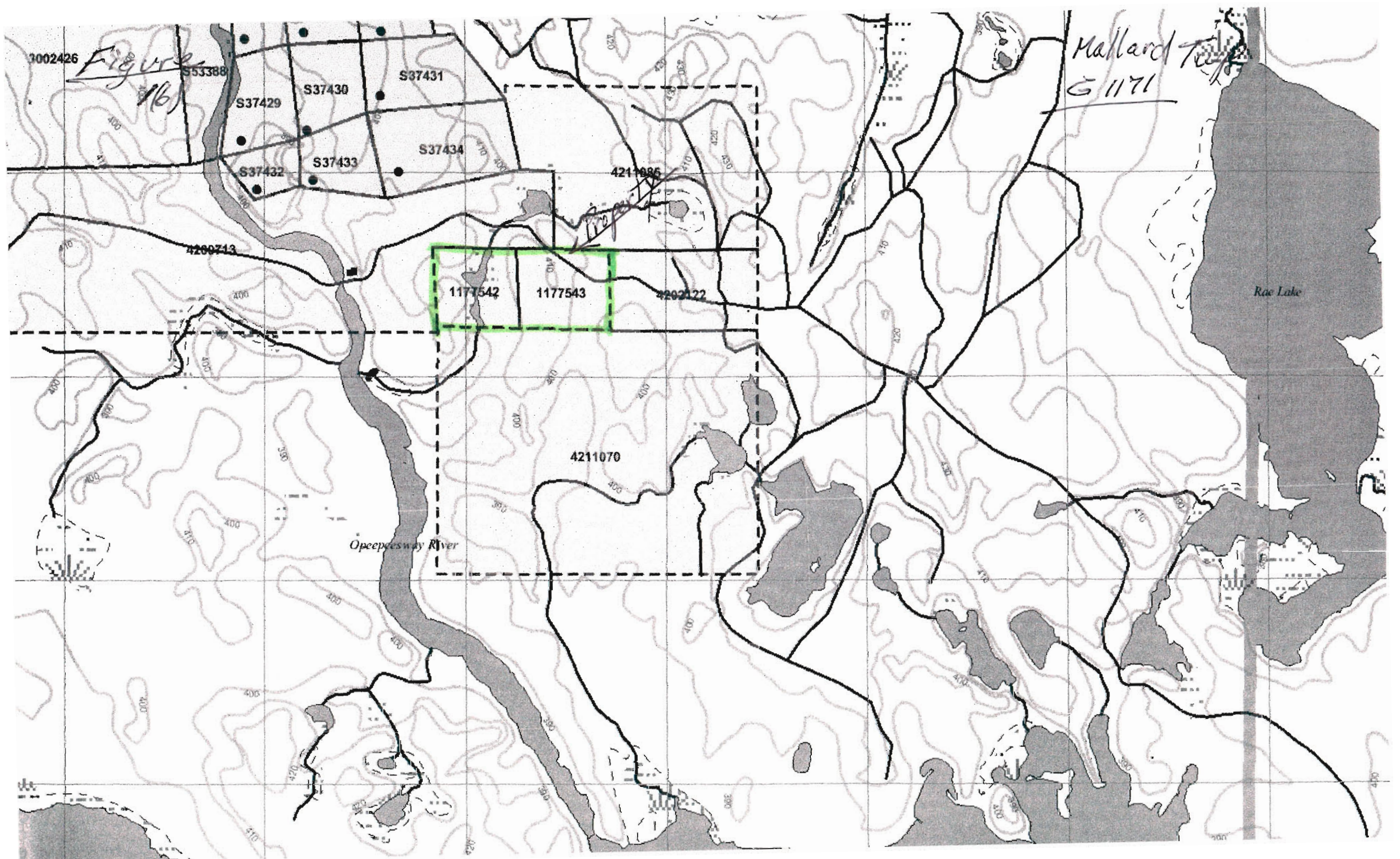

3002426

Figure 16)

S53388

S37429

S37430

S37431

S37432

S37433

S37434

4211886

4280713

1177542

1177543

4202122

4211070

Opeepesway River

Mallard Top  
G 1171

Rac Lake



Access and Location } Figure No. 1(a)

N.T.S. 41-0/NE RIDOUT

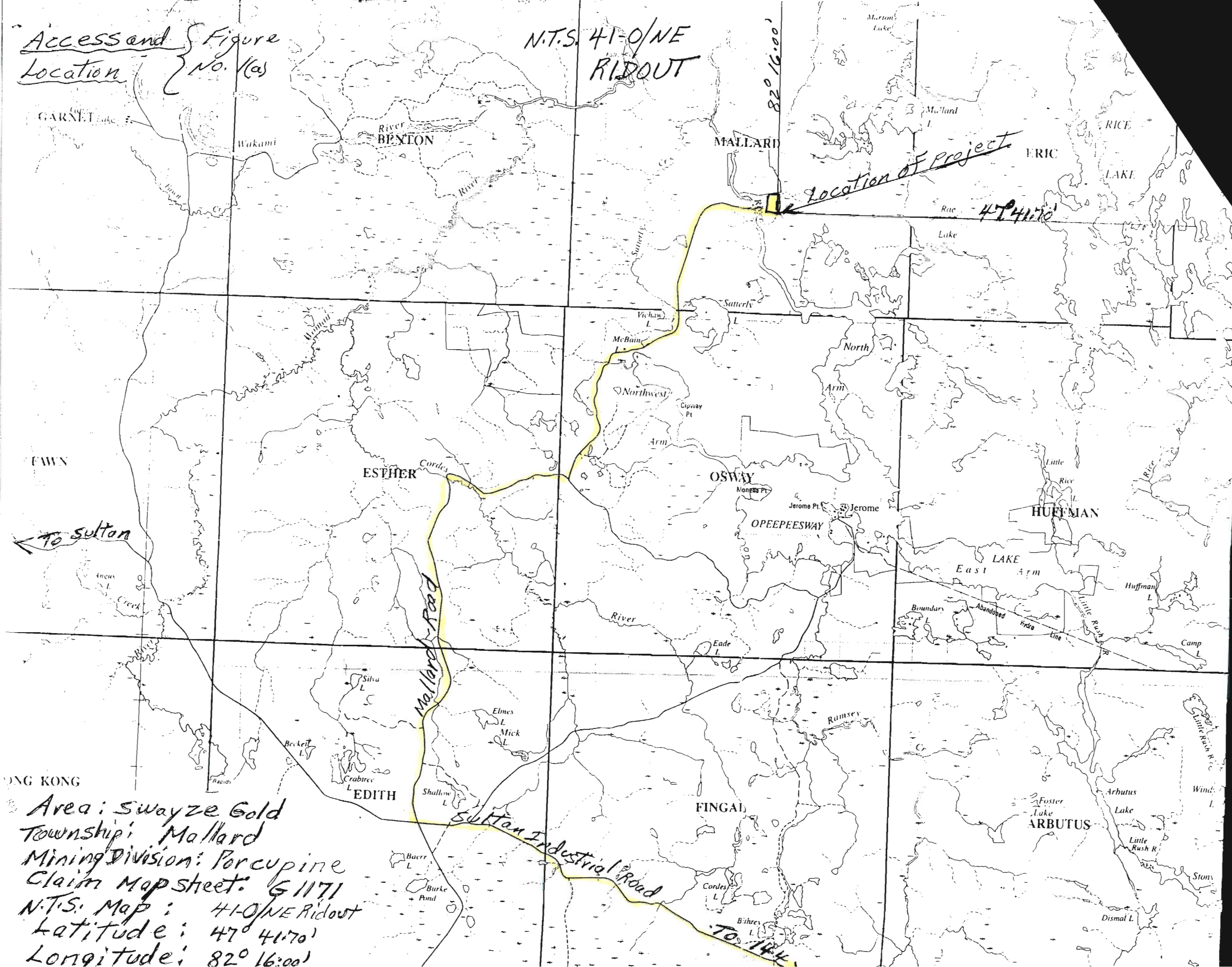

Area: Swayze Gold  
 Township: Mallard  
 Mining Division: Porcupine  
 Claim Map sheet: G 1171  
 N.T.S. Map: 41-0/NE Ridout  
 Latitude: 47° 41:70'  
 Longitude: 82° 16:00'

Appendix I

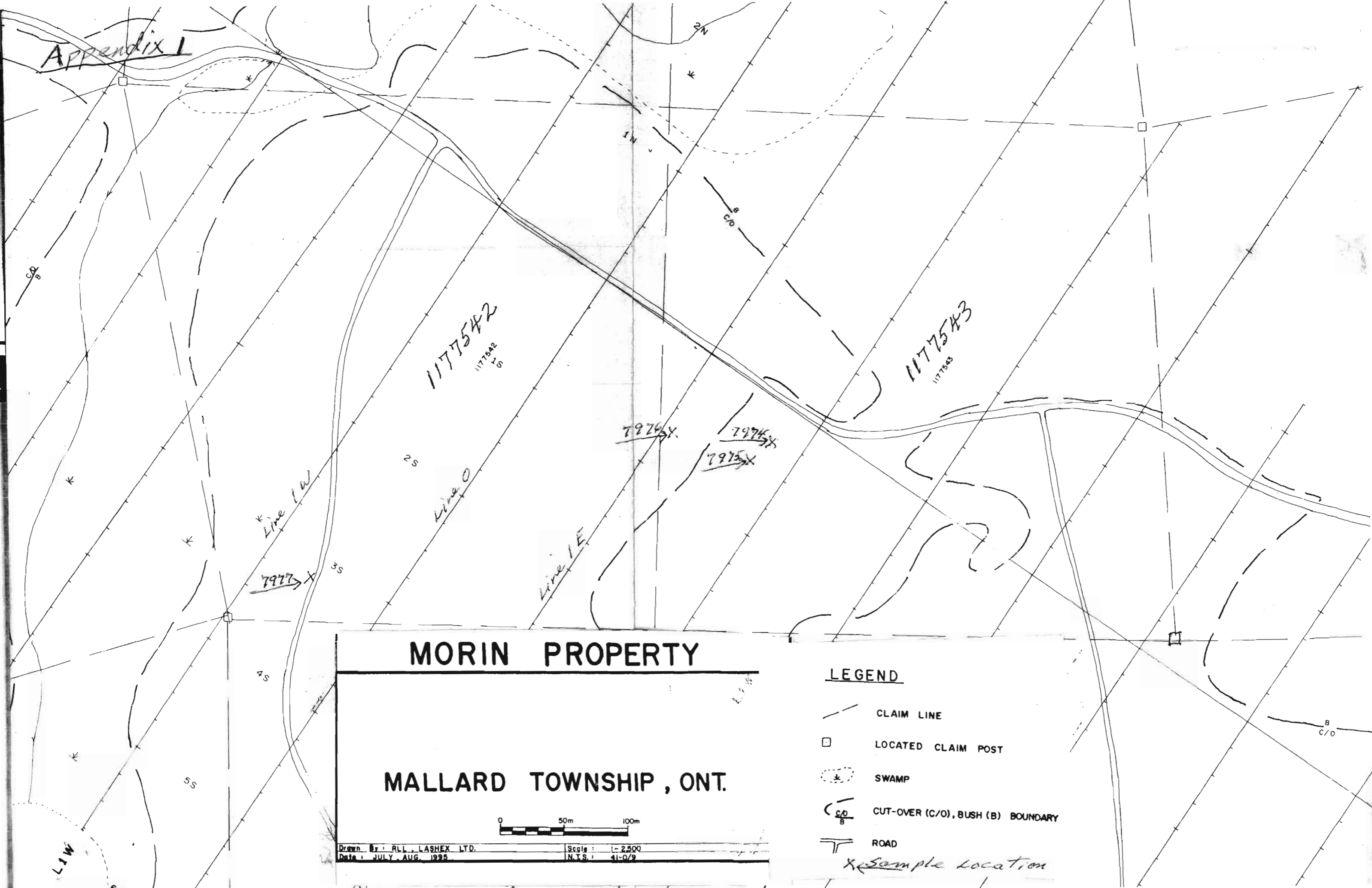







# MORIN PROPERTY

## MALLARD TOWNSHIP, ONT.



Drawn By: RLL, LASHEX LTD.      Scale: 1:2,500  
 Date: JULY, AUG, 1995      N.T.S.: 41-0/9

### LEGEND

-  CLAIM LINE
-  LOCATED CLAIM POST
-  SWAMP
-  CUT-OVER (C/O), BUSH (B) BOUNDARY
-  ROAD
-  Sample location

Appendix 2

1 of 2

**Richard & Claudette Morin**

---

**From:** "Guerina, Gilberto (Toronto)" <Gilberto.Guerina@sgs.com>  
**To:** <ricla@rogers.com>  
**Sent:** Tuesday, May 06, 2008 2:13 PM  
**Attach:** 099556 Richard Morin.CSV; DisclaimerCSV.txt  
**Subject:** SGS Provisional report/Work Order: 099556

The data included in this unsecured spreadsheet is for the personal use of the client. Final results are contained in the SGS Certificate of Analysis. In the event of a discrepancy between this data and the Certificate of Analysis, the Certificate of Analysis will be considered correct.

Data Center  
SGS Minerals Services  
1885 Leslie Street, Toronto ON M3B 2M3



p: 416 642 8398 Ext. 3239

f: 416 443 1662

Information in this email and any attachments is confidential and intended solely for the use of the individual(s) to whom it is addressed or otherwise directed. Please note that any views or opinions presented in this email are solely those of the author and do not necessarily represent those of the Company.

Finally, the recipient should check this email and any attachments for the presence of viruses. The Company accepts no liability for any damage caused by any virus transmitted by this email.

All SGS services are rendered in accordance with the applicable SGS conditions of service available on request and accessible at [http://www.sgs.com/terms\\_and\\_conditions.htm](http://www.sgs.com/terms_and_conditions.htm)

5/6/2008

| ANALYTE  | Au     | Pt     | Pd     |   |
|----------|--------|--------|--------|---|
| METHOD   | FAI313 | FAI313 | FAI313 |   |
| DETECTIC | 1      | 10     | 1      |   |
| UNITS    | PPB    | PPB    | PPB    |   |
| 7974     | 83     | <10    |        | 6 |
| 7975     | 1760   | <10    |        | 3 |
| 7976     | 251    | <10    |        | 2 |
| 7977     | 50     | <10    | <1     |   |
| DUP-7974 | 100    | <10    |        | 6 |



### Certificate of Analysis

Work Order: 099556

To: Attn: Richard Morin  
839 Swallowtail Cres  
Orleans  
ON K4A 4M5

Date: May 06, 2008

P.O. No. : Richard Morin  
Project No. : DEFAULT  
No. Of Samples : 4  
Date Submitted : Apr 14, 2008  
Report Comprises : Pages 1 to 2  
(Inclusive of Cover Sheet)

Distribution of unused material:

Discard after 90 days: 4 Rocks

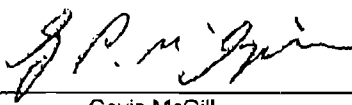
Certified By :   
Gavin McGill  
Operations Manager

ISO 17025 Accredited for Specific Tests. SCC No. 458

Report Footer: L.N.R. = Listed not received I.S. = Insufficient Sample  
n.a. = Not applicable - = No result  
\*INF = Composition of this sample makes detection impossible by this method  
M after a result denotes ppb to ppm conversion, % denotes ppm to % conversion  
Methods marked with an asterisk (e.g. \*NAA08V) were subcontracted

Subject to SGS General Terms and Conditions

The data reported on this certificate of analysis represents the sample submitted to SGS Minerals Services. Reproduction of this analytical report, in full or in part, is prohibited without prior written approval.





Final : 099556 Order: Richard Morin

Page 2 of 2

| Element   | Au     | Pt     | Pd     |
|-----------|--------|--------|--------|
| Method    | FAI313 | FAI313 | FAI313 |
| Det.Lim.  | 1      | 10     | 1      |
| Units     | PPB    | PPB    | PPB    |
| 7974      | 83     | <10    | 6      |
| 7975      | 1760   | <10    | 3      |
| 7976      | 251    | <10    | 2      |
| 7977      | 50     | <10    | <1     |
| *Dup 7974 | 100    | <10    | 6      |

The data reported on this certificate of analysis represents the sample submitted to SGS Minerals Services. Reproduction of this analytical report, in full or in part, is prohibited without prior written approval.