

Section Azimuth 142° looking northeasterly

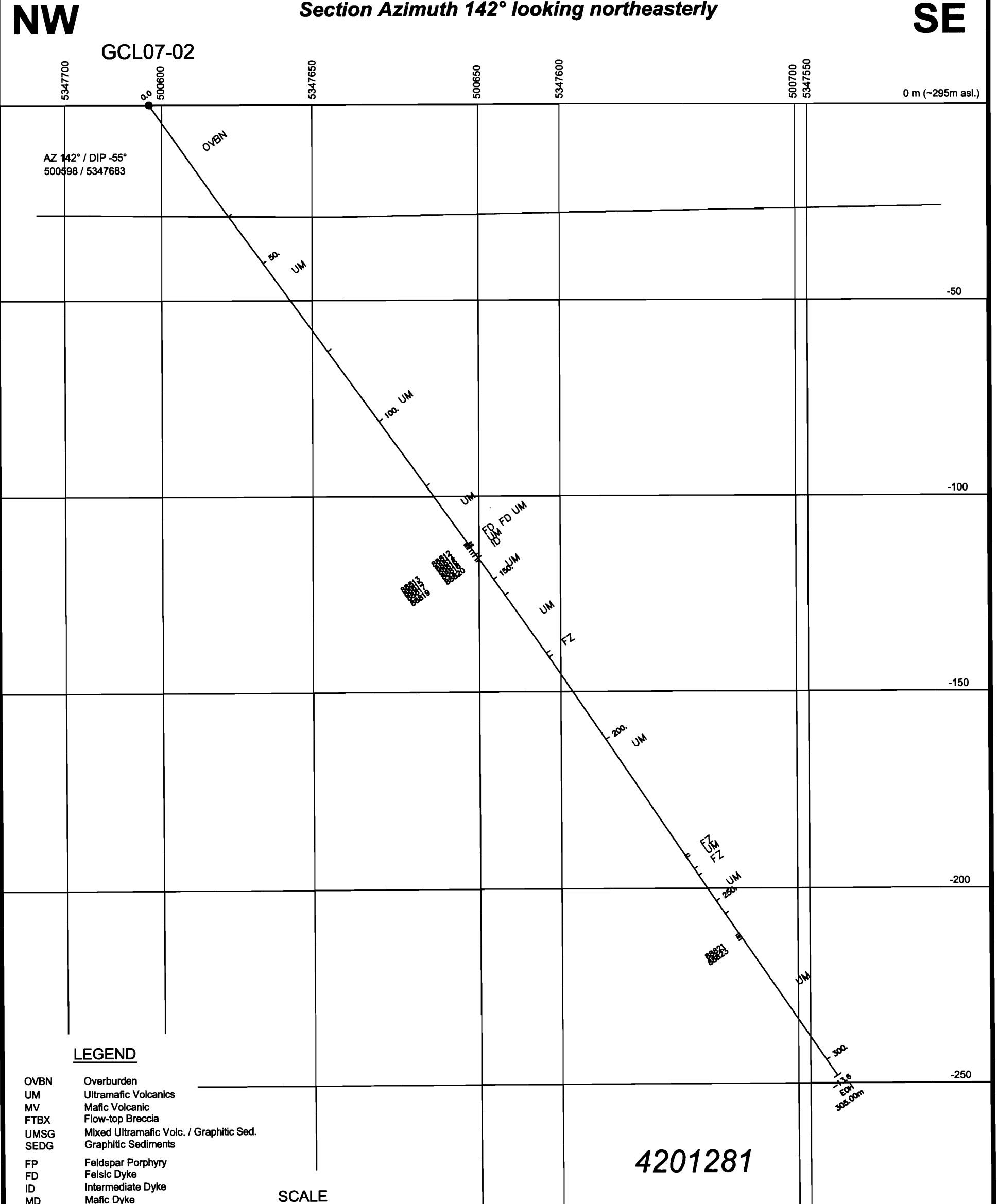

LEGEND

- OVBN Overburden
- UM Ultramafic Volcanics
- MV Mafic Volcanic
- FTBX Flow-top Breccia
- UMSG Mixed Ultramafic Volc. / Graphitic Sed.
- SEDG Graphitic Sediments
- FP Feldspar Porphyry
- FD Felsic Dyke
- ID Intermediate Dyke
- MD Mafic Dyke
- DB Diabase Dyke
- GAB Gabbro
- FZ Fault Zone
- 35001 Sample Number

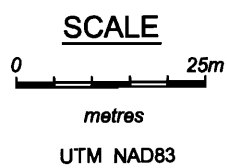

Langmuir Property
DDH GCL07-02

**GOLDEN CHALICE
RESOURCES**

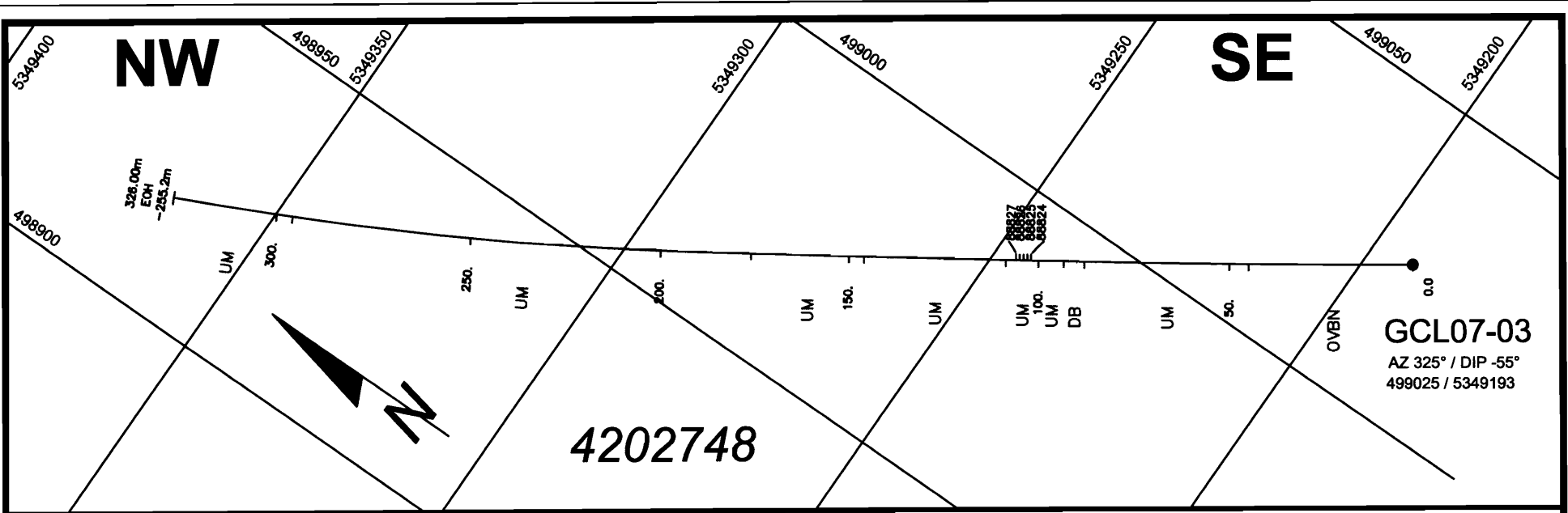

GCL07-03
 AZ 325° / DIP -55°
 499025 / 5349193

4202748

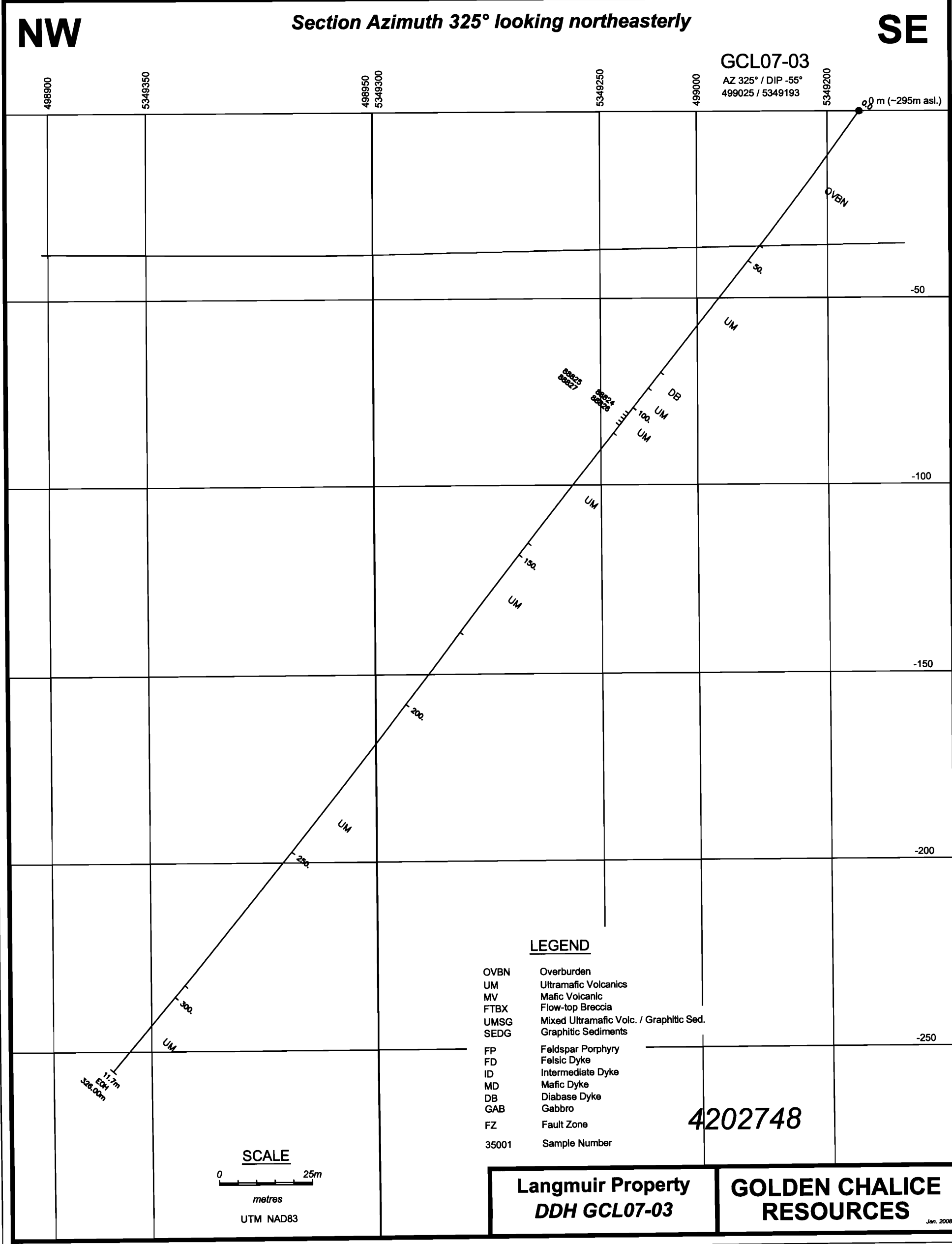

GCL07-03
 AZ 325° / DIP -55°
 499025 / 5349193

0.0 m (~295m asl.)

LEGEND

- OVBN Overburden
- UM Ultramafic Volcanics
- MV Mafic Volcanic
- FTBX Flow-top Breccia
- UMSG Mixed Ultramafic Volc. / Graphitic Sed.
- SEDG Graphitic Sediments
- FP Feldspar Porphyry
- FD Felsic Dyke
- ID Intermediate Dyke
- MD Mafic Dyke
- DB Diabase Dyke
- GAB Gabbro
- FZ Fault Zone
- 35001 Sample Number

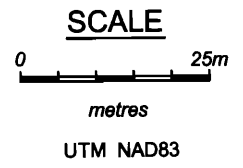

4202748

Langmuir Property DDH GCL07-03	GOLDEN CHALICE RESOURCES
---	---

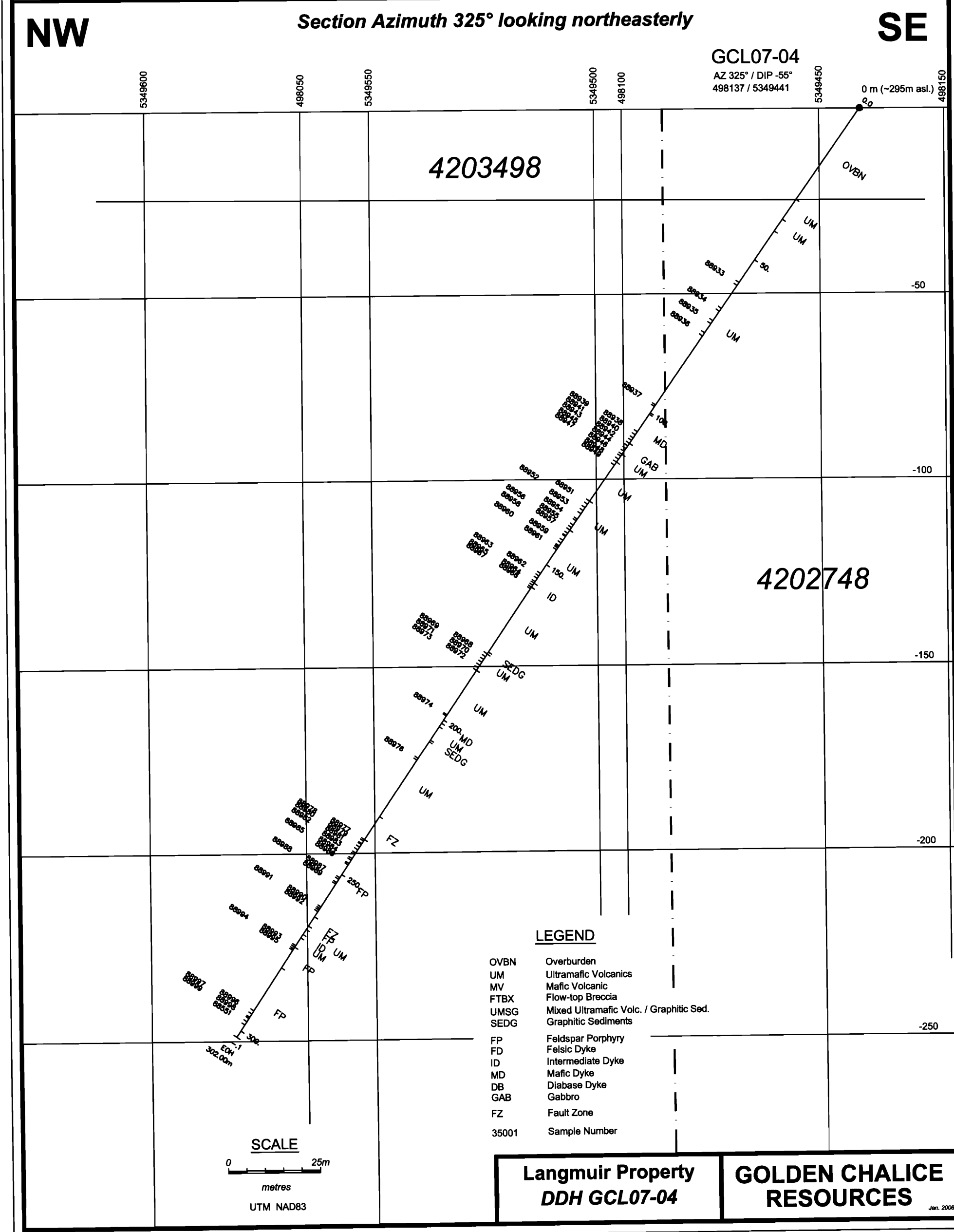
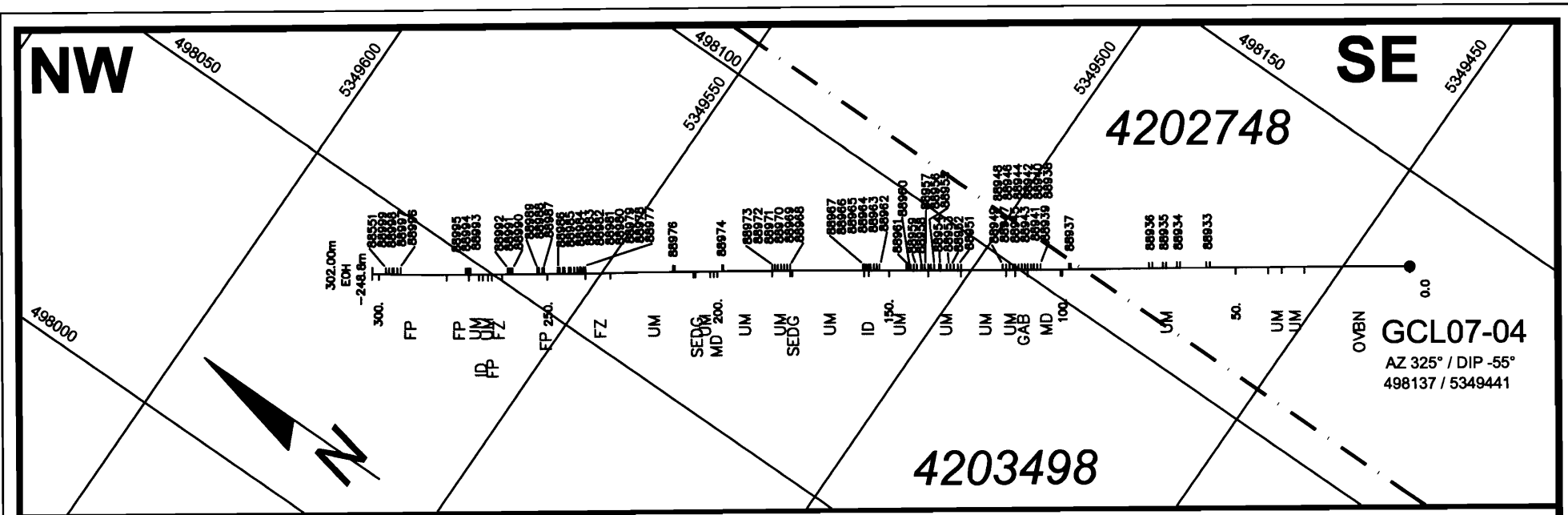

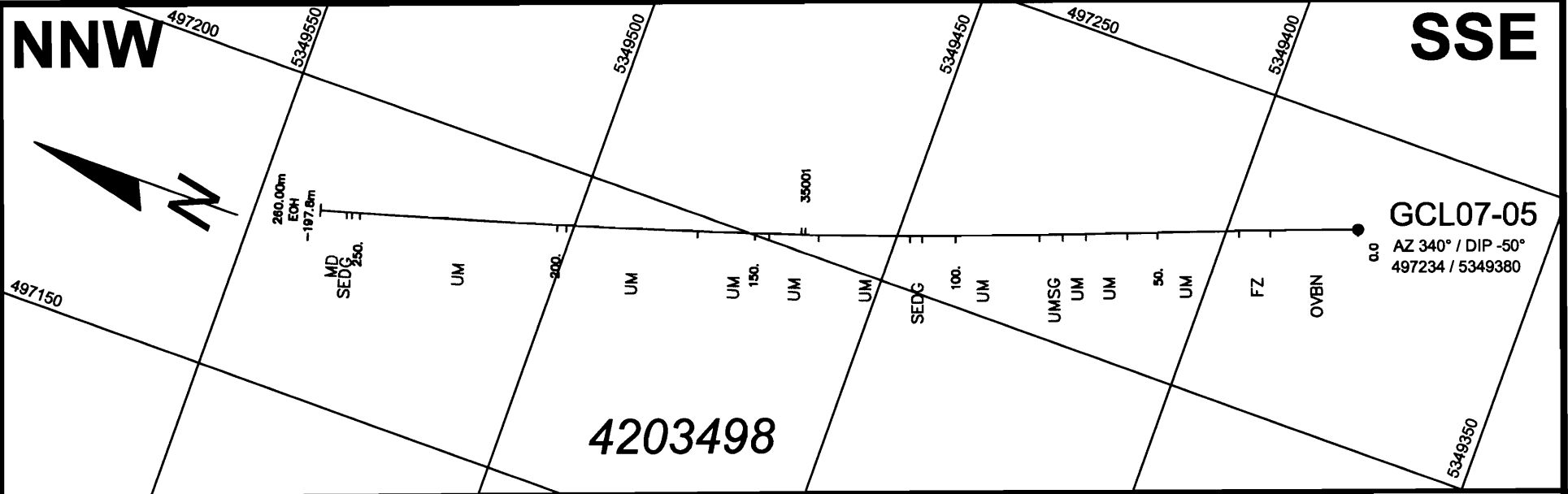

4203498

GCL07-05
AZ 340° / DIP -50°
497234 / 5349380

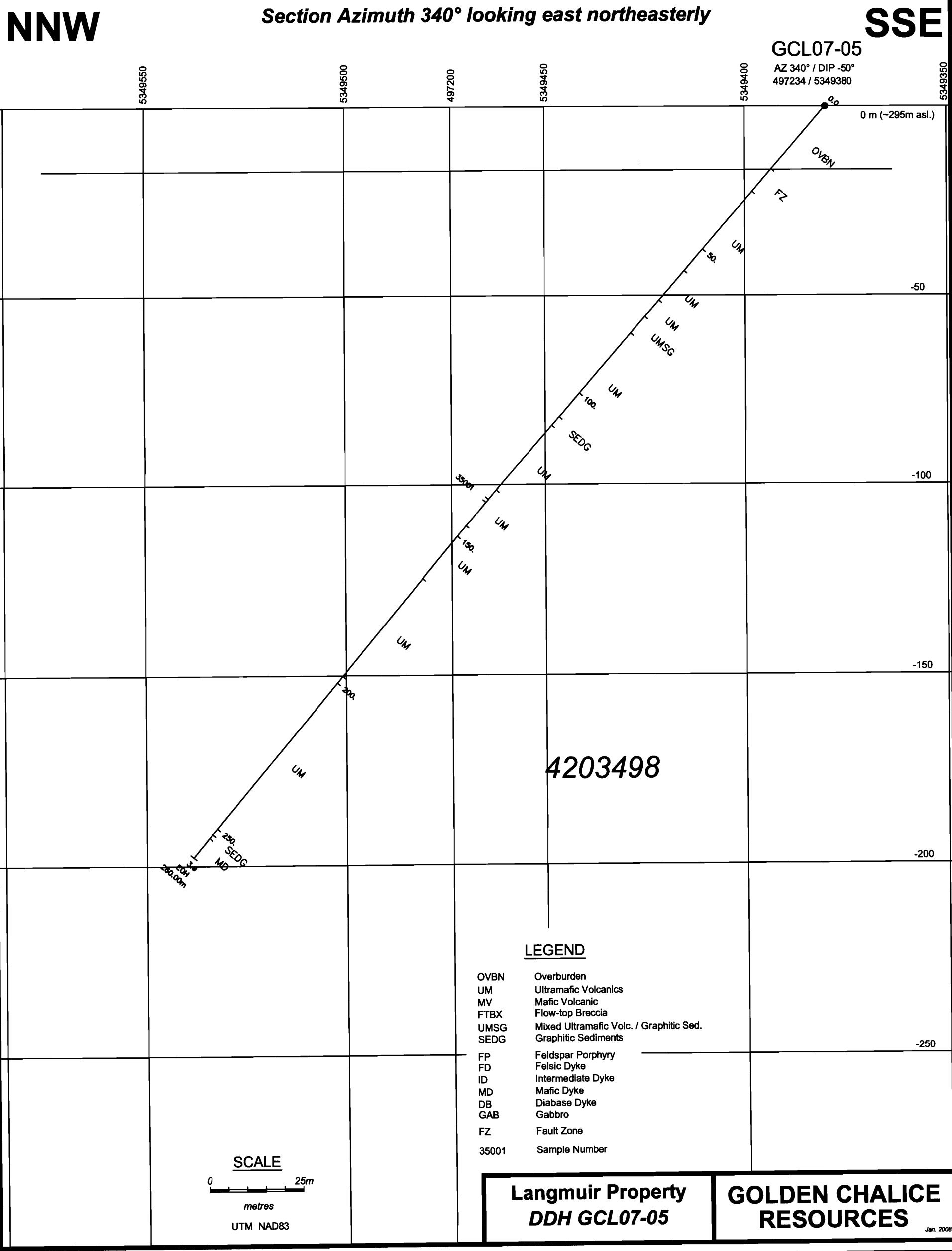

Section Azimuth 340° looking east northeasterly

GCL07-05
AZ 340° / DIP -50°
497234 / 5349380

4203498

LEGEND

- OVBN Overburden
- UM Ultramafic Volcanics
- MV Mafic Volcanic
- FTBX Flow-top Breccia
- UMSG Mixed Ultramafic Volc. / Graphitic Sed.
- SEDG Graphitic Sediments
- FP Feldspar Porphyry
- FD Felsic Dyke
- ID Intermediate Dyke
- MD Mafic Dyke
- DB Diabase Dyke
- GAB Gabbro
- FZ Fault Zone
- 35001 Sample Number

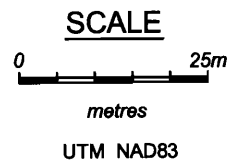

Langmuir Property
DDH GCL07-05

GOLDEN CHALICE
RESOURCES

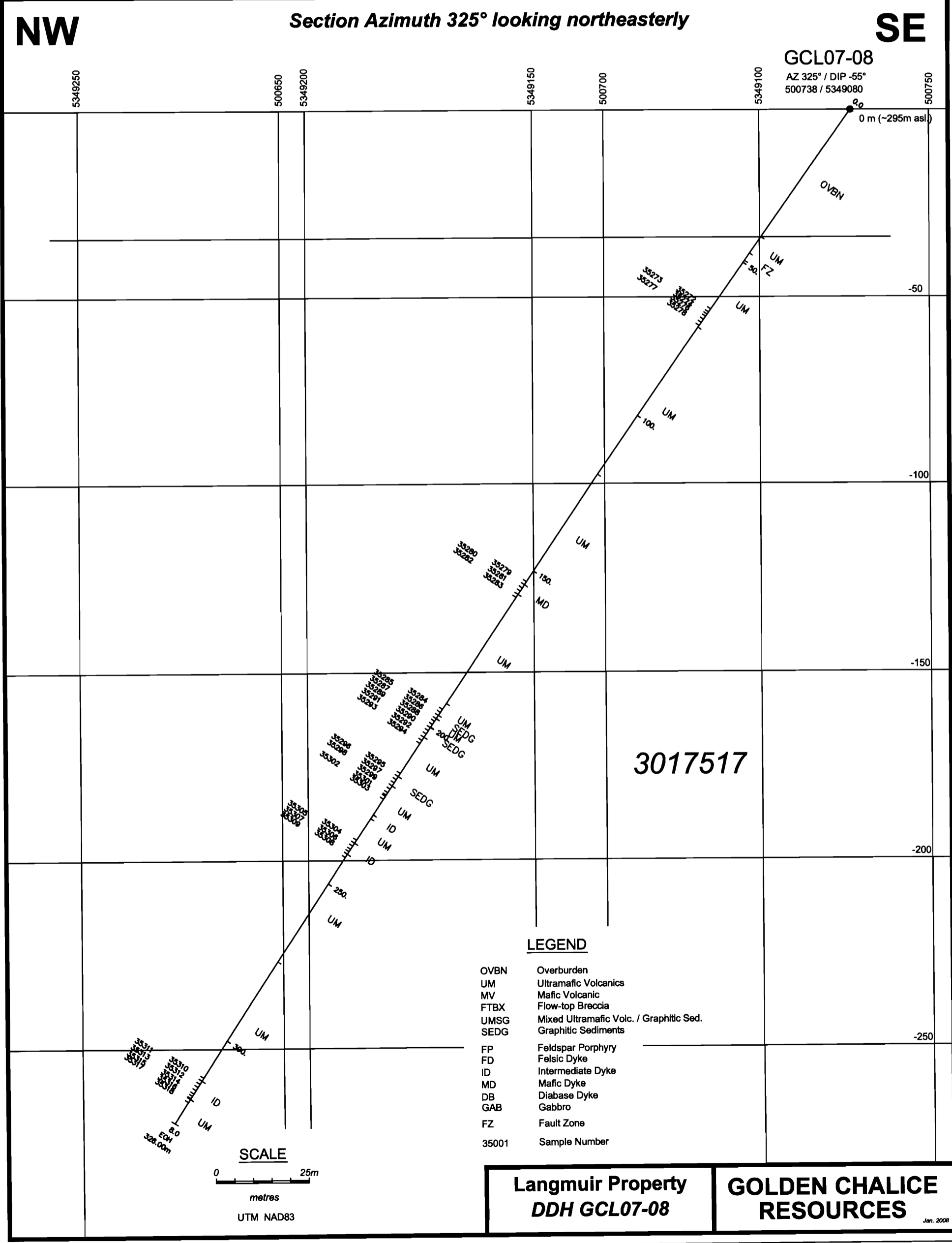
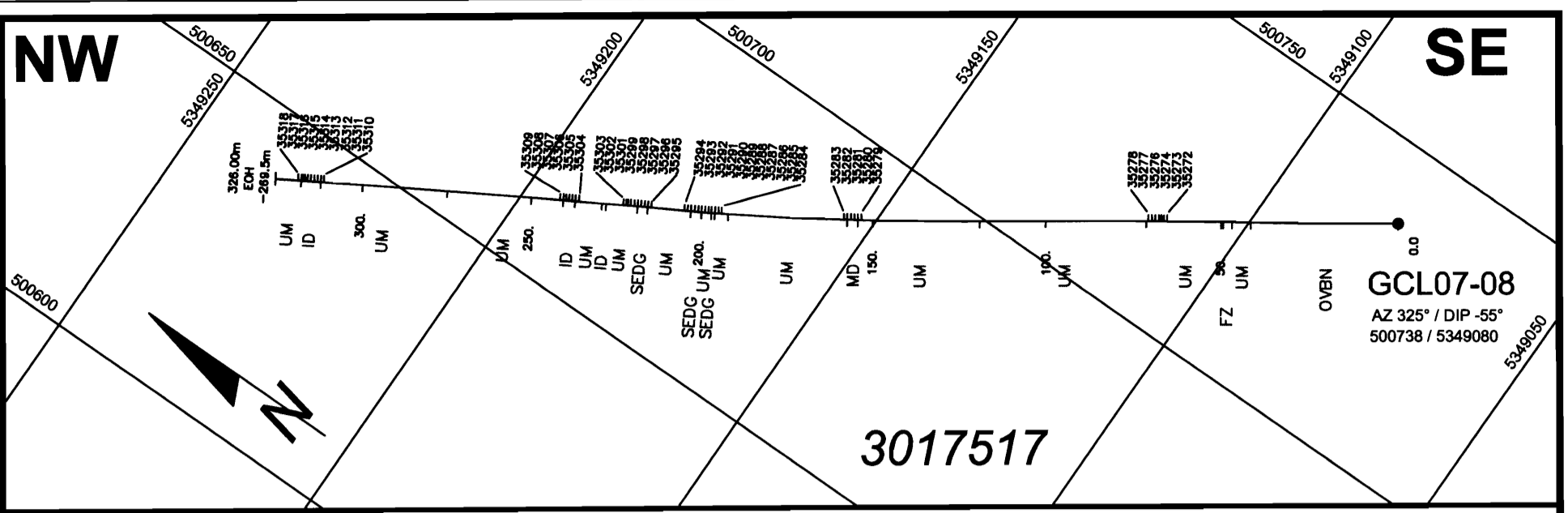

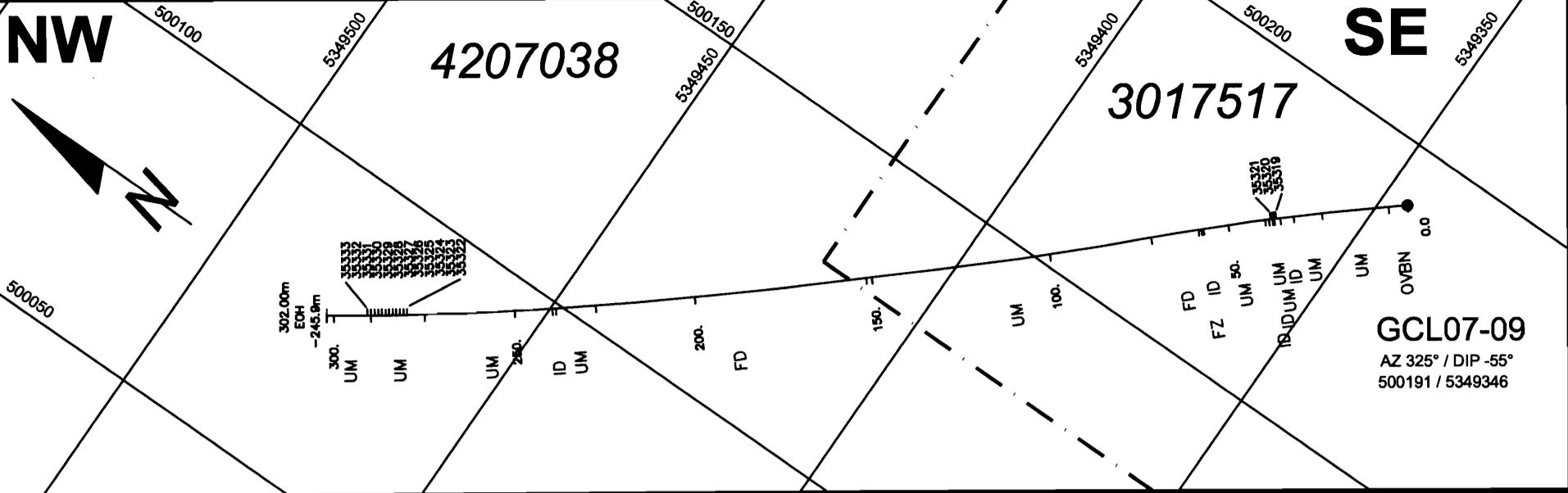

GCL07-09
 AZ 325° / DIP -55°
 500191 / 5349346

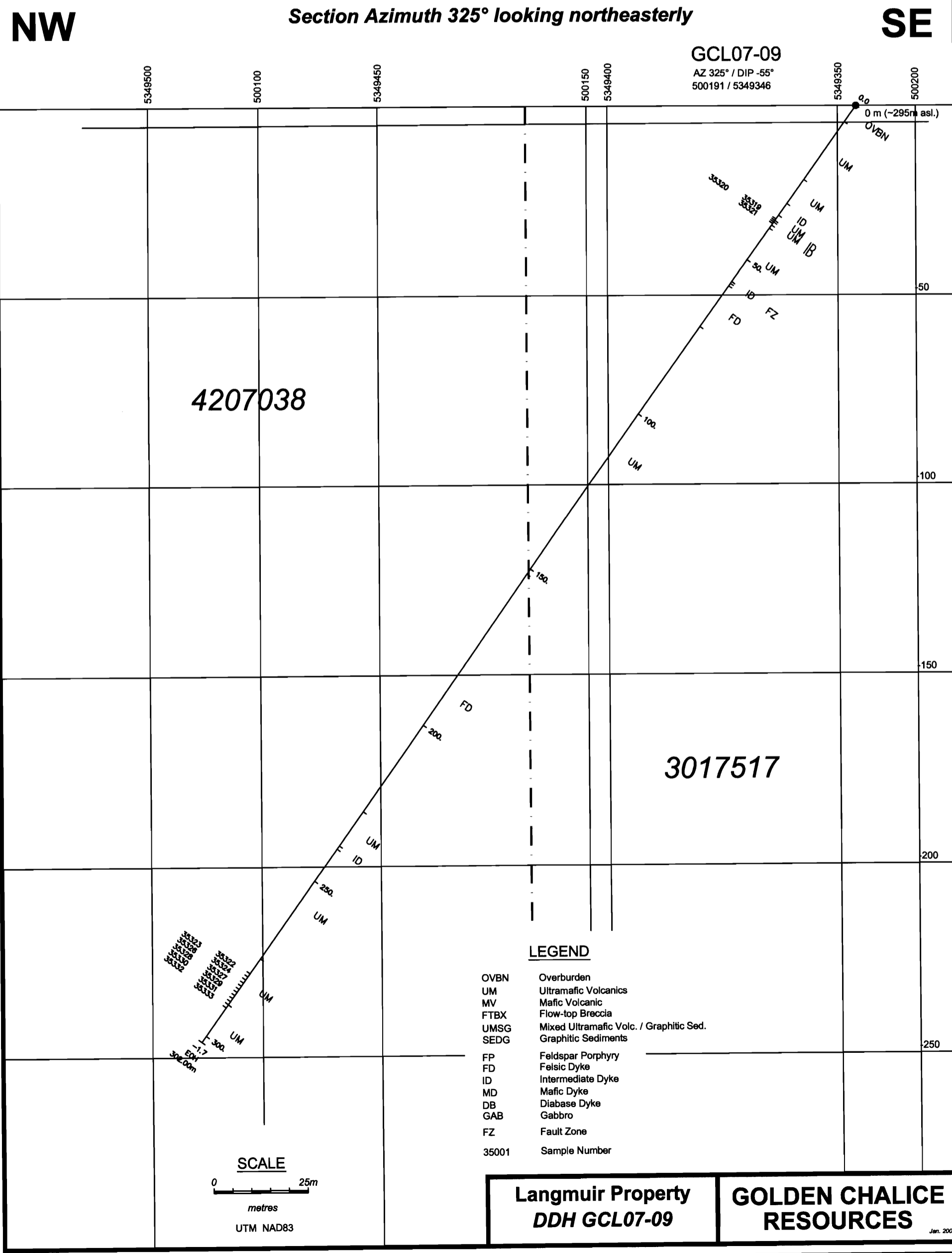

Section Azimuth 325° looking northeasterly

GCL07-09
 AZ 325° / DIP -55°
 500191 / 5349346

LEGEND

- OVBN Overburden
- UM Ultramafic Volcanics
- MV Mafic Volcanic
- FTBX Flow-top Breccia
- UMSG Mixed Ultramafic Volc. / Graphitic Sed.
- SEDG Graphitic Sediments
- FP Feldspar Porphyry
- FD Felsic Dyke
- ID Intermediate Dyke
- MD Mafic Dyke
- DB Diabase Dyke
- GAB Gabbro
- FZ Fault Zone
- 35001 Sample Number

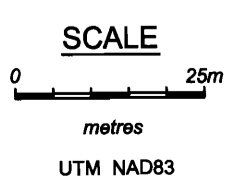

Langmuir Property
DDH GCL07-09

GOLDEN CHALICE
RESOURCES

Jan. 2008