

LEGEND

- DIA Olivine Diabase Dike
- GAB Gabbro (Nipissing)
- PYXT Pyroxenite (Nipissing)
- SED Sediment – Greywacke, Argillite (Huronian)

ABBREVIATIONS

- BXA breccia
- G geophysically inferred
- peg pegmatitic
- SX sulphides

- cpy chalcopyrite
- mt magnetite
- po pyrrhotite
- py pyrite

SYMBOLS

- x Outcrop, outcrop area; small outcrop
- Foliation
- Contact (defined, inferred)
- Fault (geophysically inferred)
- Sample Location and number
- Sulphide/Mineral occurrence
- Claim post (located, inferred)
- Claim line
- Swamp
- Pond with Beaver dam
- Road
- Trail
- Creek



Hyman-Nairn Property, Ontario

FIGURE 4:
HYMAN-NAIRN PROJECT
DRILL HOLE LOCATION MAP

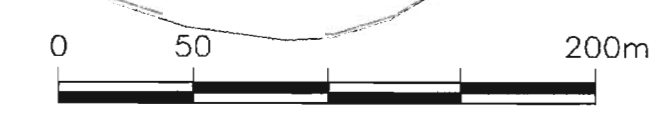

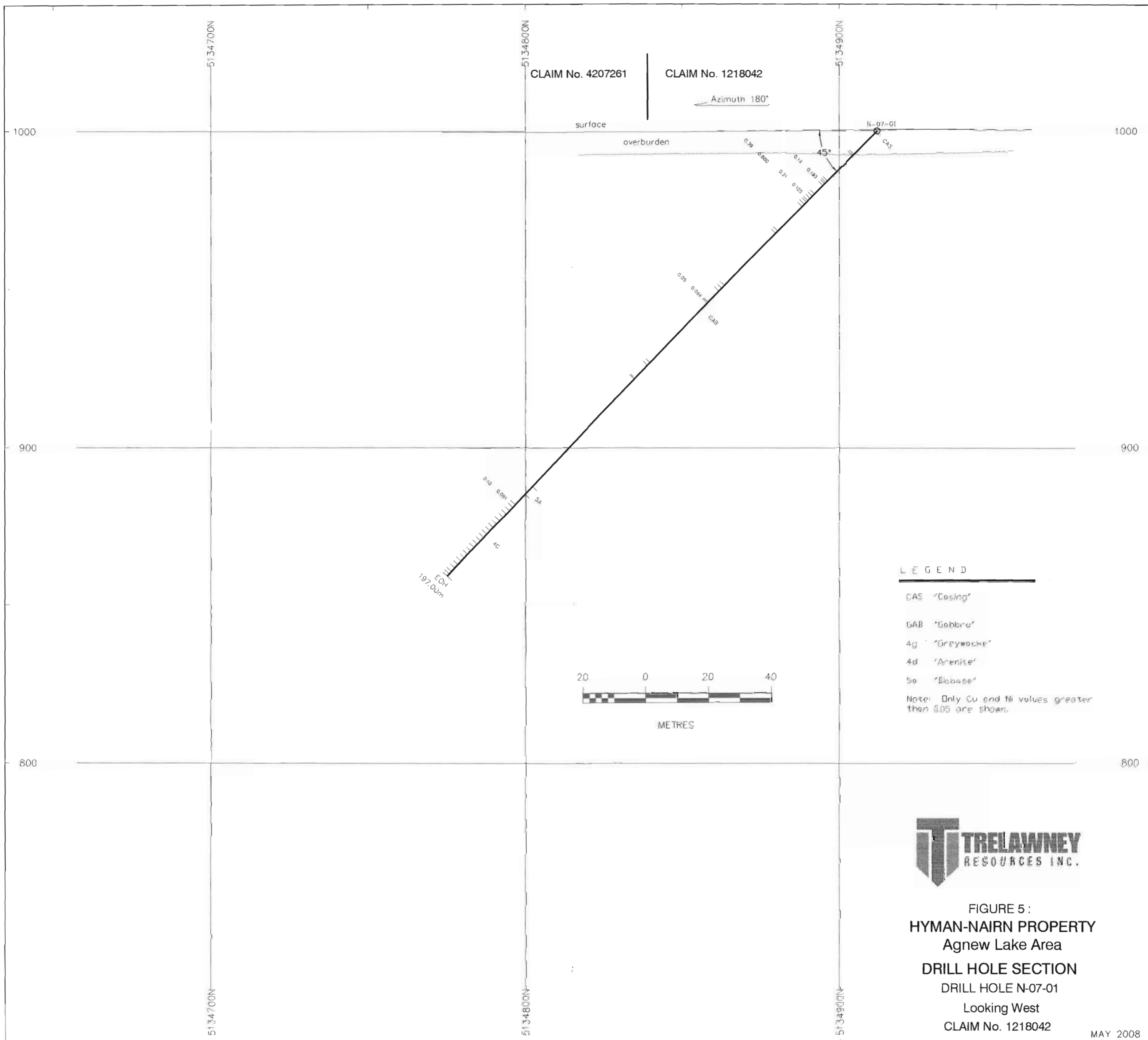

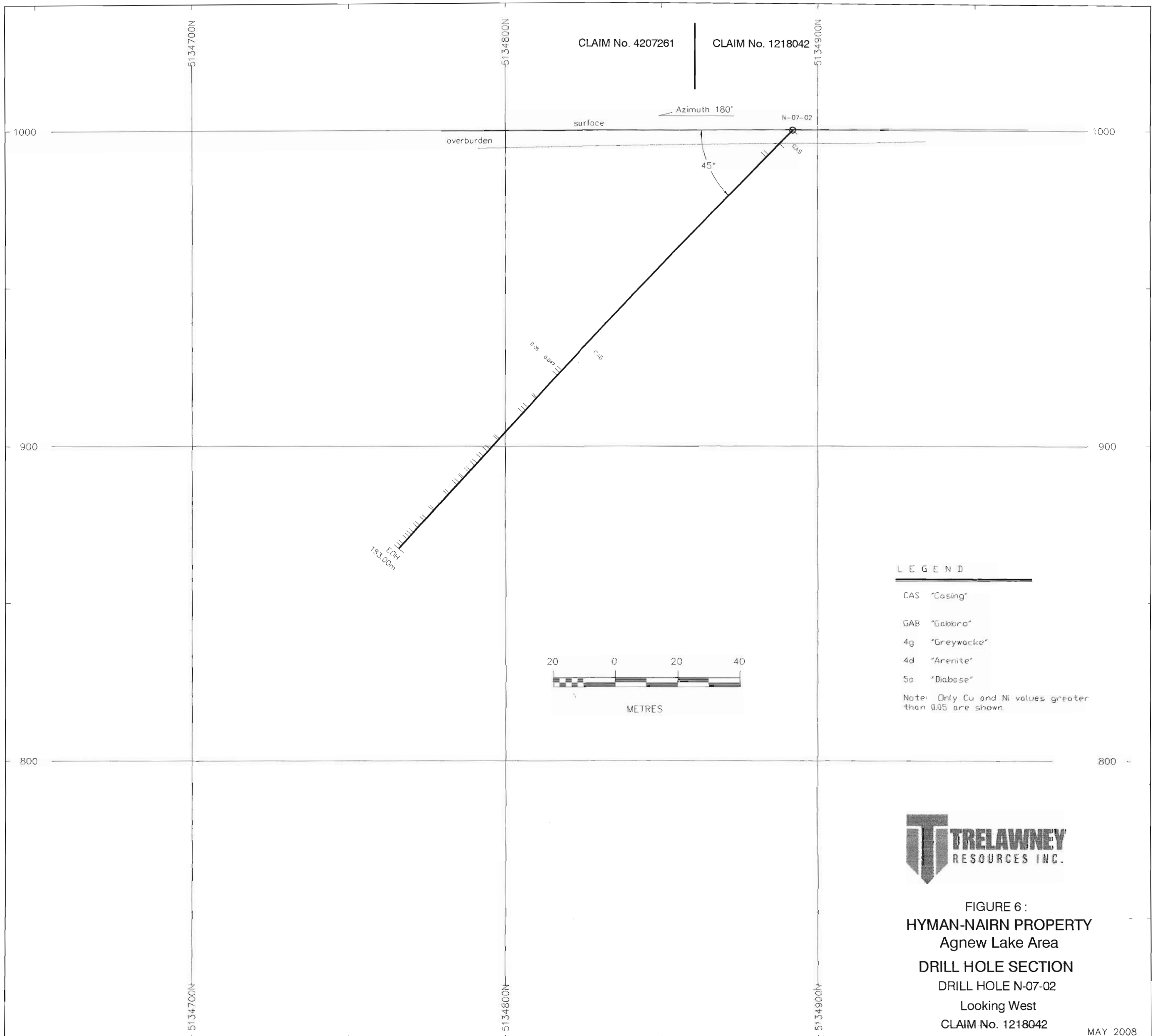

CLAIM No. 4207261

CLAIM No. 1218042

surface Azimuth 180°

N-07-02

overburden

45°

CAS

0.15 0.017

GAB

EQH 133.00m

LEGEND

CAS "Casing"

GAB "Gabbro"

4g "Greywacke"

4d "Arenite"

5a "Diabase"

Note: Only Cu and Ni values greater than 0.05 are shown.



METRES



FIGURE 6 :
HYMAN-NAIRN PROPERTY
Agnew Lake Area
DRILL HOLE SECTION
DRILL HOLE N-07-02
Looking West
CLAIM No. 1218042

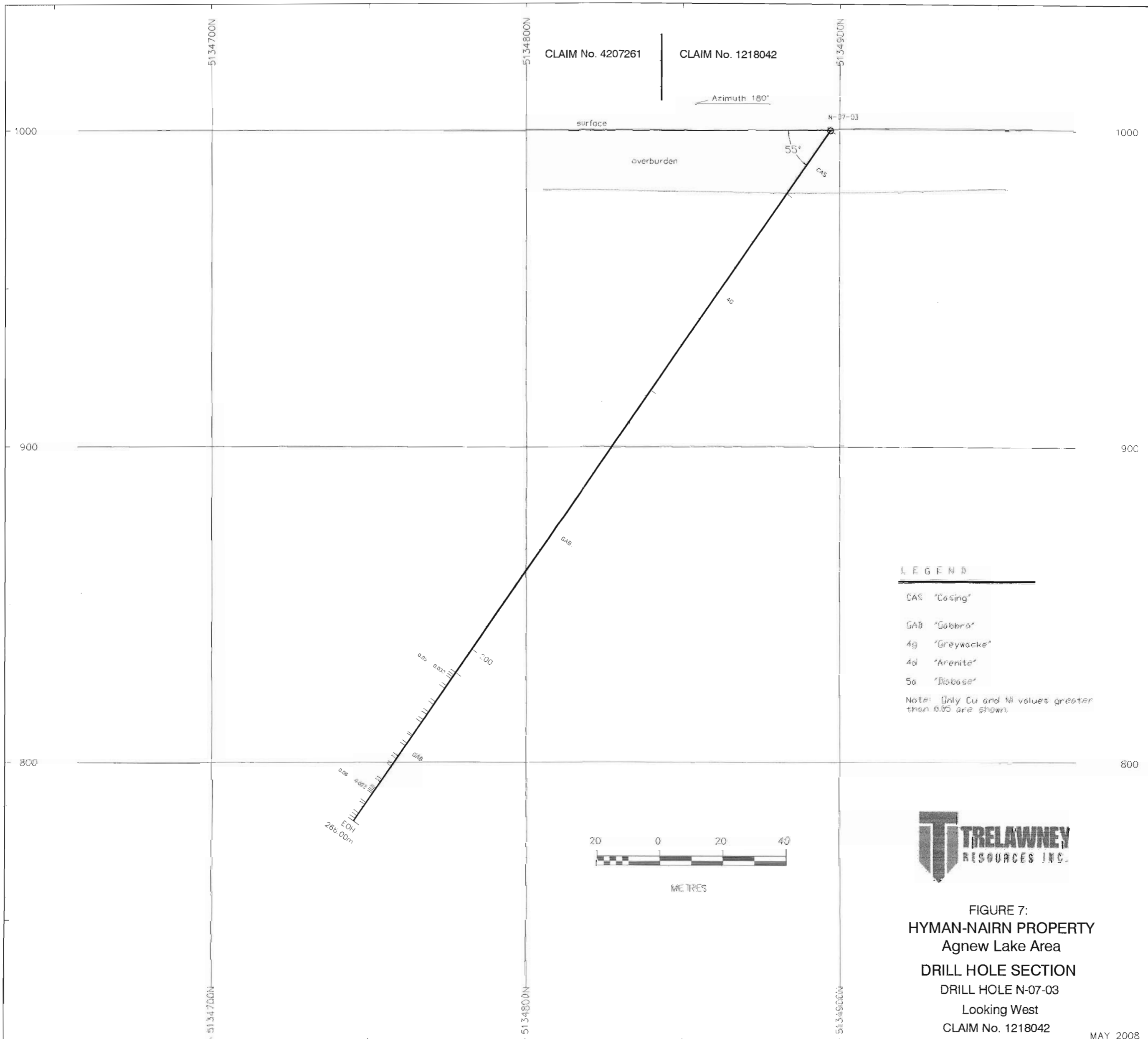

LEGEND

- GAS "Casing"
- GAB "Gabbro"
- 4g "Greywacke"
- 4d "Arenite"
- 5a "Diorase"

Note: Only Cu and Ni values greater than 0.05 are shown.



FIGURE 7:
 HYMAN-NAIRN PROPERTY
 Agnew Lake Area
 DRILL HOLE SECTION
 DRILL HOLE N-07-03
 Looking West
 CLAIM No. 1218042

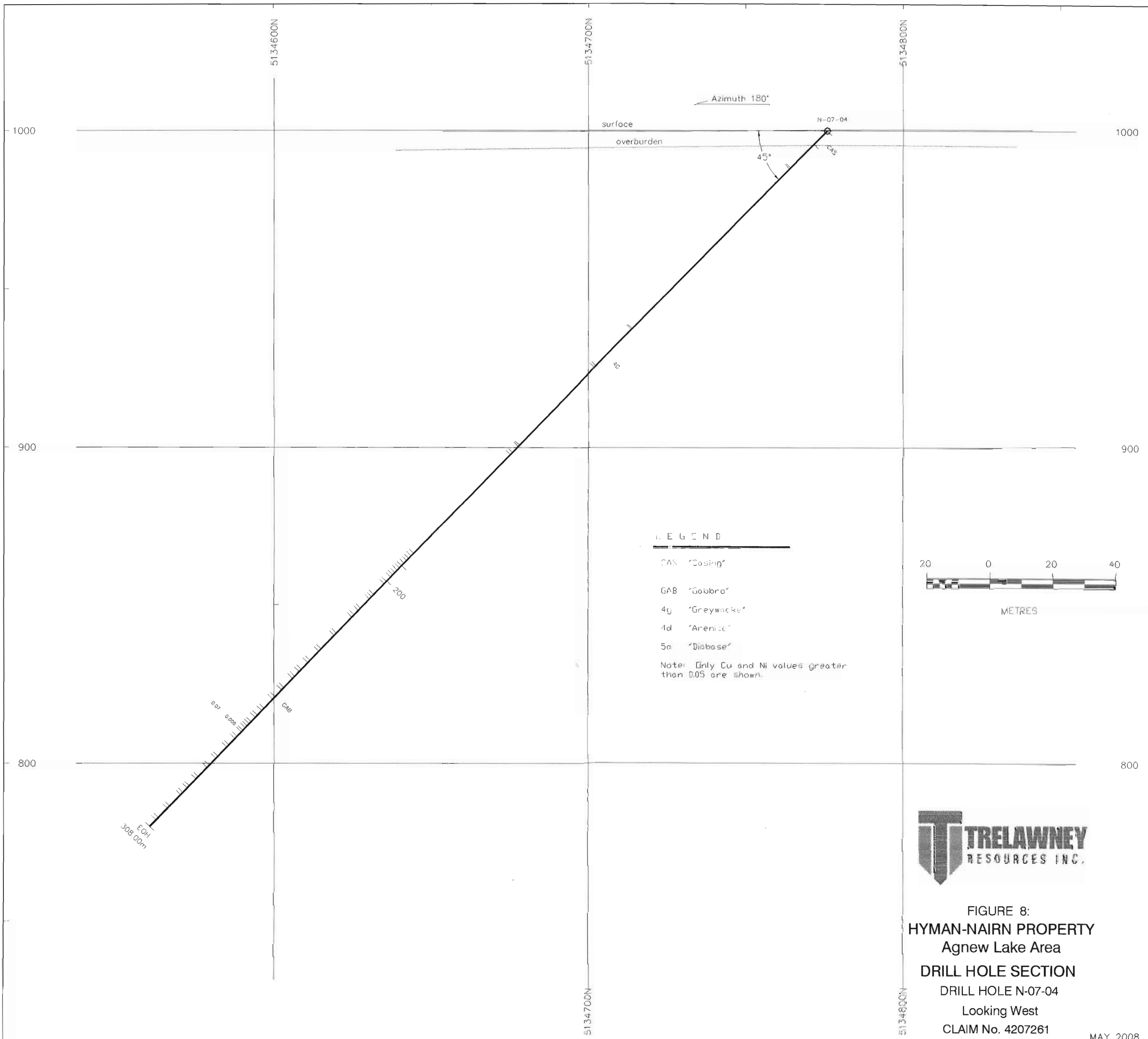

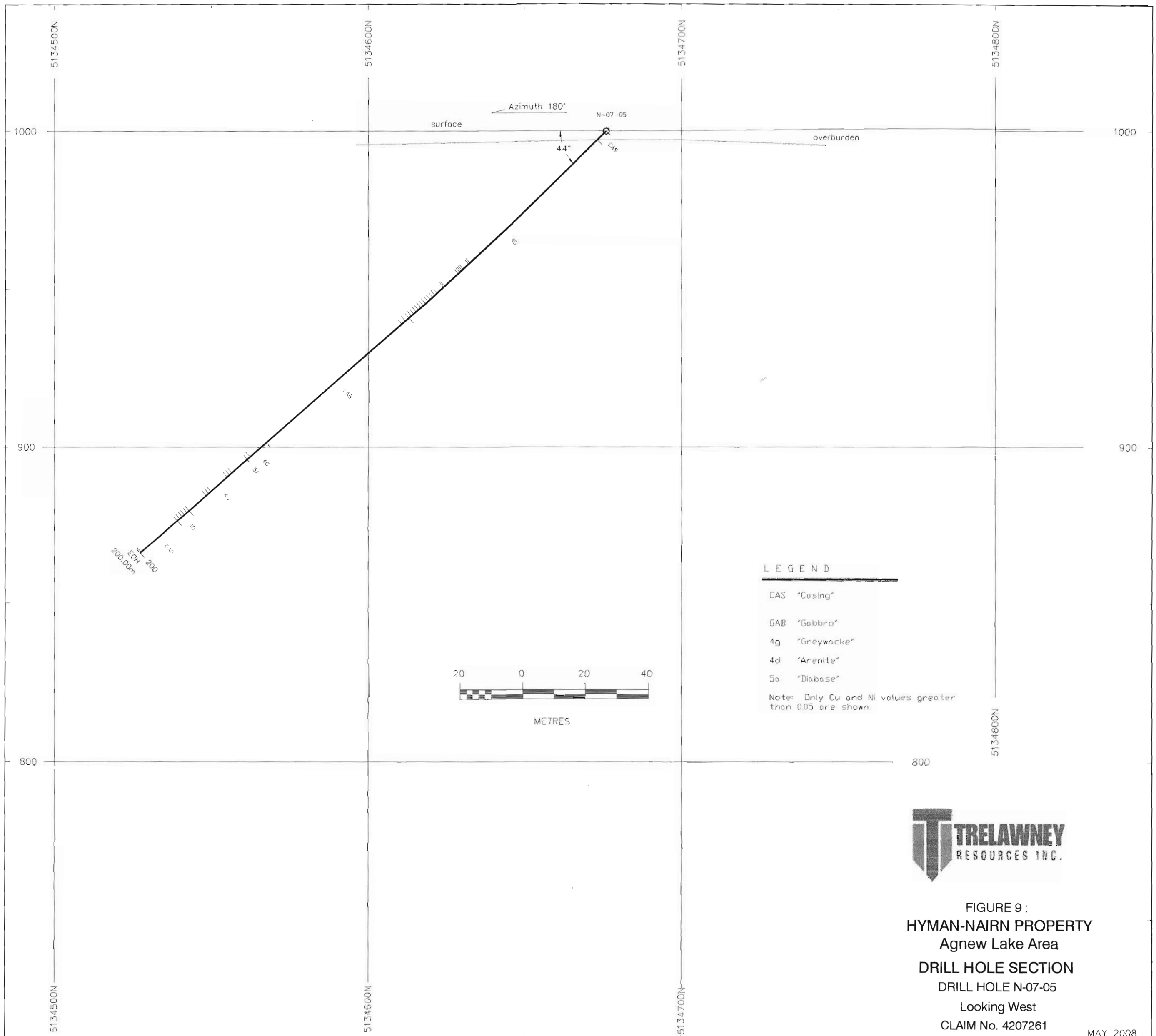

FIGURE 9 :
 HYMAN-NAIRN PROPERTY
 Agnew Lake Area
 DRILL HOLE SECTION
 DRILL HOLE N-07-05
 Looking West
 CLAIM No. 4207261