

**MAX-MIN HORIZONTAL LOOP LEGEND**

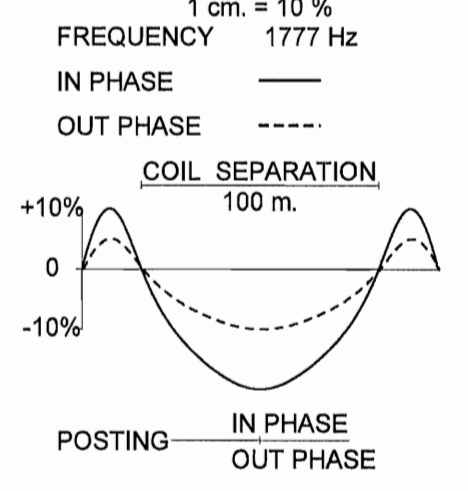

---●--- HLEM CONDUCTOR/AXIS LOCATION AND NAME

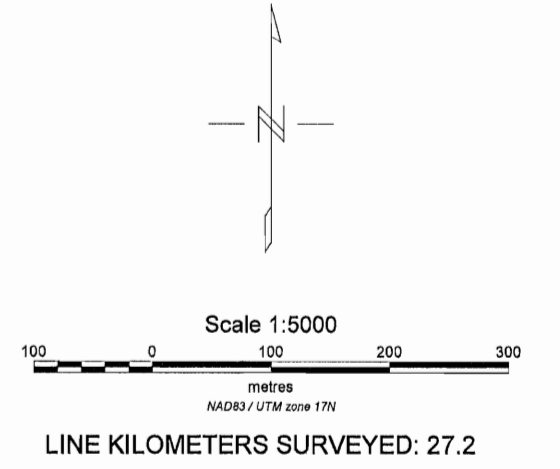

**METALS CREEK RESOURCES CORP.**  
**TILLEX PROPERTY - CURRIE BOWMAN PROJECT**  
**MAX MIN HLEM SURVEYS - 1777 Hz. PROFILES**  
**NORTH, SOUTH AND WEST GRIDS - AUGUST 2008**  
 CURRIE AND BOWMAN TOWNSHIPS - LARDER LAKE MINING DIVISION  
 CLAIMS: POSTED ON MAP  
 NEGATIVE PLOT DIRECTION TO WEST AND SOUTH  
 INSTRUMENT: APEX PARAMETRICS MAX MIN II-5  
**SURVEYED BY: HUSSEY GEOPHYSICS INC.**

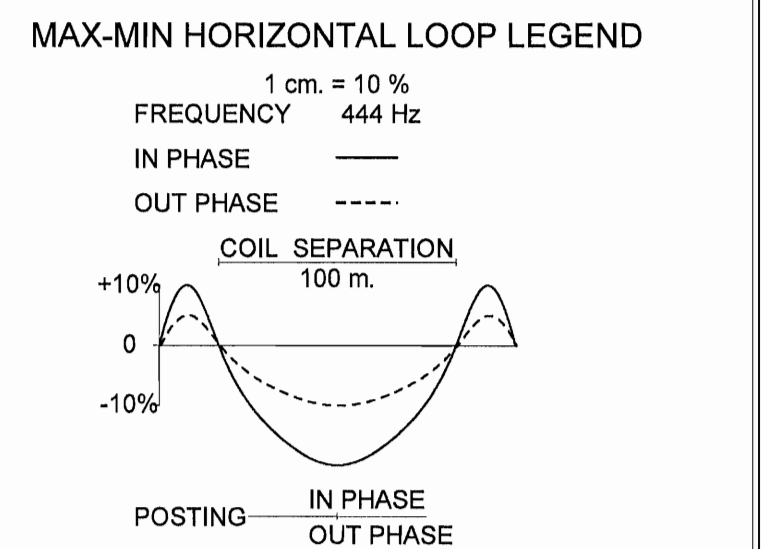
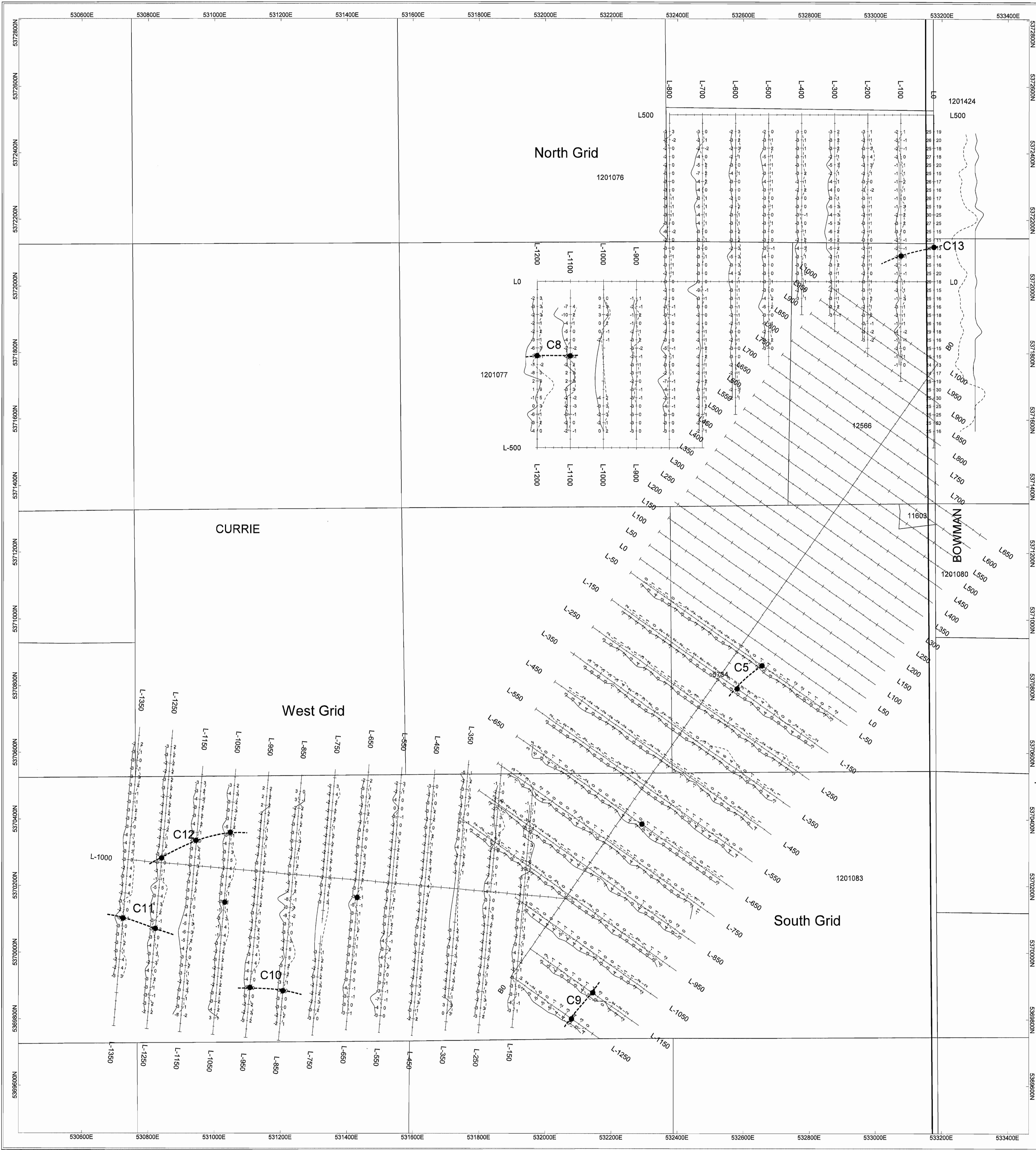

---●--- HLEM CONDUCTOR/AXIS LOCATION AND NAME

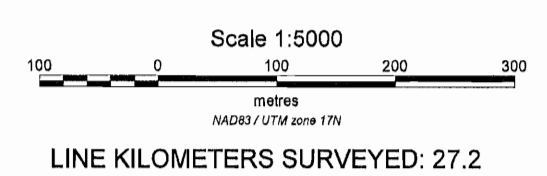
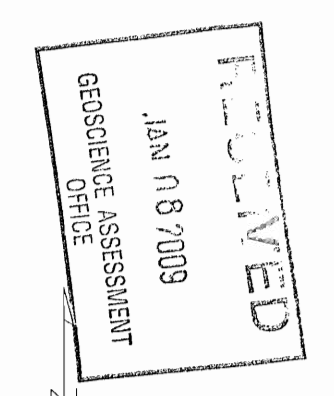

**METALS CREEK RESOURCES CORP.**  
**TILLEX PROPERTY - CURRIE BOWMAN PROJECT**  
**MAX MIN HLEM SURVEYS - 444 Hz. PROFILES**  
**NORTH, SOUTH AND WEST GRIDS - AUGUST 2008**  
 CURRIE AND BOWMAN TOWNSHIPS - LARDER LAKE MINING DIVISION  
 CLAIMS: POSTED ON MAP  
 NEGATIVE PLOT DIRECTION TO WEST AND SOUTH  
 INSTRUMENT: APEX PARAMETRICS MAX MIN II-5  
**SURVEYED BY: HUSSEY GEOPHYSICS INC.**

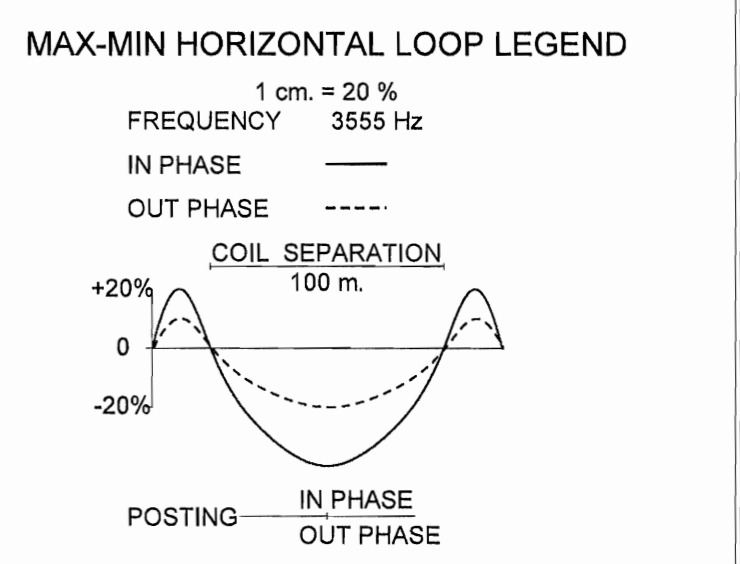
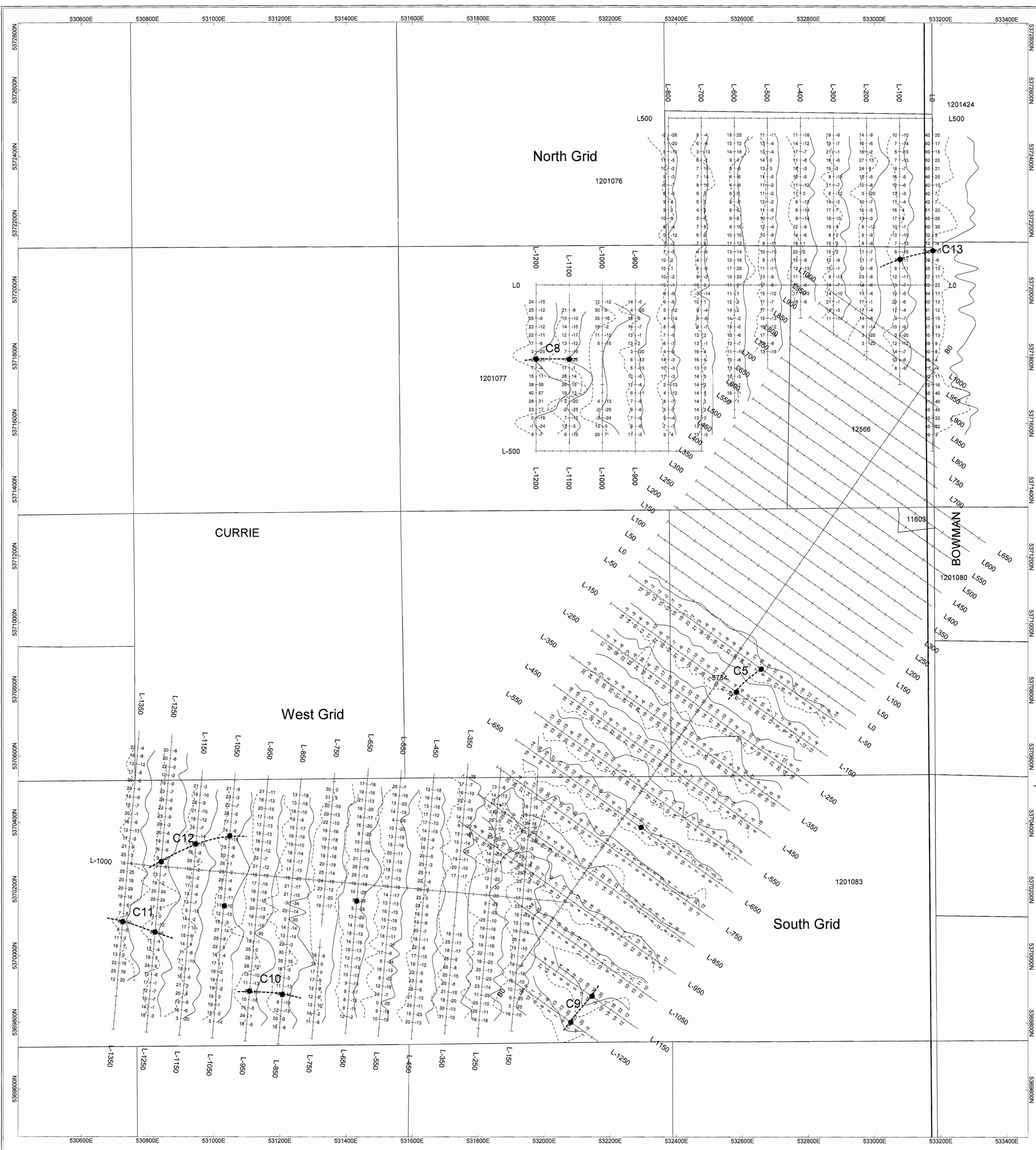

◆ - - - - HLEM CONDUCTOR/AXIS LOCATION AND NAME

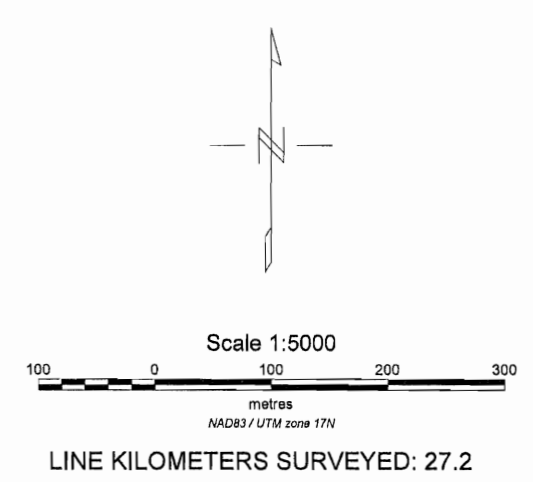

**METALS CREEK RESOURCES CORP.**  
**TILLEX PROPERTY - CURRIE BOWMAN PROJECT**  
**MAX MIN HLEM SURVEYS - 3555 Hz. PROFILES**  
**NORTH, SOUTH AND WEST GRIDS - AUGUST 2008**

CURRIE AND BOWMAN TOWNSHIPS - LARDER LAKE MINING DIVISION  
 CLAIMS: POSTED ON MAP  
 NEGATIVE PLOT DIRECTION TO WEST AND SOUTH  
 INSTRUMENT: APEX PARAMETRICS MAX MIN II-5  
**SURVEYED BY: HUSSEY GEOPHYSICS INC.**