

6378366 Canada Inc. Claims

Zone 1 - 2 MT 18.91% Fe 3.7% P
 Zone 2 - 0.5 MT 22.32% Fe 2.89% P
 Zone 3-4 - 37 MT 21.3% Apatite 0.173% Nb2O5
 Zone 6 - 5 MT 69.6% Magnetite 21.9% Apatite 2.72% REE (to 500')
 Zone 8 - 80 MT 0.25% Apatite (to 800')

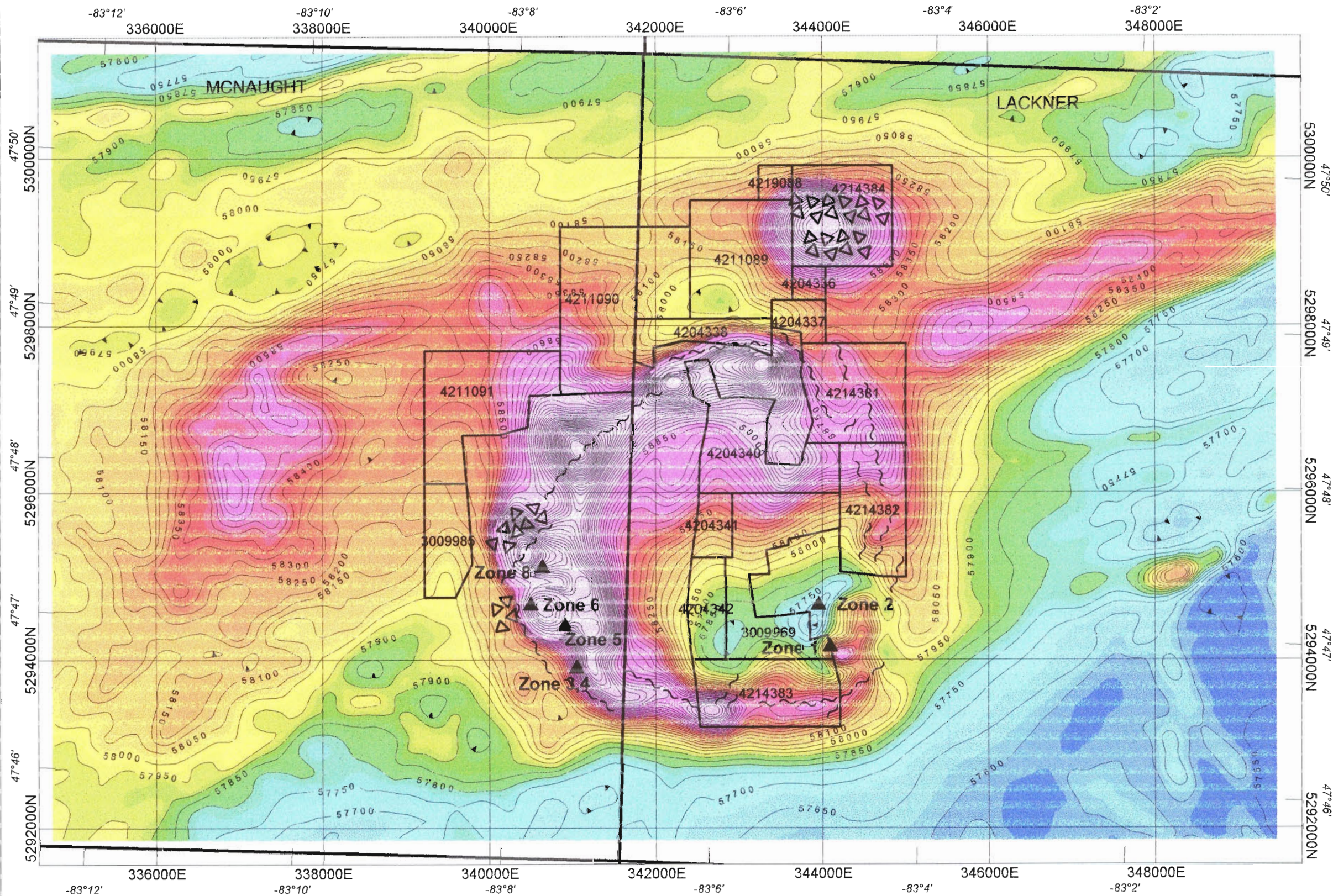

Igolite Breccia
 Foliated Igolite

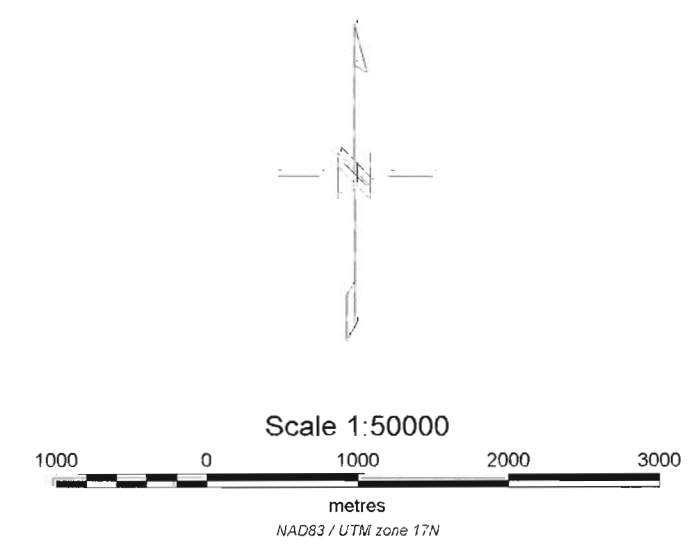

6378366 CANADA INC.

**LACKNER LAKE AREA
 TOTAL FIELD MAGNETICS
 May 2007**

NAD 83 ZONE 17
 PORCUPINE MINING DIVISION - ONTARIO
 Contour Interval = 50, 250 nT
 Lackner Township

DRAWN BY: JOHNSTON GEOPHYSICS

6378366 Canada Inc. Claims

Zone 1 - 2 MT 18.91% Fe 3.7% P
 Zone 2 - 0.5 MT 22.32% Fe 2.89% P
 Zone 3-4 - 37 MT 21.3% Apatite 0.173% Nb2O5
 Zone 6 - 5 MT 69.6% Magnetite 21.9% Apatite 2.72% REE (to 500')
 Zone 8 - 80 MT 0.25% Apatite (to 800')

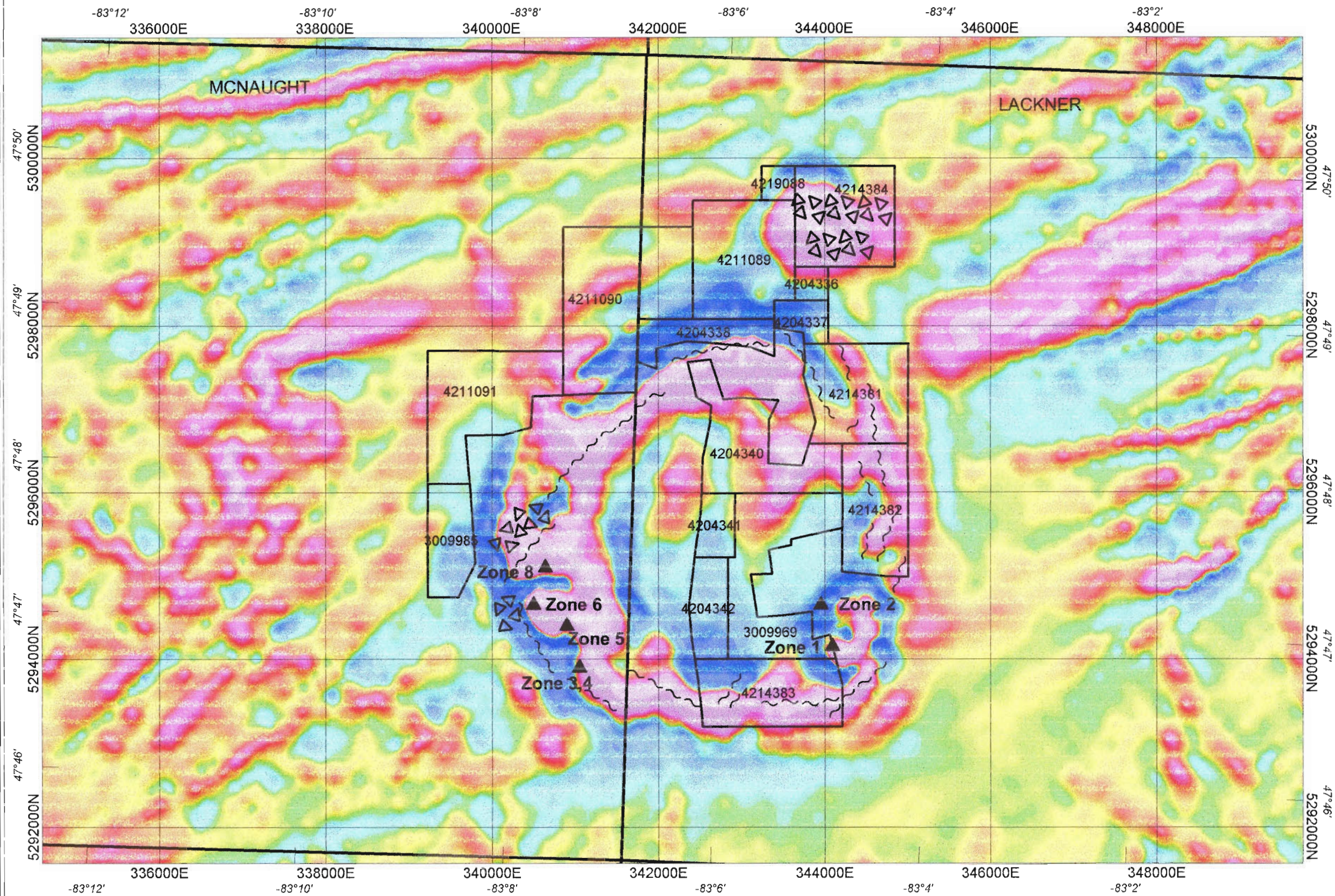

 Igolite Breccia
 Foliated Igolite

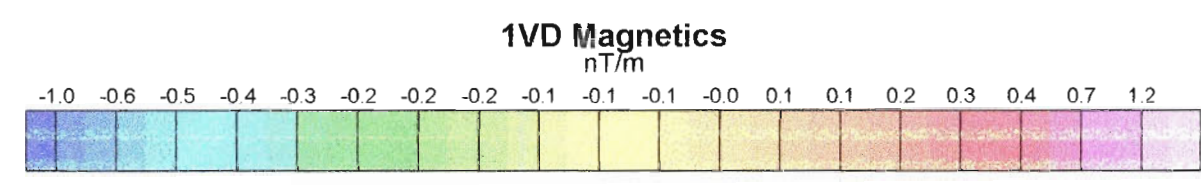
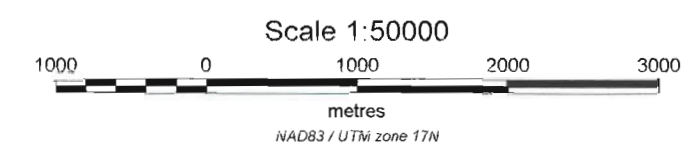
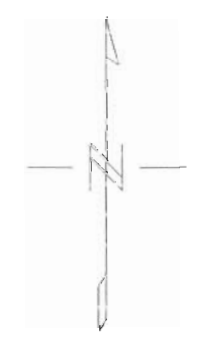

6378366 CANADA INC.

LACKNER LAKE AREA
Calculated 1VD Magnetics
May 2007

NAD 83 ZONE 17
 PORCUPINE MINING DIVISION - ONTARIO
 Shaded Inclination = 65 Declination = 0
 Lackner Township

DRAWN BY: JOHNSTON GEOPHYSICS



6378366 Canada Inc. Claims

Zone 1 - 2 MT 18.91% Fe 3.7% P
 Zone 2 - 0.5 MT 22.32% Fe 2.89% P
 Zone 3-4 - 37 MT 21.3% Apatite 0.173% Nb₂O₅
 Zone 6 - 5 MT 69.6% Magnetite 21.9% Apatite 2.72% REE (to 500')
 Zone 8 - 80 MT 0.25% Apatite (to 800')

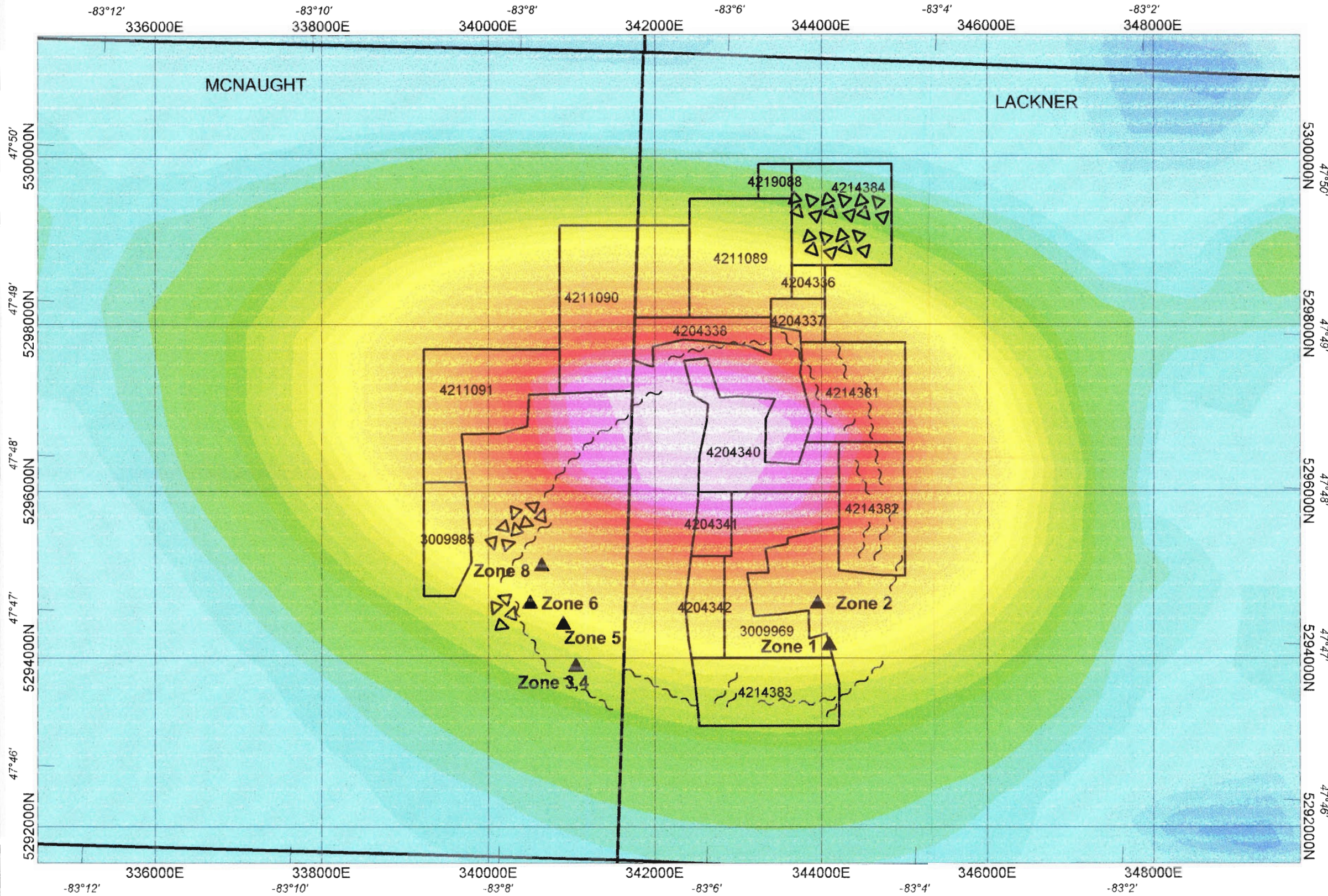

Igolite Breccia
 Foliated Igolite



Scale 1:50000
 1000 0 1000 2000 3000
 metres
 NAD83 / UTM zone 17N

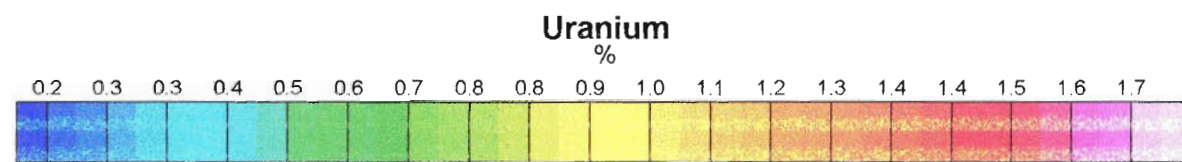

6378366 CANADA INC.

LACKNER LAKE AREA
Equivalent Uranium - GSC Regional Airborne
May 2007

NAD 83 ZONE 17
PORCUPINE MINING DIVISION - ONTARIO

Lackner Township

DRAWN BY: JOHNSTON GEOPHYSICS

RECEIVED

MAY 01 2009

GEOSCIENCE ASSESSMENT
OFFICE

Sample Easting Northing

WDV-08-001 340650.9580 5294674.1020
Samples 369641 369642

WDV-08-002 340637.6330 5294715.7280
Samples 369643 369644

WDV-08-003 340630.7090 5294711.3710
Sample 369645 369646

WDV-08-004 340636.7060 5294724.8660
Samples 369637 369638 369639 369640

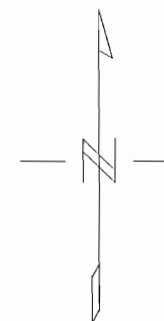
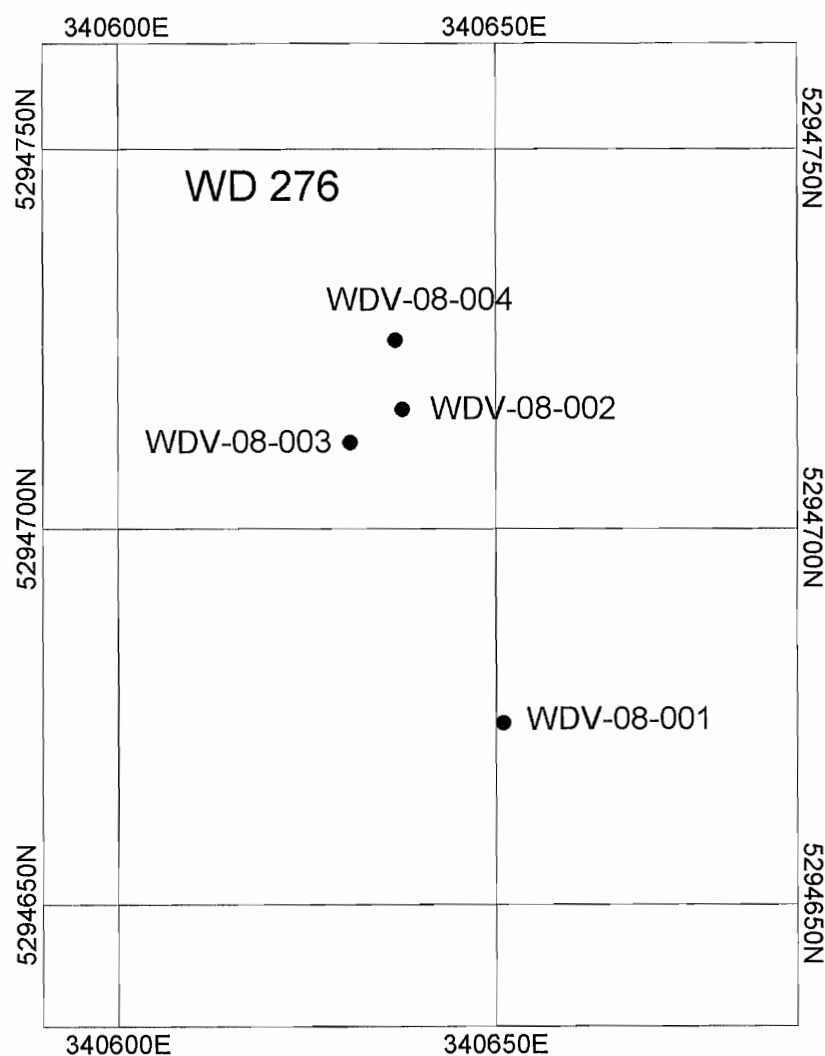

Scale 1:1000
10 0 10 20 30
metres

6378366 Canada Inc.

Lackner Property
2008 Sample Locations - Southwest
Claim Nos: Mining Patent 276 Camp Lake Area

Lackner Township
Porcupine Mining Division
NAD 83 Zone 17 Coordinates

Sampled by: 6378366 Canada Inc. and Vale-Inco

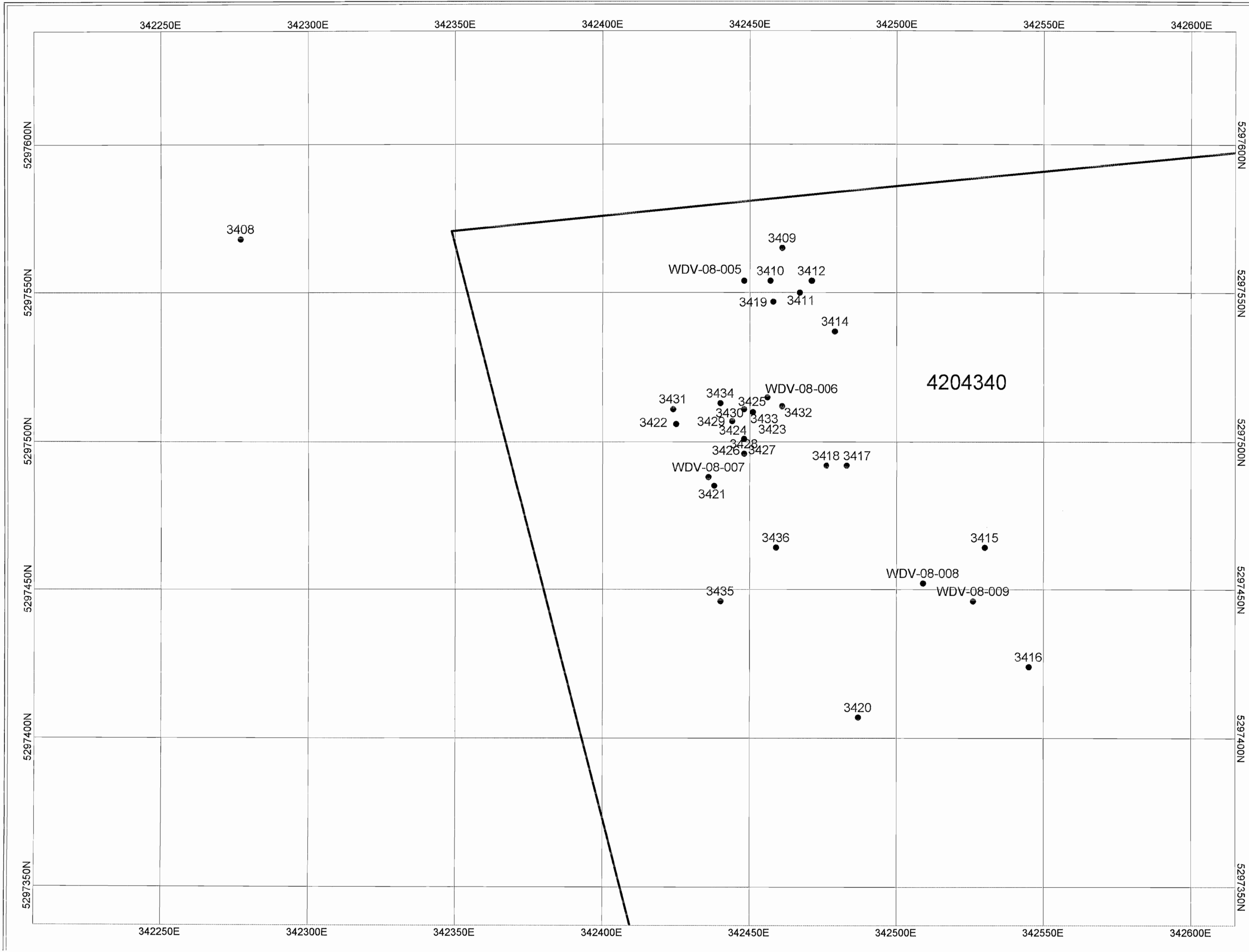

Sample No.	Sample Location Easting	Sample Location Northing
3408	342277	5297568
3409	342461	5297565
3410	342457	5297554
3411	342467	5297550
3412	342471	5297554
3414	342479	5297537
3415	342530	5297464
3416	342545	5297424
3417	342483	5297492
3418	342476	5297492
3419	342458	5297547
3420	342487	5297407
3421	342438	5297485
3422	342425	5297506
3423	342448	5297501
3424	342448	5297501
3425	342448	5297511
3426	342448	5297496
3427	342448	5297496
3428	342448	5297496
3429	342444	5297507
3430	342444	5297507
3431	342424	5297511
3432	342461	5297512
3433	342451	5297510
3434	342440	5297513
3435	342440	5297446
3436	342459	5297464

Vale Inco Samples

WDV-08-001	340650	5294674
WDV-08-002	340637	5294715
WDV-08-003	340630	5294711
WDV-08-004	340636	5294724
WDV-08-005	342448	5297554
WDV-08-006	342456	5297515
WDV-08-007	342436	5297488
WDV-08-008	342509	5297452
WDV-08-009	342526	5297446

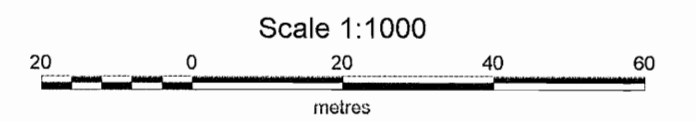
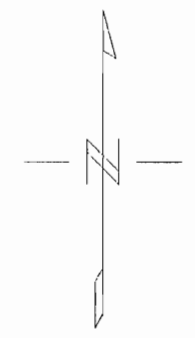

6378366 Canada Inc.
 Lackner Property
 2008 Sample Locations - Northeast
 Claim Nos: Posted on Map
 Lackner Township
 Porcupine Mining Division
 NAD 83 Zone 17 Coordinates
 Sampled by: 6378366 Canada Inc. and Vale-Inco