

Prospecting Report

January 29, 2009

Todd Mathieu

Owaissa Property

Best Township/Strathy Township

Sudbury Mining Division

2.40309

Table of Contents

Property Location	Page 3
Access	Page 3
Owaissa Claim Group	Page 3
Brief Summary of Work Completed, Theories, Discoveries	Page 3 - 4
Forward Looking Statements.....	Page 4
Appendix.....	Page 5-31

Property Location

The property is located approximately 11 km north of the town of Temagami and approximately 108 km north of the town of North Bay. The property resides in the south part of Best Township and the north part of Strathy Township.

Access

There is excellent access to most portions of the property.

On the north section access is gained through the use of the Whispering Pines cemetery road. Where the road hits the pipeline it turns into an ATV/walking trail that proceeds to Owaissa Lake. There is also a portage trail branching off shortly before Owaissa Lake that heads north to a tiny lake on the north portion of the claims. In late 2006 Temex Exploration proceeded to open up a skidder/drill road that proceeds north of the claim group off of this ATV/walking trail.

On the south part of the Owaissa property access is gained via Red Squirrel road and or by boat via Net Lake or Black Duck Lake.

Owaissa Property Claim Group

The Owaissa property currently consists of 9 claim blocks totalling 76 claims. The property consists of the following claim blocks.

4212255 – block of 8 – Best twp.
1223732 – block of 9 – Best twp.
1223731 – block of 6 – Best twp.
4227412 – block of 12 – Best twp.
4212254 – block of 2 – Best twp.
4227417 – block of 9 – Best/Strathy twp.
1223725 – block of 6 – Strathy twp.
4212253 – block of 8 – Strathy twp.
4227393 – block of 16 – Strathy twp.

Brief Summary of Work Completed, Theories, Discoveries,

The Owaissa property begins approximately 2.6 km northeast of the Kanichee mine (past producer - old Ajax property). The property continues for approximately 7km to the northeast. Most geologic structures on the property appear to be trending directly north or northeast. This leads me to believe that the Owaissa property is on trend with the Kanichee mine and may contain similar geological structures. Further north of the property lies the Latchford Gold Project (notably the location of the 6,222 g/t Au chip sampled boulder containing VG) held by Temex Exploration.

In an attempt to perform geophysics over the Mathieu showing discovered in 2007 a small chained and flagged grid was established in January of 2008. Due to equipment failure only 2km of 12.5 meter spacing magnetic surveying was performed on the northeasterly portion of the grid. This work will not be accounted for within this report due to insufficient data to plot. However the data provided by the 2km of magnetic surveying, although to the east of the Mathieu showing, did however indicate several narrow/localized bands of high and low magnetic responses. These areas were followed up with summer prospecting. Unfortunately most of the key areas turned out to be covered by overburden and glacial till.

In October a small backpack drill was purchased with the intent to drill several shallow 5-8ft sampling holes in the vicinity of the Mathieu showing. The drill turned out to be inadequate and only 3 very shallow holes were drilled. Due to financial constraints, assays will not be sent out till later in 2009.

In addition to prospecting and a bit of trenching at the Mathieu showing, Y vein, a field visit by Richard Bret from Temex Exploration also took place. Mr. Bret very thoroughly sampled the area containing the Mathieu showing and further north on the Owaissa property. Karen Reese, P. Geo and General Manager of Temex Exploration was kind enough to provide the field results from the technical analysis of the property and they have been included within this report. The field analysis completed by Temex Resources to me suggests that the increase gold values at the Mathieu showing seem to be associated with increased quantities of pyrite, iron/rust and quartz alterations. Ian Taylor, President of Temex Resources upon review of the data and a property visit has indicated that I should work towards performing VLF-EM geophysics over the Mathieu showing to help delineate any sort of structure that might be carrying the poly metallic mineralization. Please refer to the appendix for technical data/evaluation notes from Temex Exploration.

Forward Looking Statements

No significant new discoveries were located over the course of 2008 prospecting and I was unable to borrow/afford the necessary equipment/personnel to perform the geophysics required to outline any structure that might be housing the poly metallic mineralization.

It is still my belief that the Owaissa property has been under explored. I continue to work towards optioning the property or locating additional funding to advance the exploration project.

Daily Log
July 2008 to November 2008
Owaissa Property
Best Township/Strathy Township
Sudbury Mining Division

Participants

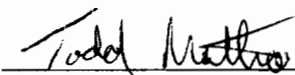
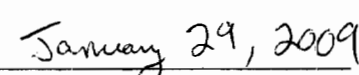
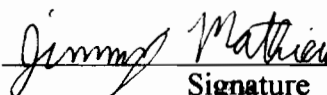
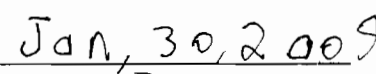
Todd Mathieu	 _____ Signature	 _____ Date
Jimmy Mathieu	 _____ Signature	 _____ Date

· July 25, 2008 I traveled to Temagami and mobilized equipment including a boat at the shore of Black Duck Lake.

July 26, 2008 met Richard Bret at beginning of Red Squirrel Road and proceeded to Mathieu showing along Red Squirrel Road. At the site I walked Richard through my sample locations, retrieved necessary equipment to clear away additional water and debris from around trenches and sampling locations. At the end of the day we quickly sampled the lamprophyre dikes on the opposite shore of Black Duck Lake. Assays results/field notes from Richard Bret are included within this report.

Sample	East N27	North N27	Magnetic properties	Description	Property	Certificate No	Au gpt	Au chk gpt	Pt gpt	Pd gpt	AuAve gpt
16317	592346	5221641	high in places	25 cm dyke fracture altered area in diabase, diabase is not magnetic. strike 60 deg, dip 90 deg, 2% chalcopyrite in places, pyrite and pyrrhotite	polymetallic	8W-2296-RA1	13.03	NA	0.01	0.01	13.03
16318	592346	5221643	none to low	2% chalcopyrite, bornite in diabase, some quartz	polymetallic	8W-2296-RA1	11.25	8.91	nil	0.02	10.08
16319	592346	5221645	none	rusty gabbro / diabase	polymetallic	8W-2296-RA1	1.08	NA	0.03	0.02	1.08
16320	592398	5221634	none	rusty fracture in diabase	polymetallic	8W-2296-RA1	3.64	3.43	0.02	0.03	3.54
16321	592379	5221608	none	rusty fracture in diabase, 2 cm wide, 2% fine pyrite rusty fracture in diabase, 5 cm wide, 1% pyrite chalcopyrite, strike 360 deg, dip 66 deg, east "splay"	polymetallic	8W-2296-RA1	6.58	8.09	0.03	0.02	7.34
16322	592293	5221623	none	quartz, some carb in altered diabase	polymetallic	8W-2296-RA1	1.51	NA	0.01	0.02	1.51
16323	592712	5221675	none		polymetallic	8W-2296-RA1	0.02	NA	nil	0.01	0.02
16324	587154	5221144	low to high in places	sulphide rich mafic volcanic, 1% pyrite trench #1	base metal	8W-2296-RA1	0.02	NA	nil	nil	0.02
16325	587183	5221185	none to high	sulphide rich mafic volcanic, 1% pyrite trench #1	base metal	8W-2296-RA1	0.02	NA	0.02	0.02	0.02
16326	587063	5221126	high in places	sulphide rich mafic volcanic, 1% pyrite trench #2	base metal	8W-2296-RA1	0.01	NA	0.01	0.02	0.01
16327	586958	5220963	high in places	sulphide rich mafic volcanic, 1% pyrite trench #3 quartz veins up to 20 cm wide, chalcopyrite, trench #4, strike 20 deg, dip 80 deg to east	base metal	8W-2296-RA1	0.01	NA	nil	nil	0.01
16328	586833	5220894	low to medium	Black Duck Lake lamprophyre in granite, not assayed	Mathieu	NA	NA	NA	NA	NA	NA
16329	592200	5223814	none								
16330	592305	5221610	none	17 cm fracture in diabase, 1 cm quartz veinlet, strike 320 deg, dip 80 deg to east 5 cm quartz vein, rusty in diabase, strike is variable, 328 deg / 10 deg / 30 deg, dip is 80 deg to east	polymetallic	8W-2296-RA1	0.28	NA	nil	nil	0.28
16331	592311	5221613	none		polymetallic	8W-2296-RA1	6.58	5.21	nil	nil	5.90
16332	592343	5221636	very low	2 cm fracture in diabase, strike 70 deg, dip 86 deg to S, pyrrhotite, pyrite 2% seen	polymetallic	8W-2296-RA1	0.28	NA	nil	0.01	0.28
16333	592351	5221620	high in places	1 cm rusty fracture in diabase, strike 78 deg, dip 88 deg E	polymetallic	8W-2296-RA1	0.99	0.66	0.02	0.02	0.83
16334	592180	5221584	low to high	diabase coarse, Matachewan / Sudbury?	polymetallic	8W-2296-RA1	0.01	NA	nil	nil	0.01
16335	593140	5223040	none	diabase granite contact	polymetallic	8W-2296-RA1	0.04	NA	0.04	0.05	0.04
16336	593389	5223121	none	fracture in granite, 1% pyrite	polymetallic	8W-2296-RA1	0.01	NA	nil	nil	0.01
16337	593456	5223162	none	granite quartz alteration, chalcopyrite, med dark, strike 30 deg, dip 80 deg to east	polymetallic	8W-2296-RA1	0.01	NA	0.01	0.01	0.01
16338	593400	5223011	none	fractures in med dark granite pyrite, strike 80 deg?	polymetallic	8W-2296-RA1	0.01	NA	0.02	0.03	0.01

Sample	Ag ppm	Al %	As ppm	Ba ppm	Be ppm	Bi ppm	Ca %	Cd ppm	Co ppm	Cr ppm	Cu ppm	Fe %	Hg ppm	K %	La ppm	Mg %	Mn ppm	Mo ppm	Na %	Ni ppm	P ppm	Pb ppm	S %	Sb ppm	Sc ppm	Sr ppm	Th ppm	Ti %	Tl ppm	U ppm	V ppm	W ppm	Zn ppm	Zr ppm
16317	41.9	2.22	1170	20	<0.5	<5	0.46	21	691	116	>10000	14.08	<1	0.02	<10	1.55	448	5	0.05	72	2566	132	6	<5	5	6	8	0.11	<10	22	71	<10	238	36
16318	59.8	2.72	>10000	10	<0.5	<5	1.03	206	7417	171	>10000	13.07	6	0.01	<10	2.33	651	<2	0.02	186	5319	171	6	<5	7	5	5	0.08	<10	23	91	<10	411	15
16319	1.1	2.65	84	33	<0.5	<5	1.1	1	72	113	942	4.58	<1	0.12	<10	1.96	466	<2	0.14	70	344	19	0.11	<5	4	26	<5	0.16	<10	<10	92	<10	67	8
16320	16.7	2.84	1087	<10	<0.5	<5	0.71	19	669	409	>10000	8.52	<1	0.01	<10	2.86	580	<2	0.04	160	753	59	3.31	<5	8	20	<5	0.19	<10	10	111	<10	66	20
16321	48.7	2.07	>10000	12	<0.5	<5	0.44	207	5654	231	>10000	14.8	4	0.01	<10	2.04	395	<2	0.04	511	1293	104	6	<5	6	15	<5	0.12	<10	20	95	<10	70	23
16322	26.8	1.73	26	20	<0.5	<5	1.09	<1	166	81	>10000	8.9	<1	0.03	<10	1.29	293	<2	0.08	97	1177	65	4.94	<5	5	37	<5	0.14	<10	<10	73	<10	28	16
16323	<0.2	0.85	29	<10	<0.5	<5	0.05	<1	20	186	145	1.9	<1	0.02	<10	1	248	<2	0.04	12	220	<2	0.05	<5	1	1	<5	0.04	<10	<10	17	<10	20	5
16324	0.9	1.12	17	<10	<0.5	<5	0.73	<1	58	173	493	5.41	<1	0.04	<10	0.9	545	<2	0.06	50	320	30	1.34	<5	6	5	<5	0.38	<10	<10	114	<10	30	6
16325	4.8	1.34	9	15	<0.5	<5	0.74	<1	148	131	3227	12.63	<1	0.04	<10	1.03	603	<2	0.06	139	580	332	6	<5	6	8	<5	0.35	<10	17	102	<10	314	10
16326	0.2	0.95	<5	<10	<0.5	<5	1.12	<1	46	120	747	5.67	<1	0.04	<10	0.48	618	<2	0.08	68	401	7	1.89	<5	6	10	<5	0.3	<10	<10	71	<10	68	4
16327	0.7	1.35	<5	13	<0.5	<5	0.9	<1	65	191	547	7.06	<1	0.04	<10	0.67	649	<2	0.05	64	401	22	1.69	<5	5	14	<5	0.27	<10	11	77	<10	60	5
16328	1.0	1.17	17	13	<0.5	<5	0.64	<1	48	224	905	5.48	<1	0.04	<10	0.83	611	5	0.04	50	274	20	0.92	<5	4	3	<5	0.17	<10	<10	75	11	658	5
n.a.	NA	NA	NA	NA	NA	NA	NA	NA	NA	NA	NA	NA	NA	NA	NA	NA	NA	NA	NA	NA	NA	NA	NA	NA	NA	NA	NA	NA	NA	NA	NA	NA	NA	NA
16330	<0.2	2.13	<5	17	<0.5	<5	0.24	<1	27	147	56	4.04	<1	0.17	11	2.32	240	6	0.09	88	370	2	0.02	<5	7	5	<5	0.14	<10	<10	142	<10	24	30
16331	7.8	1	324	19	<0.5	28	0.42	6	20	185	491	4.07	<1	0.05	<10	0.75	164	4	0.07	24	331	5	0.13	<5	3	15	<5	0.1	<10	<10	51	<10	<1	11
16332	8	3.1	327	13	<0.5	<5	0.44	4	375	154	6596	10.59	<1	0.03	<10	3.19	594	<2	0.05	73	579	29	3.99	<5	9	13	<5	0.18	<10	15	128	<10	57	20
16333	12	1.93	108	70	<0.5	8	0.75	1	31	144	4481	10.18	<1	0.27	<10	1.52	222	<2	0.08	17	467	26	0.95	<5	6	24	<5	0.19	<10	12	116	<10	24	22
16334	<0.2	3.21	22	21	<0.5	<5	2.48	<1	71	29	147	10.91	<1	0.07	38	1.97	1770	<2	0.04	55	7440	6	0.04	<5	5	27	<5	0.53	<10	<10	147	<10	74	14
16335	<0.2	1.44	<5	25	<0.5	<5	0.87	1	27	83	74	3.39	<1	0.04	<10	1.23	548	<2	0.03	45	446	223	0.02	<5	2	18	<5	0.3	<10	<10	73	<10	525	16
16336	<0.2	0.67	14	50	<0.5	<5	0.22	<1	11	117	36	3.19	<1	0.12	14	0.33	288	<2	0.05	6	635	24	0.39	<5	3	13	<5	0.15	<10	<10	23	<10	21	5
16337	<0.2	2.31	<5	12	<0.5	<5	0.1	<1	15	121	1832	5.47	<1	0.02	<10	2.19	642	<2	0.04	36	453	4	0.17	<5	4	1	<5	0.07	<10	10	32	<10	86	9
16338	<0.2	1.34	<5	22	<0.5	<5	0.02	<1	10	156	17	3.94	<1	0.06	<10	1.3	323	<2	0.03	13	354	6	0.4	<5	1	<1	<5	0.03	<10	<10	17	<10	55	6

Date: July 2008

Team members:

Richard Bret Samples

Interesting Discoveries:

Legend

Symbol	Description
	Outcrop
*	sample name and sample location
→	direction of line traversed



Declination
11° 25' West

Scale
1 inch = 200m

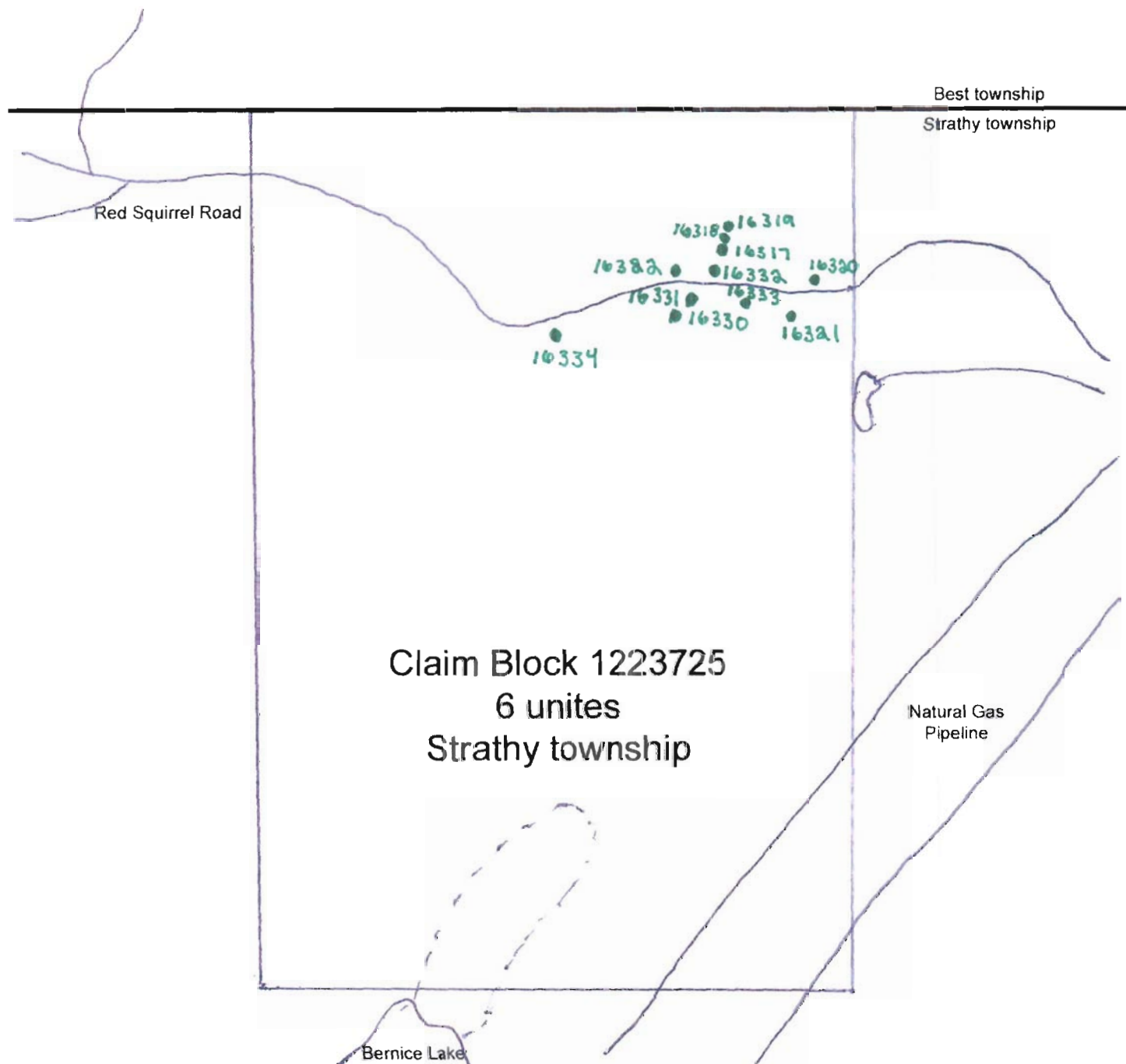
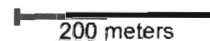



Date: July 2008

Team members:

Richard Bret Sampling

Interesting Discoveries:

Legend

Symbol	Description
	Outcrop
	sample name and sample location
	direction of line traverse



Declination
11° 25' West

Scale
1 inch = 200m

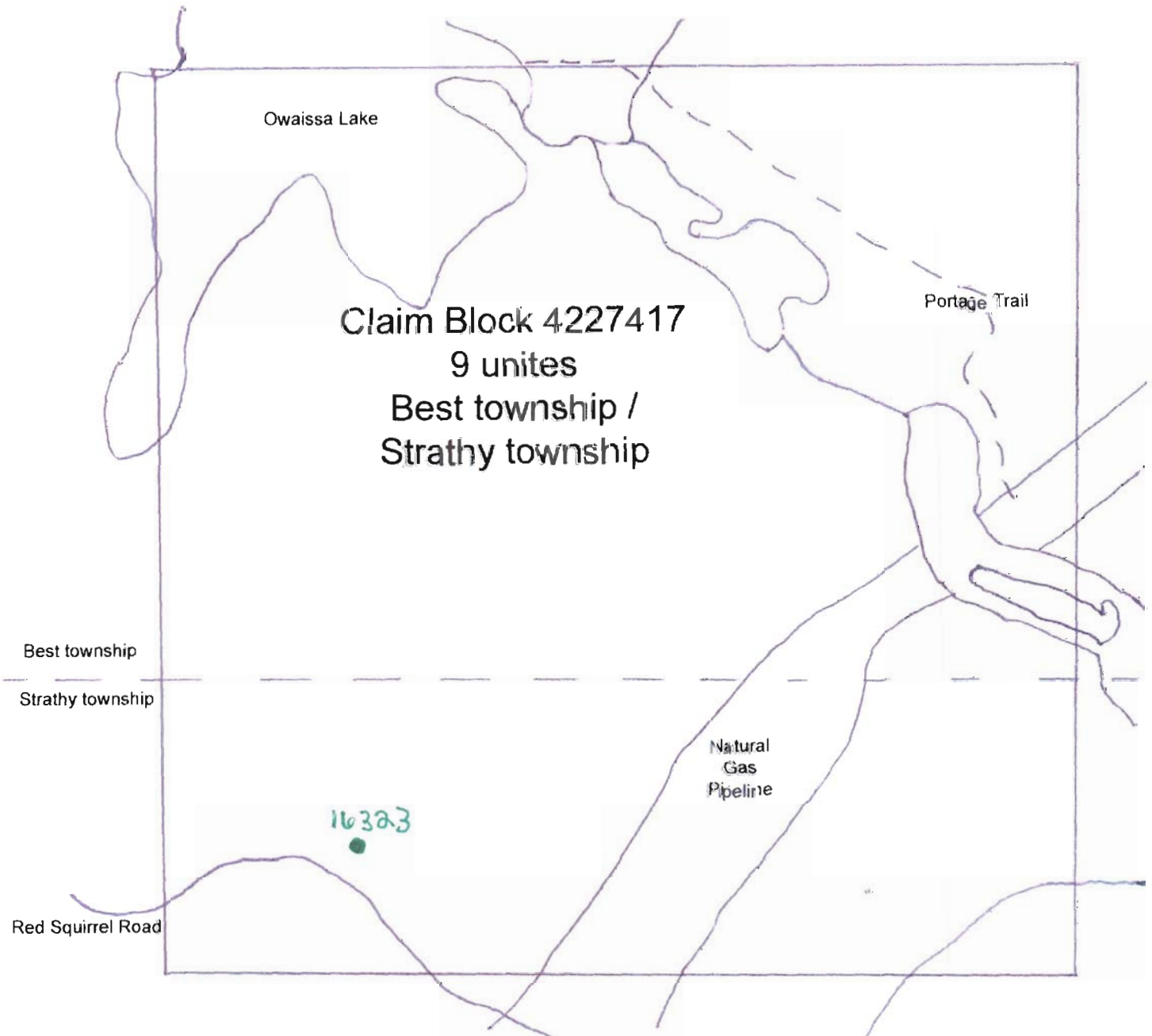
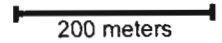



Date: July 2008

Team members:

Richard Bret Sampling

Interesting Discoveries:

Legend

Symbol	Description
	Outcrop
	sample name and sample location
	direction of line traversed



Declination
11° 25' West

Scale
1 inch = 200m

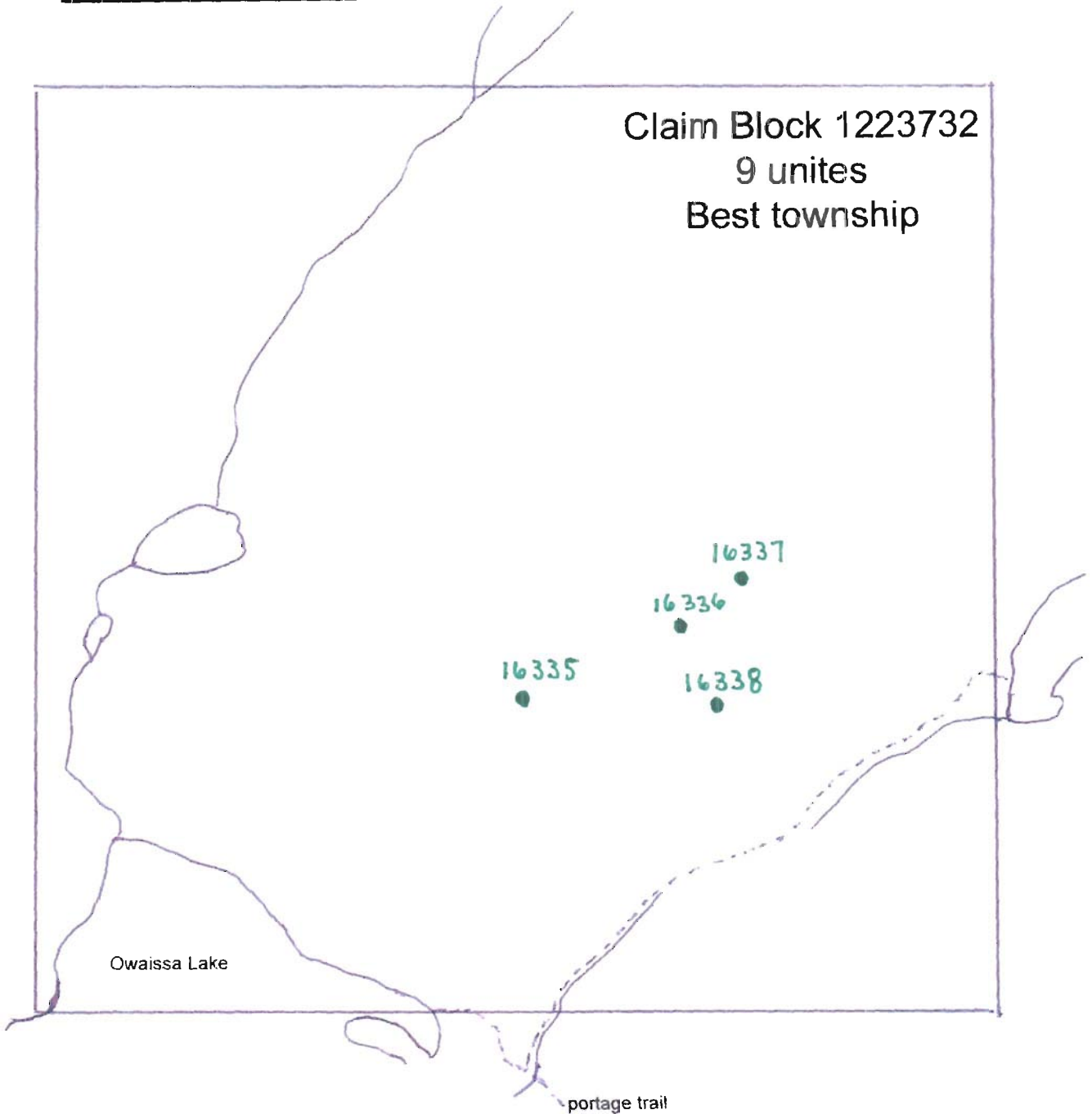
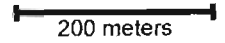

- August 16, 2008 - We mobilized equipment to Black Duck Camp.

August 19, 2008 Jimmy Mathieu and I proceeded via ATV to the east side of the Mathieu showing on Red Squirrel Road at the location of the north/south claim line between 1223725 and 4227417. From here we traversed north for approximately 200 meters and then northeast weaving back and forth in separate patterns. As we intersected the previously flagged grid lines we stopped to verify key magnetic points indicated from a short magnetic survey that remained uncompleted and un plotted due to equipment failure earlier in January 2008. Most of this area is pine to cedar swamp covered by overburden. All visible boulders were scraped and chip sampled. On the northwest portion of the ground prospected there was a granite ridge running in a northeasterly direction containing nothing of interest. At the flagged grid line furthest east there was another small granite outcrop with nothing of interest. Off the edge of this outcrop Jim did locate a pile of glacial till that appeared to be mafic and contain what appears to be pyrrhotite. We attempted to dig down through the till, but the depth was undeterminable. We worked our way back along/through the cedar swamp along Red Squirrel road. We ended our day by clearing away additional moss from quartz veins and what appears to be a trench at the location of the ATV just slightly off Red Squirrel road. There are at least 3 separate quartz veins with no metallic mineralization present. This location should be further stripped and sampled due to the proximity to the Mathieu showing and the quantity of quartz.

Todd 1 day (claim blocks 1223725 and 4227417)

Jim 1 day (claim blocks 1223725 and 4227417)

August 20, 2008

I proceeded via ATV to the Mathieu showing along Red Squirrel Road to work on deepening the Y vein trench. At the deepest portion of the trench there is still chunks of rock that have filled in the hole and I have not hit bedrock as of yet. This portion of the vein is only 2-3 inches wide, but contains large quantities of quartz, iron (rust) and sulphides. I spent half the day slightly widening the trench and deepening it by more than a foot. The sulphides have become much more colourful and concentrated. Several display samples were removed to provide a visual cue in the hopes to obtain an option. I also left several portions exposed for future sampling purposes. Massive rich visual mineralization is present in the form of chalcopyrite and bornite.

Todd ½ day (claim block 1223725)

August 21, 2008 I proceeded via ATV to the north portion of the Owaissa property on the north part of claim 4227417. I used the Whispering Pines Cemetery road/trail to proceed towards Owaissa Lake. Here I proceeded to examine the sediments and boulders within the streambed of a little creek that flows down into a beaver dam and then into Owaissa Lake. I started at the trail on the southeast bank and worked my way down to the little beaver pond. I then reversed sides and followed the stream back up above the trail to where it becomes cedar swamp and then switched sides and continued back down to the trail. I then proceed to hike approximately 350 meters up the drill road created by Temex Resources in 2006, but as the ground was mostly swamp with round boulders I eventually called it a day and headed back to camp. Nothing of interest was noted.

Todd = 1/2 day (claim block 4227417)

We demobilized and drove back to North Bay on August 24, 2008

Mileage = 398km



Date: August 19, 2008

Team members:

Todd Mathieu
Simmy Mathieu

Interesting Discoveries:

Legend

Symbol	Description
	Outcrop
	sample name and sample location
	direction of line traversed



Declination
11° 25' West

Scale
1 inch = 200m

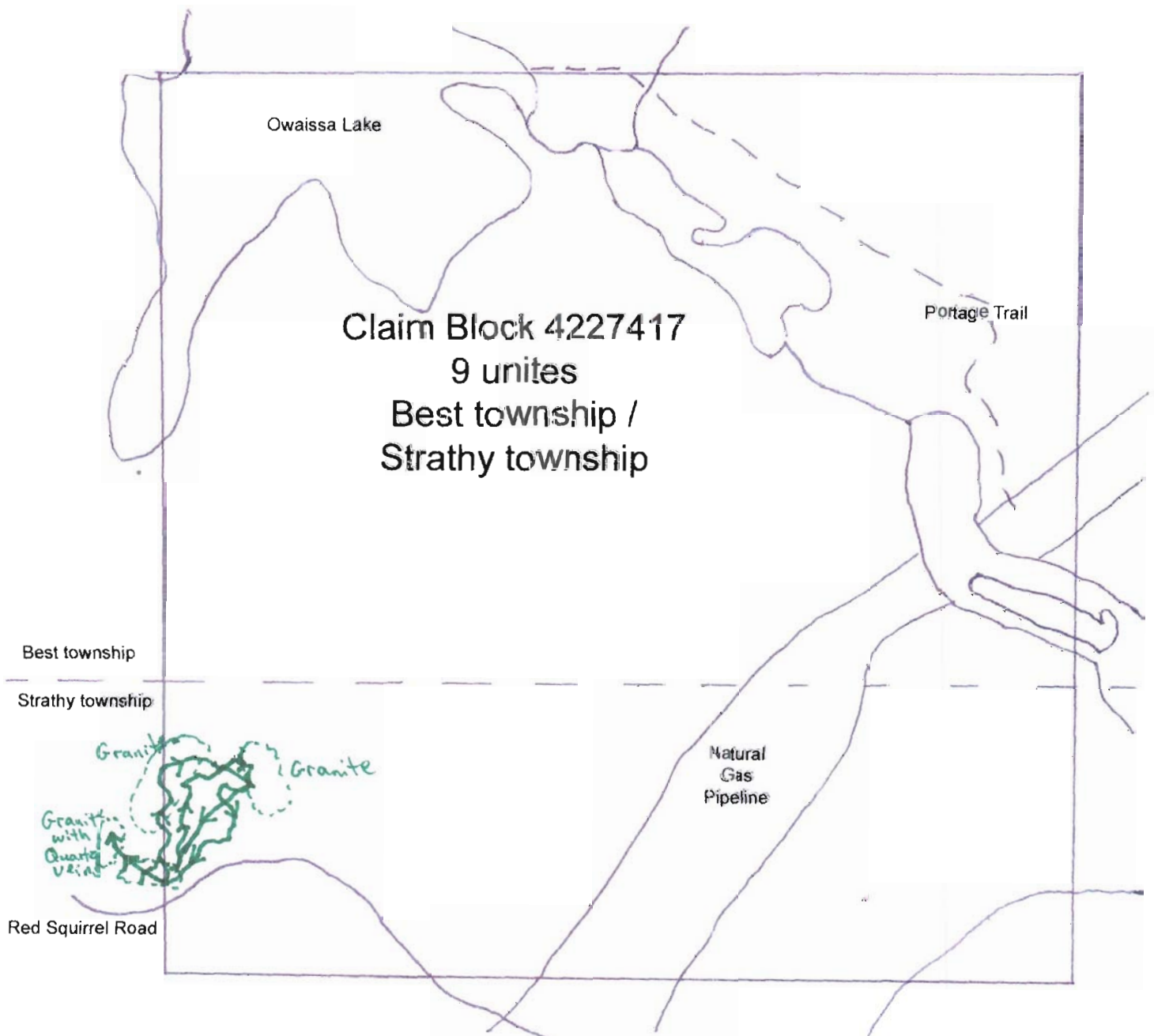
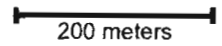



Date: August 20, 2008

Team members:

Todd Mathieu

Interesting Discoveries:

Legend

Symbol	Description
	Outcrop
	sample name and sample location
	direction of line traversed



Declination
11° 25' West

Scale
1 inch = 200m

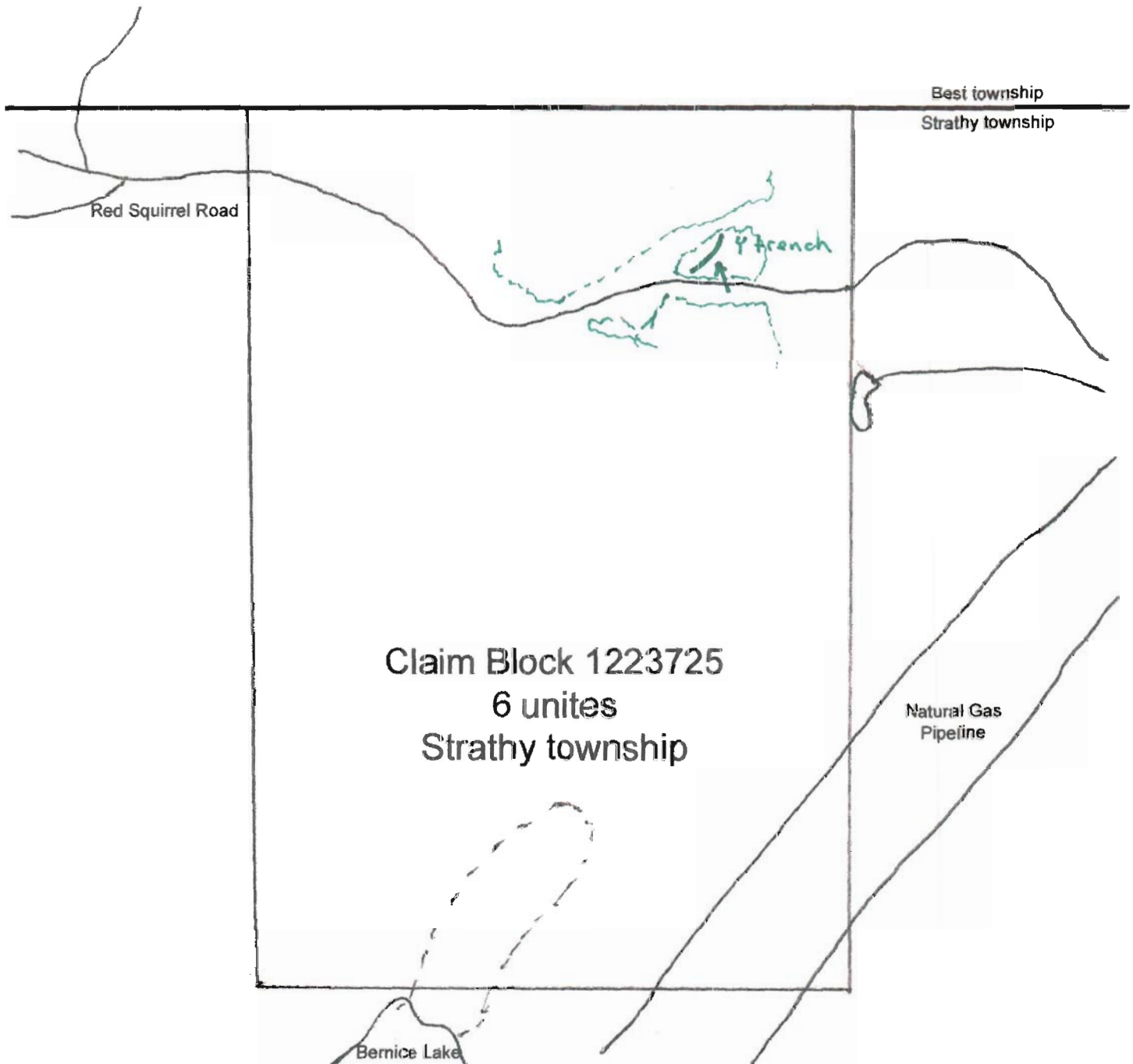
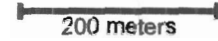



Date: August 21, 2008

Team members:

Todd Mathieu

Interesting Discoveries:

Legend

Symbol	Description
	Outcrop
	sample name and sample location
	direction of line traversed



Declination
11° 25' West

Scale
1 inch = 200m

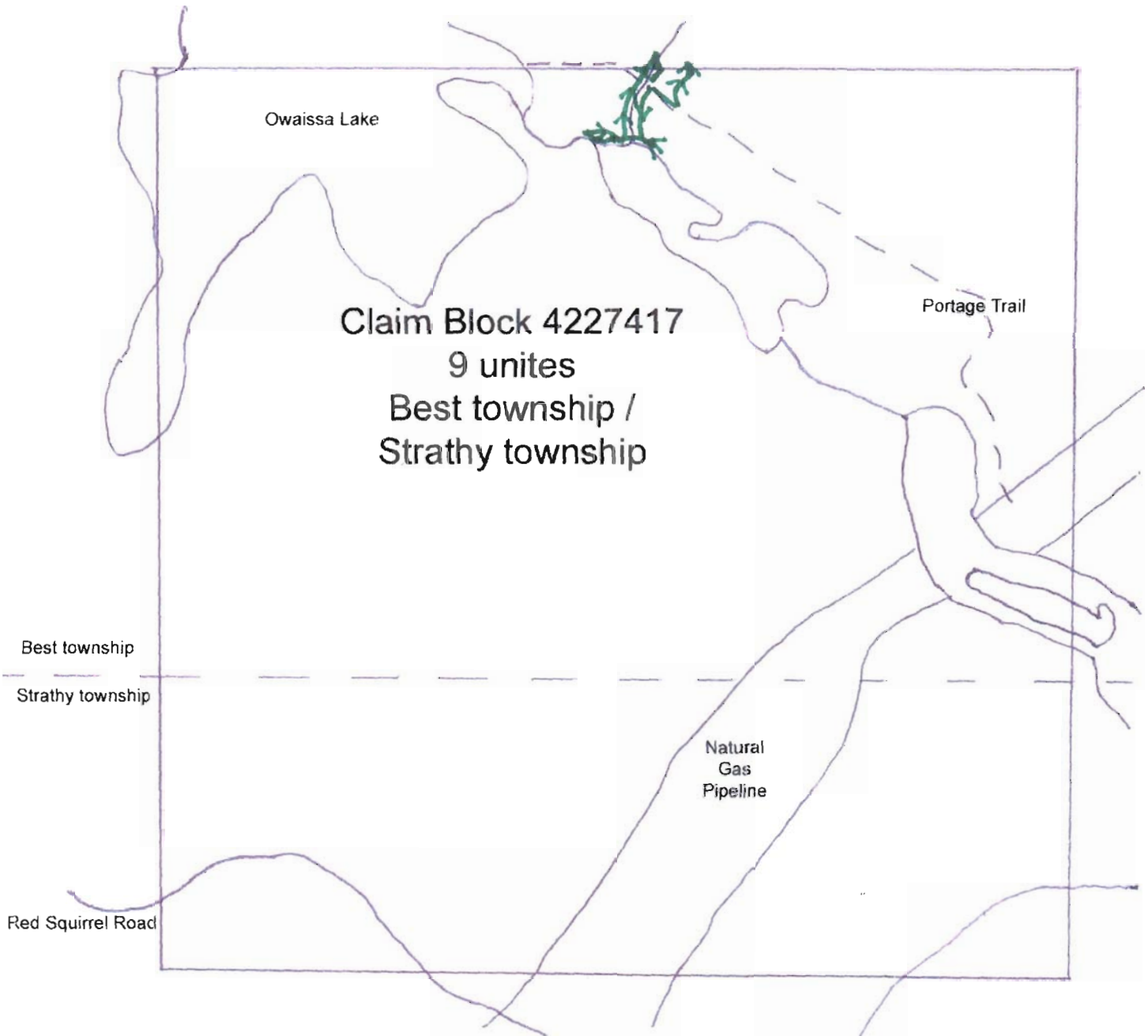
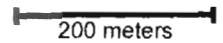

We travelled and mobilized equipment to Black Duck camp on October 9, 2008

October 12, 2008 Jim and I manually carried the backpack drill, water, and sampling tools to a location southeast of Black Duck camp previously noted as sample location H. As I had received assays indicating elevated Pd at this location I had decided to use the backpack core drill to take a deeper non-weathered sample. The outcrop is extremely fractured and proved very difficult to drill with the bit design of the portable core drill. I was forced to drill on a 45-degree dip to the southeast and the core continued to fracture and bind off inside the core barrel. I was also forced to use full water flow to limit damage to the equipment, which was causing all mineralization to be washed out of the core. Jim continued to assist with collecting/labelling core and hiking 250m down to the lake for water. By noon we had drilled only 3.5 feet, intersected nothing of interest, and had drill through and into what appears to be granite. We abandoned the hole and the core was left beside the hole. We searched for a second location, but nothing of interest was available where it would be possible to drill. We moved equipment back to camp. Drill hole is labelled O-DH1-08.

Todd ½ day (claim block 4227412)

Jim ½ day (claim block 4227412)

October 13, 2008

Jim and I mobilized equipment to the Mathieu showing location along Red Squirrel road via ATV. Here we set up our drill site to sample at the location of the Y vein where it expands to 12-14 inches wide. The backpack drill was set up dipping slightly to the southeast in attempt to drill down the vein structure. The rock was highly fractured and continued to break and bind off inside the core barrel. We were forced to use full water flow to keep the bit from binding and jamming in the hole. Jim and I continued to switch off drilling, retrieving/filtering water, labelling and placing core in core boxes. This hole was drilled to approximately 3.5 feet and had begun intersecting what I believe to be granite. A second hole at the same location on an increased dip was also drilled but only for approximately 2 feet. At this point a malfunction occurred with the J pin on the water swivel and we were no longer able to drill. We moved the equipment back to camp, packed up and drove back to North Bay that night. Drill holes are labelled O-DH2-08 and O-DH3-08. Core will be split and possibly assayed later in 2009 (due to lack of funding).

The core from both holes contained mostly remobilized diabase with solid portions of sulphides and quartz. Sulphides appear to be mostly chalcopyrite and pyrite. Core will be split and samples to be possibly sent out in early 2009.

Todd 1 day (claim block 1223725)

Jim 1 day (claim block 1223725)

Mileage = 186km (372km divided by 2 – additional work was completed at base metal property in Strathy, not included in this report)



Date: October 12, 2008

Team members:

Todd Mathieu
Simmy Mathieu

Interesting Discoveries:

Legend

Symbol	Description
	Outcrop
	sample name and sample location
	direction of line traversed



Declination
11° 25' West

Scale
1 inch = 200m

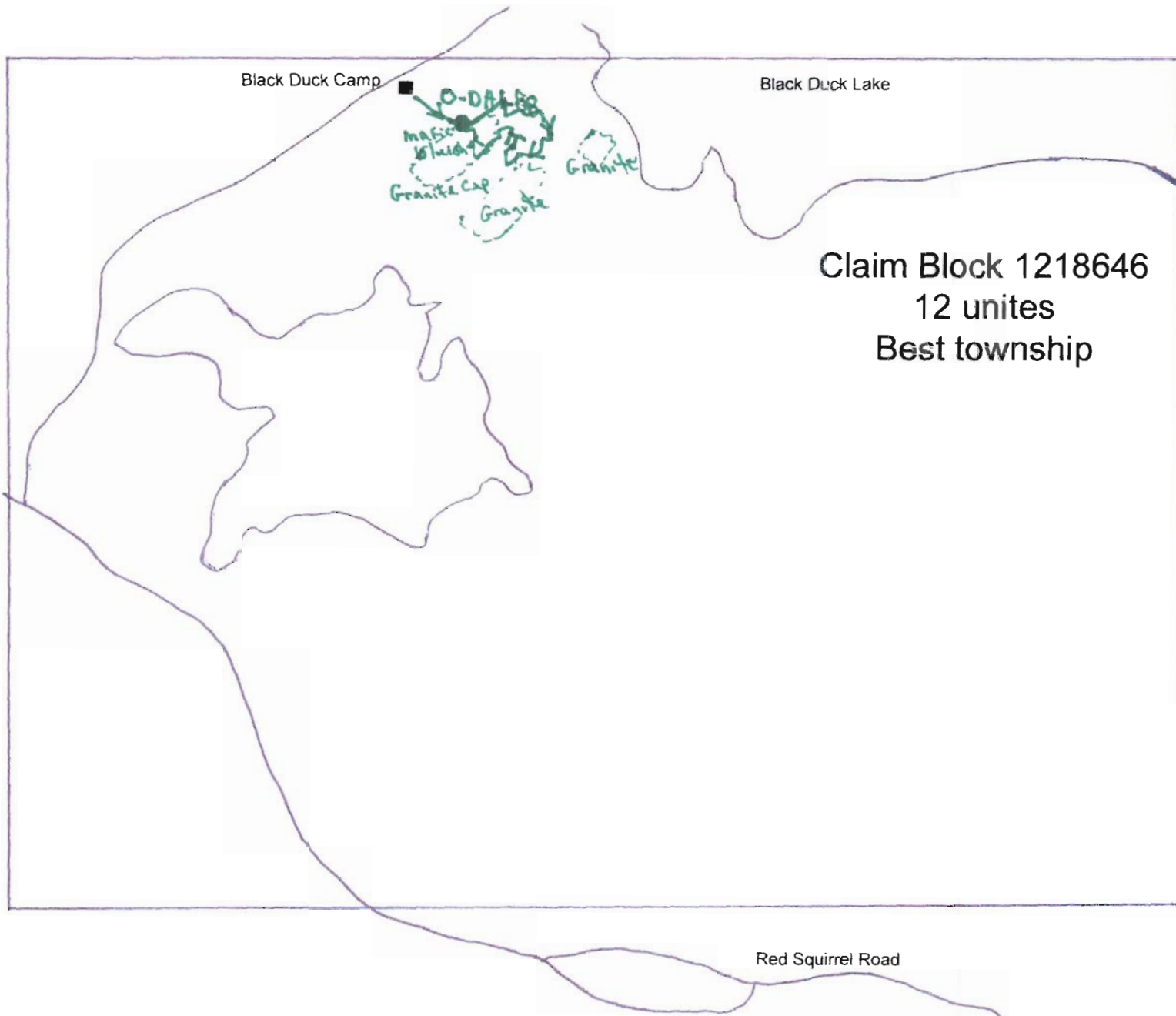
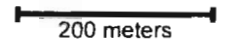



Date: October 13, 2008

Team members:

Todd Mathieu
Jimmy Mathieu

Interesting Discoveries:

Legend

Symbol	Description
	Outcrop
	sample name and sample location
	direction of line traversed



Declination
11° 25' West

Scale
1 inch = 200m

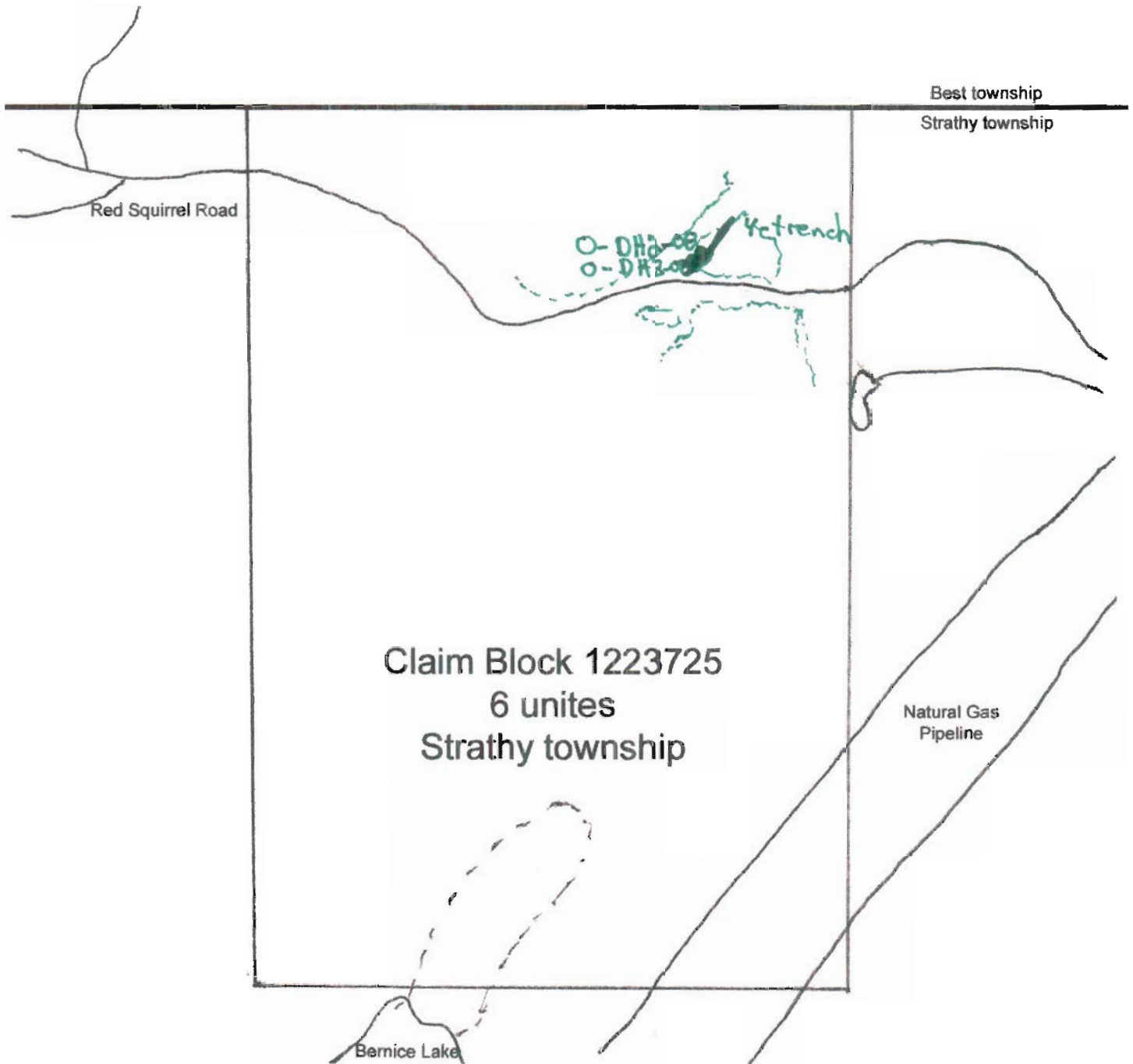
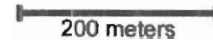

• November 1, 2008

Jim and I drove from North Bay up to Temagami, mobilized equipment to the Mathieu showing and prepared to begin drilling at the location of the Y vein. At this particular point the vein is two inches wide but is 70% sulphides mixed with quartz. We first had to widen the trench to position the drill properly. We then began drilling at an approximate 45-degree dip to the southwest. This was an attempt to drill along the vein but eventually intersect the vein at an approximate depth of 3 feet and to the southwest by 3 feet. At surface this part of the vein appears to contain the best mix of minerals believed to be the best chance for visible gold. It also appears that the vein maybe widening. Once again we were drilling through highly fractured diabase and the core kept breaking and binding in the drill barrel. Very slow drilling. Jim and I continued to switch off between drilling, retrieving/filtering water, boxing and labelling core.

At 2.75 feet there was a serious malfunction with the drill rod coupling system and the J pin on the second rod pushed under the J groove of the threaded lead. The rods bound in the hole, but carefully we manually removed the rods and gently bent the J slot back into place. Unfortunately the metal was weak and once again at approximately 3 feet the rods jammed a second time. At this point the equipment was too damaged to safely continue drilling any further and we were forced to pack up the equipment. We travelled back to North Bay.

The 3 feet of core was mostly diabase with the odd fracture of quartz. One fracture in particular appears to contain sulphides. Core will be split and possibly assayed in early 2009. Hole was terminated due to the malfunction 1.5 feet short of the target. As I was deeply disappointed with the drill, it has been sent back to the manufacturer.

Todd 1 day (claim block 1223725)

Jim 1 day (claim block 1223725)

Mileage = 248km



Date: November 4, 2008

Team members:

Todd Mathien
Jimmy Mathien

Interesting Discoveries:

Legend

Symbol	Description
	Outcrop
	sample name and sample location
	direction of line traversed



Declination
11° 25' West

Scale
1 inch = 200m

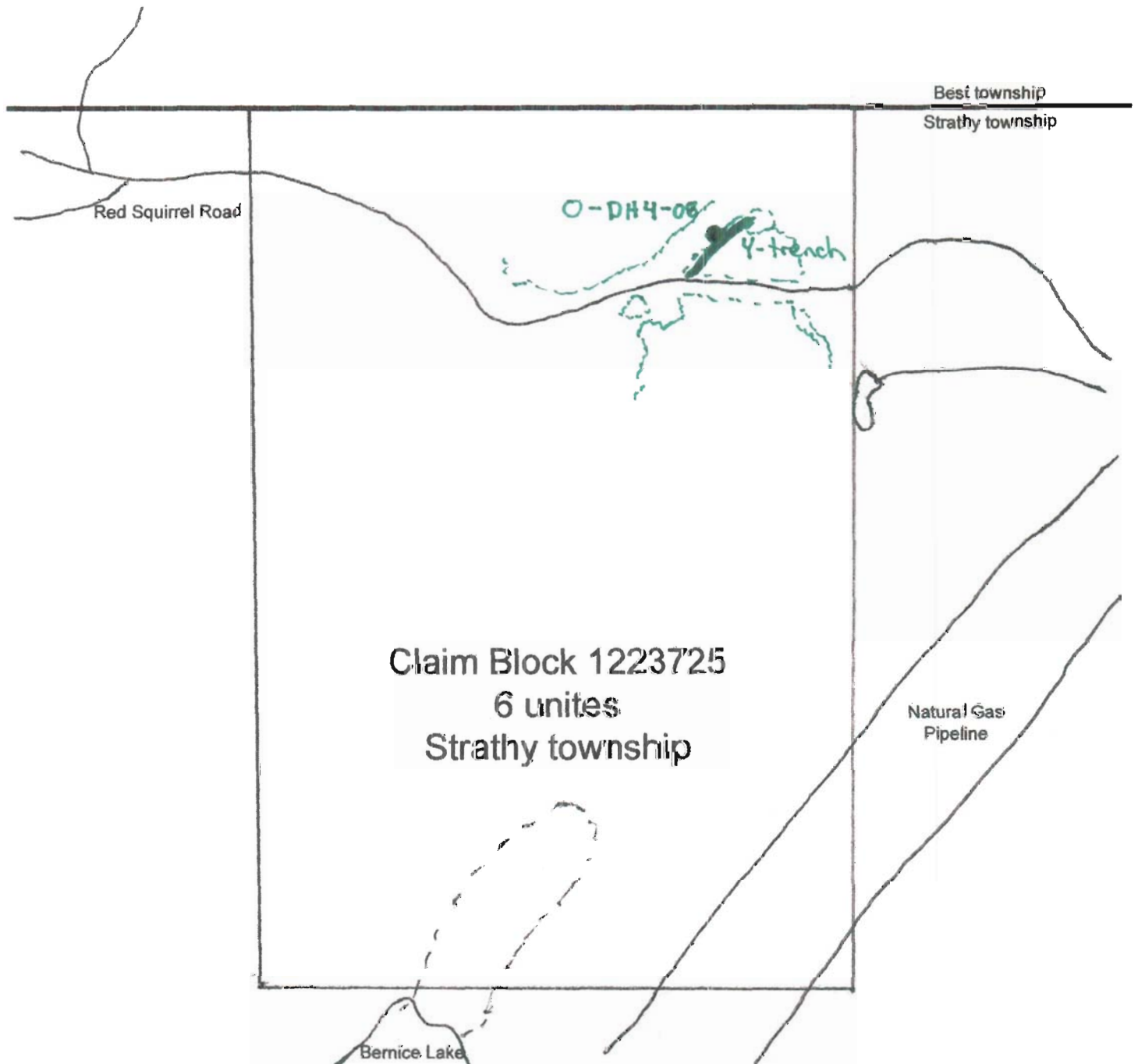

Owaisa Property - Best + Strathy township

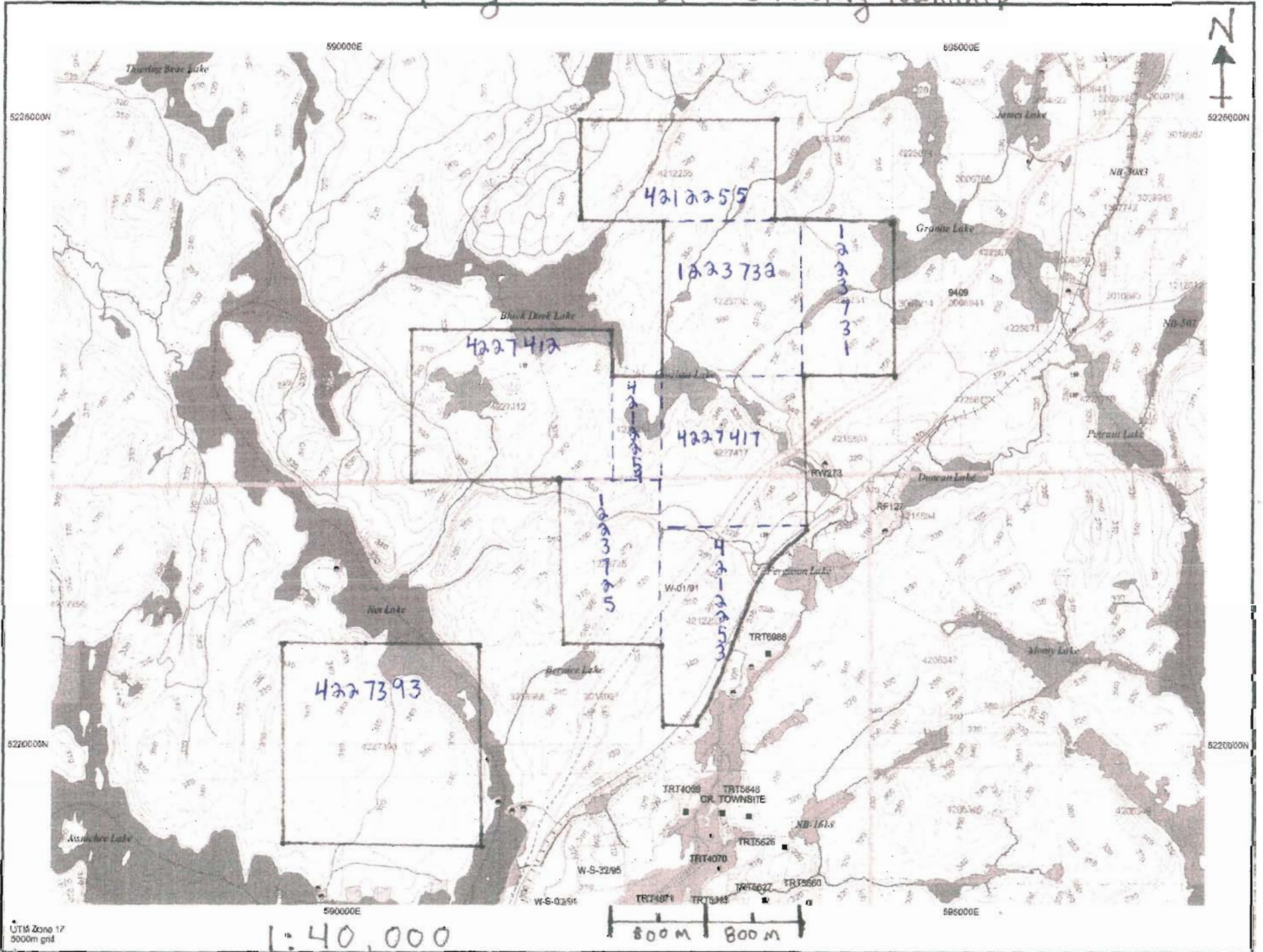

Legend

Symbol	Description
C	Cedar
P	Pines
M	Mixed
H	Hardwoods
S	Swamp



Declination
11° 25' West

Scale
1 inch = 200m

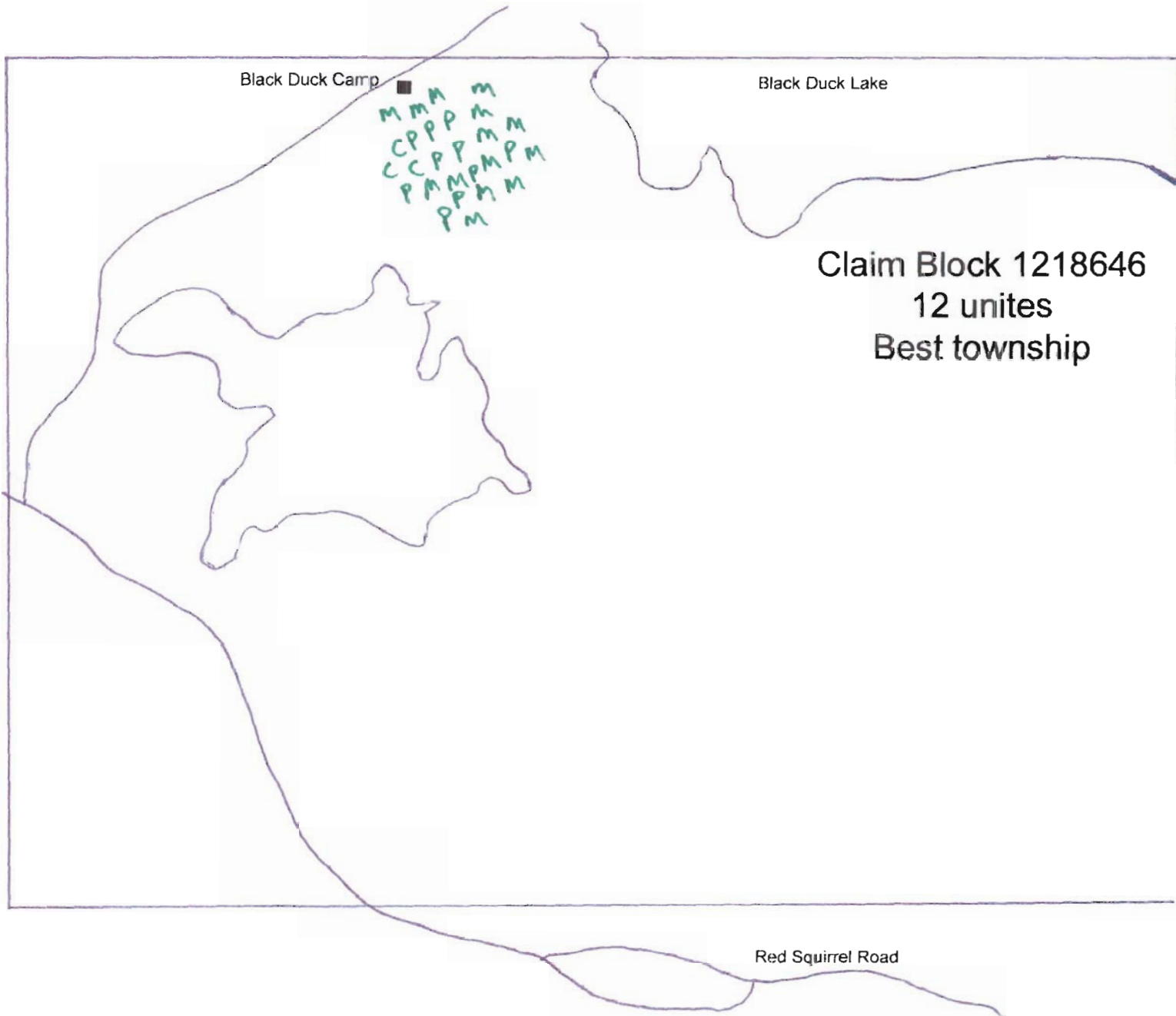
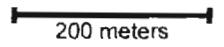

Legend

Symbol	Description
C	Cedar
P	Pines
M	Mixed
H	Hardwoods
S	Swamp



Declination
11° 25' West

Scale
1 inch = 200m

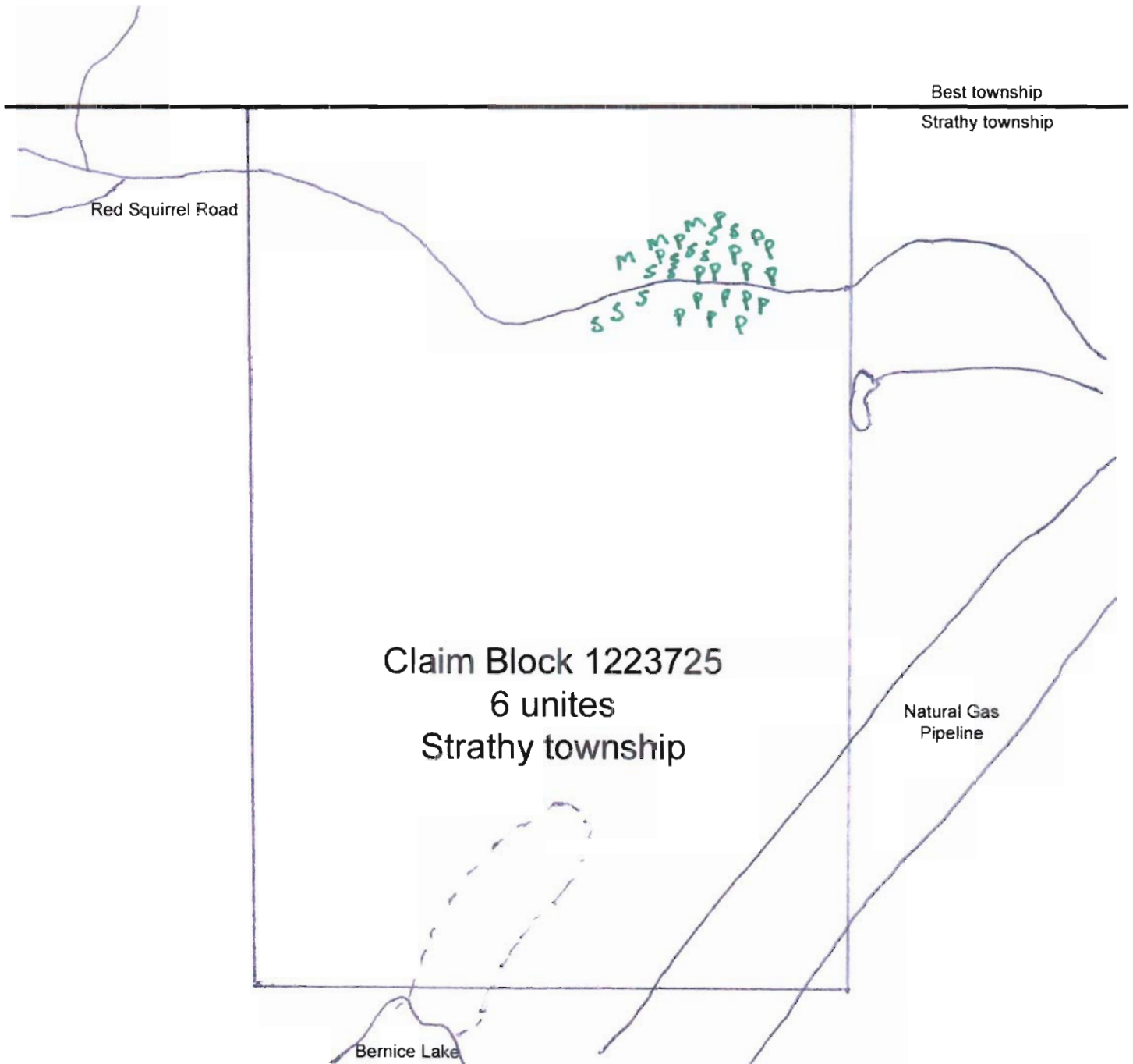
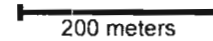

Legend

Symbol	Description
C	Cedar
P	Pines
M	Mixed
H	Hardwoods
S	Swamp



Declination
11° 25' West

Scale
1 inch = 200m

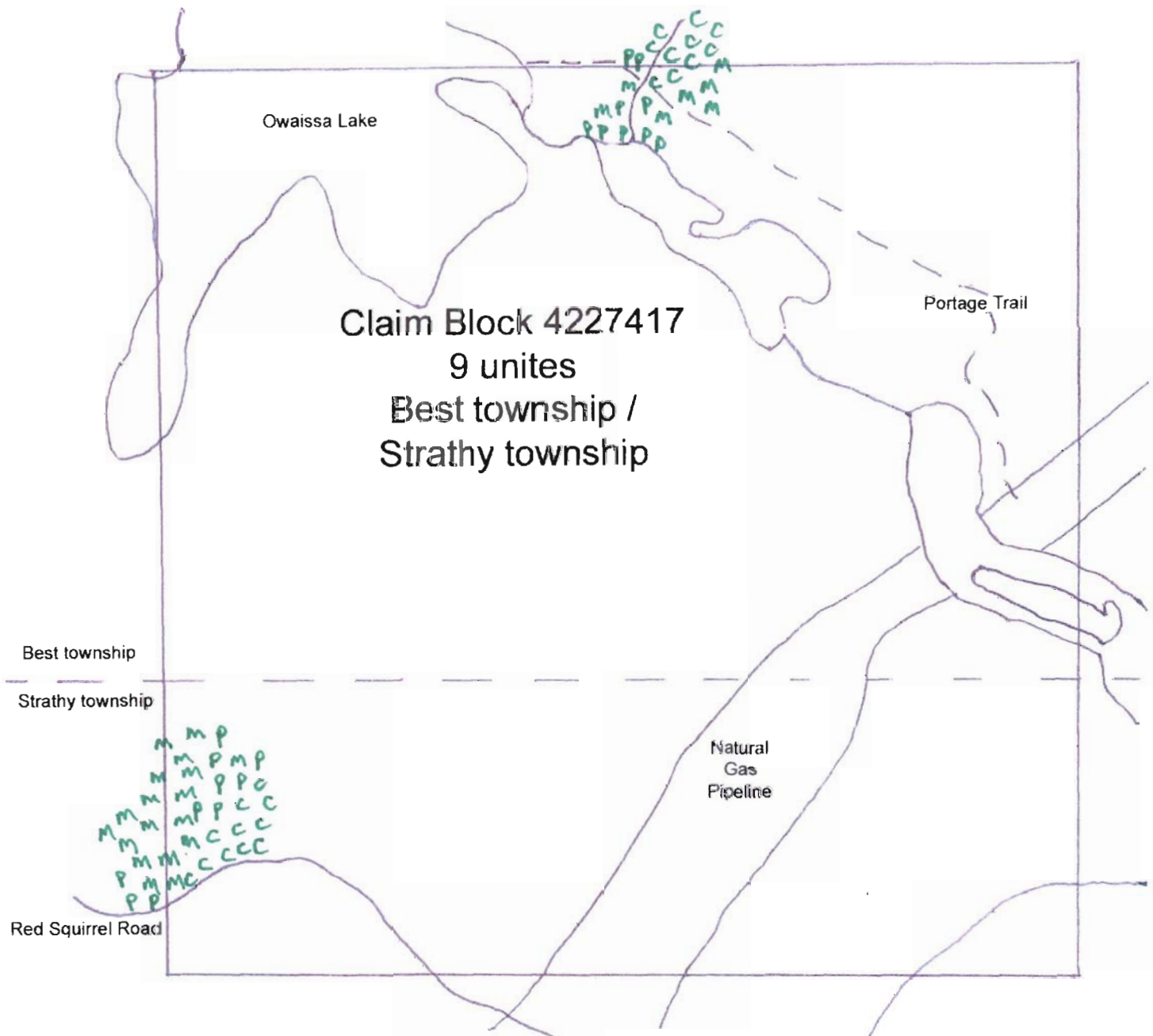
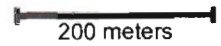

From: Karen Rees [krees@temexcorp.com]
Sent: Tuesday, October 14, 2008 11:46 AM
To: Mathieu, Todd
Cc: icampbell@temexcorp.com; kkettles@temexcorp.com
Subject: Owaissa Property

Hi Todd,

Thank you for the opportunity to review the data and visit your properties. Regarding the Owaissa Property, Temex is not interested in pursuing the Owaissa "polymetallic" property but provides the following which might assist you in further developing the property.

A brief field visit was made to this property by Ian Campbell, President and CEO of Temex this weekend, accompanied by Richard Brett. The mineral showings are approximately 700 metres west of the Highway 11 junction, and occur adjacent to the Red Squirrel Road.

Sampling by Temex has returned several highly elevated gold assays up to and including 6.58, 11.25 and 13.03 g/t gold along with highly elevated copper, silver and arsenic. Nickel and lead are mildly elevated. The values occur in sulphide-rich fractures up to several centimetres and cut gabbro in a general eastwest trend. The fractures occur over a cross strike of about 100 metres. The fractures seen to date are narrow in nature and by themselves are not interesting from an economic point of view however they do indicate that a mineralizing system is present.

Temex recommends that the vendor try a VLF-EM survey over the property area given that a zone of larger size would prove interesting and may occur. There was not much overburden in the area visited and therefore it is likely that VLF would respond to a zone of greater width.

As noted previously, Temex is also not interested in pursuing the base metal property.

I have attached the analytical certificates for samples taken by Richard Brett on both properties your information, as well as a spreadsheet indicating field notes for the samples and sample locations in UTM NAD 27, Zone 17, and into which the analytical results have been compiled.

Thank you very much for bringing these opportunities to the attention of Temex.

Regards,

Karen Rees, P. Geo.
General Manager
Temex Resources Corp.
141 Adelaide St. West, Suite 1660
Toronto, ON M5H 3L5
416-862-2246 head office
416-862-2244 fax
905-599-7639 mobile
krees@temexcorp.com



Established 1928

Swastika Laboratories Ltd

Assaying - Consulting - Representation

Assay Certificate

8W-2296-RA1

Company: **TEMEX RESOURCES CORPORATION**
Project: TEMAGAMI/TOD
Attn: K. REES

Date: AUG-14-08

We hereby certify the following Assay of 21 GRAB samples submitted AUG-05-08 by .

Sample Number	Au g/tonne	Au Check g/tonne	Pt g/tonne	Pd g/tonne	Multi Element
16317	13.03	-	0.01	0.01	RESULTS
16318	11.25	8.91	<0.005	0.02	TO
16319	1.08	-	0.03	0.02	FOLLOW
16320	3.64	3.43	0.02	0.03	
16321	6.58	8.09	0.03	0.02	
16322	1.51	-	0.01	0.02	
16323	0.02	-	<0.005	0.01	
16324	0.02	-	<0.005	<0.005	
16325	0.02	-	0.02	0.02	
16326	0.01	-	0.01	0.02	
16327	0.01	-	<0.005	<0.005	
16328	0.05	-	0.01	0.01	
16330	0.28	-	<0.005	<0.005	
16331	6.58	5.21	<0.005	<0.005	
16332	0.28	-	<0.005	0.01	
16333	0.99	0.66	0.02	0.02	
16334	0.01	-	<0.005	<0.005	
16335	0.04	-	0.04	0.05	
16336	0.01	-	<0.005	<0.005	
16337	0.01	-	0.01	0.01	
16338	0.01	-	0.02	0.03	
BLANK	NIL	-	<0.005	<0.005	
STD CDN-PGMS-9	1.00	-	0.70	2.56	

Certified by 

Assayers Canada

8282 Sherbrooke St., Vancouver, B.C., V5X 4R6

Tel: (604) 327-3436 Fax: (604) 327-3423

Report No : 8W2296RJ

Date : Oct-08-08

Temex Resources Corporation

Attention: K. Rees

Project: Temagami/Tod

Sample type: Rock

Multi-Element ICP-AES Analysis

Aqua Regia Digestion

Sample Number	Ag ppm	Al %	As ppm	Ba ppm	Be ppm	Bi ppm	Ca %	Cd ppm	Co ppm	Cr ppm	Cu ppm	Fe %	Hg ppm	K %	La ppm	Mg %	Mn ppm	Mo ppm	Na %	Ni ppm	P ppm	Pb ppm	S %	Sb ppm	Sc ppm	Sr ppm	Th ppm	Ti %	Tl ppm	U ppm	V ppm	W ppm	Zn ppm	Zr ppm
16317	41.9	2.22	1170	20	<0.5	<5	0.46	21	691	116	>10000	14.08	<1	0.02	<10	1.55	448	5	0.05	72	2566	132	>5.00	<5	5	6	8	0.11	<10	22	71	<10	238	36
16318	59.8	2.72	>10000	10	<0.5	<5	1.03	206	7417	171	>10000	13.07	6	0.01	<10	2.33	651	<2	0.02	186	5319	171	>5.00	<5	7	5	5	0.08	<10	23	91	<10	411	15
16319	1.1	2.65	84	33	<0.5	<5	1.10	1	72	113	942	4.58	<1	0.12	<10	1.96	466	<2	0.14	70	344	19	0.11	<5	4	26	<5	0.16	<10	<10	92	<10	67	8
16320	16.7	2.84	1087	<10	<0.5	<5	0.71	19	669	409	>10000	8.52	<1	0.01	<10	2.86	580	<2	0.04	160	753	59	3.31	<5	8	20	<5	0.19	<10	10	111	<10	66	20
16321	48.7	2.07	>10000	12	<0.5	<5	0.44	207	5854	231	>10000	14.80	4	0.01	<10	2.04	395	<2	0.04	511	1293	104	>5.00	<5	6	15	<5	0.12	<10	20	95	<10	70	23
16322	26.8	1.73	26	20	<0.5	<5	1.09	<1	166	81	>10000	8.90	<1	0.03	<10	1.29	293	<2	0.08	97	1177	65	4.94	<5	5	37	<5	0.14	<10	<10	73	<10	28	16
16323	<0.2	0.85	29	<10	<0.5	<5	0.05	<1	20	186	145	1.90	<1	0.02	<10	1.00	248	<2	0.04	12	220	<2	0.05	<5	1	1	<5	0.04	<10	<10	17	<10	20	5
16324	0.9	1.12	17	<10	<0.5	<5	0.73	<1	58	173	493	5.41	<1	0.04	<10	0.90	545	<2	0.06	50	320	30	1.34	<5	6	5	<5	0.38	<10	<10	114	<10	30	6
16325	4.8	1.34	9	15	<0.5	<5	0.74	<1	148	131	3227	12.63	<1	0.04	<10	1.03	603	<2	0.06	139	580	332	>5.00	<5	6	8	<5	0.35	<10	17	102	<10	314	10
16326	0.2	0.95	<5	<10	<0.5	<5	1.12	<1	46	120	747	5.67	<1	0.04	<10	0.48	618	<2	0.08	68	401	7	1.89	<5	6	10	<5	0.30	<10	<10	71	<10	68	4
16327	0.7	1.35	<5	13	<0.5	<5	0.90	<1	65	191	547	7.06	<1	0.04	<10	0.67	649	<2	0.05	64	401	22	1.69	<5	5	14	<5	0.27	<10	11	77	<10	60	5
16328	1.0	1.17	17	13	<0.5	<5	0.64	1	48	224	905	5.48	<1	0.04	<10	0.83	611	5	0.04	50	274	20	0.92	<5	4	3	<5	0.17	<10	<10	75	11	658	5
16330	<0.2	2.13	<5	17	<0.5	<5	0.24	<1	27	147	56	4.04	<1	0.17	11	2.32	240	6	0.09	88	370	2	0.02	<5	7	5	<5	0.14	<10	<10	142	<10	24	30
16331	7.8	1.00	324	19	<0.5	28	0.42	6	20	185	491	4.07	<1	0.05	<10	0.75	164	4	0.07	24	331	5	0.13	<5	3	15	<5	0.10	<10	<10	51	<10	<1	11
16332	8.0	3.10	327	13	<0.5	<5	0.44	4	375	154	6596	10.59	<1	0.03	<10	3.19	594	<2	0.05	73	579	29	3.99	<5	9	13	<5	0.18	<10	15	128	<10	57	20
16333	12.0	1.93	108	70	<0.5	8	0.75	1	31	144	4481	10.18	<1	0.27	<10	1.52	222	<2	0.08	17	467	26	0.95	<5	6	24	<5	0.19	<10	12	116	<10	24	22
16334	<0.2	3.21	22	21	<0.5	<5	2.48	<1	71	29	147	10.91	<1	0.07	38	1.97	1770	<2	0.04	55	7440	6	0.04	<5	5	27	<5	0.53	<10	<10	147	<10	74	14
16335	<0.2	1.44	<5	25	<0.5	<5	0.87	1	27	83	74	3.39	<1	0.04	<10	1.23	548	<2	0.03	45	446	223	0.02	<5	2	18	<5	0.30	<10	<10	73	<10	525	16
16336	0.3	0.67	14	50	<0.5	<5	0.22	<1	11	117	36	3.19	<1	0.12	14	0.33	288	<2	0.05	6	635	24	0.39	<5	3	13	<5	0.15	<10	<10	23	<10	21	5
16337	<0.2	2.31	<5	12	<0.5	<5	0.10	<1	15	121	1832	5.47	<1	0.02	<10	2.19	642	<2	0.04	36	453	4	0.17	<5	4	1	<5	0.07	<10	10	32	<10	86	9
16338	<0.2	1.34	<5	22	<0.5	<5	0.02	<1	10	156	17	3.94	<1	0.06	<10	1.30	323	<2	0.03	13	354	6	0.40	<5	1	<1	<5	0.03	<10	<10	17	<10	55	6

A .5 gm sample is digested with 5 ml 3:1 HCl/HNO3 at 95°C for 2 hours and diluted to 25ml.

Swastika Laboratories (2008) Ltd

Box 10, 1 Cameron Ave
Swastika, ON
P0K 1T0

Invoice

Date	Invoice #
8/15/2008	2444

Invoice To
TEMEX RESOURCES CORP. SUITE 1660 141 ADLEAIDE STREET WEST TORONTO, ONTARIO M5H 3L5

August 15 2008

PAID
8/15/08

P.O. No.	Terms	Project
	30 DAYS	

Qty	Description	Cert #	Rate	Amount
	PROJECT: TEMAGAMI/TOD			
21	GOLD PLATINUM PALLADIUM	8W-2296-RA1	18.00	378.00
21	SAMPLE PREPARATION		5.00	105.00
22	GOLD, PLATINUM & PALLADIUM		25.00	550.00
22	SAMPLE PREPARATION		5.00	110.00
	GST 5% on sales		5.00%	57.15
	<i>181.05.67</i>			
	<i>U/L</i>			
	<i>25 Aug 08</i>			

Thank you for your business.		GST Tax Total	\$57.15
		Total	\$1,200.15

Swastika Laboratories (2008) Ltd

Box 10, 1 Cameron Ave
Swastika, ON
P0K 1T0

Invoice

Date	Invoice #
10/15/2008	2948

Invoice To
Temex Resources Corporation 141 Adelaide Street West Suite 1660 TORONTO, ON M5H 3L5

P.O. No.	Terms
	30 DAYS

Qty	Description	Cert #	Rate	Amount
21	PROJECT: TEMAGAMI/TOD MULTI 30 ELEMENT AQUA REGIA GST 5% on sales <i>199.02.67</i> <i>me</i> <i>17 Oct 08</i>		10.00 5.00%	210.00 10.50
Thank you for your business.			GST Tax Total	\$10.50
			Total	\$220.50

Swastika Laboratories (2008) Ltd

Box 10, 1 Cameron Ave
 Swastika, ON
 P0K 1T0

Invoice

Date	Invoice #
10/20/2008	2979

Invoice To
Temex Resources Corporation 141 Adelaide Street West Suite 1660 TORONTO, ON M5H 3L5

Oct 22/08

P.O. No.	Terms
	30 DAYS

Qty	Description	Cert #	Rate	Amount
5	PROJECT: TEMAGAMI/TOD COPPER GST 5% on sales <i>189.0267</i> <i>112</i> <i>22 Oct 08</i>	8W-2296-RA1	9.00 5.00%	45.00 2.25
Thank you for your business.			GST Tax Total	\$2.25
			Total	\$47.25

10/27/08

Days Worked

Date	Claim Number Worked	Mileage in KM	Mileage Sub Total (\$0.40/km)	Assays	Person	Portion of day worked	Total	Claim 1223725	Claim 4227412	Claim 4227417	Claim 1223732	
July 26, 2008	1223725	N/A	N/A	$(16 \times 34.65) + 47.25 = 636.30$	Richard Brett	N/A	\$0.00	\$601.65				
	1223732			$4 \times 34.65 = 138.60$		N/A	\$0.00				\$138.60	
	4227417			$1 \times 34.65 = 34.65$		N/A	\$0.00			\$34.65		
19-Aug-08	1223725	398	\$159.20		Todd Mathieu	1	\$200.00	\$279.60		\$279.60		
	4227417				Jimmy Mathieu	1	\$200.00					
20-Aug-08	1223725				Todd Mathieu	0.5	\$100.00	\$100.00				
21-Aug-08	4227417				Todd Mathieu	0.5	\$100.00			\$100.00		
12-Oct-08	4227412	93	\$37.20		Todd Mathieu	0.5	\$100.00		\$237.20			
					Jimmy Mathieu	0.5	\$100.00					
13-Oct-08	1223725	93	\$37.20		Todd Mathieu	1	\$200.00	\$437.20				
					Jimmy Mathieu	1	\$200.00					
01-Nov-08	1223725	248	\$99.20		Todd Mathieu	1	\$200.00	\$499.20				
					Jimmy Mathieu	1	\$200.00					
Sub total		832	\$332.80	\$774.90		8	\$1,600.00	\$1,917.65	\$237.20	\$414.25	\$138.60	Total
								\$1,917.65	\$237.20	\$414.25	\$138.60	\$2,707.70

Total \$2,707.70

Total value of assessment work including assaying, shipping, transportation, days worked, other associated costs =
 1 day Report Writing, Map creation, financials = 1 x \$200 =

\$2,707.70
 \$200

Final Total

\$2,907.70