

2.41923

Report on Magnetometer Survey on Claim # 3007689
Gillies Limit, Larder Lake Mining Division

By Al Kon

June 18, 2008

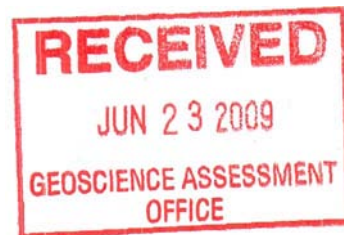

Summary

A ground magnetometer survey was completed over claim # 3007689, in Gillies Limit, Larder Lake Mining Division. Four north/south lines were recorded.

The survey provided a good database for any future work that may be contemplated on the property. This survey also indicated a possible extension to a known sulphide occurrence.

Introduction

Claim # 3007689 is currently held by Alan D Kon of North Cobalt, Ontario who recently acquired the property back from International Millennium Mining Corp, IMMC (then Cabo Mining Enterprises Ltd). Mr. Kon was the original claim holder prior to transferring the claim to IMMC. In the agreement, should IMMC decide not to hold the rights to property anymore, it was to be returned to Alan Kon.

Access and History

Claim # 3007689 is a triangle shaped claim bordering on the Gillies Limit/ Coleman township line. It is approximately 250m long and 300m wide. It was also part of the Mensilvo/ Silver Bar property. Although there are no shafts to surface on the claim, there are numerous pits and trenches. The claim is also next to the Silver Summit/Silver Fields property which produced in excess of 25 million ounces of silver. The Waldman and Wyandoh shafts are within 50 meters of the claim and produced over 50 thousand ounces of silver between the two shafts.

The claim is approximately 3 Km south of the historical silver mining town of Cobalt Ontario. Access to the claim can be achieved via highway 11 north to 11b east for 6 Km to Coleman Rd, then south east for 1 Km to Hound Chutes Rd and finally 3 Km south. Hound Chutes Rd passes through the claim.

Previous Work

During 2006 some prospecting and surface trenching was done on the property by Cabo Mining Enterprises Ltd. One diamond drill hole was also put down but the results of the assays are unknown at the time of this report. Another diamond drill hole was put down on the claim #3007689 in 2008 although only the first 50 meters of that hole was on the claim. But there was significant sulphide mineralization near surface in that hole.

Geology

The majority of the claim consists of Keewatin aged Volcanics, Andesites and Basalts. But there is a contact between the volcanics and conglomerates of the Coleman Formation on the far westside of the claim and again on the far eastside. The conglomerates are considered to be a cap and no more than 25 meters in thickness in that particular area. The strike of the rock is generally to the north. There are known minor faults in the area and the rock is highly fractured. Veining is generally east west.

Work Program

The ground magnetometer survey was completed using a Geotronics-816 Portable Proton Magnetometer. This instrument measures the total intensity of the earth's magnetic field in gammas. A Garmin GPS 60 CS was used to navigate and record the magnetometer's readings. Each station was taken at 5 meter intervals and the lines were approximately 50 meters apart. No grid was in place. The unit was set to 56000 gamma base.

Conclusions and Recommendations

There were several low magnetic readings, particularly in line with the known sulphide mineralization mentioned earlier in this report.

It is strongly recommended that a follow-up program consisting of detailed mapping and prospecting, should be considered. If possible a cut grid should be put in place and further, more detailed geophysical surveys are highly recommended.

Ala Ka
June 18, 2009

Line 1

1	08-Jun-09	11:16:51AM	56165
2	08-Jun-09	11:17:49AM	56124
3	08-Jun-09	11:18:08AM	56087
4	08-Jun-09	11:19:14AM	56072
5	08-Jun-09	11:20:27AM	56102
6	08-Jun-09	11:21:25AM	56082
7	08-Jun-09	11:22:13AM	56102
8	08-Jun-09	11:23:20AM	56075
9	08-Jun-09	11:24:33AM	56074
10	08-Jun-09	11:25:21AM	56078
11	08-Jun-09	11:26:54AM	56052
12	08-Jun-09	11:28:51AM	56060
13	08-Jun-09	11:30:04AM	56102
14	08-Jun-09	11:31:03AM	56122
15	08-Jun-09	11:32:34AM	56108
16	08-Jun-09	11:33:58AM	56124
17	08-Jun-09	11:35:17AM	56104
18	08-Jun-09	11:37:31AM	56096
19	08-Jun-09	11:38:50AM	56114
20	08-Jun-09	11:40:26AM	56093
21	08-Jun-09	11:43:10AM	56027
22	08-Jun-09	11:43:27AM	56058
23	08-Jun-09	11:44:23AM	56107
24	08-Jun-09	11:46:11AM	56151
25	08-Jun-09	11:47:31AM	56036
26	08-Jun-09	11:48:42AM	56036
27	08-Jun-09	11:51:45AM	55994
28	08-Jun-09	11:53:14AM	55993
29	08-Jun-09	11:56:44AM	55700
30	08-Jun-09	11:58:37AM	55855
31	08-Jun-09	12:02:57PM	56036
32	08-Jun-09	12:03:12PM	56036
33	08-Jun-09	12:04:38PM	56734
34	08-Jun-09	12:06:26PM	56353
35	08-Jun-09	12:08:22PM	55970
36	08-Jun-09	12:09:43PM	55894
37	08-Jun-09	12:12:29PM	55766
38	08-Jun-09	12:14:48PM	55800
39	08-Jun-09	12:17:21PM	55826
40	08-Jun-09	12:26:31PM	55902
41	08-Jun-09	12:26:43PM	56101
42	08-Jun-09	12:26:52PM	56387
43	08-Jun-09	12:26:55PM	56094
44	08-Jun-09	12:27:52PM	56019
45	08-Jun-09	12:29:53PM	56159
46	08-Jun-09	12:30:58PM	56141
47	08-Jun-09	12:31:49PM	56100
48	08-Jun-09	12:33:36PM	56131
49	08-Jun-09	12:34:59PM	56017
50	08-Jun-09	12:36:52PM	55865

51	08-Jun-09	12:37:57PM	56110
52	08-Jun-09	12:38:47PM	56409
53	08-Jun-09	12:39:50PM	56366
54	08-Jun-09	12:39:50PM	56141

Line 2

55	16-Jun-09	1:19:25PM	55981
56	16-Jun-09	1:21:00PM	56005
57	16-Jun-09	1:21:52PM	56049
58	16-Jun-09	1:22:57PM	56213
59	16-Jun-09	1:23:58PM	56410
60	16-Jun-09	1:25:11PM	56482
61	16-Jun-09	1:26:10PM	56250
62	16-Jun-09	1:28:14PM	56864
63	16-Jun-09	1:29:28PM	56081
64	16-Jun-09	1:30:26PM	56139
65	16-Jun-09	1:31:44PM	56045
66	16-Jun-09	1:32:55PM	56015
67	16-Jun-09	1:34:15PM	56377
68	16-Jun-09	1:35:00PM	56316
69	16-Jun-09	1:35:53PM	56223
70	16-Jun-09	1:37:14PM	56284
71	16-Jun-09	1:38:15PM	56314
72	16-Jun-09	1:39:09PM	56202
73	16-Jun-09	1:39:57PM	56097
74	16-Jun-09	1:40:48PM	56248
75	16-Jun-09	1:41:52PM	55918
76	16-Jun-09	1:42:48PM	56090
77	16-Jun-09	1:44:02PM	56193
78	16-Jun-09	1:45:03PM	56153
79	16-Jun-09	1:46:02PM	56038
80	16-Jun-09	1:46:59PM	55996
81	16-Jun-09	1:48:38PM	56984
82	16-Jun-09	1:49:57PM	55989
83	16-Jun-09	1:51:01PM	55995

Line 3

84	16-Jun-09	1:58:51PM	55569
85	16-Jun-09	1:59:43PM	55850
86	16-Jun-09	2:00:33PM	56062
87	16-Jun-09	2:01:45PM	55865
88	16-Jun-09	2:02:59PM	56813
89	16-Jun-09	2:04:01PM	55810
90	16-Jun-09	2:05:12PM	55886
91	16-Jun-09	2:06:26PM	55873
92	16-Jun-09	2:08:24PM	55793
93	16-Jun-09	2:09:26PM	55996
94	16-Jun-09	2:10:20PM	56287
95	16-Jun-09	2:11:05PM	56149
96	16-Jun-09	2:11:48PM	56083
97	16-Jun-09	2:13:05PM	56065
98	16-Jun-09	2:13:55PM	55984
99	16-Jun-09	2:14:55PM	55967

Line 4

100	16-Jun-09	2:25:53PM	56010
101	16-Jun-09	2:27:04PM	56114
102	16-Jun-09	2:28:25PM	56012
103	16-Jun-09	2:31:23PM	55883
104	16-Jun-09	2:34:22PM	56019
105	16-Jun-09	2:35:30PM	56011
106	16-Jun-09	2:36:22PM	56013
107	16-Jun-09	2:38:01PM	56114
108	16-Jun-09	2:38:58PM	56025
109	16-Jun-09	2:39:59PM	56033
110	16-Jun-09	2:41:13PM	56021
111	16-Jun-09	2:42:42PM	55990
112	16-Jun-09	2:43:45PM	55988
113	16-Jun-09	2:45:16PM	56100
114	16-Jun-09	2:46:15PM	56061
115	16-Jun-09	2:47:20PM	55885
116	16-Jun-09	2:48:17PM	55950
117	16-Jun-09	2:49:21PM	55992
118	16-Jun-09	2:51:03PM	56063
119	16-Jun-09	2:53:04PM	55979
120	16-Jun-09	3:19:00PM	56009

Line 5

121	16-Jun-09	3:19:49PM	56013
122	16-Jun-09	3:20:48PM	56015
123	16-Jun-09	3:21:45PM	56015
124	16-Jun-09	3:22:34PM	56031
125	16-Jun-09	3:23:31PM	56074
126	16-Jun-09	3:24:19PM	56060
127	16-Jun-09	3:25:15PM	56076
128	16-Jun-09	3:26:06PM	56058
129	16-Jun-09	3:27:00PM	56058
130	16-Jun-09	3:27:58PM	56067
131	16-Jun-09	3:28:56PM	56060
132	16-Jun-09	3:30:05PM	56047
133	16-Jun-09	3:32:29PM	56070
134	16-Jun-09	3:33:37PM	56101
135	16-Jun-09	3:37:13PM	56070
136	16-Jun-09	3:35:12PM	56105
137	16-Jun-09	3:38:18PM	56071
138	16-Jun-09	3:39:53PM	56082
139	16-Jun-09	3:41:00PM	56091
140	16-Jun-09	3:42:40PM	56081
141	16-Jun-09	3:55:17PM	56053

Line 6

142	16-Jun-09	3:56:13PM	56035
143	16-Jun-09	3:57:11PM	56031
144	16-Jun-09	3:58:24PM	56021
145	16-Jun-09	3:59:21PM	56041
146	16-Jun-09	4:00:44PM	56041
147	16-Jun-09	4:01:39PM	56045

Line 1

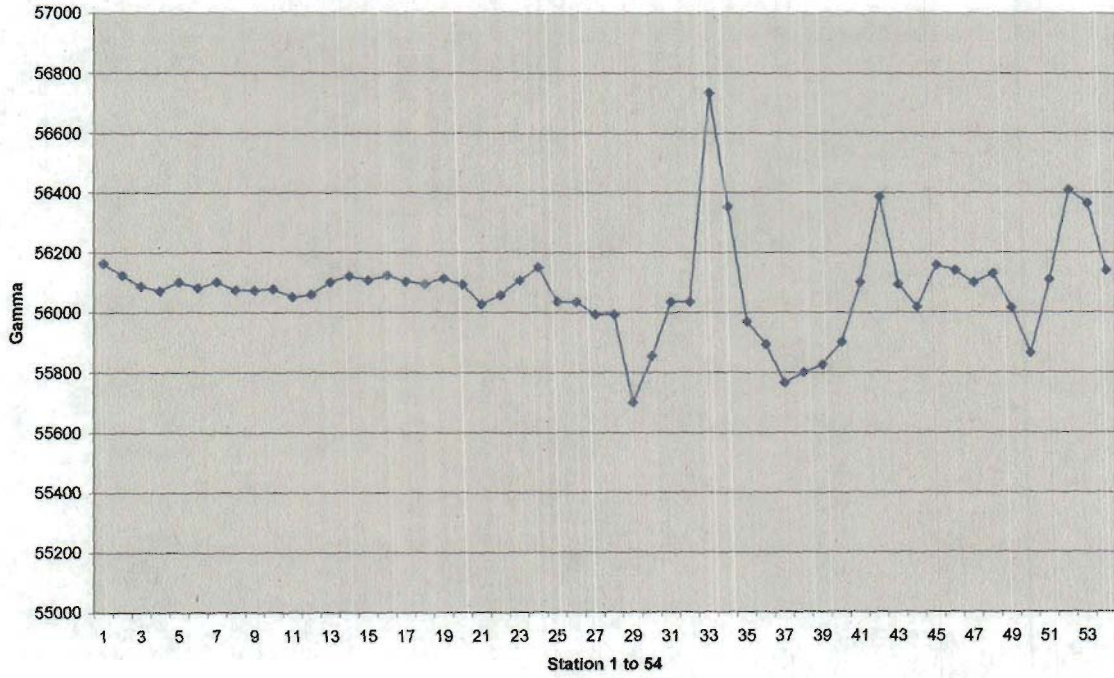

Line 2

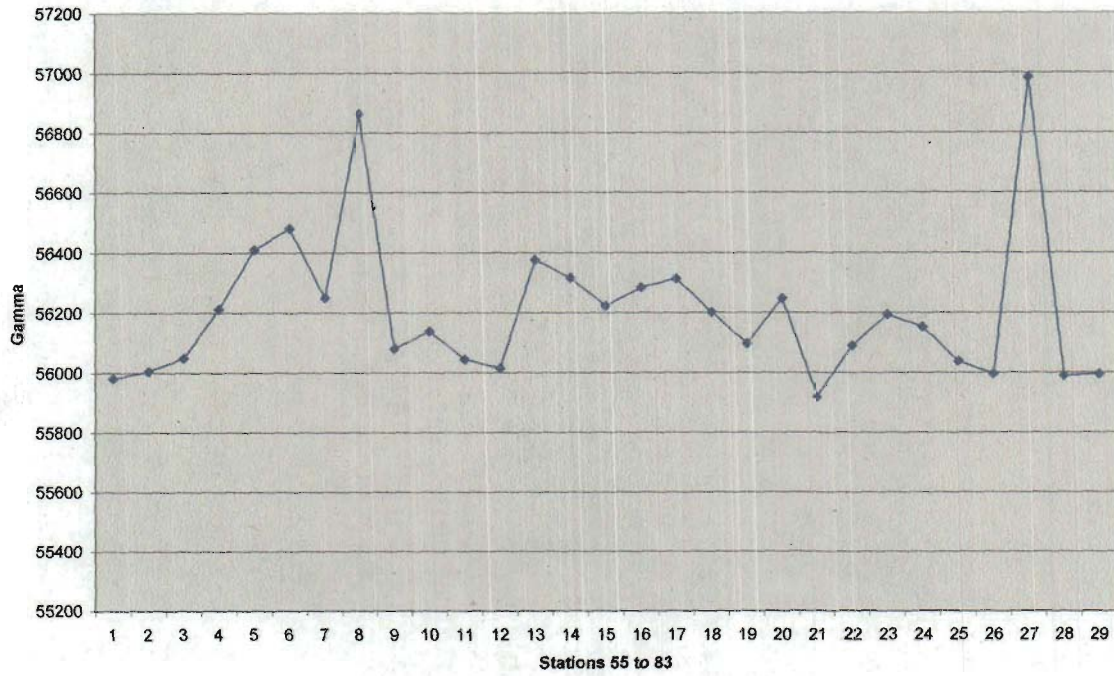

Line 3

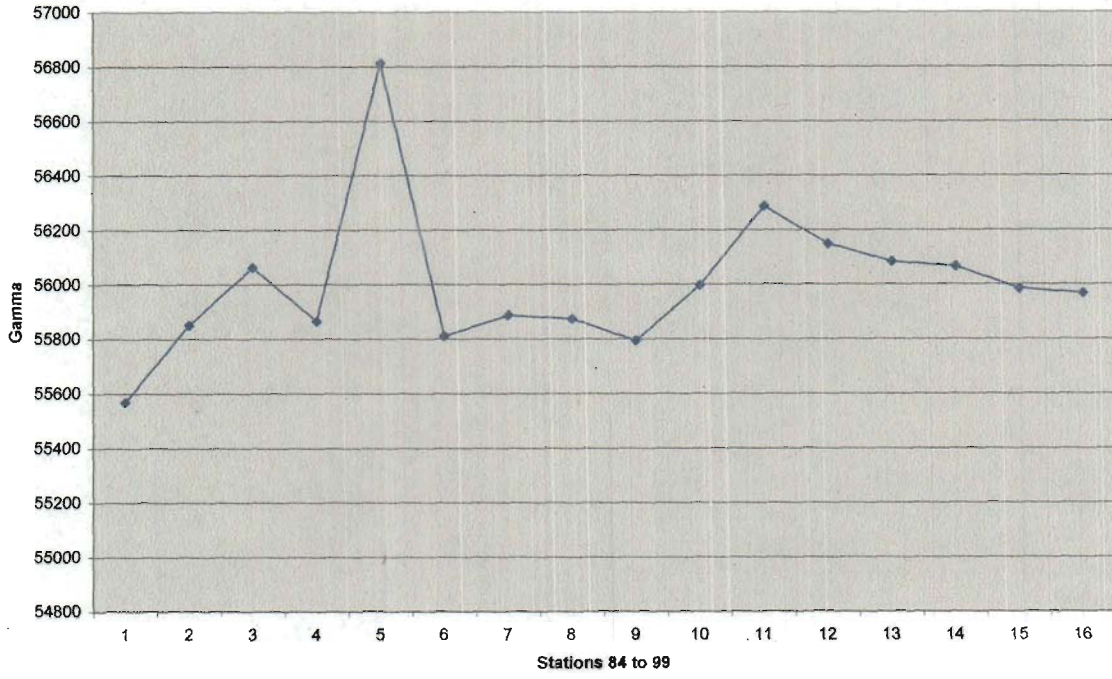

Line 4

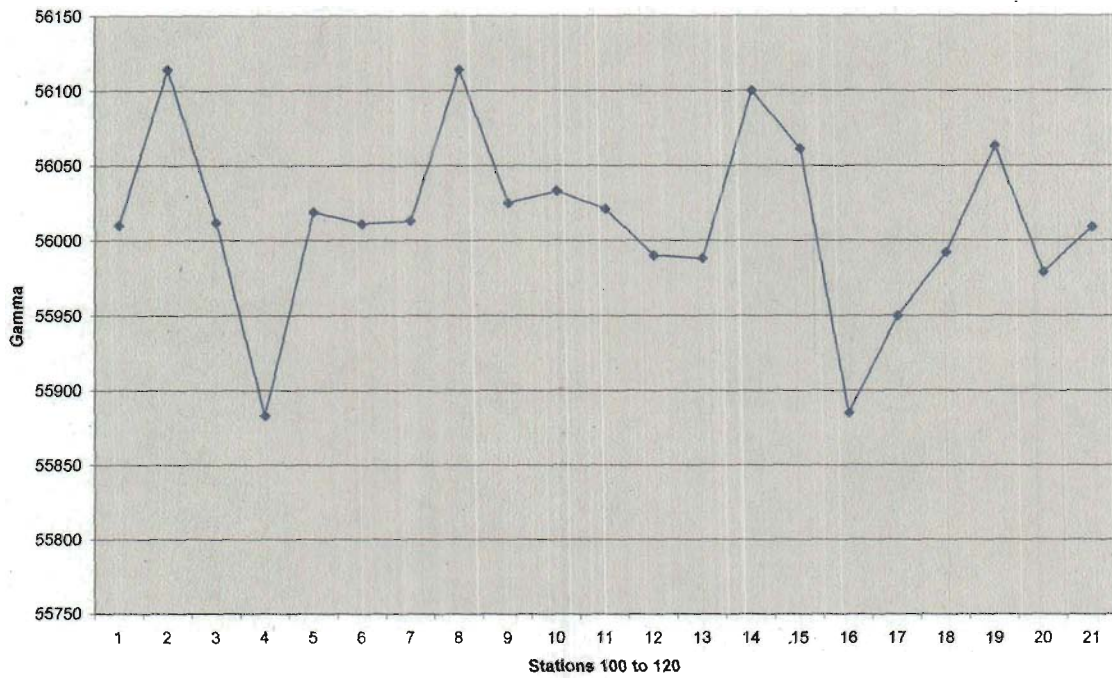

Line 5

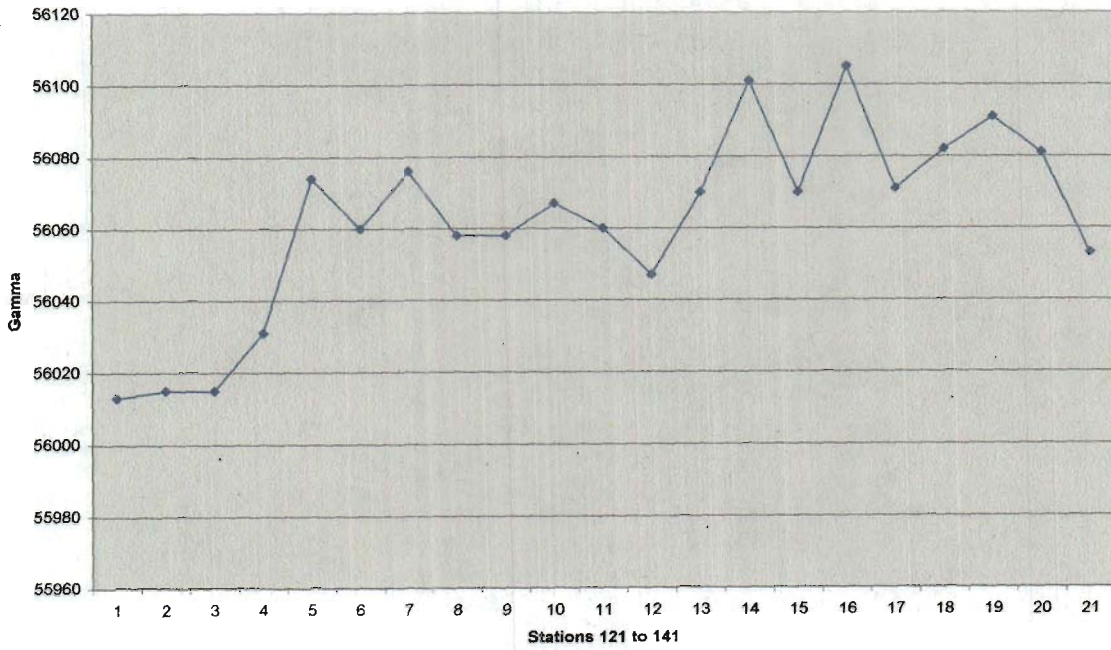

Line 6

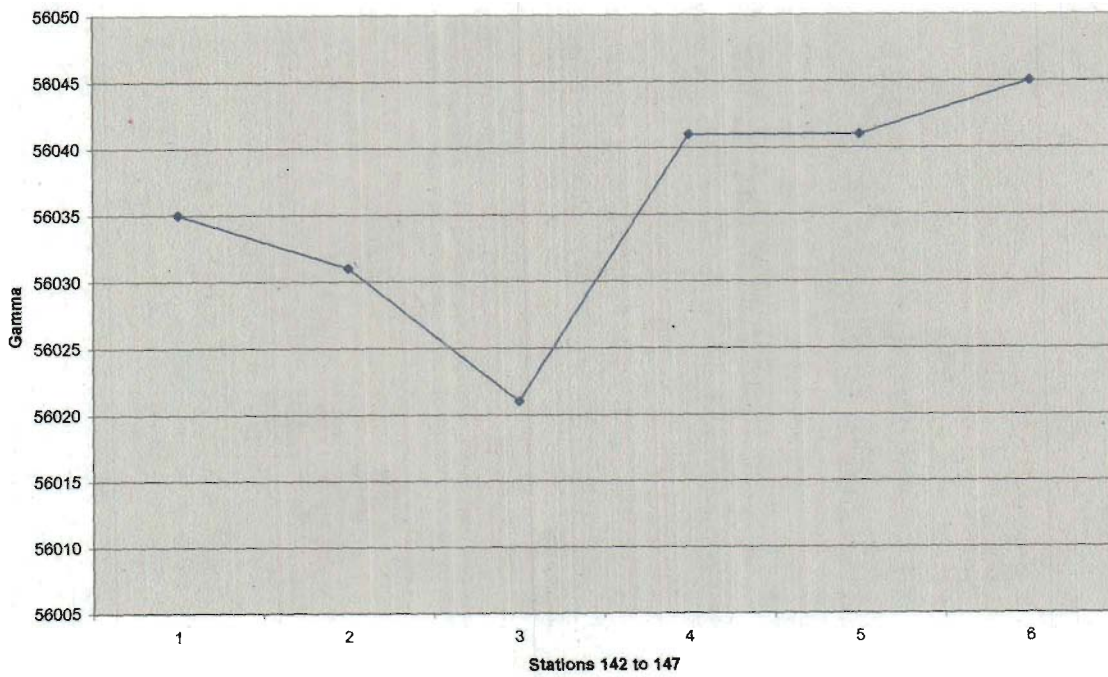

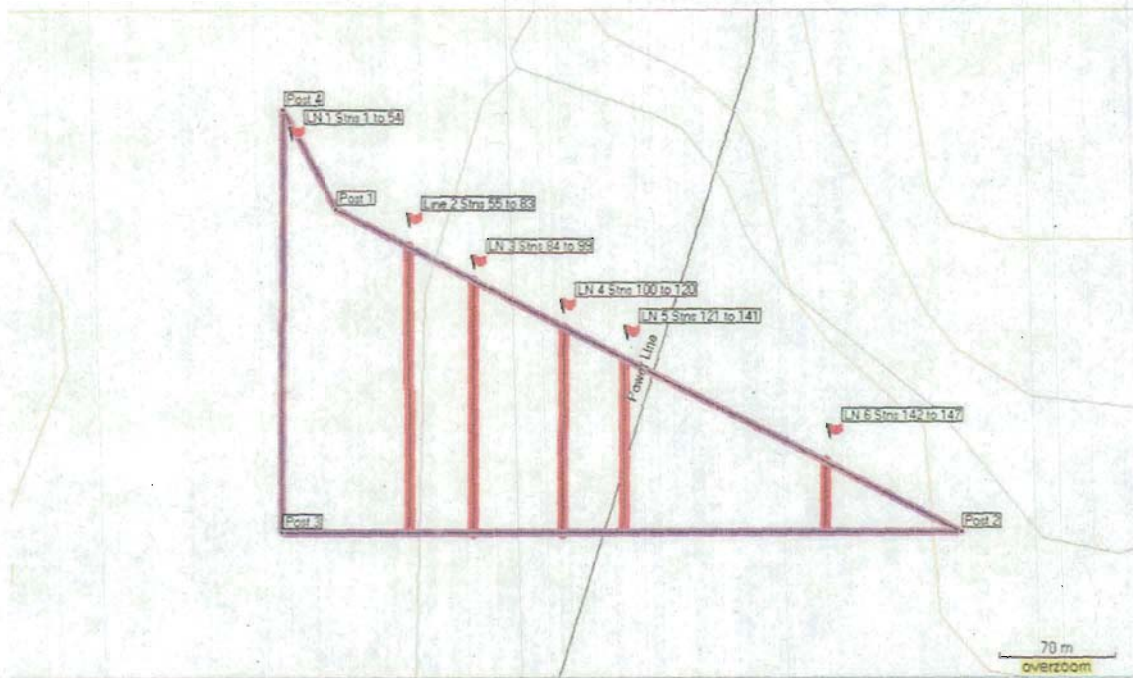

Claim # 3007689, Gillies Linn Larder Lake Mining Division. * Please note: Due to close spacing, the stations could not be added in this map *

