

63.5423



53K07NE0006 63.5423 STULL LAKE

010

1988
SUMMARY REPORT
ELLARD PROPERTY
N.T.S. 53-K-7

OM88-1-C-210

Ellard North (Au, Ontario)

Location: N.T.S. 53 K/7
Latitude 54 26'50"N
Longitude 92 35'10"W

Land Tenure: 88 Claims (1408 ha)

The Ellard North property was staked in late 1986 to acquire a gold occurrence discovered by prospectors in 1959. At that time prospectors' samples assayed as high as 137g/t Au. Ten holes (855m) were drilled by Rio Tinto over a strike length of 300 metres with the best assay being 4.8g/t/0.76m. Grab samples collected during regional mapping by the O.D.M. in 1967 returned values as high as 63.8g/t Au.

After acquiring the occurrence and its regional strike extension Westmin contracted Dighem Ltd. for a helicopter borne electromagnetic, VLF, and magnetometer survey (350 line km). A 1987 summer follow-up program of mapping and prospecting was undertaken at which time 30km of line was cut and flagged in three grids. These were surveyed by magnetometer and VLF-EM and geologically mapped. The highest assay obtained was 3.5g/t/0.5m from carbonatized volcanics with coarse quartz veins in the Eagle Island grid.

In 1988 limited geophysical and geological programs were carried out. A detailed magnetometer survey was carried out over Eagle Island (21km) and Max-Min II surveys (5.8km) covered previously defined VLF anomalies. During the summer low water levels accommodated extensive remapping and sampling of the Eagle Island grid. Mapping indicated the presence of a volcanic-sedimentary sequence. The gold showing occurs in carbonatized shear/alteration zones with coarse quartz veins which are common throughout the island. The highest assays obtained were 11.8g/t/0.5m and 10.6g/t/0.5m.

Future work on this property should consist of 600m of diamond drilling at an estimated cost of \$100,000 if carried out in conjunction with drilling at Little Stull Lake.

October 13, 1988.

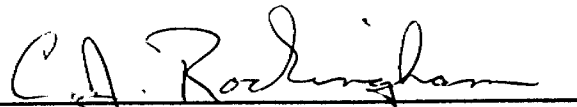
C. J. Rockingham, B.Sc., M.Sc.

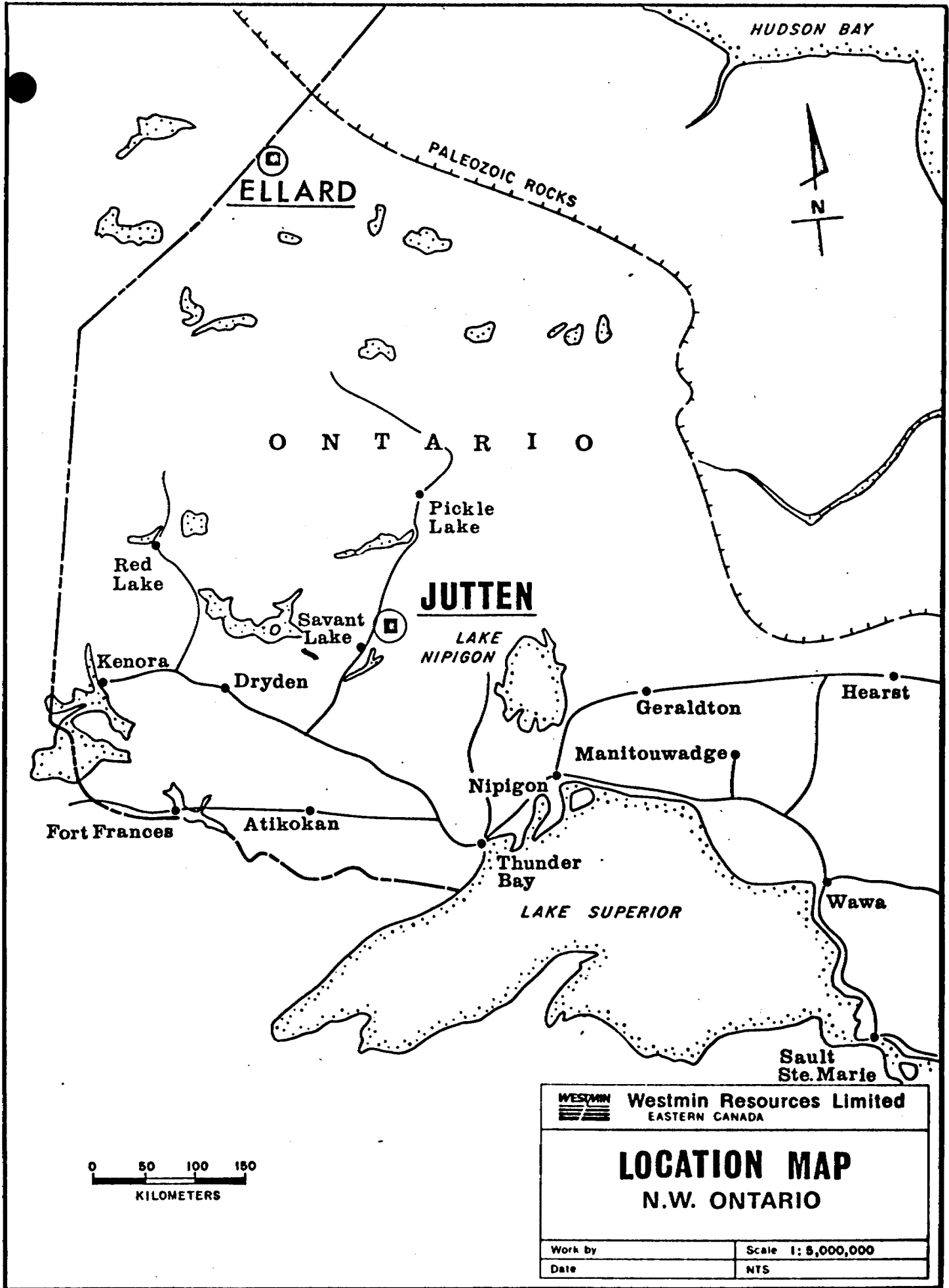

 Westmin Resources Limited EASTERN CANADA	
<h1>LOCATION MAP</h1> <h2>N.W. ONTARIO</h2>	
Work by	Scale 1: 5,000,000
Date	NTS

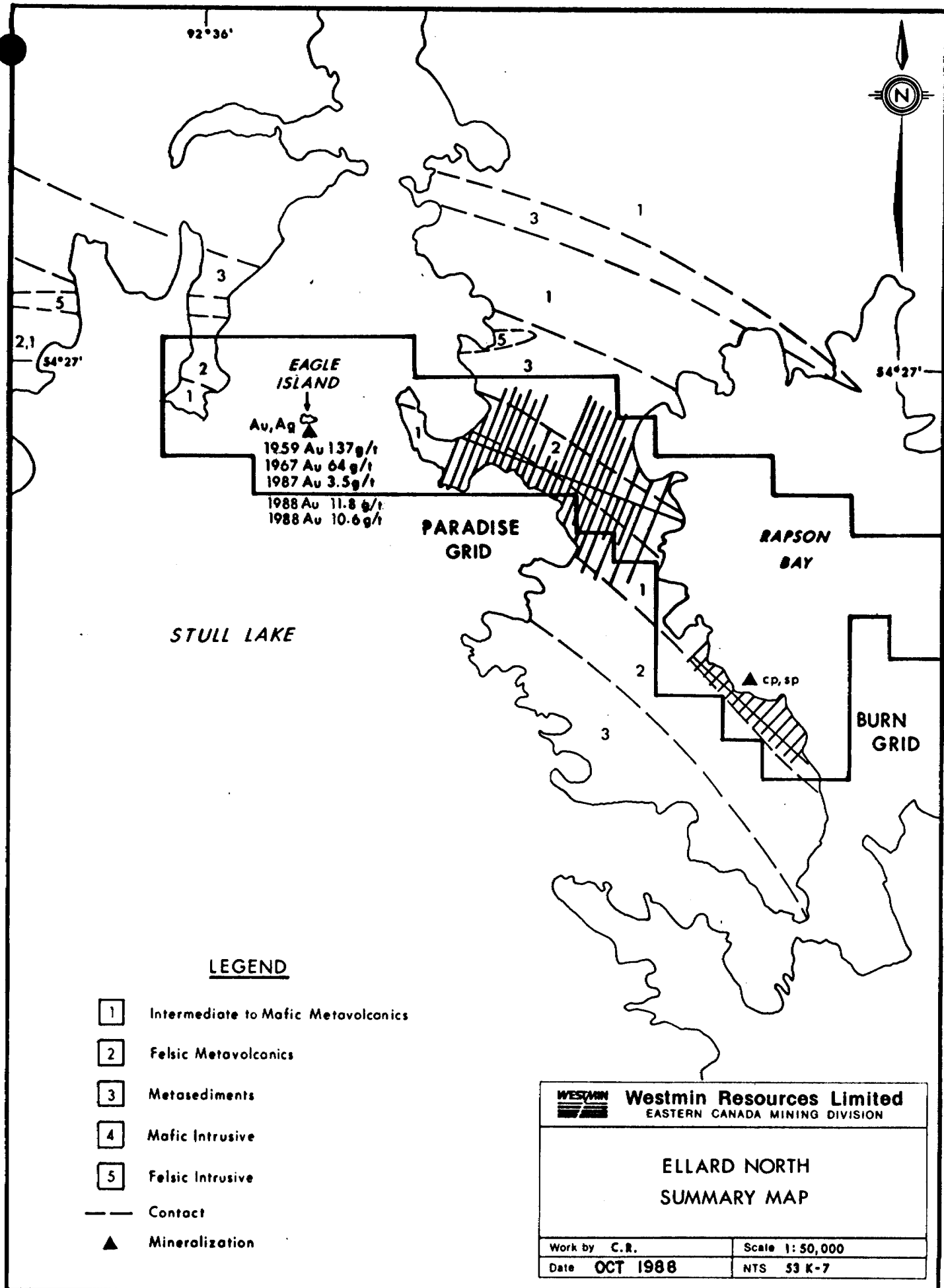

92°36'



54°27'

54°27'

EAGLE ISLAND
 Au, Ag
 ▲
 1959 Au 137 g/t
 1967 Au 64 g/t
 1987 Au 3.5 g/t
 1988 Au 11.8 g/t
 1988 Au 10.6 g/t

PARADISE GRID

RAPSON BAY

STULL LAKE

▲ cp, sp

BURN GRID

LEGEND

- 1 Intermediate to Mafic Metavolcanics
- 2 Felsic Metavolcanics
- 3 Metasediments
- 4 Mafic Intrusive
- 5 Felsic Intrusive
- Contact
- ▲ Mineralization

 Westmin Resources Limited EASTERN CANADA MINING DIVISION	
ELLARD NORTH SUMMARY MAP	
Work by C.R.	Scale 1:50,000
Date OCT 1988	NTS 53 K-7



ELLARD NORTH

KRL	KRL	KRL	KRL	KRL	KRL
904628	904633	904634	904635	904636	904637

KRL	KRL	KRL	KRL	KRL	KRL	KRL	KRL	KRL	KRL	KRL
904638	904639	904640	904641	904642	904643	904644	904645	904646	904647	904648

KRL	KRL	KRL	KRL	KRL	KRL	KRL	KRL	KRL	KRL	KRL	KRL
904630	904631	904632	904633	904634	904635	904636	904637	904638	904639	904640	904641

KRL	KRL	KRL	KRL	KRL	KRL	KRL	KRL	KRL	KRL	KRL	KRL	KRL	KRL	KRL	KRL
960110	960111	960112	904640	904641	904642	904643	904644	904645	904646	904647	904648	904649	904650	904651	904652

KRL	KRL	KRL	KRL	KRL	KRL	KRL	KRL
904653	904654	904655	904656	904657	904658	904659	904660

KRL	KRL	KRL	KRL	KRL	KRL	KRL	KRL
904661	904662	904663	904664	904665	904666	904667	904668

KRL	KRL	KRL	KRL	KRL	KRL	KRL	KRL	KRL	KRL
904669	904670	904671	904672	904673	904674	904675	904676	904677	904678

KRL	KRL	KRL	KRL	KRL	KRL	KRL	KRL
904679	904680	904681	904682	904683	904684	904685	904686

KRL	KRL	KRL	KRL	KRL	KRL	KRL	KRL
904687	904688	904689	904690	904691	904692	904693	904694

KRL	KRL	KRL	KRL	KRL	KRL
904695	904696	904697	904698	904699	904700

KRL	KRL	KRL	KRL
904701	904702	904703	904704

KRL	KRL	KRL	KRL	KRL	KRL
904554	904555	904556	904557	904558	904559

KRL	KRL	KRL	KRL	KRL	KRL
904560	904561	904562	904563	904564	904565

KRL	KRL	KRL	KRL	KRL	KRL
904566	904567	904568	904569	904570	904571

KRL	KRL	KRL	KRL	KRL	KRL
904572	904573	904574	904575	904576	904577

Rapson Bay

STW
Lake

ELLARD NORTH

Claim Map

Scale 1:31,680

Ellard South (Au, Ontario)

Location: N.T.S. 53 K/7
Latitude 54 21'50"N
Longitude 92 30'50"W

Land Tenure: 87 Claims (1392 ha)

The Ellard South property was staked in late 1986 to acquire a gold occurrence discovered by prospectors in 1935 (Wynne Bay). At that time visible gold was noted and grab sample assays as high as 56.6g/t Au were obtained by Satterly of the O.D.M. Ten short holes were drilled, but the results are not known.

After acquiring the occurrence and its regional strike extension Westmin contracted Dighem Ltd. for a helicopter borne electromagnetic, VLF, and magnetometer survey (375 line km). A 1987 summer program of mapping and prospecting was undertaken at which time 26km of line was cut and flagged in two grids. These were surveyed by VLF and magnetometer and geologically mapped. High water levels obstructed mapping in the vicinity of the gold occurrence. The mapping confirmed the presence of a volcanic-sedimentary sequence and the geophysical surveys defined eight conductive zones at or near the favourable contact area.

In 1988 limited geophysical and geological programs were carried out. Max-Min II (HLEM) surveys totalling 4.4km along a strike length of 800 metres indicated variable conductivity along the contact on which the gold occurrence is located. During the summer low water levels allowed for more extensive remapping and sampling of the Wynne Bay area. A grab sample collected by G. Bull in the vicinity of the 1935 gold showing at the metagreywacke/quartz-carbonate-chlorite schist contact yielded 5.8g/t Au.

Future work on this property should consist of 700m of diamond drilling in 8-10 holes. If this is carried out in conjunction with drilling at Little Stull Lake the estimated cost would be \$125,000.

October 13, 1988.

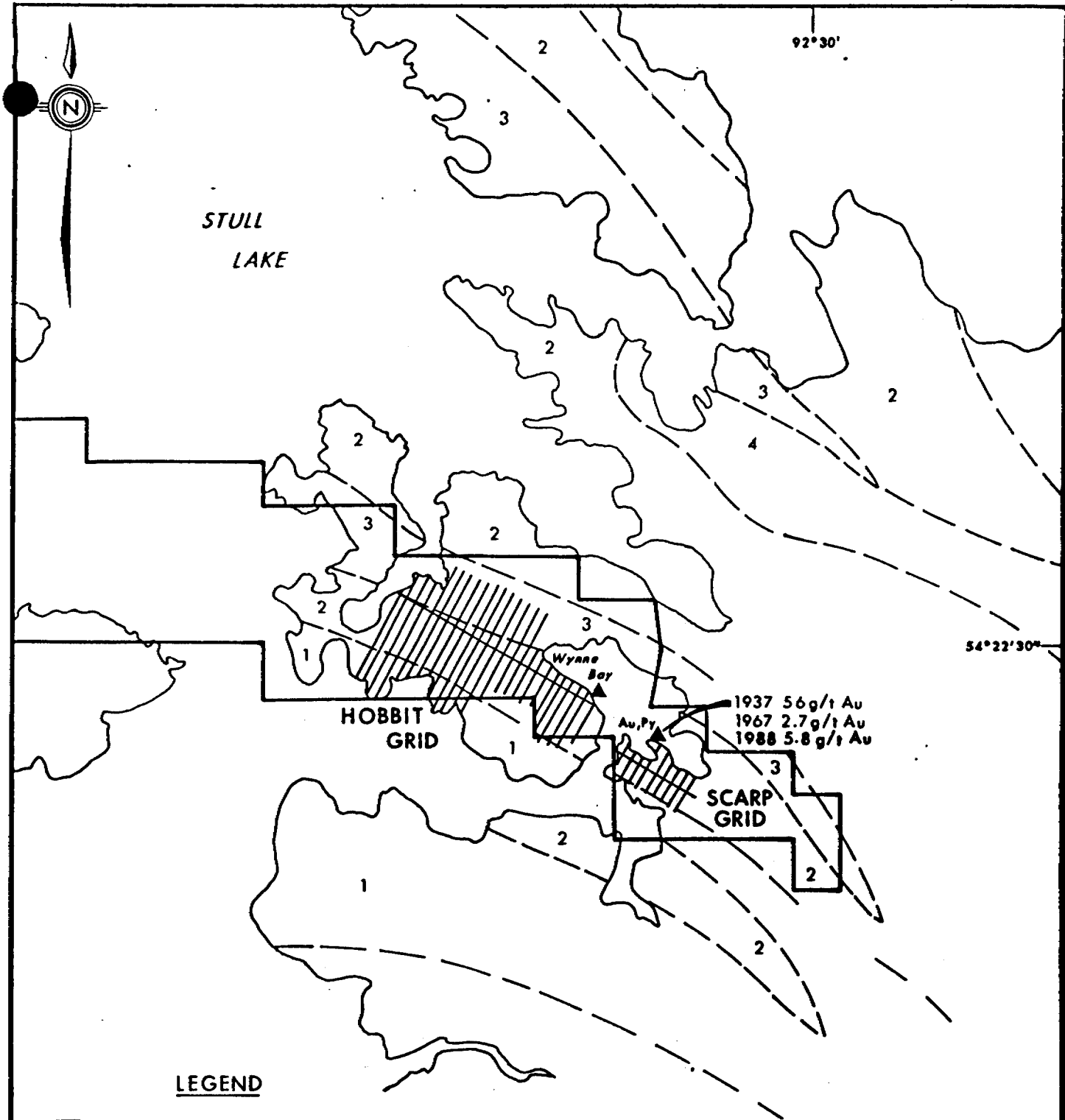

C. J. Rockingham, B.Sc., M.Sc.

File: Ellard



LEGEND

- 1 Intermediate to Mafic Metavolcanics
- 2 Felsic Metavolcanics
- 3 Metasediments
- 4 Mafic Intrusive
- 5 Felsic Intrusive
- Contact
- ▲ Mineralization

 Westmin Resources Limited EASTERN CANADA MINING DIVISION	
ELLARD SOUTH SUMMARY MAP	
Work by C. R.	Scale 1:50,000
Date OCT 1988	NTS 53 K-7

ELLARD SOUTH

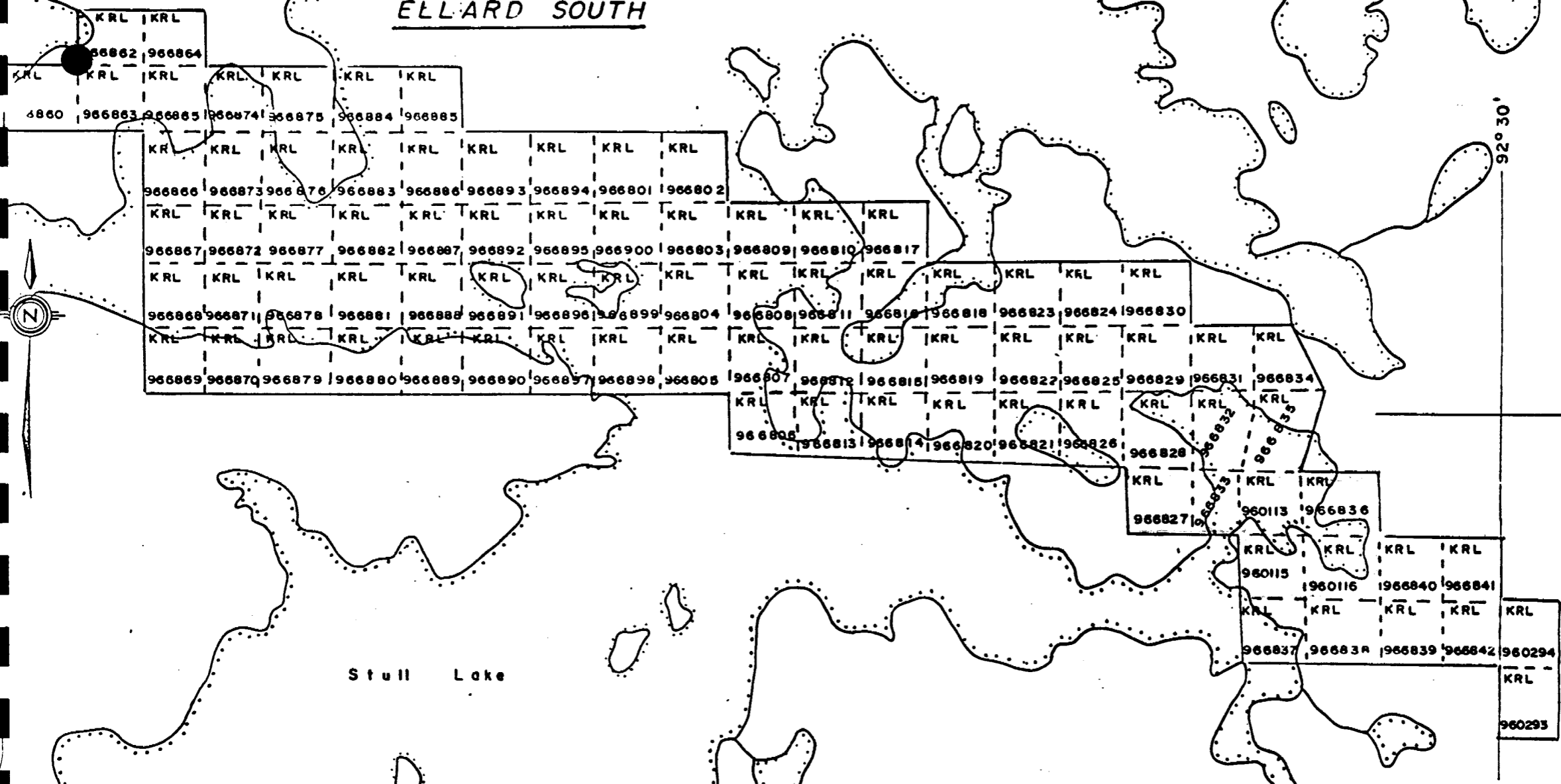

Stull Lake

Stull

 Westmin Resources Limited	
<p><u>ELLARD SOUTH</u></p> <p>Claim Map</p>	
Work by	Scale 1:31,680
Date	NTS 53-K-7



Chemex Labs Ltd.
 Analytical Chemists • Geochemists • Registered Assayers
 450 MATHESON BLVD. E. UNIT 54, MISSISSAUGA,
 ONTARIO, CANADA L4Z-1R5
 PHONE (416) 890-0310

1400 - 25 ADELAIDE ST. EAST
 TORONTO, ON
 M5C 1Y2
 Project: ELIARD /North
 Comments: ATTN: R. H. McMILLAN

Date: 20-SEP-85
 Invoice #: I-8823091
 P.O. #: NONE

CERTIFICATE OF ANALYSIS A8823091

SAMPLE DESCRIPTION	PREP CODE		Mo	Na	Ni	P	Pb	Sb	Sc	Sr	Ti	Tl	U	V	W	Zn
			ppm	%	ppm	ppm	ppm	ppm	ppm	ppm	ppm	%	ppm	ppm	ppm	ppm
10213 RESPLIT	247	238	5	0.05	10	1110	38	< 5	1	252	0.03	< 10	< 10	14	< 5	59
10226 RESPLIT	247	238	3	0.02	15	1140	12	< 5	< 1	383	< 0.01	< 10	< 10	9	< 5	46
10230 RESPLIT	247	238	7	0.03	9	1390	34	< 5	< 1	432	0.01	< 10	< 10	12	< 5	56
10231 RESPLIT	247	238	not/ss	not/ss	not/ss	not/ss	not/ss	not/ss	not/ss	not/ss	not/ss	not/ss	not/ss	not/ss	not/ss	not/ss
10233 RESPLIT	247	238	not/ss	not/ss	not/ss	not/ss	not/ss	not/ss	not/ss	not/ss	not/ss	not/ss	not/ss	not/ss	not/ss	not/ss

ALL ASSAY DETERMINATIONS ARE PERFORMED OR SUPERVISED BY B.C. CERTIFIED ASSAYERS

CERTIFICATION: *B. Coughlin*



Chemex Labs Ltd.

Analytical Chemists • Geochemists • Registered Assayers
 450 MATHESON BLVD., E., UNIT 54, MISSISSAUGA,
 ONTARIO, CANADA L4Z-1R5
 PHONE (416) 890-0310

VESMIN RESOURCES LTD.

1400 - 25 ADELAIDE ST. EAST
 TORONTO, ON
 M5C 1Y2

Project: ELLARD / North
 Comments: ATTN: R. H. MCILLAN

Page No: 1-A
 Lot: 1
 Date: 20-SEP-85
 Invoice #: I-8823091
 P.O. #: NONE

CERTIFICATE OF ANALYSIS A8823091

SAMPLE DESCRIPTION	PREP CODE		Au FA	Al	Ag	As	Ba	Be	Bi	Ca	Cd	Co	Cr	Cu	Fe	Ga	Hg	K	La	Mg	Mn
			g/tonne	%	ppm	ppm	ppm	ppm	ppm	%	ppm	ppm	ppm	ppm	%	ppm	ppm	%	ppm	%	ppm
10213 RESPLIT	247	238	5.83	0.70	0.8	50	130	0.5	6	1.61	< 0.5	6	20	15	1.74	10	< 1	0.28	50	0.49	4
10226 RESPLIT	247	238	11.80	0.50	2.2	115	50	0.5	10	3.45	< 0.5	10	12	29	2.38	< 10	< 1	0.21	30	1.31	5
10230 RESPLIT	247	238	10.60	0.85	1.6	75	110	0.5	6	2.55	< 0.5	9	16	8	2.26	10	< 1	0.33	40	0.73	5
10231 RESPLIT	247	238	not/ass	not/ass	not/ass	not/ass	not/ass	not/ass	not/ass	not/ass	not/ass	not/ass	not/ass	not/ass	not/ass	not/ass	not/ass	not/ass	not/ass	not/ass	not/ass
10233 RESPLIT	247	238	not/ass	not/ass	not/ass	not/ass	not/ass	not/ass	not/ass	not/ass	not/ass	not/ass	not/ass	not/ass	not/ass	not/ass	not/ass	not/ass	not/ass	not/ass	not/ass

ALL ASSAY DETERMINATIONS ARE PERFORMED OR SUPERVISED BY B.C. CERTIFIED ASSAYERS

CERTIFICATION: B. Coughlin



Chemex Labs Ltd.

Analytical Chemists * Geochemists * Registered Assayers
 450 MATHESON BLVD. P. UNIT 54, MISSISSAUGA,
 ONTARIO, CANADA L4Z-1R5
 PHONE (416) 890-0310

WESTMIN RESOURCES LTD.

1400 - 25 ADELAIDE ST. EAST
 TORONTO, ON
 M5C 1Y2

Project: ELLARD N & S
 Comments: ATT'N DR R H McMILLAN

Page No. 1
 Tot. Pages: 2
 Date: 8-SEP-88
 Invoice #: 1-8822465
 P.O. #

CERTIFICATE OF ANALYSIS A8822465

SAMPLE DESCRIPTION	PREP CODE		Au ppb FA+AA											
10203	212	---	< 5											
10204	212	---	< 5											
10205	212	---	< 40											
10206	212	---	< 5											
10207	212	---	70											
10208	212	---	< 5											
10209	212	---	< 5											
10210	212	---	< 40											
10211	212	---	< 5											
10212	212	---	< 5											
10213	212	---	700											
10214	212	---	< 5											
10215	212	---	< 5											
10216	212	---	< 5											
10217	212	---	< 5											
10218	212	---	< 5											
10219	212	---	< 10											
10220	212	---	< 5											
10221	212	---	< 5											
10222	212	---	< 5											
10223	212	---	< 5											
10224	212	---	< 5											
10225	212	---	95											
10226	212	---	8250											
10227	212	---	600											
10228	212	---	< 15											
10229	212	---	< 5											
10230	212	---	> 10000											
10231	212	---	1250											
10232	212	---	135											
10233	212	---	1620											
10234	212	---	65											
10235	212	---	< 5											
10236	212	---	< 5											
10237	212	---	< 5											
10238	212	---	< 55											
10239	212	---	< 5											
10240	212	---	60											
10241	212	---	300											
10242	212	---	130											

CERTIFICATION:



Chemex Labs Ltd.

Analytical Chemists * Geochemists * Registered Assayers
 450 MATHESON BLVD. E., UNIT 54, MISSISSAUGA,
 ONTARIO, CANADA L4Z-1R5
 PHONE (416) 890-0310

WEIGHT REFINERIES

1400 - 25 ADELAIDE ST. EAST
 TORONTO, ON
 M5C 1Y2

Project : ELIARD N & S
 Comments: ATT'N DR R H McMILLAN

Page No. [redacted]
 Tot. Pages: 2
 Date : 8-SEP-88
 Invoice # : I-8822465
 P.O. #

CERTIFICATE OF ANALYSIS A8822465

SAMPLE DESCRIPTION	PREP CODE		Au ppb								
			FA+AA								
10243	212	---									
10244	212	---	V	S							
10245	212	---	V	S							
10246	212	---	V	S							
10247	212	---	V	S							

CERTIFICATION : *Thade Ward*

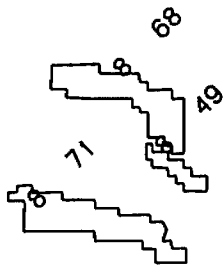



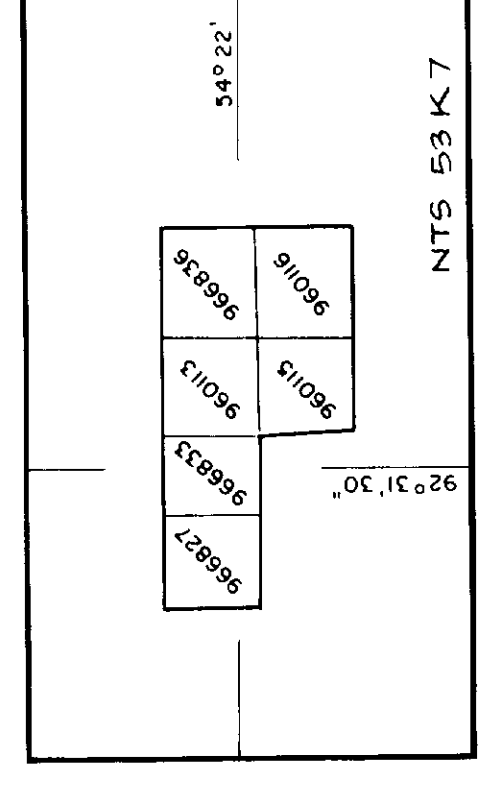
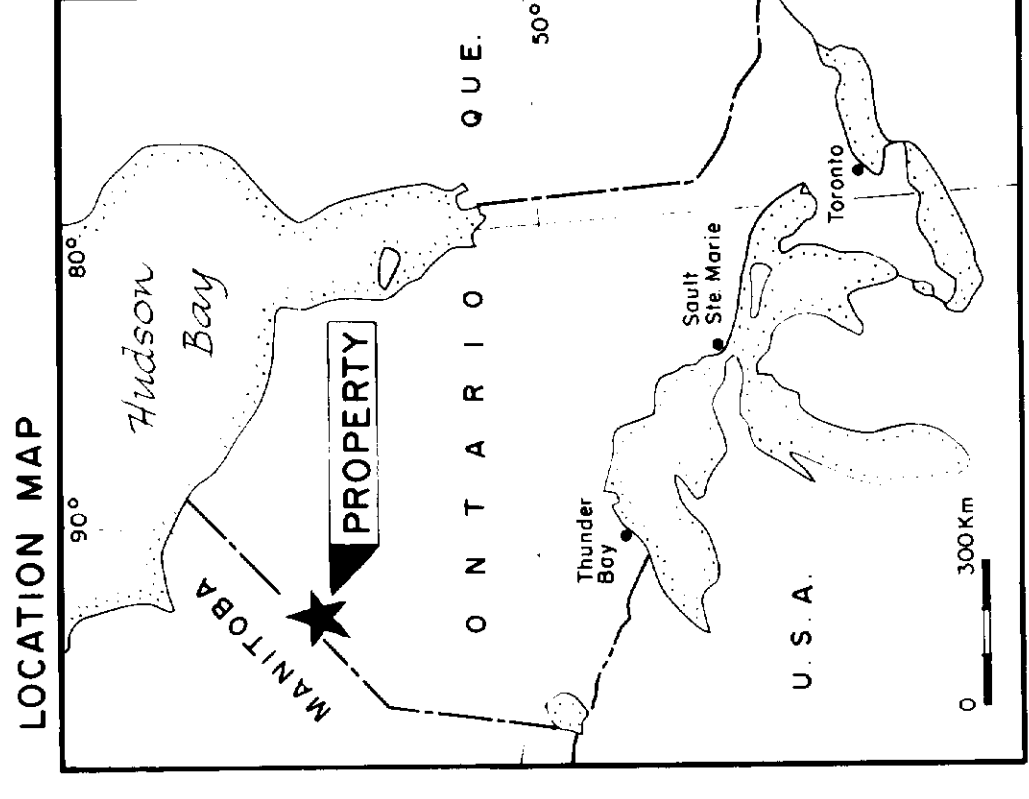
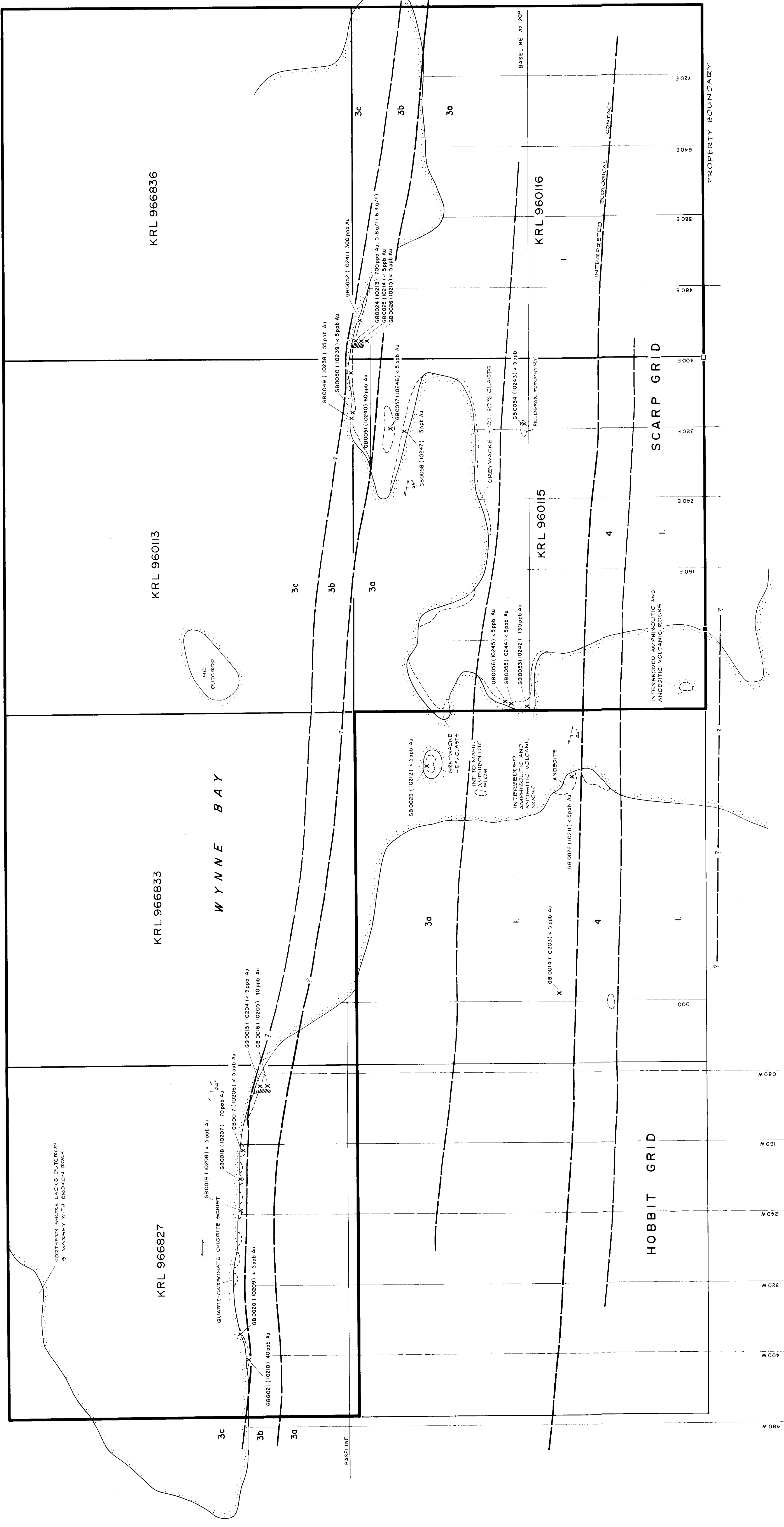
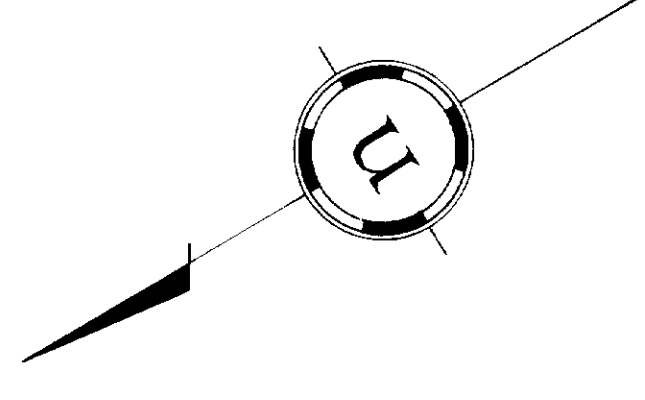

LEGEND

- I INTERMEDIATE TO MAFIC METAVOLCANICS MODERATELY TO WELL-FOLIATED VOLCANIC FLOW OF INTERMEDIATE TO MAFIC COMPOSITION. THIS INCLUDES FELDSPAR PORPHYRIES OF OF PROBABLE ANDESITIC COMPOSITION. NARROW QUARTZ VEINS OCCUR IN BOTH ANDESITIC AND INTERMEDIATE TO MAFIC BEDS. AMPHIBOLITIC AND ANDESITIC ROCK ARE INTERBEDDED AND CONTAIN TRACE TO 3% PY IN PLACES
- 3a METAGREYWACKE FOLIATED FINE-GRAINED FELSIC MATRIX CONTAINING ROUNDED TO SUBANGULAR QUARTZ AND FELDSPAR GRAINS UP TO 1.5mm. MANY GRAINS ARE ELONGATE IN THE DIRECTION OF BEDDINGS/FOLIATION. PERCENTAGE OF GLAUS RANGES FROM 5% TO 50%. 1 TO 5% PY OCCURS THROUGHOUT THE ROCK
- 3b INTERBEDDED SHALES AND METAGREYWACKE NARROW INTERBEDS OF FISSILE (SHALE-LIKE) BLACK ROCK AND SCHISTOSE METAGREYWACKE. THE PRESENCE OF MICACEOUS MINERALS (CHLORITE, SERICITE) IS OBSERVED IN THESE UNITS. 1 TO 5% PY. IS COMMON THROUGHOUT THESE ROCKS
- 3c QUARTZ-CARBONATE - CHLORITE - SCHIST SCHISTOSE ROCK CONTAINING 1 TO 3% PY AND POSSIBLE ASP MINOR BIOTITE WAS OBSERVED.
- 4 PILLOWED FELDSPAR PORPHYRY FLATTENED AND DEFORMED PILLOWS OF FINE GRAINED FELSIC MATRIX CONTAINING COARSE (UP TO 0.8cm) WELL DEVELOPED FELDSPAR 'SELVAGES' ARE ALIGNED AND SOFT. DEFORMATION MARKS ARE OBSERVED THROUGHOUT THESE ROCKS. NO VISIBLE 'SULPHIDES' WERE NOTED.

SYMBOLS

- OUTCROP
- SHORELINE
- OLD TRENCH
- INTERPRETED GEOLOGICAL CONTACT
- FOLIATION AND/OR BEDDING AND DIP

X GB 0037 (0226) 8250ppb Au - II 897/0.5m
 X GB 0037 (0226) 8250ppb Au - II 897/0.5m
 SAMPLE LOCATION AND NUMBER, CHEMEX ASSAY NUMBER, PULP ASSAY, FA OF REJECT.

NOTE: MAPPING DONE BY FACE AND COMPASS

REVISIONS	BY	DATE

655423

Westmin Resources Limited
 EASTERN MINING EXPLORATION

WYNE BAY
 GEOLOGY & PROSPECTING MAP

ELLARD SOUTH PROJECT
 PATRICK MINING DISTRICT-ONTARIO

Work by G B Scale 1:2000
 Date Aug. 1988 NTS 53 K/7

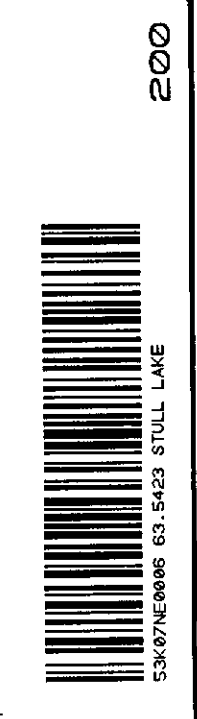

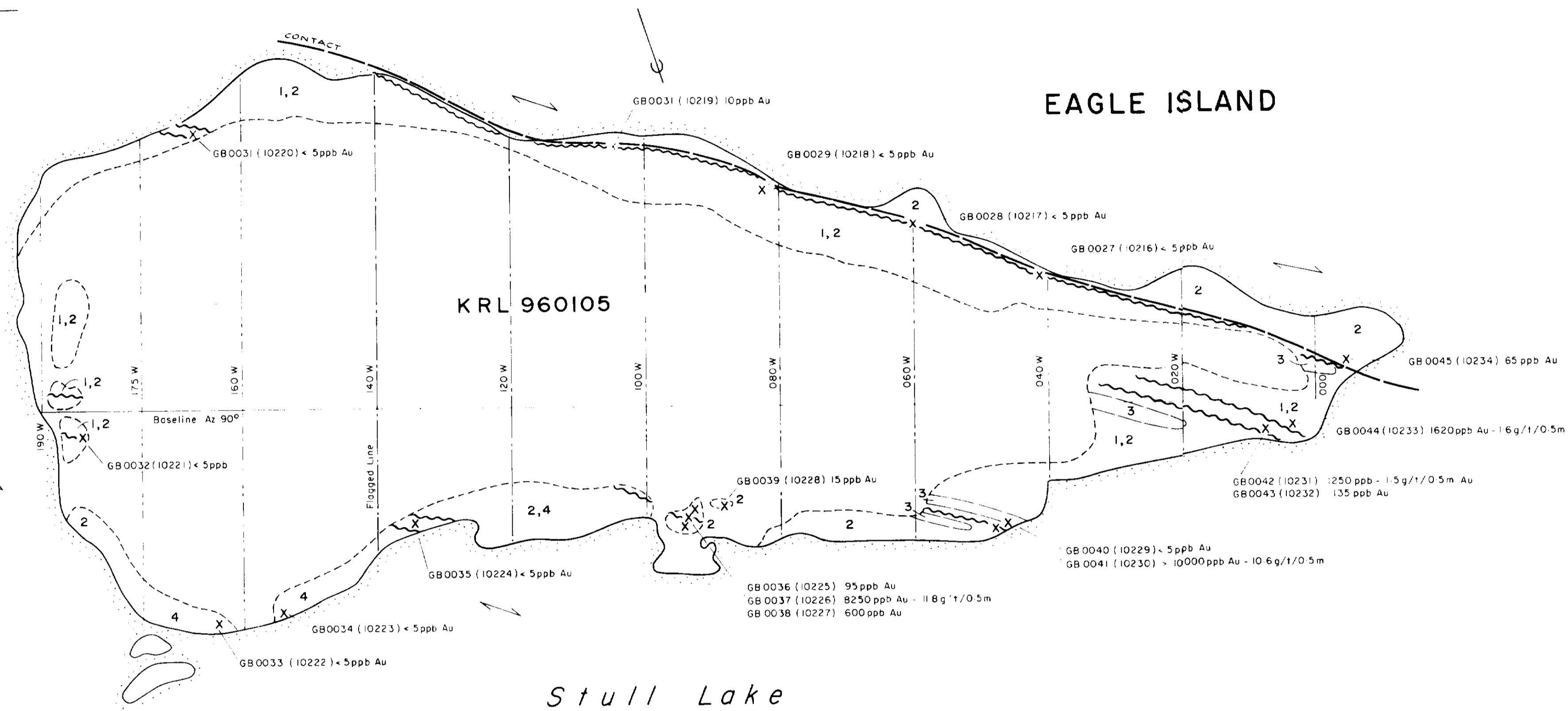
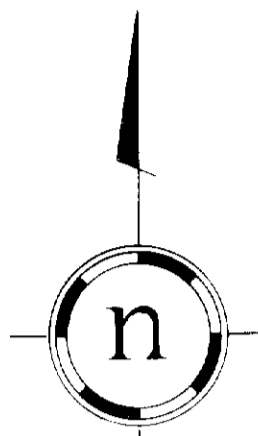

EAGLE ISLAND

LEGEND

- 1 INTERMEDIATE TO MAFIC FLOW
FINE-GRAINED WEAKLY TO MODERATELY FOLIATED MAFIC ROCK. CARBONATE IS ABUNDANT THROUGHOUT. PYRITE IS TRACE TO 1%. JOINTING AT 63° OCCURS NEAR SHEAR ZONES. MANY JOINTS ARE QUARTZ FILLED. QUARTZ OCCURS THROUGHOUT THE ROCK AND IN NARROW CONCORDANT AND DISCORDANT VEINS.
- 2 INTERMEDIATE TO MAFIC TUFF
FINELY BEDDED GREEN GREY ROCK OF INTERMEDIATE COMPOSITION. CONTAINS ABUNDANT NARROW QUARTZ VEINS, CONCORDANT AND DISCORDANT. MAINLY FINE-GRAINED BUT GRADES TO LAPILLI TUFF IN PLACES. PYRITE IS 1 TO 3%. FOLIATION IS CONCORDANT WITH BEDDING (102° - 110°). A SECOND, WEAKER FOLIATION IS APPARENT IN THIS ROCK ON THE SOUTH SHORE AT 63° TO 68°.
- 3 FELDSPAR PORPHYRY
MEDIUM TO COARSE-GRAINED. WELL DEVELOPED FELDSPAR OCCURS IN A MATRIX OF FINE-GRAINED QUARTZ AND FELDSPAR. THIS UNIT IS MASSIVE BUT LIES CONCORDANT TO BEDDING AND THE 110° FOLIATION. NO VISIBLE SULPHIDES ARE ASSOCIATED.
- 4 METAGREYWACKE
MEDIUM GRAINED FELDSPAR AND QUARTZ (< 1 TO 1.5 mm) OCCUR IN A FINE-GRAINED MATRIX OF THE SAME. TRACE TO 2% PYRITE IS ASSOCIATED WITH THIS UNIT. THIS UNIT MAY HAVE PREVIOUSLY BEEN MAPPED AS A LAPILLI TUFF.
- SHEAR ZONE
INTENSE SMALL-SCALE LOCAL FOLDING AND FAULTING OCCUR AT THESE ZONES. SILICIFICATION AND CARBONITIZATION ALTERATIONS ARE APPARENT. COARSE-GRAINED QUARTZ OCCURS IN VEINS AND FRACTURES WITHIN THESE ZONES. FOLDING AND BOUNDING OF QUARTZ VEINS OCCUR. UP TO 5% PYRITE WAS OBSERVED.

SYMBOLS

- OUTCROP
- SHORELINE
- SHEAR/ALTERATION ZONE
- STRIKE OF FOLIATION AND/OR BEDDING
- X GB 0037 (10226) 8250 ppb Au - 11.8 g/t/0.5 m
SAMPLE LOCATION AND NUMBER, CHEMEX ASSAY NUMBER, PULP ASSAY, FA OF REJECT.
- MAPPING DONE BY PACE AND COMPASS

LOCATION MAP

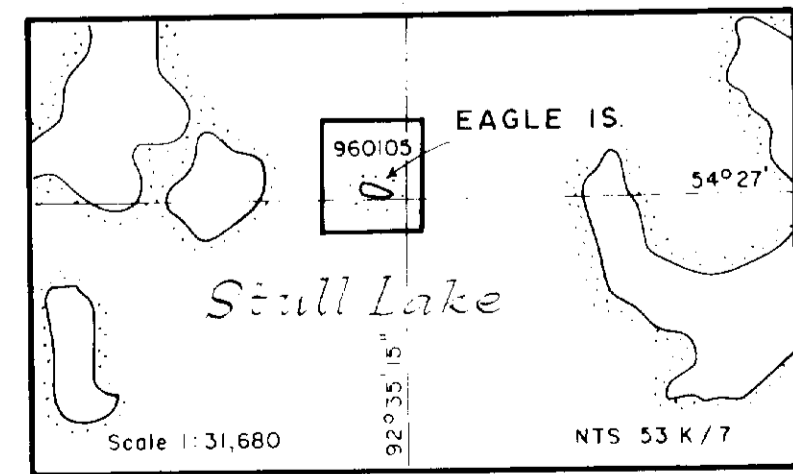
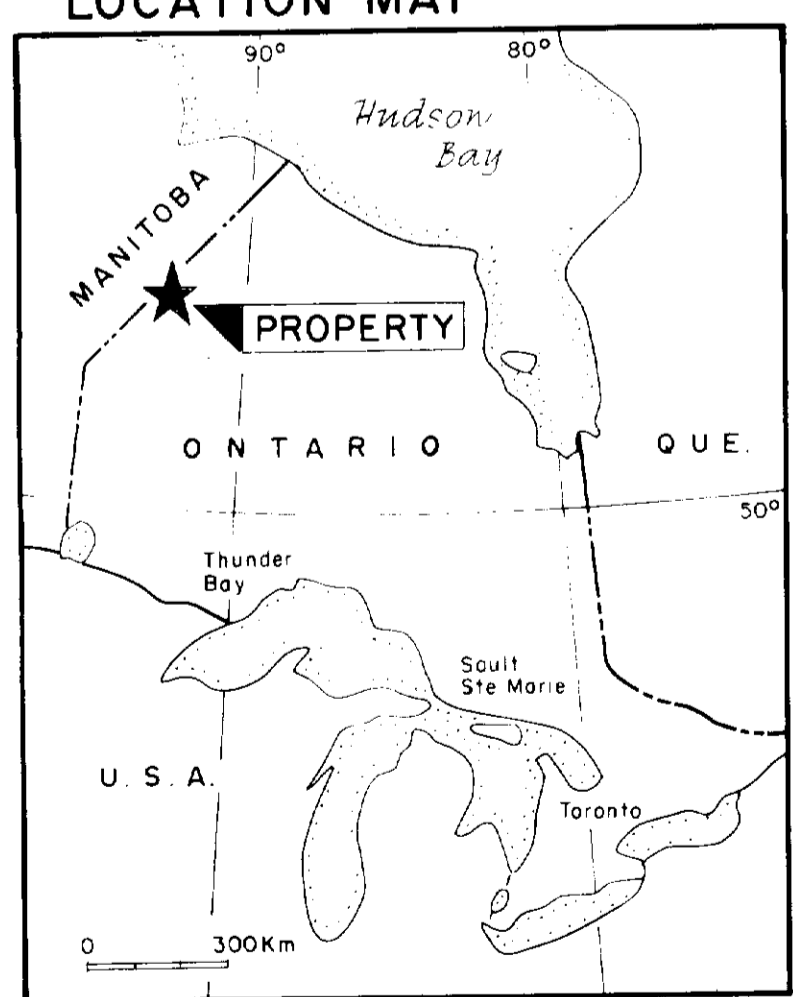

NOTE

MANY OF THE OUTCROPS SHOWED A DISTINCT FOLIATION BY DIFFERENTIAL WEATHERING AT A STRIKE OF 068°, DISCORDANT TO BEDDING AND A SECOND FOLIATION CONCORDANT TO BEDDING. NEAR SHEAR (ALTERATION) ZONES THE 068° FOLIATION HAS BEEN OBLITERATED BY THE ~112° FOLIATION. INSTANCES OF JOINING OR FRACTURING AT OR NEAR 068° IN THE VICINITY OF THE SHEAR ZONES IS COMMON. THE EMPLACEMENT OF COARSE-GRAINED QUARTZ INTO THESE JOINTS OR FRACTURES IS ALSO COMMON. GLACIAL STRIAE AT 166°-169° ARE COMMON ON MOST ROCK SURFACES.



REVISIONS	
BY	DATE

OM88-1-C-210 63.5423

WESTMIN Westmin Resources Limited
EASTERN MINING EXPLORATION

ELLARD NORTH PROJECT
PATRICIA MINING DIVISION - ONTARIO

EAGLE ISLAND
GEOLOGY & PROSPECTING MAP

Work by G B, PG	Scale 1: 500
Date AUG 1988	NTS 53 K/7

