



41P12SW0075 2.4651 CHESTER

010

November 24, 1981.

Mr. J. F. Daly,
President,
Hanson Mineral Exploration Limited,
1610 - 25 Adelaide St. East,
Toronto, Ont. M5C 1Y2

RECEIVED

MAR 29 1982

MINING LANDS SECTION

Dear Mr. Daly:

Re: North Claim Group - Chester Twp., Ont.

VLF Survey

A base line was cut across the claim group along the strike of the "Main" shear zone, on a bearing of 300°. Cross lines were run at 300 foot intervals at right angles to the base line. With the CRONE VLF instrument readings for dip angle and field strength were taken at 100 foot intervals along the lines. The station read was Seattle, Wash.

The survey showed the following:

The "East Zone" is not conductive.

A very weak possible conductor is indicated over the "Main Zone" for a length of six hundred feet.

In the northwest portion of the claim group a conductor extends for a length of nine hundred feet. Between this conductor and the "Main Zone", two possible conductors are indicated under the small lake. Survey results were not complete under the lake portion. From the "Main Zone" these conductors are offset to the northwest, each by approximately one hundred feet. This is typical of veins and zones in this area.

These possible conductors, and in part the most westerly conductor, normally would probably indicate fault zones or barren shears. However, a short distance south of the western conductor, outcrop (with thirty foot cliffs) is a sheared and carbonated greywacke similar to that at the "Main" and "East" zones. The similarity to the rock types, structure and low field strength over the known zones associated with these possible conductors suggest that there would be sulphide mineralization associated with this conductor and possible conductors. Testing by drilling would appear warranted.

Mapping

Mapping of the observed outcrops was completed except for a portion of the northeast part of claim P.537237.

The claims are located in the belt of Temiskaming sediments just north of the granite and porphyry intrusive complex of the central portion of Chester Twp. On these claims the sediments consist principally of medium textured greywacke, fairly massive to lightly sheared. The strike varies roughly, in a gentle arc, from

300° in the eastern and central portions to 260° in the western half of claim F. 537238. Dips are generally vertical to near vertical. The greywacke bordering the "Main Zone" and the "East Zone" is well sheared and carbonated and with some sericite. The greywacke along the cliff faces just south of the creek at 1300 to 1500 west is also well sheared with considerable sericite. An outcrop of carbonated greywacke also occurs in the extreme southeast corner of the claim group. Short, narrow, irregular veins of barren white quartz occur frequently in the greywacke. Several narrow bands or pods of greenstone (or chlorite schist) occur near the "Main" and "East" zones.

Three zones of sulphide mineralization have been located to date. These occur in sheared and carbonated greywacke, with the heaviest mineralization occurring in sericite schist.

"Main Zone"

This is located in the central portion of the claim group just east of the southeast corner of the small lake. Trenching has shown a 200 ft. length of a mineralized shear zone, open at both ends under overburden, with widths of mineralization to five feet. The mineralization consists of fine pyrite with slight pyrrhotite occurring disseminated and as thin seams along shear planes, occasionally up to three inches thick.

Grab samples of broken rock from the pit just east of the lake assayed 0.425 oz/ton gold. Eight channel samples taken along the zone assayed up to 0.128 oz/ton gold over 2.3 ft. and 0.102 oz/ton gold over 3.8 ft. at the east end of the trenching. One drill hole intersected the mineralized shear zone at a vertical depth of 85 ft. showing the structure continuing to depth with similar mineralization and width. Unfortunately however only 50% core recovery was obtained from the 3.5 ft. section of sericite schist in the mineralized zone. Sludge indicated the heaviest sulphide mineralization to occur in the sericite schist. Assay values of the core were nil.

"East Zone"

This zone is located nine hundred feet east of the "Main" zone and is similar, consisting of a well sheared and steeply dipping zone of carbonated and sericitized greywacke, well mineralized with fine pyrite. This zone has been established by trenching and pits for a length of one hundred feet with widths up to six feet. The zone is open at both ends.

A grab sample of mineralized rock, broken from large pieces at one of the pits, assayed 2.55 oz/ton gold. One channel sample in the old trench assayed 0.08 oz/ton gold. One drill hole under the central portion of the zone intersected the zone

at a vertical depth of forty feet with an indicated true width of six feet. A 3.9 ft. core section from the mineralized zone assayed 0.053 oz/ton gold and 3.3 oz/ton silver.

"South" Zone

No recent work has been done on this zone located on the south east-west claim line. Old trenching and pits show the zone extending for a length of forty feet and then heavy overburden at each end. The width is seven feet. The zone also consists of carbonated and sheared greywacke with the one foot sections on each wall being more heavily sheared and mineralized. The pyrite mineralization does not appear to be as heavy as in the "Main" zone but the pyrite crystals are somewhat larger. A chip sample over five feet assayed 0.205 oz/ton gold. (A grab sample of rusty overburden located fifty feet south of the No. 3 post located 75 ft. to the west, assayed 0.005 oz/ton gold.

Recommended Additional Work

For your consideration I would suggest the following:

- 1 - A drill hole to test the west conductor located by VLF survey. This could probably be tested (most inexpensively) by a short diamond drill (to 150 ft.) collared at about 1350 west on the grid. Provision should be made to collect sludge if soft sericite schist is intersected.
- 2 - In view of the good gold values obtained in surface grab samples ~~xxxxxxx~~ of freshly broken rock, several short drill holes to further test the "Main" and "East" zones should be considered.
- 3 - Additional work on the "South" zone should await results of present work being done by Murgold Resources.

Respectfully submitted

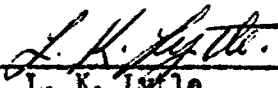

L. K. Lytle

92 Tamarack St.,
Timmins, Ont. P4N 6P6





41P12SW0075 2.4651 CHESTER

900

Mining Lands Comments

Empty lined area for Mining Lands Comments.

To: Geophysics *Mr Barlow*

Comments: *- W/ Kay map needed
Considering delay in approval process
- let go as is. John.
Dec 27/82*

Approved Wish to see again with corrections

Date: *Oct 29/82* Signature: *Ryan Pelt*

To: Geology - Expenditures *Mr Kustka*

Comments: (Empty)

Approved Wish to see again with corrections

Date: *Oct 14/82* Signature: *Kustka*

To: Geochemistry

Comments: *LA*

Approved Wish to see again with corrections

Date: Signature:

To: Mining Lands Section, Room 6462, Whitney Block. (Tel: 5-1360)

1982 04 01

2.4651

Mining Recorder
Ministry of Natural Resources
199 Larch Street
Sudbury, Ontario
P3E 5P9

Dear Sir:

We have received reports and maps for a Geophysical (Electro-magnetic) and Geological Survey submitted under Special Provisions (credit for Performance and Coverage) on Mining Claims S. 537237 et al in the Township of Chester.

This material will be examined and assessed and a statement of assessment work credits will be issued.

Yours very truly,

E.F. Anderson
Director
Land Management Branch

Whitney Block, Room 6450
Queen's Park
Toronto, Ontario
M7A 1W3
Phone: 416/965-1316

J. Skura/amc

cc Hanson Mineral Exploration Limited
Toronto, Ontario

NEVILLE TP. M.888

THE TOWNSHIP OF
OF
CHESTER

DISTRICT OF
SUDBURY

PORCUPINE
MINING DIVISION

SCALE: 1-INCH=40 CHAINS

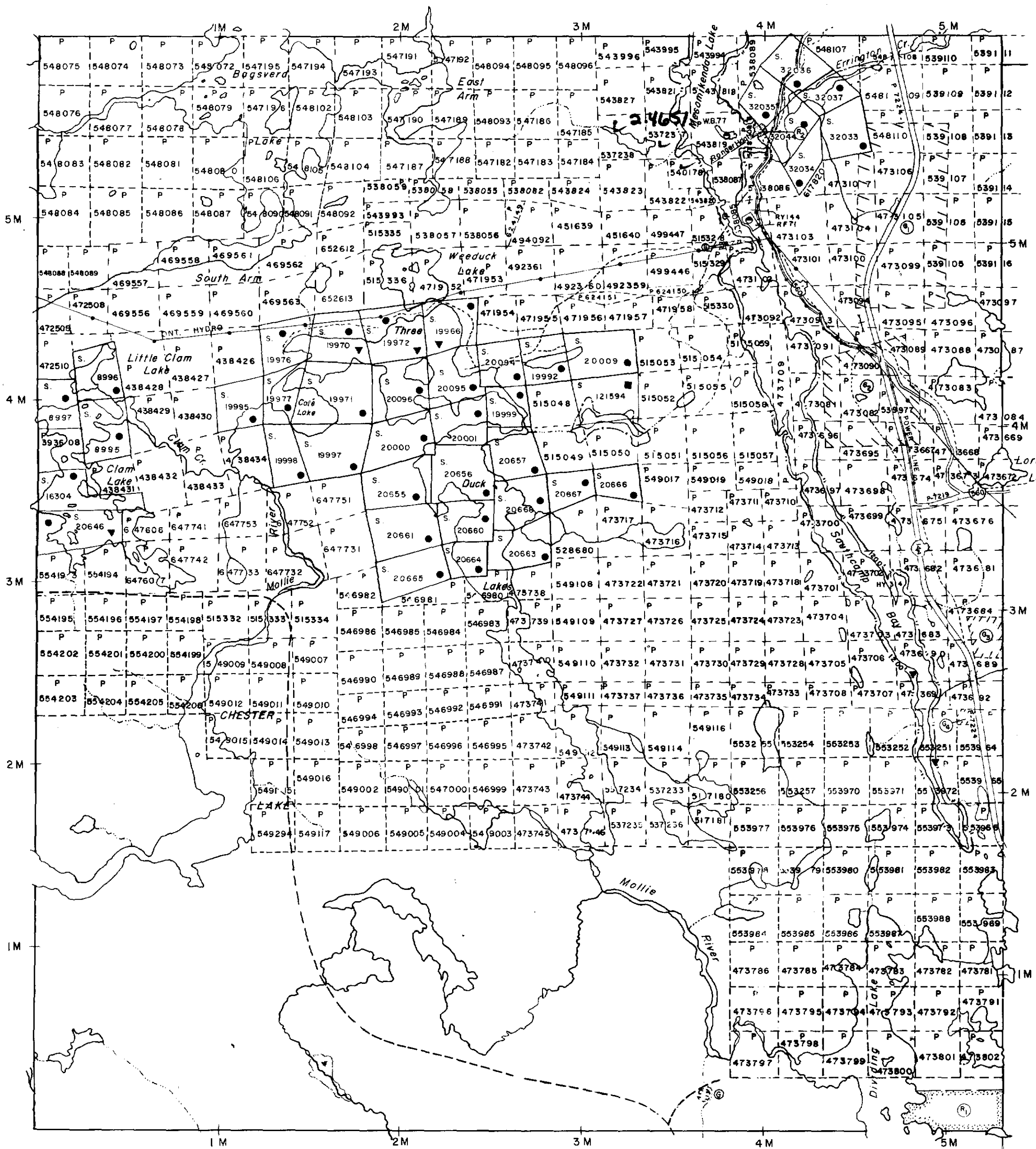

DISPOSITION OF CROWN LANDS

- PATENT, SURFACE AND MINING RIGHTS ●
- " SURFACE RIGHTS ONLY ○
- " MINING RIGHTS ONLY ◐
- LEASE, SURFACE AND MINING RIGHTS ■
- " SURFACE RIGHTS ONLY □
- " MINING RIGHTS ONLY ◑
- LICENCE OF OCCUPATION ▼
- ROADS
- IMPROVED ROADS
- KING'S HIGHWAYS
- RAILWAYS
- POWER LINES
- MARSH OR MUSKEG
- MINES
- CANCELLED

NOTES

400' Surface Rights Reservation along the shores of all lakes and rivers.

Flooding rights to 1200' contour reserved to Ont. Hydro ▼ 7543, Loc HY 34 file 10621

SAND & GRAVEL

- ① M.T.C. Pit No. 1349
- ② " Gravel Pit No. 1649
- ③ " " " No. 1385
- ④ " " " 3C-17
- ⑤ QUARRY PERMIT

AREAS WITHDRAWN FROM STAKING

S.R. - SURFACE RIGHTS DESCRIPTION	ORDER No	DATE	M.R. - MINING RIGHTS DISPOSITION	FILE
① SEC. 43		W.77/80	19/2/80	S.R. 171509
②			25/8/77	S.R. 183096

DATE OF ISSUE
DEC 14 1992
Ministry of Natural Resources
TORONTO

PLAN NO.-M.717

ONTARIO

MINISTRY OF NATURAL RESOURCES

SURVEYS AND MAPPING BRANCH

YEO TP. M.1188

BENNEWEISS TP. M.658

INVERGARRY TP. M.948



41P129W0075 2.4651 CHESTER

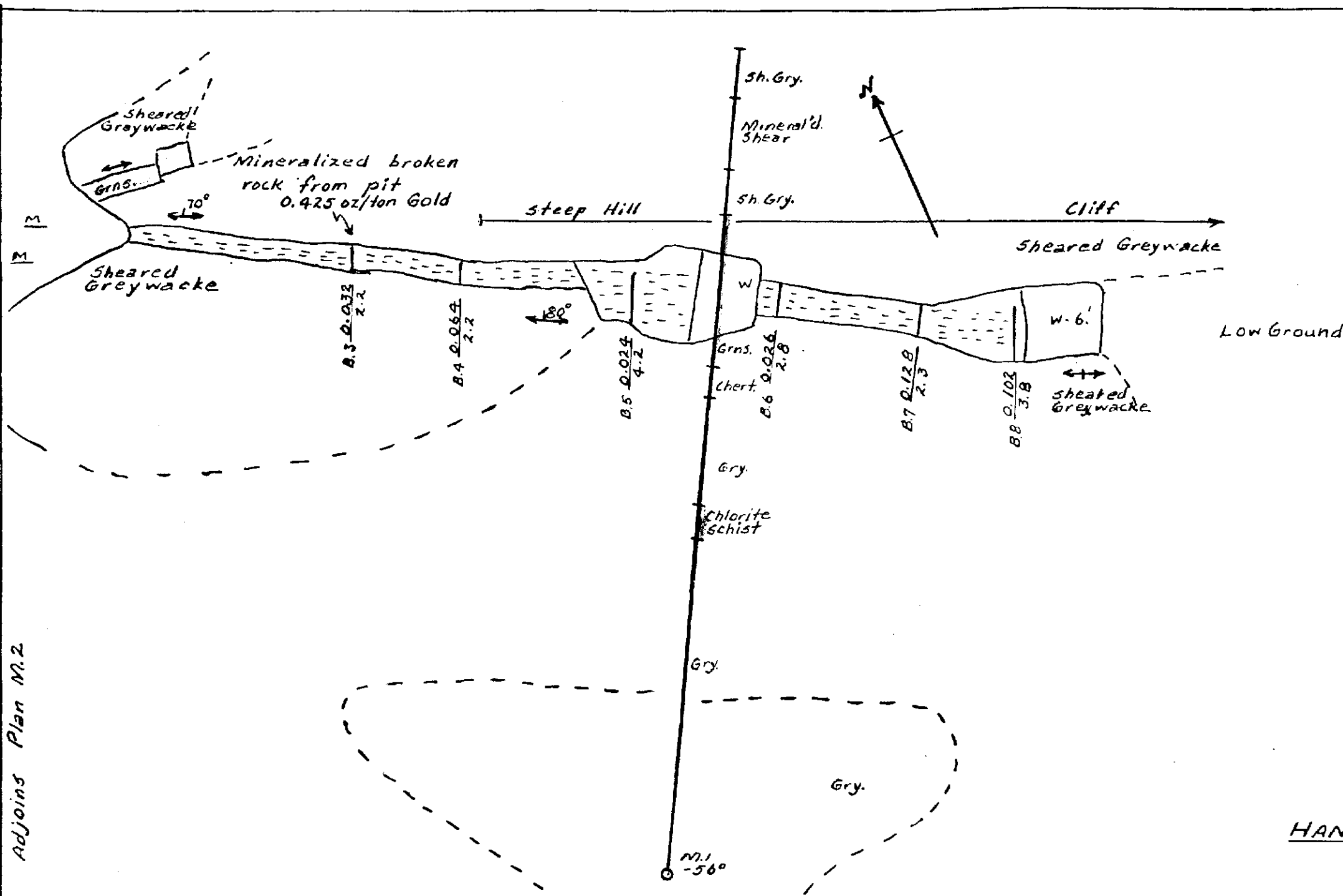

Adjoins Plan No. 2

"MAIN ZONE"
NORTH CLAIM GROUP
CHESTER TWP.

Scale: lin. = 10ft. horl. + vert.

HANSON MINERAL EXPLORATION LIMITED

PLAN No. M.1 Rev'd. Nov. 21, 1981
 L.K.

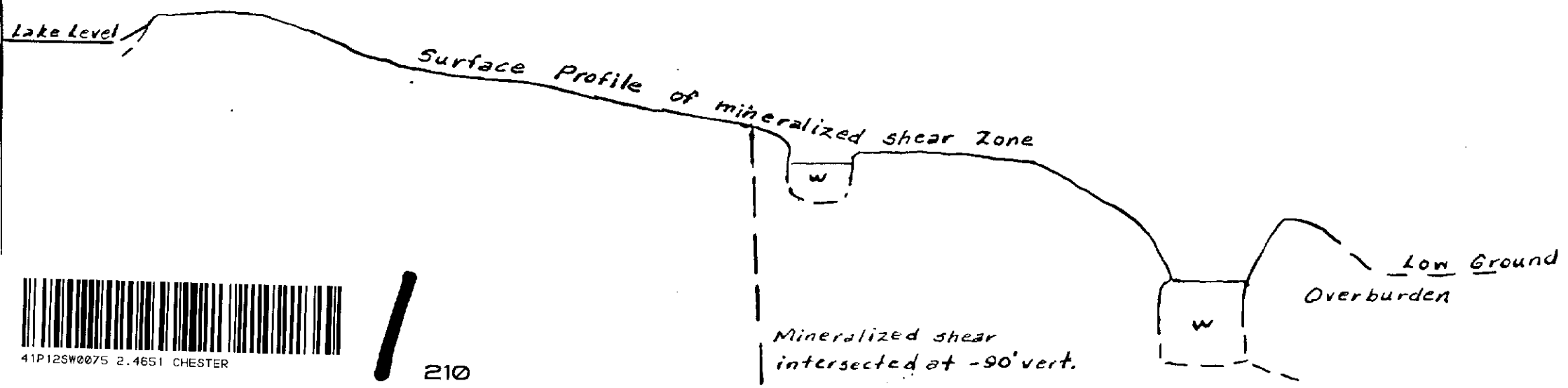

LEGEND
 As shown on PLAN M.2

2-4651
 (duplicate)

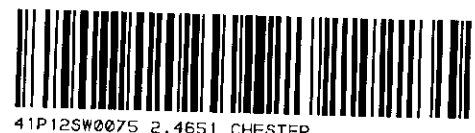

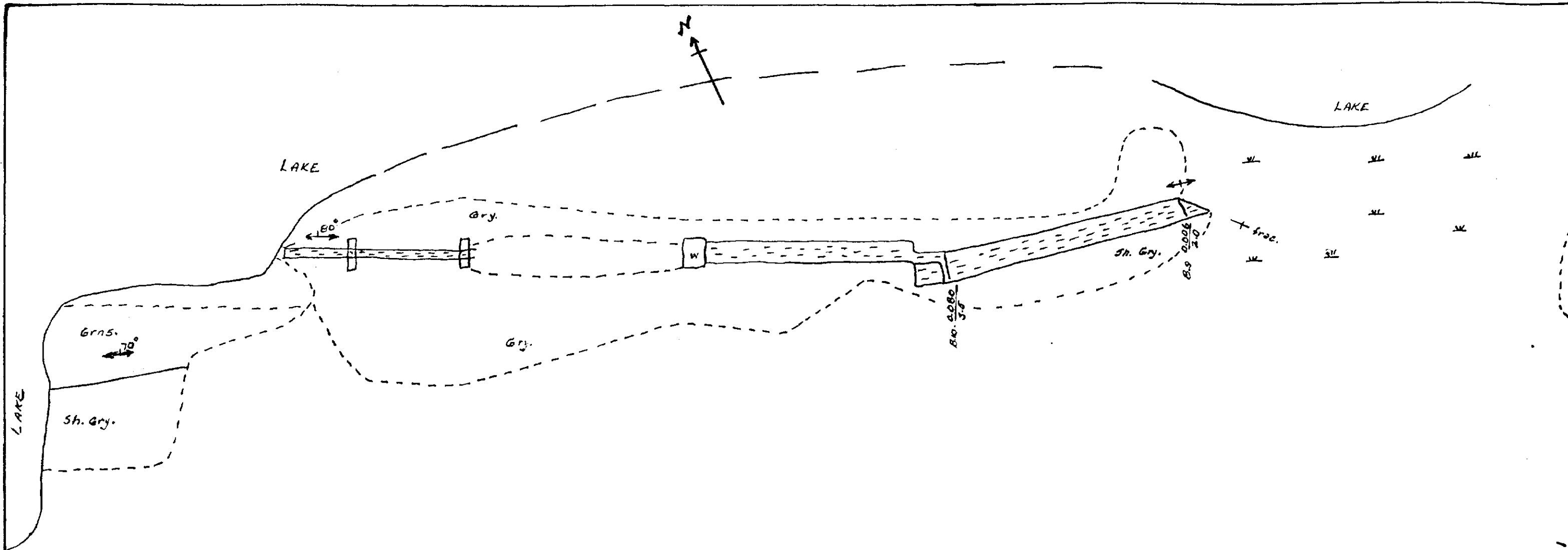

LEGEND

- Gry. - Graywacke
Sh. - Sheared
- Grns. - Greenstone
- Mineralized shear
- Border of outcrop
- Trench or Pit - in rock
- " " " - in overburden
- " " " - water filled
- Diamond Drill Hole

B.10 - 0.080 - Surface Channel Sample - 0.2 ton gold width, ft.
3.5

2.4651 (duplcity)
MAIN ZONE
NORTH CLAIM GROUP
CHESTER TWP.

Scale: 1 in. = 10 ft.



HANSON MINERAL EXPLORATION LTD.

PLAN NO. M.2

Feb. 2/81 L.K.L.



Adjoins Plan M.1

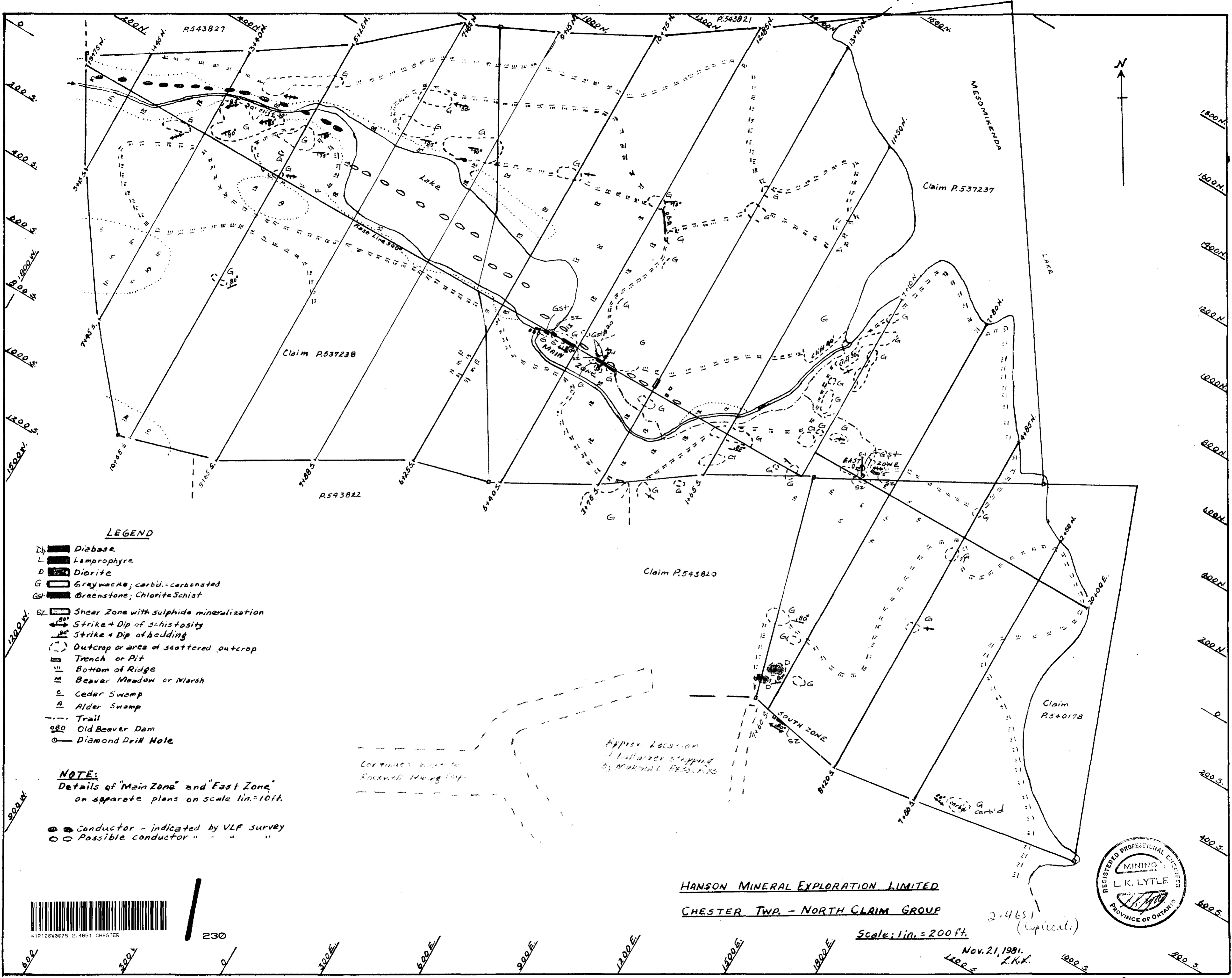

LEGEND

- Db Diabase
- L Lamprophyre
- D Diorite
- G Greywacke; carbld.=carbonated
- Gst Greenstone; Chlorite Schist
- SZ Shear Zone with sulphide mineralization
- ↙ Strike + Dip of schistosity
- ↘ Strike + Dip of bedding
- Outcrop or area of scattered outcrop
- ▭ Trench or Pit
- ▬ Bottom of Ridge
- M Beaver Meadow or Marsh
- E Cedar Swamp
- A Alder Swamp
- Trail
- ▬ Old Beaver Dam
- Diamond Drill Hole

NOTE:
 Details of "Main Zone" and "East Zone"
 on separate plans on scale 1in.=10ft.

- Conductor - indicated by VLF survey
- Possible conductor " " " "

Approx. location
 of Hall's
 discovery
 by Marshall L. Reynolds



230

HANSON MINERAL EXPLORATION LIMITED
CHESTER TWP. - NORTH CLAIM GROUP

Scale: 1in.=200ft.

Nov. 21, 1981.
 L.K.L.



0172915-0-34

