

KERWALL MINES LIMITED



52M01SW0017 63.3589 BALL TWP

010

Report by: P. S. Cross - July 28, 1947

Copied by: E. O. Chisholm - March, 1948

Group of 9 unpatented claims - K.R.L. 22413 - 22419
22420 & 22421

Comprises compact group 1 mile West from West end of Trout Bay, Red Lake. All titles believed clear.

GEN. GEOLOGY, H.C. Horwood

EXPLORATION & DETAILED GEOLOGY:

To date very little prospecting or exploration carried out on claims. On main showing located about 400 ft. southwest from the number one part of Claim K.R.L. 22415, a small amount of trenching and stripping has been done revealing an altered quartz-porphry zone, striking N 20 W and dipping to east at 45 degrees. A shear has been developed in the quartz-porphry and mineralization consisting of narrow quartz stringers and lenses with the deposition of sphalerite, of chalcopryrite, may be observed. The quartz - porphyry is in contact to the west with granodiorite and to the east with greenstone. Several inclusions of greenstone, bandlike in appearance may be seen in the quartz - porphyry. These are at first appearing to be basic dikes but proved by drilling to be greenstone inclusions in the quartz-porphry. Drilling of this main showing using seven 150 ft. holes revealed a series of narrow quartz stringers and lenses in the porphyry, some of them showing fairly heavy sphalerite and galena with minor amounts of chalcopryrite. One hole #5 revealed a width of 32 feet of quartz showing scarce pyrite. Samples cut from vein material failed to return values in gold over \$.35 cents. The geology as revealed by drilling and surface outcrop are seen on accompanying map.

Two altered small showings exist on the property but were not examined.

REPORT ON HODGSON DEAN CARLSON SYNDICATE - surface showing
by J. Hodgson - March 1946.

Property consists of 360 acres, 9 claims. Assessment work done up to date. Entire holdings burnt over several years ago. Second growth makes travelling and prospecting difficult.

GEOLOGY

The claims appear to be underlain by an intrusive contact consisting mainly of granodiorite, porphyry, quartz and fine porphyry, with one band of I.F. 20 ft. wide exposed.

SHOWINGS:

Main exposure on K.R.L. 22415 about 300 ft. N 14 W from Muddle Bay West boundary. Vein material shows over a width of 30 ft. and length of 80 ft. and only parts of this have been stripped showing stringers and bands of quartz - mineralized with sphalerite, galena and considerable chalcopyrite. This mineralized zone appears to be an altered quartz - porphyry with granodiorite on foot wall, what appears to be a fairly continuous narrow quartz vein between the sheared altered quartz-porphyry and the granodiorite gave some very interesting returns, the samples having run from a low of \$6.00 to high of $\frac{1}{2}$ oz. in gold. (P.S. Cross personally told me that his surface grabs of main show only ran \$3.00 or so). The main zone was not sampled by writer as insufficient work done at this time to warrant it but the material and general appearance seems to be pretty much same as section sampled.

Recommends further work.

GENERAL GEOLOGY

SCALE 1"=20'

ALT QTZ. PORPH

GRANODIOR

BASE

QZ

BASE LINE

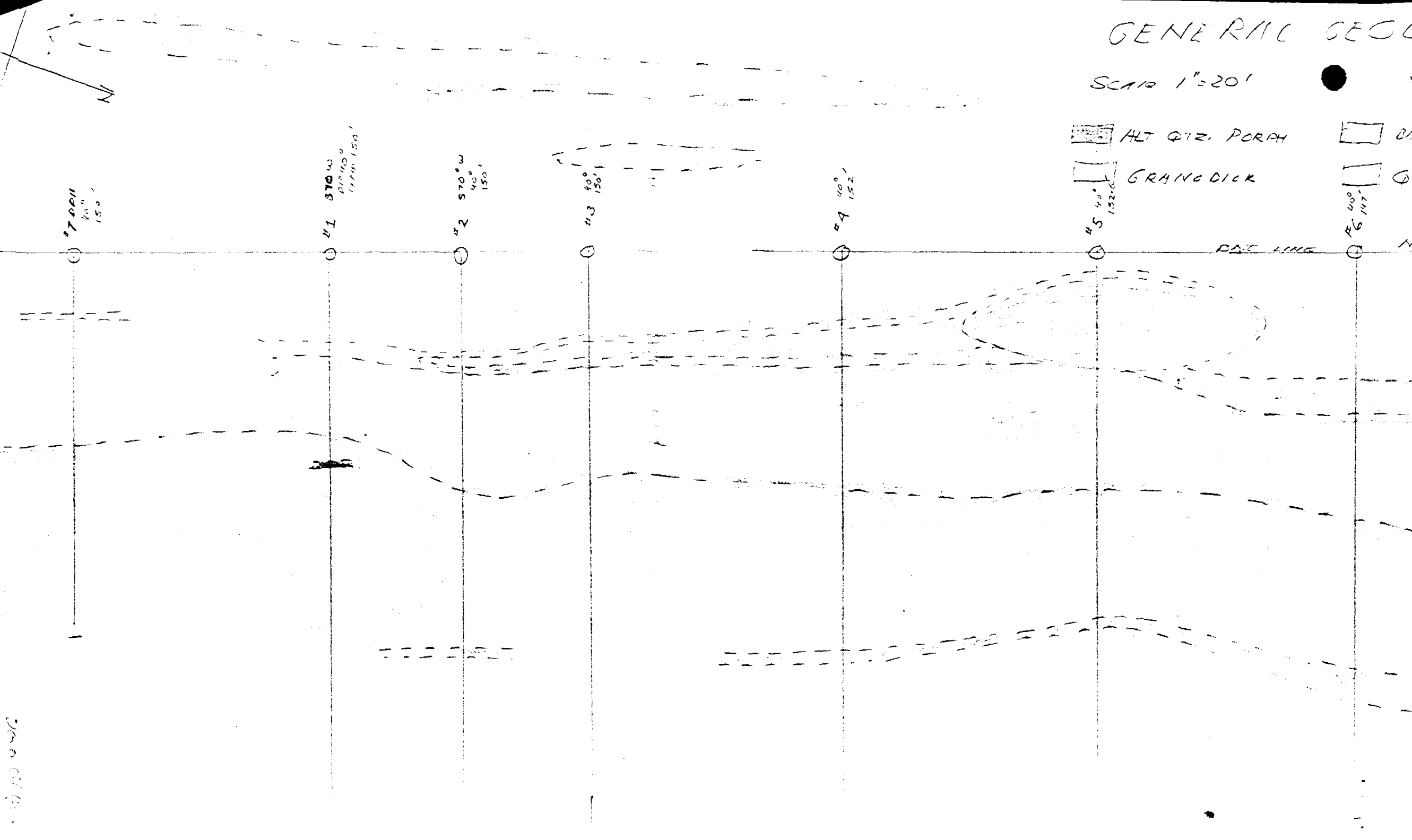

200 01 19

63.3589
M K



52N01S00W17 63.3589 BALL TWP

900

IT
HD.

3000 000

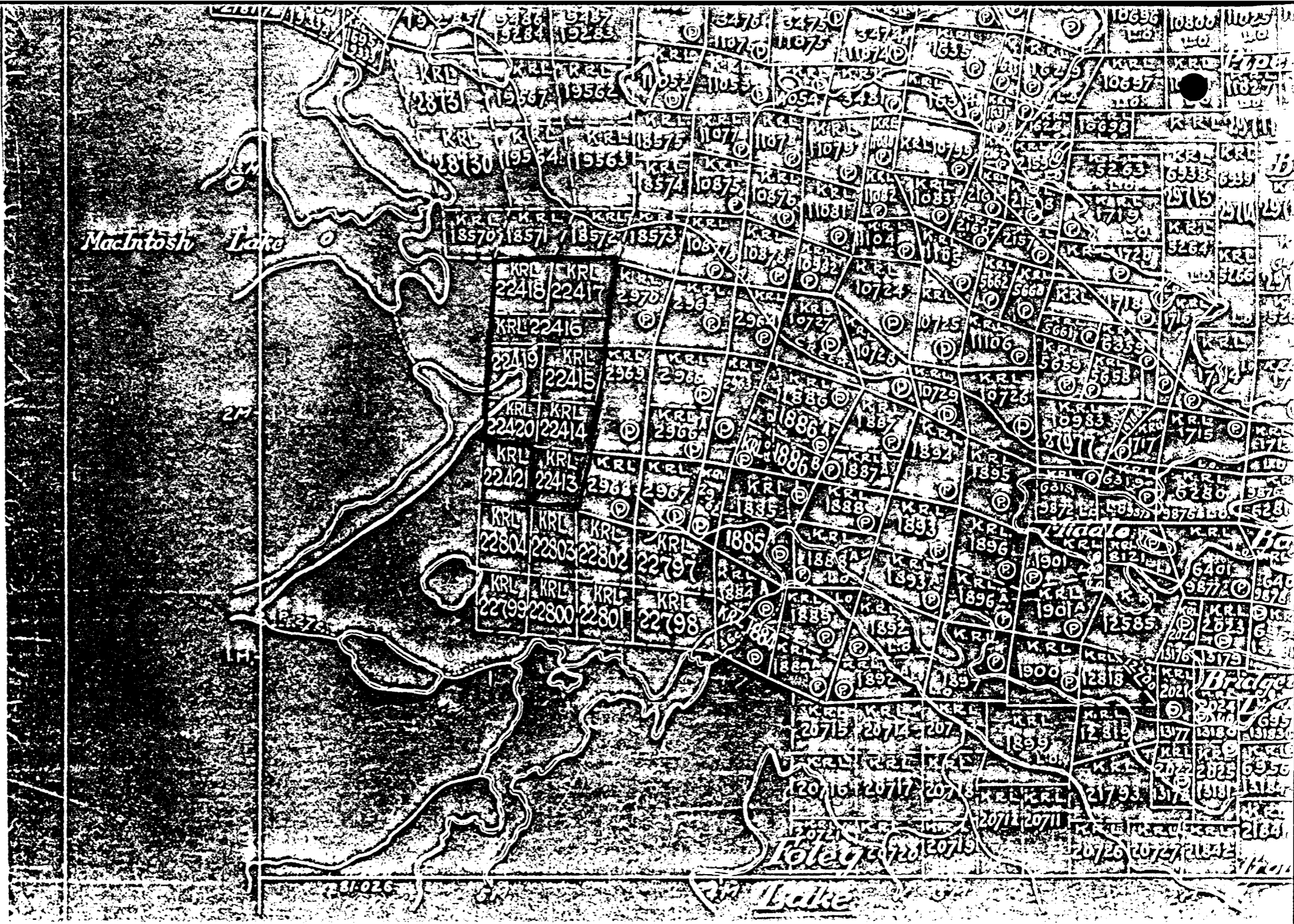

Harris, Keachie, Torrance & Johnson
Barristers & Solicitors

TELEPHONES: ADELAIDE 4482-34

ERNEST A. HARRIS, K.C. LESTER M. KEACHIE, K.C.
FREDERICK W. TORRANCE EDWARD N. JOHNSON
JAMES B. KEACHIE ROBERT W. DAVIES
WILLIAM H. ADAMS

26-28 Adelaide Street West
Toronto 1, Canada

August 19, 1947.

Mr. T. A. Wood,
Mining Recorder,
Sioux Lookout, Ontario.

Dear Mr. Wood: Re: Kerwall Gold Mines Limited,
Mining Claims KRL 22413 - 22420
inclusive.

We understand from Albert H. Pearson, diamond driller, that he has filed with you reports of work in connection with the diamond drilling completed by him on the above claims. He states that it is necessary under present regulations for some information to be given regarding the holes.

The diamond drilling consisted of seven holes, approximately 150' in length drilled on the main showing which is located about 400' south west from the #1 post on KRL 22415.

The engineer, Mr. P. S. Cross, has submitted logs of these various holes which may be summarized as follows:-

Hole #1 bearing south seventy degrees west, dip forty degrees, depth 150', started June 12, 1947 and completed June 13, 1947. This hole passed through altered quartz porphyry with several narrow quartz stringers and later through granodiorite.

Hole #2 bearing south seventy degrees west, dip forty degrees, depth 150', started June 13, 1947 and completed June 14, 1947. This hole passed through altered quartz porphyry, basic dyke and granodiorite with barren quartz stringers.

Hole #3 bearing south seventy degrees west, dip forty degrees, depth 150', started June 14, 1947 and completed June 15, 1947. This hole passed through the same geological structure as the preceding hole.

200 000

2 - Mr. T. A. Wood.

August 19, 1947.

Hole #4 bearing south seventy degrees west, dip forty degrees, depth 152', started June 15, 1947 and completed June 16, 1947. This hole passed through quartz porphyry with sparse sphalerite mineralization then through basic dyke, altered porphyry and granodiorite.

Hole #5 bearing south seventy degrees west, dip forty degrees, depth 152' 6", started June 17, 1947 and completed June 18, 1947. This hole passed through the same geological structure as the preceding hole.

Hole #6 bearing south seventy degrees west, dip forty degrees, depth 147', started June 19, 1947 and completed June 20, 1947. This hole passed through the same geological structure as the preceding hole.

Hole #7 bearing south seventy degrees west, dip forty degrees, depth 100', started June 21, 1947 and completed June 22, 1947. This hole passed through altered quartz porphyry, also a narrow quartz vein with sparse weathered minerals thence through granodiorite.

We have only the one copy of Mr. Cross' report which we could send to you if necessary but we trust the above information will be satisfactory and we will appreciate having you record on the enclosed abstracts the recording of the work. One dollar is enclosed to cover charges in this regard.

Yours very truly,

HARRIS KEACHIE TORRANCE & JOHNSON,

Per: *H. Keachie*

LMK:PB
Encls.