



42E03SW0040 13 ROPE LAKE

010



Diamond Drilling

Area of ROPE LAKE

Report N^o 13

Work performed by: CANABEL SYNDICATE

Claim N ^o	Hole N ^o	Footage	Date	Note
TB 67122	1	501.0'	Mar/58	
TB 67118	2	368.0'	Mar-Apr/58	
TB 67125	3	421.0'	Apr/58	
TB 67124	4	306.0'	June/58	
TB 67116	5	346.0'	June/58	

1942'

Notes:

Diamond Drill Record

PROPERTY CANABEL (AUTHIER)

COMPANY CANABEL SYNDICATE

HOLE No. 1

PROJECT No.

SHEET NUMBER 1 of

BEARING

STARTED Mar. 23/58

LATITUDE 22 + 50 S

DIP at Collar

Angle Vertical

COMPLETED Mar. 28/58

DEPARTURE 200' West of L-29W

at
at
at
at

PROPOSED DEPTH

ELEVATION

ULTIMATE DEPTH 501.0

Footage		Sample No.	Sample Width	Assays for	Formation and Remarks
From	To				
0.0	3.0				Casing.
3.0	382.7				Hornblende schist and hornblende mica schist. Dark greenish grey, fine to medium grained - hornblende crystals predominate but some sections very micaceous (hence hornblende mica schist) a few small quartz carbonate injections parallel to schistosity - some sections chloritized and epidotized - some garnetiferous sections - negligible sulphides - average schistosity @ 35° to core axis (varying from 25° to 45° to C.A.) 81.4 - 86.4 lost core 178.0 schistosity @ 30° to C.A. 191.2 - 192.0 milky quartz injection 225.3 - 226.1 lost core 288.8 - 289.3 minor disseminated magnetite with a 1/2 inch wide band at 289.1 at 35° to core axis (parallel to schistosity). 315.5 - 316.3 lost cores. Occasional short section of interbedded siliceous light grey sediments with bedding @ 35° to 45° to core axis. 375.0 schistosity @ 45° to C.A.
382.7	383.0				Sulphides. Roughly 40% volume of the section is sphalerite with some slightly magnetic pyrrhotite - remainder of section is siliceous light grey slightly micaceous material - no shearing.

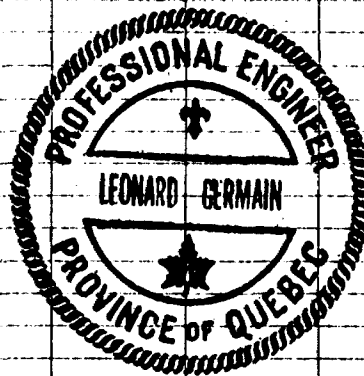

Diamond Drill Record

PROPERTY CANABEL (AUTHIER)

COMPANY CANABEL SYNDICATE

HOLE No. 1

PROJECT No.

SHEET NUMBER 2 of

BEARING

STARTED Mar. 23/58

LATITUDE 22 + 50 S

DIP at Collar

Angle Vertical

COMPLETED Mar. 28/58

DEPARTURE 200' West of L-29W

at
at
at
at

PROPOSED DEPTH

ELEVATION

ULTIMATE DEPTH 501.0

Footage		Sample No.	Sample Width	Assays for			Formation and Remarks
From	To						
383.0	501.0						<p>The sphalerite seems to have followed the schistosity.</p> <p>Mainly hornblende schist. As above - some micaceous sections - negligible sulphides - 384.5 - 387.0 well banded (@ 40° - 50° to core axis) light grey siliceous sediments with a few very narrow veinlets of magnetite occurring parallel to bedding.</p> <p>A few garnetiferous sections below 387.0 with short interbedded sedimentary bands.</p> <p>Schistosity @ 50° to 55° to C.A.</p> <p>425.2 - 426.2 lost core.</p> <p>463.6 - 465.2 quartz injection</p> <p>498.0 schistosity @ 60° to C.A.</p> <p>501.0 end of hole.</p>

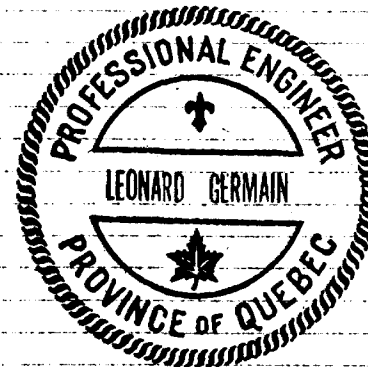

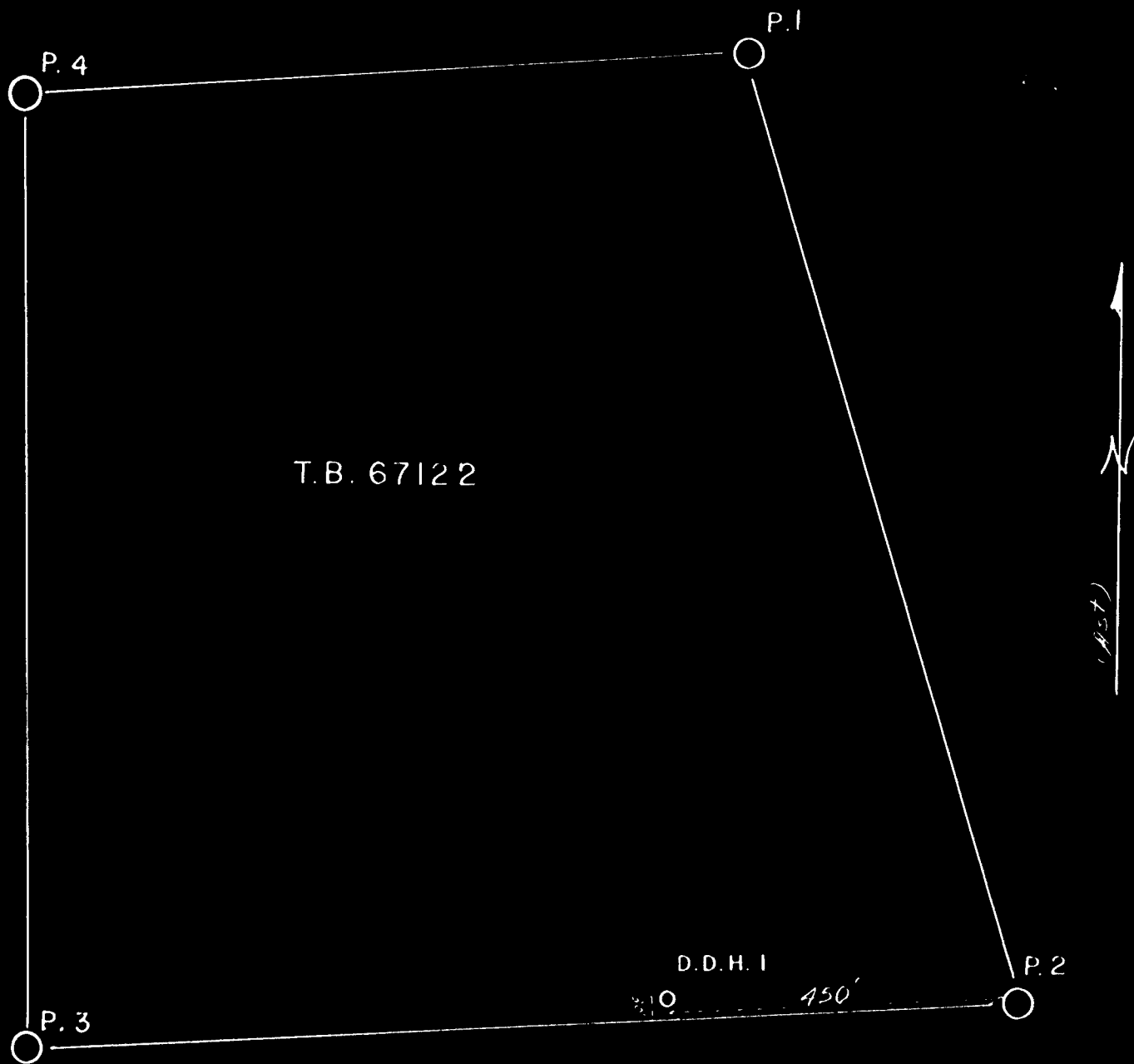

Sketch showing location of
drill hole '1'

Scale: 1 inch = 200 feet.

Diamond Drill Record

PROPERTY CANABEL (AUTHIER)

COMPANY CANABEL SYNDICATE

HOLE No. 2

PROJECT No.

SHEET NUMBER 1 of

BEARING South

STARTED March 29/58

LATITUDE 28 + 50 N

DIP at Collar

COMPLETED April 1/58

DEPARTURE L 25 W

at Angle - 45°

PROPOSED DEPTH

ELEVATION

at

ULTIMATE DEPTH 368.0'

Footage		Sample No.	Sample Width	Assays for					Formation and Remarks
From	To								
0.0	23.0								Casing.
23.0	122.5								<u>Quartz mica garnet schist</u> . Fine to medium grained light to dark grey - flecked throughout with small purplish garnet crystals - biotite mica predominate mineral with some quartz, feldspar, sericite, chlorite, scapolite - very minor epidote, pyrite and pyrrhotite. A few small carbonate filled fractures - quite schistose and well banded @ 40° - 50° to core axis.
122.5	125.2								<u>Syenite</u> . Fine to medium grained - pinkish grey, massive - pink feldspar predominate mineral with some muscovite, biotite and epidote. Also associated ferro - magnesium minerals minor quartz - contacts gradational.
125.2	261.2								<u>Quartz mica garnet schist</u> . Light to dark gray, fine to medium grained - well banded @ 60° - 70° to core axis.
<u>S A M P L E S</u>									Very micaceous in part fewer and more scattered garnets than from 23.0 - 122.5. Generally weak magnetic attraction throughout.
178.0	188.0	44	10.0	FE	S	TiO ₂	P	SiO ₂	Magnetite - occurring as very narrow bands (up to 1/2 in. wide) and disseminated in very fine grained - (appears to be metamorphosed magnetite bearing clays and silt - water unable to effect sensible separation.)
188.0	198.0	45	10.0	18.97%	0.17%	0.56%	0.11%	53.18%	Whole section may average 5% - 8% magnetite.
				17.85%	0.12%	0.62%	0.11%	53.60%	141.0 - 142.0 lost core
									199.5 - 200.0 lost core
									230.4 - 231.3 lost core
									240.0 - 241.0 lost core

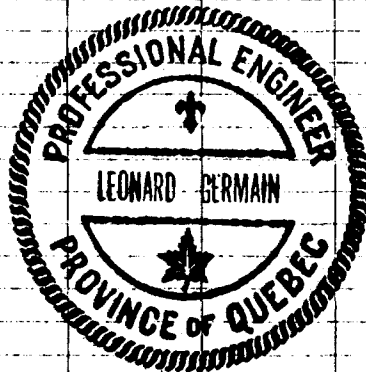

R. D. 2M 21040

Drilled by Boyles Bros.

Logged by

James O. Stewart

(Lost sections may or may not have been massive magnetite)

Diamond Drill Record

COMPANY **CANABEL SYNDICATE**

PROPERTY **CANABEL (AUTHIER)**

HOLE No. **2**

PROJECT No.

SHEET NUMBER **2** of

BEARING **South**

STARTED **Mar.29/58**

LATITUDE **28 + 50 N**

DIP at Collar

Angle - **45°**

COMPLETED **Apr.1/58**

DEPARTURE **L 25 W**

PROPOSED DEPTH

ELEVATION

at
at
at
at

ULTIMATE DEPTH **368.0**

Footage		Sample No.	Sample Width	Assays for	Formation and Remarks
From	To				
261.2	263.8				<u>Syenite.</u> Grey, medium grained, massive biotite rich - contacts @ 70° to core axis.
263.8	368.0				<u>Quartz Mica Garnet Schist.</u> Magnetic as above to 279.0 from 279.0 - 368.0 little or no magnetite. Banding and schistosity at 340.0 @ 75° to core axis. 368.0 end of hole.



R.D. 2M-21040

Drilled by **Boyles Bros.**

Logged by **James O. Stewart**

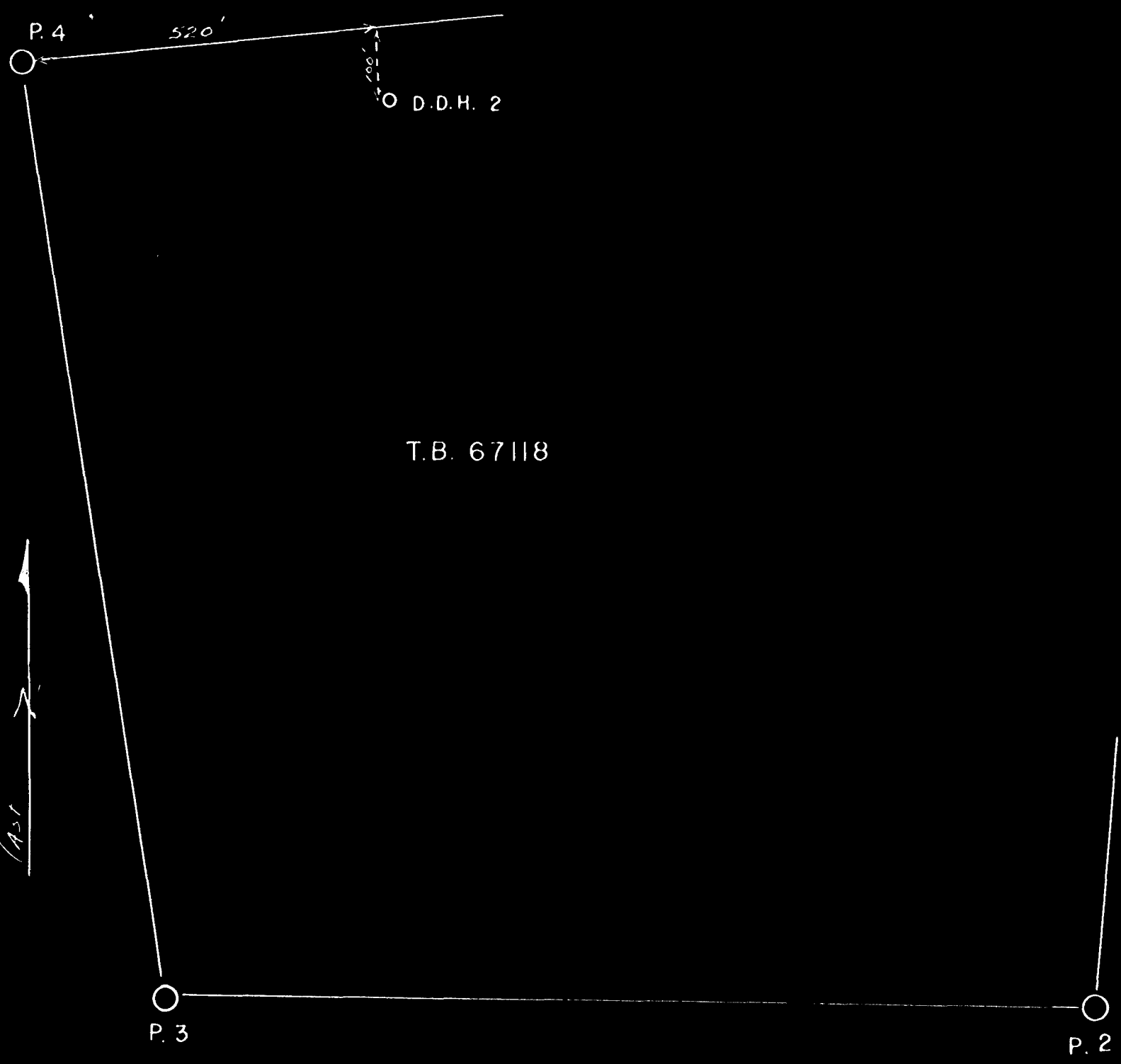

Sketch showing location of
drill hole "2"

Scale: 1 inch = 200 feet.

Diamond Drill Record

PROPERTY AUTHIER (CANABEL)

COMPANY CANABEL SYNDICATE

HOLE No. 3

PROJECT No.

SHEET NUMBER 1 of

BEARING South

STARTED Apr. 2/58

LATITUDE 27 + 00N

DIP at Collar Angle - 40°

COMPLETED April 5/58

DEPARTURE 70' W of Line 33W

at
at
at
at

PROPOSED DEPTH

ELEVATION

ULTIMATE DEPTH 421.0'

Footage		Sample No.	Sample Width	Assays for			Formation and Remarks
From	To						
0.0	8.0						Casing.
8.0	31.5						<u>Quartz mica schist.</u> Medium grained light to dark grey - quite micaceous - some small quartz filled fractures - schistosity @ 40° - 50° to core axis.
31.5	128.6						<u>Siliceous sediments.</u> Fine to medium grained, light to medium grey banded, chloritic, hard, bedding @ 50° to 60° to core axis. Several sections of whitish gray brecciated quartz with some grey feldspar fragments as from 36.0 - 43.0 66.1 - 67.2 82.1 - 84.4 95.0 - 97.2
128.6	150.3						<u>Granite gneiss.</u> Mottled pinkish grey, medium grained, hard, lineation @ 60° - 70° to core axis. Contacts gradational. 136.7 - 137.7 and 140.5 - 142.0 pinkish white quartz feldspar injection.
150.3	343.8						<u>Mica Garnet Schist.</u> Dark grey, medium grained flecked with small pink garnets schistosity @ 60° to core axis. A few minor quartz veinlets parallel to schistosity. 160.6 - 161.7 lost core 197.3 - 198.1 lost core 225.6 - 226.0 lost core 270.0 - 293.5 slightly magnetic 275.8 - 277.1 lost core

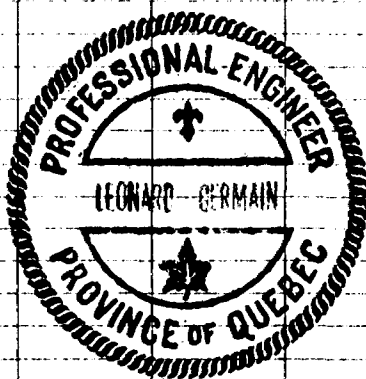

Diamond Drill Record

PROPERTY AUTHIER (CANABEL)

COMPANY CANABEL SYNDICATE

HOLE No. 3

PROJECT No.

SHEET NUMBER 2 of

BEARING South

STARTED Apr. 2/58

LATITUDE 27 + 00N

DIP at Collar Angle - 40°

COMPLETED Apr. 5/58

DEPARTURE 70' W of line 33W

at
at
at
at

PROPOSED DEPTH

ELEVATION

ULTIMATE DEPTH 421.0'

Footage		Sample No.	Sample Width	Assays for			Formation and Remarks
From	To						
							278.6 - 279.1 quite magnetic with 3 or 4 narrow (up to 1.0 inch) bands of massive magnetite.
							from 279.1 - 293.5 there are a few very narrow bands of magnetite but generally the section is very low grade. Only a few scattered garnets occur in this section.
							293.5 - 317.0 quite garnetiferous with little or no magnetite
							317.0 - 343.8 weakly magnetic - no garnets.
343.8	346.5						<u>Syenite</u> . Light grey massive, medium grained, upper contact @ 80° lower at 70° to core axis.
346.5	421.0						<u>Mica Garnet Schist</u> , As above - weakly magnetic to 372.0 except from 356.6 - 357.7 where the core is about 30% magnetite.
							372.0 - 421.0 non-magnetic quite garnetiferous.
							421.0 end of hole.

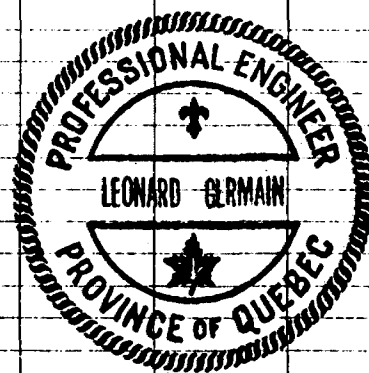

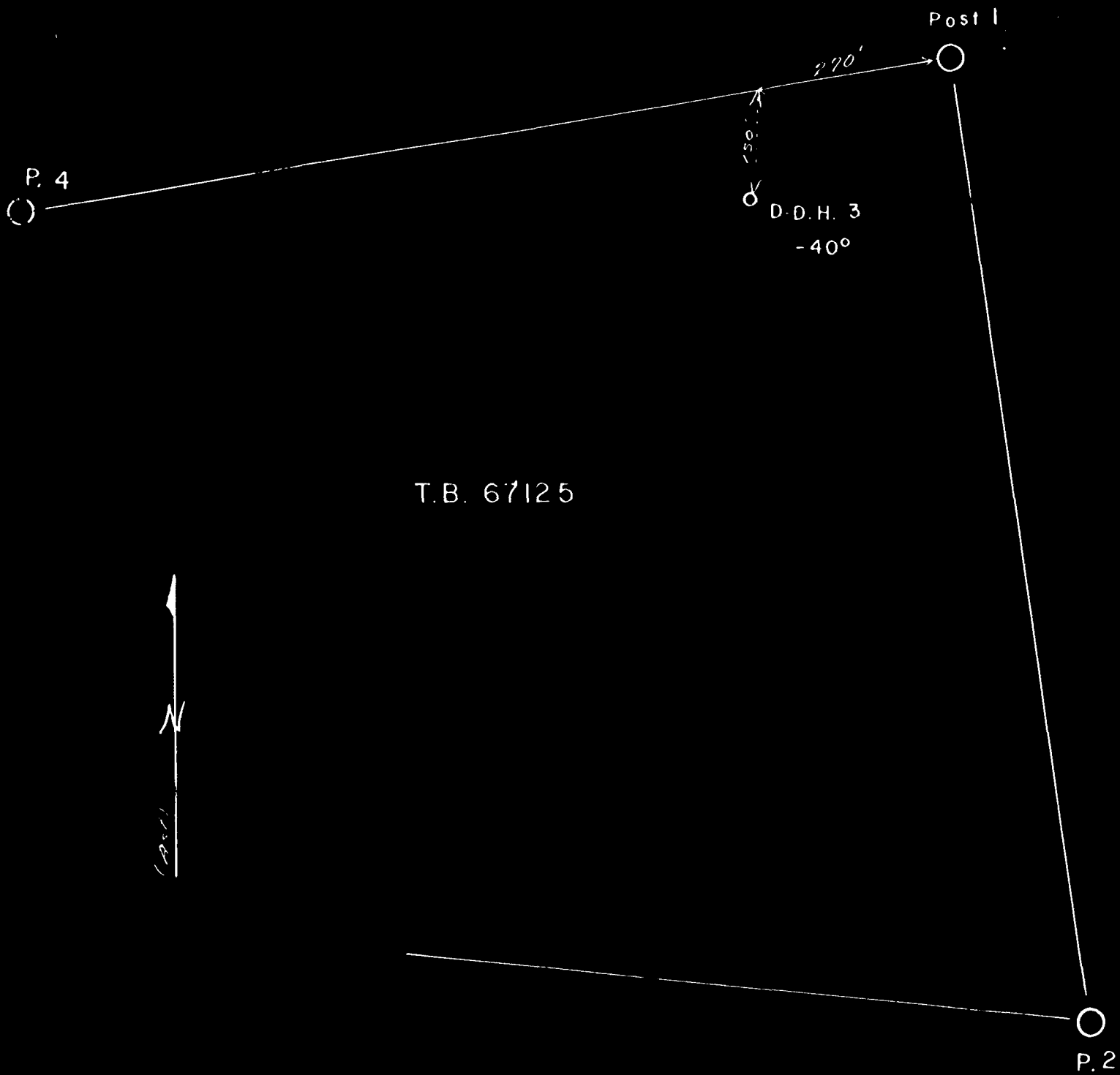

Sketch showing location of
drill hole "3"

Scale: 1 inch = 200 feet

Diamond Drill Record

COMPANY CANABEL SYNDICATE

PROPERTY CANABEL (AUTHIER)

HOLE No. 4

PROJECT No.

SHEET NUMBER 1 of

BEARING South

STARTED June 17/58

LATITUDE 11 4 00N

DIP at Collar Angle - 45°

COMPLETED June 19/58

DEPARTURE L -33W

at
at
at
at

PROPOSED DEPTH

ELEVATION

ULTIMATE DEPTH 306.0'

Footage		Sample No.	Sample Length	Assays for		Formation and Remarks
From	To			Gold	Silver	
0.0	4.0					Casing.
4.0	129.1					<p><u>Quartz mica schists.</u> Light to dark grey - interbedded fine to medium grained sediments - quite micaceous - bedding @ 60°- 65° to core axis - a few narrow quartz injections parallel to bedding occasional chloritic section.</p> <p>103.2 shearing @ 5° to core axis</p> <p>102.4 - 103.6 Black chloritic sheared section with graphite along shear planes - some disseminated pyrite</p> <p>103.6 - 127.4 - a few chloritic sections interbedded with light grey sediments</p> <p>127.4 - 129.1 well sheared at all angles to core axis - graphitic shear planes.</p>
129.1	306.0					<p><u>Mainly basic volcanics.</u> Light to dark grey - fine to medium grained - siliceous in part - some sections are garnetiferous - section contains some interbedded volcanics and mica garnet schists.</p> <p>140.0 - 141.0 calcite filled shear @ 5° to C.A.</p> <p>142.1 graphitic shear parallel to schistosity.</p> <p>143.4 - 146.0 core well sheared - some graphite - quite chloritic - many small carbonate stringers at all angles to core axis - fine sulphides</p> <p>147.8 shearing @ 5° to core axis.</p> <p>147.6 - 150.5 chloritic - sheared at all angles to core axis - numerous calcite veinlets - considerable graphite on shear planes - fine diss. sulphides.</p>
		95 from 143.5 to 147.5	4.0'	nil	0.03	
		96 from 147.5 to 150.5	3.0'	nil	0.02	



Diamond Drill Record

PROPERTY CANABEL (AUTHIER)

COMPANY CANABEL SYNDICATE

HOLE No. 4

PROJECT No.

SHEET NUMBER 2 of

BEARING South

STARTED June 17/58

LATITUDE 11 4 00N

DIP at Collar Angle - 45°

COMPLETED June 19/58

DEPARTURE L - 33W

at
at
at
at

PROPOSED DEPTH

ELEVATION

ULTIMATE DEPTH 306.0'

Footage		Sample No.	Sample Width	Assays for	Formation and Remarks
From	To				
					178.8 - 188.0 generally coarse grained dark green hornblende - garnet rich rock with minor disseminated pyrite pyrrhotite and specks of chalcopyrite.
					206.1 - 212.5 disseminated magnetite with minor pyrite and pyrrhotite in a medium grained hornblende mica schist.
					231.0 - 240.5 dark grey chloritic material with many small quartz - carbonate filled fractures occurring at all angles to core axis
					263.0 - 265.8 some disseminated pyrite with a graphitic shear at 265.8.
					Graphitic shears occur at various angles to core axis from 267.7 - 270.3 and from 272.5 - 273.5 - rock is mainly light grey well bedded sediments.
					275.0 narrow graphitic shear @ 15° to core axis.
					287.2 - 287.5 graphitic shear @ 65° to core axis.
					306.0 end of hole.

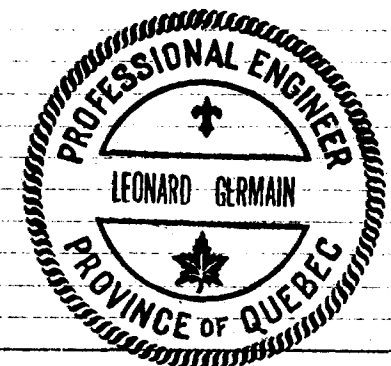

R.D. 2M-21040

Drilled by, Boyles Bros.

Logged by James O. Stewart

BIG DUCK LAKE TRACT

ONTARIO



Sketch showing location of HOLE 4 in relation to corner posts
Scale 1 inch = 200 feet

Diamond Drill Record

PROPERTY CANABEL (AUTHIER)

COMPANY CANABEL SYNDICATE

HOLE No. 5

PROJECT No.

SHEET NUMBER 1 of

BEARING South

STARTED 6/21/58

LATITUDE 54 00N

DIP at Collar Angle - 45°

COMPLETED 6/23/58

DEPARTURE Line 9W

at
at
at
at

PROPOSED DEPTH

ELEVATION

ULTIMATE DEPTH 346.0

Footage		Sample No.	Sample Width	Assays for	Formation and Remarks
From	To				
0.0	4.0				Casing.
4.0	71.0				<u>quartz mica garnet schist.</u> Fine to medium grained, light to dark grey, bedding @ 65° - 70° to core axis, garnets very small - numerous quartz veinlets generally parallel to bedding, some fine disseminated pyrite.
71.0	77.0				<u>Siliceous Zone.</u> Mainly milky quartz with a few narrow (one up to 4" wide) bands of pyrite and pyrrhotite. Some small fragments of chloritic sediments included in the quartz.
77.0	98.0				<u>Mainly Basic Volcanics.</u> Dark grey - medium to coarse grained - some included beds of light grey banded sediments - occasional narrow section with disseminated pyrite and pyrrhotite. Some short sections are siliceous - some very coarse grained sections with large garnets.
98.0	109.0				<u>Porphyritized sediments.</u> Light grey, siliceous - medium to coarse grained - evidence of bedding @ 60° to core axis. 103.3 - 103.8 disseminated pyrite 106.3 - 109.0 coarse grained quartz feldspar porphyry - massive - grey -
109.0	159.0				<u>Quartz Mica Schist.</u> Well banded fine to medium grained light to dark grey - bedding @ 70° to core axis - many narrow biotite mica bands - a few quartz veinlets.

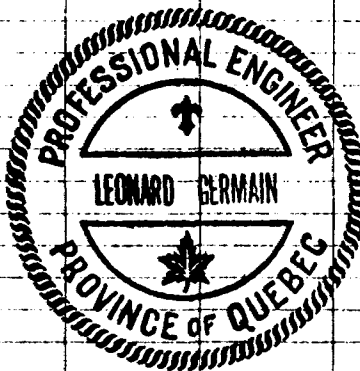

R.D. 2M-21040

Drilled by Boyles Bros.

Logged by James O. Stewart

Diamond Drill Record

PROPERTY CANABEL (AUTHIER)

COMPANY CANABEL SYNDICATE

HOLE No. 5

PROJECT No.

SHEET NUMBER 2 of

BEARING South

STARTED 6/21/58

LATITUDE 54 00N

DIP at Collar Angle - 45°

COMPLETED 6/23/58

DEPARTURE Line 9W

at
at
at
at

PROPOSED DEPTH

ELEVATION

ULTIMATE DEPTH 346.0

Footage		Sample No.	Sample Width	Assays for		Formation and Remarks
From	To					
159.0	278.7					<p><u>Mainly Basic Volcanics.</u> Dark green, medium grained - some included beds of dark grey micaceous sediments - a few quartz veinlets parallel to schistosity - some coarse grained garnetiferous sections.</p> <p>244.4 - 245.8 milky quartz injection parallel to schistosity.</p>
278.7	296.1					<p><u>Grey dike.</u> Dark grey - fine to medium grained - massive - minor disseminated pyrite - upper contact @ 15° to core axis - lower @ 70° to core axis.</p>
296.1	346.0					<p><u>Quartz feldspar porphyry.</u> Mottled grey pink - medium to coarse grained - a few light grey sections - possibly digested sediments.</p>
						346.0 end of hole.

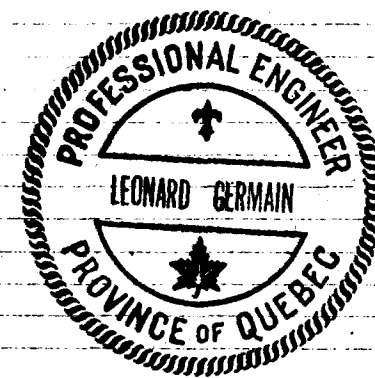

BIG DUCK LAKE AREA

ONTARIO

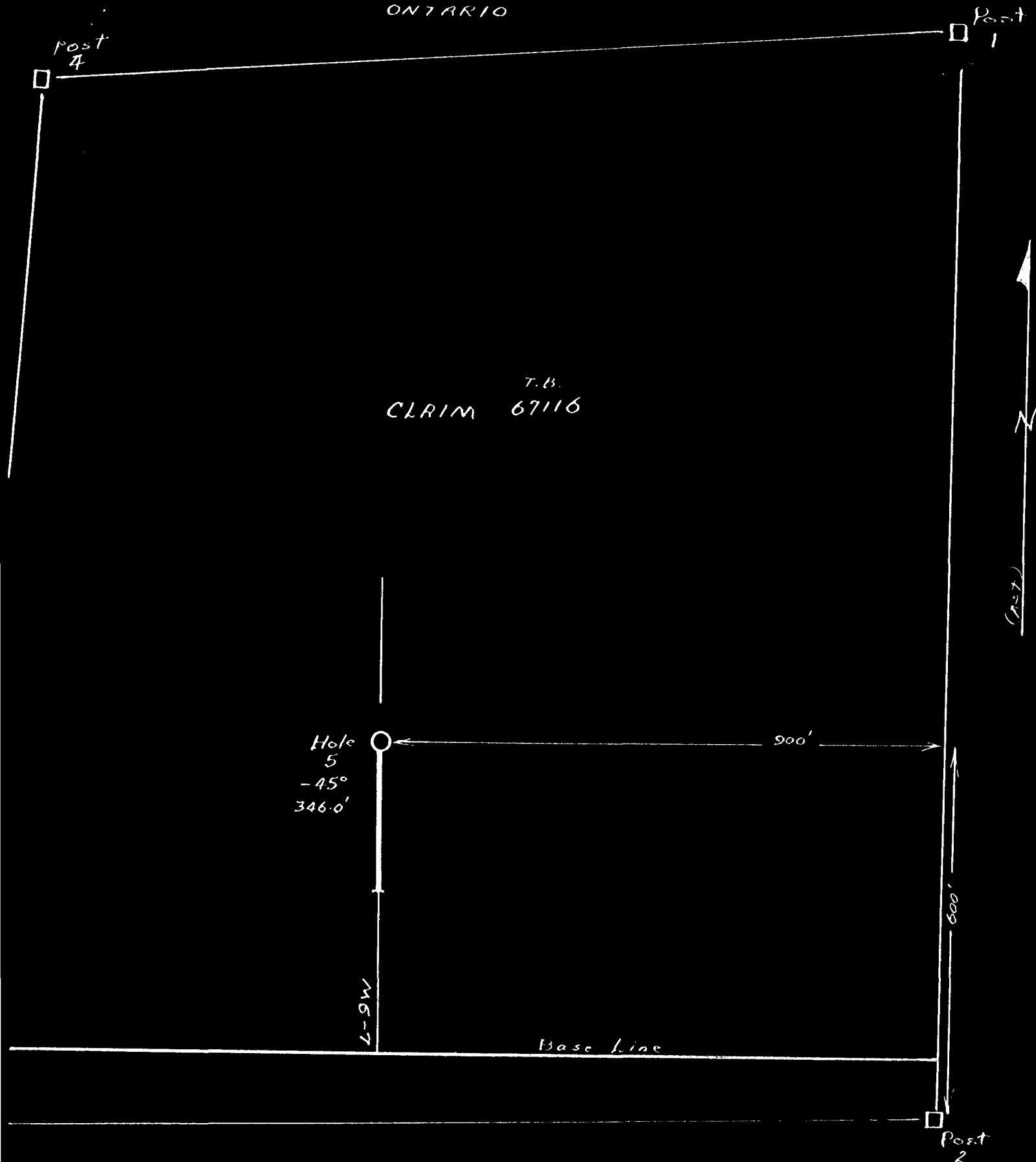

Sketch showing Hole 5 in relation to corner posts.

scale 1 inch = 200 feet