

Page 1

May 12/2010

44944 · 2

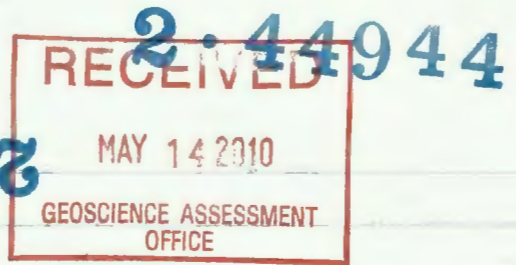

Introduction:

On October 15 & 16 2009 Richard Morin assisted by brother Roger carried out traditional prospecting and sample collection which were sent to SGS For assaying.

Geology: Mallard Twp. is in the Abitibi greenstone belt, Porcupine mining Division. Predominant rock types are mafic intrusives. A pervasive schistosity in the area strikes at 30° - 40° . Regional geology of Mallard Twp. is covered in the Ontario Geological Survey report 248. Geology of the Garnet Area 1987.

Property Location and access:

Map NTS 41-0/NE Ridout Figure 1(a). Property is in Mallard Twp. Porcupine mining Division, Claim Map 6 1171 Figure 1(b). Vehicular access is gained from Timmins via paved hwy 101 to 144 south to the junction of Sultan industrial road, thence west along the Sultan road for 46 km to a road junction in Edith Twp. then north via gravel road for 26 km. to a bridge on the Opeepeesway river then $\frac{1}{2}$ mile to claims. Approx. 226 km.

Claim Nos.

1177542

1 unit

1177543

1 unit

Client No. 172554

May 12/2010

Project:

Investigated area where blasting done during 1990's also in 2000's. Area has pyrite, calco. and visible gold. Removing blasted rock manually, breaking rock with hammer. Collected 6 samples. Four were forwarded to SGS Lab for assaying (1-800-387-0255).

7978 { shearing quartz veins with
7979 { Pyrite and calco.
7980 {

7982 { Quartz pyrite + minor calco.

Sample locations are shown on attached map Appendix 1

Assay results are appended Appendix 2

Richard Morin
May 12, 2010

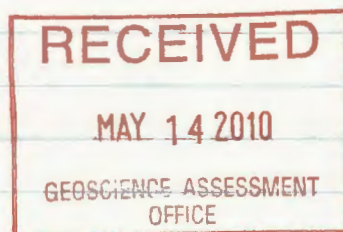

2-44944

October 12/10

Ministry of Northern Dev. + Mines
Geoscience Assessment Office,
933 Ramsey Lake Road
Sudbury, Ont. P3E 6B5

Enclosed:

- 1 copy - Assessment work performed on Mining Lands.
- 2 copies of Report.

Richard Morin,

172554

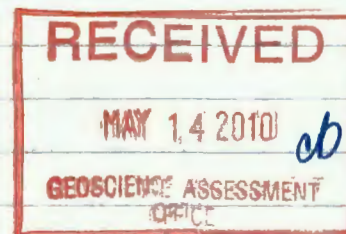

Appendix 2

2-44944

SGS

Certificate of Analysis

Work Order: TO109259

To: **Richard Morin**
COD SGS Minerals
839 Swallowtail Cres
Orleans
ON K4A 4M5

Date: Mar 18, 2010

P.O. No. : Project:October 2009
Project No. : -
No. Of Samples : 4
Date Submitted : Feb 22, 2010
Report Comprises : Pages 1 to 5
(Inclusive of Cover Sheet)

Distribution of unused material:

Discard after 90 days:

Certified By :

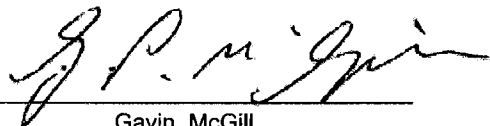

Gavin McGill
Operations Manager

SGS Minerals Services (Toronto) is accredited by Standards Council of Canada (SCC) and conforms to the requirements of ISO/IEC 17025 for specific tests as indicated on the scope of accreditation to be found at <http://www.scc.ca/en/programs/lab/mineral.shtml>

Report Footer:

L.N.R. = Listed not received
n.a. = Not applicable

I.S. = Insufficient Sample
- = No result

*INF = Composition of this sample makes detection impossible by this method
M after a result denotes ppb to ppm conversion, % denotes ppm to % conversion
Methods marked with an asterisk (e.g. *NAA08V) were subcontracted
Methods marked with the @ symbol (e.g. @AAS21E) denote accredited tests

This document is issued by the Company under its General Conditions of Service accessible at http://www.sgs.com/terms_and_conditions.htm. Attention is drawn to the limitation of liability, indemnification and jurisdiction issues defined therein.

WARNING: The sample(s) to which the findings recorded herein (the "Findings") relate was (were) drawn and / or provided by the Client or by a third party acting at the Client's direction. The Findings constitute no warranty of the sample's representativity of the goods and strictly relate to the sample(s). The Company accepts no liability with regard to the origin or source from which the sample(s) is/are said to be extracted. The findings report on the samples provided by the client and are not intended for commercial or contractual settlement purposes. Any unauthorized alteration, forgery or falsification of the content or appearance of this document is unlawful and offenders may be prosecuted to the fullest extent of the law.



Element	WtKg	Au	Be	Na	Mg	Al	P	K	Ca	Sc
Method	WGH79	FAI323	@ICP12B	@ICP12B	@ICP12B	@ICP12B	@ICP12B	@ICP12B	@ICP12B	@ICP12B
Det.Lim.	0.001	5	0.5	0.01	0.01	0.01	0.01	0.01	0.01	0.5
Units	kg	ppb	ppm	%	%	%	%	%	%	ppm
7978	1.745	2930	<0.5	0.02	2.49	2.39	0.02	0.16	5.74	8.1
7979	1.413	439	<0.5	0.02	2.75	3.24	0.03	0.10	3.56	26.6
7980	1.110	15	<0.5	0.02	5.78	2.44	0.09	0.11	7.69	9.3
7982	1.553	26	<0.5	0.08	3.90	2.53	0.02	0.08	6.30	12.5
*Rep 7982		17								

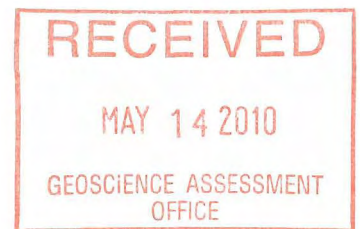

This document is issued by the Company under its General Conditions of Service accessible at http://www.sgs.com/terms_and_conditions.htm. Attention is drawn to the limitation of liability, indemnification and jurisdiction issues defined therein.

WARNING: The sample(s) to which the findings recorded herein (the "Findings") relate was (were) drawn and / or provided by the Client or by a third party acting at the Client's direction. The Findings constitute no warranty of the sample's representativity of the goods and strictly relate to the sample(s). The Company accepts no liability with regard to the origin or source from which the sample(s) is/are said to be extracted. The findings report on the samples provided by the client and are not intended for commercial or contractual settlement purposes. Any unauthorized alteration, forgery or falsification of the content or appearance of this document is unlawful and offenders may be prosecuted to the fullest extent of the law.



Element	Ti	V	Cr	Mn	Fe	Co	Ni	Cu	Zn	As
Method	@ICP12B	@ICP12B	@ICP12B	@ICP12B	@ICP12B	@ICP12B	@ICP12B	@ICP12B	@ICP12B	@ICP12B
Det.Lim.	0.01	2	1	2	0.01	1	1	0.5	0.5	3
Units	%	ppm	ppm	ppm	%	ppm	ppm	ppm	ppm	ppm
7978	<0.01	64	80	1190	6.36	33	61	188	59.9	<3
7979	<0.01	177	58	1280	8.95	42	46	266	58.5	<3
7980	<0.01	64	808	1530	5.78	32	254	4.7	60.2	<3
7982	<0.01	79	163	1360	8.25	43	131	6.6	96.7	<3

This document is issued by the Company under its General Conditions of Service accessible at http://www.sgs.com/terms_and_conditions.htm. Attention is drawn to the limitation of liability, indemnification and jurisdiction issues defined therein.

WARNING: The sample(s) to which the findings recorded herein (the "Findings") relate was (were) drawn and / or provided by the Client or by a third party acting at the Client's direction. The Findings constitute no warranty of the sample's representativity of the goods and strictly relate to the sample(s). The Company accepts no liability with regard to the origin or source from which the sample(s) is/are said to be extracted. The findings report on the samples provided by the client and are not intended for commercial or contractual settlement purposes. Any unauthorized alteration, forgery or falsification of the content or appearance of this document is unlawful and offenders may be prosecuted to the fullest extent of the law.



Element	Sr	Y	Zr	Mo	Ag	Cd	Sn	Sb	Ba	La
Method	@ICP12B	@ICP12B	@ICP12B	@ICP12B	@ICP12B	@ICP12B	@ICP12B	@ICP12B	@ICP12B	@ICP12B
Det.Lim.	0.5	0.5	0.5	1	2	1	10	5	1	0.5
Units	ppm	ppm	ppm	ppm	ppm	ppm	ppm	ppm	ppm	ppm
7978	44.1	2.7	1.7	<1	<2	<1	<10	<5	29	<0.5
7979	28.4	3.0	2.9	<1	<2	<1	<10	<5	27	1.4
7980	172	5.6	15.3	<1	<2	<1	<10	<5	15	6.7
7982	73.9	1.5	1.4	<1	<2	<1	<10	<5	16	<0.5

This document is issued by the Company under its General Conditions of Service accessible at http://www.sgs.com/terms_and_conditions.htm. Attention is drawn to the limitation of liability, indemnification and jurisdiction issues defined therein.

WARNING: The sample(s) to which the findings recorded herein (the "Findings") relate was (were) drawn and / or provided by the Client or by a third party acting at the Client's direction. The Findings constitute no warranty of the sample's representativity of the goods and strictly relate to the sample(s). The Company accepts no liability with regard to the origin or source from which the sample(s) is/are said to be extracted. The findings report on the samples provided by the client and are not intended for commercial or contractual settlement purposes. Any unauthorized alteration, forgery or falsification of the content or appearance of this document is unlawful and offenders may be prosecuted to the fullest extent of the law.



Element	W	Pb	Bi	Li	S	Ag
Method	@ICP12B	@ICP12B	@ICP12B	@ICP12B	@ICP12B	@AAS21E
Det.Lim.	10	2	5	1	0.01	0.3
Units	ppm	ppm	ppm	ppm	%	g/t
7978	<10	<2	<5	11	0.34	<0.3
7979	<10	<2	<5	13	0.78	<0.3
7980	<10	<2	<5	15	0.01	<0.3
7982	<10	<2	<5	15	0.73	<0.3
*Rep 7982						<0.3

This document is issued by the Company under its General Conditions of Service accessible at http://www.sgs.com/terms_and_conditions.htm. Attention is drawn to the limitation of liability, indemnification and jurisdiction issues defined therein.

WARNING: The sample(s) to which the findings recorded herein (the "Findings") relate was (were) drawn and / or provided by the Client or by a third party acting at the Client's direction. The Findings constitute no warranty of the sample's representativity of the goods and strictly relate to the sample(s). The Company accepts no liability with regard to the origin or source from which the sample(s) is/are said to be extracted. The findings report on the samples provided by the client and are not intended for commercial or contractual settlement purposes. Any unauthorized alteration, forgery or falsification of the content or appearance of this document is unlawful and offenders may be prosecuted to the fullest extent of the law.

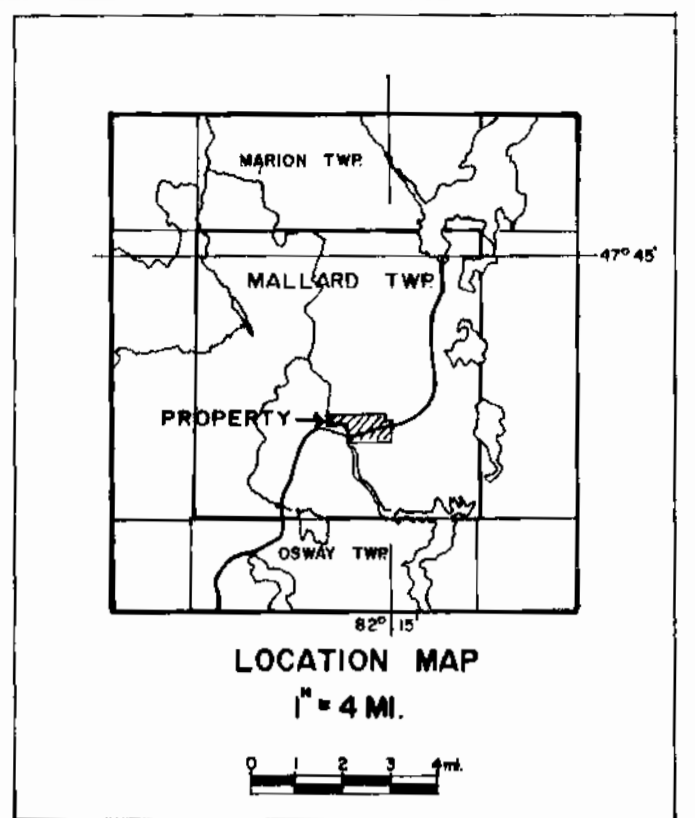
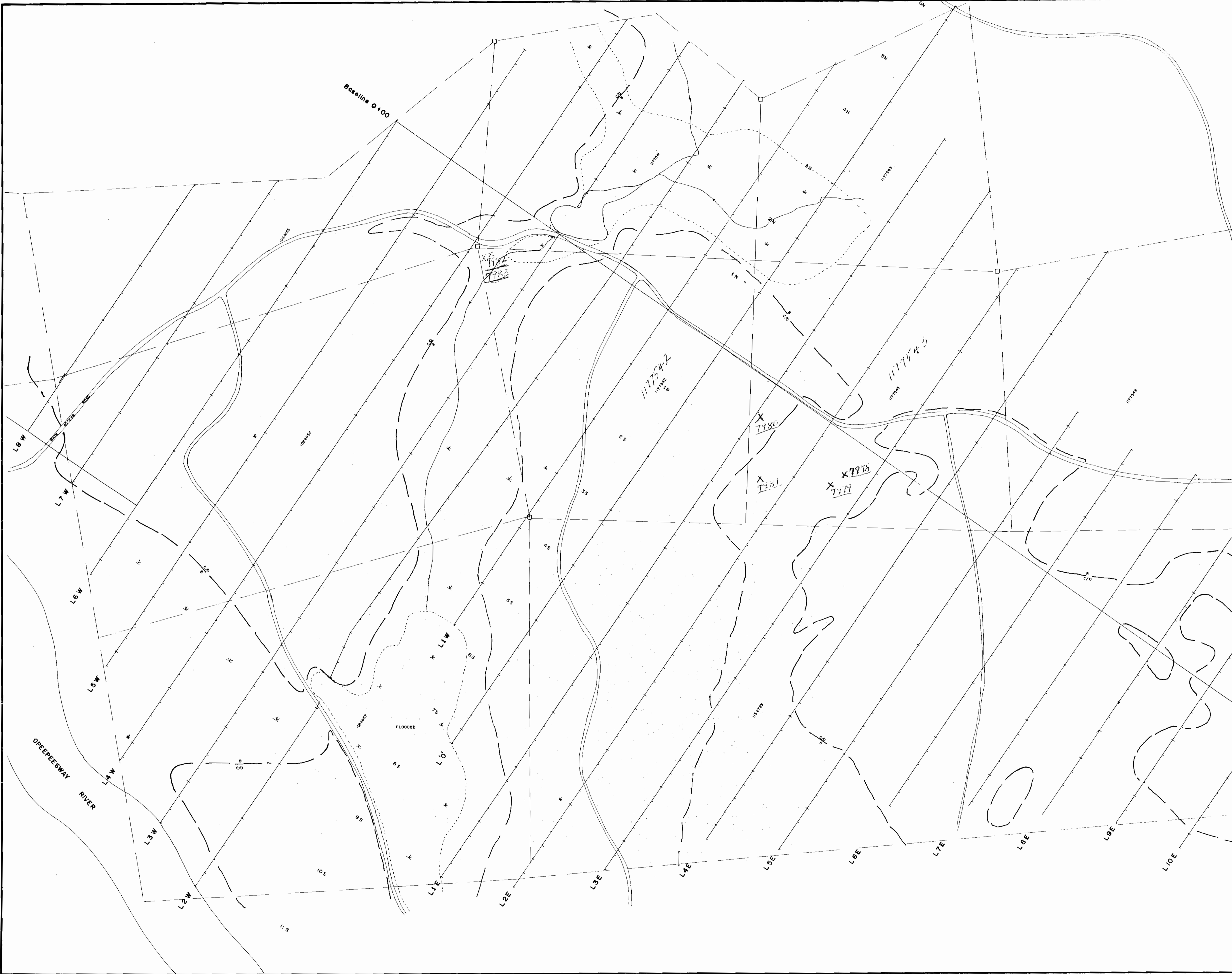

Appendix 1

LEGEND

- CLAIM LINE
- LOCATED CLAIM POST
- SWAMP
- CUT-OVER (C/O), BUSH (B) BOUNDARY
- ROAD

x sample location October 15-16/09

MORIN PROPERTY

MALLARD TOWNSHIP, ONT.

Scale: 1" = 2500'

Drawn by: ALL LASHER LTD. Date: JULY, AUG. 1998

RECEIVED
MAY 14 2010
GEOSCIENCE ASSESSMENT
DIVISION

Figure 1(b)
Mallard Twp.
G 1171

