

ASSAY AND ANALYSIS

REPORT ON THE
QUARTZ LAKE PROPERTY
FRIPP TOWNSHIP
PORCUPINE MINING DIVISION

FOR
DAVID M LEFORT

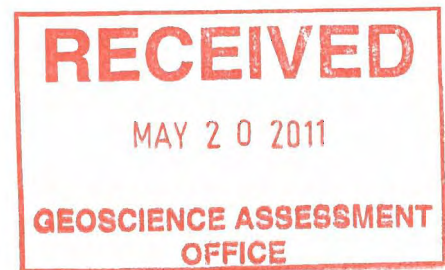

Date of completion may 09 2011

Submitted by: David M Lefort

Hard Rock Exploration

2.48491

TABLE OF CONTENTS

- P.1 INTRODUCTION/WORK PERFORMED , RECOMENDATIONS/CONCLUSIONS
- P.2 ACCESS AND LOCATION , GENERAL GEOLOGY , CLAIMS GROUP , PERSONNEL
- P.3 PREVIOUS WORK , CERTIFICATION
- P.4 SCHEDULE/DECLARATION OF COSTS
- P.5 CLAIM MAP
- P.6 DETAILED MAP
- P.7-P.10 ASSAY RESULTS

Introduction/work performed

On July 3 2009, work was performed on claim 4243969. The purpose of this work was to sample and assay a quartz vein on which an 8x8 shaft was sunk. This shaft had been previously discovered by David M Lefort during the staking of claim 4243969 as a detour around the lake was traversed. Access to the shaft was by boat via Quartz Lake to the east end of the south shore of east arm of the lake. Vein examined, approx 2m wide, striking an east west direction and dipping steeply north (approx 80N)

A sample of the shaft wall was taken from the collar as the shaft is flooded, and sent for assay, the sample taken is 001 as shown on detailed map attached to this report, Assay records are also attached to this report.

Recommendations/Conclusions

It is concluded as seen in the assay report that there is a well mineralized Quartz Vein at the location of this shaft, mainly Quartz and chalcopyrite.

It is recommended that more prospecting be done to the east and west of this vein, in the directions the vein is oriented to add extension to this vein if any.

Access and Location

Access to the claim group is gained by 4x4 truck via Pine st south ,travel 20 km south of Timmins and then 7 km west through a series of logging roads,from the truck approx 150m traverse down a trail to the lake. Travel by boat to the east end of east arm of Quartz lake where the shaft is a few meters inland from the south shore.

The claim group is located in the north central portion of Fripp Twp, Porcupine mining division, district of Cochrane. The claim group is 36 contiguous unpatented mining claims and covers nearly all of Quartz Lake and some of the surrounding area .

GENERAL GEOLOGY The claim group is underlain by early to late pre-cambrian age meta-sediments and meta-volcanics interrupted by diabase dikes and by granite with accompanying red aplite dikes, as interpreted from Map 2205 Timmins Kirkland Lake Geological Compilation Series.

<u>CLAIMS GROUP</u>	<u>CLAIM #</u>	<u># OF UNITS</u>	<u>TOWNSHIP</u>	<u>RECORDED HOLDER</u>
	4243962	12	Fripp	50% Shay B Simon , 50% David M Lefort
	4243963	2	Fripp	100% David M Lefort
	4243964	1	Fripp	100% David M Lefort
	4243965	2	Fripp	100% David M Lefort
	4243966	3	Fripp	100% David M Lefort
	4243969	16	Fripp	100% David M Lefort

PERSONNEL

The people directly involved with the work described in this report are

David M Lefort (Hard Rock Exploration)

PREVIOUS WORK

The following is a brief description of previous assessment work filed on the Quartz Lake property.

1927-28 Quarts Lake Mines Ltd

Adit driven into vein on southwest shore of canyon lake, shaft sunk on vein just off the shore near the most eastern part of the east arm of Quartz Lake, diamond drilling, small pit, trenching

1964 O'leary Malartic

Self potential survey, 7 diamond drill holes

1988 Renauld Garneau

Airborne magnetometer and VLF

1992 Dan Tichinoff

Magnetometer survey, VLF-EM survey, I.P survey, Diamond Drill (FRI-92)

CERTIFICATION

I David M Lefort of timmins on hereby certify that:

1. I am owner/operator of Hard Rock Exploration and have been in the exploration business since 2009
2. I am a narrow vein stope miner
3. I have been employed directly with, Kirkland Lake Gold inc, Dumas Mining Contracting and Engineering, Trewlaney Mining and Exploration and Hard Rock Exploration
4. I have based conclusions and recommendations based on results of the field work performed as described in this report, and knowledge of the area.
5. I was present for and supervised all work preformed as described in this report.
6. That all costs listed in the schedule of costs attached to this report are accurate and put towards the work performed in this report. All receipts,invoiced are located at the residence/office of David M Lefort/Hard Rock Exploration located at 573 Spooner dr Timmins On
7. All assay records ,field samples are accurate as described and located at the residence/office of David M Lefort/Hard Rock Exploration located at 573 Spooner dr Timmins On
8. I am the author of this report

Dated may 12 at Timmins On

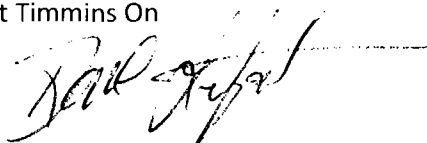

Schedule/Declaration of costs

\$150 1man @\$150/day

\$35 gasoline,4x4truck

\$20 food/1man/1day

\$80 54 element assay

\$75 report, ½ day

Total

\$ 360
\$340

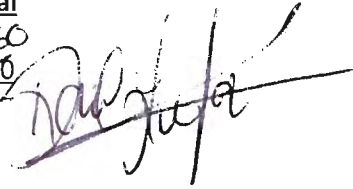
A handwritten signature in black ink, appearing to be "D. J. [unclear]", is written over the total amount. The signature is written in a cursive style and is positioned to the right of the printed total values.

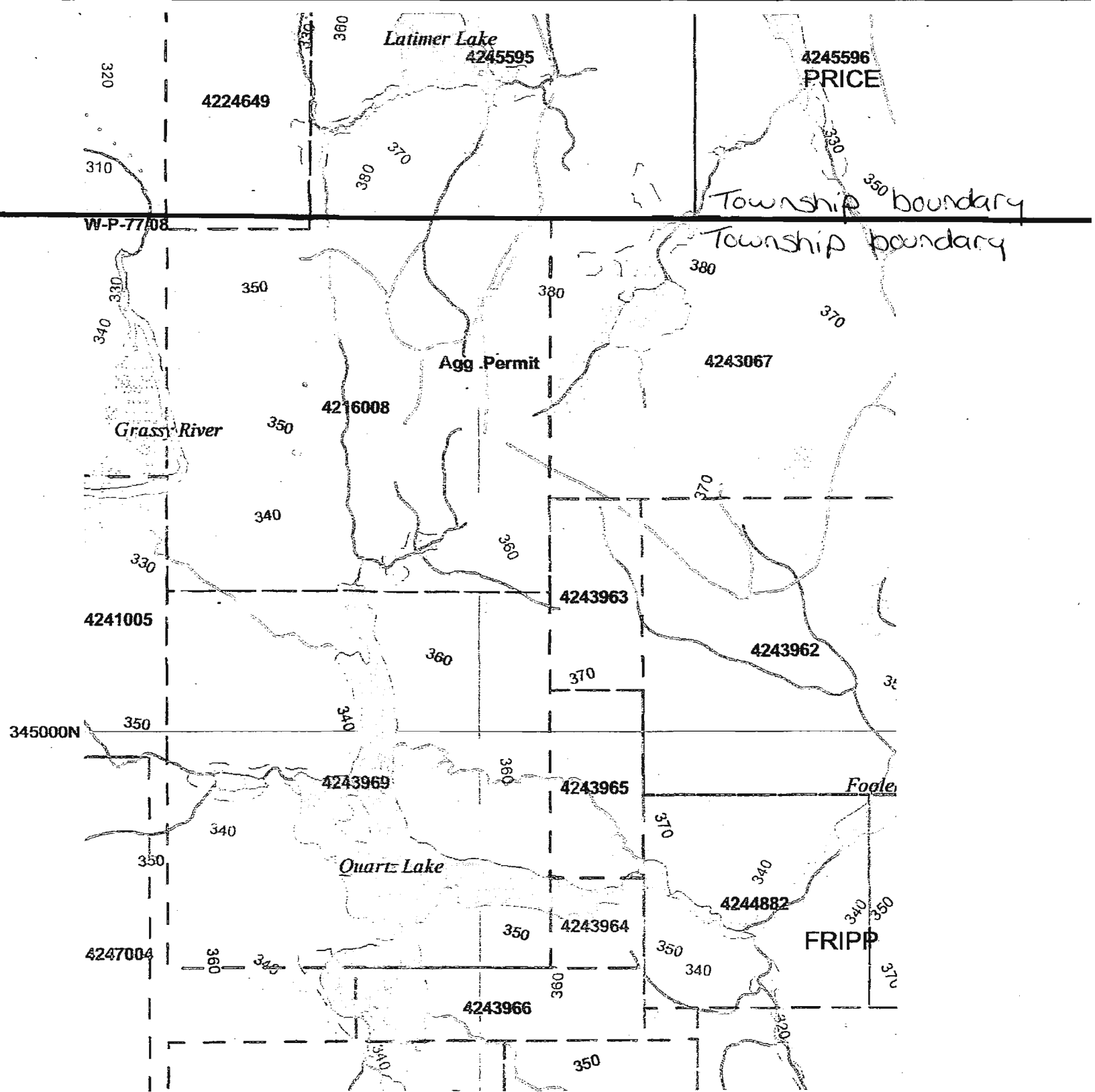

4243965

1

dedination 11° west

Scale 1:500

E Fripp Twp



4243964

4243964

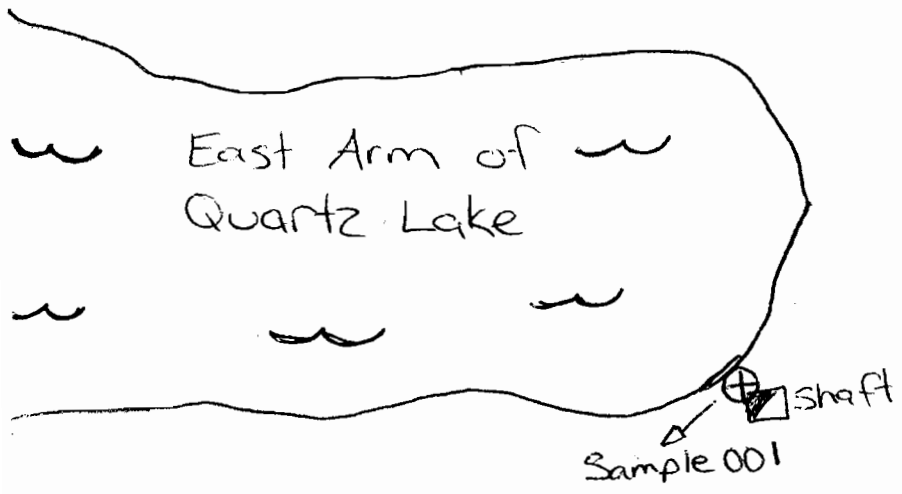

Legend

▣ Shaft

⊕ Sample taken

--- Claim border

① #1 Post

~ water

Quality Analysis ...



Innovative Technologies

Date Submitted: 14-Jul-09
Invoice No.: A09-3692 (i)
Invoice Date: 18-Aug-09
Your Reference:

True North Mineral Laboratories
475 Railway Street
Timmins Ontario P4N 2P5
Canada

ATTN: Melanie Marchand

CERTIFICATE OF ANALYSIS

2 Rock samples were submitted for analysis.

The following analytical packages were requested:

REPORT **A09-3692 (i)**

Code 1C-Exp Fire Assay-ICP/MS ✓
Code 1H INAA(INAAGEO)/Total Digestion ICP(TOTAL) ✓
Code 8-4 Acid Total Digestion Code 8-4 Acid Total Digestion Assays ✓
Code 8-Ag Ag-Fire Assay Gravimetric - OTHER CLIENT

This report may be reproduced without our consent. If only selected portions of the report are reproduced, permission must be obtained. If no instructions were given at time of sample submittal regarding excess material, it will be discarded within 90 days of this report. Our liability is limited solely to the analytical cost of these analyses. Test results are representative only of material submitted for analysis.

Notes:

We recommend reanalysis by fire assay Au, Pt, Pd Code 8 if values exceed upper limit. Elements which exceed the upper limits should be analyzed by assay techniques. Some elements are reported by multiple techniques. These are indicated by MULT.

CERTIFIED BY:

Emmanuel Eseme, Ph.D.
Quality Control

ACTIVATION LABORATORIES LTD.

1336 Sandhill Drive, Ancaster, Ontario Canada L9G 4V5 TELEPHONE +1.905.648.9611 or
+1.888.228.5227 FAX +1.905.648.9613
E-MAIL ancaster@actlabsint.com ACTLABS GROUP WEBSITE <http://www.actlabsint.com>

Report: A09-3692 (i) rev 1 Rev, 1
 Report Date: 18/08/2009

Final Report
Activation Laboratories

Analyte Symbol	Au	Pd	Pt	Au	Ag	Cu	Cd	Mo	Pb	Ni	Zn	S	Al	As	Ba	Be	Bi
Unit Symbol	ppb	ppb	ppb	ppb	ppm	ppm	ppm	ppm	ppm	ppm	ppm	%	%	ppm	ppm	ppm	ppm
Detection Limit	2	1	1	2	0.3	1	0.3	1	3	1	1	0.01	0.01	0.5	50	1	2
Analysis Method	FA-MS	FA-MS	FA-MS	INAA	MULT INAA / TD-ICP	TD-ICP	TD-ICP	TD-ICP	TD-ICP	MULT INAA / TD-ICP	MULT INAA / TD-ICP	TD-ICP	TD-ICP	INAA	INAA	TD-ICP	TD-ICP
1	10	<1	<1	<2	3.9	>10000	0.4	12	172	4	75	2.49	0.61	2.5	<50	<1	<2

8

Report: A09-3692 (i) rev 1 Rev, 1
 Report Date: 18/

Final Report
Activation Laboratories

Analyte Symbol	Br	Ca	Co	Cr	Cs	Eu	Fe	Hf	Hg	Ir	K	Mg	Mn	Na	P	Rb	Sb	Sc	Se	Sr	Ta	Ti	Th	U
Unit Symbol	ppm	%	ppm	ppm	ppm	ppm	%	ppm	ppm	ppb	%	%	ppm	%	%	ppm	ppm	ppm	ppm	ppm	ppm	%	ppm	ppm
Detection Limit	0.5	0.01	1	2	1	0.2	0.01	1	1	5	0.01	0.01	1	0.01	0.001	15	0.1	0.1	3	1	0.5	0.01	0.2	0.5
Analysis Method	INAA	TD-ICP	INAA	INAA	INAA	INAA	INAA	INAA	INAA	INAA	TD-ICP	TD-ICP	TD-ICP	INAA	TD-ICP	INAA	INAA	INAA	INAA	TD-ICP	INAA	TD-ICP	INAA	INAA
1	0.9	2.38	3	27	<1	<0.2	2.75	<1	<1	<5	0.01	0.08	323	0.02	0.016	<15	<0.1	0.8	<3	15	<0.5	0.02	<0.2	<0.5

Report: A09-3692 (i) rev 1 Rev, 1
 Report Date: 18/

Final Report
Activation Laboratories



Analyte Symbol	V	W	Y	La	Ce	Nd	Sm	Sn	Tb	Yb	Lu	Mass	Ag	Cu
Unit Symbol	ppm	ppm	ppm	ppm	ppm	ppm	ppm	%	ppm	ppm	ppm	g	g/tonne	%
Detection Limit	2	1	1	0.5	3	5	0.1	0.01	0.5	0.2	0.05		3	0.001
Analysis Method	TD-ICP	INAA	TD-ICP	INAA	INAA	INAA	INAA	INAA	INAA	INAA	INAA	INAA	FA-GRA	ICP-OES
1	10	5	2	1	< 3	< 5	0.3	< 0.01	< 0.5	< 0.2	< 0.05	30.8		2.74

10

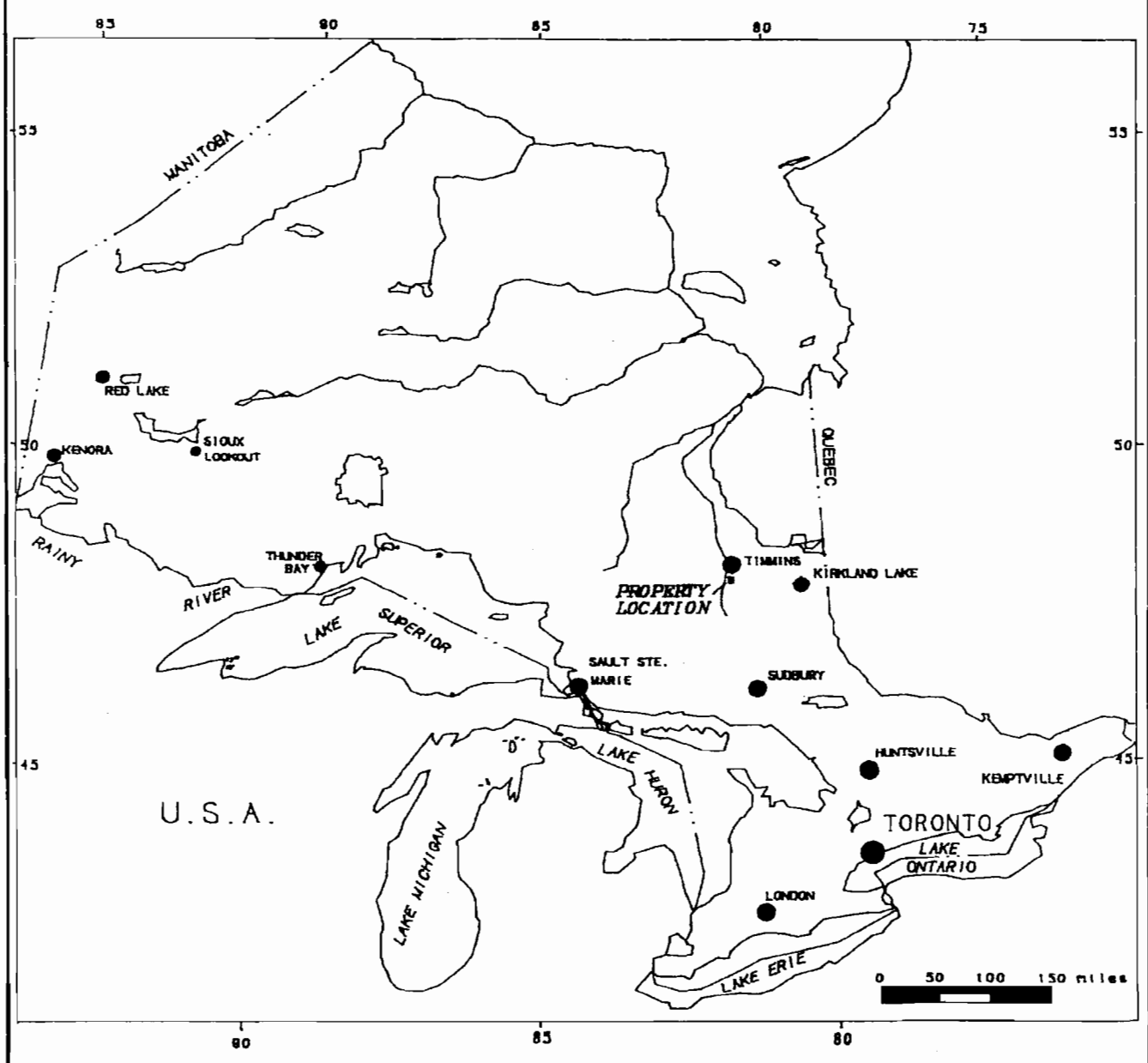

PROVINCE OF ONTARIO



Sample 000

2. 48491



Sample 002

2.48491